

CYBEX Industrial Limited

Suite 1222, 12/F | Leighton Centre | 77 Leighton Road | Causeway Bay | Hong Kong
www.cybex-online.com

Distributed in the United States by Columbus Trading-Partners USA Inc.
1801 Commerce Drive | Piqua, Ohio 45356, USA

Tel: 1-877-242-5676 | e-mail: support.americas@goodbabyint.com | www.cybex-online.com

© 2019 CYBEX Industrial Limited All rights reserved. Printed in China.
This product and its components are subject to change without notice. Patents pending.

© 2019 CYBEX Industrial Limited All rights reserved. Printed in China.
This product and its components are subject to change without notice. Patents pending.

ATON 2

OWNER'S MANUAL
MANUAL DEL PROPIETARIO

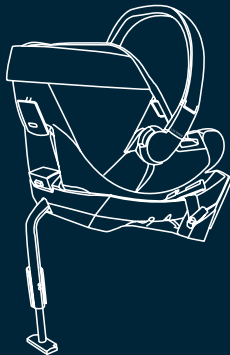

⚠ **READ** this Owner's Manual carefully before first use, and keep it for future reference.

⚠ **LEA** este Manual del Propietario minuciosamente antes de usarlo y guarde para su futura referencia.

Welcome to CYBEX!

Thank you for purchasing the CYBEX Aton 2. We are proud to bring this German engineered product to North America. We hope the Aton 2 will make your child's travel both safer and more pleasant, as well as make installation and use for you as simple as possible. The award winning Aton 2 brings two important safety innovations to the infant car seat category.

Front Impact Protection

The adjustable Load Leg helps minimize crash forces on a baby in a frontal crash. It allows the child restraint's safety systems to absorb and transfer crash forces more effectively by directing some of them to the vehicle floor.

Linear Side Impact Protection (LSP)

The side protectors transfer the initial impact of a side crash to the shell. The optimized structure of the shell absorbs the forces and channels them away from your baby.

Please read and follow these instructions carefully to install the Aton 2 correctly, even if the installation and use of this infant car seat might seem simple and intuitive. **Statistics show that over 72% of car seats are being used incorrectly!**

YOUR CHILD'S SAFETY DEPENDS ON YOU FOLLOWING THESE STEPS:

1. Choosing the best approved location in your vehicle for the child restraint.
2. Proper use of LATCH or the vehicle seat belts to install the child restraint.
3. Proper use of Load Leg whenever possible while using the Base.
4. Correct adjustment and use of the internal five-point Harness of the Infant Carrier.
5. Proper recline angle of the child restraint.

Before the first use of the Aton 2 infant car seat, please make sure you have followed all the steps in the Safety Checklist and CYBEX Safe Car Practices found on page 47.

Following the American Academy of Pediatrics' recommendations for safe transportation of infants, we recommend keeping your child rear facing in a properly installed infant seat until they are at least two (2) years of age or outgrow the maximum weight or height for the seat. Visit www.aap.org for more information on the Academy's recommendation.

No car seat can guarantee protection from injury in every situation, but proper use helps reduce the risk of death or serious injury. If you have any questions or need assistance, please contact Columbus Trading-Partners USA Inc. at 1-877-242-5676. Also, please remember to register your infant car seat so we can contact you in the unlikely event of a recall.

Keep this Owner's Manual for future reference by storing it in the pocket on the bottom of the Aton 2 Infant Carrier. We appreciate your purchase and invite you to visit www.cybex-online.com to see other great CYBEX products.

Table of Contents

Registration and Recall Information	2	Using a Lap Belt Only	36
Warnings and Important Safety Information.....	3	Using the Infant Carrier with the Base	38
Overview of the Aton 2 Infant Carrier.....	10	Using the Linear Side-impact Protection (LSP).....	39
Overview of the Aton 2 Base	12	Installing the Infant Carrier without the Base	40
Unique Features of the Aton 2.....	14	Using a Lap and Shoulder Belt.....	40
Child Size Requirements	15	Using a Lap Belt Only	42
Using the Infant Carrier	16	Adjusting the Recline Angle without the Base	43
Handle Positions	17	Using the Infant Carrier on Aircraft	44
Using the Designer Canopy™	17	Care and Cleaning.....	45
Adjusting the Harness Height	18	Safety Checklist.....	47
Newborn Inlay.....	19	General Information About Sensorsafe	48
Infant Insert	19	Using SensorSafe	52
Securing the Child.....	20	If You Need Help.....	56
More Support Options	22	If the Car Seat Has Been in a Crash.....	56
Vehicle Seat Location Requirements	23	Warranty	57
SensorSafe™ Application.....	26		
Using LATCH	27		
What is LATCH?	27		
Outer Seating Positions	27		
Center Seating Positions.....	28		
Using LATCH Guides	28		
Removing and Storing LATCH Connectors.....	29		
Using the Load Leg	30		
Adjusting the Recline Angle Using the Base.....	31		
Installing the Base	32		
Using LATCH.....	32		
Using a Lap and Shoulder Belt.....	34		

Registration and Recall Information

Please register your product immediately. You may complete the Registration Card that came with your Child Restraint and mail it to us, or register online. Child restraints could be recalled for safety reasons. You must register this restraint to be reached in a recall. Send your name, address, e-mail address if available, and the restraint's model number and manufacturing date to:

Columbus Trading-Partners USA Inc.
Attn: ParentLink
1801 Commerce Drive
Piqua, Ohio 45356, USA

Register online at: <http://register.cybex-online.com/us/carseats>

or call 1-877-242-5676

For recall information, call the U.S. Government's Vehicle Safety Hotline at: 1-888-327-4236 (TTY: 1-800-424-9153), or visit www.NHTSA.gov.

Certification

This child restraint system conforms to all applicable Federal Motor Vehicle Safety Standards.

When used WITH the internal harness and properly installed pursuant to these instructions, **this restraint is certified for use only in passenger and multi-purpose passenger motor vehicles, buses and trucks equipped with either lap belts only or lap/shoulder belt systems and for use in aircraft.**



Registration information may be found on the label to the right and also affixed to the underside of the Infant Carrier and the Base.

FOR YOUR CHILD'S CONTINUED SAFETY

Please take a few moments to promptly fill out and return the attached card (or register online using the direct link to the manufacturer's registration website provided).

Although child restraint systems undergo testing and evaluation, it is possible that a child restraint could be recalled.

In case of a recall, we can reach you only if we have your name and address, so please send in the card (or register online) to be on our recall list.

Please fill this card out using blue or black ink and mail it NOW.

(or register online at: <http://register.cybex-online.com/us/carseats>)
while you are thinking about it.

The card is already addressed and we've paid the postage.

Tear off and mail this part

Consumer: Just fill in your name and address and e-mail address.

Your Name

Your Street Address

City

State

Zip Code



E-mail Address (optional)

CHILD RESTRAINT REGISTRATION CARD

RG3099

PRODUCT INFORMATION LABEL

WARNING! DEATH or SERIOUS INJURY can occur

- **READ** this Owner's Manual carefully before first use, and keep it for future reference.
- **NEVER INSTALL** or use this child restraint until you have read and understand the instructions in this manual, the labeling on the product, the warnings, **AND** in your vehicle Owner's Manual . If there is a conflict between the two, the vehicle Owner's Manual must be followed. **FAILURE TO FOLLOW** these instructions and the instructions and warnings on the product can result in **DEATH or SERIOUS INJURY** of your child in a sharp turn, sudden stop, or crash.
- **DO NOT ALLOW** others to install or use this child restraint unless they understand how to correctly install and use it.
- **ONLY PLACE** this child restraint **REAR FACING** in a vehicle seating location allowed by the vehicle manufacturer. Refer to your vehicle's Owner's Manual  for information about vehicle seat belt systems, air bags and child restraint installations, to determine allowable seating positions.
- Not every location within a vehicle may be safe for the installation of this child restraint. In fact, some vehicles have no seating position that is safe for the installation of an Infant Car Seat. **IMPROPER PLACEMENT** of this child restraint within a vehicle will increase the risk of death or serious injury.
- Based on crash statistics, the US National Highway Traffic Safety Administration (NHTSA) recommends that parents select the **REAR SEAT** as the safest location for a properly installed child restraint.
- The primary protection for occupants of a vehicle in a collision is the structure of the vehicle itself; a child restraint will not protect a child when the vehicle is seriously impacted. **CORRECTLY USED**, this child restraint will substantially improve the chances for survival in most crashes.

⚠ WARNING! DEATH or SERIOUS INJURY can occur

When Used Inside a Vehicle

- **ONLY USE** with children who weigh between 1.8 and 15.9 kg (4 and 35 lb) **AND** whose height is between 43 and 76 cm (17 and 30 in).
- **DO NOT USE** this child restraint if the top of your child's head is **LESS THAN 2.5 cm** (1 inch) from the top of the restraint.
- **NEVER** place this child restraint on a front seat with an active airbag. **DEATH or SERIOUS INJURY** may occur. The **REAR** seat is the safest place for children 12 and under.

⚠ WARNING ⚠ AVERTISSEMENT ⚠ ADVERTENCIA

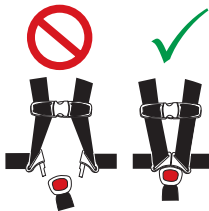

Children have **STRANGLED** in loose or partially buckled harness straps. Fully restrain the child even when the carrier is used outside the vehicle.

Des enfants se sont **ÉTRANGLÉS** dans des sangles de harnais desserrées ou mal bouclées. Bien attacher l'enfant dans le porte-bébé, même s'il est utilisé hors du véhicule.

Los niños se han **ESTRANGULADO** en las correas del arnés sueltas o parcialmente abrochado. Restringir totalmente al niño, incluso cuando el vehículo se utiliza fuera del vehículo.

CY_171_5670_A1218

WARNING! DEATH or SERIOUS INJURY can occur

- **ONLY USE** this child restraint **REAR FACING**.
- **NEVER INSTALL** this child restraint in vehicle seats that face the rear or side of the vehicle.
- **ALWAYS CHECK** the Harness buckle to make sure it is securely latched.
- **ALWAYS KEEP** your child properly secured in the Harness. A snug strap should not allow any slack. It lies in a relatively straight line without sagging. It does not press on the child's flesh or push the child's body into an unnatural position.
- **NEVER LEAVE** your child **UNATTENDED** or alone in the vehicle, even for one minute.
- **ALWAYS** have the handle **LOCKED** in the upright **DRIVE/CARRY** position while using this child restraint in a vehicle.
- **WHEN POSSIBLE, INSTALL** the Aton 2 Base in a seating position that will allow the Load Leg Foot to be extended into a **LOCKED** position with firm contact with the vehicle floor.
- **NEVER INSTALL** the Aton 2 Base in a seating position where the Load Leg, even in its shortest position, causes the Base to be pushed up above the vehicle seat. If necessary, the Base may be installed with the Load Leg folded up underneath.
- **ONLY USE** a Linear Side-impact Protection (LSP) device on the side of the child restraint immediately adjacent to a vehicle door or panel.
- **NEVER RAISE** a Linear Side-impact Protection (LSP) device toward a passenger or another child.
- **NEVER USE** this child restraint in a vehicle seating position where it cannot be secured tightly. A loosely installed child restraint will **NOT PROTECT** your child in a crash.

WARNING! DEATH or SERIOUS INJURY can occur

- **NEVER LEAVE** a vehicle seat back with a folding mechanism unlocked. In the event of a sudden stop, an unlocked vehicle seat back could prevent this child restraint from protecting your child as well as it should.
- **NEVER USE** this child restraint with any motorized or door mounted vehicle seat belts. Your child would not be properly restrained in the event of a crash.
- **NEVER USE** this child restraint on boats, low speed vehicles (LSV), all-terrain vehicles (ATV), golf carts, or any other non-certified application.
- **BEFORE** each use, **ALWAYS CHECK** that the child restraint is tightly secured in the vehicle seat and does not move more than 2.5 cm (1 inch) in any direction when checked at the belt path.
- **ALWAYS CHECK** buckles and other parts for hot surfaces. A hot surface could burn your child! Cover an unoccupied child restraint with a blanket when leaving it in a vehicle exposed to sunlight.
- **ALWAYS CHECK** to make sure the Infant Carrier is securely attached to the Base, each time you use this restraint. After attaching the Infant Carrier to the base, **LIFT UP** on the Infant Carrier handle to make sure that it is securely attached to the base.
- **NEVER LEAVE** an empty child restraint unsecured in your vehicle. This restraint **MUST ALWAYS BE SECURED**, even when not occupied. An unsecured child restraint could injure vehicle occupants in a sudden stop or crash.

WARNING! DEATH or SERIOUS INJURY can occur

- If the LATCH connectors are **NOT BEING USED** make sure they are securely stored.
- **DO NOT USE** this child restraint if it has been in a crash. There may be hidden damage and it must be replaced. Your insurance company may provide some assistance in replacing the child restraint.
- **NEVER USE** this child restraint when it is older than six (6) years. The date of manufacture can be found on a label affixed to the bottom of the Infant Carrier, as well as the Base.
- **NEVER USE** this child restraint if any of the Harness or LATCH straps are cut, frayed, or damaged in any way.
- **NEVER USE** accessories or parts with this child restraint other than those approved by CYBEX. Use of accessories or parts

from other manufacturers could alter the performance of the child restraint.

When Using the Infant Carrier Outside a Vehicle

- **NEVER LEAVE** child unattended.
- **SUFFOCATION HAZARD:** Infant carrier can roll over on soft surfaces and suffocate child. **NEVER** place Infant Carrier on beds, sofas, or other soft surfaces.
- **FALL HAZARD:** Child's activity can move carrier. **NEVER** place carrier on counter tops, tables, or any other elevated surfaces.
- **ALWAYS USE** the complete and buckled five-point Harness around your child.
- **ALWAYS KEEP** your child properly secured in the Harness, even when using the carrier outside of the vehicle.

WARNING! DEATH or SERIOUS INJURY can occur

- **DO NOT USE** the infant carrier if it is damaged or broken.
- **NEVER PLACE** Infant Carrier on top of a shopping cart.
- **MAKE SURE** the handle is **LOCKED** in the Carry Position before lifting Infant Carrier by the handle. An unlocked handle could move unexpectedly, causing child to fall.
- **ONLY USE** Infant Carrier with strollers that are approved by the manufacturer. Refer to the stroller Owner's Manual for details about how to attach the Infant Carrier to your stroller. For a list of compatible strollers, please visit www.cybex-online.com

Additional Safety Information

- **REGISTER** this child restraint. This is the best way to reach you in the event of a recall.
- **DO NOT** use this or any other child restraint with a premature, low birth weight, or medically fragile infant, until after you have consulted with your doctor. Some infants may have difficulty breathing or have other medical problems when placed in a seated position.
- **DO NOT ALLOW** children to play with this child restraint.
- **DO NOT ATTEMPT** to make repairs to or otherwise modify or tamper with this child restraint.
- **DO NOT USE** a used child restraint whose history you do not know.

WARNING! DEATH or SERIOUS INJURY can occur

- **DO NOT ALLOW** children to play with vehicle seat belts. They may create an **ENTANGLEMENT HAZARD** for any child that can reach the seat belt and may wrap it around his or her neck.
- **DO NOT LEAVE** loose objects (e.g. groceries, books, bags) in a vehicle. In the event of a sudden stop, loose objects will keep moving, potentially causing serious injuries.
- **NEVER TEND** to your child's needs while driving. **ALWAYS** safely stop your vehicle in order to tend to your child.
- **NEVER TAKE** your child out of the infant car seat while the vehicle is moving. Unrestrained occupants are at a greatly increased risk of **DEATH** or **SERIOUS INJURY** in a car crash.
- **ALWAYS LOCK** an unoccupied vehicle. Children can get into vehicle and accidentally lock themselves in, resulting in **DEATH** or **SERIOUS INJURY**.

Overview of the Aton 2 Infant Carrier

Top View

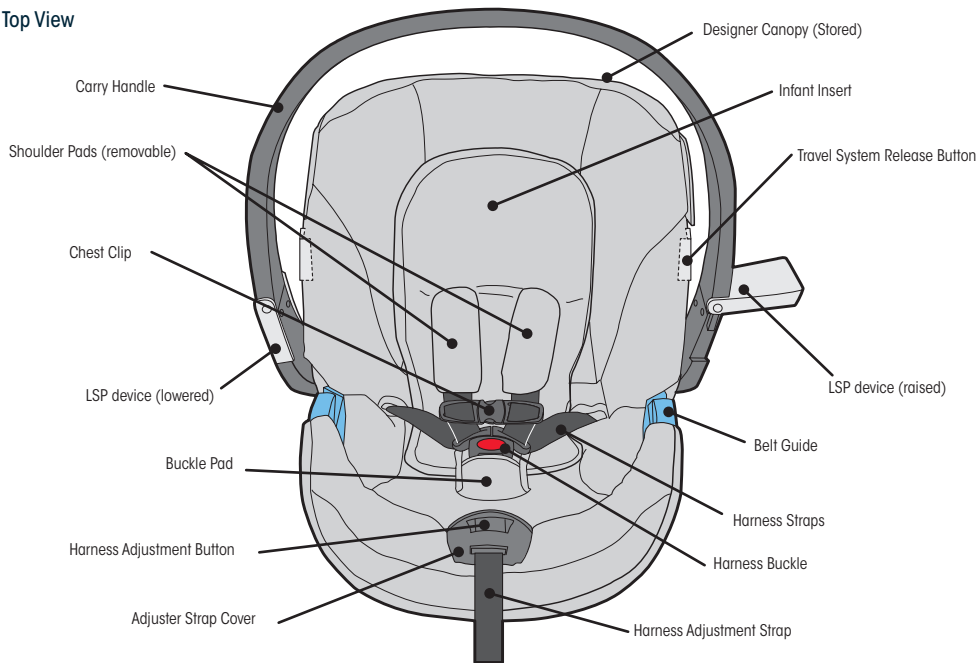

Overview of the Aton 2 Infant Carrier

Bottom View

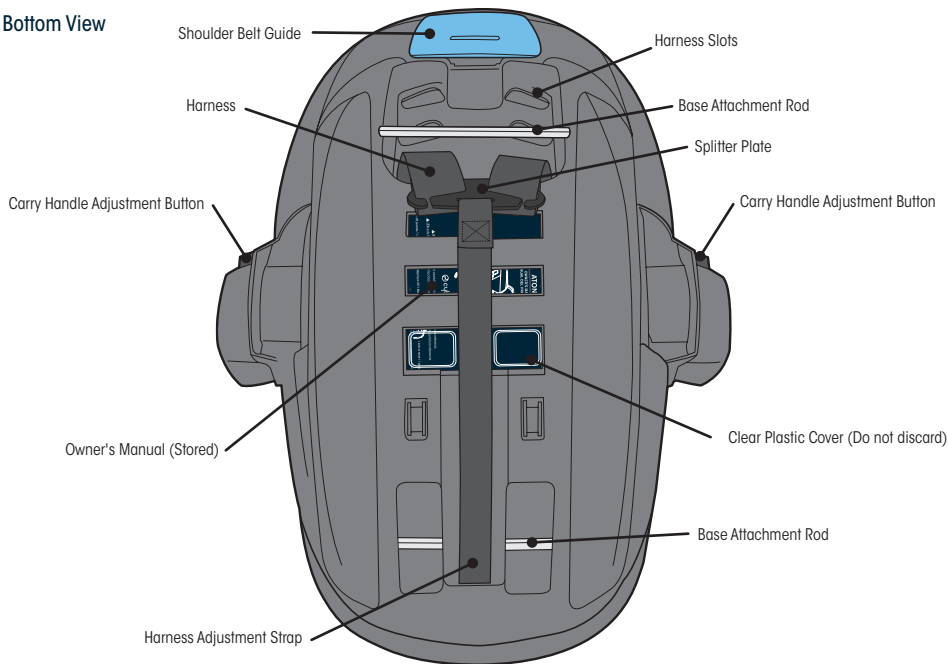

Overview of the Aton 2 Base

Front View

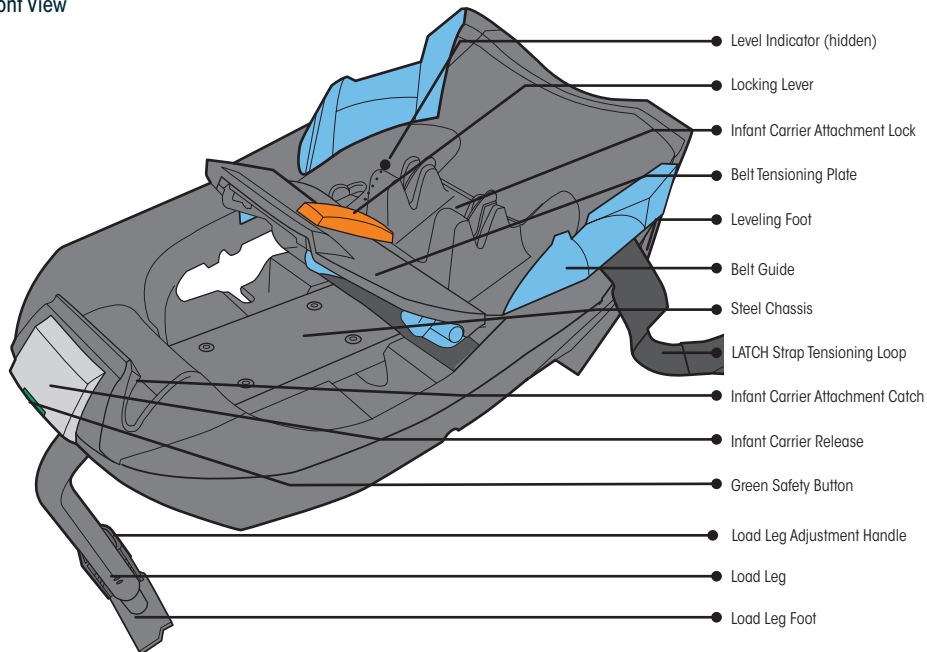

Overview of the Aton 2 Base

Rear View

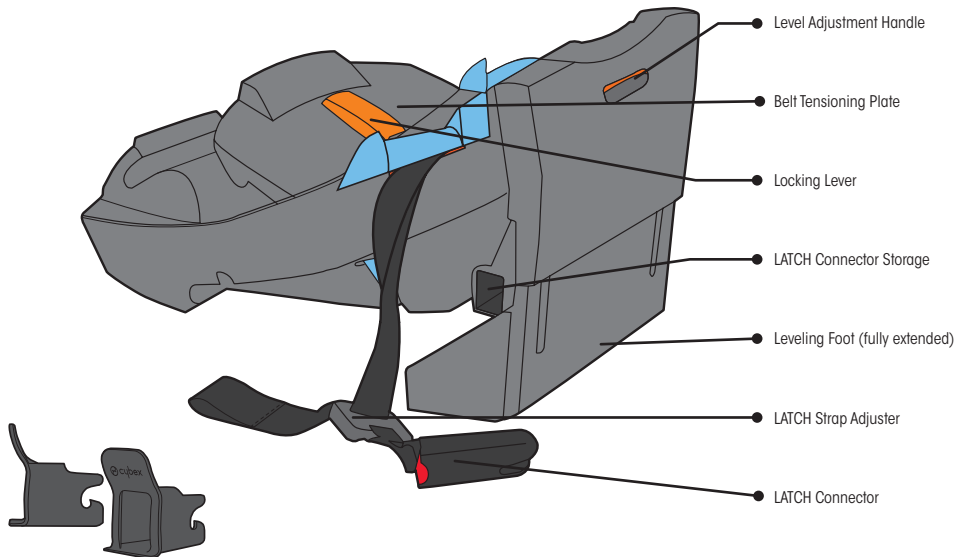

LATCH Guides

Unique Features of the Aton 2

Linear Side-impact Protection (LSP)

The side protectors transfer the initial impact of a side crash to the shell. The optimized structure of the shell absorbs the forces and channels them away from your baby.

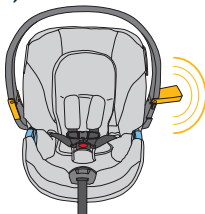

Super Easy And Tight Installation

The Aton 2 Belt Tensioner uses CYBEX's Super Easy And Tight (SEAT) Technology to achieve a quick and secure installation every time, whether you choose to use LATCH or vehicle belts.

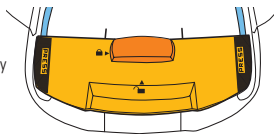

Load Leg

The adjustable Load Leg helps minimize crash forces on a baby in a frontal crash. It allows the child restraint's safety systems to absorb and transfer crash forces more effectively by directing some of them to the vehicle floor.

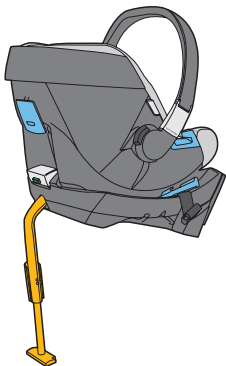

Dual Range Level Indicator

The Aton Level Indicator is calibrated for two different weight ranges. Use the weight range appropriate for your child.



Steel Chassis

The Steel Chassis is a continuous metal frame integrated into the Base from front to back. It provides strength, a secure connection between the Infant Carrier and Base, and also absorbs crash forces from the Load Leg.

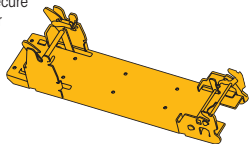

Child Size Requirements

! WARNING! DEATH or SERIOUS INJURY can occur

DO NOT USE THIS CHILD RESTRAINT IF YOUR CHILD DOES NOT MEET ALL OF THESE REQUIREMENTS:

MASS is between 1.8–15.9 kg (4–35 lb)
AND

Height is BETWEEN 43–76 cm (17–30 in)
AND

Top of child's head is a minimum of 2.5 cm (1 in) below the top of the Infant Carrier.

Rear Facing is Safest

Following the *American Academy of Pediatrics'* recommendations for safe transportation of infants, we recommend keeping your child rear facing in a properly installed infant seat until they outgrow the maximum weight or height for the seat. Visit www.aap.org for more information on the Academy's recommendation.

- ★ Use the CYBEX Aton 2 until your child reaches the maximum weight or height limits. Because not all children have the same shapes and sizes, **DO NOT USE** the Aton 2 when the top of the child's head is less than 2.5 cm (1 inch) from the top of the Infant Carrier. This allows for proper protection during a crash.
- ★ After your child outgrows the Aton 2, keep your child rear-facing in a convertible seat as long as possible, according to the manufacturer's specifications, before turning them around to ride Forward Facing.

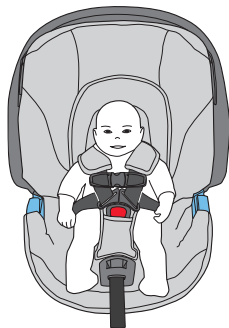

Minimum 2,5 cm (1 inch)

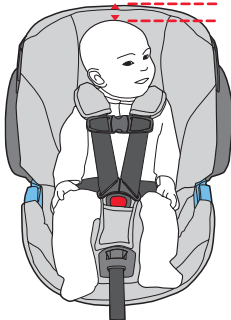

Using the Infant Carrier

Harness Buckle

To release Buckle Tongues, firmly press the **RED** button on the Harness Buckle and pull the tongues out.

To fasten, insert each Tongue into Buckle, listening for an audible . Pull on each to verify a secure connection.

★ Check that the Buckle functions properly and is kept free of dirt and debris. For cleaning, see page 45.

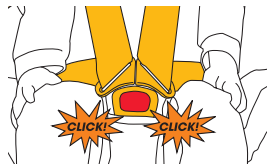

Chest Clip

To separate Chest Clip, squeeze top and bottom tabs and pull apart. To fasten, slide the two parts together until an audible  is heard.

★ Always position the center of the Chest Clip even with the child's armpits.

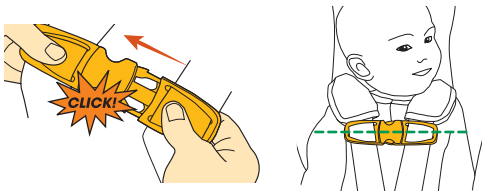

One Handed Harness Adjustment

Loosen Harness by firmly pressing down the Harness Adjustment Button **(a)** while pulling forward on both straps **(b)** at shoulder level.

Pull the Adjuster Strap **(c)** to tighten the Shoulder Straps.

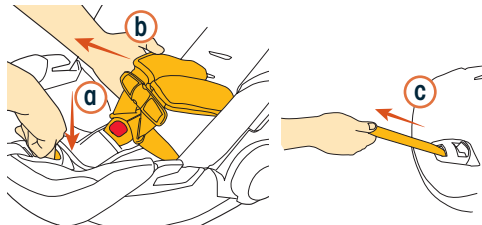

Using the Infant Carrier

Handle Positions

The Handle has four **LOCKED** positions:

1. **DRIVE and CARRY**
2. **1ST LOADING POSITION**
3. **2ND LOADING POSITION**
4. **RESTING**

To move handle to a new position, squeeze **BOTH** Handle Adjustment Buttons **a** (one on each side) while rotating handle **b**.

i BOTH Adjustment Buttons must be depressed at the same time in order for the handle to move.

! WARNING! DEATH or SERIOUS INJURY can occur

- **ALWAYS** have the handle **LOCKED** in the **DRIVE/CARRY** position while using this child restraint in a vehicle.
- **ALWAYS** verify that the handle is **LOCKED** in the **DRIVE/CARRY** position before lifting Infant Carrier by the handle. An unlocked handle could move unexpectedly, causing child to fall out.
- **ALWAYS KEEP** your child properly secured in the Harness even when using the carrier outside of the vehicle.
- **NEVER HANG** toys or other objects from handle when using child restraint in a vehicle as they could seriously injure a child in a sudden stop or crash.

Using the Designer Canopy™

Simply pull forward to extend the Aton 2 Canopy. The Canopy has two positions as shown.

To retract the Canopy, gently push it back into its original position.

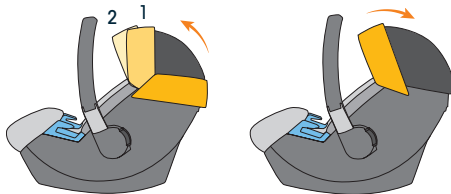
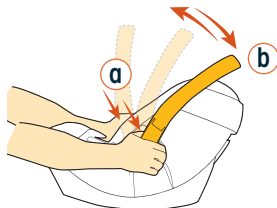
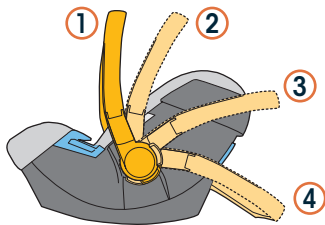

Using the Infant Carrier

Adjusting the Harness Height

For proper use of the Infant Carrier, the Harness shoulder straps **MUST** be at the correct height for your child.

1. Place child in Infant Carrier making sure their bottom is in the seat, and their back is fully supported.
2. Identify the **CLOSEST** Harness Strap Slots that are **AT or BELOW** your child's shoulders.

i The Infant Insert can obscure the correct Harness Slot. Be sure to identify the correct Harness Slot on the Carrier itself.

3. If the Harness Straps need adjusting, remove child and turn the Infant Carrier over to locate the Splitter Plate. Unhook one Shoulder Strap from the Splitter Plate.

i Only adjust one strap at a time to have the other strap for reference.

4. From the front, pull the strap out of the slot, Seat Cover, and Infant Insert (if used).
5. Re-thread through the Infant Insert (if used), Seat Cover and correct Harness Slot.
6. Reattach strap to the Splitter Plate and repeat for the other strap, ensuring that the strap is routed under the base attachment rod.
7. Check that Harness is free from twists and that it can be tightened and loosened easily.

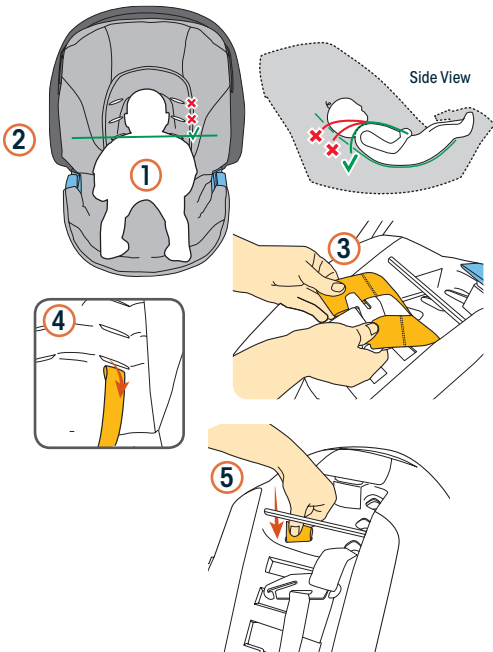

⚠ WARNING! DEATH or SERIOUS INJURY can occur

- NEVER REMOVE Harness or Harness components from Infant Carrier.
- DO NOT USE child restraint if any part of the Harness is damaged..



Periodically check for proper shoulder strap height as your child grows.

Using the Infant Carrier

Newborn Inlay

The Newborn Inlay is a specially designed EPS foam component located in the bottom of the Infant Carrier underneath the Seat Cover. The Inlay helps to position smaller babies properly in the Aton 2 during their first few months. We recommend using the Newborn Inlay until your child is 5 kg (11 lb) (about 3 months old).

Removing the Newborn Inlay

At the bottom of the seat there is an opening in the seat cover. Simply lift up and remove the Newborn Inlay from the seat. Keep it for future use.

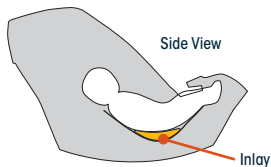

Infant Insert

To ensure a better fit for infants, we recommend using the Aton 2 Infant Insert. The Insert will give more stability to the head and upper torso, as well as provide a better Harness fit for smaller babies. We recommend using the Infant Insert until 10 kg (22 lb) or until child needs more room. If the Insert pushes baby's head forward, or compromises the fitting of the child to the seat it should be removed.

Folding the Insert

If your child's shoulders are below the first set of Harness Slots, you may fold the lower portion of the Infant Insert **UNDER** your child to boost him/her up for proper Harness fit.

Unfold the Insert when the child's shoulders are at the height of the second set of Harness Slots.

Removing the Infant Insert

Follow the steps for Adjusting Harness Height on page 18.

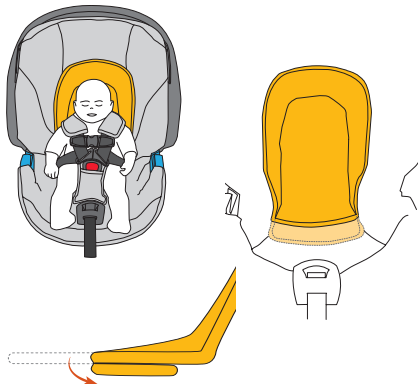

WARNING! To avoid DEATH or SERIOUS INJURY, NEVER place extra padding under or behind the child. The Infant Insert is the only approved padding to be used with the Aton 2.

Using the Infant Carrier

Securing the Child

1. Loosen Harness by firmly pressing down the Harness Adjustment Button **a** while pulling forward on both straps at shoulder level. **b**
2. Press **RED** button on Harness Buckle to release Tongues.
3. Separate Chest Clip and spread straps apart. Place child in Infant Carrier in seated position making sure their bottom is in the seat, and their back is fully supported.
4. Pull Harness straps over each arm onto shoulders and around the hips. Make sure Buckle Pad and Harness Buckle are between the legs.

★ *Newborns tend to draw arms and legs close to their bodies. Gently extend each limb to allow for proper Harness positioning. Be mindful of especially sensitive areas.*

5. Buckle by inserting one Tongue at a time into the Harness Buckle listening for an audible  with each one. Make sure Harness Straps are not twisted.

WARNING! DEATH or SERIOUS INJURY can occur

- **MAKE SURE** Harness straps are AT or BELOW child's shoulders. If not, refer to Adjusting Harness Height on page 18, or the Infant Insert section found on page 19.
 - **ALWAYS** check Harness Buckle to make sure it is securely latched..
6. Connect the Chest Clip listening for an audible .

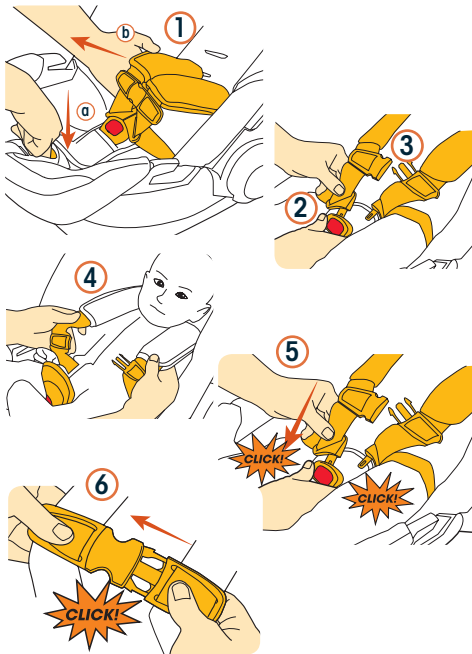

Using the Infant Carrier

7. Pull up on Harness Straps to snug around the child's hips while holding the Harness Buckle in place.
8. Slowly pull the adjuster strap to tighten the Shoulder Straps. A snug strap should not allow any slack. It lies in a relatively straight line without sagging. It does not press on the child's flesh or push the child's body into an unnatural position.
9. Position the center of the Chest Clip even with the child's armpits. Make sure the Shoulder Pads do not interfere with the placement of the Chest Clip.

i If the Shoulder Pads don't allow a proper fit, they can be removed to provide more space for the Chest Clip. Unsnap to remove.

10. Harness Pinch Test. To test for a properly tightened Harness, pinch the shoulder strap. A snug Harness should not allow you to pinch any slack when pinched between your thumb and forefinger.

★ To keep child warm, place a blanket over child and Infant Carrier, **AFTER** you have properly secured and tightened Harness around your child.

! WARNING! DEATH or SERIOUS INJURY can occur

- ALWAYS KEEP child properly secured in Harness.
- NEVER SECURE child in Infant Carrier dressed in a bulky garment or heavy clothing..

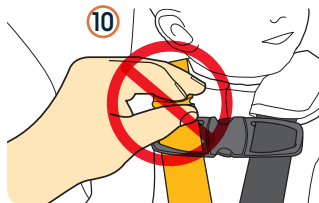
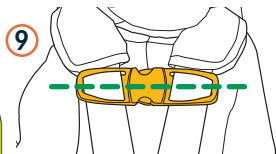
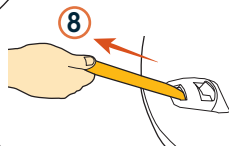
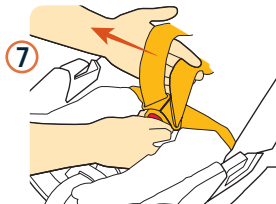

Using the Infant Carrier

More Support Options

Head and Upper Body

If you feel your child needs further head or upper body support, you may use tightly rolled blankets positioned along your child's sides for added support.

Only add blankets after child is secured in the seat, making sure that nothing interferes with the Harness.

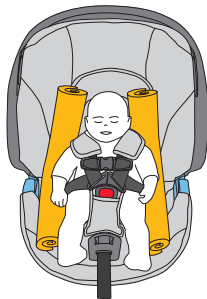
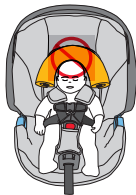

Between the Legs

With smaller babies, there is often a gap between the crotch and the crotch strap, resulting in a slouched posture. You may use a rolled wash cloth for support. Position a tightly rolled wash cloth between the legs and behind the Harness Buckle and Pad to "fill in" the extra space.

Only add the rolled wash cloth after child is in the Infant Carrier with their bottom in the seat, and their back fully supported. Make sure legs are straddling the crotch strap.

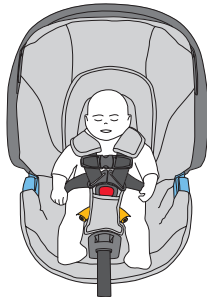

WARNING!: To avoid DEATH or SERIOUS INJURY, NEVER PLACE extra padding UNDER or BEHIND the child. The Infant Insert is the only approved padding to be used with the Aton 2.

! WARNING! DEATH or SERIOUS INJURY can occur

NEVER place this child restraint on a front seat with an active airbag. **DEATH** or **SERIOUS INJURY** may occur. The **REAR** seat is the safest place for children 12 and under.



Based on crash statistics, the US National Highway Traffic Safety Administration (NHTSA) recommends that parents select the **REAR SEAT** as the safest location for a properly installed child restraint rather than a front seating position.

ONLY PLACE this child restraint **REAR FACING** in a vehicle seating location allowed by the vehicle manufacturer. Refer to your vehicle Owner's Manual  for information about vehicle seat belt systems, air bags, and child restraint installation to determine allowable seating positions.

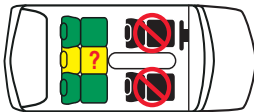
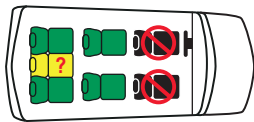

Vehicle Seat Location Requirements

⚠️ WARNING! DEATH or SERIOUS INJURY can occur

If possible, **INSTALL** the Aton 2 Base in a seating position that will allow the Load Leg Foot to be extended into a **LOCKED** position with firm contact with the vehicle floor.

NEVER INSTALL the Aton 2 Base in a seating position where the Load Leg, even in its shortest position, causes the Base to be pushed up above the vehicle seat. If necessary, the Base may be installed with the Load Leg folded up underneath.

The **REAR SEAT** is the safest location for a properly installed child restraint.

Use this child restraint in **FORWARD FACING VEHICLE SEATS ONLY**.

i The Aton 2 is allowed to touch the vehicle seat(s) in front of it, as long the recline angle of the Aton 2 is not affected.

★ The best position for the child restraint is one that is recommended by your vehicle Owner's Manual  **AND** allows a proper and secure installation of the restraint every time. If possible, have an adult ride in the rear with the child in order to monitor the child.

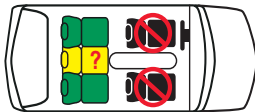
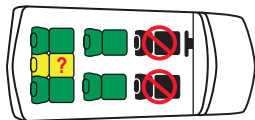

Vehicle Seat Location Requirements

Vehicle Seat Belts



The design and operation of vehicle seat belt systems vary from vehicle to vehicle and from seating location to seating location in the same vehicle. Refer to your vehicle Owner's Manual  for proper use, placement, and adjustment of the vehicle's lap and shoulder belts.

! WARNING: To avoid DEATH or SERIOUS INJURY, NEVER INSTALL THIS CHILD RESTRAINT WITH ANY OF THE FOLLOWING VEHICLE BELTS:

- A lap belt with a motorized shoulder belt
- Vehicle belts that are attached to the door in any way, or that move along a track automatically to restrain the passenger when the door is closed
- Lap belts with an Emergency Locking Retractor (ELR).
These lap belts stay loose and can move until locking in a crash or sudden stop.
- Combination Lap/Shoulder Belt with Two ELR Retractors.
Lap-shoulder belts that have a separate non-locking retractor each for the lap section and the shoulder section, including Inflatable Seat Belts.
- Lap belts forward of the seat crease, or bight.



SensorSafe™ Application

 NEVER INSTALL or use this Child Restraint until you have read and understand the instructions in this manual, the product labeling and in your vehicle Owner's Manual . If there is a conflict between the two, the vehicle Owner's Manual must be followed.

This seat works with the SensorSafe Application which can be downloaded from: The App Store® or Google Play™.***

The SensorSafe Application* can provide the following information directly to your smartphone:

1. Reminder that your child is still in your automobile
2. Current temperature of your automobile interior
3. User Manuals
4. Installation Videos
5. Customer care contact information

SensorSafe™ Technology

Questions? Comments?:

Visit us at: www.cybex-online.com

or call CYBEX at: 1-877-242-5676

* Not available on all models. Styles may vary. ** Trademarks are the property of their respective owners.

Using LATCH

What is LATCH?

LATCH is an acronym for Lower Anchors and Tethers for Children and refers to a pair of fixed lower anchors (or bars) and a top tether anchor that are built into your vehicle.

The lower LATCH anchors are located in the crease, or bight, between the vehicle seat back and seat cushion, and if not visible, will typically be indicated by  symbols. Top tether anchors are located in various places behind the seat but are **NOT USED** for the Aton 2 Infant Carrier or the Base.

Is it safer?

LATCH typically offers an easier and more consistent installation. However, this child restraint can be safely installed using either LATCH or vehicle belts. Either method is safe for your child when installed correctly.

LATCH is standard in vehicles manufactured after September 1, 2002. Refer to your vehicle Owner's Manual  for lower LATCH anchor positions in your vehicle.

Outer Seating Positions

Use the lower LATCH anchors **OR** a vehicle seat belt to install the child restraint in outboard seating positions (those on either side of the center position).

! WARNING! DEATH or SERIOUS INJURY can occur
NEVER USE LATCH together with the vehicle belts to install this child restraint. Using both is not approved and may cause improper performance of the child restraint.

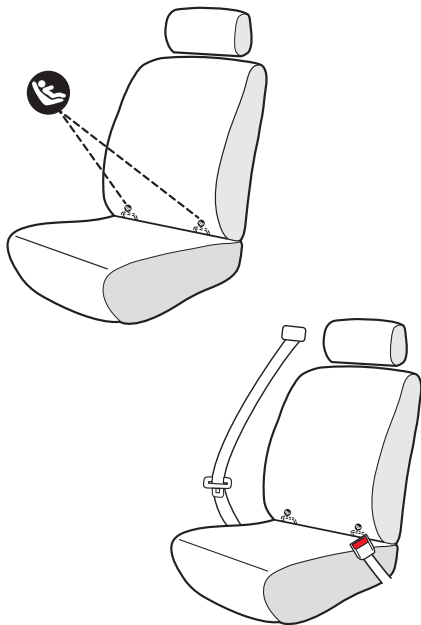

Using LATCH

Center Seating Positions

If your vehicle does not have Lower Anchors in the center seating position, check your Vehicle Owner's Manual to see if you are allowed to use the two inner Lower Anchors from the outboard seating positions to install a Child Restraint.

CYBEX allows this child restraint to be installed using the two inner Lower Anchors from the outboard seating positions if the distance between the inner Lower Anchors is between 28-51 cm (11 and 20 inches) AND if your vehicle manufacturer allows it. (If distance is not correct and/or not allowed by vehicle manufacturer, use the vehicle belt for installation in the center position.)

When using the inner Lower Anchors make sure there are no obstructions from a buckle stalk for the installation and that the LATCH straps or mini connectors do not block vehicle belt buckles.

Make sure there is enough height to use the Load Leg in the Center Seating Position. Many vehicles have a hump in the floor that could cause the Load Leg, even its shortest position, to push the Base above the vehicle seat which will not allow proper installation. See page 30.

★ If using LATCH in the center seating position, **ALWAYS** check the vehicle Owner's Manual  for correct use of lower LATCH anchors.

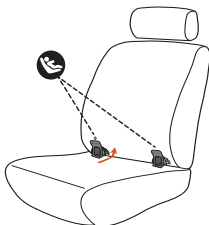
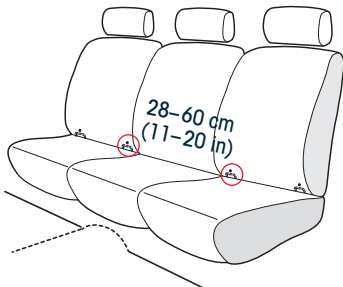

Using LATCH Guides

1. Locate the lower LATCH anchors or the symbols indicating their location.
2. If the lower LATCH anchors are hidden behind the crease between the seat back and seat cushion, install the supplied LATCH Guides to the lower LATCH anchors for easier installation of the Aton 2 Base.
3. To install, connect the two LATCH Guides to the two lower LATCH anchors by sliding the LATCH Guides into the crease and under the lower LATCH anchors.

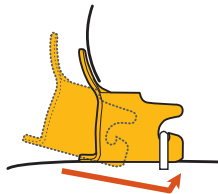

Removing and Storing LATCH Connectors

To Remove from Storage

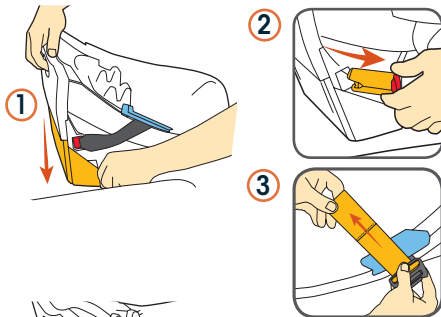

To install the Base using LATCH, the Connectors must be removed from their storage compartments.

1. To access the LATCH Connector Storage compartments, squeeze the Level Adjustment Handle to fully extend the Leveling Foot.
2. Remove each connector by pushing the **RED** button while pulling out.
3. Lengthen the strap between the connectors using the LATCH Strap Adjuster located next to the connector on the right-hand side. Push down on the Adjuster button while lengthening strap.



To Store

When using a vehicle belt to secure the Base, the LATCH Connectors **MUST** be stored in the Base. Loose Connectors could seriously injure vehicle occupants in the event of a crash.

1. Fully extend the Leveling Foot and slide each connector back into its Storage slot until an audible  is heard.
 2. Close and Lock the Belt Tensioning Plate.
 3. Remove any slack from the LATCH strap by pulling on the LATCH Strap Tensioning Loop.
-  **Do not remove more slack from the LATCH Strap than necessary to allow it to lie flat on the bottom of the Base between the Belt Guides.**
-  **DO NOT TIGHTEN the Latch Strap, as this will interfere with the Belt Tensioning Plate when installing the Base using vehicle belts.**

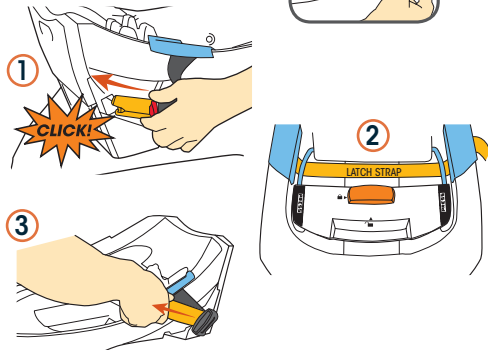

Using the Load Leg

The Load Leg is an effective safety feature of the Aton 2 and using it is **STRONGLY RECOMMENDED**. However, if necessary (e.g. in a center position with a hump in the floor), the Base may be installed with the Load Leg folded up underneath.

If ALL installation requirements for the Load Leg cannot be met, you **MUST** choose another seating position, or install the Infant Carrier without the Base.

When possible, **INSTALL** the Aton 2 Base in a seating position that will allow the Load Leg Foot to be extended into a locked position with firm contact with the vehicle floor.

⚠ WARNING! DEATH or SERIOUS INJURY can occur

- **NEVER EXTEND** the Aton 2 Base in a seating position where the Load Leg, even in its shortest position, causes the Base to be pushed up above the vehicle seat. If necessary, the Base may be installed with the Load Leg folded up underneath.
- **NEVER INSTALL** the Load Leg Foot beyond the **FIRST** hole that will lock it firmly against the vehicle floor.

To Extend

1. Install the Base making sure Recline Angle is correct for your child.
2. Squeeze the Adjustment Handle on the Load Leg and extend the Foot until it rests on the vehicle floor.
3. **Secure** the Foot into place using the first hole that will lock it firmly against the vehicle floor without lifting the Base up off of the seat.

i It may be necessary to lift up *slightly* on the Base to allow the Foot to lock into the hole.

To Retract

Squeeze Handle and retract Foot.

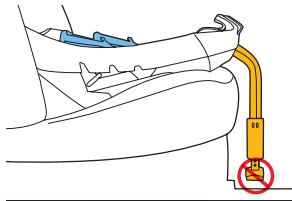

There should **NEVER** be any space between the Load Leg Foot and the vehicle floor.

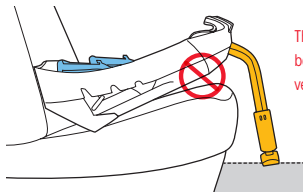

The Base should **NEVER** be pushed up above the vehicle seat.

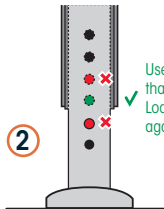
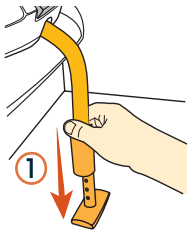

Use the **FIRST** hole that will lock the Load Leg Foot firmly against vehicle floor

Adjusting the Recline Angle Using the Base

It is very important for your child's safety that this child restraint be installed at the correct recline angle. Before attaching the Infant Carrier to the Base, always check the Level Indicator for the correct recline angle range based on child's weight.

! WARNING! DEATH or SERIOUS INJURY can occur

- DO NOT use this or any other child restraint with a premature, low birth weight, or medically fragile infant, until after you have consulted with your doctor. Some infants may have difficulty breathing or have other medical problems when placed in a seated position.
- If the child restraint is **TOO UPRIGHT**, the child's head may fall forward and cause breathing problems. If the child restraint is **TOO RECLINED** crash protection will be reduced.
- **FAILURE TO** properly recline the child restraint on the vehicle seat increases the risk of **DEATH or SERIOUS INJURY**.

i Vehicle must be on a level surface for the Level Indicator to function correctly.

Adjust Recline Angle

1. Squeeze the Level Adjustment Handle to extend or retract the Leveling Foot until the Base is within the recommended range for your child. There are four recline positions.
2. Release handle to lock Foot in place.
3. Install Base. Be sure to check for correct recline angle after installation.

i If the Recline Angle is not correct after installation, uninstall the base, adjust Leveling Foot and reinstall.

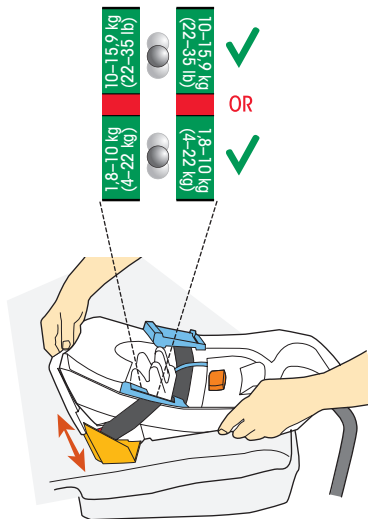

Installing the Base using LATCH

1. Remove LATCH anchors from storage. See page 29.
2. Unfold the Load Leg from underneath the Base.
3. Position Base on a rear vehicle seat. If a hump is present on the floor of the vehicle, see page 30 for important information on using the Load Leg in this seating position.
4. Adjust the Leveling Foot to achieve the correct range for your child's weight as shown on the Level Indicator. See page 31.
5. Fully open Belt Tensioning Plate by turning the **ORANGE** Locking Lever to the  OPEN position and lifting up on the Plate.

i Once open, the Belt Tensioning Plate will remain open on its own. The Locking Lever should be in the  OPEN position with the Plate open.

6. Attach both LATCH Connectors to the Lower LATCH Anchors. Each should make an audible  when attached. Make sure they are attached by pulling firmly on the connectors.
7. Push Base against vehicle seat back. Tension the LATCH strap by pulling on the LATCH Strap Tensioning Loop to take the slack out of the LATCH Strap, just enough to make it taut. Tuck the loose end of the strap under the base so it **WILL NOT INTERFERE** with the closing of the Belt Tensioning Plate or the connection of the Infant Carrier to the Base.

i At this point, the LATCH strap should be taut. The Belt Tensioning Plate will tighten the system fully.

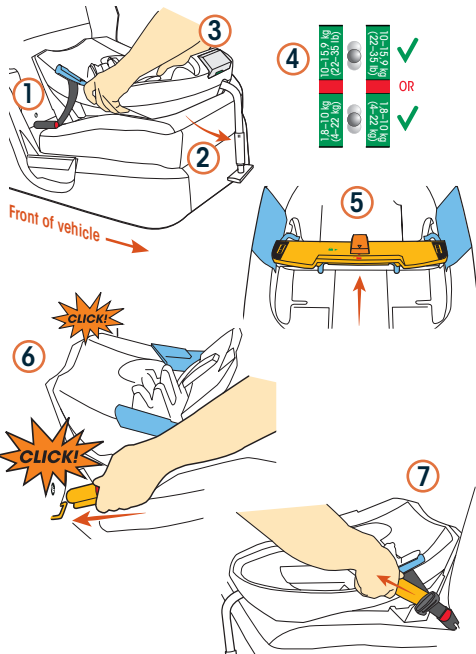

Installing the Base using LATCH

8. Press the Belt Tensioning Plate down with both hands, where indicated, until it locks into place. The **ORANGE** Locking Lever will rotate to the **LOCK** position when the Plate is locked.

i If Belt Tensioning Plate does not lock, try loosening the LATCH strap slightly.

9. Grab the Base at the Belt Guides and pull from side to side and front to back to make sure it is installed correctly. The base should not move more than 2.5 cm (1 inch) in any direction.

i If the Base moves too much, tension the LATCH Strap a little more and try again. After this, if the Base still moves too much, you may need to try a different vehicle seat location or installation method, or both.

10. Squeeze the Adjustment Handle on the Load Leg and extend it until the Foot makes firm contact with vehicle floor. Lock Leg into place using the first hole that will firmly lock it against the vehicle floor.

i It may be necessary to lift up *slightly* on the Base to allow the Foot to lock into the hole. See page 30.

11. Check that the Recline Angle remained in the appropriate range for the child's weight. If not, remove Base, adjust recline angle and reinstall. See page 31.

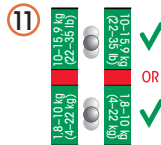
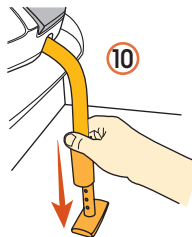
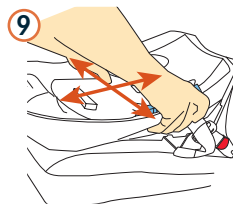
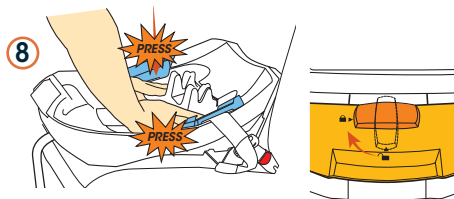

Use the **FIRST** hole that will lock the Load Leg Foot firmly against vehicle floor

Installing the Base Using a Lap and Shoulder Belt

1. Unfold the Load Leg from underneath the Base.
2. Position Base on a rear vehicle seat. If a hump is present on the floor of the vehicle, see page 30 for important information on using the Load Leg in this seating position.
3. Adjust the Leveling Foot to achieve the correct range for your child's weight as shown on the Level Indicator. See page 31.
4. Fully open Belt Tensioning Plate by turning the **ORANGE** Locking Lever to the  **OPEN** position and lifting up on the Plate.

i Once open, the Belt Tensioning Plate will remain open on its own. The Locking Lever should be in the  **OPEN** position with the Plate open.

5. Pull out vehicle belt to form a single length of about 60 cm (24 inches). Hold the buckle Tongue in one hand and squeeze the lap and shoulder belts together in the other.
6. Route the vehicle belts under the Belt Tensioning Plate, and through the Belt Guides on both sides of the Base. **BUCKLE THE BELT.** Make sure the belts lay flat and are not twisted.

i The vehicle belt should **ALWAYS** be routed **UNDER** the tab on the Belt Guide. **NEVER** place a vehicle belt over the tab on the Belt Guide, even in a vehicle with longer buckle stalks.

7. On the buckle side, first lift up on the shoulder belt to remove slack in the lap belt **(a)**. Then remove slack from the shoulder belt on the opposite side **(b)**.

i At this point, only remove slack from the vehicle belts, being careful not to over tighten them. The Belt Tensioning Plate will tighten the system fully. If you have previously installed the seat using **LATCH**, make sure the **LATCH Strap** lies flat on the bottom of the Base. See "To Store" section on page 29.

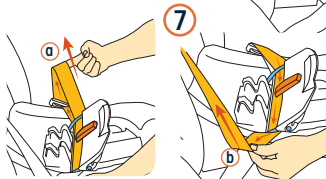
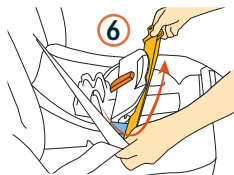
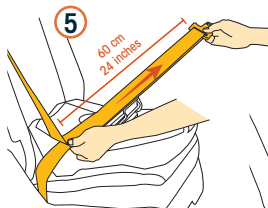
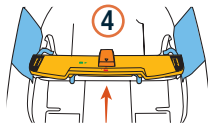
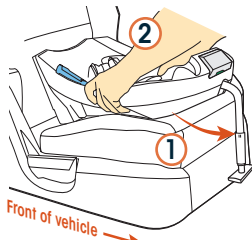

Installing the Base Using a Lap and Shoulder Belt

- Press the Belt Tensioning Plate down with both hands where indicated, until it locks into place. The **ORANGE** Locking Lever will rotate to the **CLOSE** position when the Plate is locked.

i If Belt Tensioning Plate does not lock, try loosening the vehicle belt slightly.

- Grab the Base at the Belt Guides and pull from side to side and front to back to make sure it is installed correctly. The Base should not move more than 2.5 cm (1 inch) in any direction.

i If the Base moves too much, open the Belt Tensioning Plate and remove a little more slack from the vehicle belt, close Plate and recheck. After this, if the Base still moves too much, you may need to try a different vehicle seat location or installation method, or both.

- Squeeze the Adjustment Handle on the Load Leg and extend it until the Foot makes firm contact with vehicle floor. Lock Leg into place using the first hole that will firmly lock it against the vehicle floor.

i It may be necessary to lift up *slightly* on the Base to allow the Foot to lock into the hole. See page 30.

- Check that the Recline Angle remained in the appropriate range for the child's weight. If not, remove Base, adjust recline angle and reinstall. See page 31.

i Make sure that vehicle belt buckle and hardware do not interfere with correct installation of the Base, or with the connection of the Infant Carrier to the Base.

- Put vehicle belt in **LOCKED** mode, see vehicle Owner's Manual for more information.

★ In most vehicles, you can switch the shoulder belt retractor into locking mode by pulling out shoulder belt all the way and then letting it rewind into the retractor. Pull on the belt to make sure it is locking.

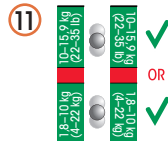
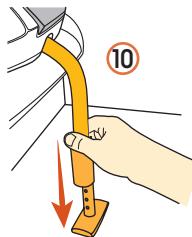
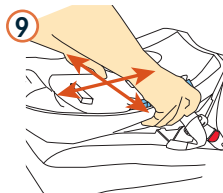
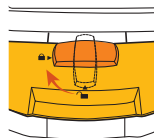
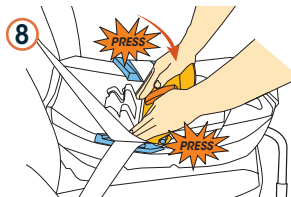

Use the **FIRST** hole that will lock the Load Leg Foot firmly against vehicle floor

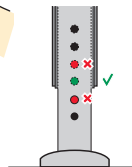

Installing the Base Using a Lap Belt Only

1. Unfold the Load Leg from underneath the Base.
2. Position Base on a rear vehicle seat. If a hump is present on the floor of the vehicle, see page 30 for important information on using the Load Leg in this seating position.
3. Adjust the Leveling Foot to achieve the correct range for your child's weight as shown on the Level Indicator. See page 31.
4. Fully open Belt Tensioning Plate by turning the **ORANGE** Locking Lever to the  **OPEN** position and lifting up on the Plate.

i Once open, the Belt Tensioning Plate will remain open on its own. The Locking Lever should be in the  **OPEN** position with the Plate open.

5. Route the lap belt under the Belt Tensioning Plate, and through the Belt Guides on both sides of the base. **BUCKLE THE BELT.** Remove slack from the lap belt and make sure the belts lay flat and are not twisted.

i The vehicle belt should **ALWAYS** be routed **UNDER** the tab on the Belt Guide. **NEVER** place a vehicle belt over the tab on the Belt Guide, even in a vehicle with longer buckle stalks.

6. Make sure the vehicle lap belt is **LOCKED**. Refer to vehicle Owner's Manual  for more information.

i At this point, only remove slack from the vehicle belt. The Belt Tensioning Plate will tighten the system fully. If you have previously installed the seat using **LATCH**, make sure the **LATCH** Strap lies flat on the bottom of the Base. See "To Store" section on page 29.

7. Tuck the loose end of the lap belt under the base, so it's out of the way and **DOES NOT INTERFERE** with the closing of the Belt Tensioning Plate or the connection of the Infant Carrier to the Base.

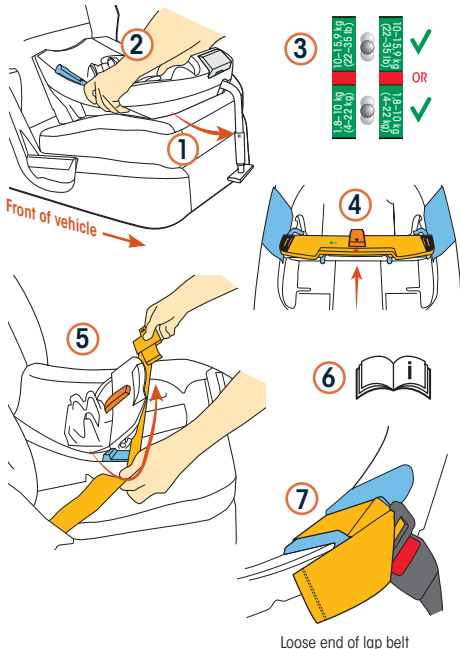

Installing the Base Using a Lap Belt Only

8. Press the Belt Tensioning Plate down with both hands, where indicated, until it locks into place. The **ORANGE** Locking Lever will rotate to the **CLOSE** position when the Plate is locked.

i If the Belt Tensioning Plate does not lock, try loosening the vehicle belt slightly.

9. Grab the Base at the Belt Guides and pull from side to side and front to back to make sure it is installed correctly. The Base should not move more than 2,5 cm (1 inch) in any direction.

i If the Base moves too much, open the Belt Tensioning Plate and remove a little more slack from the vehicle belt, close Plate and recheck. After this, if the Base still moves too much, you may need to try a different vehicle seat location or installation method, or both.

10. Squeeze the Adjustment Handle on the Load Leg and extend it until the Foot makes firm contact with vehicle floor. Lock Leg into place using the first hole that will firmly lock it against the vehicle floor.

i It may be necessary to lift up *slightly* on the Base to allow the Foot to lock into the hole. See page 30.

11. Check that the Recline Angle remained in the appropriate range for the child's weight. If not, remove Base, adjust recline angle and reinstall. See page 31.

i Make sure that vehicle belt buckle and hardware **DO NOT INTERFERE** with correct installation of the Base, or with the connection of the Infant Carrier to the Base.

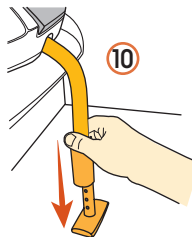
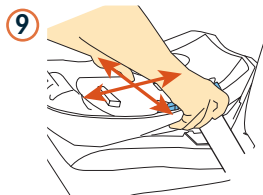
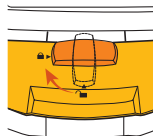
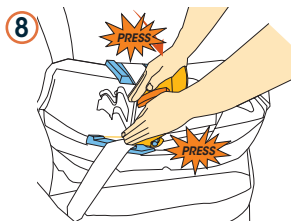

Use the **FIRST** hole that will lock the Load Leg Foot firmly against vehicle floor

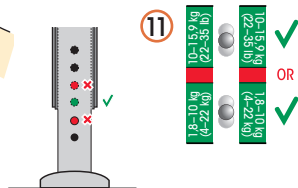

Using the Infant Carrier with the Base

Attaching Infant Carrier to Base

1. Make sure handle is **LOCKED** in the **DRIVE/CARRY** position.
2. Lift Infant Carrier by the Handle and slide the Attachment Rod under the Attachment Catch on the Base.
3. Rotate foot end of the Infant Carrier down onto the Base until an audible  is heard.

 The **GREEN** Safety Button will pop out from the middle of the Infant Carrier Release to indicate proper attachment.

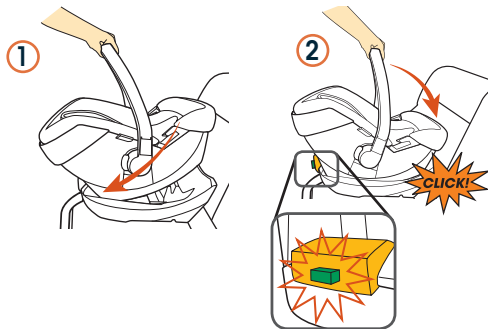

 The Aton 2 is allowed to touch the vehicle seat(s) in front of it, as long as the recline angle of the Aton 2 is not affected.

 **WARNING!** To avoid **DEATH** or **SERIOUS INJURY**, **ALWAYS** have the handle **LOCKED** in the upright **DRIVE/CARRY** position while using this child restraint in a vehicle.



Releasing Infant Carrier from Base

If used, lower the LSP device. See page 39.

1. Press **GREEN** Safety Button  in while pushing the Infant Carrier Release down .
2. Slightly tilt Infant Carrier toward front of vehicle. Grasp Infant Carrier with both hands to lift off.

 **WARNING!** **ALWAYS** verify that the handle is **LOCKED** in the **CARRY** position before lifting Infant Carrier by the handle. An unlocked handle could move unexpectedly, causing child to fall out.

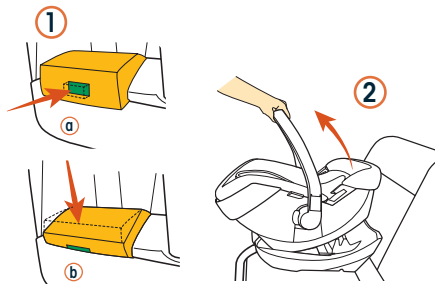

Using the Linear Side-impact Protection (LSP)

ALWAYS USE the LSP device when the Infant Carrier is installed in an outer seating position, either WITH OR WITHOUT the Base.

! WARNING! DEATH or SERIOUS INJURY can occur

- ALWAYS USE an LSP device on the side of the child restraint immediately adjacent to a vehicle door or panel.
- NEVER RAISE an LSP device toward a passenger or another child restraint.
- NEVER LIFT the child restraint using the LSP device.

To Raise

Lift the LSP device on the side of the Aton adjacent to the vehicle door or panel.

To Lower

Squeeze the two buttons **a** underneath the LSP device, while folding it down. **b**

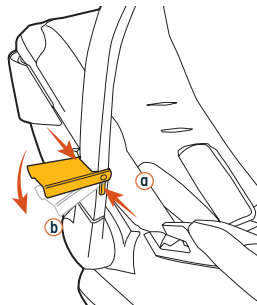
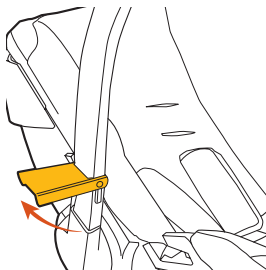
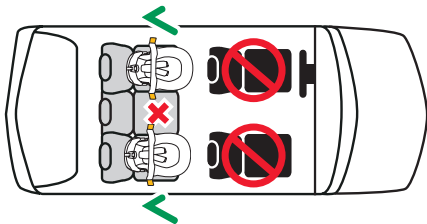

Installing the Infant Carrier without the Base using a Lap and Shoulder Belt

1. Position Infant Carrier on a rear vehicle seat, with the foot end firmly against the back of the vehicle seat.
2. Route just the lap belt portion under both Belt Guides. **BUCKLE THE BELT.**
3. Lift shoulder belt over handle and around Carrier. Slide shoulder belt into the **BLUE** Shoulder Belt Guide **a**.
4. **LOCK** your vehicle lap shoulder belt. Refer to your vehicle Owner's Manual  for how your vehicle lap and shoulder belt locks.

★ In many vehicles, you can switch the shoulder belt retractor into locking mode by pulling the shoulder belt out all the way. In some vehicles the buckle locks. Check the vehicle Owner's Manual  to see how your system locks.

★ To check if the vehicle belt is locked, after you install the infant carrier, pull up firmly on the lap belt between the Belt Guides. The belt should remain tight if the vehicle system is locked.

WARNING! To avoid DEATH or SERIOUS INJURY, NEVER install this child restraint using a non-locking vehicle lap shoulder belt. A locking clip **MUST BE** used with a vehicle belt that **DOES NOT LOCK**. Call the CYBEX Customer Care Department at 1-877-242-5676 to obtain a locking clip.

5. Push Infant Carrier firmly into vehicle seat pressing down near the crotch strap between the child's legs **a**, while removing slack from lap belt. Repeat for shoulder belt. **b**
6. Make sure that vehicle belt buckle and hardware **DO NOT INTERFERE** with the Infant Carrier.

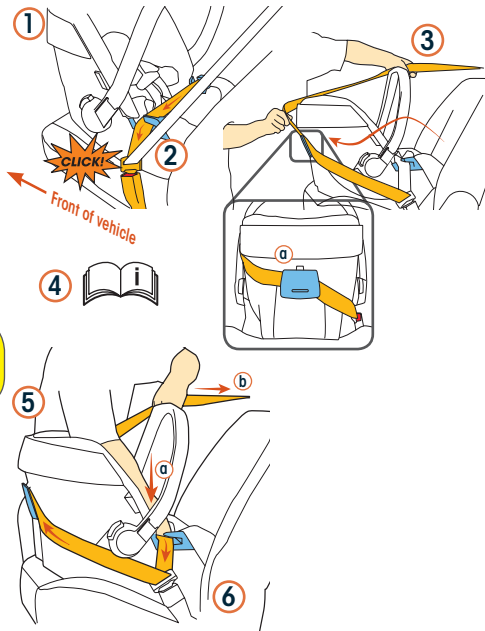

Installing the Infant Carrier without the Base using a Lap and Shoulder Belt

7. Check the recline angle. Adjust the seat angle until the **RED** line on the Infant Carrier is level with the ground. A tightly rolled towel or pool noodle may be placed under the Infant Carrier near the vehicle seat back to adjust the angle. See page 43.

i The Aton 2 is allowed to touch the vehicle seat(s) in front of it, as long as the recline angle of the Aton 2 is not affected.

8. Grab the Infant Carrier at the Belt Guides and pull from side to side and front to back to make sure it is installed correctly. The Infant Carrier should not move more than 2.5 cm (1 inch) in any direction.

i If the Infant Carrier moves too much, tighten the vehicle belts more and recheck. You may try a different vehicle seat or installation method, or both.

9. If the Infant Carrier is next to a vehicle door or panel, raise the adjacent LSP device. See page 39.

7

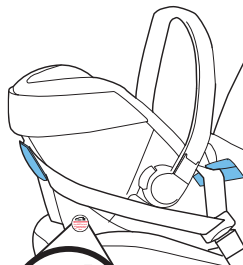

! WARNING! DEATH or SERIOUS INJURY can occur

- **ALWAYS** have the handle **LOCKED** in the upright **DRIVE/CARRY** position while using this child restraint in a vehicle.
- **NEVER INSTALL** the Infant Carrier with **BOTH** the Lap and Shoulder Belts routed underneath Belt Guides.

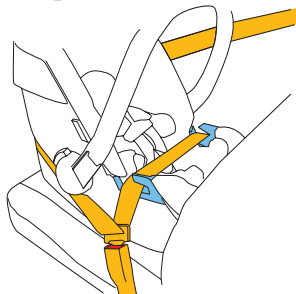
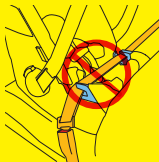

Installing the Infant Carrier without the Base using a Lap Belt Only

1. Position Infant Carrier on a rear vehicle seat, with the foot end firmly against the back of the vehicle seat.
2. Route vehicle lap belt under both Belt Guides. **BUCKLE THE BELT.**
3. Push Infant Carrier firmly into vehicle seat, pressing down near the crotch strap between the child's legs, while removing slack from the lap belt.
4. If necessary, tuck the loose end of the lap belt out of the way.
5. Check the recline angle. Adjust the seat angle until the **RED Level Line** on the Infant Carrier is level with the ground. A tightly rolled towel or pool noodle may be placed under the Infant Carrier near the vehicle seat back to adjust the angle. See page 43.

i The Aton 2 is allowed to touch the vehicle seat(s) in front of it, as long as the recline angle of the Aton 2 is not affected.

6. Grab the Infant Carrier at the Belt Guides and pull from side to side and front to back to make sure it is installed correctly. The Infant Carrier should not move more than 2.5 cm (1 inch) in any direction.
7. If the Infant Carrier is next to a vehicle door or panel, raise the adjacent LSP device. See page 39.

i If the Infant Carrier moves too much, tighten the vehicle belts more and recheck. You may try a different vehicle seat or installation method, or both.

! **WARNING!** To avoid DEATH or SERIOUS INJURY, ALWAYS have the handle **LOCKED** in the upright **DRIVE/CARRY** position while using this child restraint in a vehicle.

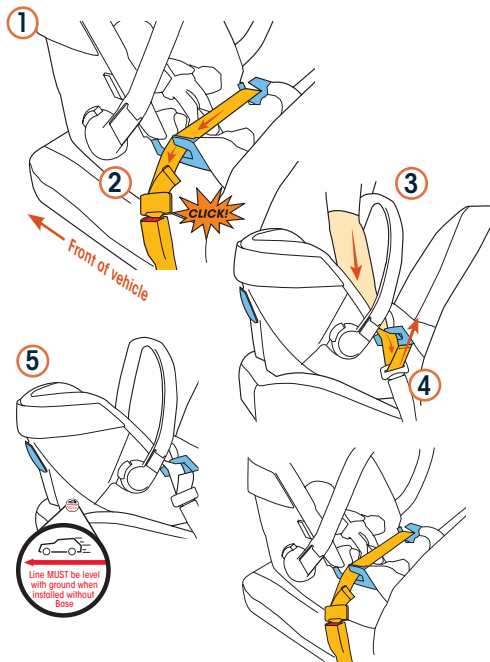

Adjusting the Recline Angle without the Base

It's very important for your child's safety that this child restraint be installed at the correct angle.

⚠ WARNING! DEATH or SERIOUS INJURY can occur

- **DO NOT** use this or any other child restraint with a premature, low birth weight, or medically fragile infant, until after you have consulted with your doctor. Some infants may have difficulty breathing or have other medical problems when placed in a seated position.
- If the child restraint is **TOO UPRIGHT**, the child's head may fall forward and cause breathing problems. If the child restraint is **TOO RECLINED** crash protection will be reduced..

Adjust Recline

Adjust the seat angle until the **RED** Level Line on the Infant Carrier is level with the ground.

If you are having trouble achieving the proper recline angle:

1. Uninstall Infant Carrier.
2. Place a tightly rolled towel or pool noodle under the Infant Carrier, where indicated. If on an aircraft, a tightly rolled airline blanket may be placed under the Infant Carrier to adjust the angle.
3. Continue installation.

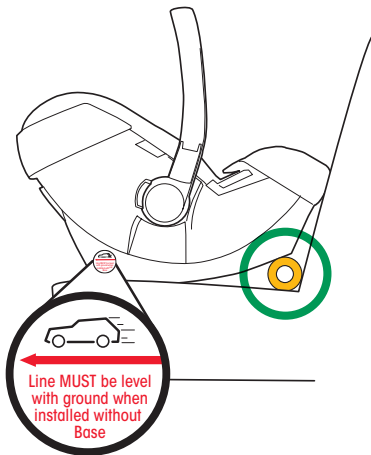

Using the Infant Carrier on Aircraft

The Federal Aviation Administration (FAA) recommends that children up to 18 kg (40 pounds) use a certified, harnessed child seat while travelling on an aircraft. The Aton 2 is certified for airplane use.



Installing the Carrier on Aircraft

Install your Infant Carrier in a window seat to avoid blocking the aisle.

1. Position Infant Carrier rear facing in aircraft seat with the foot end firmly against the back of the vehicle seat.
2. Route lap belt under both Belt Guides. **BUCKLE THE BELT.**
3. Push Infant Carrier firmly into aircraft seat while removing slack from the lap belt.
4. Check the recline angle. Adjust the seat angle until the **RED** Level Line on the Infant Carrier is level with the floor of the aircraft. A tightly rolled airline blanket may be placed under the Infant Carrier to adjust the angle. See page 43.
5. Grab the Infant Carrier at the Belt Guides and pull from side to side and front to back to make sure it is installed correctly. The Infant Carrier should not move more than 2,5 cm (1 inch) in any direction.



If the Infant Carrier moves too much, tighten the aircraft belts more and recheck.

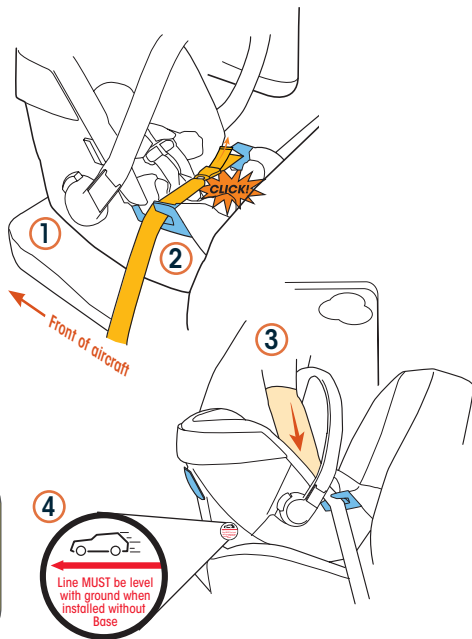

! WARNING! DEATH or SERIOUS INJURY can occur

- DO NOT USE the Base on aircraft.
- ALWAYS have the handle **LOCKED** in the upright **DRIVE/CARRY** position while using this child restraint on aircraft.
- NEVER USE the LSP device on aircraft.

Care and Cleaning

Removing the Seat Cover

The seat cover is designed to be very taut and to fit exactly inside the Infant Carrier. Please pay close attention before and during the removal of the cover, to help remember how to put it back on.

1. Remove Harness Straps from Harness Slots as described on page 18.
2. Remove Shoulder and Buckle Pads.
3. Carefully remove the cover from the perimeter of the shell around the Belt Guides, paying special attention not to damage the EPS foam.
4. Remove the cover from around the plastic Adjustment Strap Cover and slide it up around the Harness Buckle.



DO NOT damage, remove or dispose of any EPS foam.



NEVER use Infant Carrier without a properly installed Seat Cover.

Installing the Seat Cover

Reverse the removal instructions to reinstall the Seat Cover. Start at the top of the seat and work your way down to the Belt Guides and foot area.

Pay close attention to reinserting the edge of the Seat Cover into the tight spaces around the Belt Guides, as well as the foot end of the seat.

Care and Cleaning

Spot Cleaning

Spot clean Seat Covers, Shoulder Pads, Buckle Pad, and the Infant Insert as needed with a clean cloth using mild detergent and water.

Washing Instructions

Seat Cover, Shoulder Pads, Buckle Pad, and the Infant Insert may be washed as follows:



Machine wash cold, gentle cycle, mild detergent



Do not bleach



Do not tumble dry



Line dry



Do not iron

Harness Straps

Sponge clean using warm water and mild soap. Air dry. Do not iron.

- **NEVER** remove Harness or Harness components from Infant Carrier.
- **NEVER** use bleach, household cleaners or solvents.

Harness Buckle

Sponge clean or thoroughly rinse Harness Buckle with warm water. Test by fastening and unfastening until an audible **CLICK** is heard after inserting each buckle Tongue into the Buckle. If **CLICKS** are not heard, repeat the cleaning procedure.

- **NEVER** use bleach, household cleaners or solvents.
- **DO NOT** lubricate.

LATCH Connectors

Sponge clean or thoroughly rinse LATCH Connectors with warm water. Test by connecting and disconnecting until an audible **CLICK** is heard after connecting each connector to a lower LATCH anchor. If clicks are not heard, repeat the cleaning procedure.

- **NEVER** use bleach, household cleaners or solvents.
- **DO NOT** lubricate.

Plastic Parts

Wipe clean with mild detergent and warm water.

Safety Checklist

- Did you read and understand this Owner's Manual and all labels found on this child restraint?
- Is the child restraint rear facing in an approved vehicle seat location?
- If using the Base, is it securely installed with the Load Leg locked firmly against the vehicle floor whenever possible?
- Is the seat recline angle correct according to the Level Indicator or **RED** Level Line?
- Are the Harness slots that you are using at or below top of child's shoulders?
- Is the Harness secured properly with the Chest Clip positioned at the armpits?
- Is the Harness snug and not twisted?
- Is the Infant Carrier securely attached to the Base? Is the **GREEN** Safety Button visible?
- If the child restraint is next to a vehicle door or panel, is the adjacent LSP device raised?
- Does your child weigh between 1.8–15.9 kg (4 and 35 lb)?
- Is your child's height between 43–76 cm (17–30 in)?
- Is the top of your child's head more than 2.5 cm (1 inch) from the top of the Infant Carrier?
- Is today's date before the "Do Not Use After" date on the child restraint?
- Did you check for hot surfaces in sunny weather?

Safe Car Practices

- **NEVER** drive under the influence of alcohol or drugs.
- **NEVER** drive distracted (e.g. using cell phones, texting, tending to children).
- Everyone rides buckled up or the vehicle does not go! **MAKE NO EXCEPTIONS** for adults or children!
- If someone unbuckles, the vehicle **STOPS!** Being firm and consistent will result in fewer disciplinary problems as children grow older.
- **NEVER** leave loose objects (e.g. groceries, books, bags) in a vehicle. In the event of a sudden stop, loose objects will keep moving, potentially causing serious injuries.
- **NEVER** leave a child alone in a vehicle, even for one minute.
- **ALWAYS** keep car doors **LOCKED** when vehicle is parked and unattended to prevent children from climbing inside.

General Information About Sensorsafe

Secure your child into the child restraint as you would normally.

The SensorSafe Receiver Plug monitors both the Chest Clip Transmitter and the vehicle. When you arrive at your destination and turn your vehicle off, the SensorSafe system sounds a series of gentle tones reminding you that your baby is in the vehicle.

Install it once and SensorSafe is always ready to alert you.



WARNING! To avoid **DEATH** or **SERIOUS INJURY**, this product contains magnets. Before use, consult your family doctor about the compatibility of this product with pacemakers and similar devices..

Important Usage Information

- The SensorSafe system consists of two components:
 - 1) The Chest Clip Transmitter and
 - 2) The Receiver Plug. The system will not work unless both of these components are present in the vehicle with the Receiver installed in the vehicle's OBDII port. See page 52.
- This system works with the SensorSafe Application which can be downloaded from:
The App Store® or Google Play™.**
- The SensorSafe Chest Clip is designed to go into a sleep mode after being clipped for 12 hours. Although 12-hour vehicle trips without stops are uncommon and not recommended, the Chest Clip must be opened and closed after 12 hours to reactivate the SensorSafe system.

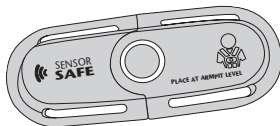

Chest Clip Transmitter



Receiver Plug

** Trademarks are the property of their respective owners.

General Information About Sensorsafe

- The Receiver Plug has ONLY been tested with 2008 or newer vehicles purchased in the U.S. or Canada. If you would like to use the SensorSafe Chest Clip with a Hybrid or Electric vehicle, you will need to download the application from the App Store® or Google Play™. ** Additional Receiver Plugs can be purchased for additional vehicles. If you have questions, please download the SensorSafe Application or contact CYBEX at: 1-877-242-5676 or online at: www.cybex-online.com

Battery Usage

- To preserve battery life, always store the SensorSafe Chest Clip in the unclipped position.
- The Chest Clip ships with 1-button cell lithium battery installed that can be replaced.
- The SensorSafe is designed to alert you of a low battery. If your Chest Clip battery is getting low, the SensorSafe Receiver will make a "low battery" alarm and LED will flash 10 times when the Chest Clip is fastened. This "low battery" alarm will sound different from the beeps you typically hear when activating your SensorSafe system. The SensorSafe Chest Clip uses a Panasonic™ CR2032 Lithium button cell Battery. Should you have problems with SensorSafe hardware, please contact CYBEX at: 1-877-242-5676 or online at: www.cybex-online.com to order a replacement battery/parts.

** Trademarks are the property of their respective owners.

General Information About Sensorsafe (Cont.)

SensorSafe™ Technology

Questions? Comments?:

Visit us at: www.cybex-online.com

or call CYBEX at: 1-877-242-5676

This device meets the requirements of SAE J3005.

FCC Certified:

Chest Clip Model: SOSR2, FCC ID: 2ABS2-SOSR3

Receiver Plug Model: SS2, FCC ID: 2ABS2-SS2

This device complies with Part 15 of the FCC Rules. Operation is subject to the following two conditions:

- (1) This device may not cause harmful interference.
- (2) This device must accept any interference received, including interference that may cause undesired operation.

! WARNING! DEATH or SERIOUS INJURY can occur

Changes or modifications not expressly approved by the party responsible for compliance could void the user's authority to operate the equipment.

NOTE: This equipment has been tested and found to comply with the limits for a Class B digital device, pursuant to Part 15 of the FCC Rules. These limits are designed to provide reasonable protection against harmful interference in a residential installation.

General Information About Sensorsafe (Cont.)

This equipment generates, uses, and can radiate radio frequency energy and, if not installed and used in accordance with the instructions, may cause harmful interference to radio communications. However, there is no guarantee that interference will not occur in a particular installation. If this equipment does cause harmful interference to radio or television reception, which can be determined by turning the equipment off and on, the user is encouraged to try to correct the interference by one or more of the following measures:

- Reorient or relocate the receiving antenna.
- Increase the separation between the equipment and receiver.
- Connect the equipment into an outlet on a circuit different from that to which the receiver is connected.
- Consult the dealer or an experienced radio/TV technician for help.

Chest Clip:

RF warning statement:

The device has been evaluated to meet general RF exposure requirement. The device can be used in portable exposure condition without restriction.

Receiver Plug:

FCC Radiation Exposure Statement:

This equipment complies with FCC radiation exposure limits set forth for an uncontrolled environment. This equipment should be installed and operated with minimum distance 20 cm between the radiator & your body..

Using SensorSafe

1. INSTALL THE SENSORSAFE RECEIVER.

Locate the 16PIN OBDII port **a** in your vehicle. Refer to your vehicle owner's manual for location. Plug in the SensorSafe Receiver.

If unable to locate your vehicle manual, the SensorSafe Application may contain information regarding the location of the 16PIN OBDII port for your vehicle.

Your SensorSafe Receiver will sound when it first communicates with the vehicle network. In some vehicles this occurs immediately after installing the SensorSafe Receiver. In other vehicles the tone will not be heard until the vehicle has been started.

This initialization signal only occurs one time after installation.

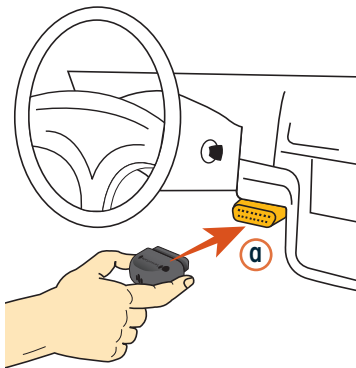

2. POWER UP THE VEHICLE.

Using SensorSafe

3. CYCLE THE SENSORSAFE CHEST CLIP.

Your SensorSafe Chest Clip is designed to “go to sleep” if left fastened for more than 12 hours. To reset, or “wake up” the Chest Clip, unfasten then re-fasten it. When you do this, the blue LED will flash two times. TO PRESERVE BATTERY LIFE, ALWAYS STORE THE SENSORSAFE CHEST CLIP IN THE UNCLIPPED POSITION.

4. DRIVE THE VEHICLE.

The SensorSafe Receiver is designed to respond after the vehicle has been driven at 5 miles per hour or more.

5. PARK THE VEHICLE AND TURN OFF THE IGNITION.

Within 2 seconds of parking your vehicle and turning off the ignition you will hear the SensorSafe reminder, alerting you that your baby is in the vehicle. If you don't hear the reminder tone, test your SensorSafe by following steps 1-5 again. Contact CYBEX at: 1-877-242-5676 or online at:

www.cybex-online.com if the reminder tone again fails to sound.



SensorSafe Receiver will also alarm if your child unclips the Chest Clip after the vehicle has been driven at 5 miles per hour or more, but only if the vehicle is on.

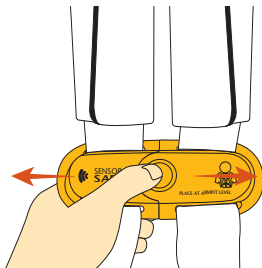

Using SensorSafe (Cont.)

Replacing the SensorSafe Chest Clip Battery.

1. Loosen Harness by pressing Harness Release Button on the front of the Child Restraint and pulling forward on both Harness Straps.
2. Unbuckle Harness by pressing the button on the Crotch Buckle and pulling out both Buckle Tongues.
3. Open Chest Clip by pressing the Release Button and pulling the Chest Clip apart.

1

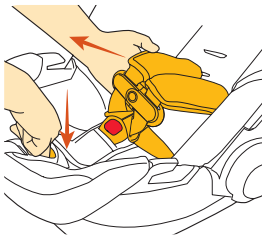

2

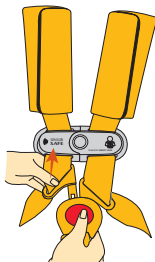

3

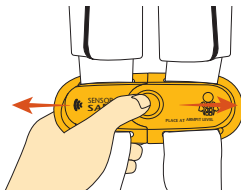

Using SensorSafe (Cont.)

4. Turn the male side of the Chest Clip over and loosen screws with a small Phillips screwdriver. Remove the cover **a**.
 5. Remove Circuit Board **b** from Chest Clip. Remove Battery **c** from Circuit Board. Replace Battery with new Panasonic™ ** CR2032 Lithium button cell Battery, as shown.
 6. Place the Circuit Board with the new Battery in the Chest Clip. Replace the Cover and tighten the screws.
- This completes the battery replacement process.
7. If you have questions, please contact CYBEX at: 1-877-242-56761 or online at: www.cybex-online.com

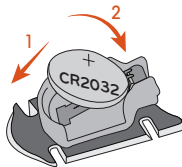
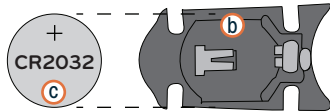
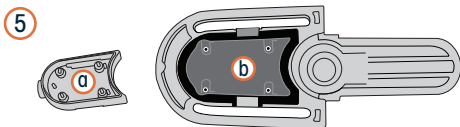
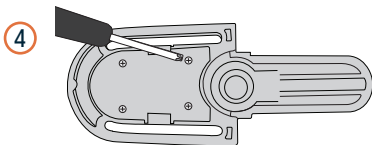

** Trademarks are the property of their respective owners.

Resources

If You Need Help...

Please contact our Customer Care Department, where we have many Child Passenger Safety (CPS) Technicians on staff, with any questions you may have concerning installation, parts, maintenance, or warranty information. If you have specific questions, e-mail us a picture. It will help us serve you better.

When you contact us, please have the Model Number and Manufactured on Date ready so that we may help you efficiently. This information can be found on the underside of your Infant Carrier and Base.

Please contact Cybex:

- TEL: 1-877-242-5676
- E-mail: support.americas@goodbabyint.com
- Web: www.cybex-online.com

Help with Installation

Installing your car seat correctly in your vehicle is extremely important for your child's safety. However, it is not always easy to do. **Statistics show that over 72% of car seats are being used incorrectly!**

Make sure your car seat is installed correctly by using one of the following:

- www.nhtsa.gov/cps/cpsfitting/index.cfm
- www.safekids.org
- www.seatcheck.org
- To find an available CPS Technician in your area, go to bit.ly/FindATech

Recycling

Once your seat has reached its expiration date, we recommend recycling the seat. Contact your local community recycling center for the best way to dispose of your seat. We do not recommend giving or selling the seat to anyone, or simply putting it in the garbage.

If the Car Seat Has Been in a Crash



WARNING! To avoid DEATH or SERIOUS INJURY, DO NOT USE this child restraint if it has been in a crash. There may be hidden damage and it must be replaced. Your insurance company may provide some assistance in replacing the child restraint.

Warranty

IMPORTANT: Immediately register your Aton 2 so we can contact you in the unlikely event of a safety recall.

Register online at <http://register.cybox-online.com/us/carseats> or mail in the separate registration card provided.

LIMITED WARRANTY

CYBEX warrants to the original consumer purchaser that this product will be free from defects in material and workmanship for two (2) years from the date of original purchase (the "Warranty Period"). During the Warranty Period, CYBEX, at its option, may repair or replace this product if it is found by the manufacturer to be defective in material or workmanship. CYBEX reserves the right to discontinue or change parts, fabrics, models, or products, or to substitute this product with a comparable model or product. To make a claim under this warranty, please contact us at info.us@cybox-online.com, call us at 1-877-242-5676 or write to us at:

Columbus Trading-Partners USA Inc.
Attn: ParentLink
1801 Commerce Drive
Piqua, Ohio 45356, USA

An original receipt is required to validate your warranty and shipping charges will be the responsibility of the original consumer purchaser. To expedite the processing of any future warranty claims and to verify the original date of purchase, please complete and mail the pre-addressed owner registration card within thirty (30) days of purchase.

WARRANTY LIMITATIONS

This warranty does not cover the effects of normal wear and tear or damages resulting from negligence, modification, improper installation, accidents, misuse or abuse of this product. It is expressly agreed that the obligations of CYBEX and the original consumer purchaser's remedies under the limited warranty contained herein are exclusive and are strictly limited to the repair or replacement of the product. This limited warranty is conditional upon strict compliance with the provisions of the Owner's Manual. In no event will CYBEX or the dealer selling this product be liable to you for any damages, including incidental or consequential damages, arising out of the use or inability to use this product.

LIMITATION OF WARRANTIES AND STATE/PROVINCIAL LAW RIGHTS:

The warranty and remedies as set forth above are exclusive and in lieu of all others, oral or written, express or implied. To the extent permitted by applicable law, any implied warranties, including implied warranties of merchantability and fitness for a particular purpose, are hereby disclaimed. Some states/provinces do not allow limitations as to how long an implied warranty lasts or the exclusion or limitation of incidental or consequential damages, so the above limitations may not apply to you. This warranty gives you specific legal rights, and you may have other rights, which vary from state/province to state/province. Neither CYBEX nor the dealer selling this product has authorized any person to create for it any other warranty, obligation, or liability in connection with this product.