

# Mini Slide Switches

Part Nos. 17TS13B, 17TS13C, 17TS14B, 17TS14C, 17TS11C

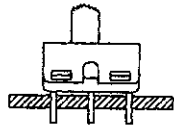
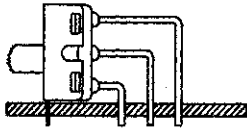

## SPECIFICATIONS

CONTACT RATING: 5A @120 VAC or 28 VDC  
3A @250 VAC

ELECTRICAL LIFE: 30,000 make-and-break cycles at full load  
CONTACT RESISTANCE: 10 mΩ max. initial @2-4 VDC, 100 mA  
INSULATION RESISTANCE: 1,000 MΩ min.  
DIELECTRIC STRENGTH: 1,500 V RMS @ sea level.  
OPERATING TEMPERATURE: -30°C to 85°C

## MATERIALS

CASE - diallyl phthalate ( DAP )  
SLIDE HANDLE - Nylon  
HOUSING - Stainless Steel  
CONTACT AND TERMINAL - Copper alloy, silver plated

**How do you build the switches you need!!**

The straight type , please see the (A) ;

The right angle P.C terminals, please see the (B)

(A) TS - 13 - A1 - 2 - C Q - E - S20

Switches Function		Actuator		Actuator color		Termination		Contact Material		Vertical support Bracket	
TS-13	SPDT on-none-on	A1	5.08	1	white	B	solder lug	Q	silver plated	(none)	
TS-14	SPDT on-off-on	A2	7.35	2	black (std.)	C	P.C	R	gold plated	S20	11.68
TS-11	DPDT on-none-on	A3	9.40	9	gray	D	Quick connect	G	gold over silver		
TS-12	DPDT on-off-on	A4	3.60			D1	wire wrap 19.05	<b>Epoxy seal</b> (none) none seal E epoxy seal			
		A5	5.08			D3	wire wrap 10.8				
		A6	12.32								
		A7	4.20								

(B) TS - 13P - A1 - 2 - Q - E

Horizon Right Angle	Vertical Right Angle	Switches Function	Actuator		Actuator color		Contact Material		Epoxy seal	
TS-13P	TS-13L	SPDT on-none-on	A1	4.72	1	white	Q	silver plated	(none)	none seal
TS-14P	TS-14L	SPDT on-off-on	A2	6.96	2	black	R	gold plated	E	epoxy seal
TS-11P	TS-11L	DPDT on-none-on	A3	8.96	9	gray	G	gold over silver		
TS-12P	TS-12L	DPDT on-off-on	A4	3.10						
			A6	11.92						

# T80-S Slide Switches

SPDT

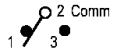

Model No.	Switching position		
TS-13	ON	NONE	ON
TS-14	ON	OFF	ON
Term. Comm.	2-3	open	2-1

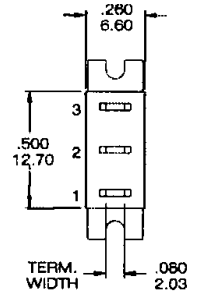
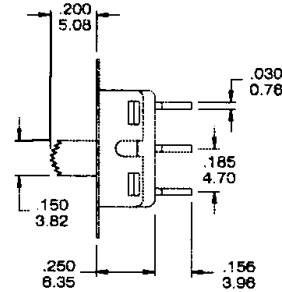
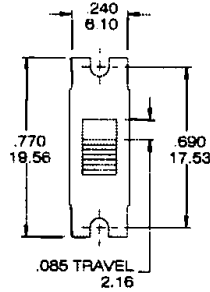

TS-13-A1-2-BQ

DPDT



Model No.	Switching position		
TS-11	ON	NONE	ON
TS-12	ON	OFF	ON
Term. Comm.	2-3	open	2-1

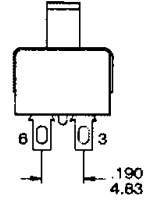
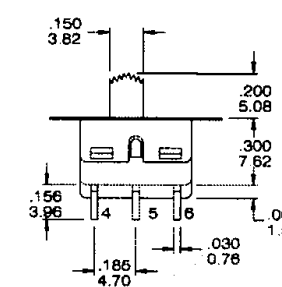
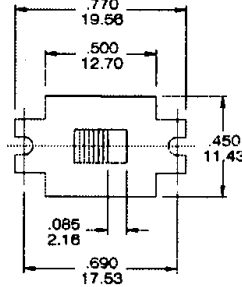

TS-11-A1-2-BQ

## HORISON RIGHT ANGLE

DPDT

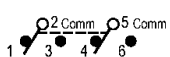

Model No.	Switching position		
TS-13P	ON	NONE	ON
TS-14P	ON	OFF	ON
Term. Comm.	2-3	open	2-1

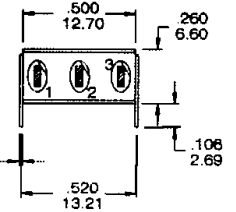
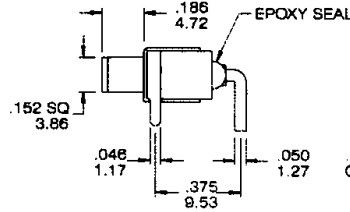
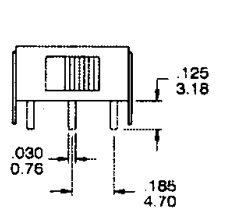

TS-13P-A1-2-Q(-E)

DPDT

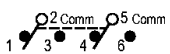

Model No.	Switching position		
TS-11P	ON	NONE	ON
TS-12P	ON	OFF	ON
Term. Comm.	2-3	open	2-1

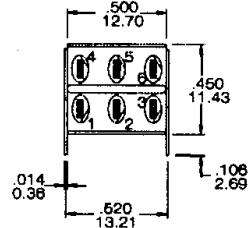
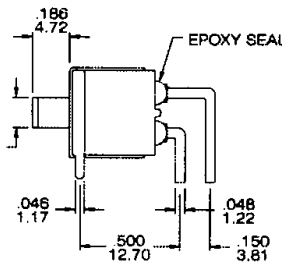
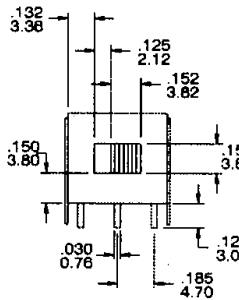

TS-11P-A1-2-Q(-E)

# T80-S Slide Switches

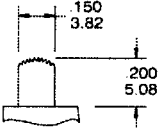
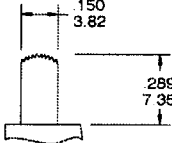
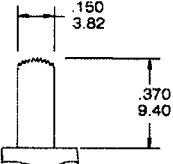
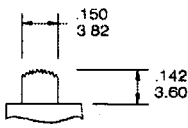
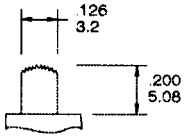
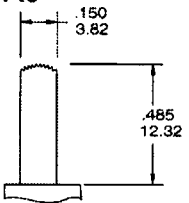
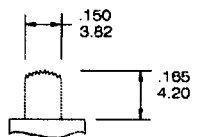
Actuator Option				Actuator Color								
<b>A1</b> 	<b>A2</b> 	<b>A3</b> 	<b>A4</b> 	<table border="1"> <thead> <tr> <th>COLOR NO.</th> <th>COLOR</th> </tr> </thead> <tbody> <tr> <td>1</td> <td>white</td> </tr> <tr> <td>2</td> <td>black</td> </tr> <tr> <td>9</td> <td>gray</td> </tr> </tbody> </table>	COLOR NO.	COLOR	1	white	2	black	9	gray
COLOR NO.	COLOR											
1	white											
2	black											
9	gray											
<b>A5</b> 	<b>A6</b> 	<b>A7</b> 	<ul style="list-style-type: none"> <li>the height of actuator is for the straight type. It will be shorter while applying in Right Angle type.</li> </ul>									

## TERMINAL OPTION

B SOLDER LUG    C PRINTED CIRCUIT

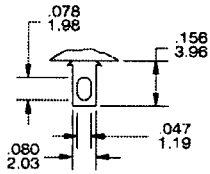

THK 0.76 (.030)

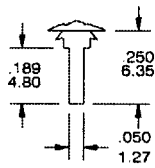

THK 0.76 (.030)

## PANEL MOUNTING DIMENSION

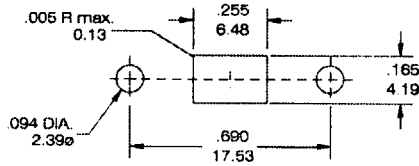

## THE P.C.B MOUNTING

TS-13/TS-14

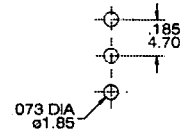

TS-11/TS-12

