

嘉尼企業股份有限公司 CANAL ELECTRONIC CO., LTD.

MOUNTING HOLE

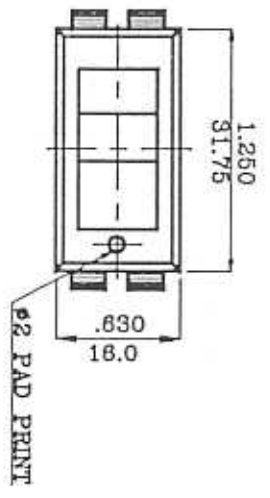
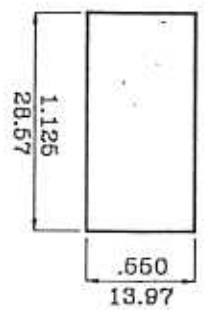

SPECIFICATION MODEL : "B" SERIES

RATING: 10A 250VAC
15A 125VAC

CONTACT RESISTANCE : 20mΩ MAX

INSULATION RESISTANCE : 500VDC - 100MΩ MIN.

WITHSTAND VOLTAGE : 1,000VAC 1 MINUTE.

OPERATION : 500±200 GRAM.

APPROVAL:

CSA LISTED FILE NO. LR566839-1
UL RECOGNIZED FILE NO. E81103

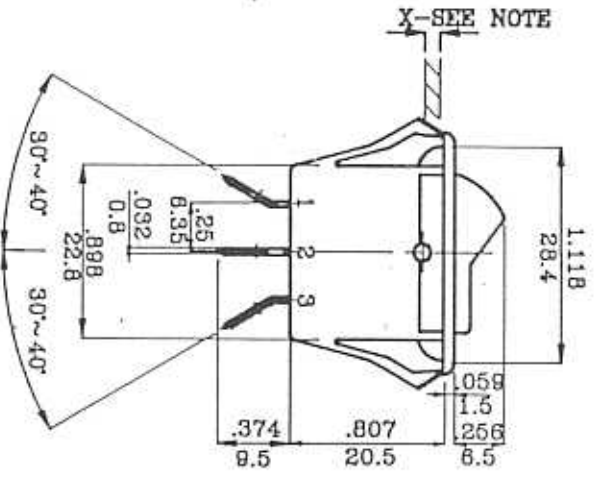
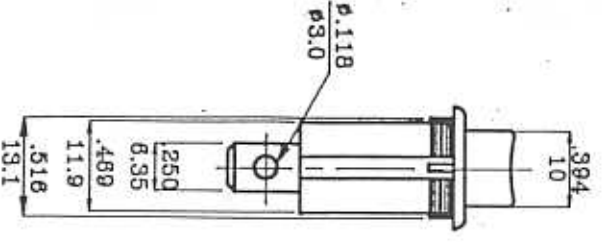

SWITCH CIRCUIT APPLICATION

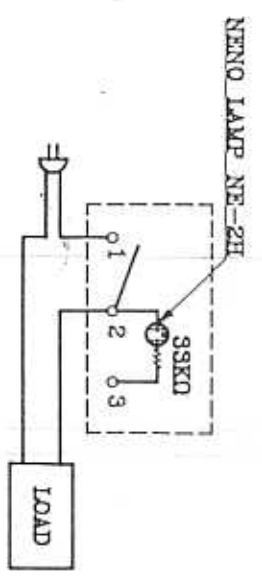

NOTE: FOR 220VAC SOURCE, RESISTOR SHOULD BE 100KΩ

NOTE: 1. TOLERANCES UNLESS OTHERWISE SPECIFIED ± .012
2. X MEANS FOR APPLICATION PANEL THICKNESS MUST BE UNDER 2.1mm

修正 REVISION	說明 DESCRIPTION	核准 APPROVAL BY	公差 TOLERANCES	圖號 DRAWING NO	比例 SCALE	日期 DATE	品名 TITLE	圖號 DRAWING NO	材料 MATERIAL	處理 FINISH
△				繪圖 DRAWN BY	1/1	1994	B160-R2L			
△				設計 DESIGNED BY						
△				核准 CHECKED BY						
△				校對 CHECKED BY						
△				校對 CHECKED BY						
△				校對 CHECKED BY						