

## GENERAL SPECS

STORAGE TEMPERATURE :  $-40^{\circ}\text{C}\sim+85^{\circ}\text{C}$

OPERATURE TEMPERATURE :  $-40^{\circ}\text{C}\sim+85^{\circ}\text{C}$

RESISTANCE TO SOLDER HEAT :  $260^{\circ}\text{C}$  10 SEC.

HAND SOLDERING TEMPERATURE :  $350^{\circ}\text{C}\sim400^{\circ}\text{C}$  3~5 SEC.

## SHAPE & DIMENSION

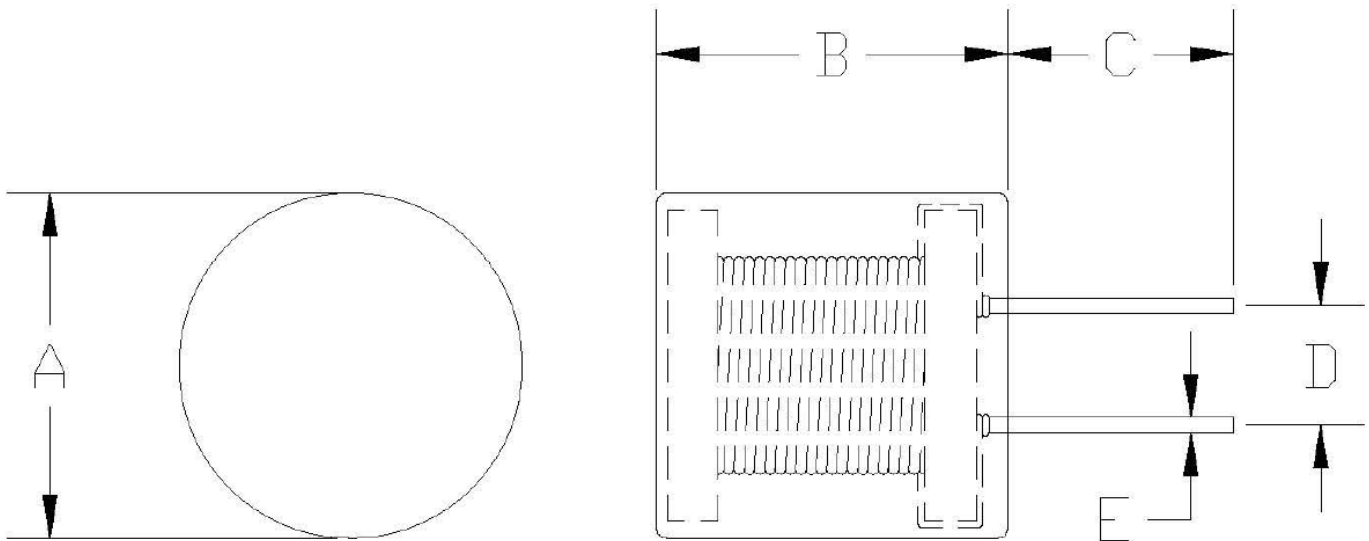

UNIT:(mm)

SYMBOL	A	B	C	D	E		
DIMENSIONS	10.5MAX	14.0MAX	25.0MIN	$5\pm 0.5$	$0.65\pm 0.1$		

## ELCETRICAL SCHEMATICS

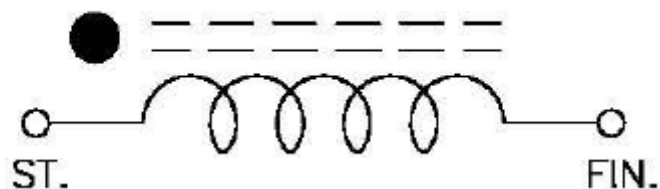

No.	Elexp Part#	Inductance L ± 10%	Test Freq. (KHz)	Q MIN	DCR (Ω) MAX.	WIRE (Φ)	TURNS (TS)REF
1		1mH	252	60	2.5	0.16	163
2		1.2mH	252	75	3.0	0.16	178
3		1.5mH	252	75	5.0	0.14	197
4		1.8mH	252	75	5.5	0.14	220
5		2.2mH	252	75	7.0	0.14	238
6		2.5mH	252	75	7.5	0.14	256
7	1502.7M	2.7mH	252	75	8.0	0.14	260
8	1503.3M	3.3mH	252	75	9.0	0.14	290
9		3.9mH	252	75	10.0	0.12	305
10	1504.7M	4.7mH	252	60	11.5	0.12	330
11		5.6mH	252	45	15.0	0.10	370
12	1506.8M	6.8mH	252	45	16.8	0.10	395
13		8.2mH	252	80	19.5	0.10	440
14		10mH	79.6	80	34.0	0.08	515
15		12mH	79.6	80	39.0	0.08	565
16		15mH	79.6	80	45.0	0.08	635
17	15022M	22mH	79.6	80	57.0	0.08	764
18	15027M	27mH	79.6	80	70.0	0.07	820
19	15033M	33mH	79.6	80	75.0	0.07	900