



Scented Vents



The Fragrance of Comfort

Congratulations on your purchase

Before you begin using your machine please read these important installation and safety instructions:

How to install your Scented Vents Machine:

- Remove the Scented Vents machine from the box and take the mounting bracket from the back of the machine.
- Level the mounting bracket and screw it to the side of the furnace, the wall, or the metal plenum (wherever you want the machine to sit). Always mount the machine in an upright and level position.
- Line up the screws on the back of the machine with the slots in the mounting bracket and fasten the machine to the bracket.
- Open the front panel on the machine and install the oil canister. Close and lock the front panel with the keys that are provided.
- If using in a room and not connected to your HVAC system, plug in supplied power cord and turn machine on. Your machine should now be working
- If you are using with your HVAC system for scent distribution throughout your vents, remove the silver diffuser fitting from the top of the machine and replace it with the threaded Tubex fitting that is provided. Tighten the Tubex fitting snugly into the top of the machine.
- Drill a 1" hole into your supply air ductwork 6-12" away from where the horizontal supply air ductwork connects to the vertical furnace plenum in the center of the horizontal duct. If you have supply air duct work that goes in two directions drill 1" holes in both horizontal supply air ducts.
- Connect the clear ½" tubing to the top of the Tubex fitting by pressing the black ring on top of the Tubex fitting down and inserting the 1/2" tubing into the top of the Tubex fitting and releasing the black ring.
- Run the ½" tubing from the top of the machine into the 1" hole(s) in the ductwork after placing the provided 1" plastic grommet into the 1" hole in the ductwork. The grommet protects the tubing from cuts and tightly seals the penetration. If you have two holes in the duct work, use the provided Y fitting and run two ½" tubes into the holes in the ductwork.
- Make sure to maintain slope running from the ductwork back to the machine. The tubing should not be level or have any sags in it.
- Install the power cord into the side of the machine and plug it into a 110v. outlet.
- Turn the power switch on the side of the machine to the on position.
- Download the app and program your machine with the settings you prefer.

Important Safety Precautions:

- Make sure all power is disconnected before installing or working on the machine. Also turn the power off prior to changing oils or cleaning your machine.
- Oil fragrances are for external use only and should not be ingested. Keep bottles of fragrance out of reach of children and pets.
- To prevent fire or injury, do not use if the power cord is damaged, kinked, or cut. **(Never insert tubing into the furnace ignition area)**
- Do not dismantle or try to repair the machine while it is plugged into the electrical outlet or in operation.
- For best results, ensure the tube running from the Scented Vents machine into your HVAC system remains clean and free from blockage.
- Never install a machine in a space where temperatures get higher than 100° Fahrenheit or lower than 32° Fahrenheit.

ScentedVents HVAC connection

Visit Scentedvents.com for installation videos

You can add multiple HVAC Adapters and scent multiple rooms.

Warning: Do not drill holes into coils or filters

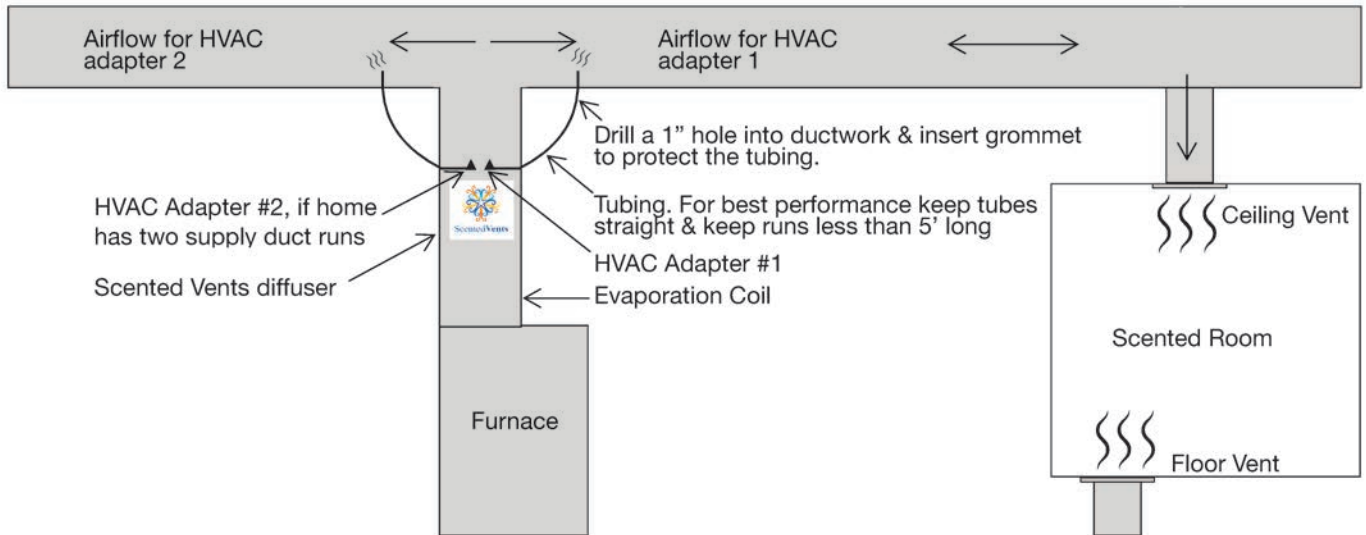

Scented Vents Machine





ScentedVents

Product Manual

1. This product is shipped with the aroma diffuser, the power plug, and the installation accessories (screws, mounting bracket, pipe connection fitting, etc.)
2. Your ScentedVents diffuser has a programming function to set a variety of schedules by days of the week, hours in the day and different aroma intensity levels.
3. You can program your machine by either using the buttons on the LCD display screen of the machine or by using the mobile app.

Operation Steps:

1. Connecting the power cord:

Plug the small end of the power cord into the side of the machine. Then plug the cord into a 110V outlet. Turn on the power to the machine by flipping the black switch on the side of the machine to the on position. The ON/OFF LCD display tells you whether the machine is on or off.

2. Setting the Scent Intensity level:

The WORK/PAUSE LCD display is the screen where you can set the working time and pause time for your diffuser. Working time is the time in which the machine is pushing scent out. Pause time is when the machine is NOT pushing scent out. If you set your machine to 45 seconds working and 145 seconds paused, then the machine will push scent out for 45 seconds and then pause for 145 seconds. Lengthening the work time and shortening the pause time will increase the intensity of the scent. (Fragrance use chart is on scentedvents.com website)

3. Working Period Settings:

The machine can be programmed to hold 4 different schedules labeled as “events”. For example you can program the machine (event 1) to turn on at 8:00 A.M. and off at 10:00 A.M. by pushing the MODE button on the machine and setting the start time at 8:00 A.M. and the stop time at 10:00 A.M. After setting your fragrance intensity for this time period you can push MODE again and set different start and stop times for time period 2 (event 2). You can continue this process to set up 4 different “on and off” periods.

4. Setting the Time:

Press the SET button to get to the hour time setting. Press the up and down arrows to set the hour. Press SET again and use the up and down arrows to set the minutes. Press SET again and use the up and down arrows to select the combination of days you want the system to run. Press SET a fourth time to exit the time and date set menu.

5. Cleaning the Machine:

It is recommended that between changing of scent bottles you clean your machine. It is also recommended you clean your machine if you have not been using your machine for long periods of time. To clean your machine, turn the power off and fill the machine’s bottle with rubbing alcohol. Turn the power back on and run the machine for 10-15 minutes. Cleaning your machine will make it last longer and run more efficiently.

Please visit our website www.scentedvents.com to view videos that will help you install your machine, program your machine, set up the mobile app, and program the mobile app.

Create a mood enhancing experience for family & friends. Style your home with ScentedVents.

Mobile App Manual

1. APP download

Search “Scented Vents” in your app store



APP store



Google play



Icon

2. Account registration

Select your country. Type in your mobile number. Click “Verification code” and fill in the verification code you receive back via text. Set your password. Login.

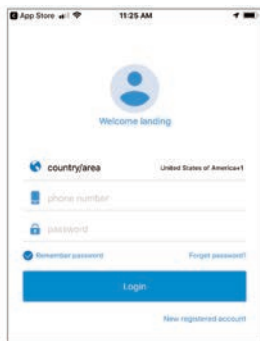

3. Main



Connect to your WIFI

Equipment List

Grouped Machines

Account Info

4. Connect to your WIFI

1. Press the “Mode” button on the scent machine and hold it for 5 seconds until you see the “C” flash on the screen. Scent machine is now ready to connect to WIFI.

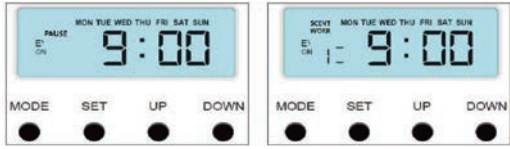

2. Connect your mobile phone to the home WIFI and Press the App’s “WIFI connect” button on your mobile phone. Input the WIFI password. Click“√” to submit. When WIFI connection is successful, the main screen on your phone will show the new machine.

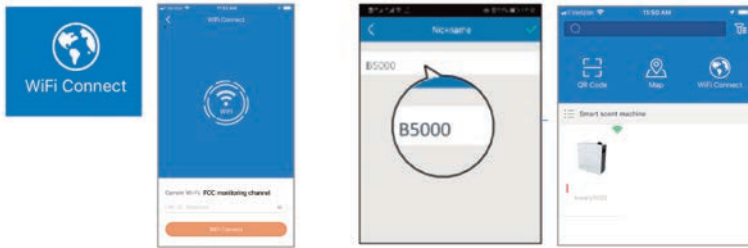

Notice: “-” flashing means you are connecting to App. “-” Always on, means you’re trying to connect with the server. When the “-” icon is no longer displayed, it means you have connected successfully. WIFI connection notice:

1. You must connect through a “2.4G” WIFI network.
2. Please make sure you have a good WIFI signal prior to installation, otherwise connection might be delayed or fail.
3. Please make sure the WIFI password you input is correct.

5. Scent machine setting Diffuser Settings:

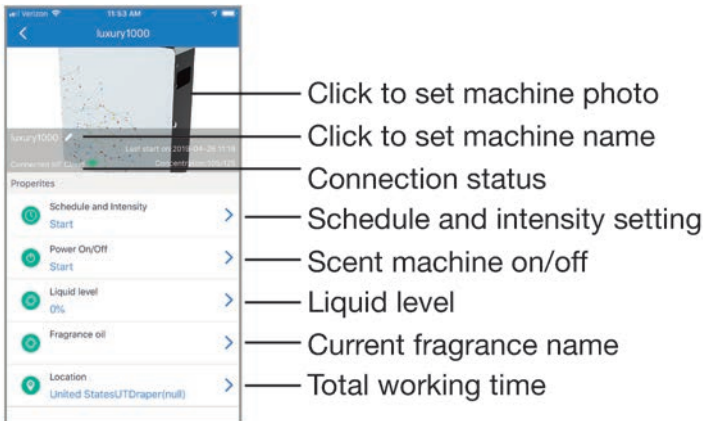

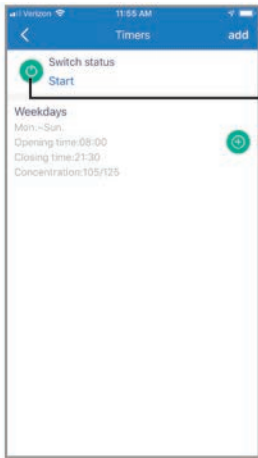

Add a new schedule
Working status
Current schedule

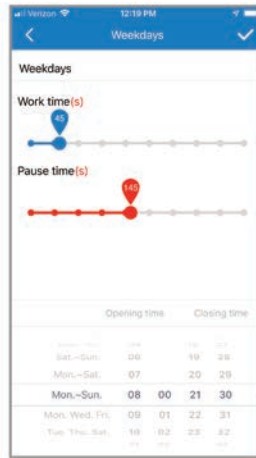

New schedule
Schedule name
Intensity run time
Intensity pause time
Days working hours setting

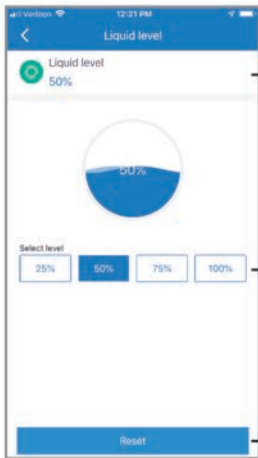

Current Oil level
Select oil level after refill
Select reset after refill



Diffuser status
Setting record
Start & stop diffuser

13. Group

To set and organize the machines by group



+: Create new group



+ Select ungroup machines



3. Group Settings

1. All start: To start all the machines

2. All off: To stop all the machines

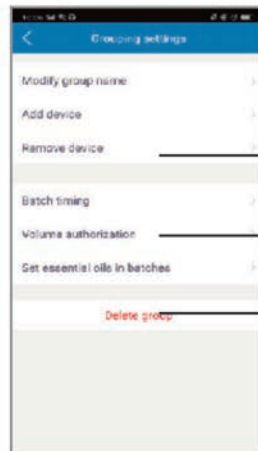

Group timer: Use to set same timer on all machines in this group.

Group Authorization: Use to authorize all machines to another user.

Group Fragrance oil name: To name all of the fragrance oils the machine is using.

FAQ

Q: Will the oils damage/dirty my HVAC vents?

A: They will not. The dry mist created by the machine doesn't leave oil residue behind.

Q: How do I adjust the strength of the fragrance blowing through my vents?

A: You adjust the intensity of your fragrance by increasing or decreasing the machine run time when programming your machine. We recommend starting with 45 seconds on followed by two minutes off and adjust from there.

Q: How do I re-order oils?

A: Visit our website at www.scentedvents.com.

Q: How long will the oils last?

A: 500 ml of oil will last 1-6 months depending on length of machine run time and the fragrance intensity level you program your machine to run at.

Q: Are the oils safe for my furniture, art, pets?

A: Yes, the cold fusion process used to convert the oils into vapor and the natural ingredients in our oils make them safe to use around pets, art work, carpet, and furniture.

Q: What square footage does one machine cover?

A: Our Luxury 6000 machine covers up to 6000 square feet. Our Luxury 2000 machine covers up to 2000 square feet.

Q: What type of maintenance is required on my machine?

A: Every 6 months we recommend you fill your oil bottle with rubbing alcohol and run your machine for 15 minutes. This will clean out all of the working parts and ensure your machine works properly.

Q: Does my furnace or AC need to be running all of the time?

A: No, but to enjoy maximum benefits, your thermostat should be turned to the "fan on" setting.

For other FAQ and tips visit Scentedvents.com/customer-service/

Contact us:

ScentedVents, LLC
1968 S. Coast Hwy # 240
Laguna Beach, CA 92651

1.877.315.8880
info@scentedvents.com