

HOW THE MOONRAKER WORKS

The MOONRAKER™ is a WDT tool that moves its needles along a spirographic paths, creating a fully de-clumped, randomized and homogenous bed of coffee ready for tamping. Whereas typical WDT tools follow circular paths repeatedly to create “trenches,” the MOONRAKER™ needles never pass over the same path twice.

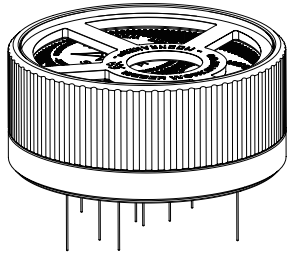

The MOONRAKER™ is designed for optimal compatibility with our own Unifilter and Unibasket products. It will work just as effectively, however, on all standard 58mm portafilter baskets.

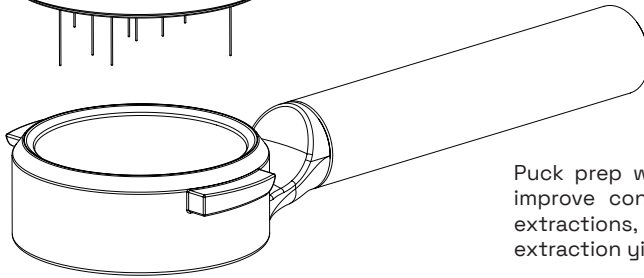

Puck prep with effective WDT is well-known to improve consistency in espresso shot-to-shot extractions, reducing channeling and maximizing extraction yields.

NEEDLES PATTERN

The MOONRAKER™ uses two gauges of stainless needles, 300 and 200 microns respectively, which are configured at 2 separate heights to break up clumps deep in the bed and rake the surface effectively for a flat top ready for tamping.

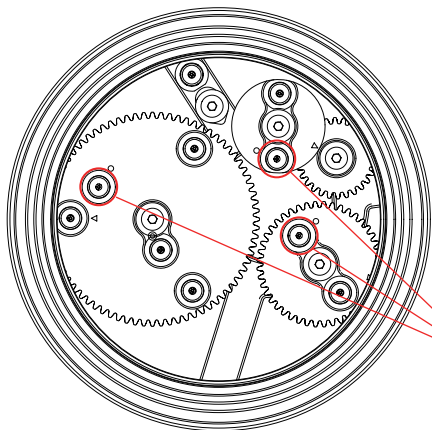

This product has ten needle positions. Use a combination of long and short needles as follows: three positions require short needles (marked with circles on gears), while the remaining positions need long needles. Install the needles accordingly for optimal results.

Short Pin (Default)

REPLACING NEEDLES

The needles are all removable and replaceable in seconds as they are held in by neodymium magnets. The MOONRAKER™ ships with 20 spare needles, as they are fragile in nature and may need to be replaced after accidents. It also ships with a spare set of longer needles that can be trimmed to a custom length for nonstandard baskets.

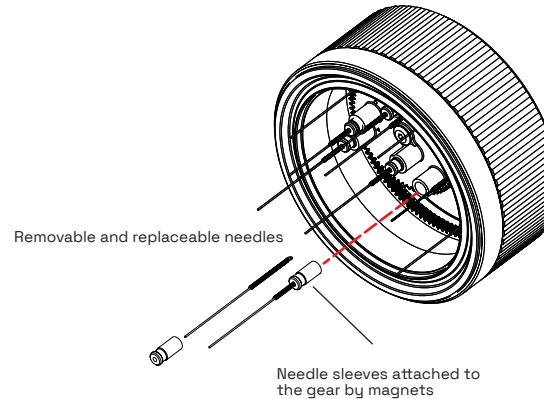

Removable and replaceable needles

Needle sleeves attached to the gear by magnets

Short Pin
Pre-assembled on MOONRAKER™

Long Pin - A
Pre-assembled on MOONRAKER™

Long Pin - B
Included as spare parts

MAINTAINING THE MOONRAKER

Clean only with a damp cloth. This product is not dishwasher safe. If coffee particles stick to the glass, use an air puffer or compressed air to clean the surfaces. If the rubber foot loses friction, you can refresh it by wiping clean with a damp cloth.

Clean the pad with coffee brush or wipe with water

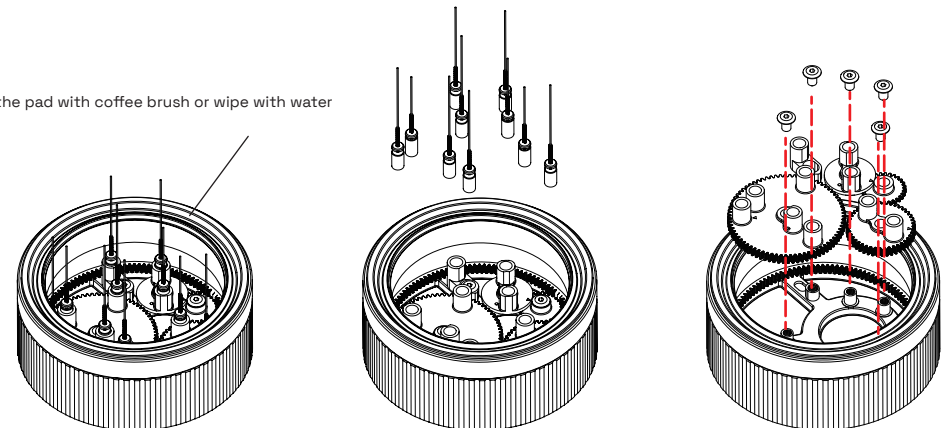

for detailed instructions, visit <https://weberworkshops.com/products/moonraker>

Size: 75mm diameter x 65mm height (2.9" x 2.55")
Weight: 500g (STANDARD), 405g (ULTRA)
Material (body): Stainless 304, Anodized Aluminum, Chem-strengthened glass.
Material (needles): Stainless 316 with Cu springs.
Material (base): Anodized Aluminum with microfiber foot.

MOONRAKER



Copyright 2023 Weber Workshops®

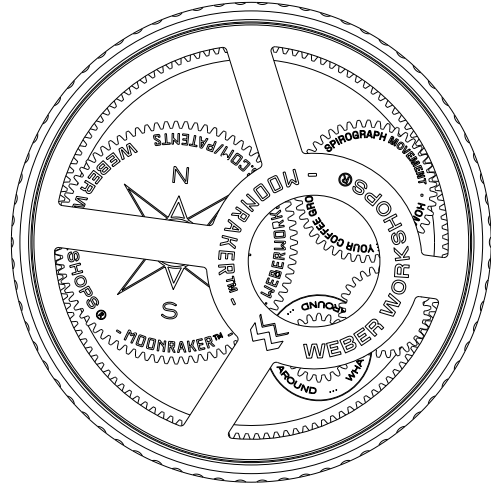

MOONRAKER™