

HOW THE SPRING CLEAN™ WORKS

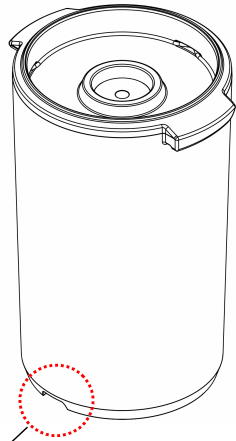

THE SPRING CLEAN™ WAS INVENTED AND DESIGNED TO IMPROVE THE BACKFLUSH PROCESS BY GENERATING SIGNIFICANTLY MORE WATER FLOW BACK THROUGH THE BREW LINES AND THE 3-WAY SOLENOID VALVE OF 58MM PORTAFILTER COMMERCIAL ESPRESSO MACHINES. BY USING MORE WATER, THE RESULT IS A CLEANER AND BETTER FUNCTIONING MACHINE. CAN ALSO BE USED BETWEEN SHOTS WHILE CHANGING BEAN TYPES TO PREVENT ANY LINE CONTAMINATION THAT MAY AFFECT FLAVOR.

A CLEANER MACHINE IS A BETTER MACHINE.

RELIEF PORT



WARNING: HOT WATER WILL COME OUT HERE.



THE BASICS

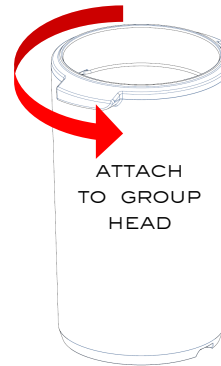

STEP 1
ATTACH SPRING CLEAN TO GROUP HEAD THE SAME WAY YOU WOULD ATTACH A PORTAFILTER. TWIST FIRMLY INTO PLACE TO ENSURE A GOOD SEAL ON THE GASKET. THE RETAINING TABS ARE PLASTIC SO DON'T USE EXCESSIVE FORCE. IF YOU ARE USING DETERGENT, PLACE IT ON TOP OF THE PISTON AT THIS TIME.

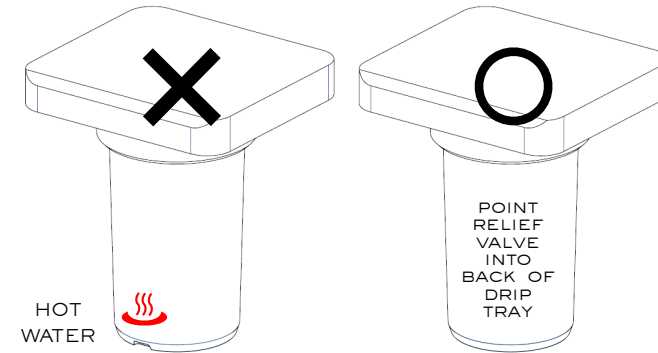

STEP 2
START MACHINE PUMP. WATER WILL FILL THE CHAMBER UNTIL IT SPRAYS OUT OF THE RELIEF PORT. STOP PUMP AND ALLOW THE BACKFLUSH TO BEGIN. IT MAY TAKE SEVERAL SECONDS TO COMPLETE. WAIT ANOTHER 10 SECONDS AND MAKE SURE THE MACHINE PRESSURE IS AT 0. USE CAUTION WHEN REMOVING SPRING CLEAN — YOU MAY WISH TO USE A RUBBER DISHWASHING GLOVE TO PROTECT HANDS.

MAINTENANCE

THE SPRING CLEAN MAY COLLECT COFFEE DEBRIS/OILS AND REQUIRE CLEANING TO CONTINUE RUNNING SMOOTHLY.

IF THE INSIDES SHOW STAINING AND THE PLUNGER IS STICKY, REMOVE THE RETAINING SPRING AND PLUNGER ASSEMBLY FOR CLEANING. THE PARTS MAY BE HAND-WASHED (DO NOT RUN IN A DISHWASHER)

NOTE:
DO NOT DISASSEMBLE OR TAMPER WITH SAFETY VALVE ASSEMBLY

CAUTION:
DO NOT LEAVE YOUR SPRING CLEAN ATTACHED TO MACHINE WHEN NOT IN USE. DO NOT STORE ON CUP WARMER AS IT MAY PREMATURELY AGE/EMBRITTLE THE RUBBER AND PLASTIC PARTS

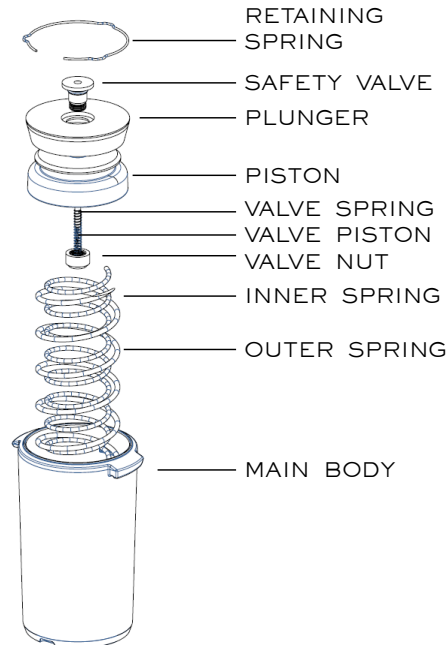

REMOVING & REPLACING RETAINING SPRING

NOTE:
BEFORE REPLACING PLUNGER, MAKE SURE INNER & OUTER SPRINGS ARE INSTALLED CORRECTLY



REMOVING PLUNGER
UNLOCK THE RETAINING SPRING BY PUSHING THE OPEN EDGES INWARDS.

REPLACING PLUNGER SPRING
FIT THE RETAINING SPRING INTO 3 GROOVES IN ORDER SHOWN.