



PERFORMANCE V700W

USER MANUAL

Please read this user manual thoroughly before you use the product and keep it well for future reference.



Thank you for choosing VANKYO.
If you have any questions or need any help,
please feel free to contact us at
support@ivankyo.com

CONTENTS

WHAT'S INCLUDED	01
PRODUCT OVERVIEW	01
QUICK START	03
PROJECTOR CONNECTION AND INPUT SOURCE	05
SCREEN MIRRORING	07
For iOS System	07
For Android System	10
For Mac	11
For Windows	12
SCREEN CASTING	14
BLUETOOTH CONNECTION	15
SETTINGS	18
PROJECTION DISTANCE & SIZE	19
SPECIFICATION	19
TROUBLESHOOTING GUIDE	20

WHAT'S INCLUDED



Projector



Remote
(Batteries Not Included)

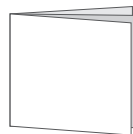

User Manual

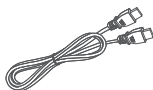

HDMI Cable



Power Cable

PRODUCT OVERVIEW

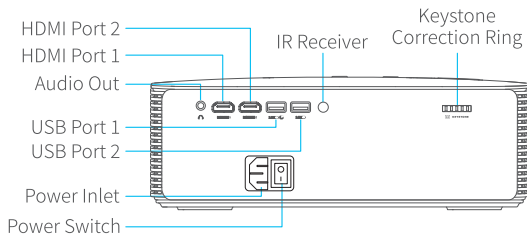
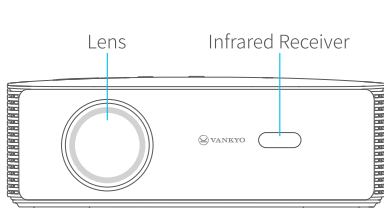

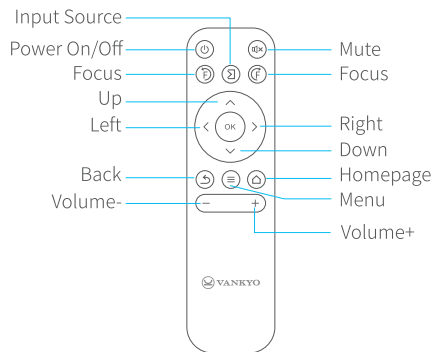
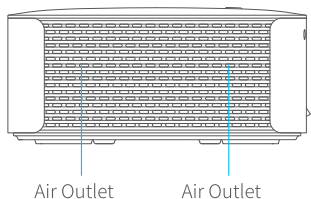
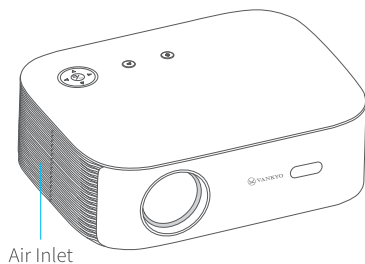
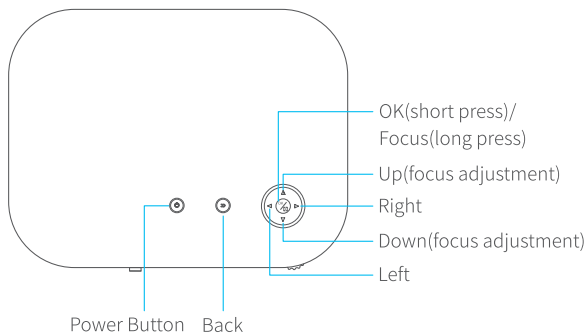

QUICK START

1. Projector Installation

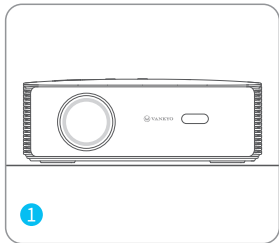

Horizontal Placement

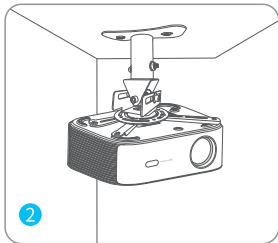

Ceiling Mounting

Note:

Whichever installation option you select, please make sure:

1. the projector is centered directly in front of the wall/screen, but not tilted or placed at an angle toward the wall/screen;
2. to go to **Settings > Projection Setting > Projection Mode** to select the corresponding projection mode so the images can be projected correctly.

2. Power On/Off

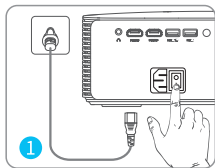

Plug the power cord into an outlet and press the **Power Switch**.

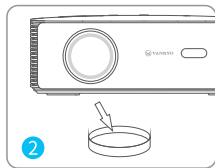

Take off the lens cover.

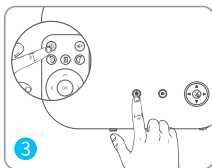

After 8 seconds, press the **Power Button** to turn on the projector.

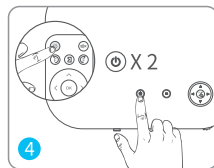

Press the **Power Button** twice to turn off the projector, then press the **Power Switch**.

3. Images Adjustment

- 1 Rotate the **Keystone Correction Ring** to correct the vertical keystone distortion until the image is evenly rectangular.

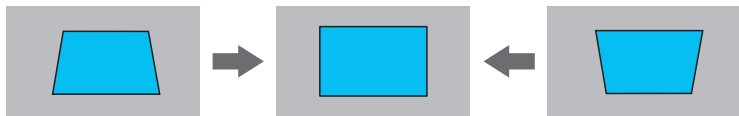

- 2 Press the focus buttons on the remote to sharpen the image focus until the blurry image becomes clear.

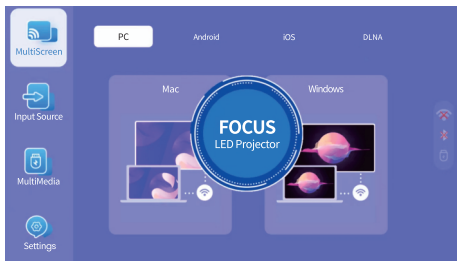
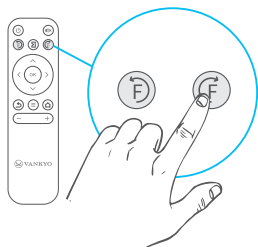

Tip:

You can also press and hold the **OK** button on the projector to enter the focus interface, then press the **UP** and **Down** buttons on it to adjust the focus.

- 3 Go to **Homepage > Settings > Projection Setting > Image Scaling** to enlarge or reduce the image size.

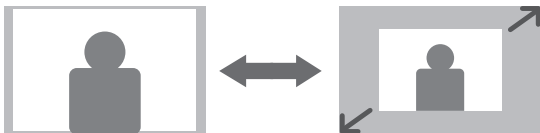

4. Homepage Overview

The projector will enter the homepage after you power it on and set the language for the first-time use.

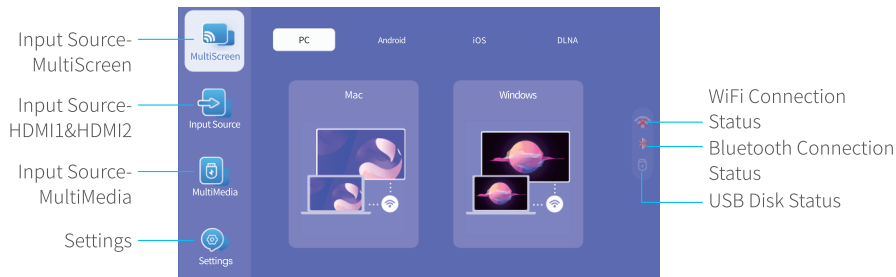

PROJECTOR CONNECTION AND INPUT SOURCE

Connect your device to the projector correctly, then select the right input source on the homepage.

1. Screen Mirroring

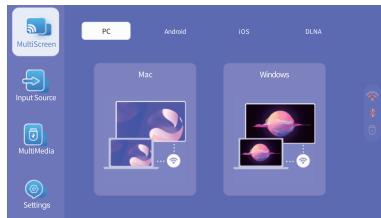
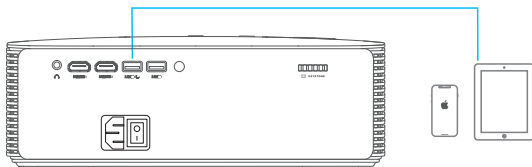

(See details on pages 07-14)

2. HDMI Connection

This option is for connecting a device with an HDMI output port.

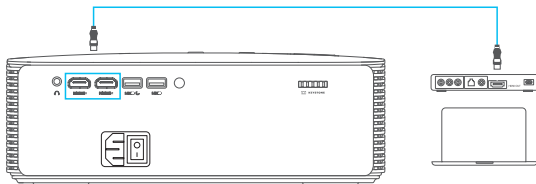

HDMI®, the HDMI® logo, and High-Definition Multimedia Interface are trademarks or registered trademarks of HDMI Licensing LLC.

3. USB Connection

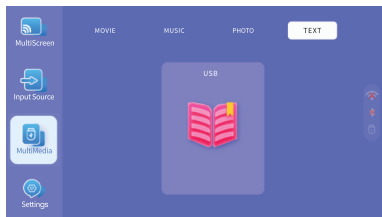
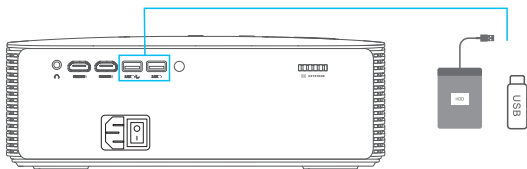
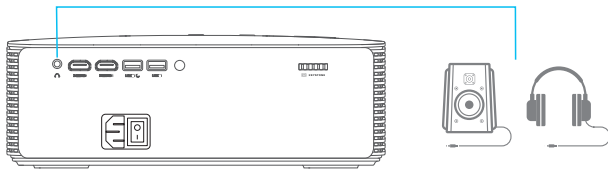

Photo Format Supported	BMP/JPG/PNG/JPEG
Audio Format Supported	AC3/AAC/MP2/MP3/FLAC/WMA
Video Format Supported	AVI/MP4/MKV/FLV/MOV/RMVB/MPEG2/H.264/XVID
Text Format Supported	TXT

4. Wired Speaker and Headphones Connection

This option is not required to select any input source.



Dolby, Dolby Audio, and the double-D symbol are trademarks of Dolby Laboratories Licensing Corporation.

SCREEN MIRRORING

For iOS System

Screen Mirroring Wirelessly

- 1 Go to **Homepage > Settings > Connect Setting > WIFI Setting** to search and connect the projector to your router's WiFi.

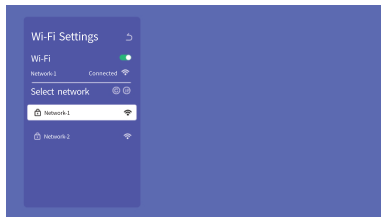

- Enter the WiFi settings of your iOS device and connect it to the same router's WiFi.
- Go to **Homepage > MultiScreen > iOS** and select **iOS Wireless Multi-screen**.

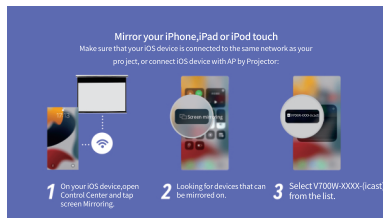
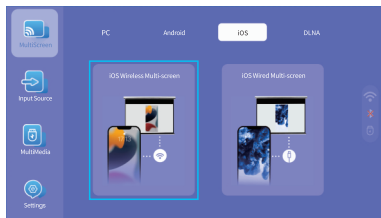

- Activate **Screen Mirroring/AirPlay Mirroring** in the **Control Center** of your iOS device and search for the projector.
- Select **V700W-XXXX-(icast)** from the searching list to connect.

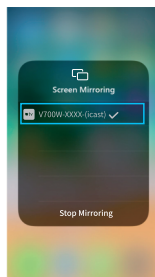
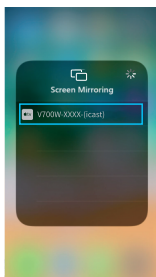
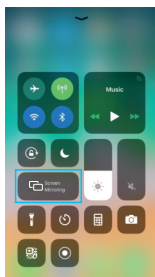

- The contents on your iOS device will be mirrored to the wall/screen after a successful connection.

Screen Mirroring via A Lightning Cable

- 1 Go to Homepage > MultiScreen > iOS and select iOS Wired Multi-screen.

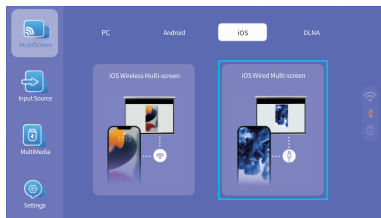

- 2 Connect your iOS mobile device to the **USB Port 1** of the projector using the ORIGINAL lightning cable.
- 3 Select **Trust** in the pop-up window of Trust This Computer?.

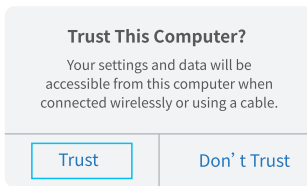

- 4 The contents on your iOS device will be mirrored to the wall/screen after a successful connection.

For Android System

To activate this function, please make sure your Android device supports **Multi-screen/ Wireless display/ Smart View**. Names may differ from one Android device to another.

- 1 Turn on the WiFi switch on your Android device.

Notes:

- * Successful WiFi connection is not a must, but please make sure the WiFi switch on your Android device is ON.
- * Make sure the WiFi feature on your projector is enabled by going to **Homepage > Settings > Connect Setting > WIFI Setting**.

- 2 Go to **Homepage > MultiScreen > Android** and select **Android Wireless Multi-Screen**.

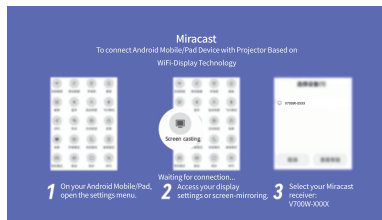
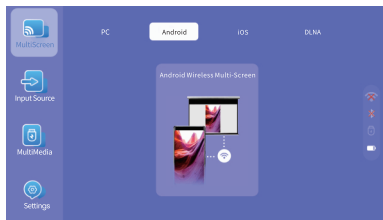

- 3 Activate **Multi-screen / Wireless display / Smart View** function on your Android device and search for the projector.
- 4 Select **V700W-XXXX** from the searching list to connect.
- 5 The contents on your Android device will be mirrored to the wall/screen after a successful connection.

For Mac

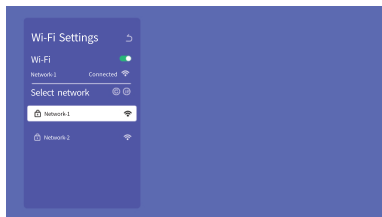

To activate this function, your Mac must support the **Screen Mirroring** feature.

- 1 Go to **Homepage > Settings > Connect Setting > WIFI Setting** to search and connect the projector to your router's WiFi.

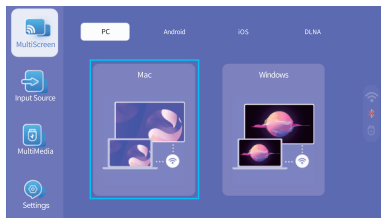

- 2 Enter the WiFi settings of your Mac and connect it to the same router's WiFi.
- 3 Go to **Homepage > MultiScreen > PC** and select **Mac**.



- Click on **Control Center**  in the upper right corner of your Mac's screen and select **Screen Mirroring**  .

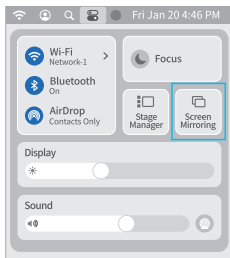

- Select **V700W-XXXX-(icast)** from the searching list to connect.
- The contents on your Mac will be mirrored to the wall/screen after a successful connection.

Note:

After successfully mirroring your screen, you can select whether to play the sound through your Mac or the projector in **Settings > Sound** on your Mac.

For Windows

To activate this function, your Windows device must support the **Miracast** feature.

- Turn on the WiFi switch on your Windows device.

Note:

Successful WiFi connection is not a must, but please make sure the WiFi switch on your **Windows** device is ON.

- 2 Go to Homepage > MultiScreen > PC and select Windows.

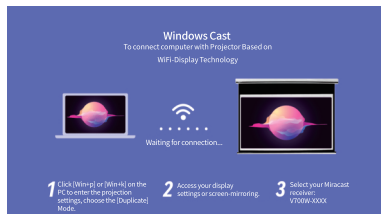
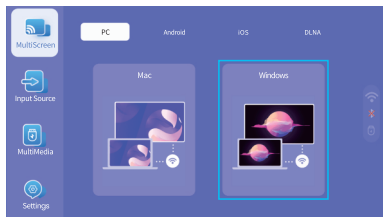

- 3 Press the "Windows Logo + K" key combination on your keyboard to enter the Cast interface. Select V700W-XXXX from the searching list to connect.
- 4 Press the "Windows Logo + P" key combination on your keyboard to enter the PROJECT interface, then click Duplicate.

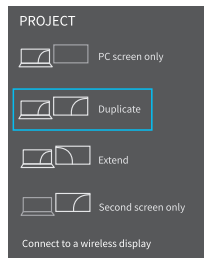
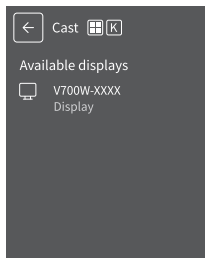

- 5 The contents on your Windows device will be mirrored to the wall/screen after a successful connection.

Notes:

- 1 The fluency of screen mirroring will be affected by the network environment. A bandwidth of 100Mbit or more is recommended when using screen mirroring.
- 2 Make sure your mobile device is close to the projector when using wireless connection. A distance within 3ft is recommended.
- 3 Some mobile devices may not support screen mirroring due to the compatibility.
- 4 Due to copyright restrictions of Hulu, Netflix, and similar services, the copyrighted contents on these streaming services CAN NOT be mirrored or cast.

SCREEN CASTING

- 1 Connect your mobile device and the projector to the same router's WiFi.
- 2 Go to **Homepage > MultiScreen > DLNA** and select DLNA.

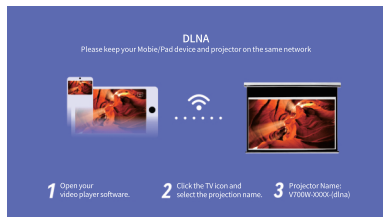
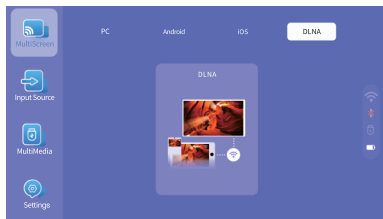

- 3 Launch a video player APP on your mobile device and select a video to play.
- 4 Tap  to search for the projector.
- 5 Select **V700W-XXXX-(dlna)** to connect.

- The contents on your device will be cast to the wall/screen.

Note:

When you cast a video from your mobile device, the video will only be displayed on the projected screen and you can still use your mobile device without interrupting the video or showing any of your other content.

BLUETOOTH CONNECTION

1. Use as A Bluetooth Speaker

You can connect your mobile device to this projector via Bluetooth connection and use it as a Bluetooth speaker.

Step 1:

Press the power button to enter the interface below, then press > to change to **Speaker Mode**.

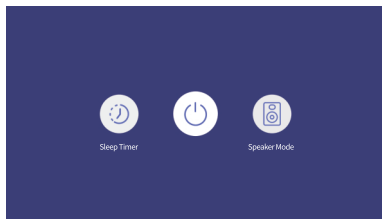

Tip:

Green means that the projection screen is off when the projector is playing audio; **Normal** means that the projection screen is on when the projector is playing audio.

Step 2:

Go to the Bluetooth setting of your mobile device to turn on the Bluetooth, then search for V700W from the searching list to pair the mobile device with the projector.

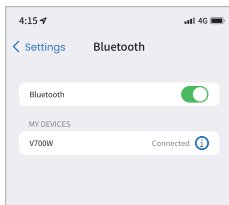
**Tip:**

Press the back button to exit this mode.

2. Connect to An External Bluetooth Speaker

Except for the wired 3.5mm audio output port connection, you can also connect a Bluetooth speaker or a pair of Bluetooth headphones to this projector via the Bluetooth connection.

Step 1:

Turn on your Bluetooth device and make it ready for a Bluetooth connection.

Step 2:

Go to the **Homepage > Settings > Connect Setting > Bluetooth** to enter the interface below.

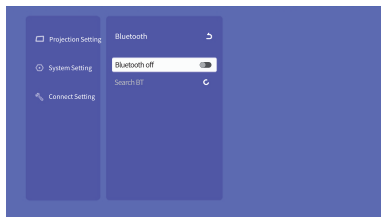

Step 3:

Press the **Left** or **Right** buttons to turn on or off the Bluetooth of the projector.

Tip:

It takes about 3 seconds to turn off the Bluetooth; please wait patiently.

Step 4:

Select **Search BT** and press **OK** to start searching for available Bluetooth devices.

Step 5:

Select your Bluetooth device and pair it with the projector.

Tip:

Compared with the wired connection, Bluetooth connection and screen mirroring technology take more time to process digital audio data, convert said data to an audio signal, and stream the signal. However, the processing time varies depending on different Bluetooth speakers and headphones. Therefore, there may be a delay or slight lag due to the processing time and signal interference.

SETTINGS

The settings include **Projection Setting**, **System Setting**, and **Connect Setting**.

Projection Setting:

Flip the image, and adjust the image size/image color/aspect ratio/picture mode.

System Setting:

Set the language of the projector, update the software of the projector with a USB disk, restore the projector to factory settings, set the time duration for the projector to power off automatically, and set the time duration for a pop-up window to disappear.

Connect Setting:

Connect the projector to WiFi or Bluetooth.

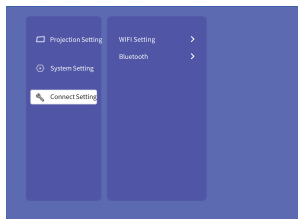
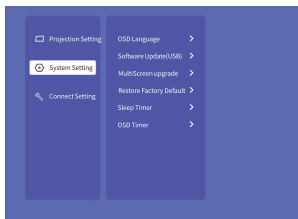
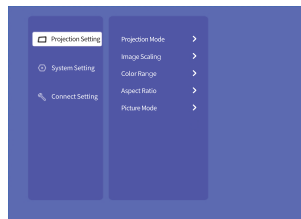

PROJECTION DISTANCE & SIZE

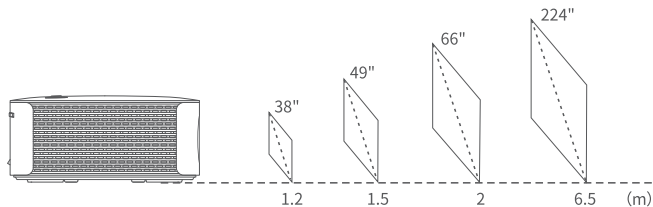

- * The recommended projection distance varies with different projection contents. Please adjust the distance between the wall/screen and the projector as needed.
- * Ambient darkness will improve the clarity of the projected images.

SPECIFICATION

Display Technology	LCD	Light Source	LED
Resolution	Native 1920 X 1080	Input Signal	576i, 576P, 720i, 720P, 1080i, 1080P
Installation Options	Front/Rear/Ceiling	Aspect Ratio	4:3/16:9/Auto
Focus	Manual(Electronic)	Keystone	Manual $\pm 15^{\circ}$
Speaker	5W/4ohm x2	Power Supply	AC 100-240V, 50/60Hz

Unit Dimension	290*220*93mm (11.4*8.7*3.7inch)	Unit Net Weight	2.23kg(4.92lbs)
----------------	------------------------------------	-----------------	-----------------

Ports	USB Port x2/HDMI Port x2/Audio Out x1
-------	---------------------------------------

TROUBLESHOOTING GUIDE

- 1** The copyrighted contents from Hulu, Netflix, and similar services can not be mirrored or cast.
 - * Due to the copyright restriction from Hulu, Netflix, and similar services, the copyrighted contents CAN NOT be mirrored or cast.
- 2** What should I do if I want to watch the copyrighted contents from Hulu, Netflix, and similar services via the projector?
 - * Please prepare a Fire TV stick , Roku stick or Chromecast™ (not included), then connect it to the projector.
- 3** Blurry image
 - * Adjust the focus ring/keystone.
 - * Projector and screen/wall must be at an effective distance.
- 4** Remote unresponsive
 - * Make sure the remote points at IR receiver directly.
 - * Do not cover the IR receiver.
 - * Try a new pair of AAA batteries.
- 5** Upside down images
 - * Go to **Homepage > Settings > Projection Setting > Projection Mode** to flip the projection image.

6 Factory reset

* Go to **Homepage** > **Settings** > **System Setting** > **Restore Factory Default** or press  on the remote in any interface to access **System Setting** and enter **Restore Factory Default**, then select **Confirm** to reset the projector to default settings.

FCC Statement

Any Changes or modifications not expressly approved by the party responsible for compliance could void the user's authority to operate the equipment. This device complies with part 15 of the FCC Rules. Operation is subject to the following two conditions:

- (1) This device may not cause harmful interference, and
- (2) this device must accept any interference received, including interference that may cause undesired operation.

NOTE: This equipment has been tested and found to comply with the limits for a Class B digital device, pursuant to part 15 of the FCC Rules. These limits are designed to provide reasonable protection against harmful interference in a residential installation. This equipment generates, uses and can radiate radio frequency energy and, if not installed and used in accordance with the instructions, may cause harmful interference to radio communications. However, there is no guarantee that interference will not occur in a particular installation. If this equipment does cause harmful interference to radio or television reception, which can be determined by turning the equipment off and on, the user is encouraged to try to correct the interference by one or more of the following measures:

- Reorient or relocate the receiving antenna.
- Increase the separation between the equipment and receiver.
- Connect the equipment into an outlet on a circuit different from that to which the receiver is connected.
- Consult the dealer or an experienced radio/TV technician for help.

This equipment complies with FCC radiation exposure limits set forth for an uncontrolled environment. This equipment should be installed and operated with minimum distance 20cm between the radiator& your body.

This transmitter must not be co-located or operating in conjunction with any other antenna or transmitter.

Canada Regulatory Information

Radio equipment

Operation of 5150-5250 MHz is restricted to indoor use only.

This device contains licence-exempt transmitter(s)/receiver(s) that comply with Innovation, Science and Economic Development Canada's licence-exempt RSS(s). Operation is subject to the following two conditions:

- (1) This device may not cause interference.
- (2) This device must accept any interference, including interference that may cause undesired operation of the device.

Le fonctionnement de cet appareil dans la bande 5150-5250 MHz est limité à une utilisation en intérieur uniquement.

L'émetteur/récepteur exempt de licence contenu dans le présent appareil est conforme aux CNR d'Innovation, Sciences et Développement économique Canada applicables aux appareils radio exempts de licence.

L'exploitation est autorisée aux deux conditions suivantes:

- 1) L'appareil ne doit pas produire de brouillage;
- 2) L'appareil doit accepter tout brouillage radioélectrique subi, même si le brouillage est susceptible d'en compromettre le fonctionnement.

CAN ICES-3 (B)/NMB-3(B)

CAUTION

 The symbol indicates DC voltage

 The symbol indicates AC voltage



This product bears the selective sorting symbol for Waste electrical and electronic equipment (WEEE). This means that this product must be handled pursuant to European directive 2012/19/EU in order to be recycled or dismantled to minimize its impact on the environment. User has the choice to give his product to a competent recycling organization or to the retailer when he buys a new electrical or electronic equipment.

This product can be used across EU member states.

The mains plug is used as the disconnect device, the disconnect device shall remain readily operable.

EU Compliance Statement: Shenzhen VanTop Technology & Innovation Co., Ltd. hereby declares that this device is in compliance with the essential requirements and other relevant provisions of the Directive 2014/53/EU.

A copy of the EU Declaration of Conformity is available online at <https://doc.vantop.com/>



BE	BG	CZ	DK	DE	EE	IE	EL
ES	FR	HR	IT	CY	LV	LT	LU
HU	MT	NL	AT	PL	PT	RO	SI
SK	FI	SE	NO	IS	LI	CH	TR

In all EU member states, operation of 5150-5250 MHz is restricted to indoor use only.