

# PERFORMANCE V630 USER MANUAL

Please read this manual thoroughly before using and keep it for future reference.

## PACKING LIST



PERFORMANCE V630



Remote  
(no batteries inside)



Carrying Bag



User Manual



AV Cable

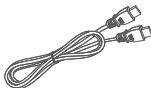

HD Cable



Power Cable

## NOTICE

Recommended

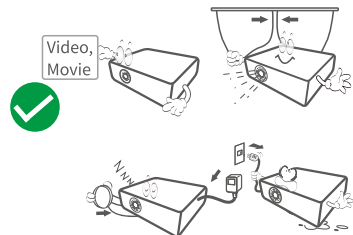

NOT Recommended

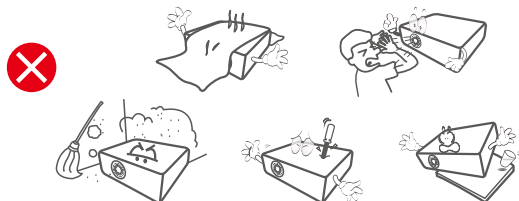

# FUNCTION OVERVIEW

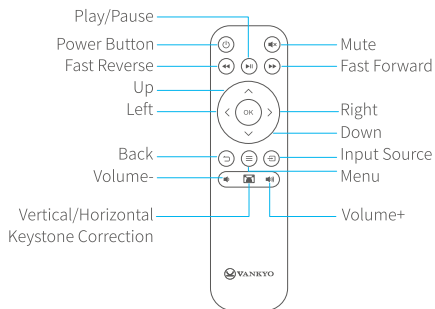
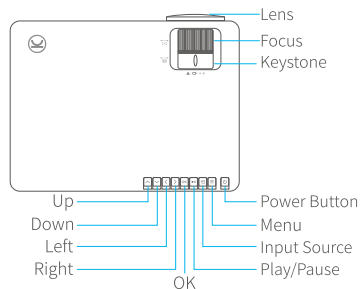
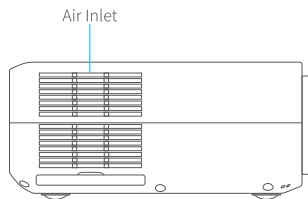
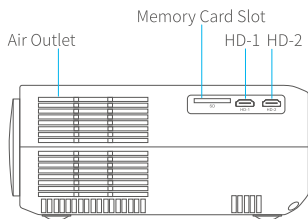
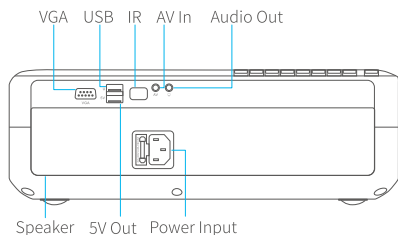

## QUICK START

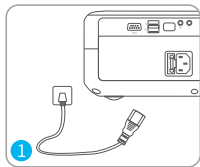

Plug the power cord into an outlet.

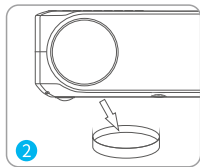

Take off the lens cover.

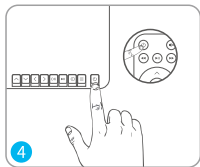

Press the **Power Button** to turn on the projector.

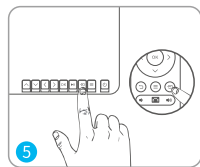

Select the correct input source to project your device.

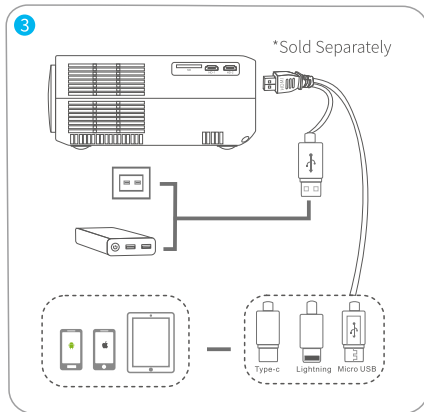

Connect your device to the projector correctly.

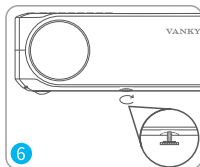

Adjust the kickstand accordingly.

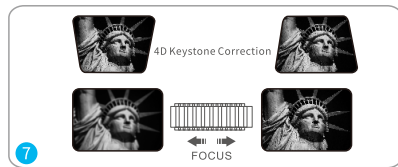

Adjust the focus ring to get a clear image.  
Press  on the remote to correct the image shape.



Press the **Power Button** twice to turn off the projector.

## KEYSTONE CORRECTION

Press **[ ]** on the projector/remote, then select **OPTION > Keystone**. Press the **[ ] [ ]** button to select from **H. Calibration**, **V. Calibration** and **Auto Adjust**, then press **[ ] [ ]** to start correcting the image shape.

### Vertical & Horizontal Correction

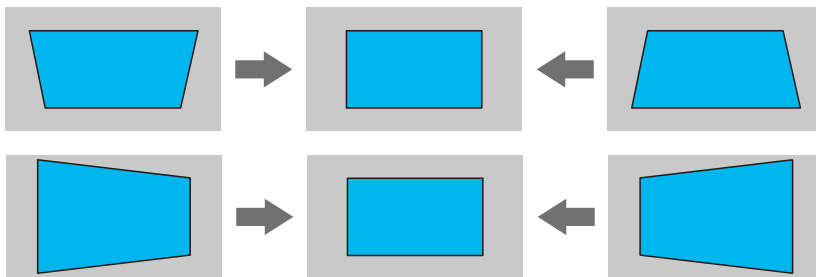

## PROJECTION DISTANCE&SIZE

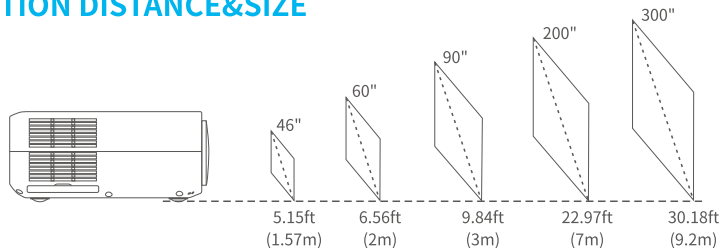

The recommended projection screen is around 90inches with a distance of around 9.84ft.

Ambient darkness will improve the clarity of the projected images.

# INPUT SOURCE

Press  on the projector/remote to enter the interface of Input Source.

## A. Multimedia Connection

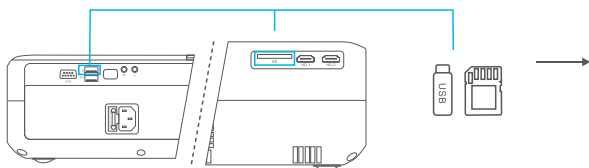

Input Source
VGA
HD1
HD2
AV
USB
SD

## B. HD Connection

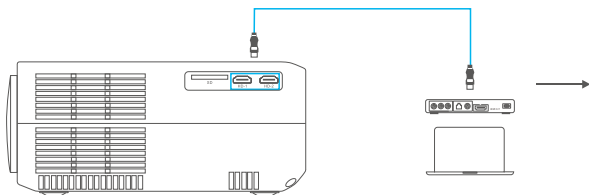

Input Source
VGA
HD1
HD2
AV
USB
SD

## C. VGA Connection

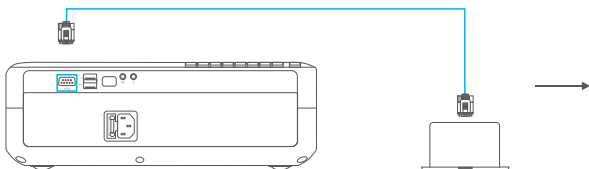

Input Source
VGA
HD1
HD2
AV
USB
SD

# PROJECTOR CONNECTION

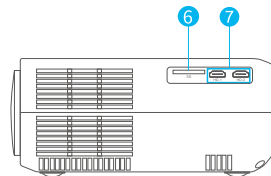
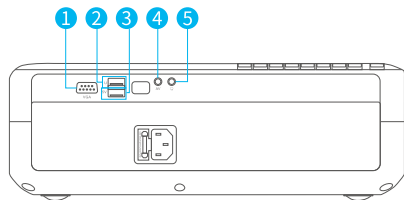

1



2

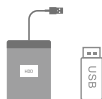

3



4



5



6



7

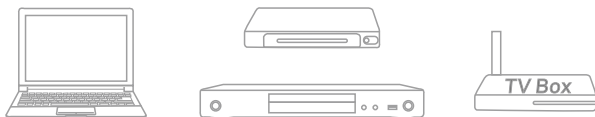

# SPECIFICATION

Display Technology	LCD	Light Source	LED
Resolution	Native 1920 X 1080	Input Signal	576i, 720P, 1080i, 1080P
Installation Type	Front/Rear/Ceiling	Aspect Ratio	4:3/16:9/Auto
Focus	Manual	Manual/Digital Keystone	±15°/±45°
Speaker	5W/4ohm	Power Supply	AC 100-240V, 50/60Hz
Unit Dimension	315 x 235 x 109mm (12.4 x 9.3 x 4.3inch)	Unit Net Weight	2.7kg(5.95lb)
Photo Format Supported	BMP/JPG/PNG/GIF	Audio Format Supported	AAC/MP2/MP3/PCM/FLAC/WMA
Video Format Supported	AVI/MP4/MKV/FLV/MOV/ RMVB/MPEG2/MPEG1/ 3GP/H.264/XVID/JPEG	Ports	HD In x 2/USB x 1/5V Out x 1/ Audio Out x 1/AV In x 1/VGA x 1/ Memory Card Slot x 1
Mounting Screws	M4 Metric	Number of Screw	4



# TROUBLESHOOTING GUIDE

## 1. Blurry Image

- \* Adjust focus ring/keystone.
- \* Projector and screen/wall must be in effective distance.

## 2. Remote Unresponsive

- \* Make sure remote points at IR receiver directly.
- \* Do not cover IR receiver.
- \* Try a new pair of AAA batteries.

## 3. Mobile Connection

- \* iOS: Genuine lightning to HDMI cable
- \* Android: Micro USB to HDMI adapter/Type C to HDMI cable

## 4. Up Down Images

- \* Go to **Menu > PICTURE > Projection Mode** to flip the projection image.

## CAUTION



The symbol indicates AC voltage



RECYCLING

This product bears the selective sorting symbol for Waste electrical and electronic equipment (WEEE). This means that this product must be handled pursuant to European directive 2012/19/EU in order to be recycled or dismantled to minimize its impact on the environment.

This product can be used across EU member states.

# VANKYO SUPPORT

North America [support@ivankyo.com](mailto:support@ivankyo.com)

United Kingdom [support.uk@ivankyo.com](mailto:support.uk@ivankyo.com)



[www.ivankyo.com](http://www.ivankyo.com)



[@VankyoOfficial](https://www.facebook.com/VankyoOfficial)



[VANKYO](https://www.youtube.com/VANKYO)