

# PERFORMANCE V630W USER MANUAL

Please read this manual thoroughly before using and keep it for future reference.

# CONTENTS

WHAT'S INCLUDED .....	01
NOTICE .....	01
FUNCTION OVERVIEW .....	02
QUICK START .....	03
INPUT SOURCE .....	04
PROJECTOR CONNECTION .....	05
SCREEN MIRRORING .....	06
For iOS System .....	06
For Android System .....	08
SETTINGS .....	09
PROJECTION DISTANCE&SIZE .....	10
SPECIFICATION .....	11
TROUBLESHOOTING GUIDE .....	12

# WHAT'S INCLUDED



Projector



Remote  
(Batteries Not Included)



User Manual



Carrying Bag

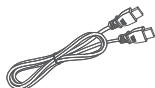

HD Cable



Power Cable

## NOTICE

### Recommended

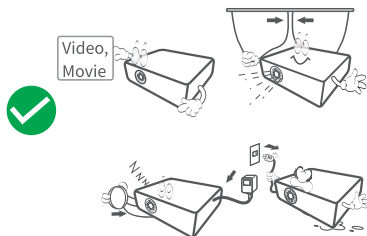

### NOT Recommended

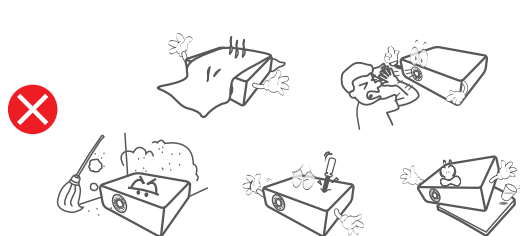

# FUNCTION OVERVIEW

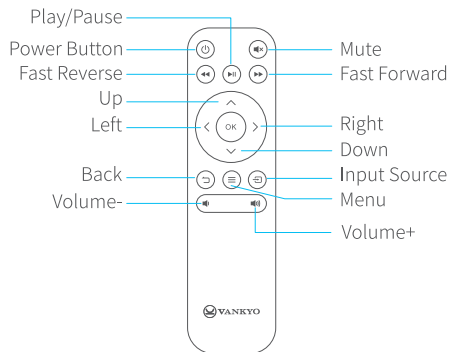
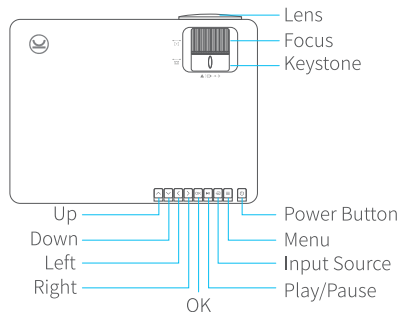
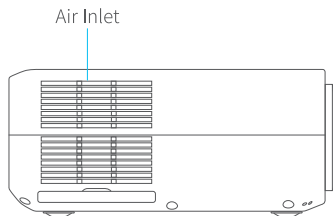
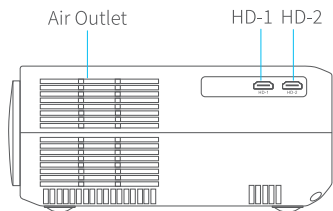
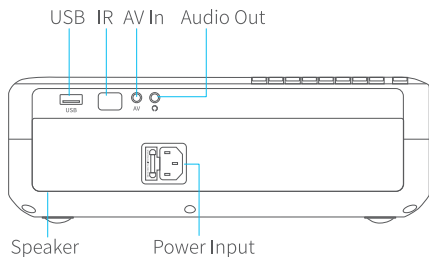

# QUICK START

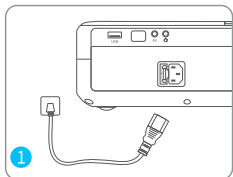

Plug the power cord into an outlet.

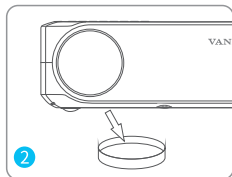

Take off the lens cover.

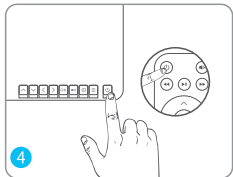

Press the **Power Button** to turn on the projector.

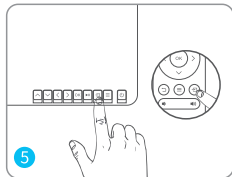

Select the correct input source to project your device.

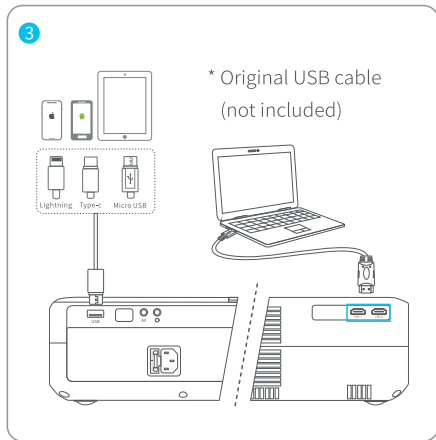

Connect your device to the projector correctly.

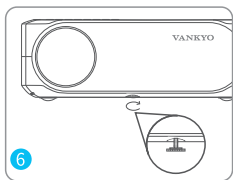

Adjust the kickstand accordingly.

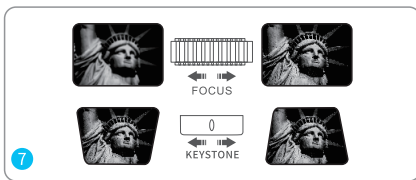

Adjust the focus ring and keystone to get the best image performance.

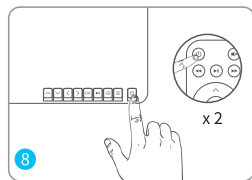

Press the **Power Button** twice to turn off the projector.

# INPUT SOURCE

Press  on the projector/remote to enter the interface of Input Source.

## A. HD Connection

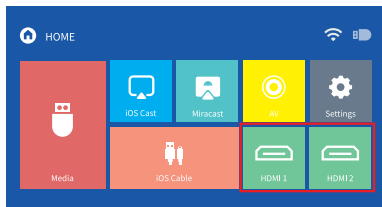
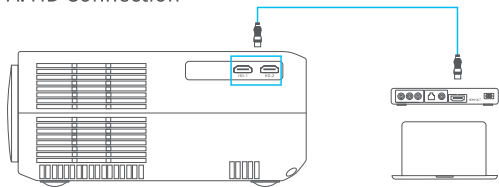

## B. USB Connection

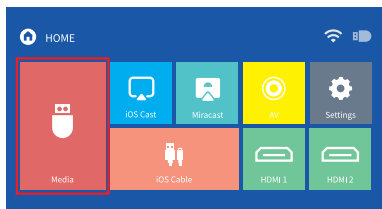
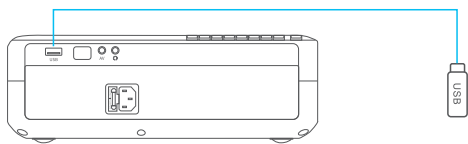

## C. AV Connection

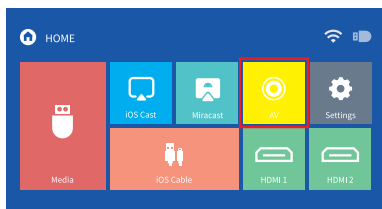
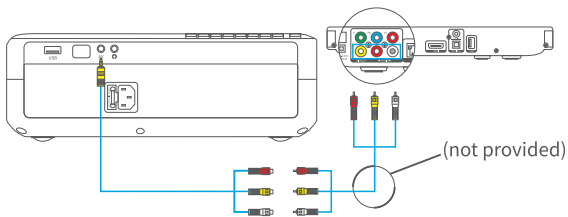

# PROJECTOR CONNECTION

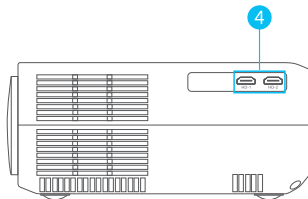
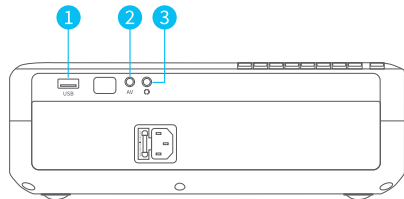

1

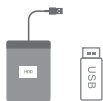

2



3



4

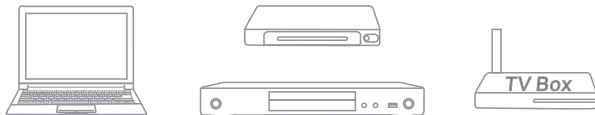

# SCREEN MIRRORING

## For iOS System

### Screen Mirroring Wirelessly

#### Step 1:

Connect the projector and your mobile device to the same router's WiFi or directly connect your mobile device to the projector's AP hotspot.

#### Tip:

When you are using the projector's AP hotspot, the content will be mirrored via the cellular data.

#### Step 2:

Go to **Homepage** and select **iOS Cast** to enter the interface below.

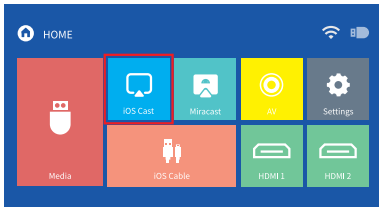

#### Step 3:

Activate **Screen Mirroring/AirPlaying Mirroring** in the **Control Center** of your iOS device and search for the projector.

#### Step 4:

Select **V630W-xxxx** from the searching list. The contents on your iOS device will be mirrored on the projection screen/wall after a successful connection.



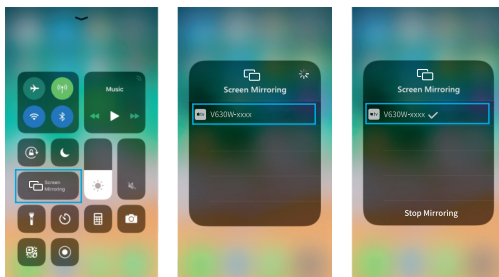

## Screen Mirroring via A Lightning Cable

### Step 1:

Go to **Homepage** and select **iOS Cable** to enter the interface below.

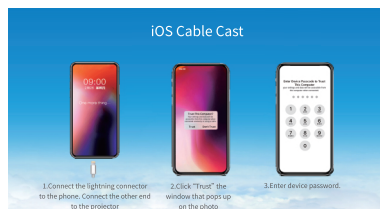
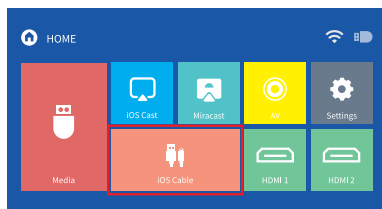

### Step 2:

Connect your mobile device to the **USB Port** on the projector using the **ORIGINAL** lightning cable.

**Step 3:**

Select **Trust** in the pop-up window of **Trust This Computer?**

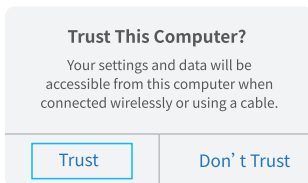
**Step 4:**

The contents on your iOS device will be mirrored on the projection screen/wall after a successful connection.

## For Android System

To activate this function, please make sure your Android device supports **Multi-screen/Smart View/Wireless Display**. Names may vary on different Android devices.

**Step 1:**

Go to the WiFi settings of your Android mobile device to switch on the option of **WiFi**.

**Note:**

Successful WiFi connection is not a must, but please make sure the WiFi switch on your Android device is **ON**.

**Step 2:**

Go to **Homepage** and select **Miracast** to enter the interface below.

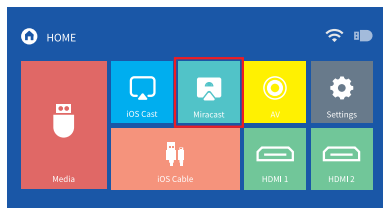

### Step 3:

Activate the Multi-screen/Smart View/Wireless Display function on your Android device and search for the projector.

### Step 4:

Select V630W-xxxx from the searching list. The contents on your Android device will be mirrored on the projection screen/wall after a successful connection.

## SETTINGS

1. Press the **Menu** button on any interface to check the **PICTURE**, **SOUND** and **OPTION** settings.

Picture Mode	User
Contrast	50
Brightness	50
Color	50
Tint	50
Sharpness	50
Color Temperature	Medium
Noise Reduction	Middle

PICTURE

Sound Mode	User
Treble	3
Bass	100

SOUND

Aspect Ratio	16:9
Software Upgrade	
Version	ENTER

OPTION

### Tips:

- After you select **User** in the option of **Picture Mode**, you can change the settings of the **Contrast**, **Brightness**, **Color**, **Tint** and **Sharpness** to adjust the image quality.

- 2 If you select **User** in the option of **SOUND**, you could change the settings of the **Treble** and **Bass** to adjust the sound effect.
- 3 When you are using the **USB connection** or **HD connection** on the projector, the option of **Aspect Ratio** will be activated. You can then adjust the aspect ratio of the projection image.

2. Go to **Homepage** > **Settings** to connect the projector to a WiFi network, change language, restore the projector to factory settings, change the projection mode and adjust the image size.

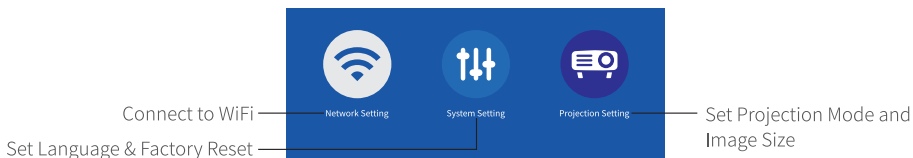

## PROJECTION DISTANCE&SIZE

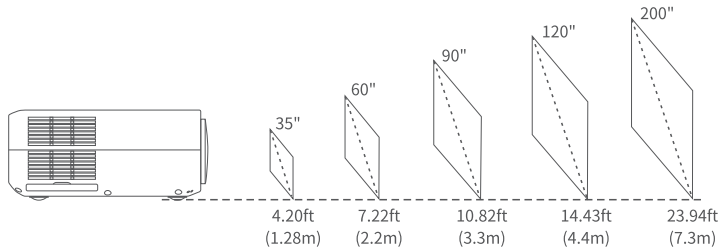

\* The recommended projection distance varies with different projection contents. Please adjust the distance between the wall/screen and the projector properly as needed.

\* Ambient darkness will improve the clarity of the projected images.

# SPECIFICATION

Display Technology	LCD	Light Source	LED
Resolution	Native 1920 X 1080	Input Signal	576i、720P、1080i、1080P
Installation Type	Front/Rear/Ceiling	Aspect Ratio	4:3/16:9/Auto
Speaker	3W/4ohm	Power Supply	AC 100-240V, 50/60Hz
Unit Dimension	270 x 202.3 x 95.4mm (10.6 x 8.0 x 3.8inches)	Unit Net Weight	1.85kg(4.08lb)
Photo Format Supported	BMP/JPG/PNG/GIF	Audio Format Supported	AAC/MP2/MP3/PCM/FLAC/WMA
Video Format Supported	AVI/MP4/MKV/FLV/MOV/ RMVB/MPEG2/MPEG1/ 3GP/H.264/XVID/JPEG	Ports	HD In x 2/USB x 1/Audio Out x 1/ AV In x 1
Mounting Screws	M4 Metric	Number of Screw	4

# TROUBLESHOOTING GUIDE

## 1. The copyrighted contents from Hulu, Netflix, and similar services can not be mirrored or cast.

\* Due to the copyrighted restriction from Hulu, Netflix, and similar services, the contents MAY NOT be mirrored or cast.

## 2. What should I do if I want to watch the copyrighted contents from Hulu, Netflix, and similar services via the projector?

\* Please prepare a Fire TV stick , Roku stick or Chromecast™ (not included), then connect it to the projector to watch the contents.

## 3. Blurry Image

\* Adjust the focus ring/keystone.

\* Projector and screen/wall must be in the effective distance.

## 4. Remote Unresponsive

\* Make sure the remote points at the IR receiver directly.

\* Do not cover the IR receiver.

\* Replace the old AAA batteries with new ones.

## 5. Upside Down Images

\* Go to Homepage > Settings > Projection Setting > Projection Mode to flip the projection image.

## 6. Factory Reset

\* Go to Homepage > Settings > System Setting > Restore Factory Default to restore the projector to default settings.

## FCC Statement

Any Changes or modifications not expressly approved by the party responsible for compliance could void the user's authority to operate the equipment. This device complies with part 15 of the FCC Rules. Operation is subject to the following two conditions:

- (1) This device may not cause harmful interference, and
- (2) this device must accept any interference received, including interference that may cause undesired operation.

**NOTE:** This equipment has been tested and found to comply with the limits for a Class B digital device, pursuant to part 15 of the FCC Rules. These limits are designed to provide reasonable protection against harmful interference in a residential installation. This equipment generates, uses and can radiate radio frequency energy and, if not installed and used in accordance with the instructions, may cause harmful interference to radio communications. However, there is no guarantee that interference will not occur in a particular installation. If this equipment does cause harmful interference to radio or television reception, which can be determined by turning the equipment off and on, the user is encouraged to try to correct the interference by one or more of the following measures:

- Reorient or relocate the receiving antenna.
- Increase the separation between the equipment and receiver.
- Connect the equipment into an outlet on a circuit different from that to which the receiver is connected.
- Consult the dealer or an experienced radio/TV technician for help.

This equipment complies with FCC radiation exposure limits set forth for an uncontrolled environment.

This equipment should be installed and operated with minimum distance 20cm between the radiator & your body.

This transmitter must not be co-located or operating in conjunction with any other antenna or transmitter.

## ISED Warning

This device complies with Industry Canada licence-exempt RSS standard(s). Operation is subject to the following two conditions:

- (1) this device may not cause interference, and
- (2) this device must accept any interference, including interference that may cause undesired operation of the device.

Le présent appareil est conforme aux CNR d'Industrie Canada applicables aux appareils radio exempts de licence. L'exploitation est autorisée aux deux conditions suivantes:

- (1) l'appareil ne doit pas produire de brouillage, et
- (2) l'utilisateur de l'appareil doit accepter tout brouillage radioélectrique subi, même si le brouillage est susceptible d'en compromettre le fonctionnement.

The device is compliance with RF exposure guidelines, users can obtain Canadian information on RF exposure and compliance. The minimum distance from body to use the device is 20cm.

L'appareil est conforme aux directives d'exposition aux RF, les utilisateurs peuvent obtenir des informations canadiennes sur l'exposition aux RF et la conformité. La distance minimale du corps pour utiliser l'appareil est de 20cm.

This transmitter must not be co-located or operating in conjunction with any other antenna or transmitter. Cet émetteur ne doit pas être colocalisé ou fonctionner en conjonction avec une autre antenne ou un autre émetteur.

Operation of this device in the band 5150-5250 MHz is restricted to indoor use only. Le fonctionnement de cet appareil dans la bande 5150-5250 MHz est limité à une utilisation en intérieur uniquement.



## Caution

To avoid replacement of a battery with an incorrect type.

Don't dispose of a battery into fire or a hot oven, or mechanically crush or cut a Battery.

Don't leave a battery in an extremely high temperature surrounding environment.

To avoid battery subjected to extremely low air pressure.

The mains plug is used as the disconnect device, the disconnect device shall remain readily operable.

 The symbol indicates DC voltage

 The symbol indicates AC voltage

 The symbol indicates For indoor use only

 RECYCLING

This product bears the selective sorting symbol for Waste electrical and electronic equipment (WEEE).

This means that this product must be handled pursuant to European directive 2012/19/EU in order to be recycled or dismantled to minimize its impact on the environment. User has the choice to give this product to a competent recycling organization or the retailer when he buys a new electrical or electronic equipment. This product can be used across EU member states.

The mains plug is used as the disconnect device, the disconnect device shall remain readily operable.

EU Compliance Statement: Shenzhen VanTop Technology & Innovation Co., Ltd. hereby declares that this device is in compliance with the essential requirements and other relevant provisions of the Directive 2014/53/EU.

A copy of the EU Declaration of Conformity is available online at <https://doc.vantop.com/>.



BE	BG	CZ	DK	DE	EE	IE	EL
ES	FR	HR	IT	CY	LV	LT	LU
HU	MT	NL	AT	PL	PT	RO	SI
SK	FI	SE	NO	IS	LI	CH	TR

In all EU member states, operation of 5150-5250 MHz is restricted to indoor use only.

## VANKYO SUPPORT

North America [support@ivankyo.com](mailto:support@ivankyo.com)

United Kingdom [support.uk@ivankyo.com](mailto:support.uk@ivankyo.com)

Deutschland [support.de@ivankyo.com](mailto:support.de@ivankyo.com)

Français [support.fr@ivankyo.com](mailto:support.fr@ivankyo.com)