



Miracle 120



USER MANUAL

Please read this manual thoroughly before using and keep it for future reference.

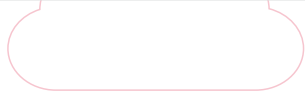
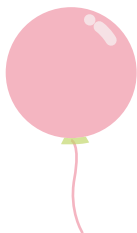

PACKING LIST

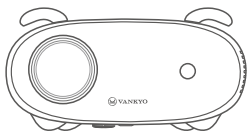

Miracle 120



Carrying Bag



Remote
(Batteries Not Included)

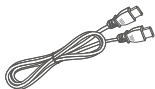

HD Cable



Power Cable



User Manual

NOTICE

Recommended



Video,
Movie

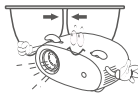

NOT Recommended



PowerPoint,
Excel, Word



FUNCTION OVERVIEW

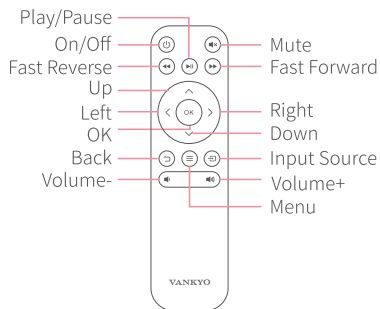
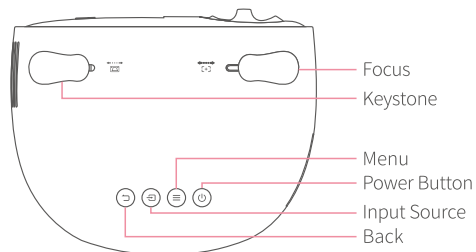
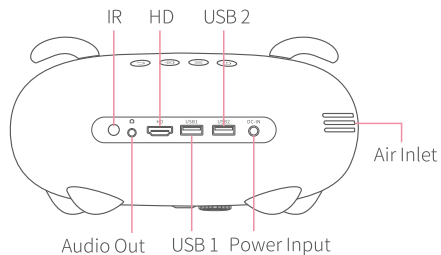
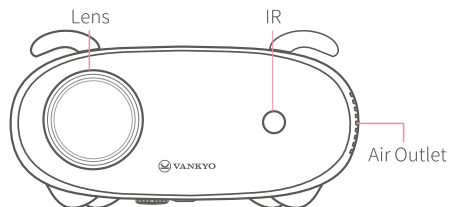

QUICK START

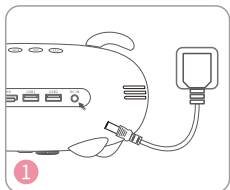

1 Plug the power cord into an outlet.

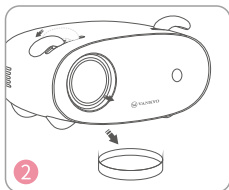

2 Move the focus to the right to take off the lens cover.

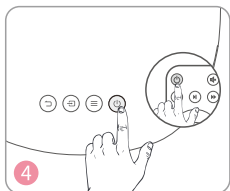

4 Press the **Power Button** to turn on the projector.

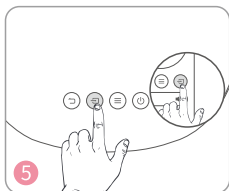

5 Select the correct input source by pressing the **Source** button.

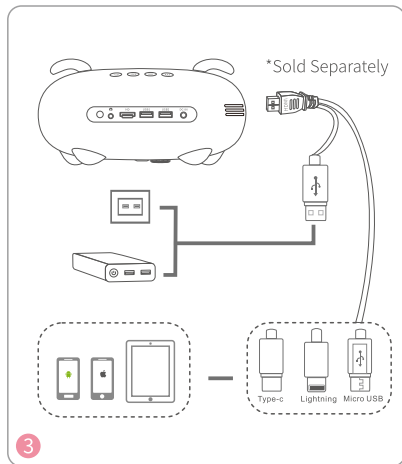

3 Connect your device to the projector correctly.

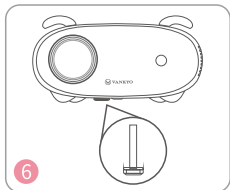

6 Adjust the kickstand accordingly.

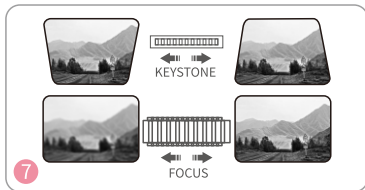

7 Adjust the keystone and the focus to get the best image performance.

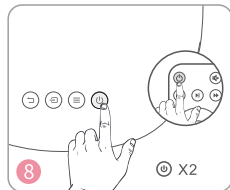

8 Press the **Power Button** twice to turn off the projector.

INPUT SOURCE

Press  on the projector or remote to enter the interface of **Input Source**.

A. USB 1 Connection

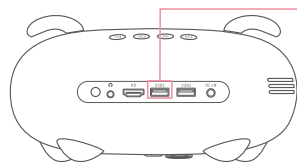

Input Source
HD
USB 1
USB 2

B. USB 2 Connection

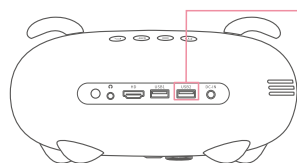

Input Source
HD
USB 1
USB 2

C. HD Connection

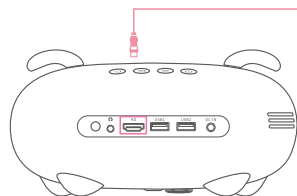

Input Source
HD
USB 1
USB 2

PROJECTOR CONNECTION

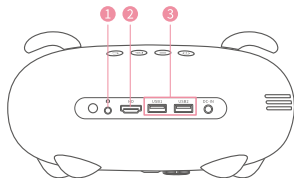

PROJECTION DISTANCE&SIZE

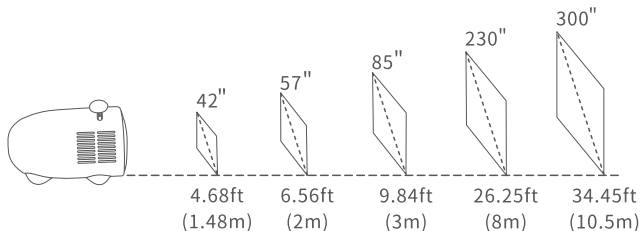

*The recommended projection distance varies with different projection contents. Please adjust the distance between the wall/screen and the projector properly as needed.

*Ambient darkness will improve the clarity of the projected images.

SPECIFICATION

Display Technology	LCD	Light Source	LED
Resolution	Native 800 x 480	Input Signal	480P/576i/576P/720i/720P/1080i/1080P
Installation Type	Front/Rear/Ceiling	Aspect Ratio	4:3/16:9/Auto
Focus	Manual	Keystone	±15°
Speaker	3W/4ohm	Power Supply	DC 20V
Unit Dimension	8.11 × 6.50 × 4.13 in (206 x 165 x 105mm)	Unit Net Weight	1.98lb (0.897kg)
Photo Format Supported	BMP/JPG/PNG	Audio Format Supported	MP3/WMA/OGG/AAC/FLAC/WAV
Video Format Supported	3GP(H.263,MPEG4)/AVI(XVID,DIVX,H.264)/MKV(XVID,H.264,DIVX)/FLV(FLV)/MOV(H.234)/MP4(PEG4,AVC)/MPG(MPEG1)/VOB(MPEG2)/MPG(MPG-PS)/RMVB(RV40)/RM	Ports	HD In x 1/Audio Out x 1/USB Port x 2
Mounting Screw	1/4"	Number of Screw	1

TROUBLESHOOTING GUIDE

1. What should I do if I get blurry images?

- * Adjust focus ring/keystone.
- * Projector and screen/wall must be in effective distance.

2. What should I do if the remote is unresponsive?

- * Make sure remote points at IR receiver directly.
- * Do not cover IR receiver.
- * Try a new pair of AAA batteries.

3. How do I flip the upside-down images?

- * Go to **Menu > PICTURE > Projection Direction** to flip the projection image.

4. How do I restore the projector to factory default?

- * Go to **Menu > OPTION > Restore Factory Default** to restore factory settings as needed.

5. How do I set the language?

- * Go to **Menu > OPTION > OSD Language** to select the language.

CAUTION



The symbol indicates DC voltage



RECYCLING

This product bears the selective sorting symbol for Waste electrical and electronic equipment (WEEE). This means that this product must be handled pursuant to European directive 2012/19/EU in order to be recycled or dismantled to minimize its impact on the environment.

This product can be used across EU member states.

VANKYO SUPPORT



North America

support@ivankyo.com

United Kingdom

support.uk@ivankyo.com



www.ivankyo.com



[@VankyoOfficial](https://www.facebook.com/VankyoOfficial)



[VANKYO](https://www.youtube.com/VANKYO)