

LEISURE 430 USER MANUAL

Please read this manual thoroughly before using this product and keep it for future reference.

PACKING LIST

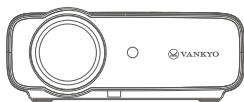

Leisure 430

Remote
(Batteries Not Included)

Carrying Bag



User Manual

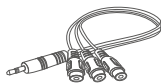

AV Cable

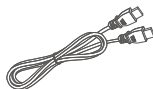

HD Cable



Power Cable

NOTICE

Recommended

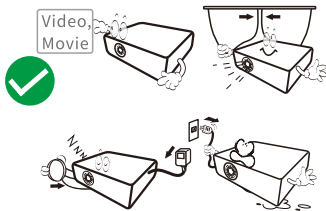

NOT Recommended

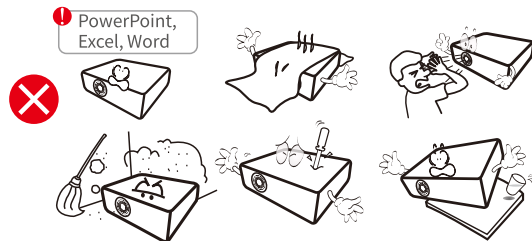

FUNCTION OVERVIEW

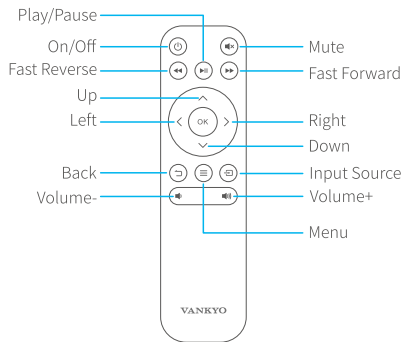
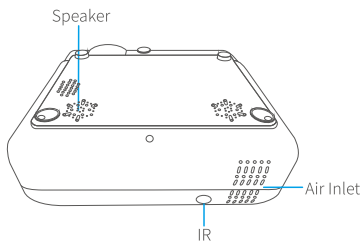
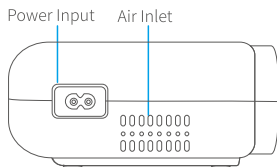
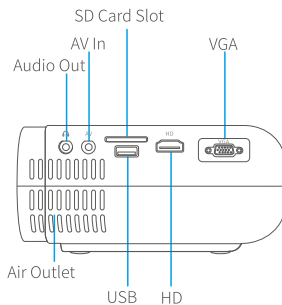
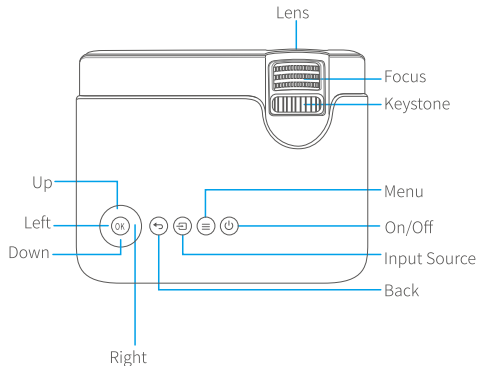

QUICK START

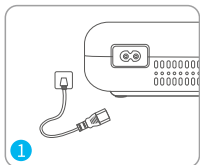

1 Plug the power cord into an outlet.

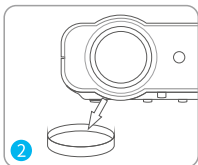

2 Take off the lens cover.

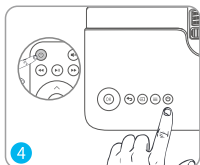

4 Press power button to turn on the projector.

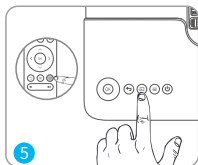

5 Select the correct input source to project your device.

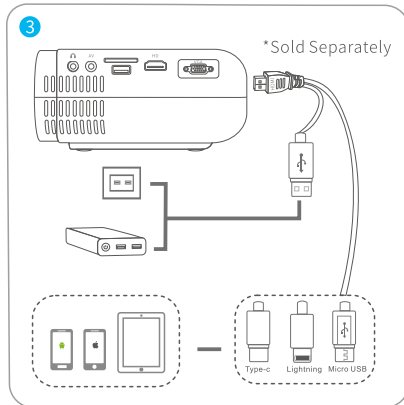

3 Connect your device to the projector correctly.

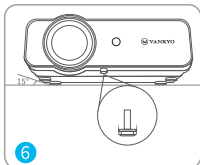

6 Adjust the kickstand accordingly.

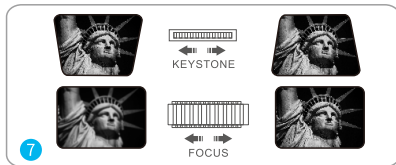

7 Adjust the keystone and focus ring to get the best image performance.

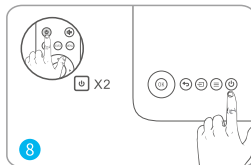

8 Press the power button twice to turn off the projector.

INPUT SOURCE

Press  on the projector or remote to enter the interface of Input Source.

A.Multimedia Connection

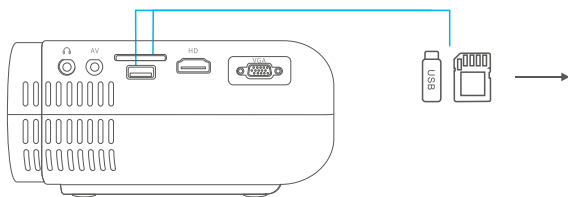

Input Source
VGA
HD
AV
USB
SD

B.HD Connection

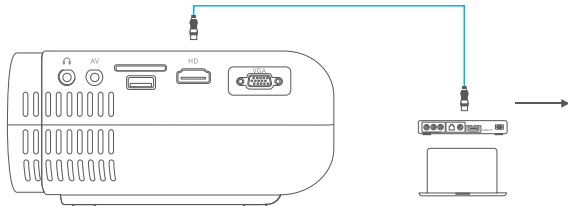

Input Source
VGA
HD
AV
USB
SD

C.VGA Connection

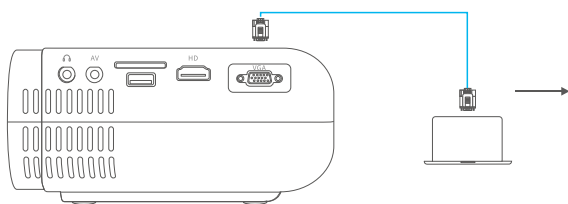

Input Source
VGA
HD
AV
USB
SD

PROJECTOR CONNECTION

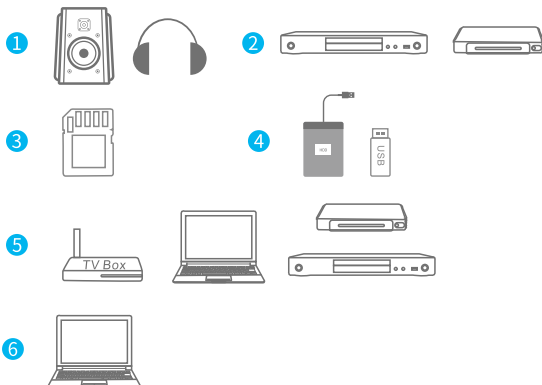
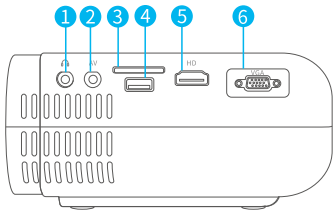

PROJECTION DISTANCE&SIZE

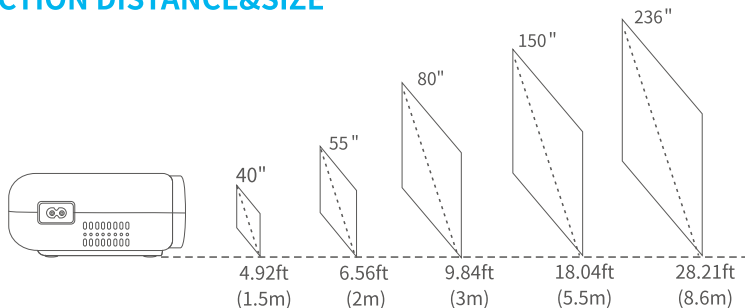

The recommended projection screen is around 80 inches with a projection distance of around 9.84ft. Ambient darkness will improve the clarity of the projected images.

SPECIFICATION

Display Technology	LCD	Light Source	LED
Resolution	Native 800 x 480	Input Signal	576i, 576P, 720i, 720P, 1080i, 1080P
Installation Type	Front/Rear/Ceiling	Aspect Ratio	4:3/16:9/auto
Focus	Manual	Keystone	±15°
Speaker	3W/4ohm	Power Supply	100V-240V, 50/60Hz
Unit Dimension	220 x 170 x 90mm (8.7 x 6.7 x 3.5in)	Unit Net Weight	1.22kg (2.68lb)
Photo Format Supported	BMP/JPG/PNG/GIF/JPEG	Audio Format Supported	ACC/MP2/MP3/PCM/FLAC/WMA
Video Format Supported	AVI/MP4/MKV/FLV/MOV/ RMVB/3GP/MPEG1/ MPEG2/H.264/XVID	Ports	HD In x 1/USB2.0 Port x 1/VGA Port x 1/ AV In x 1/Audio Out x 1/SD Card Slot x 1
Mounting Screw	1/4"	Number of Screw	Not included

TROUBLESHOOTING GUIDE

1. Blurry Image

- * Adjust focus ring/keystone.
- * Projector and screen/wall must be in effective distance.

2. Remote Unresponsive

- * Make sure remote points at IR receiver directly.
- * Do not cover IR receiver.
- * Try a new pair of AAA batteries.

3. Mobile Connection

iOS: Genuine lightning to HDMI cable

Android: Micro USB to HDMI adapter/Type C to HDMI cable

4. Up Side Down Images

- * Enter "Menu" on projector or remote to flip the projection image.

VANKYO SUPPORT



www.ivankyo.com



[@VankyoOfficial](https://www.facebook.com/VankyoOfficial)



[VANKYO](https://www.youtube.com/VANKYO)



North America support@ivankyo.com

United Kingdom support.uk@ivankyo.com

Deutschland support.de@ivankyo.com

France support.fr@ivankyo.com

España support.es@ivankyo.com

Italia support.it@ivankyo.com

日本 support.jp@ivankyo.com