

BURGER 101

USER MANUAL

Please read this manual thoroughly before using this product and keep it for future reference.

PACKING LIST

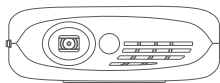

BURGER 101



Remote



Carrying Bag



User Manual



Tripod

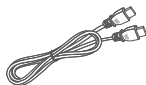

HDMI Cable



Adapter

NOTICE

Recommended

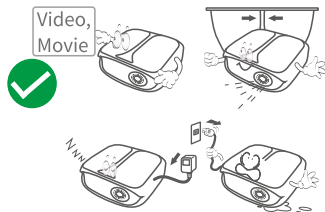

NOT Recommended

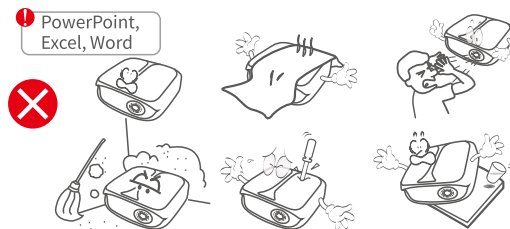

FUNCTION OVERVIEW

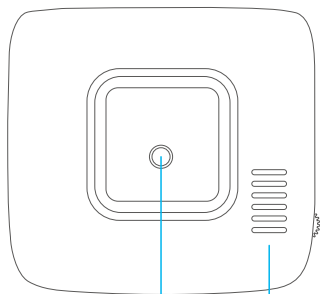

Tripod Socket Hole

Air Inlet

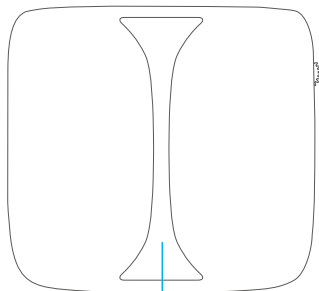

LED

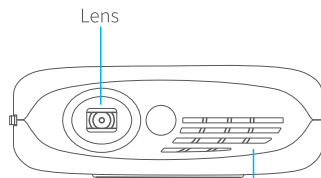

Lens

Air Outlet

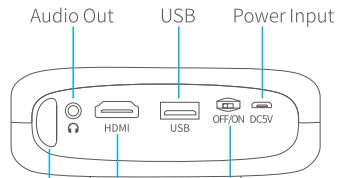

Audio Out

USB

Power Input

IR Receiver

HDMI

ON/OFF Switch

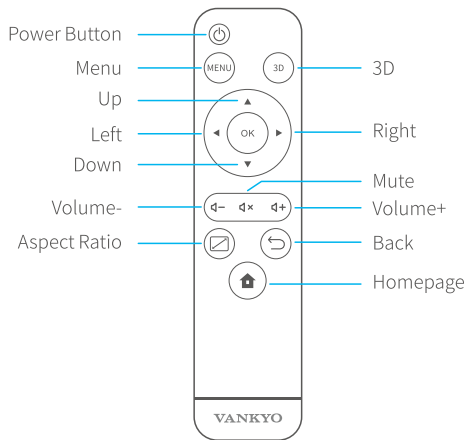
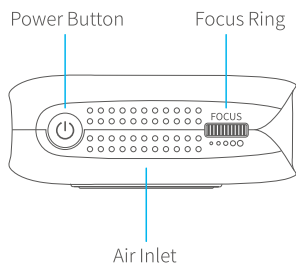
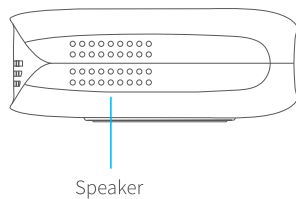

GETTING STARTED

1. Turn On

- ① Plug the power cable into the projector and the socket;

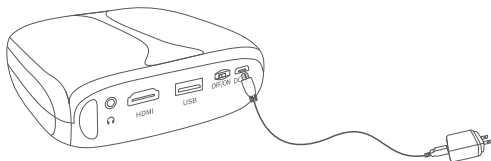

- ② Switch the **ON/OFF Switch** to **ON**;

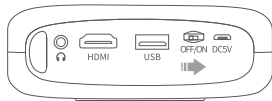

- ③ Press the **Power button** to turn the projector on.

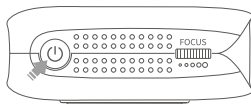

2. Turn Off

- ① Press the **Power button** once, then select **Confirm** to turn off the projector.
- ② Switch off the **ON/OFF Switch** to **OFF**.

3. Battery

This projector is equipped with the built-in Li-ion rechargeable battery which can provide power supply to other mobile devices through the USB port when needed.

4. Charging

Fully Charged: LED Off

Charging: Blue LED

IMPORTANT:

- * To avoid turning on the projector accidentally which may lead to electrical fires, switch the ON/OFF Switch to OFF;
- * Do not use it as a projector and power bank at the same time;
- * Always connect your projector to power or charge it timely when the battery is low.

FOCUS AND KEYSTONE

Slightly adjust the focus ring on the projector to get the best image.

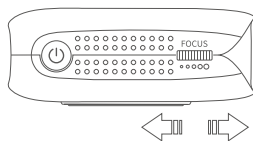

The projector supports automatic vertical Keystone correction within a degree of $\pm 40^\circ$.



WI-FI CONNECTION

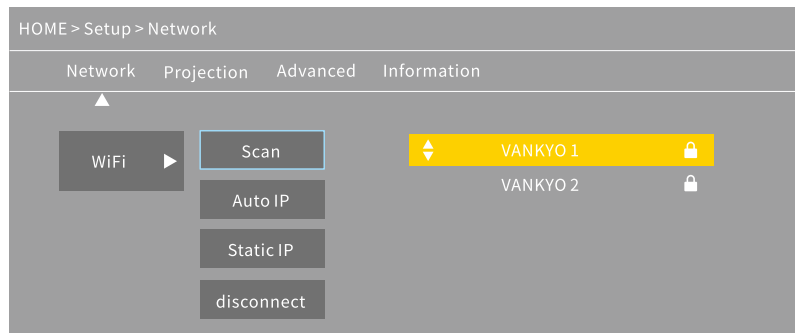

1. Go to **Homepage** > **Setup** > **Network** > **WiFi**, then select **Scan** to display the Wi-Fi list;
2. Press the **Up/Down** button to select your Wi-Fi, then press the **OK** button to continue;
3. Enter the correct password, then select **Confirm** to get Internet connection.

MULTIMEDIA CONNECTION

Projecting from a USB Disk

1. Turn on the projector and insert your USB disk into the USB port;
2. Go to **Homepage** to select **Media**, it will display an interface for projecting from a USB Disk.

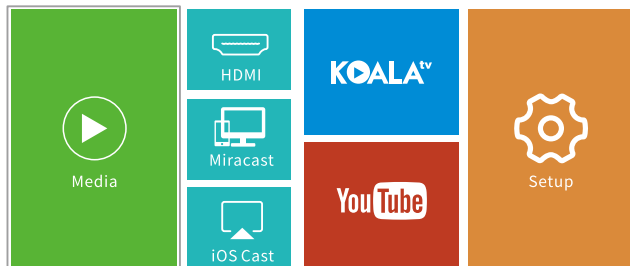

3. Select the category of the file you would like to project accordingly.

* To play the video, select **Movie**, then find your video file and play it by pressing the **OK** button. To watch 3D video, please press the **3D** button on the remote when playing it (3D video source is required and 3D glasses are not included).

* To play the audio file, select **Music** to find your audio file. Select it first by pressing the **OK** button, then select the **Play** option to start playing;

* To project photo, select **Photo**, then find your photo and play it by pressing the **OK** button;

* To project text, select **Text**, then find your text file and open it by pressing the **OK** button;

Different File Formats Supported

Text Format Supported: TXT

Image Format Supported: JPG/JPEG/BMP/PNG

Audio Format Supported: MP1/MP2/MP3/WMA/WAV/OGG/FLAC/AAC/M4A

Video Format Supported: MPEG1/MPEG2/MPEG4/H.264/MVC/H.263/DAT/MPG/VOB/TS/AVI/MKV/MP4/MOV/3GP/FLV

Projecting from HDMI Input Connection

1. Turn on the projector, then connect the projector to your device with the provided HDMI cable.
2. Go to **Homepage**, then select **HDMI** to project the contents from your device to the screen/wall.

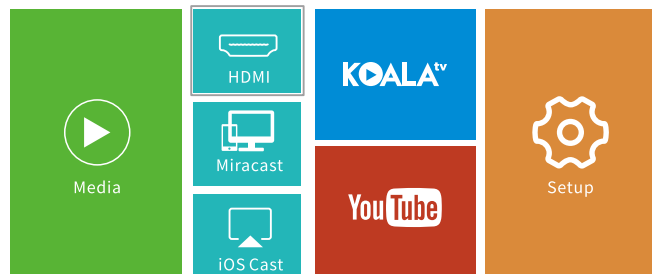

Play Videos in KOALA and YouTube

Go to **Homepage** > **KOALA/YouTube** to play videos after the projector is connected to your Wi-Fi.

Tip:

Press the **Menu** button on the remote to get back to the Home Page of **KOALA/YouTube**.



SCREEN MIRRORING

For iOS System

1. Connect your iOS device and the projector to the same Wi-Fi network;
2. Go to **Homepage** > **iOS Cast** to display the following interface;

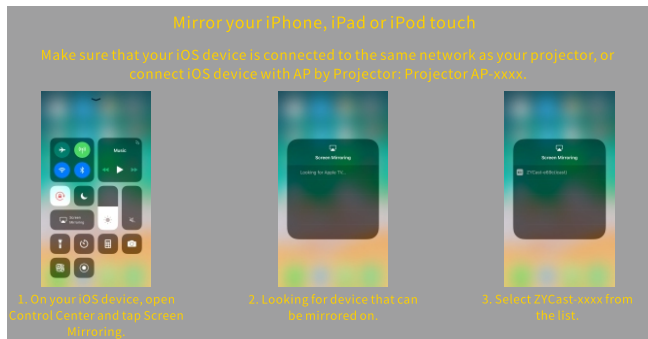

3. Swipe your iOS device up, then tap **Screen Mirroring/AirPlay Mirroring** and search for the projector;
4. Select **ZYCast-xxxx(icast)** from the searching list;
5. Your iOS device display will be projected on the wall/screen.

For Android system

To activate this function, please make sure your android device supports **Multi-screen/Wireless display**. Names may differ from different Android devices.

1. Turn the **Wi-Fi** to **ON** status in the settings of your Android device. To make a smoother streaming, please do not connect to any Wi-Fi on your projector;
2. Go to **Homepage > Miracast** to enter the following interface;



3. Activate **Multi-Screen** function in your Android device and search for the projector;
4. Select **ZYCast-xxxx(mcast)** from the searching list;
5. Your Android device display will be projected on the wall/screen.

SETTINGS

Go to **Homepage** > **Setup** to adjust the settings of your projector.

Network

Connect the projector to your Wi-Fi.

Projection

Set up brightness mode, brightness level, projection mode, Keystone configurations etc..

Advanced

Change language, update the firmware, select the boot channel, set up the sleep timer, make a factory restore, etc..

Information

Check the memory, software version, etc..

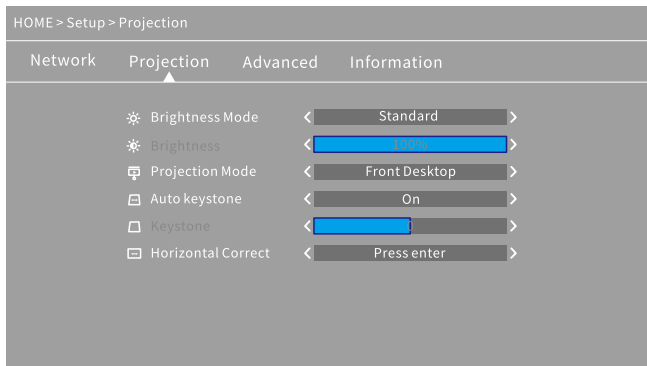

SPECIFICATIONS

Adapter Input	AC100V-240V, 50/60Hz
Adapter Output	DC 5V/3A
Ports	USB Port*1/HDMI In*1/Audio Out*1/DC In*1
Operating System	Linux
Wi-Fi	2.4G
RAM/ROM	256MB/1G bits
CPU	Mstar V66
Battery Capacity	5200mAh (Rechargeable Li-ion battery)
Display Technology	DLP
Light Source	LED
Resolution	Native 854 x 480
Projection Distance/Size	0.8-3M/30-110inches
Projection Mode	Front/Rear/Ceiling
Aspect Ratio	4:3/16:9
Keystone	Auto/Manual $\pm 40^{\circ}$
Focus	Manual

VANKYO SUPPORT



www.ivankyo.com



[@VankyoOfficial](https://www.facebook.com/VankyoOfficial)



[VANKYO](https://www.youtube.com/VANKYO)



North America support@ivankyo.com

United Kingdom support.uk@ivankyo.com

Deutschland support.de@ivankyo.com

France support.fr@ivankyo.com

España support.es@ivankyo.com

Italia support.it@ivankyo.com

日本 support.jp@ivankyo.com