

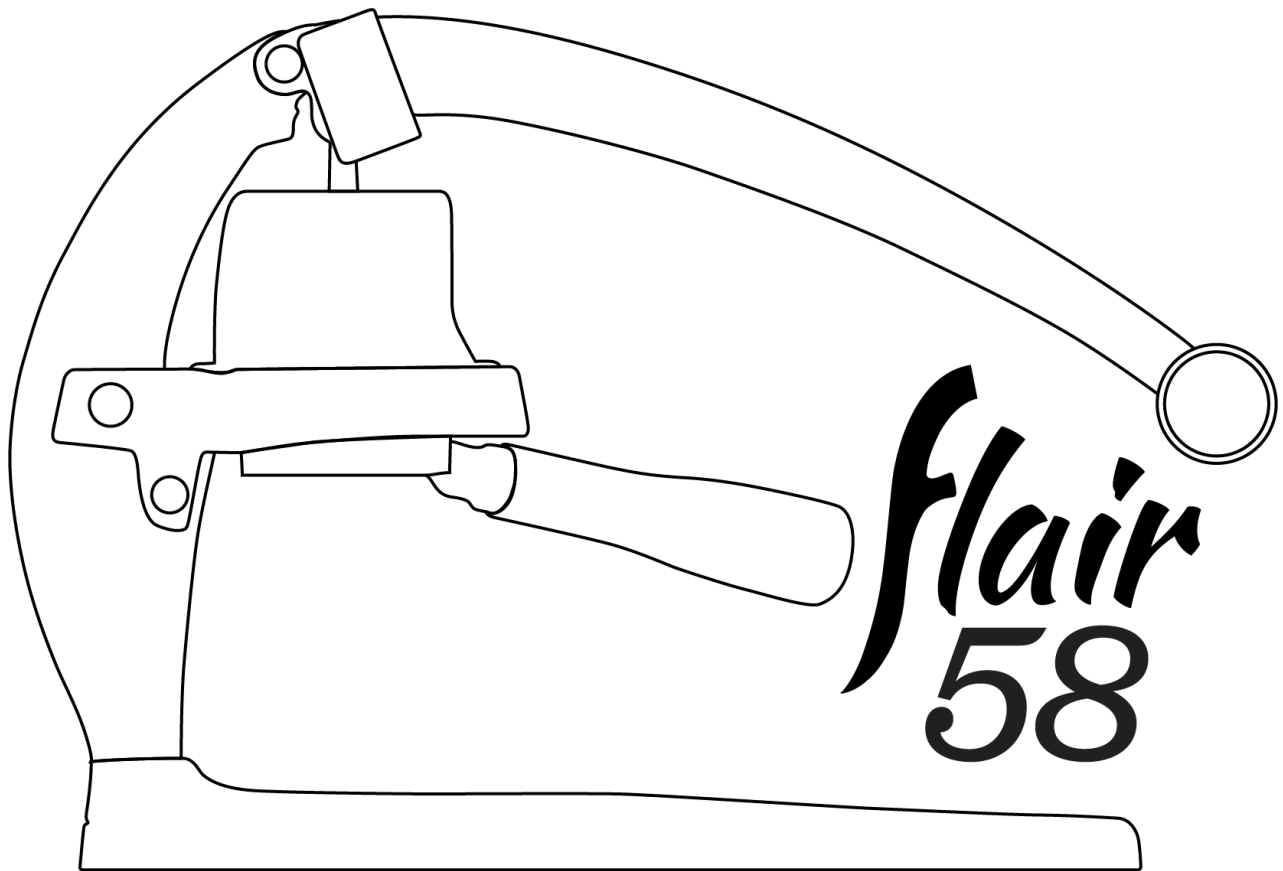

Flair 58

Preheat System Safety & Instructions Guide



Flair Espresso
28 Hammond Street, Suite B
Irvine, CA 92618
www.flairespresso.com - service@flairespresso.com



IMPORTANT SAFEGUARDS

When using electrical appliances, basic safety precautions should always be followed. This includes the following:

- Read all instructions.
- Do not touch hot surfaces. Use handles and silicone pads.
- To protect against fire, electric shock and injury to persons, do not immerse cord, plugs, base or brew head in water or other liquid, regardless if the cords are connected or plugged into an electrical socket.
- Never leave this appliance unattended while in use. Keep this appliance away from children's reach. Close supervision is necessary when this appliance is used near children to ensure that they do not play with this appliance.
- This appliance is not intended for use by persons (including children) with reduced physical, sensory, or mental capabilities, or lack of experience and knowledge, unless they have been given supervision or instruction concerning use of the appliance by a person responsible for their safety.
- Unplug from outlet when not in use and before cleaning. Allow to cool before putting on or taking off parts and before cleaning this appliance.
- Do not operate this appliance with a damaged cord or plug or after the appliance malfunctions or has been damaged in any manner. Email our customer service team for examination, repair or adjustment.
- Do not let cord hang over edge of table, or counter, or touch hot surfaces.
- A power-supply cord is provided to reduce risks resulting from becoming entangled in or tripping over a longer cord.
- Electric brew head must be used while installed on the portafilter base of the Flair 58 only. Before use, ensure the Flair 58 is on a flat and even surface. Do not place on or near a hot gas or electric burner, or in a heated oven, or on the top of other electric appliances.
- Always attach plug to appliance first, then plug cord into the wall outlet.
- To disconnect, push and hold main button until lights turn off, then remove plug from wall outlet.
- Do not use appliance for any purpose other than intended use.
- To avoid circuit overload, do not operate another high wattage appliance on the same circuit.
- Do not use the brew head to heat anything other than water. Do not overfill. If the cylinder is overfilled, boiling water may be ejected.
- Do not insert any object into slots or holes of the brew head.
- If the supplied cord is damaged, it must be replaced by the manufacturer, its service agent, or a similarly qualified person in order to avoid hazard.
- Do not use a longer detachable power-supply cord or extension cord.
- Never move the brew head or entire Flair 58 together while the unit is in use.
- To avoid burns and risk of personal injury, use extreme caution when dealing with hot water.
- Do not use the brew head if your hands are wet.
- Position the brew head properly on the portafilter base before connecting or switching on.
- Use the brew head and Flair 58 only with delivered power equipment. Do not use any other power or electrical equipment that was not delivered with your Flair 58. Use only the original, delivered Flair 58 power and electrical equipment.



WARNING: The appliance is very hot during use. Do not touch the surface of the brew head while in use or heated. Danger of burns!

WARNING: Never leave the brew head unattended while preheating water, especially if there are children nearby.

WARNING: Do not immerse or wash the entire brew head in water or any other liquid. This may cause electric shock or damage the appliance.

WARNING: Be careful when handling hot water. Danger of scalding!

TO PREVENT SCALDING: - Never move the Flair 58 while the preheat system is on and water is inside the brew head - Water can remain hot for a long time after preheating and can present a scalding hazard - Keep the Flair 58 and the brew head away from the edge of the work surface and out of the reach of children. Do not remove the brew head until it has fully cooled down.

Save these instructions.

CONTENTS OF THIS MANUAL

- **Flair 58 Preheat System Introduction**
- **Flair 58 Preheat System Parts**
- **Flair 58 Preheat System Setup**
- **Flair 58 Preheat System Use Instructions**
- **Flair 58 Preheat System Cleaning Instructions**
- **Flair 58 Warranty**

Introduction

Your Flair 58 comes equipped with a preheat system on the brewing head that allows users to maintain a constant preheat during and in-between shots of espresso. This Preheat System has three temperature tiers:

- **Low Heat – roughly 85° C (185° F)**
- **Medium Heat – roughly 90° C (194° F)**
- **High Heat – roughly 95° C (203° F)**

These temperature tiers are meant to loosely correspond to different roast levels: light, medium and dark but can be used as desired to dial-in your shot of espresso for the best taste experience. Your Flair 58 Preheat System is not meant to boil your water, and cannot be used for anything other than its intention of maintaining a constant temperature on your brew head for enhanced thermal control. In all cases, the initial temperature of your brew water should be managed with your kettle, prior to pouring into your Flair 58.

Further instructions can be found in our Quick Start Guide, provided with your Flair 58, or online at: <https://flairespresso.com/learn>. There you will find video guides as well as downloads that will aid you in any troubleshooting. As always, if you do experience any issues, please reach out to our customer support via the email address at the bottom of each page.



Preheat System Parts

1. Brew Head with four-pin (male) connector
2. Power Supply with a single-pin (female) connector
3. Preheat Controller with four-pin (female) and single-pin (male) connectors
4. Power Supply Extension Cord



Preheat System Setup

Setting up your Preheat system is a simple process of making the appropriate connections so power can be supplied to the brewing head.

1. Unpack and remove any and all protective plastic from parts received in your Flair 58 packing box
2. Ensure you have each of the four Preheat System parts as described, and shown, in the page above
3. Follow instructions to put together your Flair 58 base and lever, with the included screws
4. Add your Flair 58 Brew Head onto the portafilter base and lock into place by turning counter-clockwise (when locked, the Flair 58 logo should be facing front)
5. Connect the four-pin (male) connector on the brew head with the four-pin (female) connector on the Preheat Controller, by first aligning the tabs using the small arrows on each piece, and screw lock into place
6. Connect the single-pin (male) connector on the Controller to the single-pin (female) connector on the power supply
- WARNING: Always ensure the single pin connectors are UNPLUGGED before connecting or disconnecting the four-pin connectors.**
7. Ensure the Power Supply Extension Cord is plugged into the Power Supply
8. Plug Power Supply into outlet on the wall

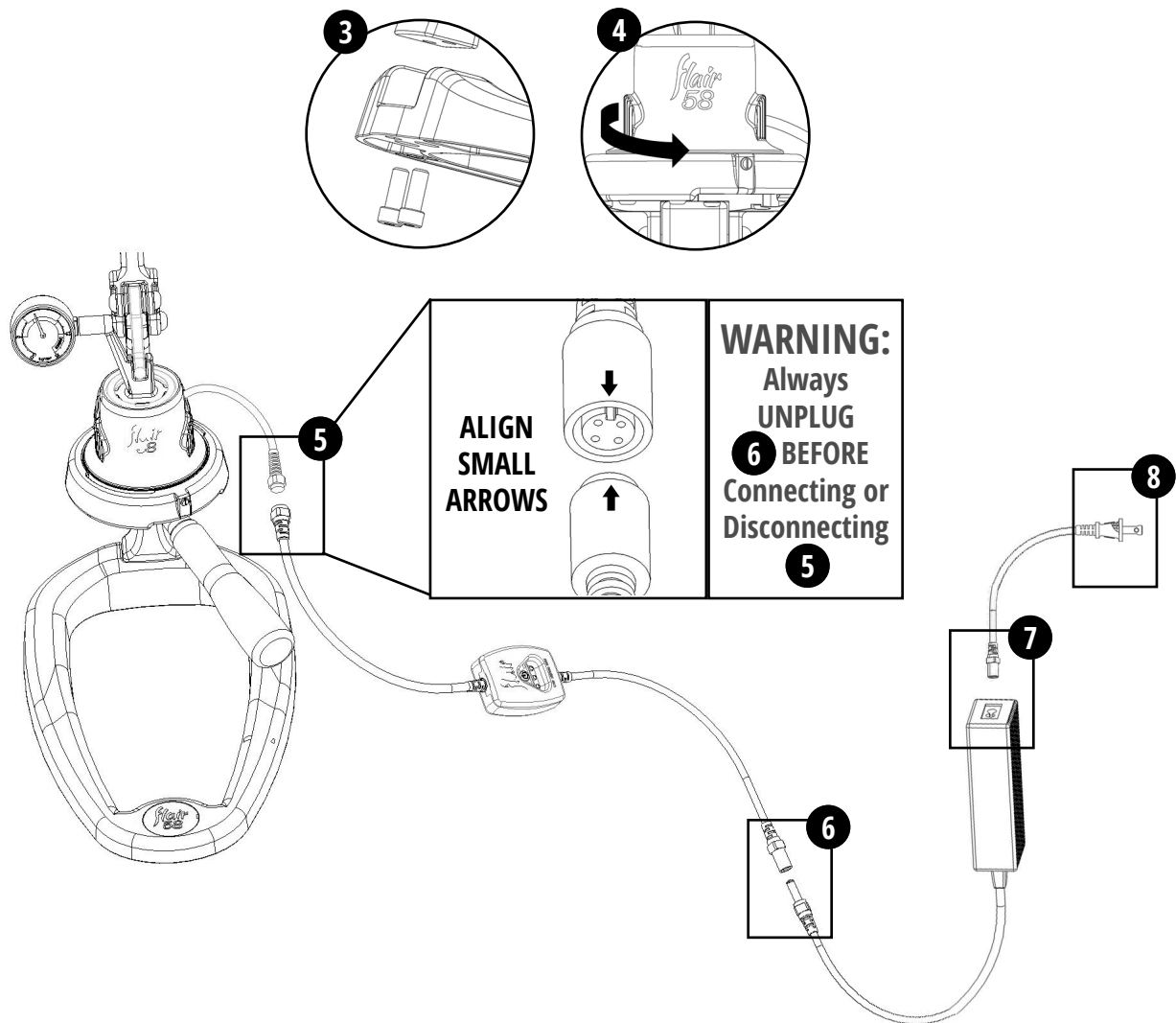



Preheat System Use Instructions

Before using the Preheat System it is important for each user to determine the level of preheat temperature they'd like: Low, Medium or High.

In addition, it is important to remember that the Preheat System is meant to maintain the temperature of the system while adding heated brew water. It is not intended to be used as a method to heat your brew water. The heating and management of your brew water's temperature should always be managed with your kettle.

The Controller has one singular button with three green indicator lights. These lights have three states each: off, blinking and solid on. The indicators of each of these states is listed below:

- **OFF** – This temperature level is off or inactive
- **BLINKING** – Indicates a heating stage
- **SOLID ON** – Indicates that the desired temperature has been reached

The three lights correspond to the different preheat temperature that has been selected: Low, Medium and High, from left to right across the controller. Directions for selecting and preheating to each level are below.

Low ~85° C (185° F)	Medium ~90° C (194° F)	High ~95° C (203° F)
TURN ON - Press & hold button until LEFT light starts BLINKING (3 seconds)	TURN ON - Press & hold button until LEFT light starts BLINKING (3 seconds)	TURN ON - Press & hold button until LEFT light starts BLINKING (3 seconds)
BLINKING LEFT light indicates that Preheat System is coming up to Low temperature	Immediately push button ONE more time – CENTER light will start BLINKING (LEFT light will turn SOLID)	Immediately push button TWO more times – RIGHT light will start BLINKING (LEFT & CENTER lights will turn SOLID)
After a few minutes, LEFT light will turn SOLID – This means Low temperature has been reached and is brew-ready	BLINKING CENTER light indicates that Preheat System is coming up to Medium temperature	BLINKING RIGHT light indicates that Preheat System is coming up to High temperature
	After a few minutes, CENTER light will turn SOLID – This means Medium temperature has been reached and is brew-ready	After a few minutes, RIGHT light will turn SOLID – This means High temperature has been reached and is brew-ready
TURN OFF - Press & hold button until ALL lights are OFF (3 seconds)	TURN OFF - Press & hold button until ALL lights are OFF (3 seconds)	TURN OFF - Press & hold button until ALL lights are OFF (3 seconds)

Once a temperature setting has been reached, the Preheat System will maintain that setting until turned off. In order to reduce the level of your preheat - from high to medium, or medium to low - simply use short presses of the button to quickly cycle through the various heat settings.



Preheat System Cleaning

Your Flair 58 Preheat system and brew head, if maintained correctly, will not require significant maintenance. For best results, all cleanings should be completed while the brew head is affixed onto the portafilter base of the Flair 58.

Please Note: The Preheat System must be turned off and allowed ample time (at least 15 minutes) to cool before any cleaning is attempted. Failure to allow the system to cool adequately can result in burns.

Cleaning should be completed with cool water only, and a clean damp cloth. No soaps or detergents are needed and may damage your Flair 58 and your Preheat System. Using soap can also impact the flavor of your espresso.

WARNING: Never immerse, submerge, or fully rinse the components of the Preheat System in water. Also ensure that the open connector points, both the four-pin and single-pin, male and female, are kept dry at all times. Failure to do this can damage the system and will void the warranty.

To clean your Preheat System, follow these simple steps:

1. Remove plunger by pulling it out with stem while brewing cylinder is installed on base
2. Use damp cloth to wipe the inside and bottom of the brew head. Also wipe the plunger.
3. For more thorough cleaning, place a cup beneath your Flair 58 and flush with cool water before wiping. This can be repeated multiple times to remove any coffee residue

Flair 58 & Preheat System Warranty

The Flair 58 Press Stand is warranted against functional defects for ten (10) years, from date of purchase, when used in accordance with all operating and safety instructions. The Flair 58 metal brew head components are warranted for five (5) years, from the date of purchase, when used in accordance with all operating and safety instructions. The electrical components of the Preheat System of the Flair 58 are warranted against functional defects for two (2) years from the purchase date, again when used in accordance with all operating and safety instructions. Parts that are more subject to normal wear and tear, such as O-rings, Silicone Sleeves, Piston, Tamper, Portafilter and Filter Basket are warranted against defects in material, design or workmanship for six (6) months from the purchase date, although these items are expected to last beyond the warranty.

Proof of purchase is required to validate the warranty period.

The warranty applies only when the product and parts are used in accordance with all operating instructions. The warranty does not include shipping costs. The warranty becomes void if we deem that the product or parts were modified, abused or improperly used, damaged by accident or neglect, or if any parts are improperly installed.

Intact Idea makes no other warranties, express or implied, and specifically excludes warranties of merchantability and fitness for a particular purpose. Intact Idea's liability under this warranty shall be limited to repair or replacement of the defective part(s), whichever may apply. Intact Idea shall not be responsible for any damages or personal injuries, whether incidental or consequential, or claims for such damages based on any legal theory, which may occur while using this product. This warranty gives you specific legal rights, and you may also have other rights which may vary from state to state and country to country.