

LIMITED WARRANTY:

Pulsar® products are guaranteed from manufacturer defects or malfunction from the original date of purchase for a period of 1 year. This limited warranty protects against manufacturer defects under normal use and does not apply to normal wear and tear, improper use, and accidental damage from dropping or submerging in liquid, improper cleaning, neglect, or any other damage that is not a result of defective materials or workmanship. If your device qualifies, we will replace, at our discretion and expense, any defective parts or materials. Purchaser must provide a copy of the original dated sales receipt and may be required to provide shipping to return defective parts or materials. We intend to complete all replacements within 7 business days, although this timeframe may vary depending on shipping, replacement part availability, or other related factors. The lawful and proper use of this device is a condition of sale. Any improper use of the device will void the warranty. Warranty is non-transferable. This warranty gives you specific legal rights, and you may also have other rights, which vary from state to state.

Sometimes, water and oil DO mix. Get twice the power in your pocket with dual cart technology.



DUAL AND SINGLE CART FUNCTION
Carts not included.



4-SETTING VARIABLE VOLTAGE WITH "SHIFT" BUTTON & AUTO-DRAW



INCLUDED ADAPTER WORKS WITH 14MM & 19MM FEMALE FITTINGS



FOR USE WITH THICK OILS



FAST USB-C CHARGING



15-SECOND PRE-HEAT

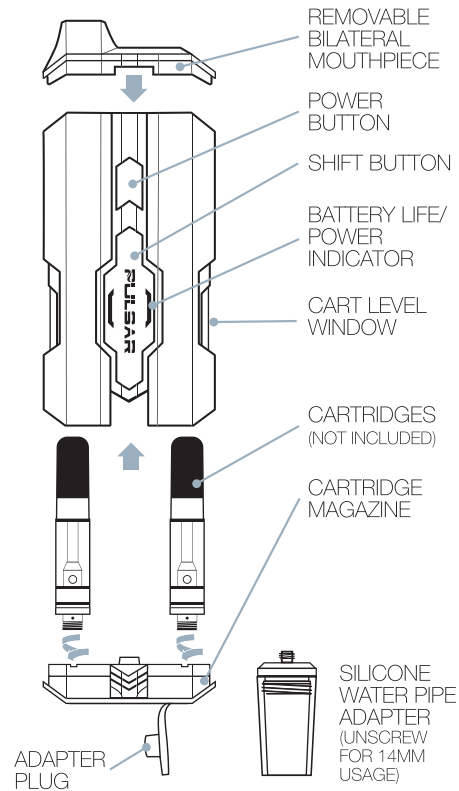

VOLTAGE SETTINGS:

Green - 2.8V

Blue - 3.2V

Yellow - 3.7V

Red - 4.2V

TECH SPECS:

Height 99mm

Width 47.5mm

Thickness 20mm

Max Cartridge Diameter 11.5mm

Accepts 1.0ml and 0.5ml Cartridges

Battery Capacity 650 mAh

15 Minute Auto-Shutoff

Input 5V 1A

PULSAR®
ENJOY HIGHER CULTURE™



PulsarVaporizers.com
#EnjoyHigherCulture

PU-0356-21

PULSAR®
DUPLO
CART H2O

14/19MM WATER PIPE COMPATIBLE THICK OIL VAPE

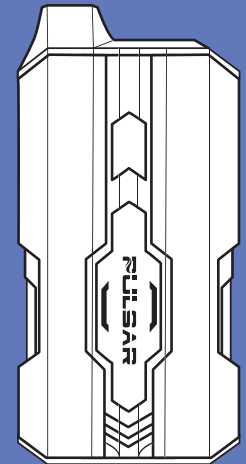

CHARGING THE DEVICE:

Plug in the USB-C charging cable provided into DuploCart H2O vaporizer and attach it to a 5V 1A charging brick. Do not let the vaporizer hang while charging as it could damage the charging port.

The LED strip will appear solid RED when charging, BLUE when device is at medium power, and turn solid GREEN when fully charged.

The device will fully charge in approximately 35–40 minutes.

HOW TO LOAD:

Remove the magnetic bottom Cartridge Magazine from the unit, and attach 1 or 2 cartridges to the device by screwing them into the 510 threaded connections turning clockwise until fit is snug (DO NOT OVERTIGHTEN CARTRIDGES).

Re-Insert the Cartridge Magazine back into the bottom portion of the unit. When inserted correctly, the indicator light will light up, signifying a connection. When only one cart is inserted, only that side of the DuploCarts indicator light will respond. (MAKE SURE THE MAGNETIC CONNECTION IS SOLID AND THE MAGAZINE IS SEATED PROPERLY).

HOW TO OPERATE:

Powering On - Click the POWER BUTTON 5 times to turn on.

Battery Level Check - Before the device is turned on, you can click the power button one time to view the device's battery level. Green signifies a full battery charge, Blue signifies a medium charge, and red signifies you should charge your battery.

Variable Voltage Settings - After powering on, select your voltage setting by pressing the power button 3 times. This action will cycle you through the 4 different voltage settings. Choose your setting at this time.

Mouthpiece - The mouthpiece on the DuploCart H2O is easily removable and swappable from the left or right side of the unit. Either side is transferrable, depending on your preference.

Operating the Vaporizer - The DuploCart H2O is designed to use one or two cartridges simultaneously or separately.

Single or Dual Cart Function - You can choose to load and operate only one cartridge in the DuploCart H2O, or load two cartridges and operate each independently.

To select which cartridge to operate, push the cartridge shift button. If you have 2 cartridges inserted, this button will help you shift from one cartridge to the other or operate both simultaneously. Follow the corresponding lighting to that particular side of the DuploCart H2O. Both lights present indicate both cartridges will operate simultaneously. If you only have 1 cartridge inserted, then only that side will light up and be available for use.

Preheat Function - If cold ambient temperatures cause cartridge contents to become more solid, the DuploCart H2O is equipped with a 15-second preheat mode to make oils more viscous for a better vaping experience. Preheat is recommended under these colder temperatures. To activate, make sure the device is turned on and press the power button 2 times. The LED band will flash a variety of colors for 15 seconds. When the flashing ends, your device is primed and ready to go.

Start Vaping - Once your desired voltage and cartridge setting is selected, then you are ready to start vaping.

Auto Draw Mode - The DuploCart H2O is enhanced with an auto-draw feature. Simply pull from the mouthpiece to start vaping. No

button press is required. During auto draw mode, when successfully implemented, you will see the lights on the light indicator light up when drawing from the unit. Some oils may be too thick to operate in auto draw mode. If you find this is true, please refer to button press mode.

Button Press Mode - Simply hold the unit to your lips and press the power button to start vaping. The indicator lights will be present when the button is pressed, and the color of the LED will signify your current voltage setting.

H2O MODE -

1. Pull open the Silicone Plug on the bottom of the unit.
2. Screw in FULLY ASSEMBLED water pipe adapter (do not overtighten) for 19mm pipes.
3. After inserted, you may unthread OUTER adapter for use with 14mm pipes.

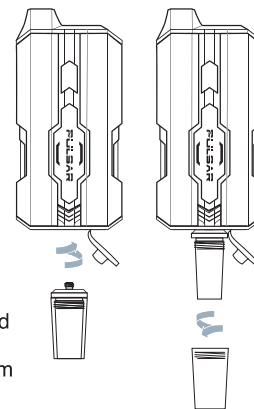

4. Place unit onto water pipe (use appropriate configuration for 14mm or 19mm female fittings).

5. Allow one preheat cycle to prime the cartridge(s).

6. Select your preferred heating mode.

7. Start your vaping session by pressing the power button and holding or pull to activate via the auto draw feature. Auto draw will activate automatically.

HOW TO CLEAN:

1. Unscrew cartridges from the bottom magazine.
2. Wipe cartridge ports clean with 91% isopropyl alcohol using a dampened cotton-tip swab.
3. Wipe any excess oil around the cartridge port and also from the bottom of the cartridges.
4. Reassemble unit for use.