

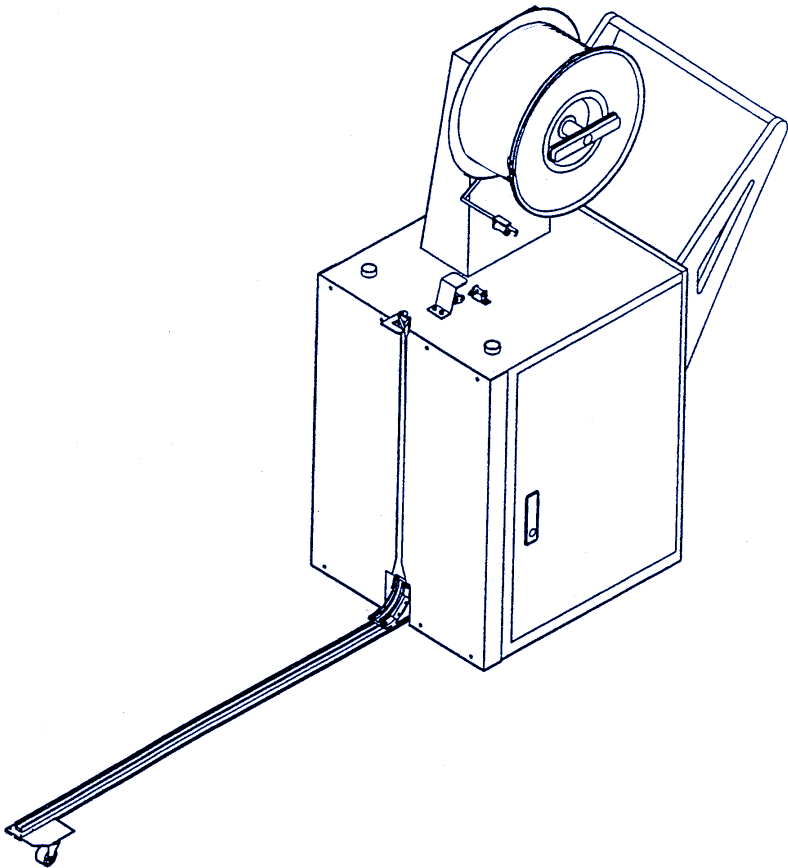

5SECONDS™ 1SYS505 SEMI AUTO PALLET STRAPPING MACHINE

Important Safety Information

USER MANUAL



5Seconds™ 1SYS505 SEMI AUTO PALLET STRAPPING MACHINE

SAFETY INSTRUCTIONS

This manual gives you information on safety instructions, specifications, operation and maintenance of your strapping machine.

Before operating or servicing the machine, please read the following safety Instructions carefully.

BEFORE MACHINE OPERATION

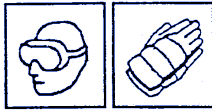

- * Read the operating instructions.
- * Wear eye (or face) and hand protection.
- * Check the voltage and use the specified electric power to insure proper operation of the machine.
- * Check that all guards are in place and all safety devices are working properly.
- * Do not operate machine with any safety devices removed.
- * Make sure machine is clear of all tools, debris, and other objects not related to machine function.

DURING MACHINE OPERATION

- * Follow the instructions provided in this manual.
- * Never put any part of your body near, under or into a moving machine.
- * Keep hands out of the strap chute area.
- * Only trained persons should operate the machine, even though operation is simple and easy.
- * Do not strap any part of your body.

AFTER MACHINE OPERATION

- * Remove all tools, debris and other objects from machine area.
- * Shut off all electric and air power and make sure that the electric power is off.

MACHINE MAINTENANCE

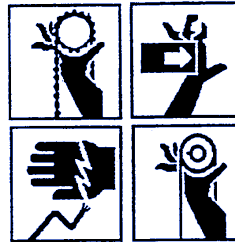

- * Shut off and lock out all electric and air power.
- * Do not stand or walk on the conveyor to service the machine.
- * Follow the maintenance instructions in this manual.
- * Use the correct tools and parts to repair the machine.

ADDITIONAL CONSIDERATIONS

- * To insure proper operation of machine use the specified electric or air power sources.
- * Do not attempt to change machine design unless written approval is received from our company.
- * Additional safety instructions are located throughout this manual. They serve to warn the operator and serviceman about potentially hazardous situations.

SIGNS

- * Read all of the signs on the machine.
- * Do not remove any signs from machine.
- * Replace all missing or damaged signs.

5Seconds™ 1SYS505 SEMI AUTO PALLET STRAPPING MACHINE

INDEX

| | PAGE |
|---|-------|
| PREFACE | 1 |
| SPECIFICATIONS | 2 |
| OPERATION BOARD | 3 |
| OPERATION PROCEDURE | 4 |
| MAJOR COMPONENT AND STRUCTURE | 5 |
| INSTALLATION & SETTING P.P STRAP PROCESS | 6-7 |
| TENSION ADJUSTMENT | 8 |
| ELECTRICAL CONTROL UNIT | 9 |
| TEMPERATURE ADJUSTMENT | 10 |
| FORWARD AND REVERSE FEEDING STRENGTH ADJUSTMENT | 11 |
| PROXIMITY SWITCH ADJUSTMENT | 12 |
| EASY TROUBLE-SHOOTING GUIDE | 13-14 |
| PROPER P.P STRAP ALIGMENT | 15 |
| SYMBOL OF ELECTRIC ACCESSORY OF DRIVE UNIT | 16 |
| CIRCUIT DIAGRAM | 17-19 |
| PART LISTS | 1- 28 |

5Seconds™ 1SYS505 SEMI AUTO PALLET STRAPPING MACHINE

MACHINE ASSEMBLY

NOTE:

The dispenser and handle was disassembled from the body to prevent machine from damage during the transportation. Customers should assemble them back before operation.

HANDLE ASSEMBLY

1. Please release all the screws and washers (4 sets) from the frame body. (Ref. Fig.A-1).
2. Connect the handle with machine by screws and washers and please check again if the handle is firmly installed on the machine.

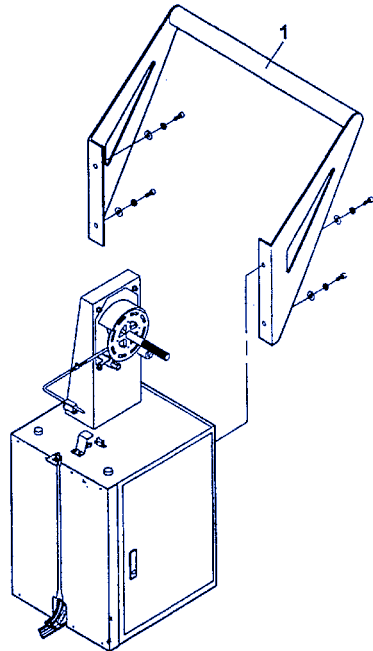

FIG.A HANDLE ASSEMBLY

DISPENSER ASSEMBLY

1. Please release all the screws and washers (4 sets) from the base-disc of dispenser.
2. Assembly the left Dispenser disc (Ref. Fig.B-1) with Coil base (Ref. Fig.B-2) and firmly connect them by screws and washers when a strap coil was installed.

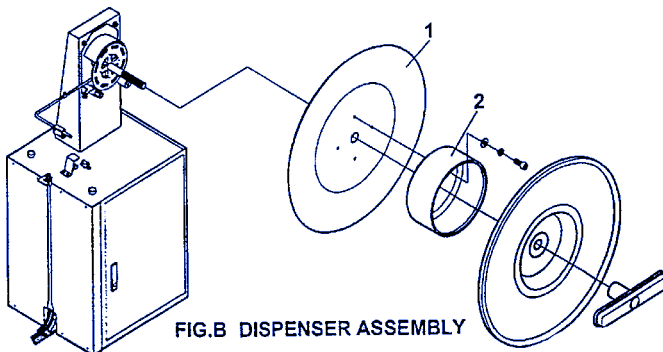

FIG.B DISPENSER ASSEMBLY

5Seconds™ 1SYS505 SEMI AUTO PALLET STRAPPING MACHINE

PREFACE

Thank you for purchasing your new strapping machine. This machine has been designed by our engineering staff to provide you with the newest in modern strapping system technology.

The system with its strong yet lightweight construction has been designed to minimize maintenance and give you trouble-free operation for many years when operated properly in accordance with the instructions in this manual.

We ask you to read the instructions in the manual carefully and to regularly keep your machine clean and follow the maintenance instructions here in to guarantee and prolong the life of the machine.

Please check to see that all of the following accessories are supplied with your machine.

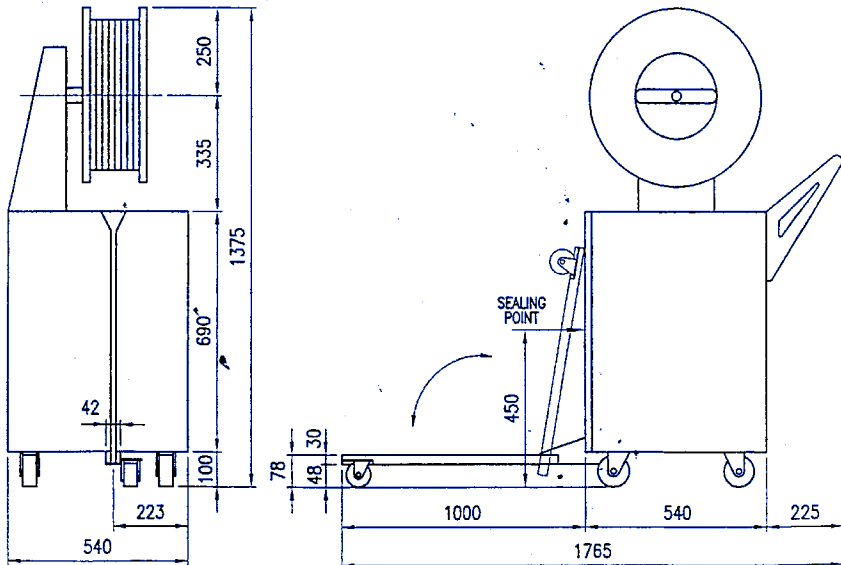

FIG.1 SPECIFICATIONS

5Seconds™ 1SYS505 SEMI AUTO PALLET STRAPPING MACHINE

SPECIFICATIONS

| NO | DESCRIPTION | STANDARD TYPE | |
|-----|----------------|--|------|
| 1-1 | DIMENSIONS | LENGTH | 830 |
| | | WIDTH | 550 |
| | | HEIGHT | 1390 |
| 1-2 | SEALING METHOD | HEAT SEAL | |
| 1-3 | STRAP WIDTH | 9, 12, 15, 19mm | |
| 1-4 | SPEED | 5 SEC./ STRAP | |
| 1-5 | TENSION | 70KGS | |
| 1-6 | POWER SUPPLY | 1Ø 110V/ 220V/ 50/ 60 HZ 3Ø 380V/ 220V/ 50/ 60 HZ | |
| 1-7 | PACKING SIZE | MIN. 550Hmm 21" MAX. 1000Lmm 39" | |

Supplies and Consumption

(a) Electricity

Voltage: 110V / 220V / 380V

Frequency: 50 / 60 Hz

Main breaker: 25A / 16A / 10A

Wire size: 2.0mm

Power consumption: 0.5 kW

(b) Spring Parts

0721-00 FEED SPRING

0916-00 ARCH FLAP SPRING

0616-02 TENSION ARM SPRING

1125-02 BRAKE ARM SPRING

(c) Belt Parts

0121-23A V-BELT 260J6

0120-07 V-BELT M-24 (J)

5Seconds™ 1SYS505 SEMI AUTO PALLET STRAPPING MACHINE

OPERATION BOARD

- (1). **POWER SWITCH:** This is the main power switch on the machine. Electrical power supply to the machine from the power source is controlled through this switch.
- (2). **FEED TIMER:** This switch is used to adjust the length of the P.P strap.
- (3). **RESET BUTTON:** Push this at first time to reverse strap back out from the roller, push this button at second time to let the cam return "Zero" point.

CAUTION: EVERY TIME WHEN PUSHING "RESET" BUTTON, PLEASE ROTATE THE STRAP REEL AND WITHDRAW STRAP AND THEN RE-THREAD STRAP WHEN PREPARING ANOTHER STRAPPING ACTION.

- (4). **FORWARD:** The feed-button is for manually feeding strap to get a proper length for strapping.

※ If you shut down the system then turn it on again. It is necessary to push "RESET" button and make the machine stand-by. Otherwise a threading problem will be occurred and the machine will be unable to thread strap.

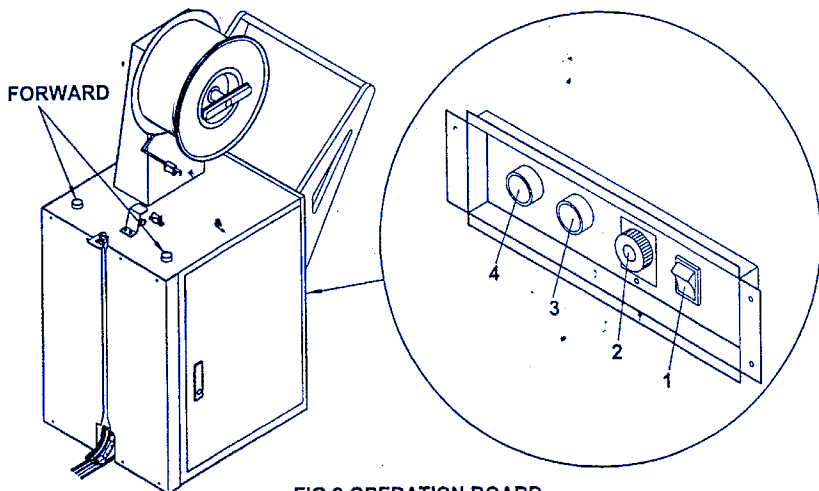

FIG.2 OPERATION BOARD

5Seconds™ 1SYS505 SEMI AUTO PALLET STRAPPING MACHINE

OPERATION PROCEDURE

- (1). Push the machine close to the palletized packages and thread the ARCH GUIDE through the pallet till the guide end appear out from the pallet. Keep the package very **CLOSE** and **FIRM** on the strapping table of machine.

CAUTION: IF THE CLEARANCE IS TOO WIDE BETWEEN PACKAGES AND THE STRAPPING TABLE WILL CAUSE FAILURE OF STRAPPING.

- (2). Manually **INSERT** the strap end into the strap guide insertion to activate the strapping cycle.

- (3). When the strapping cycle is activated, the system will be completed and automatically ready for another strapping application.

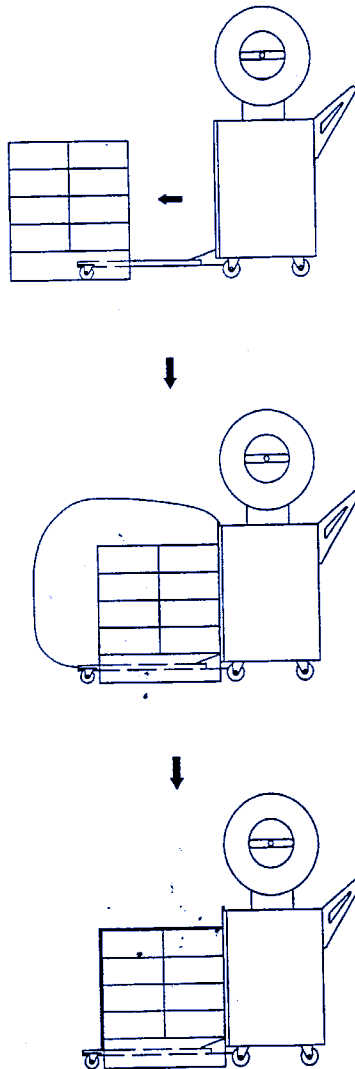

FIG.3 OPERATION PROCEDURE

5Seconds™ 1SYS505 SEMI AUTO PALLET STRAPPING MACHINE

MAJOR COMPONENT & STRUCTURE

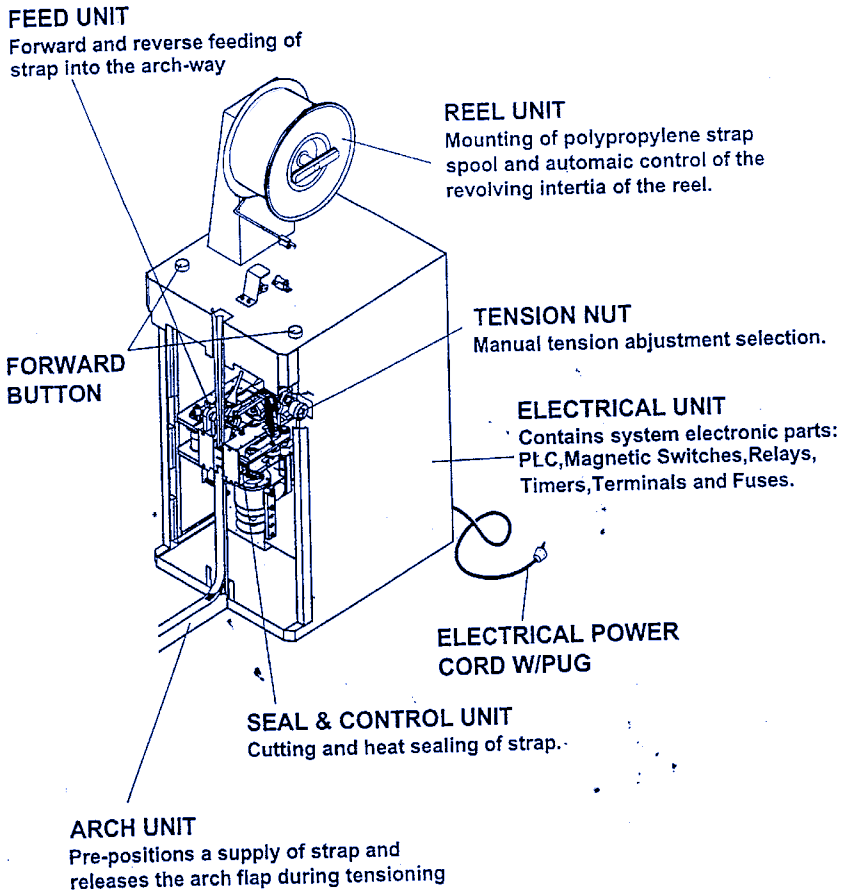

FIG. 4 MAJOR COMPONENT & STRUCTURE

5Seconds™ 1SYS505 SEMI AUTO PALLET STRAPPING MACHINE

INSTALLATION & SETTING PROCESS OF P.P STRAP

WARNING !

Please turn off the power switch before setting the P.P. strap. Then open the right-hand door and install P.P. strap according to the following procedure.

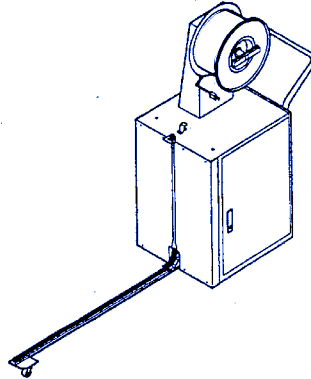

SETTING STRAP 1

Remove the packing paper on the P.P. strap coil. Refer to the drawing below to install the strap coil onto the inner dispenser disc (FIG.5.A) and tighten the dispenser outer disc (FIG.5.B) locking knob(FIG.5.C) against the coil. Cut the packing strings(FIG.5.D) if any on the P.P. strap coil.

SETTING STRAP 2

Pull a sufficient amount (about 100cm) of P.P. strap from the coil and thread it through Brake Roller(FIG.5.1), and Roller(FIG.5.2) to the Pool Box Entrance Roller(FIG.5.3).

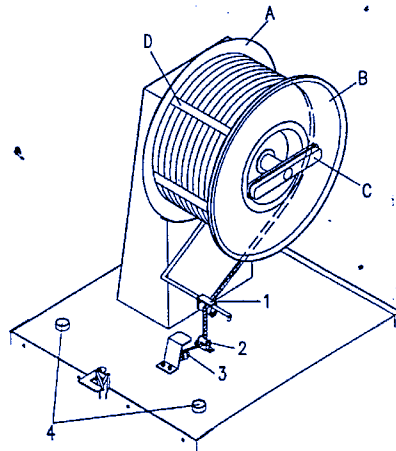

FIG. 5 SETTING STRAP PROCESS

5Seconds™ 1SYS505 SEMI AUTO PALLET STRAPPING MACHINE

SETTING STRAP 3

Release the rollers by pushing the Upper Roller Grip (FIG.6.2) Thread the strap tip through the Tension Arm (FIG.6.1) between Feed Rollers (FIG.6.3) and (FIG.6.4) until the strap stays in the Feed Shooter (FIG.6.5). The setting (threading) process is now finished and please close the cabinet door of the machine.

Release the Strap Guide from the angle plate and turn on the power switch. Press the "Forward" feeding switch (Ref. FIG.5.4) on top of each side of machine to feed proper length of strap out from the strap guide. The machine is now ready for strapping.

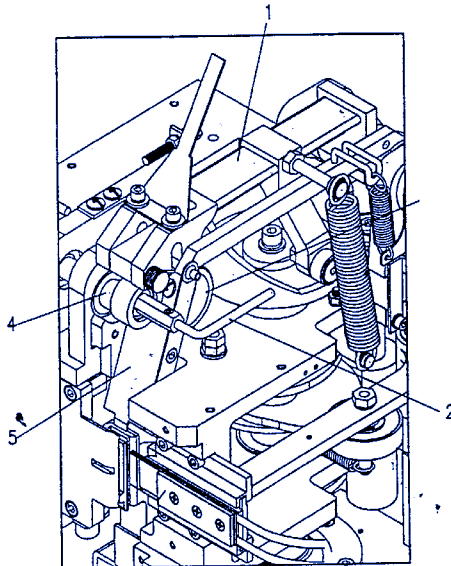

FIG. 6 SETTING STRAP PROCESS

5Seconds™ 1SYS505 SEMI AUTO PALLET STRAPPING MACHINE

TENSION ADJUSTMENT

When doing tension adjustments, open the right-hand door of machine and then gently pull up the Tension Selecting Dial (FIG.7.1). Turn the dial left or right for desired tension strength to your strapping packages.

When the strapping strength is set, push the dial back to secure your setting.
(NOTE: Try degree "5" at first strapping then making necessary adjustment with reference to your packaging material).

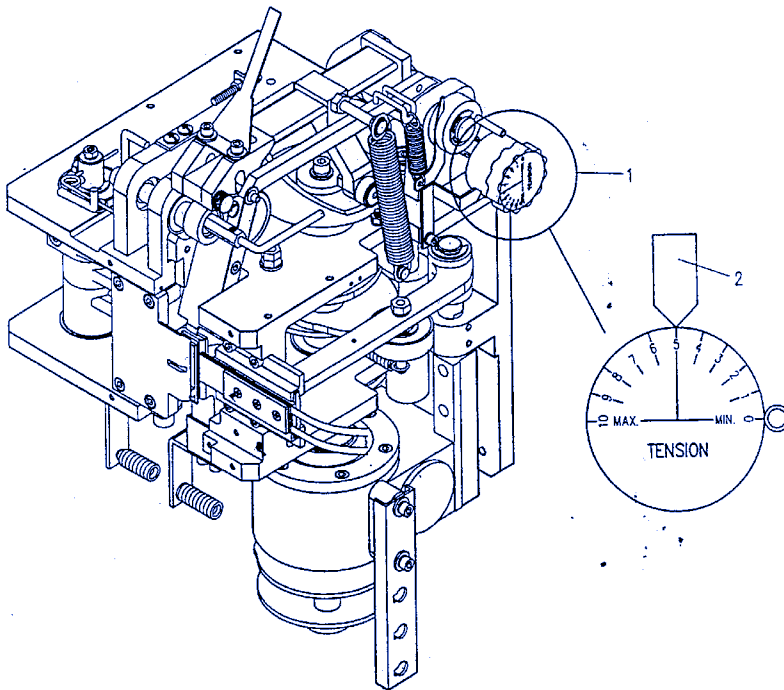

FIG. 7 TENSION ADJUSTMENT

5Seconds™ 1SYS505 SEMI AUTO PALLET STRAPPING MACHINE

ELECTRICAL CONTROL UNIT

MG1 : Controls Timing Motor

MG2 : Controls Forward & Reverse Feed Motor

OVERLOAD SW-1 : Thermal Relay.

Setting 5.5 ~ 8A if the voltage is 220V/1PH

Setting 2.5 ~ 4A if the voltage is 220V/3PH.

Setting 9 ~ 13A if the voltage is 110V/1PH

Setting 1.6 ~ 2.5A if the voltage is 380V/415V/3PH

OVERLOAD SW-2 : Thermal Relay.

Setting 2.5 ~ 4A if the voltage is 220V/1PH and

Setting 1.6 ~ 2.5A if the voltage is 220V/3PH.

Setting 5.5 ~ 8A if the voltage is 110V/1PH and

Setting 1.6 ~ 2.5A if the voltage is 380V/415V/3PH.

NOTICE: When you find either the Timing Motor MG1 or Feeding Motor MG2 switches have tripped due to overload current. Do as following to reset the system.

1. Turn off the system "POWER"
2. Wait "15" seconds and then push the "RESET" button.
3. Turn the "POWER" back on.

A) When the PLC is turned on the POWER and RUN lamps will keep lighting up.

B) When the PROG/ C.P.U.E lamp twinkling, it shows there program is irregular.

C) When the PROG/ C.P.U.E lamp keep lighting, it shows the CPU is out of order.

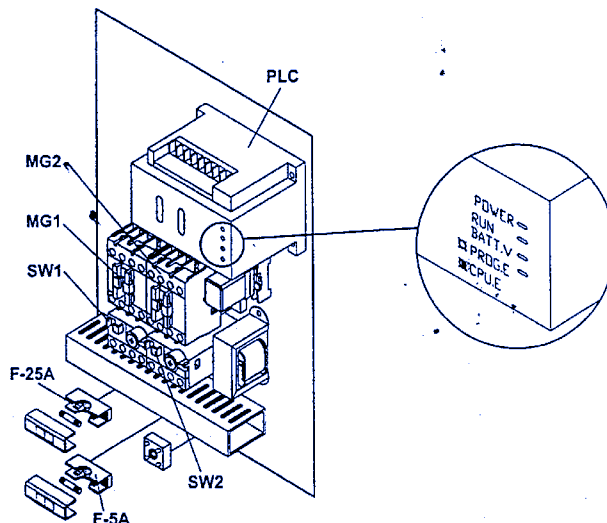

FIG.8 ELECTRICAL CONTROL UNIT

5Seconds™ 1SYS505 SEMI AUTO PALLET STRAPPING MACHINE

TEMPERATURE ADJUSTMENT

Please allow approximately 2 minutes for the heater blade to reach the working temperature after initial Power-ON of machine.

The primary set-up of heater temperature in the factory is 2 under max setting and that is suitable for the working place on most environments.

In certain areas where the ambient working environment temperature is extreme, adjustment of the Temperature Adjusting Dial may become necessary.



FIG. 9 TEMPERATURE ADJUSTMENT

5Seconds™ 1SYS505 SEMI AUTO PALLET STRAPPING MACHINE

FORWARD & REVERSE FEED ROLLER GAP ADJUSTMENT

The roller gap setting on the forward and reverse feeding strength in the factory is for strap Thickness between 0.55mm +/- 0.10mm (normal size). If your strap in use is out of this range, please take the following steps to adjust the roller gap.

1. Insert strap between Feed Roller (FIG.10-1.0704-00) and Upper Feed Roller (FIG.10-2.0703-00) on the Feed Shooter (FIG.10-1.0710-00).
2. If the clearance is too much or too little, loosen 2 bolts (FIG.10-2.1) holding The RH Block Arm (FIG.10-2.2). The Press Arm Shaft (FIG.10-2.3) then moves easily.
3. Adjust the clearance between 0.5 to 1mm depends on the thickness of your strap at Upper Roller Spring (FIG.10-2.4) and Upper Roller Weight Adj. (FIG.10-2.5) in the circle shows.

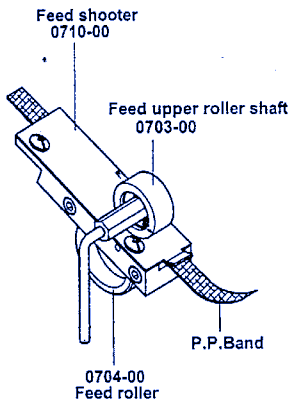

FIG.10-1 SHOOTER

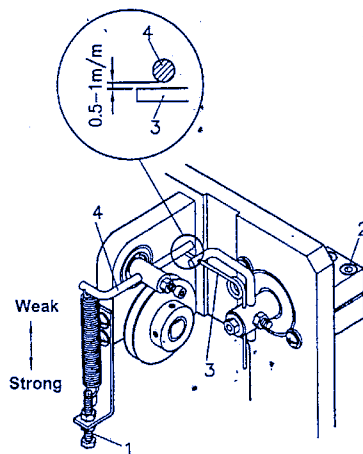

FIG.10-2 PRESS ARM SHAFT

5Seconds™ 1SYS505 SEMI AUTO PALLET STRAPPING MACHINE

PROXIMITY SWITCH ADJUSTMENT

There are three proximity switches on the left side of the reduction gear. They are used to determine the accurate position of the Cam to the Cam Follower during machine operation. At installations where there is insufficient or poor power supply to the system there arises the need to re-adjust the pre-set positions of the LS Cam to the Proximity Switch.

The red lamp on the proximity switch is "ON" when the switch is activated.

LS-1 RETURN ZERO PROXIMITY SWITCH

1. When LS-1 is activated the Cam Follower should be in the position of the Tension Cam as shown in Fig. A-A. The system is in Return Zero condition.

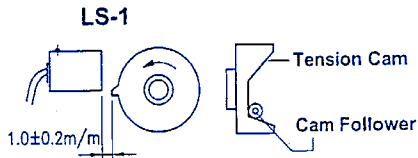

FIG. A

FIG. A-A

LS-2 FORWARD & REVERSE FEED PROXIMITY SWITCH

1. When LS-2 is activated the Cam Follower should be in the position of the Tension Cam as Shown in Fig. C-C. In this position proper forward feed occurs.
2. If the position of the LS-2 and the LS-2 Cam are not the same as in Fig. B then forward feed problems will occur. Adjustment of LS-2 Cam position is then necessary.
3. When LS-2 is activated the Cam Follower should be in the position of the Tension Cam as shown in Fig. C-C. In this position proper reverse feed occurs.
4. If the position of the LS-2 and the LS-2 Cam are not the same as in Fig. C then reverse feed problems will occur. Adjustment of LS-2 Cam position is then necessary.

LS-2

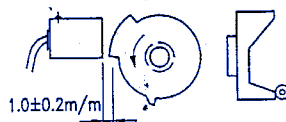

FIG. B

FIG. B-B

LS-2

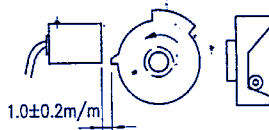

FIG. C

FIG. C-C

FIG. 11 PROXIMITY SWITCH ADJ.

5Seconds™ 1SYS505 SEMI AUTO PALLET STRAPPING MACHINE

EASY TROUBLE-SHOOTING GUIDE

**CONDITION (A) : AFTER THE SETTING STRAP PROCESS
THE P.P. STRAP RETURNS TO THE TENSION
ARM WITHOUT FEEDING STRAP.**

Reason

1) The setting strap process was done incorrectly not allowing the end gripper to grip the end of the P.P. strap properly.

2) The P.P. strap is of poor quality or has a curve of over 5mm per meter.

3) Proximity Switch and Cam adjustment are incorrect.

4) The inner part of the Feed Shooter is worn causing erratic and or delayed strap feed.

Solution

1) Refer to the installation of P.P. strap and setting strap process.

2) Replace with good P.P. strap.

5) Refer to page 12 Proximity Switch Adjustment.

6) Replace the Feed shooter.
(Part No. 0710-00)

**CONDITION (B) : REVERSE FEED OCCURS OR THE P.P. STRAP IS CUT
WITHOUT TIGHTENING.**

Reason

1) Reverse Feed Tension Adjustment is incorrect.

2) Proximity Switch and Cam Adjustment are incorrect.

3) The inner part of the Feed Shooter is worn causing erratic and or delayed strap feed.

Solution

1) Refer to page 10

2) Refer to page 12.
Proximity Switch Adjustment.

3) Replace the Feed Shooter.
(Part No. 0710-00)

5Seconds™ 1SYS505 SEMI AUTO PALLET STRAPPING MACHINE

CONDITION (C) : P.P. STRAP CANNOT BE BANDED TIGHTLY.

Reason

1) The Tension Jaw is worn.

Solution

1) Replace the Tension Jaw.
(Part No. 0606-01)

CONDITION (D) : MOTOR, M1 AND M2 ARE NOT FUNCTIONING.

Reason

1) The motor is faulty

2) When the amperage to the motor exceeds pre-set limitations the protective breaker will be activated.

Solution

1) Replace motor.

2) Refer to the Electric Control Box capital (page 8).
(a) Press the reset button to recover power supply.
(b) Check voltage source. If the voltage is too low, it will cause high electric current. Please re-adjust the electric current of Overload SW-1 or SW-2.

5Seconds™ 1SYS505 SEMI AUTO PALLET STRAPPING MACHINE

PROPER P. P. STRAP ALIGNMENT

NOTE: PLEASE DO AS FOLLOWING STEPS TO ADJUST THE ALIGNMENT OF THE P. P. STRAP WHEN IT IS NOT CONNECTED UNIFORMLY (REFER TO THE DRAWING BELOW).

CONDITION A :



STEP 1 : Loosen the Hex. Nut of RH. Band Way and then move the RH. Band Way forward till the strap is uniformly sealed.

STEP 2 : Tighten the Hex. Nut to secure the adjustment.

CONDITION B :

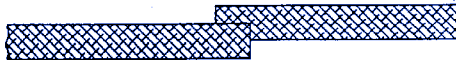

STEP 1 : Loosen the Hex. Nut of RH. Band Way and then move the RH. Band Way backward till the strap is uniformly sealed.

STEP 2 : Tighten the Hex. Nut to secure the adjustment.

Also, adjust the bandwidth block and to match the P.P width plus 0.5mm of clearance after the previous 2 steps is made. To adjust the bandwidth block, please do as following steps:

- (1). Loosen the socket screw on the strap head block.
- (2). Adjust the bandwidth block to match the strap width plus 0.5mm.
- (3). Tighten the socket screw to secure the adjustment.

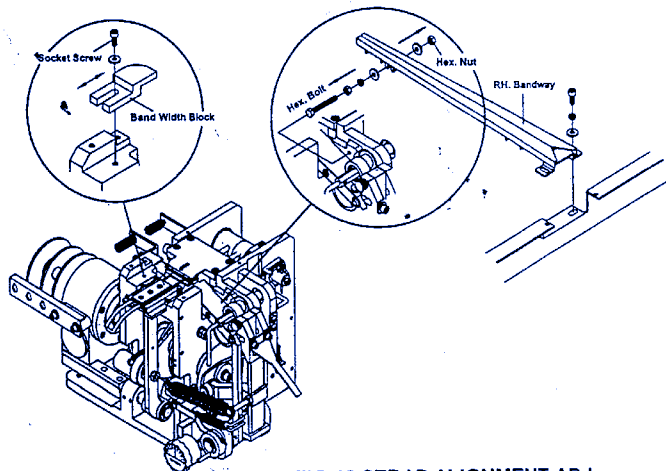
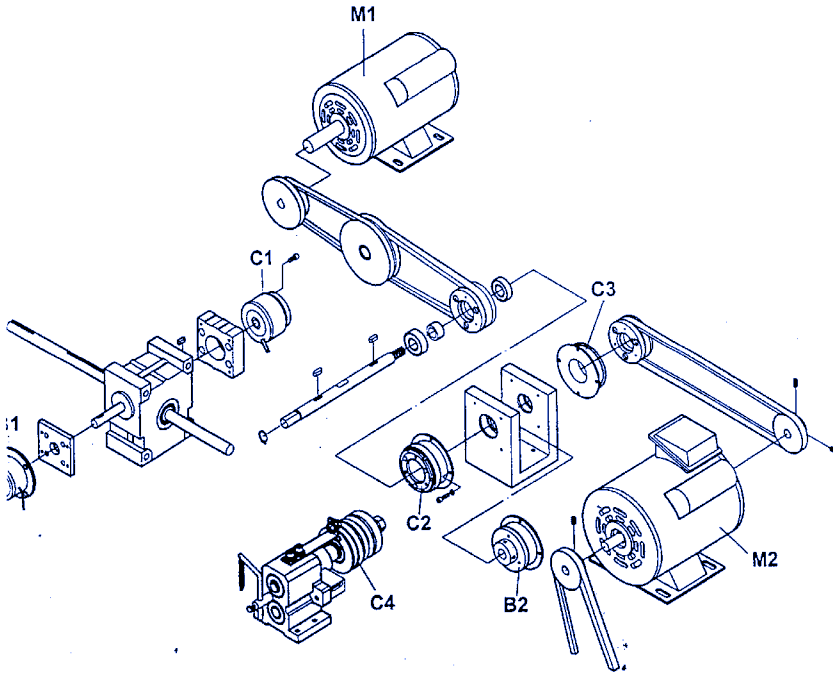

FIG. 12 STRAP ALIGNMENT AD. I

5Seconds™ 1SYS505 SEMI AUTO PALLET STRAPPING MACHINE

SYMBOL OF ELECTRIC ACCESSORY OF DRIVE UNIT



SYMBOL LIST OF DRIVE UNIT

| SYMBOL | DESCRIPTION |
|--------|--|
| M1 | Timing Motor 1/2HP Single Phase/ Three Phase |
| M2 | Pool Motor 1/3HP Single Phase/Three Phase |
| C1 | Reducer Clutch 0.6K 24DC |
| C2 | Forward Feeding Clutch 0.6K 24DC |
| C3 | Reverse Feeding Clutch 0.6K 24DC |
| C4 | Pool Clutch 0.6K 24DC |
| B1 | Reducer Brake 0.6K 24DC |
| B2 | Forward & Reverse Feeding Brake 0.6K 24DC |

5Seconds™ 1SYS505 SEMI AUTO PALLET STRAPPING MACHINE

ELECTRICAL SCHEMATIC

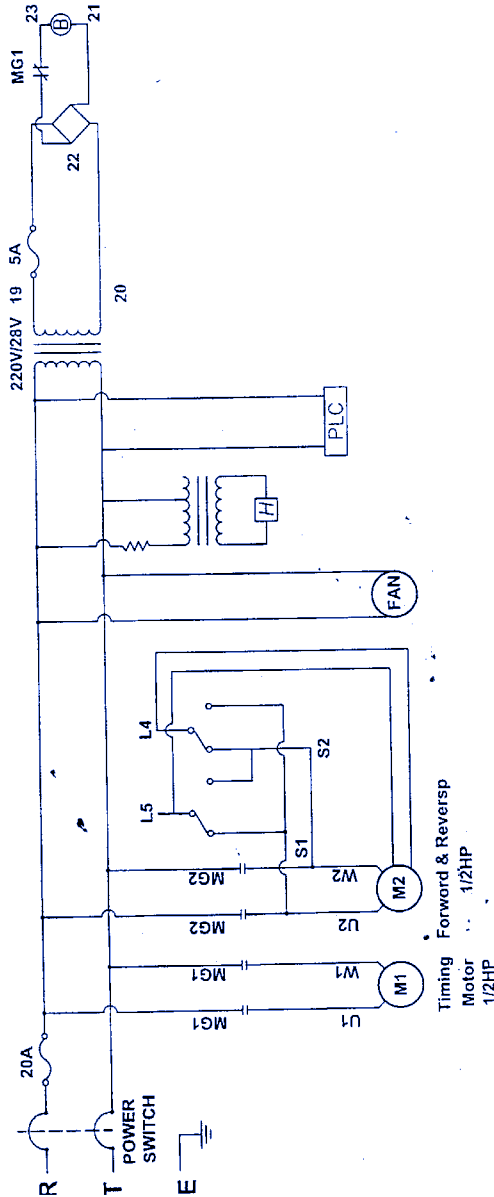

5S\NORMAL\85PS\001 2001/4/20

5Seconds™ 1SYS505 SEMI AUTO PALLET STRAPPING MACHINE

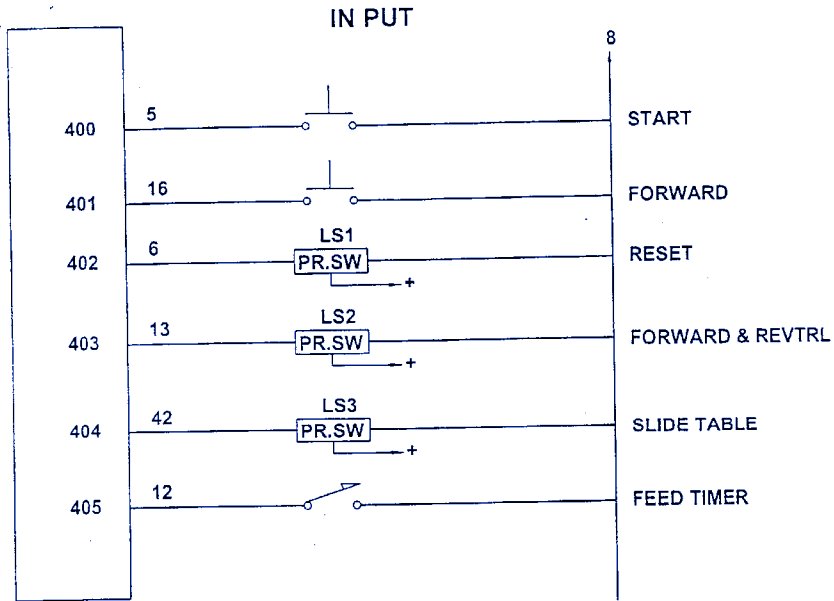

5Seconds™ 1SYS505 SEMI AUTO PALLET STRAPPING MACHINE

OUT PUT

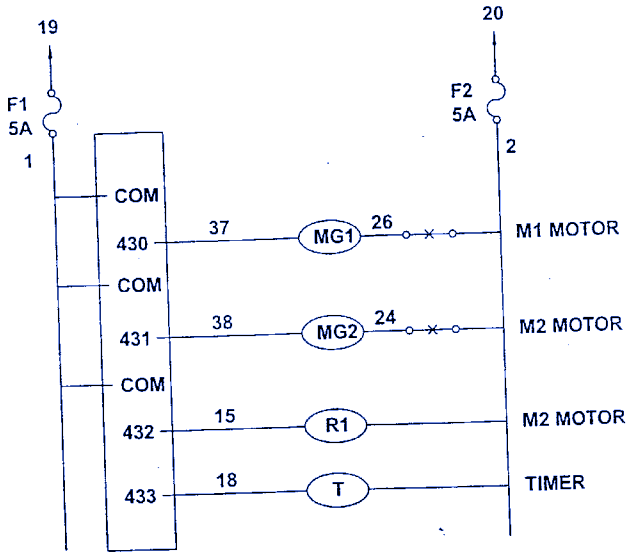

5Seconds™ 1SYS505 SEMI AUTO PALLET STRAPPING MACHINE

INDEX

| | PAGE |
|----------------------------------|------|
| FIG. 1 CAM UNIT----- | 1 |
| FIG. 2 SLIDE TABLE UNIT----- | 3 |
| FIG. 3 PRESS UNIT----- | 5 |
| FIG. 4 HEATER UNIT----- | 7 |
| FIG. 5 CONTROL FRAME UNIT----- | 9 |
| FIG. 6 TENSION UNIT----- | 11 |
| FIG. 7 FEED UNIT----- | 13 |
| FIG. 8 BAND WAY UNIT (85PS)----- | 15 |
| FIG. 9 ARCH UNIT (85PS)----- | 17 |
| FIG. 11 REEL UNIT----- | 19 |
| FIG. 12 BODY UNIT----- | 21 |
| FIG. 13 ELECTRIC UNIT----- | 23 |
| FIG. 14 CONTROL BOX UNIT----- | 25 |
| FIG. 15 DRIVE UNIT----- | 27 |

* When ordering or asking for replace parts, please state the phase, voltage and parts number.

5Seconds™ 1SYS505 SEMI AUTO PALLET STRAPPING MACHINE

Fig. 1 CAM UNIT

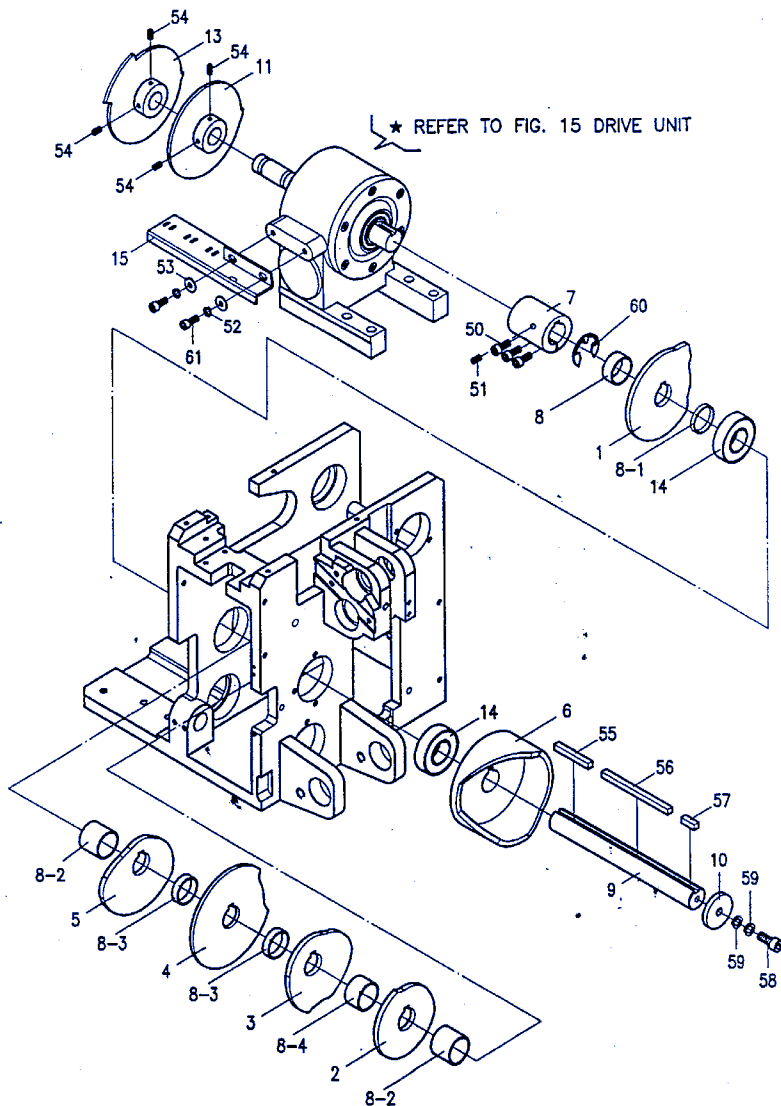

Parts:1

5Seconds™ 1SYS505 SEMI AUTO PALLET STRAPPING MACHINE

FIG. 1 CAM SHFT (85PS)

| KEY | PARTS NO. | QTY | DESCRIPTION |
|-----|-------------|-----|------------------------------------|
| 1 | 0101-00 | 1 | Slide Table Cam |
| 2 | 0102-00 | 1 | Right Press Cam |
| 3 | 0102-01 | 1 | Center Press Cam |
| 4 | 0103-00 | 1 | Heater Cam |
| 5 | 0103-01 | 1 | Left Press Cam |
| 6 | 0104-00 | 1 | Tension Cam |
| 7 | 0105-00 | 1 | Cam Shaft Coupling |
| 8 | 0106-00 | 1 | Cam Collar (L-13 mm) |
| 8-1 | 0106-01 | 1 | Cam Collar (L-15 mm) |
| 8-2 | 0106-02 | 2 | Cam Collar (L-27 mm) |
| 8-3 | 0106-03 | 2 | Cam Collar (L-7 mm) |
| 8-4 | 0106-04 | 1 | Cam Collar (L-19 mm) |
| 9 | 0107-00 | 1 | Cam Shaft |
| 10 | 0108-00 | 1 | Cam Shaft End Plate |
| 11 | 0111-00 | 1 | Proximity Switch Cam (LS-3) (85PS) |
| 13 | 0112-00 | 1 | Proximity Switch Cam (LS-1) (85PS) |
| 14 | 2201-02B | 2 | Ball Bearing 6205ZZ (NBK) |
| 15 | 0122-02 | 1 | Proximity Bracket |
| 50 | SCM6X20R | 3 | Socket Head Cap Screw 6 x 20R |
| 51 | SSM8X10 | 1 | Set Socket Cap Screw 8 x 10 |
| 52 | SSPWM6 | 2 | Spring Washer 6 mm |
| 53 | SWM6X21 | 2 | Plain Washer 6 x 21 |
| 54 | SSM6X10 | 6 | Set Socket Cap Screw 6 x 10 |
| 55 | KEY-7750 | 1 | Key 7 x 7 x 50 |
| 56 | KEY-77100-1 | 1 | Key 7 x 7 x 100 |
| 57 | KEY-7720 | 1 | Key 7 x 7 x 20 |
| 58 | SCM8X25R | 1 | Socket Head Cap Screw 8 x 25R |
| 59 | SSPWM8 | 2 | Spring Washer 8 mm |
| 60 | RE-24 | 1 | Ring E-24 |
| 61 | SLCM6X20R | 2 | Socket Head Cap Screw 6 x 20R |

Parts:2

5Seconds™ 1SYS505 SEMI AUTO PALLET STRAPPING MACHINE

Fig. 2 SLIDE TABLE UNIT

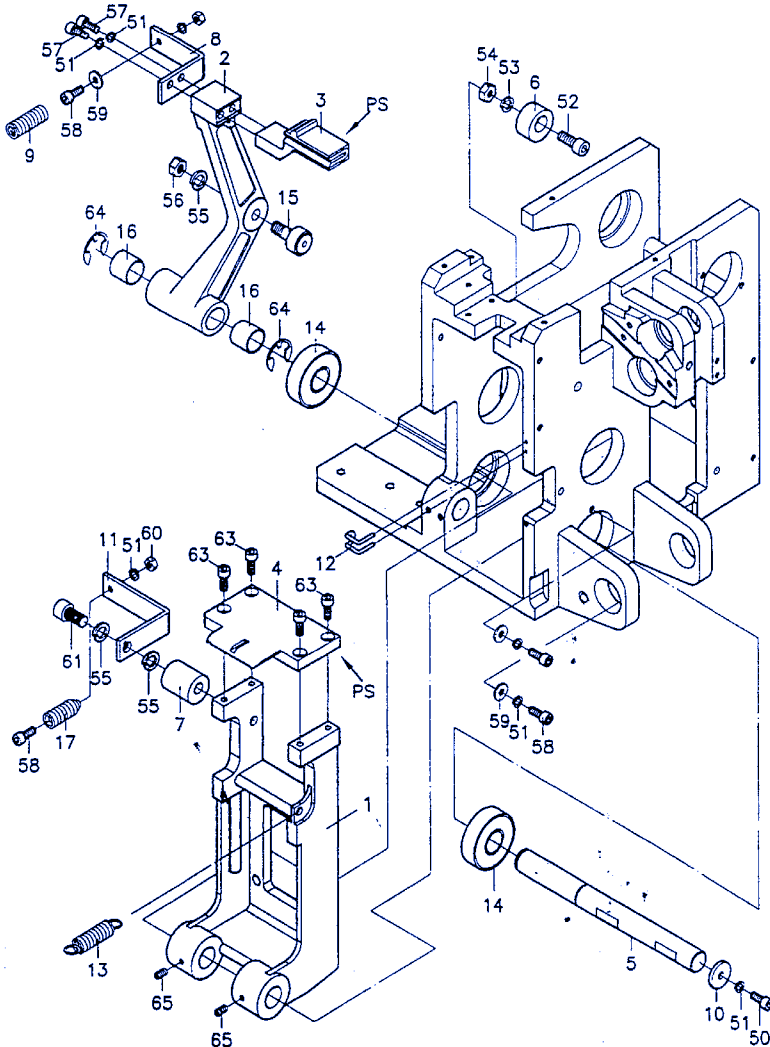

PS: PLEASE REFER TO FIG. 13 WHEN THE UNDER OF SLIDE TABLE (KEY NO.3 & KEY NO.4) BE INSTALLED WITH PROXIMITY SWITCH.

Parts:3

5Seconds™ 1SYS505 SEMI AUTO PALLET STRAPPING MACHINE

FIG. 2 SLIDE TABLE UNIT

| KEY | PART NO. | Q'TY | DESCRIPTION |
|-----|-----------|------|--------------------------------|
| 1 | 0201-00 | 1 | Slide Table Frame |
| 2 | 0202-01 | 1 | Band Guide Arm |
| 3 | 0203-02 | 1 | Band Guide |
| 4 | 0204-00 | 1 | Slide Table 12mm |
| | 0204-01 | 1 | Slide Table 15mm |
| | 0204-02 | 1 | Slide Table 9mm |
| | 0204-03 | 1 | Slide Table 6mm & 7mm |
| 5 | 0205-00 | 1 | Slide Table Frame Shaft |
| 6 | 0206-00 | 1 | Slide Table Stopper |
| 7 | 0207-00 | 1 | Slide Table Back Adj. |
| 8 | 0208-00 | 1 | Flap Connecting Spring Bracket |
| 9 | 0208-01 | 1 | Band Guide Spring |
| 10 | 0210-00 | 1 | Slide Table Shaft End Plate |
| 11 | 0222-00 | 1 | Band Guide Spring Bracket |
| 12 | 0212-00 | 1 | Slide Table Frame Spring Hook |
| 13 | 0220-00 | 1 | Slide Table Tension Spring |
| 14 | 2201-03 | 2 | Ball Bearing 6304ZZ |
| 15 | 2204-00 | 1 | Cam Follower CF-10 |
| 16 | 2202-04 | 2 | Metal Bush MB2025 |
| 17 | 0214-00 | 1 | Band Guide Spring |
| 50 | SCM6x20R | 1 | Socket Head Cap Screw 6x20R |
| 51 | SSPWM6 | 7 | Spring Washer 6mm |
| 52 | SCM8x30 | 1 | Socket Head Cap Screw 8x30 |
| 53 | SSPWM8 | 1 | Spring Washer 8mm |
| 54 | SNM8x125R | 1 | Hex. Nut 8X125R |
| 55 | SSPWM10 | 1 | Spring Washer 10Ø |
| 56 | SNM10x15R | 3 | Hex. Nut 10m/m |
| 57 | SCM6x50R | 2 | Socket Head Cap Screw 6x50R |
| 58 | SCM6x15R | 4 | Socket Head Cap Screw 6x15R |
| 59 | SWM6x21 | 3 | Plain Washer 6x21Ø |
| 60 | SNM6x10R | 2 | Hex. Nut 6x10R |
| 61 | SCM10x50R | 1 | Socket Head Cap Screw |
| 63 | SSCM6x15 | 4 | Stainless Socket Cap 6x15 |
| 64 | RE-15 | 2 | Ring E-15 |
| 65 | SSM6x10 | 2 | Set Socket Cap Screw 6x10 |

Parts:4

5Seconds™ 1SYS505 SEMI AUTO PALLET STRAPPING MACHINE

Fig. 3 PRESS UNIT

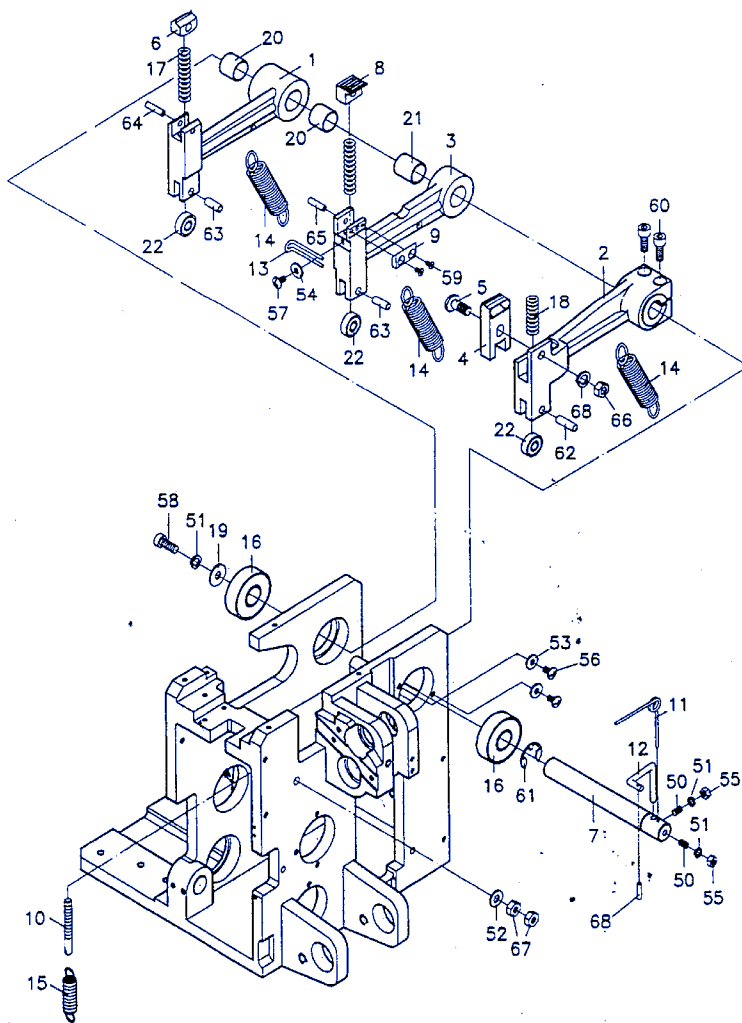

Parts:5

5Seconds™ 1SYS505 SEMI AUTO PALLET STRAPPING MACHINE

FIG. 3 PRESS UNIT

| KEY | PART NO. | Q'TY | DESCRIPTION |
|-----|-----------|------|---------------------------------|
| 1 | 0301-00 | 1 | Lf. Block Arm |
| 2 | 0302-02 | 1 | Rh. Block Arm |
| 3 | 0303-00 | 1 | Center Block Arm |
| 4 | 0304-00 | 1 | Cutter (Upper) (9-15mm) |
| | 0304-01 | 1 | Cutter (Upper) (6mm & 7mm) |
| | 0304-02 | 1 | Cutter (Upper) 19mm |
| 5 | 0305-00 | 1 | Cutter Pin |
| 6 | 0306-01 | 1 | Jam (Lf.) |
| 7 | 0307-00 | 1 | Press Arm Shaft |
| 8 | 0308-00 | 1 | Universal Press |
| 9 | 0309-00 | 1 | Cutter (Lower) |
| 10 | 0310-00 | 1 | Cutter Tension Spring |
| 11 | 0311-00 | 1 | Upper Roller Spring |
| 12 | 0312-00 | 1 | Upper Shaft Spring Adjuster |
| 13 | 0313-00 | 1 | Cutter Spring Hook |
| 14 | 0314-00 | 3 | Press Tension Spring |
| 15 | 0315-00 | 1 | Cutter Tension Spring |
| 16 | 2201-03 | 2 | Ball Bearing 6304ZZ |
| 17 | 0317-01 | 2 | Lf. & Center Block Spring |
| 18 | 0318-00 | 1 | Rh. Block Spring |
| 19 | 0319-00 | 1 | Press Arm End Plate |
| 20 | 2202-03 | 2 | Metal Bush MB2020 |
| 21 | 2202-04 | 1 | Metal Bush MB2025 |
| 22 | 2201-05C | 3 | Ball Bearing 628ZZ |
| 50 | SSM6x16 | 2 | Set Screw 6x16 |
| 51 | SSPWM6 | 4 | Spring Washer 6mm |
| 52 | SWM8x18 | 1 | Plain Washer 5/16x18 |
| 53 | SWM6x21 | 2 | Plain Washer 6x21 |
| 54 | SWM6x16 | 2 | Plain Washer 6x16 |
| 55 | SNM6x10R | 2 | Hexagon Nut 6x1.0 |
| 56 | SB1M6x15 | 1 | Truss Head Screw 6x15 |
| 57 | SB1M6x10 | 1 | Truss Head Screw 6x10 |
| 58 | SCM6x20R | 1 | Socket Head Cap Screw 6x20 |
| 59 | SCH5x8 | 2 | Flat Head Socket Screw 5x8 |
| 60 | SSCM8x35R | 2 | Socket Head Cap Screw 8x35R |
| 61 | RE-15 | 1 | E-Stop Ring No.15 |
| 62 | PIN-822 | 1 | V-Spring Pin (Straight) 8 φ x22 |
| 63 | PIN-820 | 2 | V-Spring Pin (Straight) 8 φ x20 |
| 64 | PIN-624 | 1 | V-Spring Pin (Straight) 6 φ x24 |
| 65 | PIN-622 | 1 | V-Spring Pin (Straight) 6 φ x22 |
| 66 | SNM10x15 | 1 | Hexagon Nut 10x1.5 |
| 67 | SNM8x125R | 2 | Hexagon Nut 8x1.25 |
| 68 | PIN-218 | 1 | V-Spring Pin (Straight) 2 φ x18 |

Parts:6

5Seconds™ 1SYS505 SEMI AUTO PALLET STRAPPING MACHINE

Fig. 4 HEATER UNIT

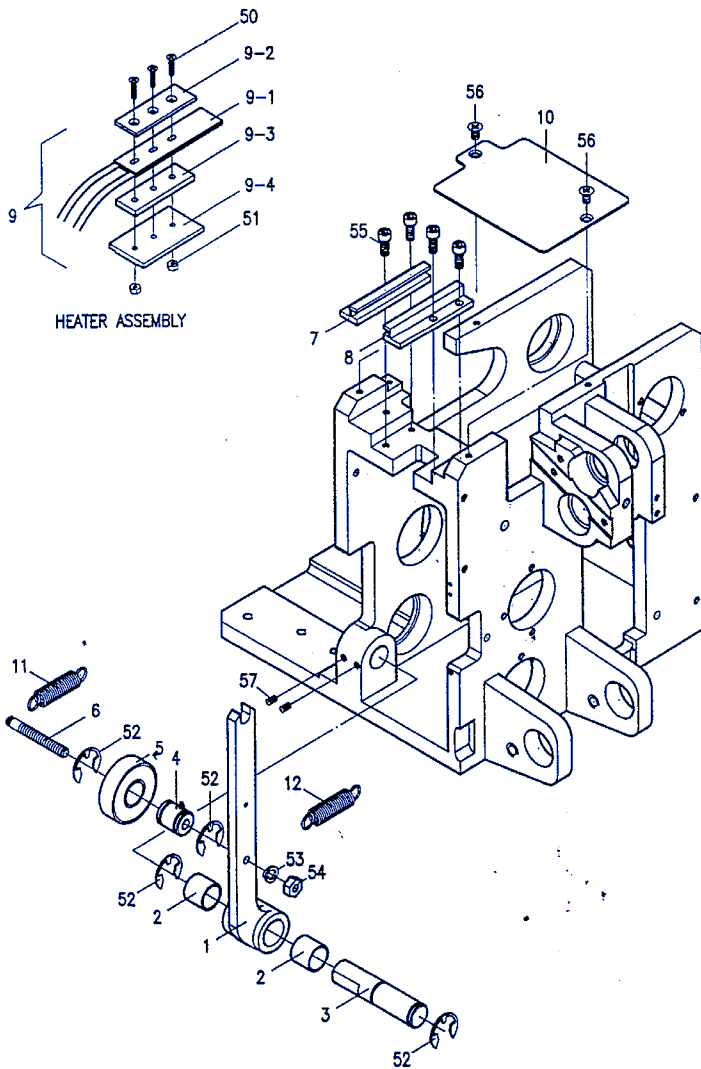

Parts:7

5Seconds™ 1SYS505 SEMI AUTO PALLET STRAPPING MACHINE

FIG. 4 HEATER UNIT

| KEY | PART NO. | Q'TY | DESCRIPTION |
|-----|-----------|------|------------------------------|
| 1 | 0401-00 | 1 | Heater Crank |
| 2 | 2202-03 | 2 | Metal Bush MB2020 |
| 3 | 0404-01 | 1 | Heater Crank Shaft |
| 4 | 0405-00 | 1 | Heater Crank Roller Collar |
| 5 | 2201-03 | 1 | Ball Bearing 6304ZZ |
| 6 | 0407-02 | 1 | Heater Bearing Shaft |
| 7 | 0403-01 | 1 | Heater Slide Guide (Lf.) |
| 8 | 0403-00 | 1 | Heater Slide Guide (Rh.) |
| 9 | 0409-AS1 | 1 | Heater Assembly |
| 9-1 | 0409-02 | 1 | Heater Plate |
| 9-2 | 0409-03 | 1 | Cover Plate |
| 9-3 | 0409-04 | 1 | Heater Guide |
| 9-4 | 0409-05 | 1 | Heater Seat |
| 10 | 0408-02 | 1 | Heater Cover |
| 11 | 0411-00 | 1 | Heater Crank Spring |
| 12 | 0409-10 | 1 | Spring |
| 50 | SFM4X20 | 3 | Flat Head Screw |
| 51 | SNM4X0.7R | 2 | Hex. Nut 4 x 0.7R |
| 52 | RE-15 | 2 | Ring E-15 |
| 53 | SSPWM8 | 1 | Spring Washer 8mm |
| 54 | SNM8X125R | 1 | Hex. Nut 8 x 12.5R |
| 55 | SCM5X16 | 4 | Socket Head Cap Screw 5 x 16 |
| 56 | SFM5X10 | 2 | Flat Head Cap Screw |
| 57 | SSM6X10 | 2 | Set Screw 6 x 10 |

Parts:8

5Seconds™ 1SYS505 SEMI AUTO PALLET STRAPPING MACHINE

Fig. 5 CONTROL FRAME UNIT

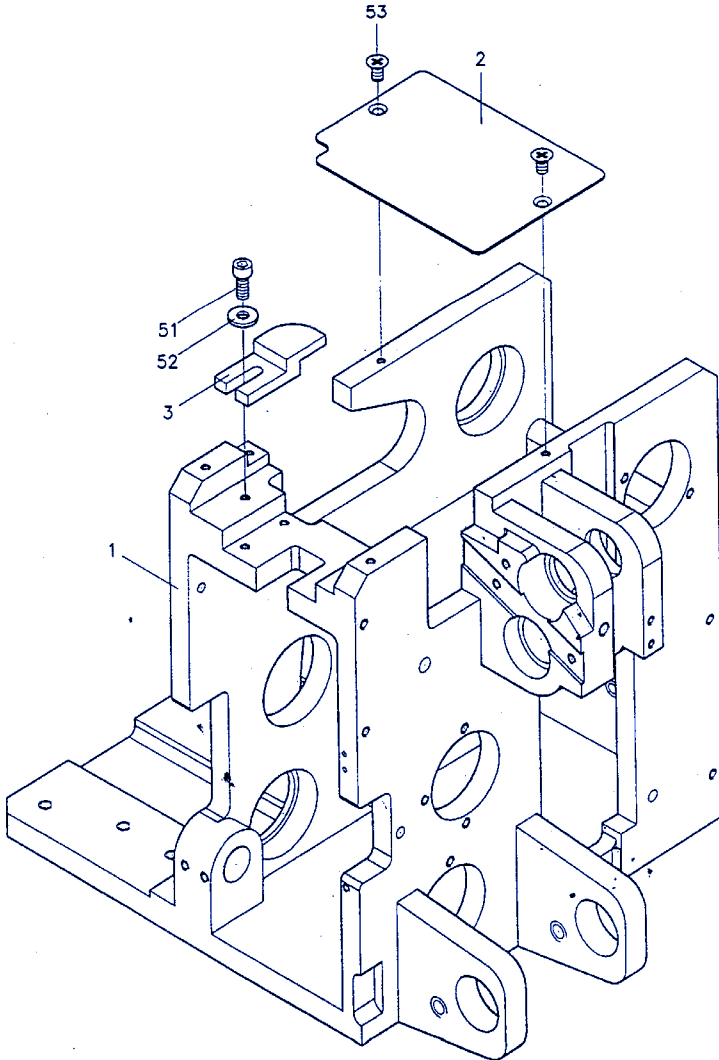

Parts:9

5Seconds™ 1SYS505 SEMI AUTO PALLET STRAPPING MACHINE

FIG. 5 CONTROL FRAME UNIT

| KEY | PART NO. | Q'TY | DESCRIPTION |
|-----|----------|------|-----------------------|
| 1 | 0501-06 | 1 | Control Frame |
| 2 | 0507-01 | 1 | Slide Table Cover |
| 3 | 0506-02 | 1 | Band Width Block |
| 51 | SCM6x16 | 1 | Socket Head Cap Screw |
| 52 | SWM6x16 | 1 | Plain Washer |
| 53 | SFM5x10 | 2 | Flat Head Cap Screw |

Parts:10

5Seconds™ 1SYS505 SEMI AUTO PALLET STRAPPING MACHINE

Fig. 6 TENSION UNIT

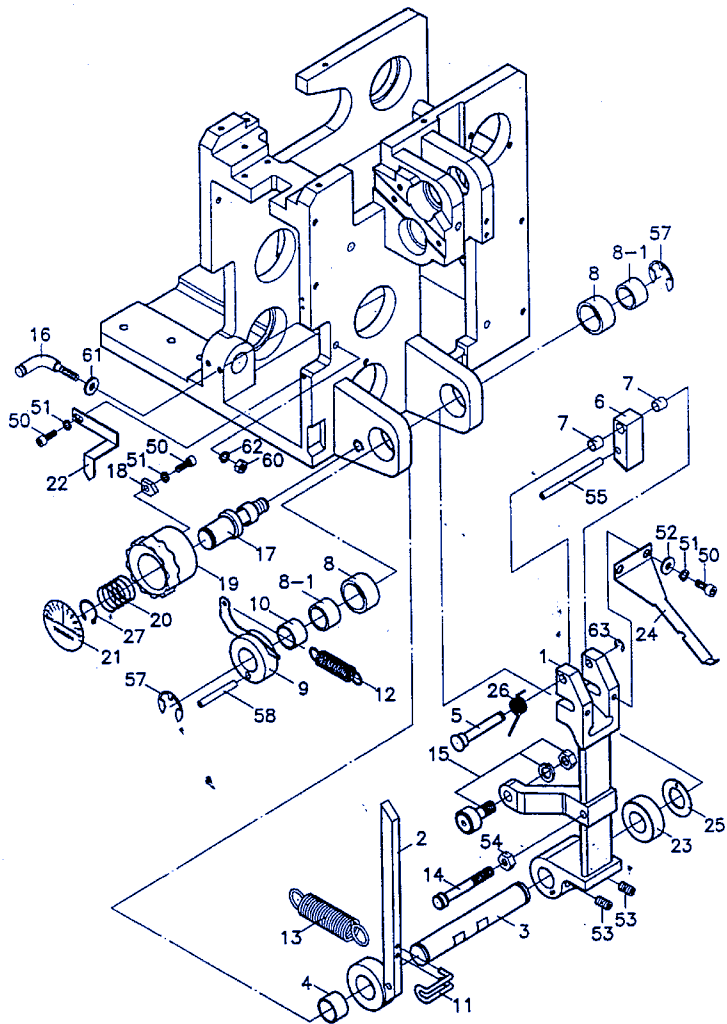

Parts:11

5Seconds™ 1SYS505 SEMI AUTO PALLET STRAPPING MACHINE

FIG. 3 TENSION SYSTEM

| KEY | PARTS NO. | QTY | DESCRIPTION |
|-----|-----------|-----|----------------------------------|
| 1 | 0601-00 | 1 | Tension Arm |
| 2 | 0602-02 | 1 | Tension Adj. Arm |
| 3 | 0603-00 | 1 | Tension Arm Shaft |
| 4 | 2202-02 | 1 | Metal Bush MB2015 |
| 5 | 0605-00 | 1 | Tension Jaw Shaft |
| 6 | 0606-01 | 1 | Tension Jaw |
| 7 | 2202-00 | 2 | Metal Bush MB 0808 |
| 8 | 2203-00A | 2 | Needle Bearing HK2516 |
| 8-1 | 2203-00B | 2 | Needle Bearing (Inner) IRT2015-1 |
| 9 | 0609-02 | 1 | Tension Adj. |
| 10 | 2202-02 | 1 | Metal Bush MB2015 |
| 11 | 0611-00 | 1 | Tension Adj. Arm Spring Hook |
| 12 | 0617-02 | 1 | Tension Adj. Arm Spring Hook |
| 13 | 0616-02 | 1 | Tension Arm Spring |
| 14 | 0614-00 | 1 | Tension Arm Spring Hook-1 |
| 15 | 2204-00 | 1 | Cam Follower CF-10 |
| 16 | 0620-00 | 1 | Tension Arm Hook |
| 17 | 0638-01 | 1 | Tension Adj. Cam Shaft |
| 18 | 0646-02 | 1 | Tension Adj. Cam Lock |
| 19 | 0613-01 | 1 | Tension Adj. Cam |
| 20 | 0643-02 | 1 | Tension Adj. Cam Spring |
| 21 | 0632-00 | 1 | Tension Select Dial |
| 22 | 0628-00 | 1 | Tension Finger |
| 23 | 0634-01 | 1 | Tension Arm Collar |
| 24 | 0612-10 | 1 | Strap Guide 9 mm (85PS) |
| | 0612-11 | 1 | Strap Guide 12 mm (85PS) |
| | 0612-12 | 1 | Strap Guide 15 mm (85PS) |
| 25 | 2205-00 | 1 | Metal Plate WC18DUN |
| 26 | 0615-00 | 1 | Tension Jaw Spring |
| 50 | SCM5X12 | 1 | Socket Head Cap Screw |
| 51 | SSPWM5 | 4 | Spring Washer M5 |
| 52 | SWM5X12 | 2 | Plain Washer 5 x 12 |
| 53 | SSM6X10 | 2 | Set Socket Cap Screw 6 x 10 |
| 54 | SWM8X125 | 1 | Plain Washer 8 x 125 |
| 55 | PIN-675 | 1 | Pin 6 x 75 |
| 57 | RE-15 | 2 | Ring E-15 |
| 58 | PIN-645 | 1 | Pin 6 x 45 |
| 59 | RR-20 | 1 | Ring R-20 |
| 60 | SNM6X10 | 1 | Hex. Nut M6 |
| 61 | SWM6X16 | 1 | Plain Washer 6 x 16 |
| 62 | SSPWM6 | 1 | Spring Washer M6 |
| 63 | RE-6 | 1 | Ring E-6 |

Parts:12

5Seconds™ 1SYS505 SEMI AUTO PALLET STRAPPING MACHINE

Fig. 7 FEED UNIT

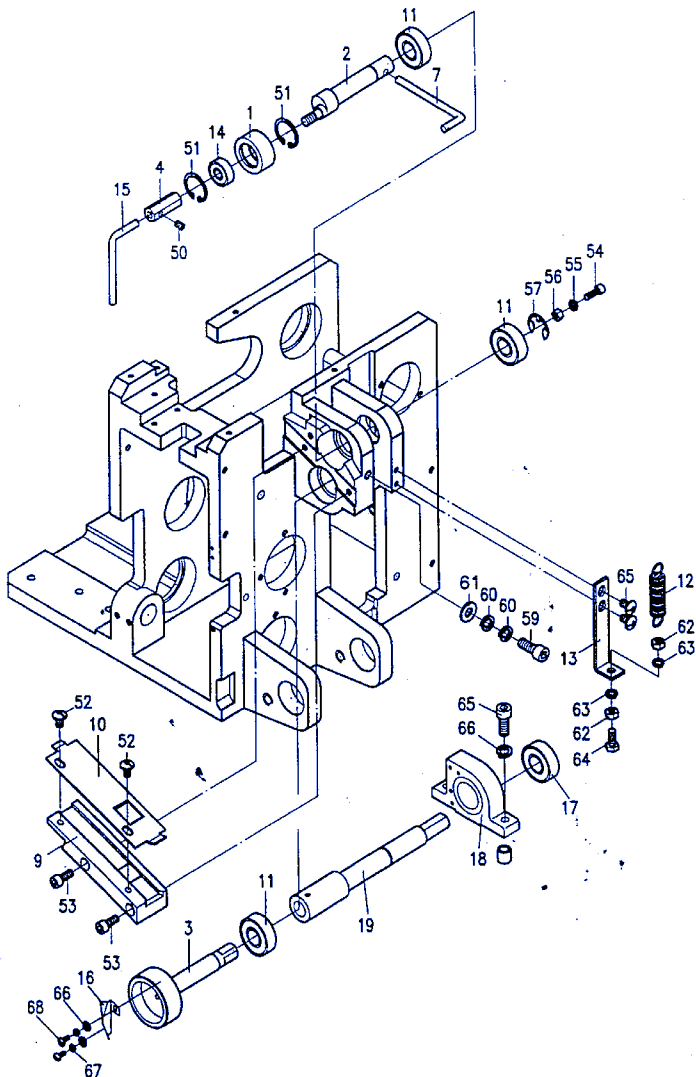

Parts:13

5Seconds™ 1SYS505 SEMI AUTO PALLET STRAPPING MACHINE

FIG. 7 FEED UNIT (85PS)

| KEY | PARTS NO. | QTY | DESCRIPTION |
|-----|-----------|-----|-------------------------------|
| 1 | 0702-00 | 1 | Upper Feed Roller (6#) |
| | 0702-01 | 1 | Upper Feed Roller (7# & 9#) |
| | 0702-02 | 1 | Upper Feed Roller (12#) |
| | 0702-03 | 1 | Upper Feed Roller (15#) |
| | 0702-AS1 | 1 | Upper Feed Roller Assembly |
| 2 | 0703-00 | 1 | Upper Feed Roller Shaft |
| 3 | 0704-00 | 1 | Feed Roller |
| 4 | 0705-01 | 1 | Upper Roller Grip |
| 7 | 0708-02 | 1 | Upper Roller Weight Adj. |
| 9 | 0710-00B | 1 | Feed Shooter 6# |
| | 0710-01B | 1 | Feed Shooter 7# & 9# |
| | 0710-02B | 1 | Feed Shooter 12# |
| | 0710-03B | 1 | Feed Shooter 15# |
| 10 | 0711-00 | 1 | Feed Shooter Cover |
| 11 | 2201-01 | 4 | Ball Bearing 6202ZZ |
| 12 | 0721-00 | 1 | Feed Spring |
| 13 | 0724-00 | 1 | Pool Clutch Holder |
| 14 | 2201-05D | 1 | Bearing 628ZZ NBK |
| 15 | 0726-00 | 1 | Upper Roller Grip (L type) |
| 16 | 0701-00 | 1 | Cooling Fan |
| 17 | D-05-01 | 1 | Ball Bearing 6003ZZ |
| 18 | D-06-00 | 1 | Bearing Bracket |
| 19 | 0704-03 | 1 | Shaft |
| 50 | SSM6X6 | 1 | Set Cap Screw 6 x 6 |
| 51 | RR-24 | 2 | Ring R-24 |
| 52 | SB1M6X10 | 2 | Phillips Head Screw 6 x 10 |
| 53 | SCM6X45R | 2 | Socket Head Cap Screw 6 x 45R |
| 54 | SCM6X16 | 1 | Socket Head Cap Screw 6 x 16 |
| 55 | SSPWM6 | 1 | Spring Washer M6 |
| 56 | SNM6X10 | 1 | Hex. Nut M6 |
| 57 | RE-12 | 1 | Ring E-12 |
| 58 | SSM6X10 | 2 | Set Socket Cap Screw 6 x 10 |
| 59 | SCM8X12 | 1 | Socket Head Cap Screw 8 x 12 |
| 60 | SSPWM8 | 2 | Spring Washer M8 |
| 61 | 0607-00 | 1 | Shim 8.10 x 130 x 0.3m/m |
| 62 | SNM6X10 | 2 | Hex. Nut M6 |
| 63 | SSPWM6 | 2 | Spring Washer M6 |
| 64 | 0722-00 | 1 | Adj. Screw 6 x 50 m/m |
| 65 | SB1M5X10 | 2 | Truss Head Screw 5 x 10 |
| 66 | SWM4X12R | 2 | Plain Washer 4 x 12R |
| 67 | SSPWM4 | 2 | Spring Washer 4 m/m |
| 68 | SBM4X8 | 2 | Phillips Head Screw M4 x 8 |

Parts:14

5Seconds™ 1SYS505 SEMI AUTO PALLET STRAPPING MACHINE

Fig. 8 BAND WAY UNIT

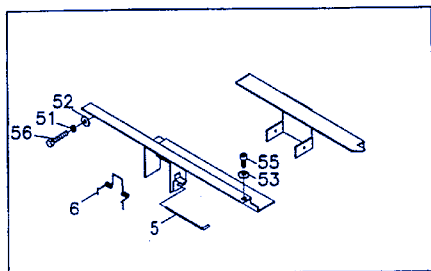

7
ASSEMBLIES

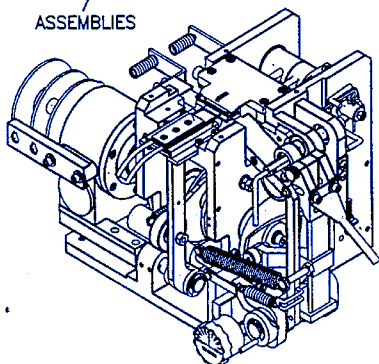

ASSEMBLIES
4

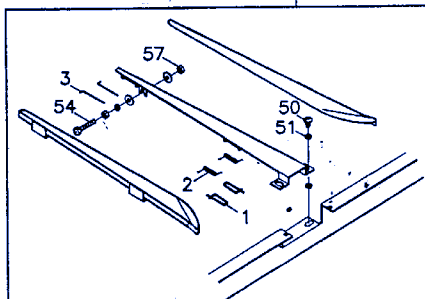

Parts:15

5Seconds™ 1SYS505 SEMI AUTO PALLET STRAPPING MACHINE

FIG. 8 BAND WAY UNIT (85PS)

| KEY | PARTS NO. | QTY | DESCRIPTION |
|-----|-----------|-----|-------------------------------|
| 1 | 0807-00 | 2 | Rh. Bandway Flap Pin |
| 2 | 0808-00 | 2 | Rh. Bandway Flap Spring |
| 3 | 0811-00 | 2 | Rh. Bandway Flap Pin |
| 4 | 0820-UN01 | 1 | Rh. Bandway Unit |
| 5 | 0806-00 | 1 | Lf. Bandway Flap Pin |
| 6 | 0810-00 | 1 | Lf. Bandway Flap Spring |
| 7 | 0819-UN01 | 1 | Lf. Bandway Unit |
| 50 | SB1M6X15 | 2 | Truss Head Screw 6 x 15 |
| 51 | SSPWM6R-1 | 4 | Spring Washer M6 |
| 52 | SWM6X16R | 1 | Plain Washer 6 x 16R |
| 53 | SWM5X12R | 1 | Plain Washer 5 x 12R |
| 54 | SSHM6X50 | 1 | Case Roller Shaft |
| 55 | SCM5X16R | 1 | Socket Head Cap Screw 5 x 16R |
| 56 | SCM6X10R | 1 | Hex. Square Head Bolt 6 x 10 |
| 57 | SNM6X10R | 1 | Hex. Nut 6 x 10R |

Parts:16

5Seconds™ 1SYS505 SEMI AUTO PALLET STRAPPING MACHINE

Fig. 9 ARCH UNIT

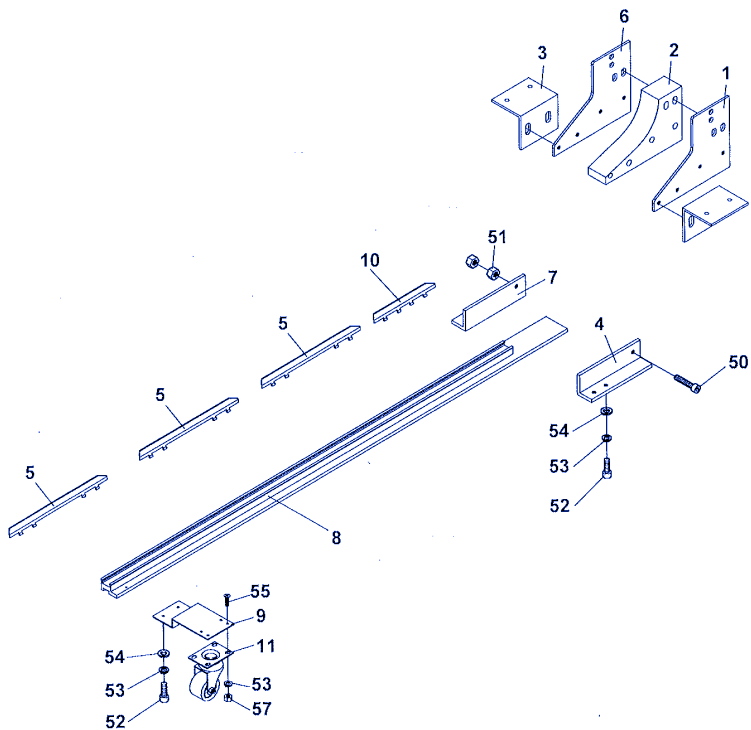

Parts:17

5Seconds™ 1SYS505 SEMI AUTO PALLET STRAPPING MACHINE

FIG. 9 ARCH UNIT (85PS)

| KEY | PARTS NO. | QTY | DESCRIPTION |
|-----|-----------|-----|------------------------------|
| 1 | 0984-07R | 1 | Arch Frame Plate (R) |
| 2 | 0984-06 | 1 | Arch Frame 9-15mm |
| 3 | 0984-08 | 2 | Arch Frame Plate |
| 4 | 0994-00R | 1 | Connected Plate (R) |
| 5 | 0985-09-1 | 3 | Arch Flap (15 mm) |
| 6 | 0984-07L | 1 | Arch Frame Plate (L) |
| 7 | 0994-00L | 1 | Connected Plate (L) |
| 8 | 0995-00 | 1 | Aluminum Arch L970 mm |
| | 0995-02 | 1 | Aluminum Arch L1170 mm |
| 9 | 0994-01 | 1 | Caster Seat |
| 10 | 0985-09 | 1 | Arch Flap |
| 11 | 1226-12 | 1 | Wheel Swivel |
| 50 | SLCM6X55 | 1 | Socket Head Cap Screw 6 x 55 |
| 51 | SNM6X10R | 3 | Hex. Nut 6 x 1.0R |
| 52 | SLCM5X12R | 2 | Socket Head Cap Screw 5 x 12 |
| 53 | SSPWM5R | 6 | Spring Washer 5m/m |
| 54 | SWM5X12R | 2 | Plain Washer 5 x 12R |
| 55 | SFM5X15 | 4 | Flat Head Cap Screw 5 x 15 |

Parts:18

5Seconds™ 1SYS505 SEMI AUTO PALLET STRAPPING MACHINE

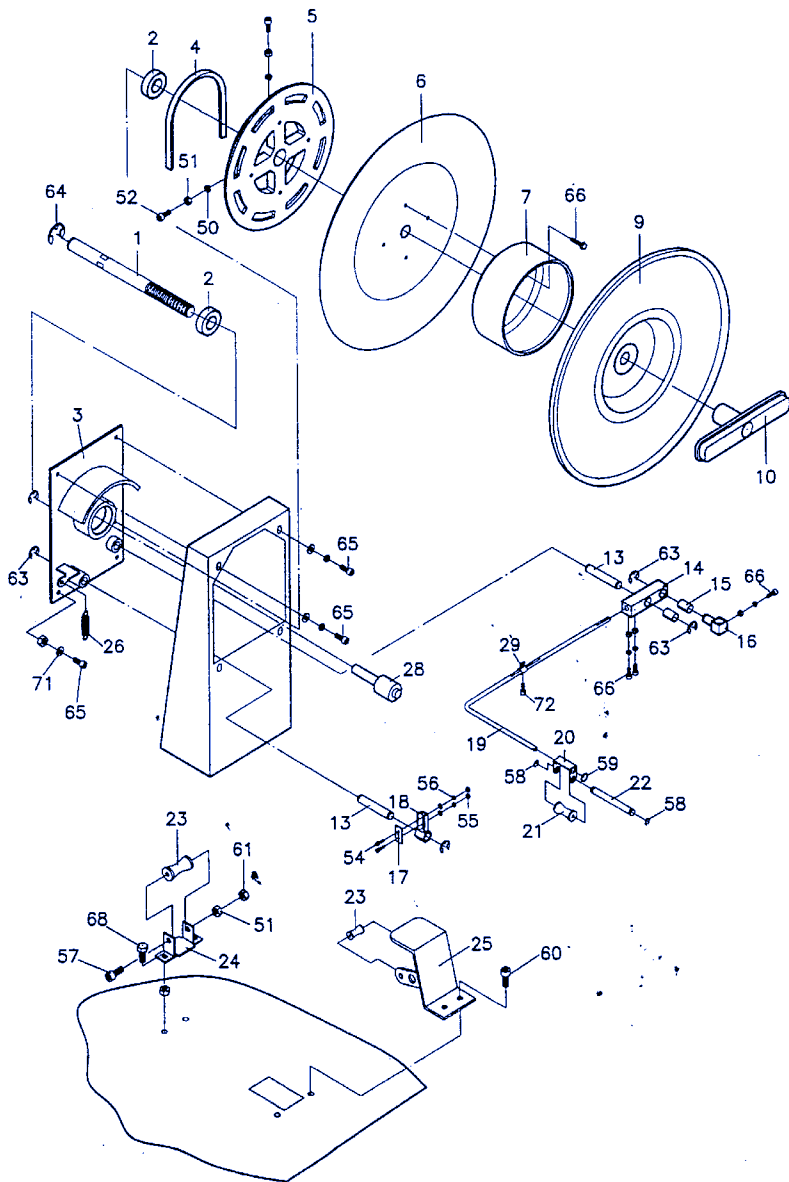

Parts:19

5Seconds™ 1SYS505 SEMI AUTO PALLET STRAPPING MACHINE

FIG. 11 REEL UNIT (85PS)

| KEY | PARTS NO. | QTY | DESCRIPTION |
|-----|------------|-----|-------------------------------|
| 1 | 1107-02 | 1 | Shaft (Dispenser) |
| 2 | 2201-02B | 2 | Ball Bearing 6205ZZ (NBK) |
| 3 | 1101-07 | 1 | Reel Unit Base |
| 4 | 1126-01 | 1 | Brake V-Belt |
| 5 | 1103-02 | 1 | Reel Brake Pulley |
| 6 | 1118-00 | 1 | Inner Reel Flange |
| 7 | 1124-00 | 1 | Reel Center Drum 200φ |
| 9 | 1119-00 | 1 | Outer Reel Flange 200φ |
| 10 | 1108-00 | 1 | Reel Handle |
| 13 | 1109-01 | 2 | Helder Shaft |
| 14 | 1105-00 | 1 | Brake Tension Holder |
| 15 | 2202-01 | 2 | Metal Bush MB1525 |
| 16 | 1106-02 | 1 | Brake Belt Tightener |
| 17 | J-17-20 | 1 | Brake Belt Plate |
| 18 | 1104-04 | 1 | Brake Belt Guard |
| 19 | 1111-09 | 1 | Brake Arm |
| 20 | 1113-01 | 1 | Roller Bracket |
| 21 | 1115-00 | 1 | Brake Roller |
| 22 | J-11-11-1 | 1 | Brake Roller Shaft |
| 23 | 1115-01A | 2 | Nylon Roller |
| 24 | 1113-02 | 1 | Roller Bracket |
| 25 | 1113-03 | 1 | Roller Bracket |
| 28 | 1111-04 | 1 | Brake Holder |
| 29 | 1111-AS1 | 1 | Brake Spring Adj. Assembly |
| 50 | SSPWM6R-1 | 5 | Spring Washer M6 |
| 51 | SNM6X10R | 10 | Hex. Nut 6 x 10R |
| 52 | SLCM6X16R | 4 | Socket Head Cap Screw 6 x 16R |
| 54 | SSCM4X25 | 2 | Socket Head Cap Screw 4 x 25 |
| 55 | SNM4X07R | 2 | Hex. Nut 4 x 0.7R |
| 56 | SSPWM4 | 2 | Spring Washer 4m/m |
| 57 | SLCM6X35R | 1 | Socket Head Cap Screw 6 x 35 |
| 58 | RE-5 | 2 | Ring E-5 |
| 59 | 1133-00 | 1 | Ring |
| 60 | SLCM5X12R | 2 | Socket Head Cap Screw 5 x 12R |
| 61 | SUNM5 | 1 | Hex. Nut M5 (U#) |
| 63 | RE-12 | 2 | Ring E-12 |
| 65 | SLCM8X25R | 4 | Socket Head Cap Screw 8 x 25R |
| 66 | SLCM6X20R | 7 | Socket Head Cap Screw 6 x 20R |
| 70 | SWM8X18X2R | 7 | Plain Washer 8φ x 18φ |
| 72 | SLCM6X20R | 1 | Socket Head Cap Screw 6 x 20R |

Parts:20

5Seconds™ 1SYS505 SEMI AUTO PALLET STRAPPING MACHINE

Fig. 12 BODY UNIT

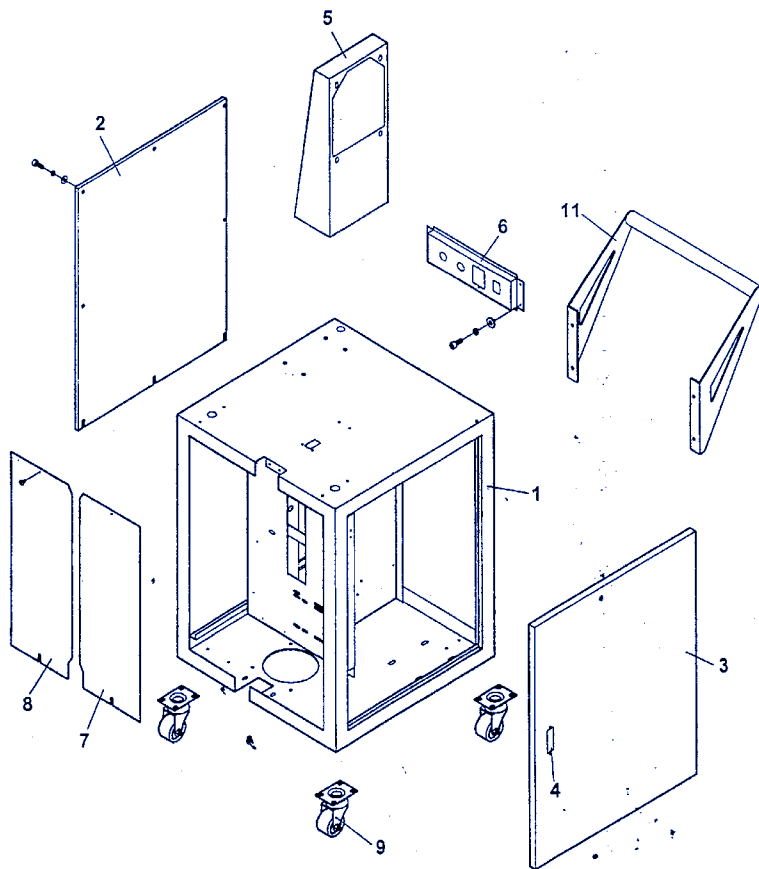

Parts:21

5Seconds™ 1SYS505 SEMI AUTO PALLET STRAPPING MACHINE

FIG. 12 BODY UNIT (85PS)

| KEY | PARTS NO. | QTY | DESCRIPTION |
|-----|------------|-----|------------------------------|
| 1 | 1201-46 | 1 | Case Assembly (85PS) |
| 2 | 1201-46-01 | 1 | Left Plate |
| 3 | 1201-46-02 | 1 | Right Door |
| 4 | J-07-05 | 1 | Control Box Lock |
| 5 | 1101-08 | 1 | Dispenser Frame |
| 6 | 1205-25 | 1 | Control Panel |
| 7 | 1210-4-1R | 1 | Aluminum Cover (R) 9 & 15 mm |
| 8 | 1210-4-1L | 1 | Aluminum Cover (L) 9 & 15 mm |
| 9 | 1226-03 | 4 | Wheel Shivel 3" PU |
| 11 | 1201-46-00 | 1 | Handle |

Parts:22

5Seconds™ 1SYS505 SEMI AUTO PALLET STRAPPING MACHINE

FIG. 13 ELECTRIC UNIT

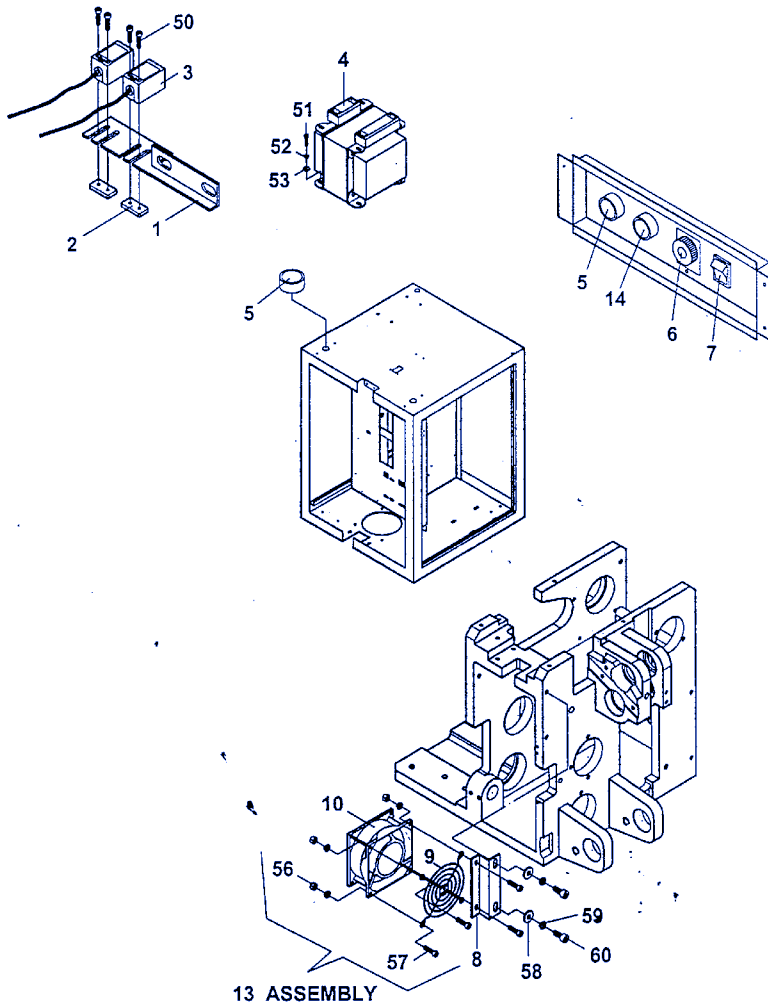

Parts:23

5Seconds™ 1SYS505 SEMI AUTO PALLET STRAPPING MACHINE

FIG. 13 ELECTRIC UNIT (85PS)

| KEY | PARTS NO. | QTY | DESCRIPTION |
|-----|------------|-----|--------------------------------|
| 1 | 0122-02 | 1 | Proximity Bracket |
| 2 | 0123-00 | 2 | Proximity Bracket Guide |
| 3 | 1503-11 | 2 | Proximity Switch |
| 4 | 1306-08 | 1 | Transformer (Heater) 210-240V |
| | 1306-09 | 1 | Transformer (Heater) 110V-120V |
| 5 | 1407-17 | 2 | Start Switch 22 ϕ 1A |
| 6 | 1405-22 | 1 | Timer H3Y-10S AC/DC 24V |
| 7 | KSW-20A | 1 | Power Switch |
| 8 | 1324-01 | 1 | Smoke Fan Fixed Plate |
| 9 | 1325-00 | 1 | Smoke Fan Cover 3" |
| 10 | 1324-00 | 1 | Smoke Fan 220V |
| | 1324-03 | 1 | Smoke Fan 110V |
| 13 | 1324-AS2 | 1 | Smoke Fan Assembly 110V |
| | 1324-AS1 | 1 | Smoke Fan Assembly 220V |
| 14 | 1407-18 | 1 | Switch 22 ϕ 1A |
| 50 | SBM3X25 | 2 | Phillips Head Screw 3 x 25 |
| 51 | SB1M4X8 | 8 | Phillips Head Screw 4 x 8 |
| 52 | SSPWM4R | 8 | Spring Washer 4 mm |
| 53 | SWM4X12R | 8 | Plain Washer 4 x 12R |
| 56 | SNM4X07R | 4 | Hex. Nut 4 x 0.7R |
| 57 | SBM4X15 | 4 | Phillips Head Screw 4 x 15 |
| 58 | SWM6X16X2R | 2 | Plain Washer 6 x 16 x 2.0R |
| 59 | SSPWM6R-1 | 2 | Spring Washer 6 mm |
| 60 | SLCM6X20R | 2 | Socket Head Cap Screw 6 x 20R |

Parts:24

5Seconds™ 1SYS505 SEMI AUTO PALLET STRAPPING MACHINE

FIG. 14 CONTROL BOX UNIT (85PS)

| KEY | PARTS NO. | QTY | DESCRIPTION |
|-----|-----------|-----|--|
| 1 | 1401-13 | 1 | Control Box Base Plate |
| 2 | 1401-13-1 | 1 | Control Box Top Cover |
| 3 | 1401-13-2 | 1 | Control Box Front Cover |
| 4 | 1430-00 | 1 | PLC A1-12MR |
| 5 | 1427-06E | 1 | Relay 24V |
| 6 | 1415-20 | 1 | Transformer 28/220/380V |
| | KTF-TA-1 | 1 | Transformer 28/110V |
| 7 | KAD-08-02 | 1 | Wire Duct 25 mm x 45 mm |
| 8 | KTR-01-12 | 1 | Rectifier SB-358 |
| 9 | 1424-00 | 2 | Fuse Seat |
| 10 | KFS-2-20A | 1 | Fuse 20A 30 mm |
| 11 | 1425-00 | 2 | Fuse Cover |
| 12 | KFS-3-50A | 1 | Fuse 5A 30 mm |
| 13 | 1403A-AS5 | 1 | Magnetic Switch MSO-P11/AC24V/2E 3A1B/9-13A |
| 14 | 1402A-AS1 | 1 | Magnetic Switch AC-24V 1.6-2.6A with Thermal Relay |
| 15 | 1419-AS2 | 1 | Heater Temperature Adj. (220V) |
| | 1419-AS1 | 1 | Heater Temperature Adj. (110V) |
| 16 | 1427-05 | 1 | Relay Seat PF-085A |

Parts:26

5Seconds™ 1SYS505 SEMI AUTO PALLET STRAPPING MACHINE

Fig. 15 DRIVE UNIT (85PS)

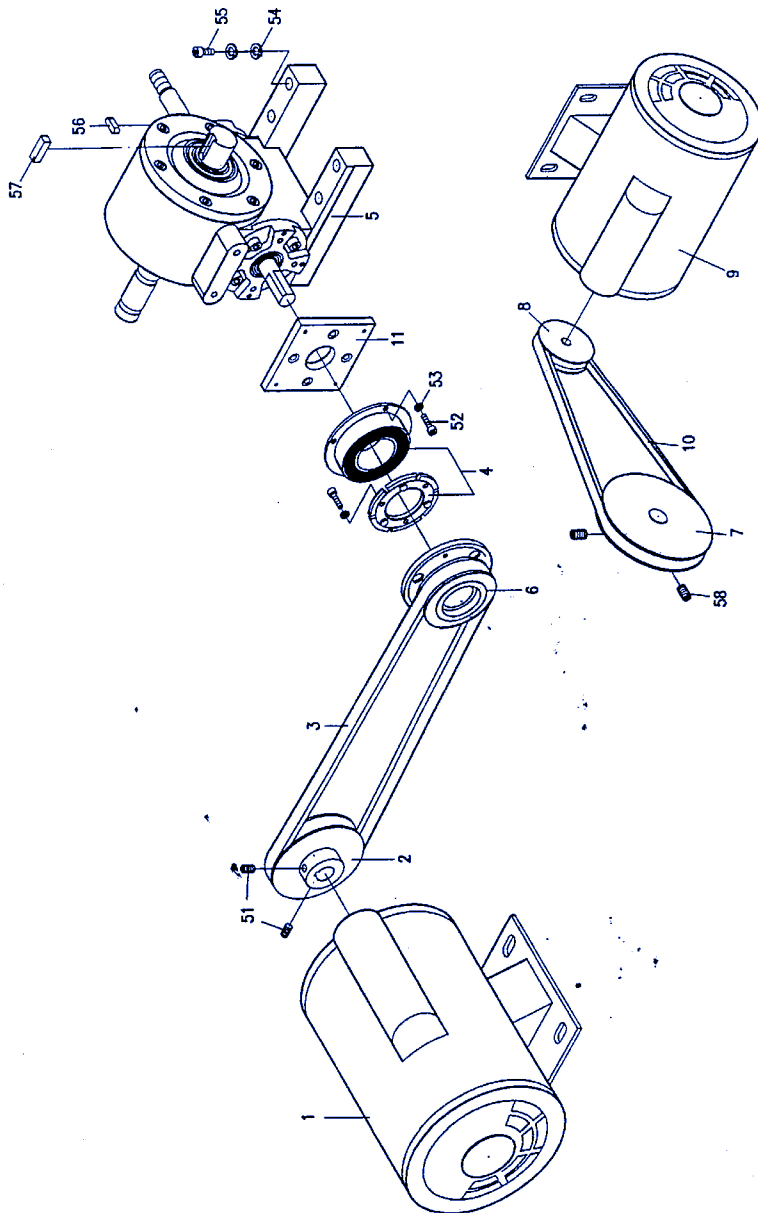

MANUAL-1\NFP\85PS\F15 2001/4/20

5Seconds™ 1SYS505 SEMI AUTO PALLET STRAPPING MACHINE

FIG. 15 DRIVE UNIT (85PS)

| KEY | PARTS NO. | QTY | DESCRIPTION |
|-----|------------|-----|-----------------------------------|
| 1 | 1301-26 | 1 | Motor 1PH 220V 50HZ 1/2HP |
| | 1301-27 | 1 | Motor 1PH 110/220V 60HZ 1/2HP |
| 2 | 1302-01 | 1 | Motor Pulley 14φ A72φ |
| 3 | 0120-21A | 1 | Belt A-23 (J) |
| 4 | 0113-01 | 1 | Magnetic Brake 0.8K (T) |
| 5 | 0119-00 | 1 | Reduction Gear |
| 6 | 0116-01 | 1 | Reduction Gear Pulley A76φ (60HZ) |
| 7 | 0706-09 | 1 | Feed Roller Pulley M-100φ |
| 8 | 1007-00 | 1 | Pulley 14φ M56φ |
| 9 | 1014-26 | 1 | Motor 1PH 220V 50HZ 1/8 |
| | 1014-28 | 1 | Motor 1PH 110/220V 60HZ |
| 10 | 0120-07B | 1 | V-Belt M-24(J) |
| 11 | 0113-00 | 1 | Brake Seat |
| 51 | SAEM6X10 | 6 | Flat Screw 6 x 10 x 1.0 |
| 52 | SLCM5X12R | 4 | Socket Head Cap Screw 5 x 12 |
| 53 | SSPWM5R | 4 | Spring Washer 5 mm |
| 54 | SWM8X18X2R | 4 | Plain Washer 8φ x 18φ |
| 55 | SLCM8X20R | 4 | Socket Head Cap Screw 8 X 25R |
| 56 | SSPWM8R | 4 | Spring Washer M8 |
| 57 | KEY-7723 | 1 | Key 7 x 7 x 23 |

Parts:28