

Kit For BACKSPLASH

www.mineraltiles.com

do it
yourself

PEEL & STICK TECHNOLOGY



To assure that your peel & stick mosaics will perform as expected during and after the installation we only use **Stick-On** technology on our peel & stick products and kits.

Installation Guide

IN YOUR BOX

Before get started, please check if your box contains all the items you ordered. Different type kits come with different items, as listed below.



DIY BACKSPLASH KITS

- 15 sheets of peel & stick mosaic tiles
- 1 grout float
- 1 pair of gloves
- 1 bag of spacers
- 1 utility blade
- 1 sponge
- 1 measuring tape
- Premixed grout
- Trim Pieces (only for models that require it) – Check the product's description on our website if you're not sure about it.

DIY ADD PACK KITS

- 5 sheets of peel & stick mosaic tiles
- 1 bag of premixed grout
- Trim Pieces (only for models that require it) – Check the product's description on our website if you're not sure about it.

INDIVIDUAL TILES SHEETS

- The quantity you ordered of Stick-On Tiles
- Tool Box and premixed grout are sold separately.

Important: If your order comes with grout bags, check the bags and search for any leaking. If you find any problem with your purchase, please let us know immediately: info@mineraltiles.com

ADDITIONAL TOOLS

You will need a screwdriver to remove any outlets covers from your backsplash.

www.mineraltiles.com

RECOMMENDED SURFACES

This product will stick well on any flat, clean surface that is free of chemicals, oils or any residue that will not allow the mosaic to adhere. Mosaics can be applied over metal, alloy, glass, stone, drywall, plaster, wood or any other rigid surfaces that is free of oil and dust surface.

Surfaces where paint is peeling or otherwise coming off must be repaired prior to installation of Stick-On mosaics. Also the surface should be uniform and stable before applying mosaic.

Step 1

1 - REMOVE THE OUTLET COVERS

Remove outlet covers with a screwdriver. Make sure that the electricity is turned off before you remove the outlet covers to avoid accidents.



1.1 - MEASURE YOUR BACKSPLASH AND PLAN YOUR INSTALLATION

A. Using the measuring tape check the distance between the countertop and the bottom of the cabinet (or top desired endpoint of tile surface) to calculate the amount of tile needed to fill the space.



B. Place a sheet of mosaic on your counter, cut to appropriate size and test on the wall without peeling the back.

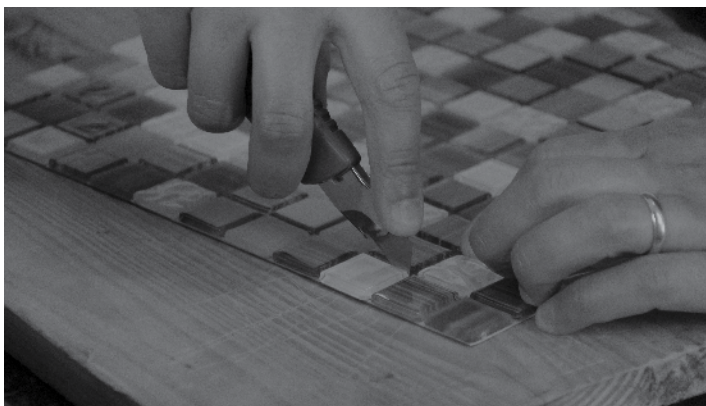

C. Choose an alignment reference (horizontal and vertical) that is level (e.g., the corner of a wall, the top of the counter). Don't forget to check the top, bottom and sides of the tile to make sure it lines up.



1.2 CLEAN THE BACKSPLASH WALL

Use a towel, rag or scrub brush with a glass or multipurpose cleaner to remove any dust, grease or oil that will keep the mosaic from sticking to the backsplash wall. The wall must be dry and clean before starting the installation.

Remove all objects from the countertop. You may also need to move stove, microwave or refrigerator in order have enough space to move around when installing the mosaic.

Step 2

2 - INSTALLATION

A. Peel off half the back of a mosaic sheet and line it up with the countertop. Adjustment may be needed, so leave some space on bottom and top of the installation to allow for a proper fit between the counter and the bottom of the cabinet.

DO NOT APPLY PRESSURE until you are sure that the mosaic is lined up correctly.

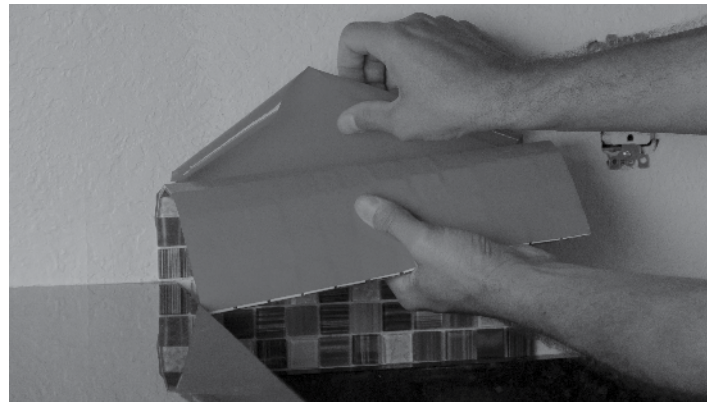

B. Begin the installation from left to right completing the bottom row first. After installing your first row you can begin installing the top row. Take your time and make sure you align the grout joints before you apply pressure. Once you are happy with how your grout joints are lined up use your grout float to apply even more pressure to assure good adhesion to the wall.

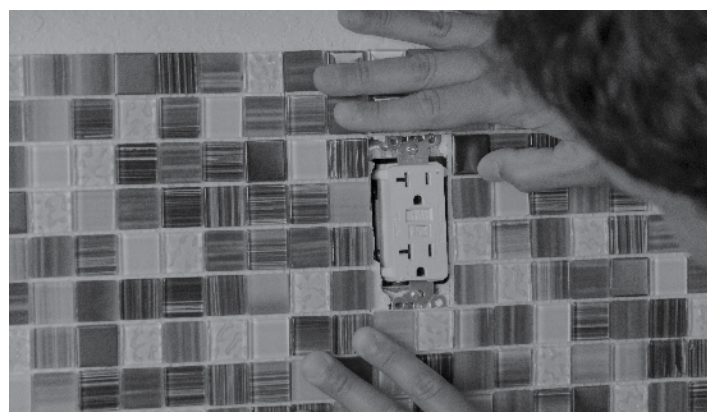

TIPS

1. ADJUSTING THE GROUT JOINTS

For uneven walls you can use your utility knife in between the joints, cutting the peel & stick backing from the row you want to adjust. Then, simply lift the end of the row and reposition. When happy with the results, reapply pressure.

2. OUTLETS AND WALL FAUCETS

Remove all finish plates first. Install the tile and grout before replacing it. Cut the sheets around the fixtures as closely as possible to ensure a seamless look.

3. TACKLING TRICKY AREAS: WINDOWS AND OPENINGS

Make sure you have a plan as to how the mosaic will fit on the backsplash before adhering the tile when working on walls with windows and openings.

Step 3

3 - GROUTING

- A. Open the container and drag an amount of grout onto the float.
- B. Use the float to apply grout to the mosaic in a diagonal pattern, from



bottom to top. Bring the float back across the mosaic in the opposite direction applying additional pressure. Check to see if the joints are completely filled with grout and all excess grout is removed from the tile. Repeat until complete the entire backsplash.



TIP

Grout dries based on humidity and temperature. If this is your first time grouting, apply grout in sections no bigger than 2'x2'. When you finish cleaning the first section, start to grout another section.

Step 4

4 - CLEANING

You can start cleaning within minutes after applying the grout, however do not wait more than 10 minutes because the grout will become more difficult to remove. If your grout is too wet to clean, let it dry for 2-3 minutes and try again.

Start cleaning from where the grout was first applied. Wet the sponge and wipe the tile to remove grout residues. Always use clean water. It may take several passes over tile to clean the surface completely. After cleaning the grout your tile may look lightly hazy. Don't worry, wait for 24 hours and make final cleaning.



DO I NEED TO CAULK?

We recommend that you caulk the edges with a silicon-based caulk to get extra protection for wet areas such as behind the kitchen faucet.

You can also use caulk to finish the edges of the installation.

Before and After





Mineral Tiles
Where tiles come from.

For more information on our products go to www.mineraltiles.com

