

CONTENTS:

- A. 4 Corners
- B. 4 Tubes (1 hole)
- C. 2 Tubes (10 holes)
- D. 2 Tubes (8 holes)
- E. 4 Screws and Nuts to fix the Extension
- F. 1 Thick Rope for Laundry
- G. 1 Thin Rope to Hang up the 
- H. 4 Simple Pulleys for Ceiling
- I. 6 Dowels for Pulley
- J. 2 Double Pulleys for Wall
- K. 1 Reel
- L. 2 Dowels and Screws for Reel
- M. 1 Hook
- N. 1 Dowel for Hook

DRY-SMART FLEX

PLEASE CONSIDER:

- The Dry-Smart should have a distance of 10-15 cm from a wall or column.
- The REEL "K" must have a maximum height of 70 cm from the floor and must be in a vertical line with the DOUBLE PULLEYS FOR WALL "J" of the wall.

Video &

Anleitung auf **DEUTSCH** hier:
 Instructions in **ENGLISH** here:
 Instrucciones en **ESPAÑOL** aquí:
 Istruzioni in **ITALIANO** aquí:
 Instructions en **FRANÇAIS** ici:



dry-smart.com/pages/instructions



After selecting the desired size, secure it with the 2 SCREWS AND NUTS TO FIX THE EXTENSION "E" on each side.

4



Connect each of the 4 CORNERS "A" to a TUBE "B" (1 hole) on the opposite side of the hole.

1



Connect 2 of these CORNERS "A" to each end of a TUBE "C" (10 holes).

2

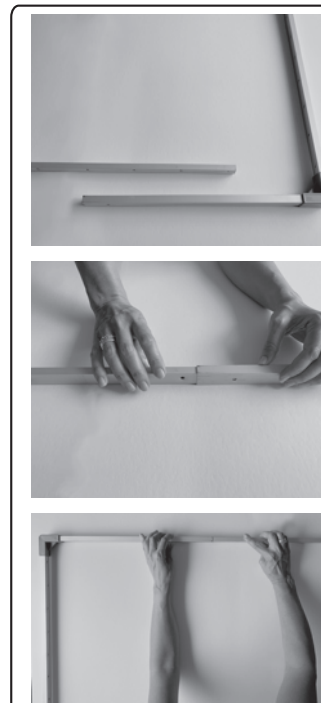

Slide the 2 TUBES "D" (8 holes) into the TUBES "B". Use them to select the final size of your 

3



Insert one end of the THICK ROPE FOR LAUNDRY "F" into the first hole of one of the TUBES "C" (10 holes) and secure with a double knot.

5

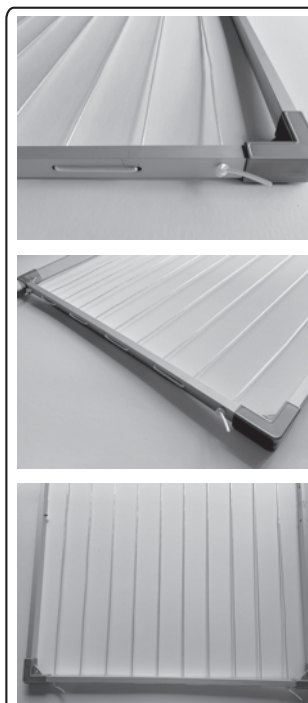

Thread the rest of the rope back and forth. When you have finished, tighten the rope well and secure it with another double knot.

6

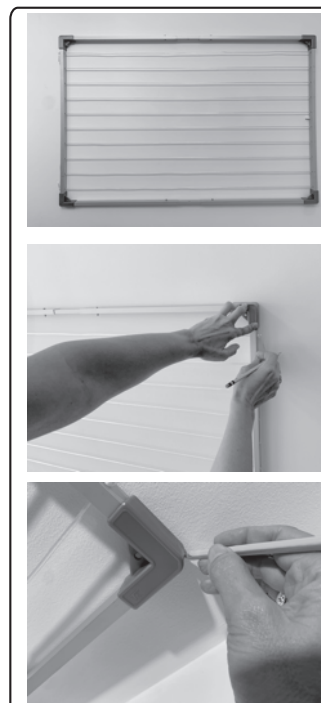

Place the finished frame on the selected area of the ceiling and mark the 4 corners.

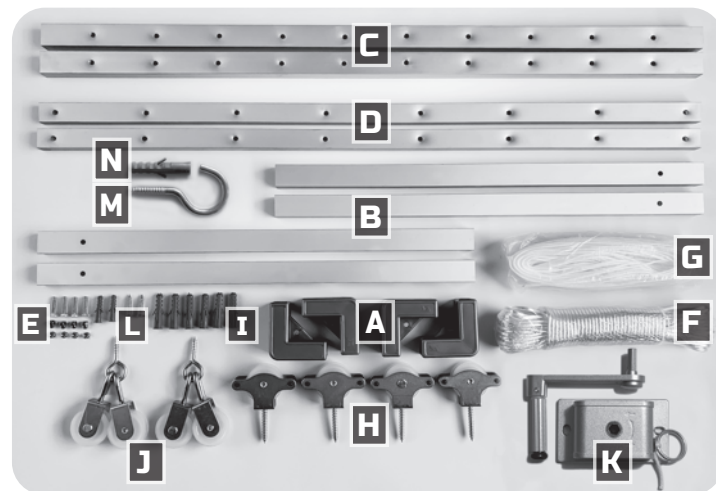

CONTENTS:

- A. 4 Corners
- B. 4 Tubes (1 hole)
- C. 2 Tubes (10 holes)
- D. 2 Tubes (8 holes)
- E. 4 Screws and Nuts to fix the Extension
- F. 1 Thick Rope for Laundry
- G. 1 Thin Rope to Hang up the **DRY-SMART**
- H. 4 Simple Pulleys for Ceiling
- I. 6 Dowels for Pulley
- J. 2 Double Pulleys for Wall
- K. 1 Reel
- L. 2 Dowels and Screws for Reel
- M. 1 Hook
- N. 1 Dowel for Hook



Cut the THIN ROPE TO HANG UP THE DRY-SMART "G" in 4 sections, 2 of 4 meters and 2 of 3.5 meters.

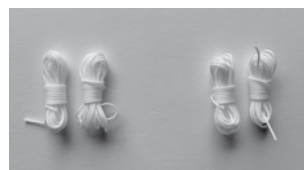

10



Using the drill (8mm drill bit), drill a hole (50mm deep) in each mark. Insert the DOWEL FOR PULLEYS "I" and then, in order not to force and damage the pulleys, we suggest inserting the HOOK "M" once in each dowel, then the SIMPLE PULLEYS FOR CEILING "H "

7

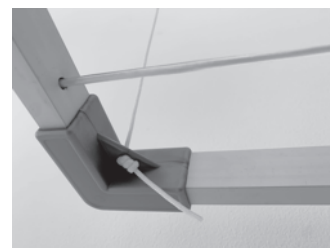
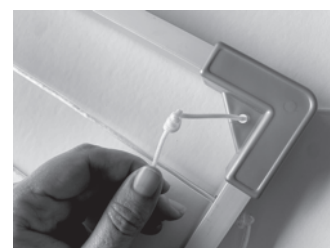

Insert the freshly cut ropes into the holes in the CORNERS "A". The 2 ropes of 4 meter, in the corners furthest from the DOUBLE PULLEYS FOR WALL "J" and the other 2 (3.5 meter ropes) in the corners closest to the corners. To secure the rope properly, tie a triple knot in each rope at the CORNERS "A".

11

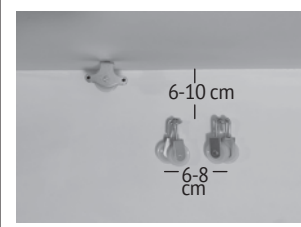
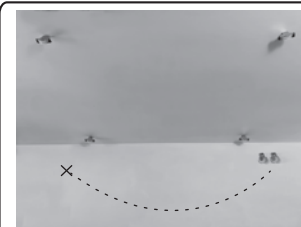

Place the 2 DOUBLE PULLEYS FOR WALL "J" on one side of the frame on the wall at a distance of 6-10 cm from the ceiling and 6-8 cm from each other. Remember to use the DOWELS FOR PULLEY "I" if necessary.

8



Hang the frame by threading the rope from each corner into the corresponding pulley on the ceiling. Take the ropes and bring them to the DOUBLE PULLEYS FOR WALL "J"; spread them out so that they do not cross each other.

To level, pull the 4 ropes until the frame touches the ceiling at all 4 corners.

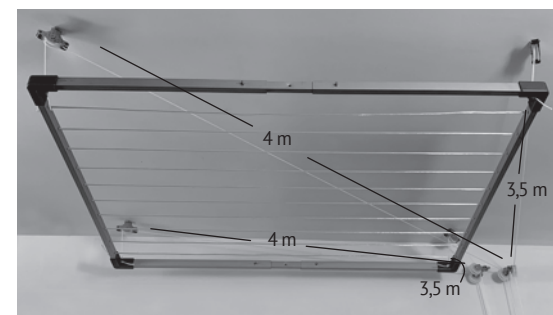

12



Attach the REEL "K" to the wall, under the 2 DOUBLE PULLEYS FOR WALL "J", 70 cm from the floor. To do this, use the 2 DOWELS AND SCREWS FOR REEL "L".

9

While holding them at this point, tie a knot to join the ropes to the REEL "K" hoop. If desired, tie another knot before cutting off the excess rope.



Place HOOK "M" 10-15 cm above ROLLER "K" (use DOWEL FOR HOOK "N" if necessary).

13

Video &

Anleitung auf **DEUTSCH** hier:
 Instructions in **ENGLISH** here:
 Instrucciones en **ESPAÑOL** aquí:
 Istruzioni in **ITALIANO** aquí:
 Instructions en **FRANÇAIS** ici:



dry-smart.com/pages/instructions