

# TBI PRO Dual Vibration Bark Control Collar Manual

READ AND FULLY UNDERSTAND THIS MANUAL BEFORE USE

## Important Safety Information

- This product is designed for no-pain correction with enhanced vibration and tone technology, which helps to stop barking for small & medium dogs with NO SHOCK.
- This product is Vibration Bark Control Collar, the prongs cannot deliver shock.
- This product is NOT intended for use on dogs under 6 months old and less than 8 pounds.
- NOT for use with aggressive dogs. Use the product under supervision.
- For the comfort of your pet, please wear the Prong Covers to the prong before use.
- Avoid leaving the product on dog for more than 12 hours per day. Never connect a leash to the collar.
- Check the contact area daily for signs of rash or a sore. If a rash or sore is found, STOP using the product immediately until the skin heals.
- Wash the dog's neck area and the prong covers and prongs weekly with a damp cloth.
- The product senses the dog's high-frequency barking and other dog's barking may have a very small chance to activate the product. Decrease the sensitivity level when other dog's nearby.

## Product Information

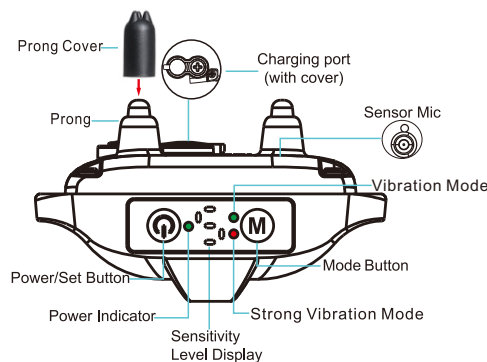
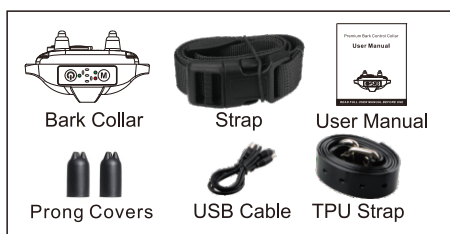

## 1. Test The Product

### 1A. Charge the Bark Control Collar before use.

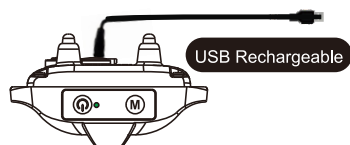

You can charge the product via PC, Power Bank or Adapter with output voltage of 5V for 2-3 hours.

#### Description for Power Indicator

- ★Blink in green, device is charging
- Solid in green, device is fully charged
- Solid in red, device is charged with improper charger

Notes: improper charger means chargers with output voltage over 5V.

### 1B. Power on the Bark Control Collar.

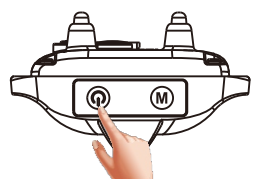

Press and hold the button for 1 second to power on

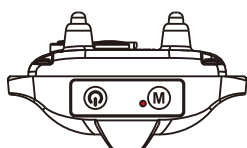

Indicator will be solid red or green after device is powered on.

1C. Set the Bark Control Collar to Test Mode, the display will show digit 0. After that, blow or bark like a dog towards the microphone sensor located at the back of the product.

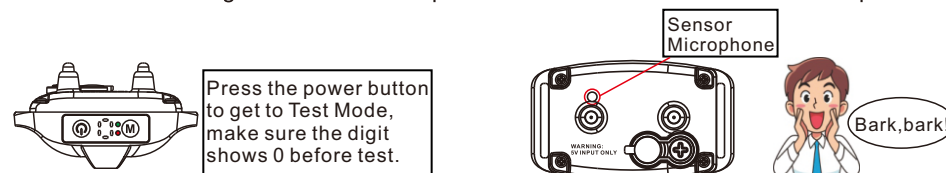

### 1D. The Bark Control Collar Responds at Test Mode:

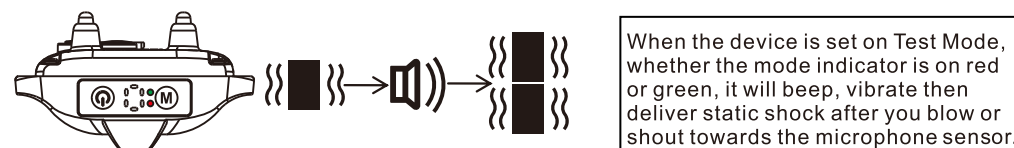

If the product responds as described above, you've succeeded at setting up the collar properly!

## 2. Put The Product on Your Pet

### 2A. Attach the strap to the bark collar.

& Follow the A-B-C-D steps instructed to thread the collar.

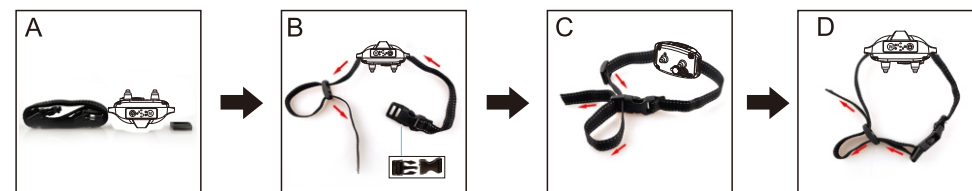

**Notes:** If you have the TPU collar in your package, mark the desired length, leaving some extra inches (if your dog is still young and will grow more or for thicker winter coat), and cut off the excess. Seal the edge of the cut strap by holding it above the fire for a few seconds.

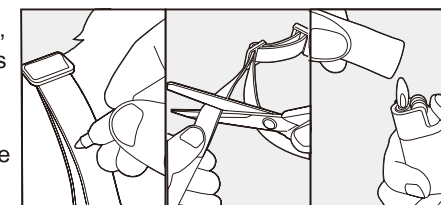

### 2B. Put the product on your dog.

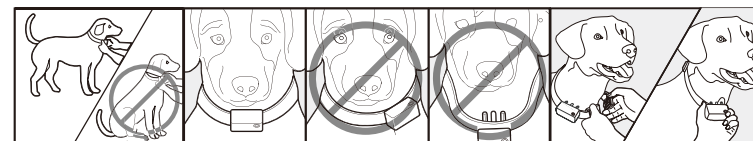

Please ensure to fit the product snugly, yet loose enough to allow one finger to fit between the strap and your pet's neck.



GREAT! Now you have successfully put the Bark Control Collar on your dog and it's ready for training.

### 3.Mode Setting

The following instruction will guide through the processes of switching modes.

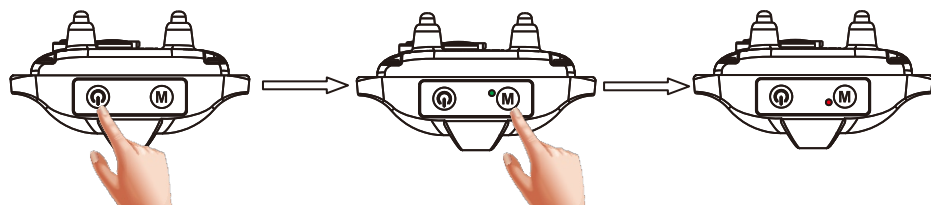

Power on the device by pressing and holding the power button for 1 second.

Mode indicator will display green or red after device powered on. Press the M button to switch Mode Indicator.

Green Mode Indicator means Vibration Mode.  
 Red Mode Indicator means Strong Vibration Mode.

### 4.Indicator & Display

Mode Indicator		Power Indicator		Sensitivity Level
				1 2 3 4 5
<b>SOLID</b>	<b>SOLID</b>	<b>SOLID</b>	<b>BLINKS</b>	<b>SOLID</b>
On Vibration Mode	On Strong Vibration Mode	On charged & fully Charged	Low Battery, or On charged but not fully charged	When device is powered on & charged with improper charger, power indicator will become solid. When device is powered off & charged with improper charger, power indicator remains off and becomes solid when pressing the power button. Notes: Improper chargers mean those with input voltage over 5V.
				Sensitivity level. Level 5 is the most sensitive, level 1 is the least. One press on the power button a time to change the sensitivity levels.
		<b>Test Mode</b>		On Test Mode. Press the power button to get to Test Mode. Display shows digit 0 when it is set on Test Mode, it will automatically display digit 5 after the test completes or test is not conducted within 10 seconds.

### 5.How It Works

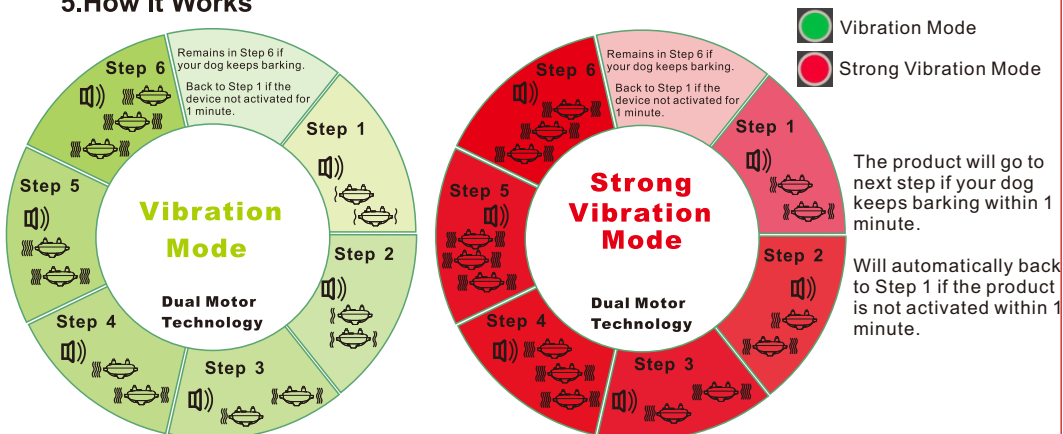

### 6.Frequently Asked Questions & Answers

Q: Why doesn't the product work when the dog barks?

A: Please first ensure to fit the product snugly, yet loose enough to allow one finger to fit between the strap and your pet's neck. Some dogs have weak barking, in this case you will need to level up the sensitivity level. Thick coat on the neck area may also have small chance to decrease the sensing from the barking, trim the coat near the area where you place the product.

Q: Why is the product triggered sometimes in a noisy environment though the dog isn't barking?

A: Though we have optimized the barking detection to the best, some environment noises may have similar frequency to barking, which may have small chance to activate the product. Please lower the sensitivity level.

Q: Can I use the product when there are other dogs playing around?

A: Dogs will bark when playing and get excited, for the comfort and safety of your pet, we don't suggest using this product in such environment.

Q: How do I know if I can use this product for my pet?

A: The product is designed for healthy dogs over 6 months old, weighing no less than 8 pounds. Most importantly, this product cannot be used on unhealthy or aggressive dogs, and if you are unsure whether this product is appropriate for your pet, please consult your veterinarian or a certified trainer.

Q: Can this product stop my dog's howl?

A: No, this Bark Control Collar is designed to detect the barking only. It cannot detect or stop the howling.

Q: Can I charge this product with any type of charger?

A: No, you are suggested to charge this product with charger of 5V output voltage, because charger with output voltage of 9V or 12V may cause damage to the product. The product will stop charging automatically if input voltage becomes too high and the power indicator turns red.

Q: Will my dog stop barking completely?

A: The Bark Control Collar effectively and humanely stops all barking when it is worn. It should only be worn during periods of unwanted barking.

Q: Is the Bark Control Collar safe and humane?

A: Yes. The Bark Control Collar is designed to get your dog's attention, not to punish him. This product does not have the shock unit and it will only deliver tone and vibration correction. However, the initial Strong Vibration Correction may startle your dog.

If the FQA cannot solve your problem or you need more help, please reach to our Customer Service.



**Customer Service :**

support@tbi-pro.com

Just scan the QR code with your iPhone or Android camera to get contact with us.



Scan me to Text us:



Text us: +1 800-674-9229

Scan me to Email us:



Email us: support@tbi-pro.com