

DURONIC

Creative Consumer Electronics



IM120 - Ice Maker

PLEASE READ ALL THE INSTRUCTIONS BEFORE USE



duronicon.com



[duronicon](https://www.youtube.com/channel/UCduronicon)



[@duroniconmedia](https://www.instagram.com/duronicon)



[Duronicon](https://www.facebook.com/duronicon)



[@duroniconmedia](https://www.twitter.com/duronicon)

Contents

English Manual	4
Manuel d'utilisation en français	13
Gebrauchsanleitung auf Deutsch	22
Manual de Instrucciones en Español	31
Manuale D'istruzioni In Italiano	40
Instrukcja obsługi. Polski	49
Gebruikershandleiding Nederlands	58

English Manual

Safety Instructions

PLEASE READ THIS MANUAL CAREFULLY BEFORE USING AND RETAIN IT FOR FUTURE REFERENCE

- This appliance is for indoor/household use only. Do not use outdoors.
- The IM120 Ice Maker is only for domestic use, it is not for commercial use.
- This appliance is not intended for use by persons (including children) with reduced physical, sensory or mental capabilities, or lack of experience and knowledge, unless they have been given supervision or instruction concerning use of the appliance by a person responsible for their safety.
- Do not operate this appliance if the power cable or plug is damaged. If either is damaged, return the machine to Duronic for service or repair by professional technician.
- Please ensure the mains power supply is 220-240V / 50Hz.
- Never try to replace the parts and repair the unit by yourself.
- To reduce the risk of electric shock, never operate this product near water, with wet hands, spill liquid on the appliance or submerge it in water or any other liquid.
- Do not use the ice maker machine near gas or other inflammable materials (such as benzene, paint thinner, sprays, etc.)
- Do not place the appliance on or near a hot gas or on a heated oven.
- Keep the machine 15cm from other objects to ensure heat has space to escape from the vents.
- Do not put any extension leads or portable power supplies near or behind the appliance.
- Do not use any accessories which are not recommended by Duronic.
- Do not insert any foreign or electrical objects into the appliance.
- Do not store explosive substances such as aerosol cans with a flammable propellant in or next to this appliance.
- The refrigerant and insulation blowing gas inside this machine is flammable. When disposing of the appliance, do so only at an authorised waste disposal centre. Do not expose the appliance to flames.
- Unplug the appliance after using it or before cleaning it.
- When cleaning the ice maker machine, do not use sharp utensils, steel

Safety Instructions (Continued)

wool, metal scouring pads or abrasive cleaners as they will scratch or damage the appliance.

- Do not use distilled water in this machine. Mineral water is recommended.
- When moving the appliance, do not tilt the machine more than 45 degrees and do not turn the machine upside down. This may damage the compressor and the sealing system.
- It is normal for the compressor and condenser surface to reach temperatures between 70°C and 90°C during operation and the surrounding areas may be very hot.
- Due to the fast freezing process, ice cubes may appear “cloudy”. This is normal, it is air trapped in the water during the freezing process and it will not affect the quality or taste of the ice.

Specifications

MODEL	POWER	VOLTAGE RATING	WATER TANK CAPACITY	DIMENSIONS
ICM120	120W	220-240V / 50Hz	1.5L	22.4 x 30.8 x 28.3cm

Features:

- The IM120 makes bullet-shaped ice cubes
- Up to 9 pieces of ice can be made per eight minutes
- Daily ice output: 12kg / 26.5lbs per 24 hours
- Ice storage facility: 1.5L / 600g
- Refrigerant: R600a
- Noise level: $\leq 60\text{dB(A)}$ [ambient noise level $\leq 17\text{dB(A)}$]
- Prompts when ice basket is full and when water level is insufficient.

Components

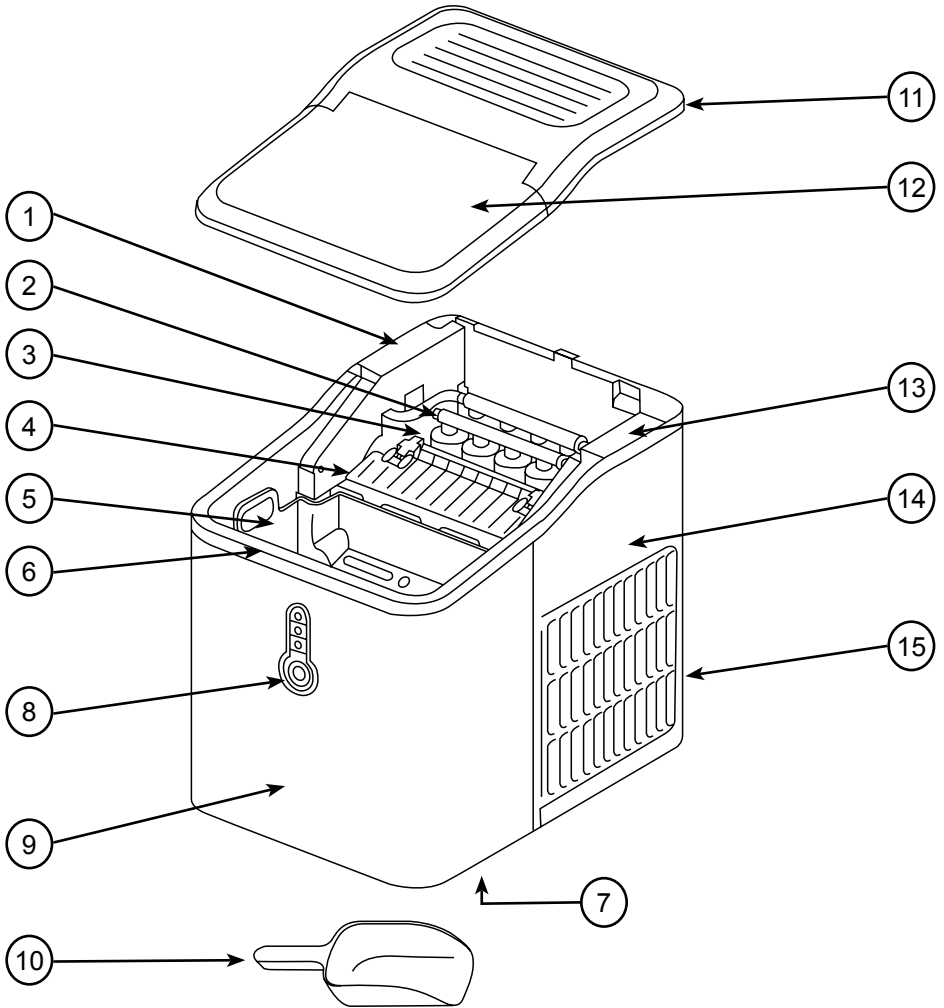

- 1. Micro switch
- 2. Evaporator
- 3. Water tray
- 4. Ice shovel
- 5. Ice basket
- 6. Water tank

- 7. Drainage plug
- 8. Control panel
- 9. Front housing
- 10. Ice scoop
- 11. Top cover
- 12. Transparent lid

- 13. Motor
- 14. Back housing
- 15. Air vent

Before First Use

- Before first use, remove all the packing materials, check the machine carefully and make sure that the machine, power cable and plug are normal and do not have any damage.
- The machine should be positioned on a level surface. To ensure sufficient ventilation, the distance of the back of ice maker to the wall and surrounding objects should be at least 15cm. It should not be positioned near an oven, radiator or any other heat source.
- Before using the machine for the first time, place the machine and leave the transparent cover open for at least two hours.
- Distilled water should not be used. Mineral water is recommended.

The Control Panel

There are light 3 indicators and 1 button on the control panel:

ICE FULL	Ice full alarm
ADD WATER	Water shortage alarm
ICE MAKING	Ice is being produced
	Power button



Before First Use

ICE MAKING:

- When you plug in the ice maker machine the ICE MAKING light indicator will flash.
- Press the power button to switch on the machine. The ICE MAKING indicator light will stay on and the machine will start to make ice cubes.
- After the first batch of ice cubes have finished being made, the de-icing will activate, followed by the ice shovel which will move the ice into the ice basket.

ADD WATER:

- When the ADD WATER light turns red, it means that there is not enough water left in the tank. You will need to add more water and then press the power button to restart the machine.



Do not fill up the tank directly from a tap. When refilling the water tank, use a bottle or jug to pour water into it.

ICE FULL:

- When the ice cubes fill up the ice basket and it reaches the maximum capacity, the ICE FULL light will flash, and the machine will automatically stop. You will then need to empty the ice basket using the ice scoop.
- Once the sensor inside the machine can detect the ice basket is empty, the machine will restart automatically and continue making ice cubes.

How to Use

1. Open the transparent lid, take out the ice basket and add water to the water tank. The water should not exceed the MAX mark.
Use either cold or room-temperature water to fill the tank. Do not fill the tank with hot water.
If the water exceeds the MAX mark, you will need to drain a little water away. You do this by opening the bottom drain plug and releasing some water.
2. Put the ice basket back into the machine and close the lid.
3. Plug in the machine and switch it on at the plug.
4. Press the power button to start the machine.
5. The machine will start to make ice cubes.
6. The ICE MAKING indicator light will light up stay on while the machine works making the ice cubes.
7. When the ice basket is full, the machine will automatically stop. Remove the ice cubes using the ice scoop. The machine will then restart and

continue making ice cubes.

8. When you have finished making ice cubes, turn off the machine by pressing the power button again. Switch off the plug socket and unplug the cable from the mains socket.

Cleaning and Maintenance

Clean the inside of the machine (ice basket, water tank, ice shovel) and the ice scoop frequently.

How to clean your ice maker:

1. Switch off the machine and allow it to de-ice for a 2-3 hours. Do not use any mechanical devices or any other means to accelerate the defrosting process.
2. Before cleaning, unplug the machine and remove any ice cubes from the ice basket.
3. Use a diluted solution of water and white vinegar to clean the inside and the outside surface of the machine using a cloth. Do not use chemicals or diluted agents such as acids, gasoline or oil on the machine.
4. After using the water/vinegar solution to wipe over the machine, rinse the cloth in water and wipe over the same parts again to clean away the solution.
5. Allow the machine to air and dry thoroughly. Keep ventilation openings in/on the machine clear of obstruction.

To ensure the ice made is fresh, change the water in the reservoir at least once a day. If you do not plan to use the machine for a long time, drain the water out and clean the machine before storing it away.

Troubleshooting

Note: If the power is accidentally disconnected while the machine is on during an ice making cycle, small ice chips may form and lodge in the ice shovel. If this occurs, check that the machine is switched off at the mains socket, then gently push the shovel backwards towards the rear of the machine to remove ice chips. Then restart the machine as normal.

Problem	Possible Cause	Suggested Solutions
The ice shovel does not move ice into the ice basket.	The water tank is not on a flat even surface.	Check that the surface the machine is on is flat and even. With the machine switched off at the plug, gently push the ice shovel using your finger, then press the power button to restart it.
The compressor works abnormally with a buzzing noise	The voltage is lower than recommended.	Stop the machine and do not restart it until it's plugged into the correct voltage.
Water shortage indicator light is on.	1. There is no water 2. The pump is full of air	1. Add to some water until it reaches MAX position. 2. Press POWER button to restart the machine.
Indicator lights on display are not on.	1) No power 2) Blown fuse	1) Turn the power on 2) Replace fuse
The Ice made is too large and with pieces sticking together.	Ice of previous cycles left in the water tray.	Take out the ice under the standby state.
The ice making process was correct, but no ice has come out.	1. The compressor has no refrigerant 2. Compressor damaged 3. Fan motor damaged	Call Duronic Customer Care Team for advice.
All indicators twinkle simultaneously.	Water tray is blocked by ice cubes.	Unplug the power, take out the ice which blocking the tray, then plug in the power and press the POWER button. The machine will restart after around 3 minutes.
The machine has been working, but the water has been warming up	Solenoid has broken down	Call Duronic Customer Care Team for advice
When the ice is full, the machine does not display the ICE FULL icon	'Ice Full' sensor is damaged	Call Duronic Customer Care Team for advice

Warranty

1 Year Guarantee from Shine-Mart Ltd, Trademark owners of Duronic Products.

NOTE: THESE STATEMENTS DO NOT AFFECT YOUR STATUTORY RIGHTS AS A CONSUMER

This product has been manufactured under the strictest or quality control procedures, and using the highest quality of materials, to ensure excellent performance and reliability. It will give very good and long lasting service, provided it is properly used and maintained. The product is guaranteed for 1 years from the date of original purchase. If any defect arises due to a faulty materials or poor workmanship, the faulty product must be returned to the original place of purchase. Refund or replacement is at the discretion of that company. Duronic Products are offered with a 1 year guarantee under the following conditions:

1. The product must be returned to the retailer with original proof of purchase.
2. The product must be installed and used in accordance with the instructions contained in this operating manual.
3. It must be used only for domestic purposes.
4. It does not cover wear and tear, malicious damage, misuse, neglect, inexpert repairs or consumable parts.
5. Shine-Mart Ltd has no responsibilities for accidental or consequential loss or damage.
6. Shine-Mart Ltd are not liable to carry out any type of servicing work, under the guarantee
7. Valid in the UK only



This product is fitted with CE:1363 plug and fuse
Imported by Shine-Mart Ltd, RM3 8SB



Information on waste Disposal for Consumers of
Electrical & Electronic Equipment.

This mark on a product and/or accompanying documents indicates that when it is to be disposed of, it must be treated as Waste Electrical & Electronic Equipment, (WEEE).

Any WEEE marked products must not be mixed with general household waste, but kept separate for the treatment, recovery and recycling of the materials used. For proper treatment, recovery and recycling; please take all WEEE marked waste to your Local Authority Civic waste site, where it will be accepted free of charge.

If customers dispose of Waste Electrical & Electronic Equipment correctly, they will be helping to save valuable resources and preventing any potential negative effects upon human health and the environment, of any hazardous materials that the waste may contain.

Follow Us



duronic.com



[duronic](https://www.youtube.com/channel/UCduronic)



[@duronicmedia](https://www.instagram.com/duronicmedia)



[Duronic](https://www.facebook.com/duronic)



[@duronicmedia](https://twitter.com/duronicmedia)

Manuel d'utilisation en français

Safety Instructions

PLEASE READ THIS MANUAL CAREFULLY BEFORE USING AND RETAIN IT FOR FUTURE REFERENCE

- This appliance is for indoor/household use only. Do not use outdoors.
- The IM120 Ice Maker is only for domestic use, it is not for commercial use.
- This appliance is not intended for use by persons (including children) with reduced physical, sensory or mental capabilities, or lack of experience and knowledge, unless they have been given supervision or instruction concerning use of the appliance by a person responsible for their safety.
- Do not operate this appliance if the power cable or plug is damaged. If either is damaged, return the machine to Duronic for service or repair by professional technician.
- Please ensure the mains power supply is 220-240V / 50Hz.
- Never try to replace the parts and repair the unit by yourself.
- To reduce the risk of electric shock, never operate this product near water, with wet hands, spill liquid on the appliance or submerge it in water or any other liquid.
- Do not use the ice maker machine near gas or other inflammable materials (such as benzene, paint thinner, sprays, etc.)
- Do not place the appliance on or near a hot gas or on a heated oven.
- Keep the machine 15cm from other objects to ensure heat has space to escape from the vents.
- Do not put any extension leads or portable power supplies near or behind the appliance.
- Do not use any accessories which are not recommended by Duronic.
- Do not insert any foreign or electrical objects into the appliance.
- Do not store explosive substances such as aerosol cans with a flammable propellant in or next to this appliance.
- The refrigerant and insulation blowing gas inside this machine is flammable. When disposing of the appliance, do so only at an authorised waste disposal centre. Do not expose the appliance to flames.
- Unplug the appliance after using it or before cleaning it.
- When cleaning the ice maker machine, do not use sharp utensils, steel

Safety Instructions (Continued)

wool, metal scouring pads or abrasive cleaners as they will scratch or damage the appliance.

- Do not use distilled water in this machine. Mineral water is recommended.
- When moving the appliance, do not tilt the machine more than 45 degrees and do not turn the machine upside down. This may damage the compressor and the sealing system.
- It is normal for the compressor and condenser surface to reach temperatures between 70°C and 90°C during operation and the surrounding areas may be very hot.
- Due to the fast freezing process, ice cubes may appear “cloudy”. This is normal, it is air trapped in the water during the freezing process and it will not affect the quality or taste of the ice.

Specifications

MODEL	POWER	VOLTAGE RATING	WATER TANK CAPACITY	DIMENSIONS
ICM120	120W	220-240V / 50Hz	1.5L	22.4 x 30.8 x 28.3cm

Features:

- The IM120 makes bullet-shaped ice cubes
- Up to 9 pieces of ice can be made per eight minutes
- Daily ice output: 12kg / 26.5lbs per 24 hours
- Ice storage facility: 1.5L / 600g
- Refrigerant: R600a
- Noise level: $\leq 60\text{dB(A)}$ [ambient noise level $\leq 17\text{dB(A)}$]
- Prompts when ice basket is full and when water level is insufficient.

Components

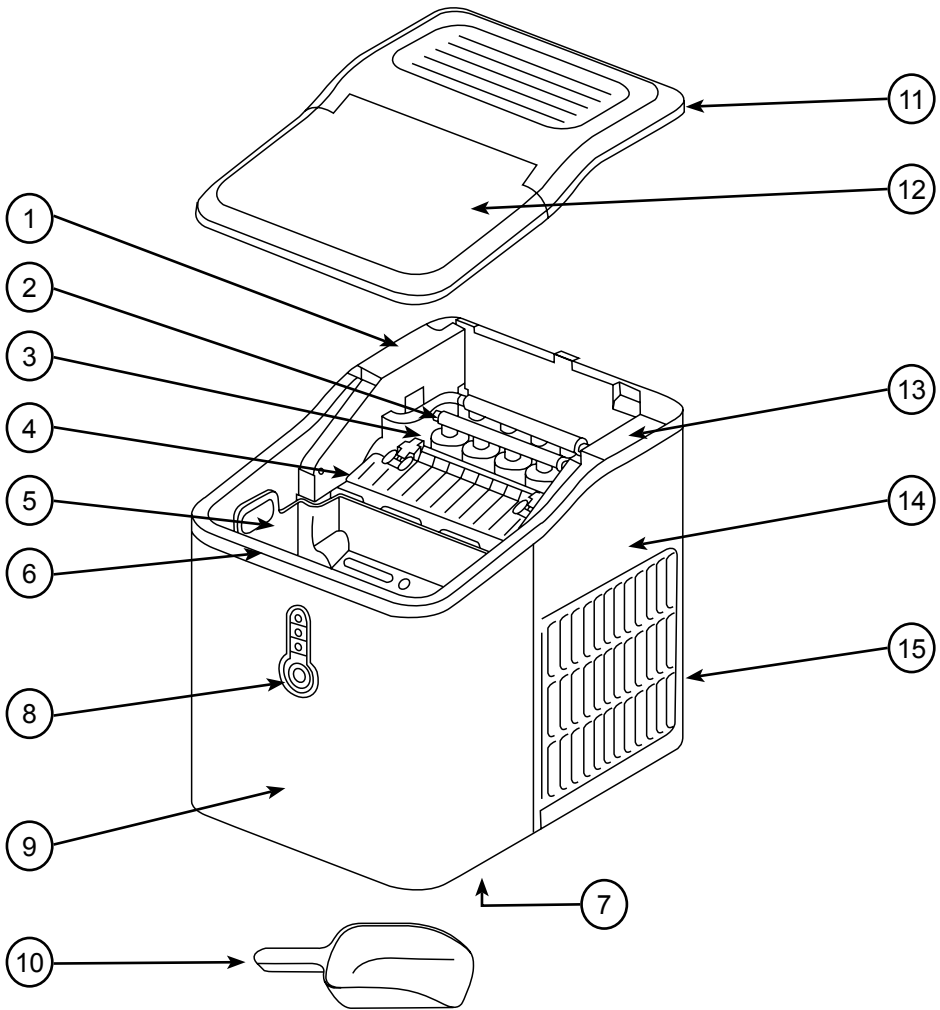

- 1. Micro switch
- 2. Evaporator
- 3. Water tray
- 4. Ice shovel
- 5. Ice basket
- 6. Water tank

- 7. Drainage plug
- 8. Control panel
- 9. Front housing
- 10. Ice scoop
- 11. Top cover
- 12. Transparent lid

- 13. Motor
- 14. Back housing
- 15. Air vent

Before First Use

- Before first use, remove all the packing materials, check the machine carefully and make sure that the machine, power cable and plug are normal and do not have any damage.
- The machine should be positioned on a level surface. To ensure sufficient ventilation, the distance of the back of ice maker to the wall and surrounding objects should be at least 15cm. It should not be positioned near an oven, radiator or any other heat source.
- Before using the machine for the first time, place the machine and leave the transparent cover open for at least two hours.
- Distilled water should not be used. Mineral water is recommended.

The Control Panel

There are light 3 indicators and 1 button on the control panel:

ICE FULL	Ice full alarm
ADD WATER	Water shortage alarm
ICE MAKING	Ice is being produced
	Power button



Before First Use

ICE MAKING:

- When you plug in the ice maker machine the ICE MAKING light indicator will flash.
- Press the power button to switch on the machine. The ICE MAKING indicator light will stay on and the machine will start to make ice cubes.
- After the first batch of ice cubes have finished being made, the de-icing will activate, followed by the ice shovel which will move the ice into the ice basket.

ADD WATER:

- When the ADD WATER light turns red, it means that there is not enough water left in the tank. You will need to add more water and then press the power button to restart the machine.



Do not fill up the tank directly from a tap. When refilling the water tank, use a bottle or jug to pour water into it.

ICE FULL:

- When the ice cubes fill up the ice basket and it reaches the maximum capacity, the ICE FULL light will flash, and the machine will automatically stop. You will then need to empty the ice basket using the ice scoop.
- Once the sensor inside the machine can detect the ice basket is empty, the machine will restart automatically and continue making ice cubes.

How to Use

1. Open the transparent lid, take out the ice basket and add water to the water tank. The water should not exceed the MAX mark.

Use either cold or room-temperature water to fill the tank. Do not fill the tank with hot water.

If the water exceeds the MAX mark, you will need to drain a little water away. You do this by opening the bottom drain plug and releasing some water.

2. Put the ice basket back into the machine and close the lid.
3. Plug in the machine and switch it on at the plug.
4. Press the power button to start the machine.
5. The machine will start to make ice cubes.
6. The ICE MAKING indicator light will light up stay on while the machine works making the ice cubes.
7. When the ice basket is full, the machine will automatically stop. Remove the ice cubes using the ice scoop. The machine will then restart and

continue making ice cubes.

8. When you have finished making ice cubes, turn off the machine by pressing the power button again. Switch off the plug socket and unplug the cable from the mains socket.

Cleaning and Maintenance

Clean the inside of the machine (ice basket, water tank, ice shovel) and the ice scoop frequently.

How to clean your ice maker:

1. Switch off the machine and allow it to de-ice for a 2-3 hours. Do not use any mechanical devices or any other means to accelerate the defrosting process.
2. Before cleaning, unplug the machine and remove any ice cubes from the ice basket.
3. Use a diluted solution of water and white vinegar to clean the inside and the outside surface of the machine using a cloth. Do not use chemicals or diluted agents such as acids, gasoline or oil on the machine.
4. After using the water/vinegar solution to wipe over the machine, rinse the cloth in water and wipe over the same parts again to clean away the solution.
5. Allow the machine to air and dry thoroughly. Keep ventilation openings in/on the machine clear of obstruction.

To ensure the ice made is fresh, change the water in the reservoir at least once a day. If you do not plan to use the machine for a long time, drain the water out and clean the machine before storing it away.

Troubleshooting

Note: If the power is accidentally disconnected while the machine is on during an ice making cycle, small ice chips may form and lodge in the ice shovel. If this occurs, check that the machine is switched off at the mains socket, then gently push the shovel backwards towards the rear of the machine to remove ice chips. Then restart the machine as normal.

Problem	Possible Cause	Suggested Solutions
The ice shovel does not move ice into the ice basket.	The water tank is not on a flat even surface.	Check that the surface the machine is on is flat and even. With the machine switched off at the plug, gently push the ice shovel using your finger, then press the power button to restart it.
The compressor works abnormally with a buzzing noise	The voltage is lower than recommended.	Stop the machine and do not restart it until it's plugged into the correct voltage.
Water shortage indicator light is on.	1. There is no water 2. The pump is full of air	1. Add to some water until it reaches MAX position. 2. Press POWER button to restart the machine.
Indicator lights on display are not on.	1) No power 2) Blown fuse	1) Turn the power on 2) Replace fuse
The Ice made is too large and with pieces sticking together.	Ice of previous cycles left in the water tray.	Take out the ice under the standby state.
The ice making process was correct, but no ice has come out.	1. The compressor has no refrigerant 2. Compressor damaged 3. Fan motor damaged	Call Duronic Customer Care Team for advice.
All indicators twinkle simultaneously.	Water tray is blocked by ice cubes.	Unplug the power, take out the ice which blocking the tray, then plug in the power and press the POWER button. The machine will restart after around 3 minutes.
The machine has been working, but the water has been warming up	Solenoid has broken down	Call Duronic Customer Care Team for advice
When the ice is full, the machine does not display the ICE FULL icon	'Ice Full' sensor is damaged	Call Duronic Customer Care Team for advice

Garantie

Garantie et service après-vente

1 an de garantie de la part de Shine-Mart Ltd, propriétaire de la marque Duronic.

NOTE : CES DÉCLARATIONS N'AFECTENT EN RIEN VOTRE DROIT STATUTAIRE EN TANT QUE CONSOMMATEUR

Ce produit a été produit en suivant les procédures de contrôle de qualité les plus strictes en utilisant des matériaux de qualité pour assurer une excellente durabilité et performance.

Cette centrifugeuse vous offrira de longues années de service tant que vous utilisez correctement cette machine et suivez les instructions de maintenance contenues dans ce manuel. Ce produit est garanti pour 1 an à partir de la date originelle d'achat. Si ce produit était endommagée en raison d'un problème électrique ou d'une fabrication imparfaite, le produit défectueux peut être remplacé au vendeur à la discrétion de la marque sous conditions:

1. Le produit doit être retourné avec la preuve originale d'achat.
2. Le produit doit être installé et utilisé en accord avec les instructions contenues dans ce manuel d'utilisation.
3. Le produit doit être réservé à un usage privé.
4. La garantie ne protège pas contre les dommages dus à l'usure normale, l'utilisation malveillante, la mauvaise utilisation, la négligence, les réparations conduites par des non-experts ainsi que les pièces consommables.
5. Shine-Mart Ltd ne porte pas de responsabilité pour tout dommage ou perte accidentel ou conséquent causé par ce produit.
6. Shine-Mart Ltd se dégage de toute responsabilité en matière de réparation durant la période de garantie.
7. Valide dans toute l'Union Européenne.



Ce produit est fourni avec une prise européenne et un fusible de 3 ampères.
Importé par Shine-Mart Ltd, RM3 8SB.



Ce symbole apparaît sur le produit et/ou les documents accompagnant ce produit pour indiquer que pour procéder à la destruction de ce produit, celui-ci doit être traité comme un déchet électrique et électronique (WEEE). Les produits marqués WEEE ne doivent être mélangés avec les déchets ménagers et doivent être séparés pour traitement et recyclage des composants. Afin de traiter et recycler ce produit, veuillez déposer tous les composants marqués WEEE au site de recyclage le plus proche où ce produit sera repris gratuitement. Si les clients jettent les déchets électriques et électroniques WEEE correctement, ce geste aidera la préservation de ressources précieuses et prévient les potentiels effets négatifs que ces composants ou tout autre composant dangereux ont sur la santé humaine et l'environnement.

suivez nous



www.duronic.com



[@duronic_france](https://www.instagram.com/duronic_france)



[Duronic France](https://www.facebook.com/Duronic France)



[@Duronic_France](https://www.twitter.com/Duronic_France)

Gebrauchsanleitung auf Deutsch

Safety Instructions

PLEASE READ THIS MANUAL CAREFULLY BEFORE USING AND RETAIN IT FOR FUTURE REFERENCE

- This appliance is for indoor/household use only. Do not use outdoors.
- The IM120 Ice Maker is only for domestic use, it is not for commercial use.
- This appliance is not intended for use by persons (including children) with reduced physical, sensory or mental capabilities, or lack of experience and knowledge, unless they have been given supervision or instruction concerning use of the appliance by a person responsible for their safety.
- Do not operate this appliance if the power cable or plug is damaged. If either is damaged, return the machine to Duronic for service or repair by professional technician.
- Please ensure the mains power supply is 220-240V / 50Hz.
- Never try to replace the parts and repair the unit by yourself.
- To reduce the risk of electric shock, never operate this product near water, with wet hands, spill liquid on the appliance or submerge it in water or any other liquid.
- Do not use the ice maker machine near gas or other inflammable materials (such as benzene, paint thinner, sprays, etc.)
- Do not place the appliance on or near a hot gas or on a heated oven.
- Keep the machine 15cm from other objects to ensure heat has space to escape from the vents.
- Do not put any extension leads or portable power supplies near or behind the appliance.
- Do not use any accessories which are not recommended by Duronic.
- Do not insert any foreign or electrical objects into the appliance.
- Do not store explosive substances such as aerosol cans with a flammable propellant in or next to this appliance.
- The refrigerant and insulation blowing gas inside this machine is flammable. When disposing of the appliance, do so only at an authorised waste disposal centre. Do not expose the appliance to flames.
- Unplug the appliance after using it or before cleaning it.
- When cleaning the ice maker machine, do not use sharp utensils, steel

Safety Instructions (Continued)

wool, metal scouring pads or abrasive cleaners as they will scratch or damage the appliance.

- Do not use distilled water in this machine. Mineral water is recommended.
- When moving the appliance, do not tilt the machine more than 45 degrees and do not turn the machine upside down. This may damage the compressor and the sealing system.
- It is normal for the compressor and condenser surface to reach temperatures between 70°C and 90°C during operation and the surrounding areas may be very hot.
- Due to the fast freezing process, ice cubes may appear “cloudy”. This is normal, it is air trapped in the water during the freezing process and it will not affect the quality or taste of the ice.

Specifications

MODEL	POWER	VOLTAGE RATING	WATER TANK CAPACITY	DIMENSIONS
ICM120	120W	220-240V / 50Hz	1.5L	22.4 x 30.8 x 28.3cm

Features:

- The IM120 makes bullet-shaped ice cubes
- Up to 9 pieces of ice can be made per eight minutes
- Daily ice output: 12kg / 26.5lbs per 24 hours
- Ice storage facility: 1.5L / 600g
- Refrigerant: R600a
- Noise level: $\leq 60\text{dB(A)}$ [ambient noise level $\leq 17\text{dB(A)}$]
- Prompts when ice basket is full and when water level is insufficient.

Components

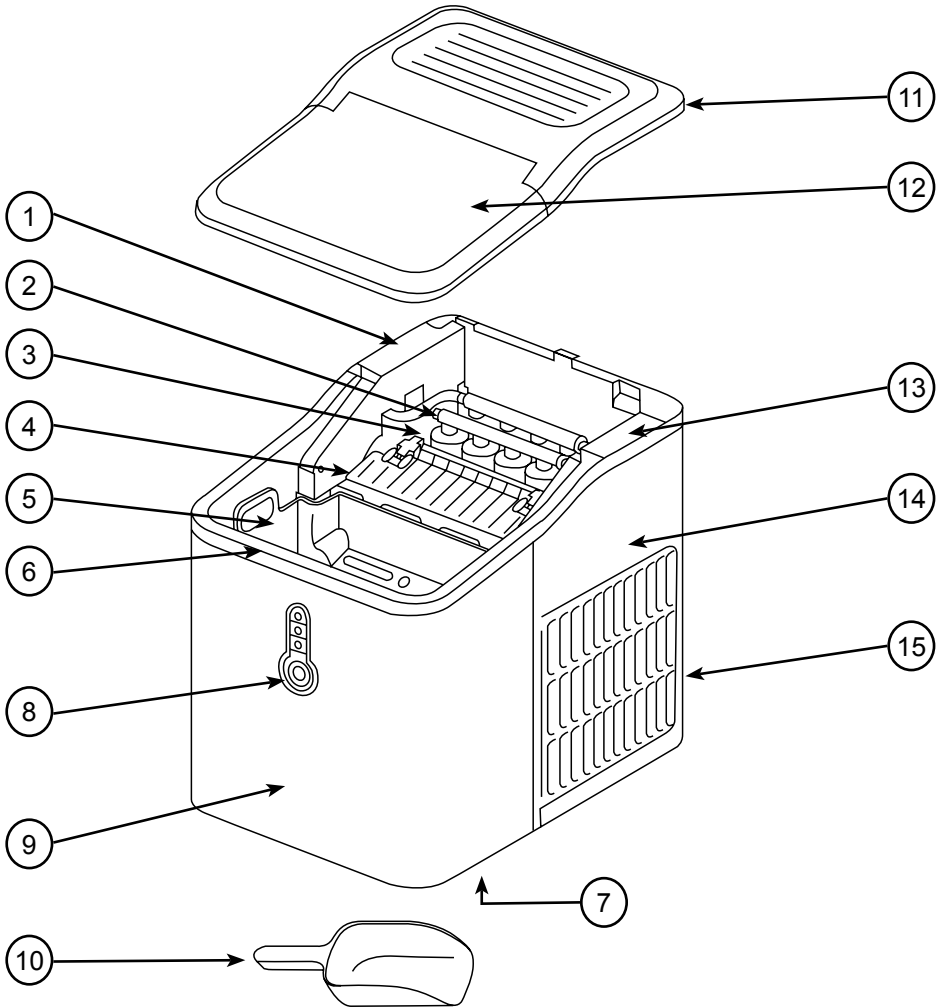

- 1. Micro switch
- 2. Evaporator
- 3. Water tray
- 4. Ice shovel
- 5. Ice basket
- 6. Water tank

- 7. Drainage plug
- 8. Control panel
- 9. Front housing
- 10. Ice scoop
- 11. Top cover
- 12. Transparent lid

- 13. Motor
- 14. Back housing
- 15. Air vent

Before First Use

- Before first use, remove all the packing materials, check the machine carefully and make sure that the machine, power cable and plug are normal and do not have any damage.
- The machine should be positioned on a level surface. To ensure sufficient ventilation, the distance of the back of ice maker to the wall and surrounding objects should be at least 15cm. It should not be positioned near an oven, radiator or any other heat source.
- Before using the machine for the first time, place the machine and leave the transparent cover open for at least two hours.
- Distilled water should not be used. Mineral water is recommended.

The Control Panel

There are light 3 indicators and 1 button on the control panel:

ICE FULL	Ice full alarm
ADD WATER	Water shortage alarm
ICE MAKING	Ice is being produced
	Power button



Before First Use

ICE MAKING:

- When you plug in the ice maker machine the ICE MAKING light indicator will flash.
- Press the power button to switch on the machine. The ICE MAKING indicator light will stay on and the machine will start to make ice cubes.
- After the first batch of ice cubes have finished being made, the de-icing will activate, followed by the ice shovel which will move the ice into the ice basket.

ADD WATER:

- When the ADD WATER light turns red, it means that there is not enough water left in the tank. You will need to add more water and then press the power button to restart the machine.



Do not fill up the tank directly from a tap. When refilling the water tank, use a bottle or jug to pour water into it.

ICE FULL:

- When the ice cubes fill up the ice basket and it reaches the maximum capacity, the ICE FULL light will flash, and the machine will automatically stop. You will then need to empty the ice basket using the ice scoop.
- Once the sensor inside the machine can detect the ice basket is empty, the machine will restart automatically and continue making ice cubes.

How to Use

1. Open the transparent lid, take out the ice basket and add water to the water tank. The water should not exceed the MAX mark.
Use either cold or room-temperature water to fill the tank. Do not fill the tank with hot water.
If the water exceeds the MAX mark, you will need to drain a little water away. You do this by opening the bottom drain plug and releasing some water.
2. Put the ice basket back into the machine and close the lid.
3. Plug in the machine and switch it on at the plug.
4. Press the power button to start the machine.
5. The machine will start to make ice cubes.
6. The ICE MAKING indicator light will light up stay on while the machine works making the ice cubes.
7. When the ice basket is full, the machine will automatically stop. Remove the ice cubes using the ice scoop. The machine will then restart and

continue making ice cubes.

8. When you have finished making ice cubes, turn off the machine by pressing the power button again. Switch off the plug socket and unplug the cable from the mains socket.

Cleaning and Maintenance

Clean the inside of the machine (ice basket, water tank, ice shovel) and the ice scoop frequently.

How to clean your ice maker:

1. Switch off the machine and allow it to de-ice for a 2-3 hours. Do not use any mechanical devices or any other means to accelerate the defrosting process.
2. Before cleaning, unplug the machine and remove any ice cubes from the ice basket.
3. Use a diluted solution of water and white vinegar to clean the inside and the outside surface of the machine using a cloth. Do not use chemicals or diluted agents such as acids, gasoline or oil on the machine.
4. After using the water/vinegar solution to wipe over the machine, rinse the cloth in water and wipe over the same parts again to clean away the solution.
5. Allow the machine to air and dry thoroughly. Keep ventilation openings in/on the machine clear of obstruction.

To ensure the ice made is fresh, change the water in the reservoir at least once a day. If you do not plan to use the machine for a long time, drain the water out and clean the machine before storing it away.

Troubleshooting

Note: If the power is accidentally disconnected while the machine is on during an ice making cycle, small ice chips may form and lodge in the ice shovel. If this occurs, check that the machine is switched off at the mains socket, then gently push the shovel backwards towards the rear of the machine to remove ice chips. Then restart the machine as normal.

Problem	Possible Cause	Suggested Solutions
The ice shovel does not move ice into the ice basket.	The water tank is not on a flat even surface.	Check that the surface the machine is on is flat and even. With the machine switched off at the plug, gently push the ice shovel using your finger, then press the power button to restart it.
The compressor works abnormally with a buzzing noise	The voltage is lower than recommended.	Stop the machine and do not restart it until it's plugged into the correct voltage.
Water shortage indicator light is on.	1. There is no water 2. The pump is full of air	1. Add to some water until it reaches MAX position. 2. Press POWER button to restart the machine.
Indicator lights on display are not on.	1) No power 2) Blown fuse	1) Turn the power on 2) Replace fuse
The Ice made is too large and with pieces sticking together.	Ice of previous cycles left in the water tray.	Take out the ice under the standby state.
The ice making process was correct, but no ice has come out.	1. The compressor has no refrigerant 2. Compressor damaged 3. Fan motor damaged	Call Duroic Customer Care Team for advice.
All indicators twinkle simultaneously.	Water tray is blocked by ice cubes.	Unplug the power, take out the ice which blocking the tray, then plug in the power and press the POWER button. The machine will restart after around 3 minutes.
The machine has been working, but the water has been warming up	Solenoid has broken down	Call Duroic Customer Care Team for advice
When the ice is full, the machine does not display the ICE FULL icon	'Ice Full' sensor is damaged	Call Duroic Customer Care Team for advice

Gewährleistung

Shine-Mart Ltd, der Markeninhaber von Duronic Produkten, bietet 1 Jahr Gewährleistung.

HINWEIS: DIESE BEDINGUNGEN BEEINFLUSSEN IHRE GESETZLICHE RECHTE ALS VERBRAUCHER NICHT

Dieses Produkt wurde unter strengen Qualitätskontrollen produziert und aus hochwertigen Materialien hergestellt, um ausgezeichnete Leistung und Zuverlässigkeit zu gewährleisten. Sofern das Produkt korrekt benutzt und gewartet wird, kann eine langlebige Lebensdauer erwartet werden.

Das Produkt hat eine Gewährleistung von einem Jahr ab Kaufdatum. Beim Auftreten eines Schadens, der von fehlerhaften Materialien oder Verarbeitung verursacht wurde, sollte das defekte Produkt an den ursprünglichen Verkäufer zurückgegeben werden. Die Erstattung oder Umtausch erfolgt nach Vorschriften des Unternehmens.

Duronic Produkte haben 1 Jahr Gewährleistung unter folgenden Bedingungen:

1. Das Produkt muss mit dem Kaufnachweis zurückgegeben werden.
2. Das Produkt muss unter den Anweisungen und Anleitungen installiert und benutzt worden sein.
3. Es muss ausschließlich für den Hausgebrauch genutzt worden sein.
4. Natürliche Abnutzung oder Verschleiß, böswillige Beschädigung, Missbrauch, Vernachlässigung und unsachgemäße Reparaturen sind von der Gewährleistung ausgeschlossen.
5. Shine-Mart Ltd übernimmt keine Verantwortung für zufällige oder Folgeschäden.
6. Shine-Mart Ltd ist nicht für Wartungsarbeiten zuständig. Diese fallen nicht unter die Gewährleistung.
7. Gültig in der EU



Dieses Produkt ist mit fitted CE geprüfte Typ-F
Euro Stecker/BS Stecker ausgestattet
Von Shine-Mart Ltd, RM3 8SB importiert



Information über Abfalllagerung für Verbraucher von elektronischen Geräten.
Dieses Zeichen auf dem Produkt und/oder auf mitgelieferte Dokumenten zeigt, dass, wenn eine Entsorgung erfolgt, das Gerät an einer Elektro- und Elektronikgeräte-Abfall-Sammelstelle (WEEE) abgegeben werden muss.
Um eine weitere Behandlung und Weiterverarbeitung der Materialien zu gewährleisten dürfen diese WEEE-markierten Produkte nicht mit dem Hausmüll vermisch werden.
Für die korrekte Behandlung, Aufbereitung und Wiederverwendung geben Sie alle WEEE-markierten Produkte zur kommunalen Abfallbeseitigungsanlage.
Dort können Sie diese kostenlos abgeben.
Wenn die Beseitigung von Elektro- und Elektronik-Altgeräten korrekt durchgeführt wird, tragen Sie zur Gewinnung von wertvollen Ressourcen bei, sowie einer möglichen Vermeidung von negativen Auswirkungen auf Gesundheit und Umwelt.

Folgen Sie Uns



duronic.com

Manual De Instrucciones En Español

Safety Instructions

PLEASE READ THIS MANUAL CAREFULLY BEFORE USING AND RETAIN IT FOR FUTURE REFERENCE

- This appliance is for indoor/household use only. Do not use outdoors.
- The IM120 Ice Maker is only for domestic use, it is not for commercial use.
- This appliance is not intended for use by persons (including children) with reduced physical, sensory or mental capabilities, or lack of experience and knowledge, unless they have been given supervision or instruction concerning use of the appliance by a person responsible for their safety.
- Do not operate this appliance if the power cable or plug is damaged. If either is damaged, return the machine to Duronic for service or repair by professional technician.
- Please ensure the mains power supply is 220-240V / 50Hz.
- Never try to replace the parts and repair the unit by yourself.
- To reduce the risk of electric shock, never operate this product near water, with wet hands, spill liquid on the appliance or submerge it in water or any other liquid.
- Do not use the ice maker machine near gas or other inflammable materials (such as benzene, paint thinner, sprays, etc.)
- Do not place the appliance on or near a hot gas or on a heated oven.
- Keep the machine 15cm from other objects to ensure heat has space to escape from the vents.
- Do not put any extension leads or portable power supplies near or behind the appliance.
- Do not use any accessories which are not recommended by Duronic.
- Do not insert any foreign or electrical objects into the appliance.
- Do not store explosive substances such as aerosol cans with a flammable propellant in or next to this appliance.
- The refrigerant and insulation blowing gas inside this machine is flammable. When disposing of the appliance, do so only at an authorised waste disposal centre. Do not expose the appliance to flames.
- Unplug the appliance after using it or before cleaning it.
- When cleaning the ice maker machine, do not use sharp utensils, steel

Safety Instructions (Continued)

wool, metal scouring pads or abrasive cleaners as they will scratch or damage the appliance.

- Do not use distilled water in this machine. Mineral water is recommended.
- When moving the appliance, do not tilt the machine more than 45 degrees and do not turn the machine upside down. This may damage the compressor and the sealing system.
- It is normal for the compressor and condenser surface to reach temperatures between 70°C and 90°C during operation and the surrounding areas may be very hot.
- Due to the fast freezing process, ice cubes may appear “cloudy”. This is normal, it is air trapped in the water during the freezing process and it will not affect the quality or taste of the ice.

Specifications

MODEL	POWER	VOLTAGE RATING	WATER TANK CAPACITY	DIMENSIONS
ICM120	120W	220-240V / 50Hz	1.5L	22.4 x 30.8 x 28.3cm

Features:

- The IM120 makes bullet-shaped ice cubes
- Up to 9 pieces of ice can be made per eight minutes
- Daily ice output: 12kg / 26.5lbs per 24 hours
- Ice storage facility: 1.5L / 600g
- Refrigerant: R600a
- Noise level: $\leq 60\text{dB(A)}$ [ambient noise level $\leq 17\text{dB(A)}$]
- Prompts when ice basket is full and when water level is insufficient.

Components

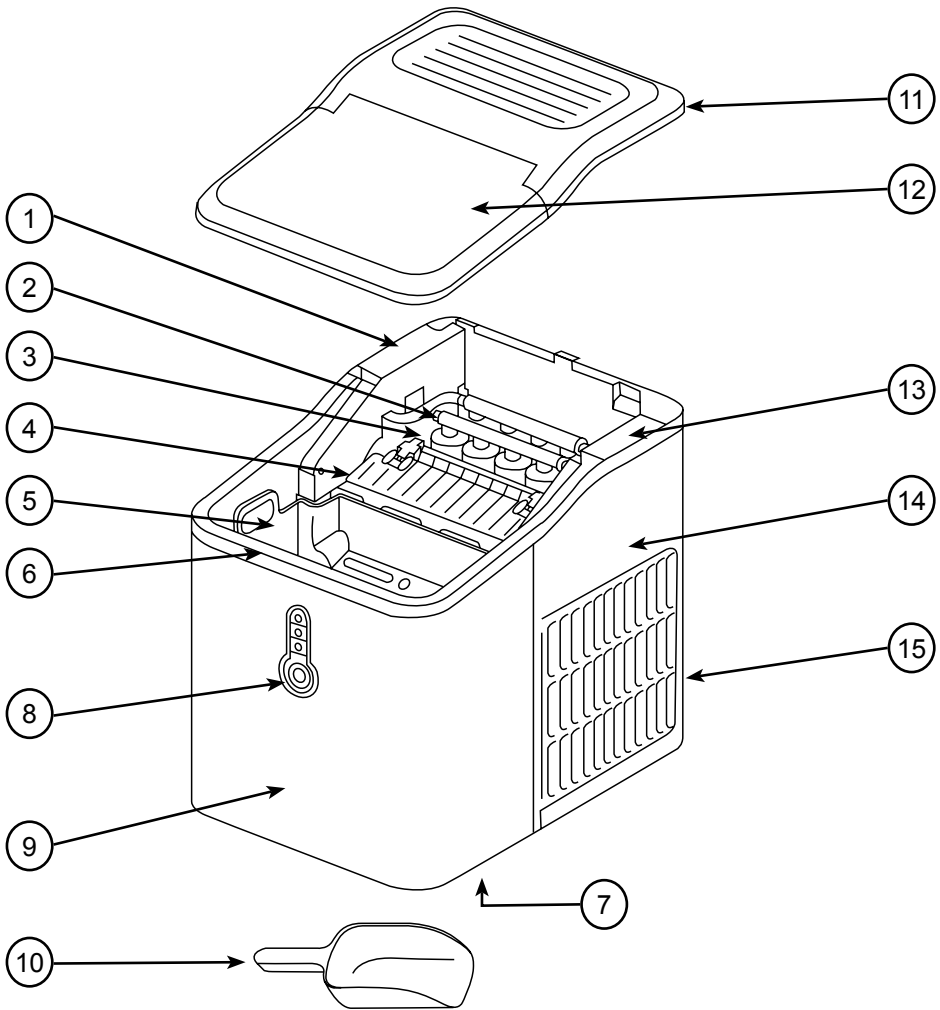

- 1. Micro switch
- 2. Evaporator
- 3. Water tray
- 4. Ice shovel
- 5. Ice basket
- 6. Water tank

- 7. Drainage plug
- 8. Control panel
- 9. Front housing
- 10. Ice scoop
- 11. Top cover
- 12. Transparent lid

- 13. Motor
- 14. Back housing
- 15. Air vent

Before First Use

- Before first use, remove all the packing materials, check the machine carefully and make sure that the machine, power cable and plug are normal and do not have any damage.
- The machine should be positioned on a level surface. To ensure sufficient ventilation, the distance of the back of ice maker to the wall and surrounding objects should be at least 15cm. It should not be positioned near an oven, radiator or any other heat source.
- Before using the machine for the first time, place the machine and leave the transparent cover open for at least two hours.
- Distilled water should not be used. Mineral water is recommended.

The Control Panel

There are light 3 indicators and 1 button on the control panel:

ICE FULL	Ice full alarm
ADD WATER	Water shortage alarm
ICE MAKING	Ice is being produced
	Power button



Before First Use

ICE MAKING:

- When you plug in the ice maker machine the ICE MAKING light indicator will flash.
- Press the power button to switch on the machine. The ICE MAKING indicator light will stay on and the machine will start to make ice cubes.
- After the first batch of ice cubes have finished being made, the de-icing will activate, followed by the ice shovel which will move the ice into the ice basket.

ADD WATER:

- When the ADD WATER light turns red, it means that there is not enough water left in the tank. You will need to add more water and then press the power button to restart the machine.



Do not fill up the tank directly from a tap. When refilling the water tank, use a bottle or jug to pour water into it.

ICE FULL:

- When the ice cubes fill up the ice basket and it reaches the maximum capacity, the ICE FULL light will flash, and the machine will automatically stop. You will then need to empty the ice basket using the ice scoop.
- Once the sensor inside the machine can detect the ice basket is empty, the machine will restart automatically and continue making ice cubes.

How to Use

1. Open the transparent lid, take out the ice basket and add water to the water tank. The water should not exceed the MAX mark.

Use either cold or room-temperature water to fill the tank. Do not fill the tank with hot water.

If the water exceeds the MAX mark, you will need to drain a little water away. You do this by opening the bottom drain plug and releasing some water.

2. Put the ice basket back into the machine and close the lid.
3. Plug in the machine and switch it on at the plug.
4. Press the power button to start the machine.
5. The machine will start to make ice cubes.
6. The ICE MAKING indicator light will light up stay on while the machine works making the ice cubes.
7. When the ice basket is full, the machine will automatically stop. Remove the ice cubes using the ice scoop. The machine will then restart and

continue making ice cubes.

8. When you have finished making ice cubes, turn off the machine by pressing the power button again. Switch off the plug socket and unplug the cable from the mains socket.

Cleaning and Maintenance

Clean the inside of the machine (ice basket, water tank, ice shovel) and the ice scoop frequently.

How to clean your ice maker:

1. Switch off the machine and allow it to de-ice for a 2-3 hours. Do not use any mechanical devices or any other means to accelerate the defrosting process.
2. Before cleaning, unplug the machine and remove any ice cubes from the ice basket.
3. Use a diluted solution of water and white vinegar to clean the inside and the outside surface of the machine using a cloth. Do not use chemicals or diluted agents such as acids, gasoline or oil on the machine.
4. After using the water/vinegar solution to wipe over the machine, rinse the cloth in water and wipe over the same parts again to clean away the solution.
5. Allow the machine to air and dry thoroughly. Keep ventilation openings in/on the machine clear of obstruction.

To ensure the ice made is fresh, change the water in the reservoir at least once a day. If you do not plan to use the machine for a long time, drain the water out and clean the machine before storing it away.

Troubleshooting

Note: If the power is accidentally disconnected while the machine is on during an ice making cycle, small ice chips may form and lodge in the ice shovel. If this occurs, check that the machine is switched off at the mains socket, then gently push the shovel backwards towards the rear of the machine to remove ice chips. Then restart the machine as normal.

Problem	Possible Cause	Suggested Solutions
The ice shovel does not move ice into the ice basket.	The water tank is not on a flat even surface.	Check that the surface the machine is on is flat and even. With the machine switched off at the plug, gently push the ice shovel using your finger, then press the power button to restart it.
The compressor works abnormally with a buzzing noise	The voltage is lower than recommended.	Stop the machine and do not restart it until it's plugged into the correct voltage.
Water shortage indicator light is on.	1. There is no water 2. The pump is full of air	1. Add to some water until it reaches MAX position. 2. Press POWER button to restart the machine.
Indicator lights on display are not on.	1) No power 2) Blown fuse	1) Turn the power on 2) Replace fuse
The Ice made is too large and with pieces sticking together.	Ice of previous cycles left in the water tray.	Take out the ice under the standby state.
The ice making process was correct, but no ice has come out.	1. The compressor has no refrigerant 2. Compressor damaged 3. Fan motor damaged	Call Duronic Customer Care Team for advice.
All indicators twinkle simultaneously.	Water tray is blocked by ice cubes.	Unplug the power, take out the ice which blocking the tray, then plug in the power and press the POWER button. The machine will restart after around 3 minutes.
The machine has been working, but the water has been warming up	Solenoid has broken down	Call Duronic Customer Care Team for advice
When the ice is full, the machine does not display the ICE FULL icon	'Ice Full' sensor is damaged	Call Duronic Customer Care Team for advice

Garantía

NOTA: ESTAS DECLARACIONES NO AFECTAN SUS DERECHOS LEGALES COMO CONSUMIDOR

Este producto ha sido fabricado bajo las más estrictas control de calidad y utilizando materiales de alta calidad para asegurar confiabilidad y excelente funcionamiento. Le dará buen servicio y una larga duración, siempre y cuando se utilice correctamente y sea bien mantenido.

El producto está garantizado por 1 año desde la fecha de compra original. Si surge cualquier defecto debido a un error/defecto de fábrica o mano de obra, entonces el producto debe ser devuelto al lugar original de compra. Reembolso o reemplazo es a discreción de la compañía.

Productos Duronic se ofrecen con una garantía de 1 año bajo las siguientes condiciones:

1. El producto debe ser devuelto al vendedor con comprobante de compra original.
2. El producto debe instalarse y usarlo según las instrucciones contenidas en este manual.
3. Este aparato es únicamente de uso doméstico.
4. No cubre desgaste, daños maliciosos, uso indebido, negligencia, reparaciones inexpertas o partes consumibles.
5. Shine-Mart Ltd no será responsable por cualquier daño consecuente, accidentes o pérdidas.
6. Shine-Mart Ltd no es responsable ah llevar a cabo cualquier tipo de servicio, bajo la garantía.
7. Valido solamente dentro de la (EU).



Este producto esta equipado con enchufe/fusible Europeo
Importado por Shine-Mart Ltd, RM3 8SB



Información sobre la eliminación de residuos para los consumidores de equipos eléctricos y electrónicos:

Esta marca en un producto y/o documentos adjuntos indica que cuando se va a desechar, se debe tratar como equipos residuos eléctricos y electrónicos (RAEE)

Cualquier producto marcado (RAEE) no debe ser mezclado con la basura doméstica, sino separado para el tratamiento, recuperación y reciclaje de los materiales utilizados.

Para el tratamiento adecuado, recuperación y reciclaje; por favor, tome todos los productos (RAEE) y llévelo al sitio de residuos de su Autoridad Local, donde será aceptado de forma gratuita.

Si los clientes desechan los residuos eléctricos y electrónicos correctamente, ayudar a ahorrar valiosos recursos y prevenir los efectos negativos sobre la salud humana y el medio ambiente, de materiales peligrosos que pueden contener los residuos

Síguenos



duronic.com

Manuale D'istruzioni In Italiano

Safety Instructions

PLEASE READ THIS MANUAL CAREFULLY BEFORE USING AND RETAIN IT FOR FUTURE REFERENCE

- This appliance is for indoor/household use only. Do not use outdoors.
- The IM120 Ice Maker is only for domestic use, it is not for commercial use.
- This appliance is not intended for use by persons (including children) with reduced physical, sensory or mental capabilities, or lack of experience and knowledge, unless they have been given supervision or instruction concerning use of the appliance by a person responsible for their safety.
- Do not operate this appliance if the power cable or plug is damaged. If either is damaged, return the machine to Duronic for service or repair by professional technician.
- Please ensure the mains power supply is 220-240V / 50Hz.
- Never try to replace the parts and repair the unit by yourself.
- To reduce the risk of electric shock, never operate this product near water, with wet hands, spill liquid on the appliance or submerge it in water or any other liquid.
- Do not use the ice maker machine near gas or other inflammable materials (such as benzene, paint thinner, sprays, etc.)
- Do not place the appliance on or near a hot gas or on a heated oven.
- Keep the machine 15cm from other objects to ensure heat has space to escape from the vents.
- Do not put any extension leads or portable power supplies near or behind the appliance.
- Do not use any accessories which are not recommended by Duronic.
- Do not insert any foreign or electrical objects into the appliance.
- Do not store explosive substances such as aerosol cans with a flammable propellant in or next to this appliance.
- The refrigerant and insulation blowing gas inside this machine is flammable. When disposing of the appliance, do so only at an authorised waste disposal centre. Do not expose the appliance to flames.
- Unplug the appliance after using it or before cleaning it.
- When cleaning the ice maker machine, do not use sharp utensils, steel

Safety Instructions (Continued)

wool, metal scouring pads or abrasive cleaners as they will scratch or damage the appliance.

- Do not use distilled water in this machine. Mineral water is recommended.
- When moving the appliance, do not tilt the machine more than 45 degrees and do not turn the machine upside down. This may damage the compressor and the sealing system.
- It is normal for the compressor and condenser surface to reach temperatures between 70°C and 90°C during operation and the surrounding areas may be very hot.
- Due to the fast freezing process, ice cubes may appear “cloudy”. This is normal, it is air trapped in the water during the freezing process and it will not affect the quality or taste of the ice.

Specifications

MODEL	POWER	VOLTAGE RATING	WATER TANK CAPACITY	DIMENSIONS
ICM120	120W	220-240V / 50Hz	1.5L	22.4 x 30.8 x 28.3cm

Features:

- The IM120 makes bullet-shaped ice cubes
- Up to 9 pieces of ice can be made per eight minutes
- Daily ice output: 12kg / 26.5lbs per 24 hours
- Ice storage facility: 1.5L / 600g
- Refrigerant: R600a
- Noise level: $\leq 60\text{dB(A)}$ [ambient noise level $\leq 17\text{dB(A)}$]
- Prompts when ice basket is full and when water level is insufficient.

Components

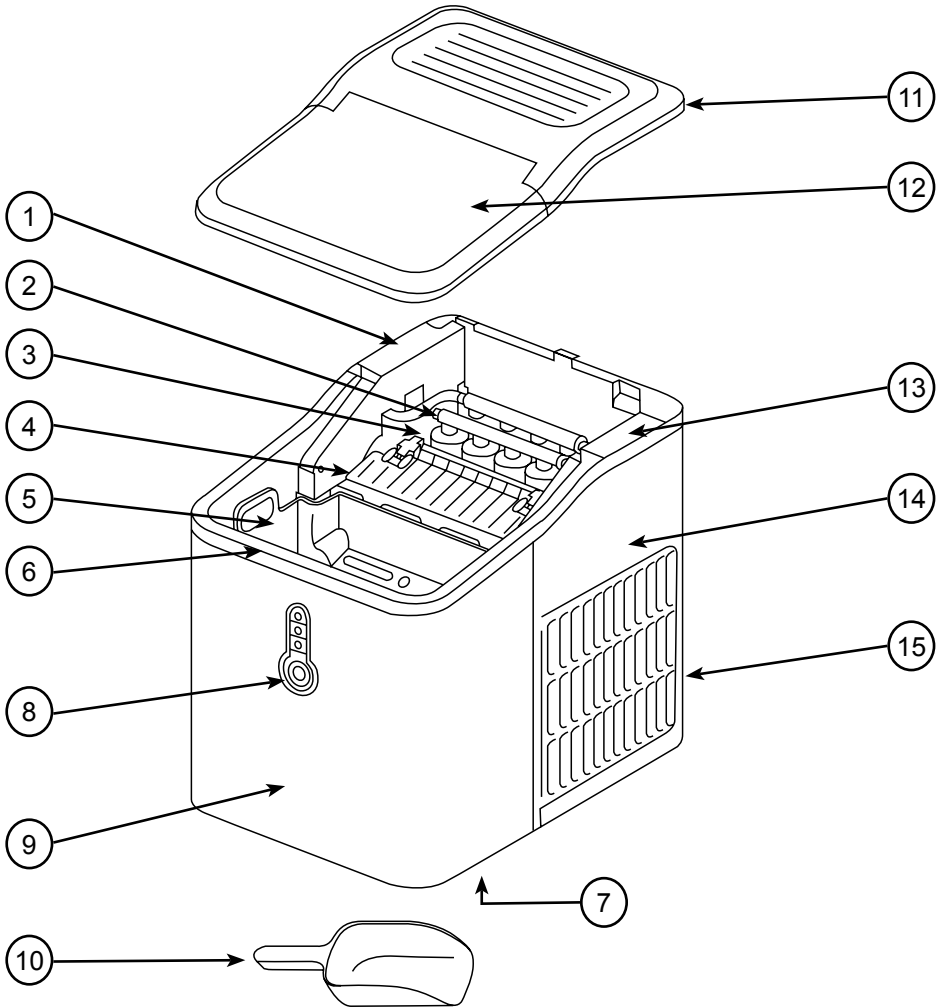

- 1. Micro switch
- 2. Evaporator
- 3. Water tray
- 4. Ice shovel
- 5. Ice basket
- 6. Water tank

- 7. Drainage plug
- 8. Control panel
- 9. Front housing
- 10. Ice scoop
- 11. Top cover
- 12. Transparent lid

- 13. Motor
- 14. Back housing
- 15. Air vent

Before First Use

- Before first use, remove all the packing materials, check the machine carefully and make sure that the machine, power cable and plug are normal and do not have any damage.
- The machine should be positioned on a level surface. To ensure sufficient ventilation, the distance of the back of ice maker to the wall and surrounding objects should be at least 15cm. It should not be positioned near an oven, radiator or any other heat source.
- Before using the machine for the first time, place the machine and leave the transparent cover open for at least two hours.
- Distilled water should not be used. Mineral water is recommended.

The Control Panel

There are light 3 indicators and 1 button on the control panel:

ICE FULL	Ice full alarm
ADD WATER	Water shortage alarm
ICE MAKING	Ice is being produced
	Power button



Before First Use

ICE MAKING:

- When you plug in the ice maker machine the ICE MAKING light indicator will flash.
- Press the power button to switch on the machine. The ICE MAKING indicator light will stay on and the machine will start to make ice cubes.
- After the first batch of ice cubes have finished being made, the de-icing will activate, followed by the ice shovel which will move the ice into the ice basket.

ADD WATER:

- When the ADD WATER light turns red, it means that there is not enough water left in the tank. You will need to add more water and then press the power button to restart the machine.



Do not fill up the tank directly from a tap. When refilling the water tank, use a bottle or jug to pour water into it.

ICE FULL:

- When the ice cubes fill up the ice basket and it reaches the maximum capacity, the ICE FULL light will flash, and the machine will automatically stop. You will then need to empty the ice basket using the ice scoop.
- Once the sensor inside the machine can detect the ice basket is empty, the machine will restart automatically and continue making ice cubes.

How to Use

1. Open the transparent lid, take out the ice basket and add water to the water tank. The water should not exceed the MAX mark.
Use either cold or room-temperature water to fill the tank. Do not fill the tank with hot water.
If the water exceeds the MAX mark, you will need to drain a little water away. You do this by opening the bottom drain plug and releasing some water.
2. Put the ice basket back into the machine and close the lid.
3. Plug in the machine and switch it on at the plug.
4. Press the power button to start the machine.
5. The machine will start to make ice cubes.
6. The ICE MAKING indicator light will light up stay on while the machine works making the ice cubes.
7. When the ice basket is full, the machine will automatically stop. Remove the ice cubes using the ice scoop. The machine will then restart and

continue making ice cubes.

8. When you have finished making ice cubes, turn off the machine by pressing the power button again. Switch off the plug socket and unplug the cable from the mains socket.

Cleaning and Maintenance

Clean the inside of the machine (ice basket, water tank, ice shovel) and the ice scoop frequently.

How to clean your ice maker:

1. Switch off the machine and allow it to de-ice for a 2-3 hours. Do not use any mechanical devices or any other means to accelerate the defrosting process.
2. Before cleaning, unplug the machine and remove any ice cubes from the ice basket.
3. Use a diluted solution of water and white vinegar to clean the inside and the outside surface of the machine using a cloth. Do not use chemicals or diluted agents such as acids, gasoline or oil on the machine.
4. After using the water/vinegar solution to wipe over the machine, rinse the cloth in water and wipe over the same parts again to clean away the solution.
5. Allow the machine to air and dry thoroughly. Keep ventilation openings in/on the machine clear of obstruction.

To ensure the ice made is fresh, change the water in the reservoir at least once a day. If you do not plan to use the machine for a long time, drain the water out and clean the machine before storing it away.

Troubleshooting

Note: If the power is accidentally disconnected while the machine is on during an ice making cycle, small ice chips may form and lodge in the ice shovel. If this occurs, check that the machine is switched off at the mains socket, then gently push the shovel backwards towards the rear of the machine to remove ice chips. Then restart the machine as normal.

Problem	Possible Cause	Suggested Solutions
The ice shovel does not move ice into the ice basket.	The water tank is not on a flat even surface.	Check that the surface the machine is on is flat and even. With the machine switched off at the plug, gently push the ice shovel using your finger, then press the power button to restart it.
The compressor works abnormally with a buzzing noise	The voltage is lower than recommended.	Stop the machine and do not restart it until it's plugged into the correct voltage.
Water shortage indicator light is on.	1. There is no water 2. The pump is full of air	1. Add to some water until it reaches MAX position. 2. Press POWER button to restart the machine.
Indicator lights on display are not on.	1) No power 2) Blown fuse	1) Turn the power on 2) Replace fuse
The Ice made is too large and with pieces sticking together.	Ice of previous cycles left in the water tray.	Take out the ice under the standby state.
The ice making process was correct, but no ice has come out.	1. The compressor has no refrigerant 2. Compressor damaged 3. Fan motor damaged	Call Duronic Customer Care Team for advice.
All indicators twinkle simultaneously.	Water tray is blocked by ice cubes.	Unplug the power, take out the ice which blocking the tray, then plug in the power and press the POWER button. The machine will restart after around 3 minutes.
The machine has been working, but the water has been warming up	Solenoid has broken down	Call Duronic Customer Care Team for advice
When the ice is full, the machine does not display the ICE FULL icon	'Ice Full' sensor is damaged	Call Duronic Customer Care Team for advice

Garanzia

Questo prodotto è garantito per una durata determinata con il distributore a partire dalla data di acquisto contro ogni difetto derivante da difetti di fabbricazione o dei materiali. Questa garanzia non copre difetti o danni derivanti da installazione impropria, uso improprio o usura anomala del prodotto.

L'apparecchio deve essere restituito nella sua confezione originale e accompagnato dalla ricevuta e deve essere stato utilizzato in modo corretto. È importante rispettare le istruzioni per l'uso e le precauzioni di sicurezza indicate di seguito. Inoltre, non possiamo garantire l'apparecchio se è stato modificato o riparato dall'acquirente o da terzi.

1 anno di garanzia da Shine-Mart Ltd, proprietari del marchio commerciale Duronic.

NOTA: QUESTE DICHIARAZIONI NON INFLUISCONO SUI DIRITTI LEGALI DEL CONSUMATORE

Questo prodotto è stato realizzato con le rigorose procedure del controllo qualità, e utilizzando materiali di altissima qualità, per garantire affidabilità e prestazioni eccellenti. Vi regalerà un servizio ottimo e a lungo termine, purchè venga opportunamente usata e mantenuta. Il prodotto è garantito per 1 anno dalla data di acquisto. Se sorge qualche difetto a causa di materiali difettosi o scarsa manodopera, il prodotto difettoso dovrà essere restituito al luogo originale di acquisto. Il rimborso o la sostituzione sono a discrezione dell'azienda. I prodotti Duronic offrono 1 anno di garanzia alle seguenti condizioni:

1. Il prodotto deve essere restituito al rivenditore con la prova d'acquisto originale
 2. Il prodotto deve essere installato e usato seguendo le istruzioni contenute nel manuale.
 3. Il prodotto va utilizzato solo per scopi domestici. Non è da utilizzarsi per uso commerciale.
 4. La garanzia non copre usura, danni volontari, abuso, negligenza, riparazioni inesperte o consumo dei materiali.
 5. Shine-Mart Ltd non è responsabile per Danni accidentali o consequenziali.
 6. Shine-Mart Ltd non è tenuta a eseguire qualsiasi tipo di riparazione, ai sensi della garanzia.
 7. Termini validi in tutta l'unione europea *Ci riserviamo il diritto di modificare le sopracitate condizioni Per parti di ricambio si prega di consultare il sito www.duronic.com
- Corretto smaltimento del prodotto.



Questo prodotto è inclusivo di spina certificata CE
importata da Shine-Mart Ltd, RM3 8SB



Questo segno su un prodotto o su documenti indica che quando deve essere smaltito, deve essere trattato come i rifiuti elettrici ed elettronici (WEEE). Tutti i prodotti marcati WEEE non devono essere buttati nei rifiuti domestici generici, ma separati per il trattamento, il recupero e il riciclaggio dei materiali utilizzati.

Per un corretto trattamento, recupero e riciclaggio; si prega di portare tutti i prodotti marcati WEEE al Vostro centro smaltimenti rifiuti autorizzato, dove saranno accettati gratuitamente.

Se i consumatori sono propensi allo smaltimento corretto di rifiuti elettrici ed elettronici, aiuteranno a salvare risorse importanti e a prevenire i potenziali effetti negativi sulla salute umana e sull'ambiente di tutti i materiali pericolosi che i rifiuti possono contenere.

Seguici



duronic.com

Instrukcja obsługi. Polski

Safety Instructions

PLEASE READ THIS MANUAL CAREFULLY BEFORE USING AND RETAIN IT FOR FUTURE REFERENCE

- This appliance is for indoor/household use only. Do not use outdoors.
- The IM120 Ice Maker is only for domestic use, it is not for commercial use.
- This appliance is not intended for use by persons (including children) with reduced physical, sensory or mental capabilities, or lack of experience and knowledge, unless they have been given supervision or instruction concerning use of the appliance by a person responsible for their safety.
- Do not operate this appliance if the power cable or plug is damaged. If either is damaged, return the machine to Duronic for service or repair by professional technician.
- Please ensure the mains power supply is 220-240V / 50Hz.
- Never try to replace the parts and repair the unit by yourself.
- To reduce the risk of electric shock, never operate this product near water, with wet hands, spill liquid on the appliance or submerge it in water or any other liquid.
- Do not use the ice maker machine near gas or other inflammable materials (such as benzene, paint thinner, sprays, etc.)
- Do not place the appliance on or near a hot gas or on a heated oven.
- Keep the machine 15cm from other objects to ensure heat has space to escape from the vents.
- Do not put any extension leads or portable power supplies near or behind the appliance.
- Do not use any accessories which are not recommended by Duronic.
- Do not insert any foreign or electrical objects into the appliance.
- Do not store explosive substances such as aerosol cans with a flammable propellant in or next to this appliance.
- The refrigerant and insulation blowing gas inside this machine is flammable. When disposing of the appliance, do so only at an authorised waste disposal centre. Do not expose the appliance to flames.
- Unplug the appliance after using it or before cleaning it.
- When cleaning the ice maker machine, do not use sharp utensils, steel

Safety Instructions (Continued)

wool, metal scouring pads or abrasive cleaners as they will scratch or damage the appliance.

- Do not use distilled water in this machine. Mineral water is recommended.
- When moving the appliance, do not tilt the machine more than 45 degrees and do not turn the machine upside down. This may damage the compressor and the sealing system.
- It is normal for the compressor and condenser surface to reach temperatures between 70°C and 90°C during operation and the surrounding areas may be very hot.
- Due to the fast freezing process, ice cubes may appear “cloudy”. This is normal, it is air trapped in the water during the freezing process and it will not affect the quality or taste of the ice.

Specifications

MODEL	POWER	VOLTAGE RATING	WATER TANK CAPACITY	DIMENSIONS
ICM120	120W	220-240V / 50Hz	1.5L	22.4 x 30.8 x 28.3cm

Features:

- The IM120 makes bullet-shaped ice cubes
- Up to 9 pieces of ice can be made per eight minutes
- Daily ice output: 12kg / 26.5lbs per 24 hours
- Ice storage facility: 1.5L / 600g
- Refrigerant: R600a
- Noise level: $\leq 60\text{dB(A)}$ [ambient noise level $\leq 17\text{dB(A)}$]
- Prompts when ice basket is full and when water level is insufficient.

Components

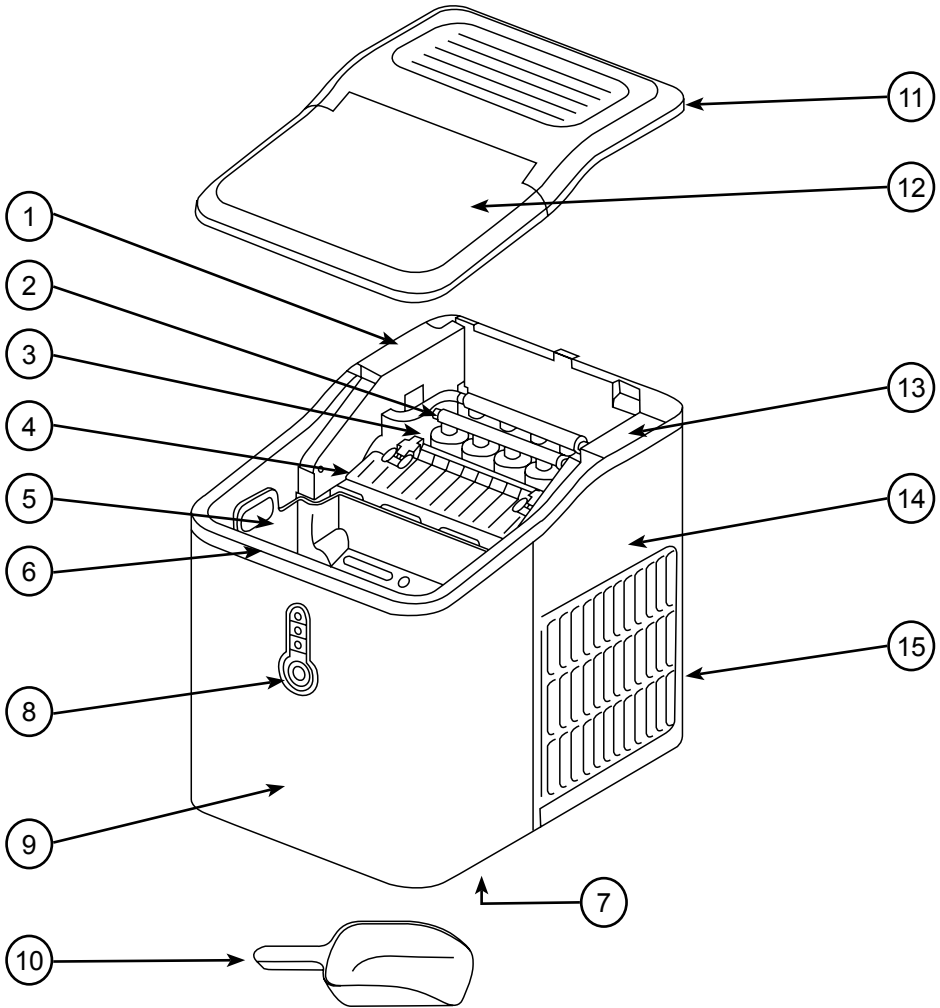

- 1. Micro switch
- 2. Evaporator
- 3. Water tray
- 4. Ice shovel
- 5. Ice basket
- 6. Water tank

- 7. Drainage plug
- 8. Control panel
- 9. Front housing
- 10. Ice scoop
- 11. Top cover
- 12. Transparent lid

- 13. Motor
- 14. Back housing
- 15. Air vent

Before First Use

- Before first use, remove all the packing materials, check the machine carefully and make sure that the machine, power cable and plug are normal and do not have any damage.
- The machine should be positioned on a level surface. To ensure sufficient ventilation, the distance of the back of ice maker to the wall and surrounding objects should be at least 15cm. It should not be positioned near an oven, radiator or any other heat source.
- Before using the machine for the first time, place the machine and leave the transparent cover open for at least two hours.
- Distilled water should not be used. Mineral water is recommended.

The Control Panel

There are light 3 indicators and 1 button on the control panel:

ICE FULL	Ice full alarm
ADD WATER	Water shortage alarm
ICE MAKING	Ice is being produced
	Power button



Before First Use

ICE MAKING:

- When you plug in the ice maker machine the ICE MAKING light indicator will flash.
- Press the power button to switch on the machine. The ICE MAKING indicator light will stay on and the machine will start to make ice cubes.
- After the first batch of ice cubes have finished being made, the de-icing will activate, followed by the ice shovel which will move the ice into the ice basket.

ADD WATER:

- When the ADD WATER light turns red, it means that there is not enough water left in the tank. You will need to add more water and then press the power button to restart the machine.



Do not fill up the tank directly from a tap. When refilling the water tank, use a bottle or jug to pour water into it.

ICE FULL:

- When the ice cubes fill up the ice basket and it reaches the maximum capacity, the ICE FULL light will flash, and the machine will automatically stop. You will then need to empty the ice basket using the ice scoop.
- Once the sensor inside the machine can detect the ice basket is empty, the machine will restart automatically and continue making ice cubes.

How to Use

1. Open the transparent lid, take out the ice basket and add water to the water tank. The water should not exceed the MAX mark.

Use either cold or room-temperature water to fill the tank. Do not fill the tank with hot water.

If the water exceeds the MAX mark, you will need to drain a little water away. You do this by opening the bottom drain plug and releasing some water.

2. Put the ice basket back into the machine and close the lid.
3. Plug in the machine and switch it on at the plug.
4. Press the power button to start the machine.
5. The machine will start to make ice cubes.
6. The ICE MAKING indicator light will light up stay on while the machine works making the ice cubes.
7. When the ice basket is full, the machine will automatically stop. Remove the ice cubes using the ice scoop. The machine will then restart and

continue making ice cubes.

8. When you have finished making ice cubes, turn off the machine by pressing the power button again. Switch off the plug socket and unplug the cable from the mains socket.

Cleaning and Maintenance

Clean the inside of the machine (ice basket, water tank, ice shovel) and the ice scoop frequently.

How to clean your ice maker:

1. Switch off the machine and allow it to de-ice for a 2-3 hours. Do not use any mechanical devices or any other means to accelerate the defrosting process.
2. Before cleaning, unplug the machine and remove any ice cubes from the ice basket.
3. Use a diluted solution of water and white vinegar to clean the inside and the outside surface of the machine using a cloth. Do not use chemicals or diluted agents such as acids, gasoline or oil on the machine.
4. After using the water/vinegar solution to wipe over the machine, rinse the cloth in water and wipe over the same parts again to clean away the solution.
5. Allow the machine to air and dry thoroughly. Keep ventilation openings in/on the machine clear of obstruction.

To ensure the ice made is fresh, change the water in the reservoir at least once a day. If you do not plan to use the machine for a long time, drain the water out and clean the machine before storing it away.

Troubleshooting

Note: If the power is accidentally disconnected while the machine is on during an ice making cycle, small ice chips may form and lodge in the ice shovel. If this occurs, check that the machine is switched off at the mains socket, then gently push the shovel backwards towards the rear of the machine to remove ice chips. Then restart the machine as normal.

Problem	Possible Cause	Suggested Solutions
The ice shovel does not move ice into the ice basket.	The water tank is not on a flat even surface.	Check that the surface the machine is on is flat and even. With the machine switched off at the plug, gently push the ice shovel using your finger, then press the power button to restart it.
The compressor works abnormally with a buzzing noise	The voltage is lower than recommended.	Stop the machine and do not restart it until it's plugged into the correct voltage.
Water shortage indicator light is on.	1. There is no water 2. The pump is full of air	1. Add to some water until it reaches MAX position. 2. Press POWER button to restart the machine.
Indicator lights on display are not on.	1) No power 2) Blown fuse	1) Turn the power on 2) Replace fuse
The Ice made is too large and with pieces sticking together.	Ice of previous cycles left in the water tray.	Take out the ice under the standby state.
The ice making process was correct, but no ice has come out.	1. The compressor has no refrigerant 2. Compressor damaged 3. Fan motor damaged	Call Duronic Customer Care Team for advice.
All indicators twinkle simultaneously.	Water tray is blocked by ice cubes.	Unplug the power, take out the ice which blocking the tray, then plug in the power and press the POWER button. The machine will restart after around 3 minutes.
The machine has been working, but the water has been warming up	Solenoid has broken down	Call Duronic Customer Care Team for advice
When the ice is full, the machine does not display the ICE FULL icon	'Ice Full' sensor is damaged	Call Duronic Customer Care Team for advice

Warunki Gwarancji

1 Rok Gwarancji firmy Shine-Mart LTD, marki handlowej Duronic Products.
 UWAGA: ten dokument nie wpływa na twoje ustawowe prawo jako konsumenta.

Ten produkt został wykonany zgodnie z restrykcyjnymi normami kontroli i wykorzystuje najwyższej jakości materiały dla uzyskania doskonałej wydajności i niezawodności. Długotrwałość produktu zostaje osiągnięta przez właściwe użytkowanie i konserwację. Gwarancja obejmuje 1 rok od daty zamówienia. Jeżeli jakkolwiek defekt powstanie ze względu na wadliwość materiału lub niewłaściwe wykonanie to uszkodzony produkt musi zostać dostarczony do miejsca, z którego został zamówiony. Zwrot pieniędzy lub wymiana produktu jest w gestii firmy.

Duronic Products oferuje jeden rok gwarancji na podstawie poniższych warunków:

1. Produkt musi zostać zwrócony do sprzedawcy z oryginalnym dowodem zakupu.
2. Produkt był instalowany i użytkowany zgodnie z instrukcją obsługi.
3. Produkt użytkowany był wyłącznie w celach domowych.
4. Gwarancja nie obejmuje naturalnego zużycia się produktu, celowego uszkodzenia, niewłaściwego użycia, zaniedbania, niewłaściwych napraw lub części eksploatacyjnych.
5. Shine-Mart Ltd. nie ponosi odpowiedzialności za przypadkowe albo celowe zgubienie produktu lub jego uszkodzenie.
6. Firma Shine-Mart Ltd nie jest zobowiązana do przeprowadzania jakichkolwiek prac serwisowych w ramach gwarancji.
7. Obowiązuje na obszarze Unii Europejskiej.



Ten produkt jest wyposażony we wbudowaną wtyczkę typu Euro-Plug / BS z certyfikatem CE importowaną przez Shine-Mart Ltd, RM3 8SB



Informacja o odpadach i utylizacja dla użytkowników sprzętu elektrycznego i elektronicznego.

Usuwanie wyeksploatowanych urządzeń elektrycznych i elektronicznych (dotyczy krajów Unii Europejskiej i innych krajów europejskich z wydzielonymi systemami zbierania odpadów). Ten symbol na produkcie lub jego opakowaniu oznacza, że produkt nie powinien być zaliczany do odpadów domowych. Należy go przekazać do odpowiedniego punktu, który zajmuje się zbieraniem i recyklingiem urządzeń elektrycznych i elektronicznych. Prawidłowe usunięcie produktu zapobiegnie potencjalnym negatywnym konsekwencjom dla środowiska naturalnego i zdrowia ludzkiego, których przyczyną mogłoby być niewłaściwe usuwanie produktu.

Recykling materiałów pomaga w zachowaniu surowców naturalnych.

Śledź Nas



duronic.com

Gebruikershandleiding Nederlands

Safety Instructions

PLEASE READ THIS MANUAL CAREFULLY BEFORE USING AND RETAIN IT FOR FUTURE REFERENCE

- This appliance is for indoor/household use only. Do not use outdoors.
- The IM120 Ice Maker is only for domestic use, it is not for commercial use.
- This appliance is not intended for use by persons (including children) with reduced physical, sensory or mental capabilities, or lack of experience and knowledge, unless they have been given supervision or instruction concerning use of the appliance by a person responsible for their safety.
- Do not operate this appliance if the power cable or plug is damaged. If either is damaged, return the machine to Duronic for service or repair by professional technician.
- Please ensure the mains power supply is 220-240V / 50Hz.
- Never try to replace the parts and repair the unit by yourself.
- To reduce the risk of electric shock, never operate this product near water, with wet hands, spill liquid on the appliance or submerge it in water or any other liquid.
- Do not use the ice maker machine near gas or other inflammable materials (such as benzene, paint thinner, sprays, etc.)
- Do not place the appliance on or near a hot gas or on a heated oven.
- Keep the machine 15cm from other objects to ensure heat has space to escape from the vents.
- Do not put any extension leads or portable power supplies near or behind the appliance.
- Do not use any accessories which are not recommended by Duronic.
- Do not insert any foreign or electrical objects into the appliance.
- Do not store explosive substances such as aerosol cans with a flammable propellant in or next to this appliance.
- The refrigerant and insulation blowing gas inside this machine is flammable. When disposing of the appliance, do so only at an authorised waste disposal centre. Do not expose the appliance to flames.
- Unplug the appliance after using it or before cleaning it.
- When cleaning the ice maker machine, do not use sharp utensils, steel

Safety Instructions (Continued)

wool, metal scouring pads or abrasive cleaners as they will scratch or damage the appliance.

- Do not use distilled water in this machine. Mineral water is recommended.
- When moving the appliance, do not tilt the machine more than 45 degrees and do not turn the machine upside down. This may damage the compressor and the sealing system.
- It is normal for the compressor and condenser surface to reach temperatures between 70°C and 90°C during operation and the surrounding areas may be very hot.
- Due to the fast freezing process, ice cubes may appear “cloudy”. This is normal, it is air trapped in the water during the freezing process and it will not affect the quality or taste of the ice.

Specifications

MODEL	POWER	VOLTAGE RATING	WATER TANK CAPACITY	DIMENSIONS
ICM120	120W	220-240V / 50Hz	1.5L	22.4 x 30.8 x 28.3cm

Features:

- The IM120 makes bullet-shaped ice cubes
- Up to 9 pieces of ice can be made per eight minutes
- Daily ice output: 12kg / 26.5lbs per 24 hours
- Ice storage facility: 1.5L / 600g
- Refrigerant: R600a
- Noise level: $\leq 60\text{dB(A)}$ [ambient noise level $\leq 17\text{dB(A)}$]
- Prompts when ice basket is full and when water level is insufficient.

Components

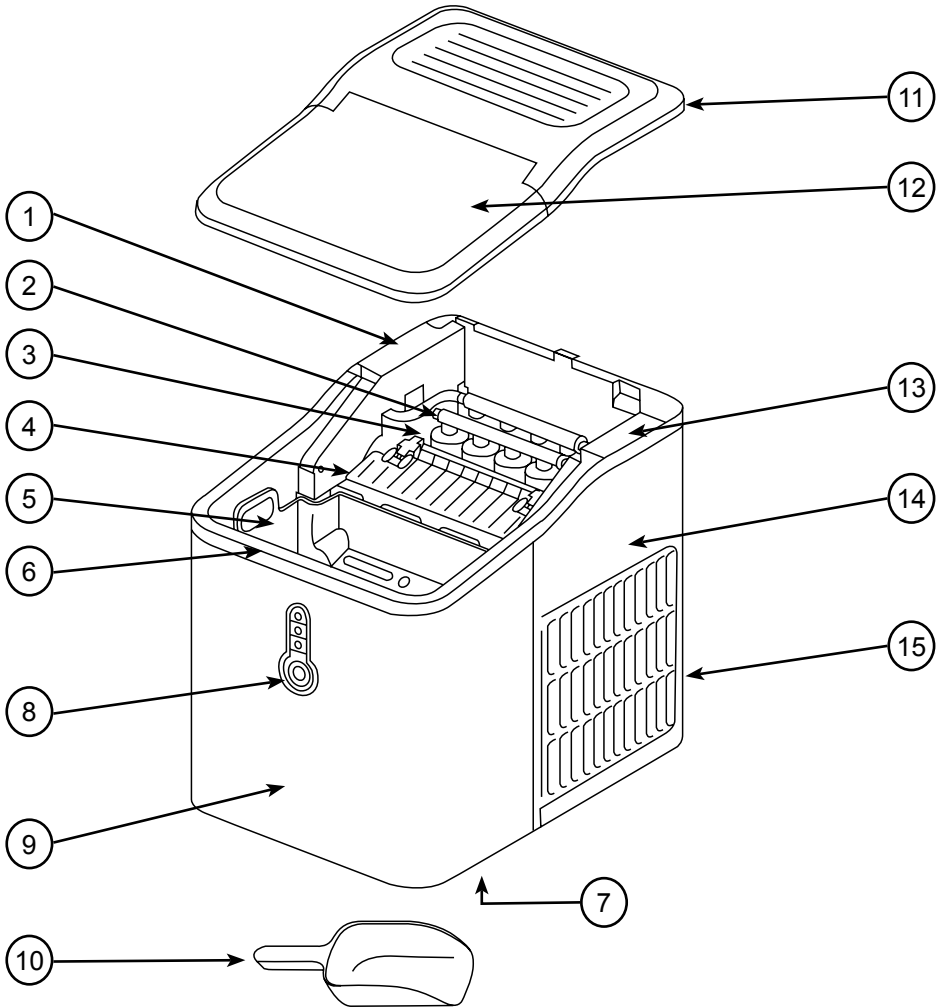

- 1. Micro switch
- 2. Evaporator
- 3. Water tray
- 4. Ice shovel
- 5. Ice basket
- 6. Water tank

- 7. Drainage plug
- 8. Control panel
- 9. Front housing
- 10. Ice scoop
- 11. Top cover
- 12. Transparent lid

- 13. Motor
- 14. Back housing
- 15. Air vent

Before First Use

- Before first use, remove all the packing materials, check the machine carefully and make sure that the machine, power cable and plug are normal and do not have any damage.
- The machine should be positioned on a level surface. To ensure sufficient ventilation, the distance of the back of ice maker to the wall and surrounding objects should be at least 15cm. It should not be positioned near an oven, radiator or any other heat source.
- Before using the machine for the first time, place the machine and leave the transparent cover open for at least two hours.
- Distilled water should not be used. Mineral water is recommended.

The Control Panel

There are light 3 indicators and 1 button on the control panel:

ICE FULL	Ice full alarm
ADD WATER	Water shortage alarm
ICE MAKING	Ice is being produced
	Power button



Before First Use

ICE MAKING:

- When you plug in the ice maker machine the ICE MAKING light indicator will flash.
- Press the power button to switch on the machine. The ICE MAKING indicator light will stay on and the machine will start to make ice cubes.
- After the first batch of ice cubes have finished being made, the de-icing will activate, followed by the ice shovel which will move the ice into the ice basket.

ADD WATER:

- When the ADD WATER light turns red, it means that there is not enough water left in the tank. You will need to add more water and then press the power button to restart the machine.



Do not fill up the tank directly from a tap. When refilling the water tank, use a bottle or jug to pour water into it.

ICE FULL:

- When the ice cubes fill up the ice basket and it reaches the maximum capacity, the ICE FULL light will flash, and the machine will automatically stop. You will then need to empty the ice basket using the ice scoop.
- Once the sensor inside the machine can detect the ice basket is empty, the machine will restart automatically and continue making ice cubes.

How to Use

1. Open the transparent lid, take out the ice basket and add water to the water tank. The water should not exceed the MAX mark.
Use either cold or room-temperature water to fill the tank. Do not fill the tank with hot water.
If the water exceeds the MAX mark, you will need to drain a little water away. You do this by opening the bottom drain plug and releasing some water.
2. Put the ice basket back into the machine and close the lid.
3. Plug in the machine and switch it on at the plug.
4. Press the power button to start the machine.
5. The machine will start to make ice cubes.
6. The ICE MAKING indicator light will light up stay on while the machine works making the ice cubes.
7. When the ice basket is full, the machine will automatically stop. Remove the ice cubes using the ice scoop. The machine will then restart and

continue making ice cubes.

8. When you have finished making ice cubes, turn off the machine by pressing the power button again. Switch off the plug socket and unplug the cable from the mains socket.

Cleaning and Maintenance

Clean the inside of the machine (ice basket, water tank, ice shovel) and the ice scoop frequently.

How to clean your ice maker:

1. Switch off the machine and allow it to de-ice for a 2-3 hours. Do not use any mechanical devices or any other means to accelerate the defrosting process.
2. Before cleaning, unplug the machine and remove any ice cubes from the ice basket.
3. Use a diluted solution of water and white vinegar to clean the inside and the outside surface of the machine using a cloth. Do not use chemicals or diluted agents such as acids, gasoline or oil on the machine.
4. After using the water/vinegar solution to wipe over the machine, rinse the cloth in water and wipe over the same parts again to clean away the solution.
5. Allow the machine to air and dry thoroughly. Keep ventilation openings in/on the machine clear of obstruction.

To ensure the ice made is fresh, change the water in the reservoir at least once a day. If you do not plan to use the machine for a long time, drain the water out and clean the machine before storing it away.

Troubleshooting

Note: If the power is accidentally disconnected while the machine is on during an ice making cycle, small ice chips may form and lodge in the ice shovel. If this occurs, check that the machine is switched off at the mains socket, then gently push the shovel backwards towards the rear of the machine to remove ice chips. Then restart the machine as normal.

Problem	Possible Cause	Suggested Solutions
The ice shovel does not move ice into the ice basket.	The water tank is not on a flat even surface.	Check that the surface the machine is on is flat and even. With the machine switched off at the plug, gently push the ice shovel using your finger, then press the power button to restart it.
The compressor works abnormally with a buzzing noise	The voltage is lower than recommended.	Stop the machine and do not restart it until it's plugged into the correct voltage.
Water shortage indicator light is on.	1. There is no water 2. The pump is full of air	1. Add to some water until it reaches MAX position. 2. Press POWER button to restart the machine.
Indicator lights on display are not on.	1) No power 2) Blown fuse	1) Turn the power on 2) Replace fuse
The Ice made is too large and with pieces sticking together.	Ice of previous cycles left in the water tray.	Take out the ice under the standby state.
The ice making process was correct, but no ice has come out.	1. The compressor has no refrigerant 2. Compressor damaged 3. Fan motor damaged	Call Duronic Customer Care Team for advice.
All indicators twinkle simultaneously.	Water tray is blocked by ice cubes.	Unplug the power, take out the ice which blocking the tray, then plug in the power and press the POWER button. The machine will restart after around 3 minutes.
The machine has been working, but the water has been warming up	Solenoid has broken down	Call Duronic Customer Care Team for advice
When the ice is full, the machine does not display the ICE FULL icon	'Ice Full' sensor is damaged	Call Duronic Customer Care Team for advice

Garantie

1 Jaar Garantie van Shine-Mart Ltd Handelsmerk eigenaars van Duronic Producten. LET OP: DEZE STELLINGEN HEBBEN GEEN INVLOED OP UW WETTELIJKE RECHTEN ALS CONSUMENT

Dit product is vervaardigd onder de strengste kwaliteitscontrole procedures, met materialen van de hoogste kwaliteit, om uitstekende werking en betrouwbaarheid te verzekeren. Het zal zeer goed en langdurig dienstdoen, naar gelang het correct gebruikt en onderhouden wordt. Het product heeft 1 jaar garantie van de originele aankoopdatum. Als een defect zich toont vanwege een materiaal- of constructiefout, dient het defecte apparaat bij de originele aankoop locatie geretourneerd te worden. Terugbetaling of vervanging is ter discretie van dat bedrijf.

Duronic Producten worden aangeboden met een 1-jarige garantie onder de volgende omstandigheden:

1. Het product dient naar de verkoper geretourneerd te worden met aankoopbewijs.
2. Het product dient geïnstalleerd en gebruikt te worden naar de instructies in deze gebruikshandleiding.
3. Het product is alleen geschikt voor huishoudelijk gebruik.
4. De garantie dekt geen gebruiksschade, opzettelijke schade, verkeerd gebruik of verwaarlozing.
5. Shine-Mart Ltd heeft geen verantwoordelijkheid voor accidentele schade of verlies.
6. Shine-Mart Ltd is niet aansprakelijk voor onderhoud onder de garantie.
7. Alleen geldig in Nederland



Dit product is uitgerust met een CE:1363 stekker en zekering.
Geïmporteerd door Shine-Mart Ltd, RM3 8SB



Informatie over afvalverwerking voor Afgedankte Elektrische en Elektronische Apparatuur (AEEA).

Dit teken geeft aan dat een product en/of bijbehorende documentatie bij verwijdering, dient te worden behandeld als Afgedankte Elektrische en Elektronische Apparatuur (AEEA).

Alle AEEA gemarkeerde producten dienen niet te worden gemengd met algemeen huishoudelijk afval, maar moeten apart worden gehouden voor de behandeling, herwinning en hergebruik van de gebruikte materialen.

Volg ons



duronic.com

DURONIC