

apuro

Meat Mincer

Instruction manual



**Model:
CD400-A**

Safety Tips

- Position on a flat, stable surface.
- A service agent/qualified technician should carry out installation and any repairs if required. Do not remove any components on this product.
- Consult Local and National Standards to comply with the following:
 - Health and Safety at Work Legislation
 - Fire Precautions
 - Wiring Regulations
 - Building Regulations
- DO NOT feed meat in to the appliance by hand. ALWAYS use the pusher supplied.
- DO NOT use fingers to clear the exit hole while the appliance is turned on.
- DO NOT allow the motor to work against a blockage for any length of time.
- DO NOT immerse in water.
- Only use original Apuro parts and attachments with this appliance.
- Unplug from outlet when not in use, before putting on or taking off parts, and before cleaning.
- Always carry the appliance by the motor housing.
- Not suitable for outdoor use.
- Keep all packaging away from children. Dispose of the packaging in accordance to the regulations of local authorities.
- If the power cord is damaged, it must be replaced by a Apuro agent or a recommended qualified technician in order to avoid a hazard.
- Apuro recommend that this appliance is PAT tested on an annual basis to ensure the product remains safe.

Introduction

Please take a few moments to carefully read through this manual. Correct maintenance and operation of this machine will provide the best possible performance from your Apuro product.

Pack Contents

The following is included:

- Apuro Meat Mincer
- Hopper tray
- Food pusher
- Feed screw
- Cutting blade
- Cutting plate (coarse - 8mm)
- Cutting plate (medium - 6mm)
- Instruction manual
- Sausage maker assembly

Apuro prides itself on quality and service, ensuring that at the time of packaging the contents are supplied fully functional and free of damage.

Should you find any damage as a result of transit, please contact your Apuro dealer immediately.

Assembly

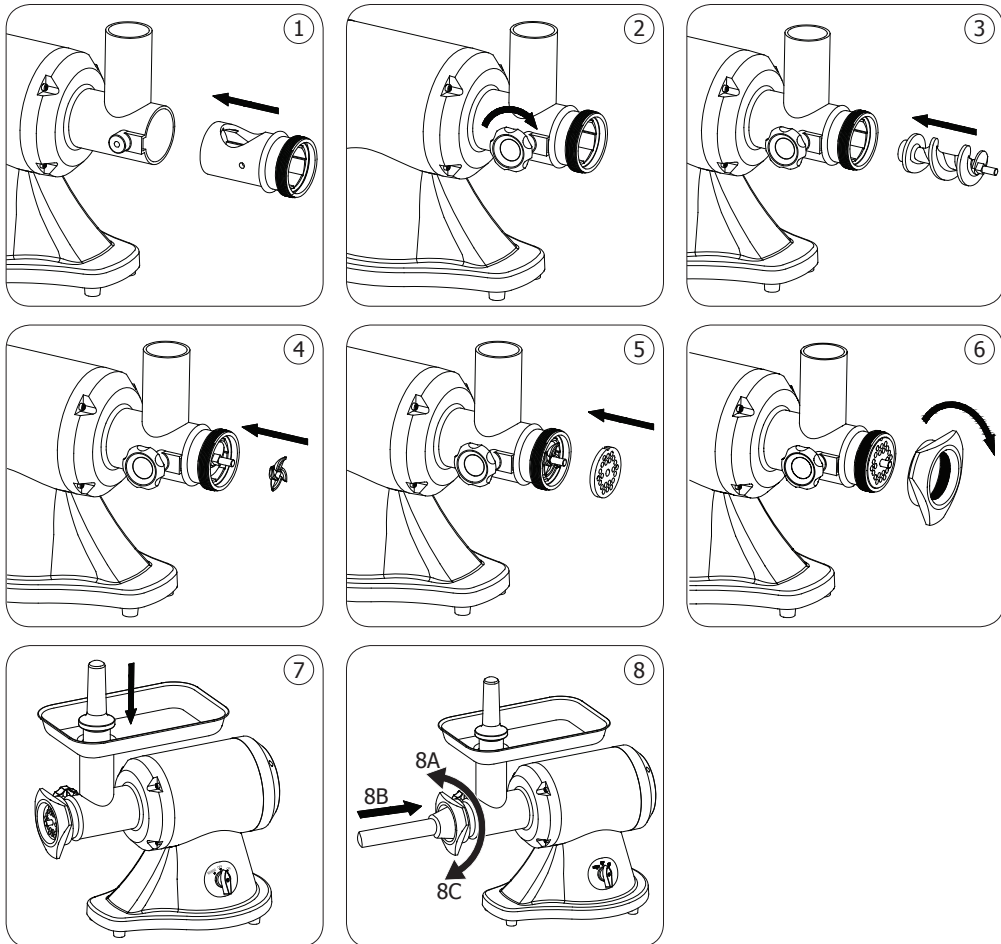

1. Insert the mincing barrel into the motor housing mouth, with the shaft facing upwards [Fig. 1].
2. Tighten the locking knob [Fig. 2].
3. Insert the feed screw into the mincing barrel. Turn the screw slightly to slot the base of the screw on to the transmission shaft, if necessary [Fig. 3].
4. Insert the cutting blade on to the end of the feed screw [Fig. 4].



Note: Ensure the flat face of the blade faces forwards as illustrated.

5. Match the groove on the edge of the desired cutting plate to the pin on the mincing barrel. Slide the cutting plate on to the feed screw [Fig. 5].
6. Screw the barrel cap on to the end of the mincing barrel until tight [Fig. 6].
7. Twist the hopper tray into place [Fig. 7].
8. If to make sausage, install the desired sausage maker onto the mincing barrel as illustrated (Fig. 8).
Note: Before this, ensure to unscrew the barrel cap first. After the sausage maker mounted in place, re-attach the barrel cap and screw tight.

Operation



Note: Clean the appliance with warm soapy water and dry thoroughly before using for the first time.

1. Cut the meat into small enough pieces to fit in to the hole in the hopper tray.
2. Turn the power switch ON.
3. Feed the meat into the shaft using the food pusher.



WARNING: Never push the meat into the shaft using your fingers.

If the circuit breaker stops the appliance or the appliance becomes jammed:

1. Turn Off the appliance immediately.
2. Press the RESET button located at the back of the appliance above the power cord.
3. Turn and HOLD the switch in the reverse position to clear the blockage.
4. Remove and clear the mincing barrel and all components.

Cautions

- When carrying the unit, hold the Motor Housing with both Hands, not to hold only Plate.
- Be careful to carry the unit because it is very heavy.
- Do not grind hard food such as bones or nuts.
- Do not grind food with hard fiber (e.g. ginger).
- The air passage at the bottom and the side of Motor Housing.
- To avoid jamming, do not force to operate the unit with excessive pressure.
- Do not unplug the appliance by pulling the cord. To unplug, grasp the plug not the cord.
- Make sure that the voltage and frequency indicated on the rating plate are the same as your local supply, and that the external earthed wire is reliable connected.
- The appliance should be used strictly in accordance with these instructions as no liability can be accepted for any damage caused by non-compliance with these instructions, or any other improper of handling.

Cleaning, Care & Maintenance



Note: Always switch off and disconnect the appliance from the power supply before cleaning.

- Do not use any abrasive cleaning agents on the appliance. Use warm soapy water.
- Do not immerse the motor housing in water. Clean the exterior with a damp cloth.
- Always dry thoroughly after cleaning.
- A Apuro agent or qualified technician should carry out repairs if required.

For ease of cleaning, disassemble the appliance:

- Unscrew the barrel cap.



Note: If the cap has been put on too tight, knock the corners of the cap with a rubber mallet or similar instrument to loosen it.

- Remove the mincing barrel, plate, blade and feed screw as one unit. Gently tip the barrel to remove the pieces one by one.
- Twist off the hopper tray.
- Remove meat from all components and wash in warm, soapy water.
- Dry thoroughly.
- Lubricate the parts with a little cooking oil before replacing for best performance.

Troubleshooting

If your Apuro appliance develops a fault, please check the following table before making a call to the Helpline

Fault	Probable Cause	Solution
The unit is not working	The unit is not switched on	Check the unit is plugged in correctly and switched on
	Plug and lead are damaged	Call Apuro agent or qualified technician
	Fuse in the plug has blown	Replace the plug fuse
	Power supply	Check power supply
	Internal wiring fault	Call Apuro agent or qualified technician
	Thermal cut-out switch has activated	Reset Thermal cut-out switch (Page 4)
Minced meat does not exit the appliance evenly	The barrel cap is on too tight	Loosen the cap
	The cutting plate is blocked	Remove and clean the plate
	The cutting blade is blunt	Replace the cutting blade

Technical Specifications

Model	Voltage	Power	Output	Dimensions h x w x d (mm)	Weight
CD400-A	230V 50Hz	800W	250kg/hour	410 x 328 x 517	24.5kg

Electrical Wiring

The plug is to be connected to a suitable mains socket.

This appliance is wired as follows:

- Live wire (coloured brown) to terminal marked L
- Neutral wire (coloured blue) to terminal marked N
- Earth wire (coloured green/yellow) to terminal marked E

This appliance must be earthed.



If in doubt consult a qualified electrician.

Electrical isolation points must be kept clear of any obstructions. In the event of any emergency disconnection being required they must be readily accessible.

Compliance

The WEEE logo on this product or its documentation indicates that the product must not be disposed of as household waste. To help prevent possible harm to human health and/or the environment, the product must be disposed of in an approved and environmentally safe recycling process. For further information on how to dispose of this product correctly, contact the product supplier, or the local authority responsible for waste disposal in your area.



Apuro parts have undergone strict product testing in order to comply with regulatory standards and specifications set by international, independent, and federal authorities.



Apuro products have been approved to carry the following symbol:



All rights reserved. No part of these instructions may be produced or transmitted in any form or by any means, electronic, mechanical, photocopying, recording or otherwise, without the prior written permission of Apuro.

Every effort is made to ensure all details are correct at the time of going to press, however, Apuro reserves the right to change specifications without notice.

DECLARATION OF CONFORMITY

Equipment Type	Heavy Duty Meat Mincer - 250kg/hr
Model	CD400-A
Legislation	Electrical Safety Electromagnetic Compatibility
Standards	IEC 60335-1 (fifth Edition) IEC 60335-2-64:2008 (edition 3.1) EN55014-1:2017 EN55014-2:2015 EN61000-3-2:2014 EN61000-3-3:2013
Producer Name	Apuro
Producer Address	15 Badgally Road, Campbelltown, NSW 2560

I, the undersigned, hereby declare that the equipment specified above conforms to the above Legislation and Standard(s)

Date	21/05/2018
Signature	
Full Name	Ashley Hooper
Position	Technical & Quality Manager



CD400-A_A5_v3_20180531