

# SKIPIO

By Experts  
For Experts

[WWW.SKIPIOGROUP.COM](http://WWW.SKIPIOGROUP.COM)

# SKIPIO

### Sydney Branch

ADD: 218 Woodpark Road Smithfield NSW 2164  
TEL: +61 2 8798 5061 / 5283 / 5581  
FAX: +61 2 8798 5283  
EMAIL: [admin@skipio-australia.com](mailto:admin@skipio-australia.com)

### Melbourne Branch

ADD: 55 Lara Way Campbellfield VIC 3061  
TEL: +61 3 8405 3359/ 9408 4081  
EMAIL: [adminvic@skipio-australia.com](mailto:adminvic@skipio-australia.com)

### Brisbane Branch

ADD: 3/74 Murdoch Circuit, Acacia Ridge 4110 QLD  
TEL: +61 7 3155 0250  
EMAIL: [adminqld@skipio-australia.com](mailto:adminqld@skipio-australia.com)

### SKIPIO KOREA Factory

ADD: 971, Sihwahosu-ro, Danwon-gu, Ansan-si,  
Gyeonggi-do, Republic of Korea.

### SKIPIO QINGDAO Factory

ADD: Zhaizishan Road No. 1001, Huangdao Region,  
Qingdao, China.

SKIPIO

PRODUCT CATALOG 2021

# SKIPIO

by Experts, for Experts



\*The specifications of this catalog may change without any advance notice due to meet the demand of customers.

[WWW.SKIPIOGROUP.COM](http://WWW.SKIPIOGROUP.COM)





**Produce and Service  
all products directly.**



# SKIPIO

SKIPIO is an international commercial refrigeration manufacturer with its Korean headquarter in Seoul and factory fully operated in Ansan. We SKIPIO have long-term global experience and abundant knowledge in sales, manufacturing and technology for refrigeration. Our expertise lies in the field of commercial refrigerated cabinets, bakery showcases, ice makers, blast chillers, custom-made products, and so on.

We produce 30,000 units per year in these factories with the most cutting -edge facilities and manufacturing equipment such as NCTs, individual foaming jigs, and automatic bending machines along with mass production lines. With such high-tech-equipment, we inspect and assess every single product thoroughly in our performance test laboratory and Institute of Technology. SKIPIO manufactures products with a high level of efficiency and quality, and exports its products to five continents including 67 countries in Europe, Asia, America and so forth. we have built our reputation and trust in the global markets for years through our quality products, product performance and satisfactory after-sales service.

## AUSTRALIA BRANCH



SYDNEY



MELBOURNE



BRISBANE

# SKIPIO GLOBAL NETWORK



## SKIPIO FACTORY



### KOREA FACTORY SYSTEM

ADD : 971, Sihwahosu-ro, Danwon-gu, Ansan-si, Gyeonggi-do, Republic of Korea.



### CHINA FACTORY

ADD : Zhaizhisan Road No. 1001, Huangdao Region, Qingdao, China.

## FACTORY LINE



Manufacturing Line



Foaming Line



Assembly Line



Quality Control



Warehouse

# INDEX SKIPIO PRODUCTS

## REACH-IN / BAR LINE

---



GLASSDOOR MERCHANDISER  
ICE CREAM GLASS DOOR FREEZER

#7



REACH-IN

#13



REACH-IN  
[GLASS DOOR]

#16



UNDER COUNTER

#21



UNDER COUNTER  
[GLASS DOOR]

#23



UNDER COUNTER  
[DRAWER]

#24



SALAD PREP TABLE  
[BUFFET]

#29



SALAD PREP TABLE  
[HOOD LID]

#30



PIZZA TABLE

#31



BACK BAR

#33



SIDE-MOUNT BACK BAR

#34

## DISPLAY LINE

---



#40

RECTANGLE  
BAKERY CASE



#43

GELATO CASE



#45

CHEF BASE

# SKIPIO

by Experts, for Experts



- GLASS DOOR  
MERCHANDISER  
- ICE CREAM  
GLASSDOOR FREEZER

[SWING DOOR]



• LED LIGHT BOX



• DIGITAL CONTROL SYSTEM



• LED LAMP

Display effect enhanced,  
Low energy consumption



• DRAIN WATER EVAPORATION SYSTEM



• DOOR HANDLE

Easy Grip Door Handle



• QUALITY IMPORTED COMPRESSOR



• SHELVES

# GLASS DOOR MERCHANDISER

\* Standard - Plain white AD decal



Fan cooling



Digital



LED lamp

SGM-18



SGF-18



SGM-18  
SGF-18

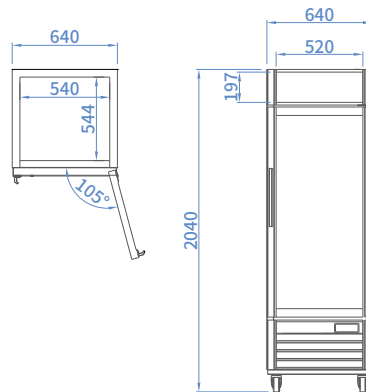

MODEL	SGM-18	SGF-18
Classification	Refrigerator	Freezer
Cabinet Dimension (WxDxH mm)	640 x 700 x 2040	
Capacity (ℓ)	420	
Inner Temperature (°C)	1~ 8	-25 ~ -15
Ambient Temperature (°C)	40	38
Refrigerant	R-134a	R-404a
Insulation Type	Polyurethane / Cyclopentane + CFC Free	
Amps (A)	1.7	3
Voltage (V/Hz/Ph)	240 / 50 / 1	
Weight (Kg)	80	
Door Type	Swing Door	
Number of Doors	1	
Power (W)	380	642
Number of Shelves	3	
Power Plug	10A	

GLASS DOOR MERCHANDISER

REACH-IN

UNDER COUNTER

BAR EQUIPMENT

ICE MAKER

DISPLAY CASE

SPECIAL MODEL

BAKING LINE

# GLASS DOOR MERCHANDISER



Fan cooling



Digital



LED lamp

SGM-35



SGM-49



SGM-72

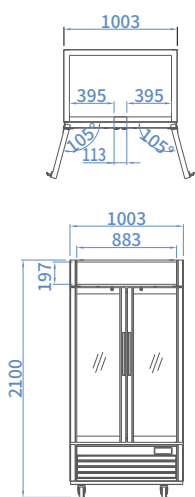

SGM-35

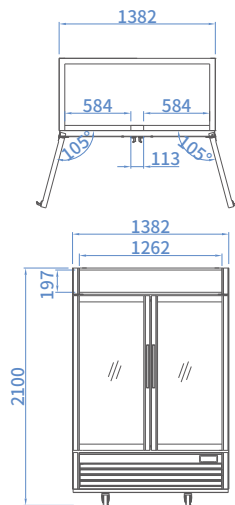

SGM-49

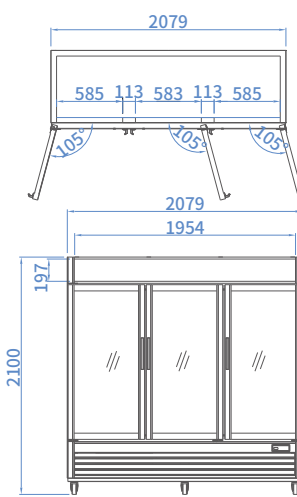

SGM-72

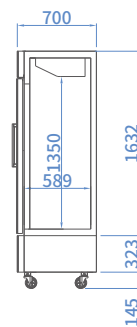

MODEL	SGM-35	SGM-49	SGM-72
Classification		Refrigerator	
Cabinet Dimension (WxDxH mm)	1003 x 700 x 2100	1382 x 700 x 2100	2079 x 700 x 2100
Capacity (ℓ)	752	1039	1604
Inner Temperature (°C)		1~ 8	
Ambient Temperature (°C)		40	
Refrigerant		R-134a	
Insulation Type		Polyurethane/ Cyclopentane + CFC Free	
Amps (A)	2	2	5.5
Voltage (V/Hz/Ph)		240 / 50 / 1	
Weight (Kg)	140	160	220
Door Type		Swing door	
Number of Doors	2	2	3
Power (W)	435	435	550
Number of Shelves	8	8	12
Power Plug		10A	



# ICE CREAM GLASSDOOR FREEZER



Fan cooling



Digital



LED lamp

SGF-35

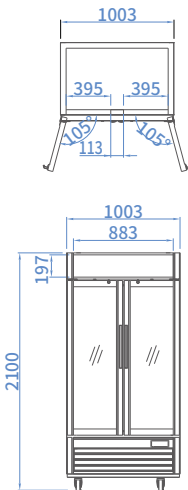

SGF-49

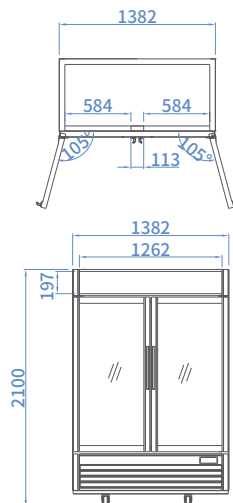

SGF-72

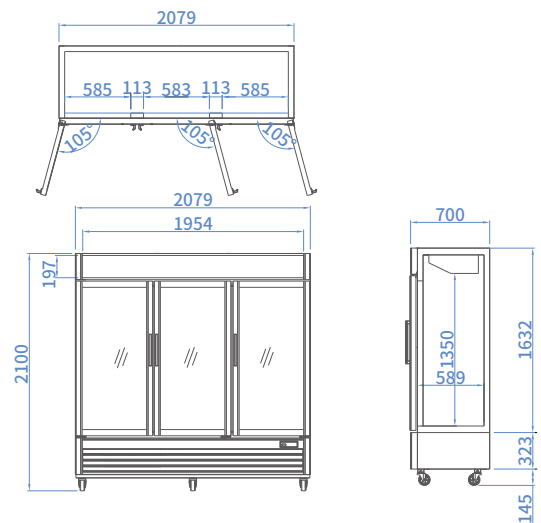

NSW GOV'T REBATE  
\$800 Till Aug 2021

MODEL	SGF-35	SGF-49	SGF-72
Classification	Freezer		
Cabinet Dimension (WxDxH mm)	1003 x 700 x 2100	1382 x 700 x 2100	2079 x 700 x 2100
Capacity (ℓ)	752	1039	1604
Inner Temperature (°C)	-25 ~ -15		
Ambient Temperature (°C)	38		
Refrigerant	R-404a		
Insulation Type	Polyurethane / Cyclopentane + CFC Free		
Amps (A)	4.5	5.2	8.6
Voltage (V/Hz/Ph)	240 / 50 / 1		
Weight (Kg)	140	160	220
Door Type	Swing door		
Number of Doors	2	2	3
Power (W)	982	1025	1125
Number of Shelves	8	8	12
Power Plug	10A	10A	15A

GLASS DOOR MERCHANDISER

REACH-IN

UNDER COUNTER

BAR EQUIPMENT

ICE MAKER

DISPLAY CASE

SPECIAL MODEL

BAKING LINE

---

# REACH-IN

[SOLID]

- REFRIGERATOR / FREEZER
- DUAL TYPE



# [GLASS]

## - REFRIGERATOR





# REACH-IN



SKIPIO

# REACH-IN Dual temp



Fan cooling



Digital



LED lamp

\* Standard - Wire Shelving Type

SRFT25-2

SRFT45-2

SRFT65-3

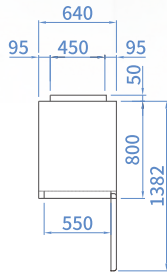

SRFT25-2

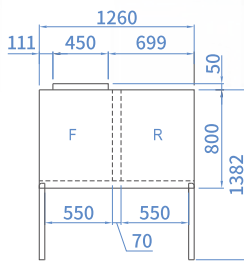

SRFT45-2

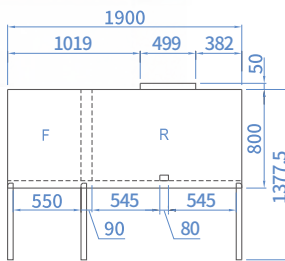

SRFT65-3

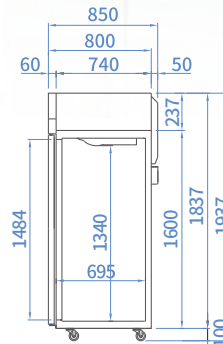

SIDE VIEW  
(Full Door)

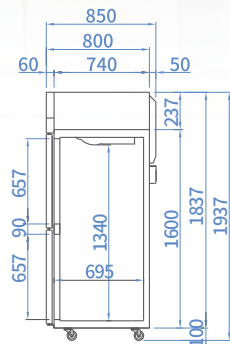

SIDE VIEW  
(Half Door)

MODEL	SRFT25-2	SRFT45-2	SRFT65-3
Classification	Refrigerator + Freezer		
Cabinet Dimension (WxDxH mm)	640 x 850 x 1937	1260 x 850 x 1937	1900 x 850 x 1937
Capacity (ℓ)	R:254 / F:254	R:507 / F:507	R:1124 / F:562
Inner Temperature (°C)	R:-2~ 8 / F: -21 ~ -12		
Ambient Temperature (°C)	R: 40 / F: 38		
Refrigerant	R-404a	R-134a / R-404a	R-134a / R-404a
Insulation Type	Polyurethane / Cyclopentane + CFC Free		
Amps (A)	3.5	4.5	5.5
Voltage (V/Hz/Ph)	240 / 50 / 1		
Weight (Kg)	85	152	177
Power (W)	653	732	1098
Number of Doors	2	2	3
Compressor (HP)	1/2	1/3	1/3
Number of Shelves	1	3	6
Power Plug	10A		

GLASS DOOR MERCHANDISER

REACH-IN

UNDER COUNTER

BAR EQUIPMENT

ICE MAKER

DISPLAY CASE

SPECIAL MODEL

BAKING LINE

# REACH-IN REFRIGERATOR / FREEZER

SRT25-1  
SFT25-1



SRT25-2  
SFT25-2



SRT45-2  
SFT45-2



MODEL	SRT25-1 SFT25-1	SRT25-2 SFT25-2	SRT45-2 SFT45-2	SRT45-4 SFT45-4	SRT65-3 SFT65-3
Classification	Refrigerator / Freezer				
Cabinet Dimension (WxDxH mm)	640 x 850 x 1937	640 x 850 x 1937	1260 x 850 x 1937	1260 x 850 x 1937	1900 x 850 x 1937
Capacity (ℓ)	574	572	1215	1210	1876
Inner Temperature (°C)	-2~ 8 / -21 ~ -12				
Ambient Temperature (°C)	40 / 38				
Refrigerant	R-134a / R-404a				
Insulation Type	Polyurethane / Cyclopentane + CFC Free				
Amps (A)	2.8 / 3.5	2.8 / 3.5	3.5 / 5.3	3.5 / 5.3	6 / 8.5
Voltage (V/Hz/Ph)	240 / 50 / 1				
Weight (Kg)	77 / 80	77 / 80	142 / 142	142 / 142	167 / 167
Power (W)	314 / 496	314 / 496	366 / 774	366 / 774	732 / 1346
Number of Doors	1	2	2	4	3
Compressor (HP)	1/4 2/3	1/4 2/3	1/3 1	1/3 1	3/4 3/4 x 2
Number of Shelves	3	3	6	6	9
Power Plug	10A				



Fan cooling



Digital



LED lamp

SRT45-4  
SFT45-4



SRT65-3  
SFT65-3

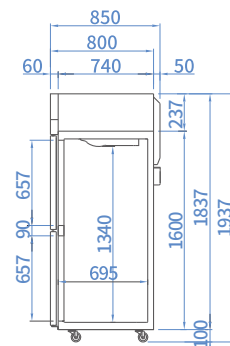
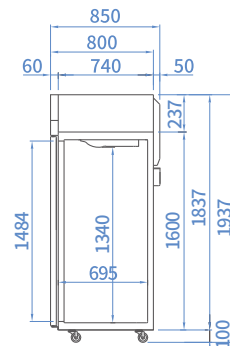
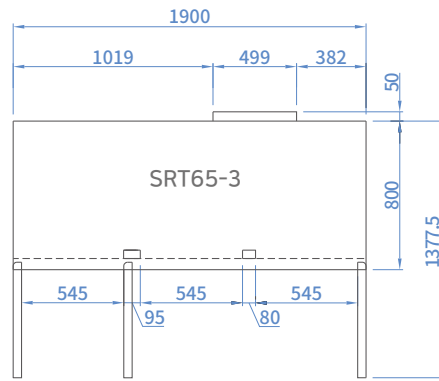
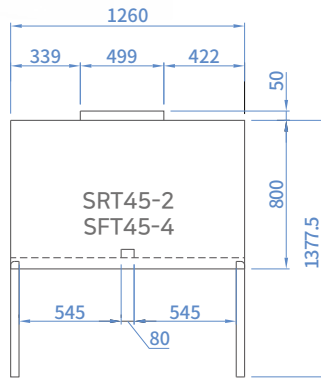
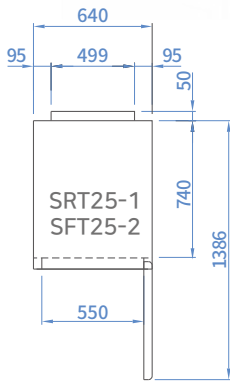

# REACH-IN [GLASS DOOR] REFRIGERATOR

SRT25-1G



SRT45-2G



MODEL	SRT25-1G	SRT45-2G	SRT65-3G
Classification	Refrigerator		
Cabinet Dimension (WxDxH mm)	640 x 850 x 1937	1260 x 850 x 1937	1900 x 850 x 1937
Capacity (ℓ)	574	1215	1876
Inner Temperature (°C)	-2 ~8		
Ambient Temperature (°C)	40		
Refrigerant	R-134a		
Insulation Type	Polyurethane / Cyclopentane + CFC Free		
Amps (A)	2.8	2.9	6
Voltage (V/Hz/Ph)	240 / 50 / 1		
Weight (Kg)	87	152	177
Power (W)	314	366	732
Number of Doors	1	2	3
Compressor (HP)	1/4	1/3	1/3x2
Number of Shelves	3	6	9
Power Plug	10A		





Fan cooling



Digital

\* SRT65-3G



GLASS DOOR MERCHANDISER

REACH-IN

UNDER COUNTER

BAR EQUIPMENT

ICE MAKER

DISPLAY CASE

SPECIAL MODEL

BAKING LINE

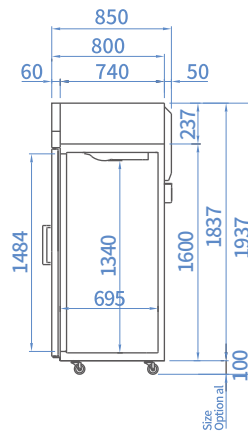
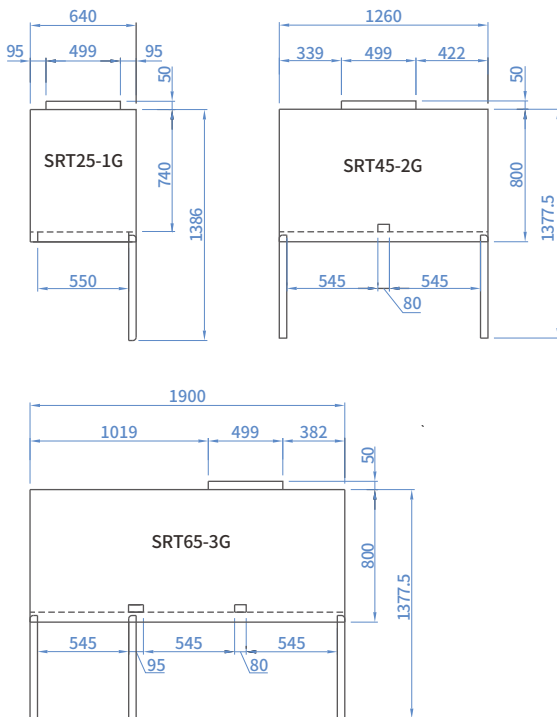

SIDE VIEW (Glass Door)

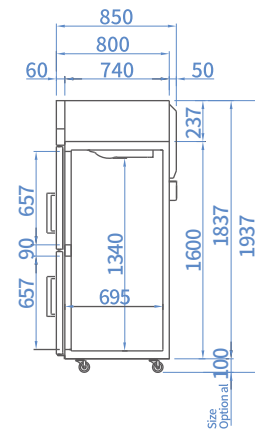

SIDE VIEW (Half glass Door)

---

# UNDER COUNTER

- SOLID TYPE

- DUAL TEMP



- GLASS DOOR

- DRAWER





# UNDER COUNTER



# UNDER COUNTER

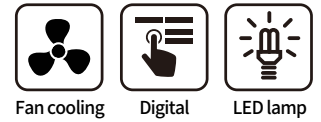

SUR9-1  
SUF9-1



SUR12-2  
SUF12-2



SUR15-2  
SUF15-2



SUR18-3  
SUF18-3



SUR24-4

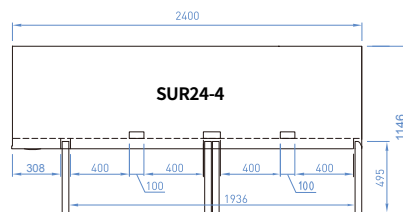
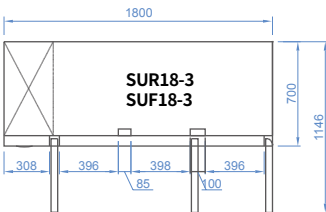
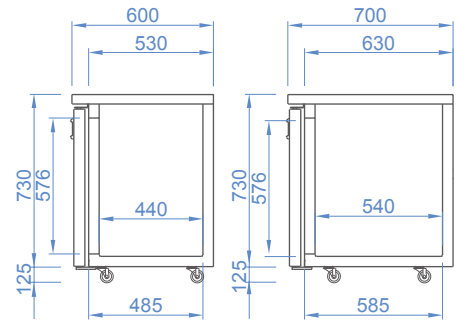
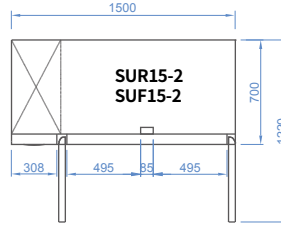
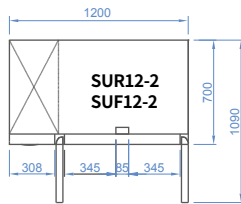
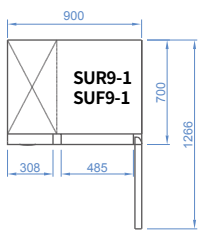

MODEL	SUR9-1 SUF9-1	SUR12-2 SUF12-2	SUR15-2 SUF15-2	SUR18-3 SUF18-3	SUR24-4
Classification	Refrigerator / Freezer				
Cabinet Dimension (WxDxH mm)	900x 700(600) x 855	1200 x 700(600) x 855	1500 x 700(600) x 855	1800 x 700(600) x 855	2400 x 700x 855
Capacity (ℓ)	179	280	395	505	600
Inner Temperature (°C)	-2~ 8 / -21 ~ -12				
Ambient Temperature (°C)	40 / 38				
Refrigerant	R-134a/R-134a	R-134a/R-404a	R-134a/R-404a	R-134a/R-404a	R-134a/R-404a
Insulation Type	Polyurethane / Cyclopentane + CFC Free				
Amps (A)	2.3/2.3	2.5/2.5	2.5/3	3/4.4	3.2
Voltage (V/Hz/Ph)	240 / 50 / 1				
Weight (Kg)	72	84	93	109	145
Power (W)	314/366	314/613	314/613	366/613	440
Number of Doors	1	2	2	3	4
Compressor (HP)	1/4 1/3	1/4 1/3	1/4 3/4	1/3 3/4	1/3
Number of Shelves	1	2	2	3	4
Power Plug	10A				

GLASS DOOR MERCHANDISER

REACH-IN

UNDER COUNTER

BAR EQUIPMENT

ICE MAKER

DISPLAY CASE

SPECIAL MODEL

BAKING LINE

# UNDER COUNTER Dual temp



Fan cooling



Digital



LED lamp

SURF12-2

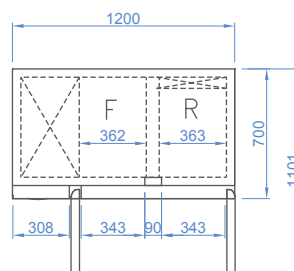

SURF 12-2

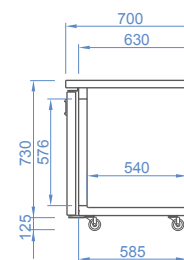

SURF15-2

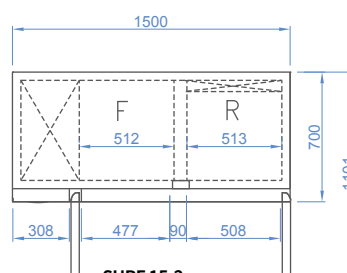
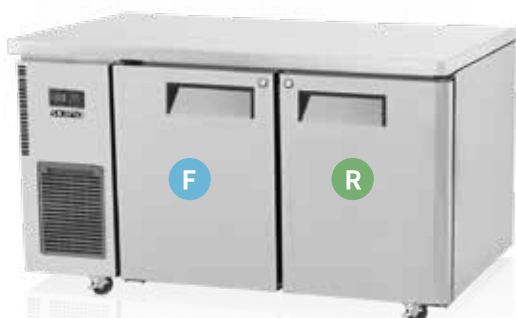

SURF 15-2

SURF18-3

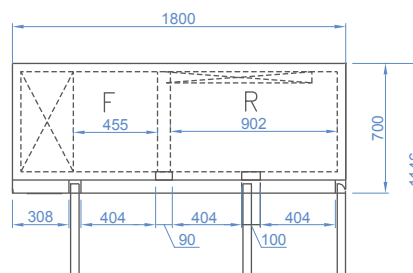

SURF 18-3

MODEL	SURF12-2	SURF15-2	SURF18-3
	Refrigerator / Freezer	Refrigerator / Freezer	Refrigerator / Freezer
Classification		Refrigerator + Freezer	
Cabinet Dimension (WxDxH mm)	1200x 700 x 855	1500x 700 x 855	1800x 700 x 855
Capacity (ℓ)	127/135	178/190	333/154
Inner Temperature (°C)		-2~ 8 / -21 ~ -12	
Ambient Temperature (°C)	38	38	38
Refrigerant	R-134a	R-404a	R-404a
Insulation Type	Polyurethane / Cyclopentane + CFC Free		
Amps (A)	3	4.35	4.4
Voltage (V/Hz/Ph)		240 / 50 / 1	
Weight (Kg)	92	101	120
Power (W)	316	316	366
Number of Doors	2	2	3
Compressor (HP)	1/3	3/4	3/4
Number of Shelves	1	1	2
Power Plug		10A	

# UNDER COUNTER Glass door



Fan cooling



Digital



LED lamp

SGR9-1



SGR12-2



SGR15-2



SGR18-3



SGR24-4

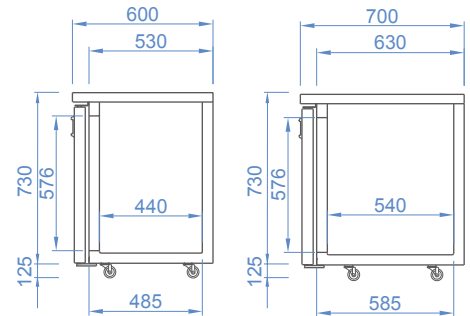
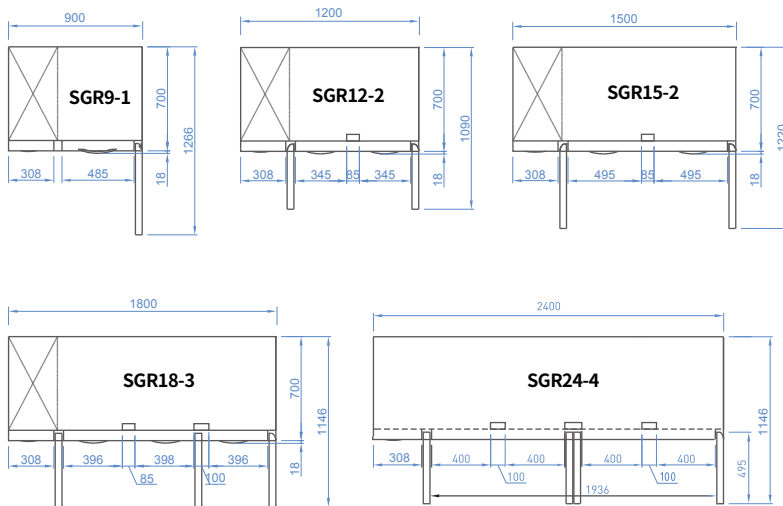

MODEL	SGR9-1	SGR12-2	SGR15-2	SGR18-3	SGR24-4
Classification	Refrigerator				
Cabinet Dimension (WxDxH mm)	900x 700(600) x 855	1200x 700(600)x 855	1500x 700(600) x 855	1800x 700(600) x 855	2400x 700 x 855
Capacity (ℓ)	179	280	395	505	600
Inner Temperature (°C)	-2~ 8				
Ambient Temperature (°C)	38				
Refrigerant	R-134a				
Insulation Type	Polyurethane / Cyclopentane + CFC Free				
Amps (A)	2.3	2.5	2.5	3	3.2
Voltage (V/Hz/Ph)	240 / 50 / 1				
Weight (Kg)	80	96	110	127	145
Power (W)	314	314	314	366	440
Number of Doors	1	2	2	3	4
Compressor (HP)	1/4	1/4	1/4	1/3	1/3
Number of Shelves	1	2	2	3	4
Power Plug	10A				

GLASS DOOR MERCHANDISER

REACH-IN

UNDER COUNTER

BAR EQUIPMENT

ICE MAKER

DISPLAY CASE

SPECIAL MODEL

BAKING LINE

# UNDER COUNTER Drawer

\*SUR9-3D-3  
\*SUF9-3D-3

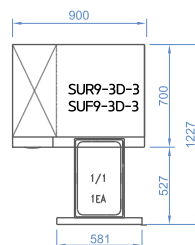

\*SUR12-3D-3  
\*SUF12-3D-3

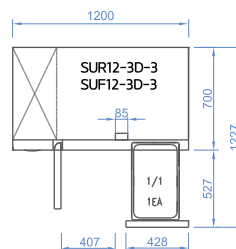

\*SUR12-3D-6  
\*SUF12-3D-6

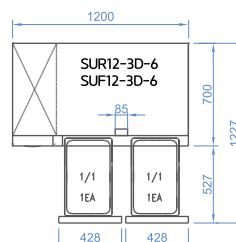

\*SUR15-3D-3  
\*SUF15-3D-3

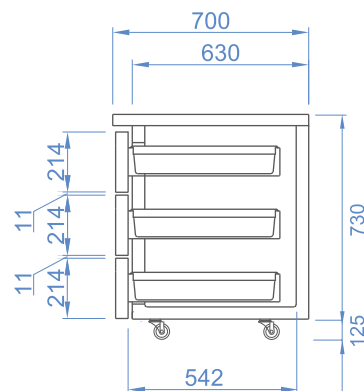
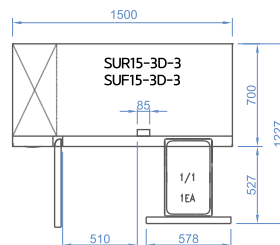

MODEL	SUR9-3D-3 SUF9-3D-3	SUR12-3D-3 SUF12-3D-3	SUR12-3D-6 SUF12-3D-6	SUR15-3D-3 SUF15-3D-3
Classification	Refrigerator / Freezer			
Cabinet Dimension (WxDxH mm)	900x 700 x 855	1200x 700 x 855	1200x 700 x 855	1500x 700 x 855
Capacity (ℓ)	179	280	280	395
Inner Temperature (°C)	-2~ 8 / -21 ~ -12			
Ambient Temperature (°C)	40 / 38			
Refrigerant	R-134a / R-134a	R-134a / R-404a	R-134a / R-404a	R-134a / R-404a
Insulation Type	Polyurethane / Cyclopentane + CFC Free			
Amps (A)	2.3/3	2.5/3.3	2.5/ 3.3	2.5 / 4.4
Voltage (V/Hz/Ph)	240 / 50 / 1			
Weight (Kg)	84	97	106	107
Power (W)	314/366	314/366	314/366	314/366
Number of Doors	0	1	0	1
Compressor (HP)	1/4 1/3	1/4 1/3	1/4 1/3	1/4 3/4
Number of Shelves	0	1	0	1
Power Plug	10A			





Fan cooling



Digital



LED lamp

- \* SUR15-3D-6
- \* SUF15-3D-6

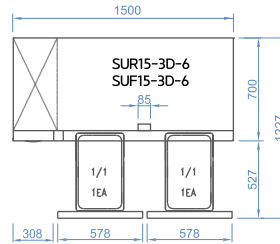

- \* SUR18-3D-3
- \* SUF18-3D-3

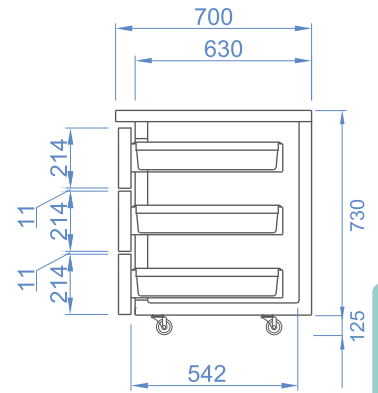
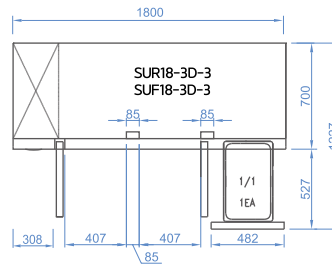

- \* SUR18-3D-6
- \* SUF18-3D-6

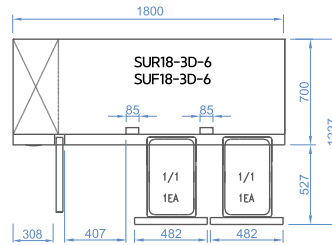

- \* SUR18-3D-9
- \* SUF18-3D-9

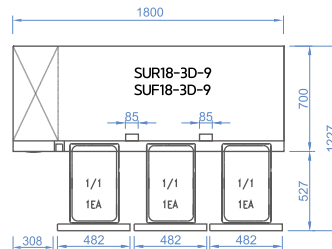

MODEL	SUR15-3D-6 SUF15-3D-6	SUR18-3D-3 SUF18-3D-3	SUR18-3D-6 SUF18-3D-6	SUR18-3D-9 SUF18-3D-9
Classification	Refrigerator / Freezer			
Cabinet Dimension (WxDxH mm)	1500x 700 x 855	1800x 700 x 855	1800x 700 x 855	1800x 700 x 855
Capacity (ℓ)	395	505	505	505
Inner Temperature (°C)	-2~ 8 / -21 ~ -12			
Ambient Temperature (°C)	40 / 38			
Refrigerant	R-134a / R-404a			
Insulation Type	Polyurethane / Cyclopentane + CFC Free			
Amps (A)	2.5/4.4	3/4.6	3/4.6	3/4.6
Voltage (V/Hz/Ph)	240 / 50 / 1			
Weight (Kg)	116	126	135	144
Power (W)	314/366	366/643	366/643	366/643
Number of Doors	0	2	1	0
Compressor (HP)	1/4 3/4	1/3 3/4	1/3 3/4	1/3 3/4
Number of Shelves	0	2	1	0
Power Plug	10A			

GLASS DOOR MERCHANDISER

REACH-IN

UNDER COUNTER

BAR EQUIPMENT

ICE MAKER

DISPLAY CASE

SPECIAL MODEL

BAKING LINE

# UNDER COUNTER Drawer

- \* SUR9-2D-2
- \* SUF9-2D-2

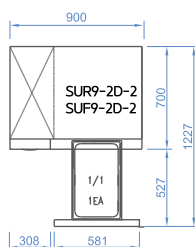

- \* SUR12-2D-2
- \* SUF12-2D-2

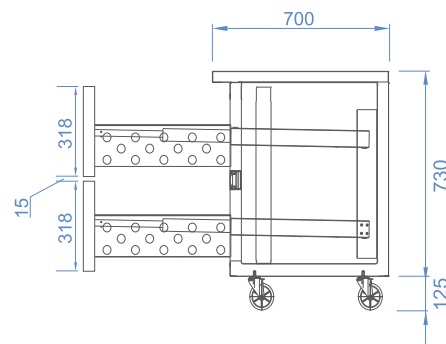
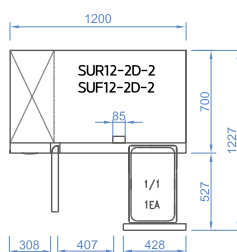

- \* SUR12-2D-4
- \* SUF12-2D-4

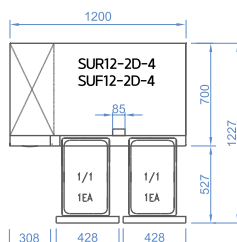

- \* SUR15-2D-2
- \* SUF15-2D-2

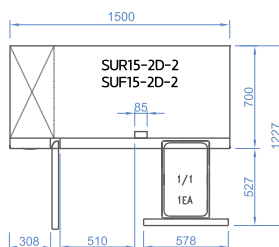

MODEL	SUR9-2D-2 SUF9-2D-2	SUR12-2D-2 SUF12-2D-2	SUR12-2D-4 SUF12-2D-4	SUR15-2D-2 SUF15-2D-2
Classification	Refrigerator / Freezer			
Cabinet Dimension (WxDxH mm)	900x 700 x 855	1200x 700 x 855	1200x 700 x 855	1500x 700 x 855
Capacity (ℓ)	179	280	280	395
Inner Temperature (°C)	-2~ 8 / -21 ~ -12			
Ambient Temperature (°C)	40 / 38			
Refrigerant	R-134a / R-134a	R-134a / R-404a	R-134a / R-404a	R-134a / R-404a
Insulation Type	Polyurethane / Cyclopentane + CFC Free			
Amps (A)	2.3/3	2.5/3.3	2.5/ 3.3	2.5 / 4.4
Voltage (V/Hz/Ph)	240 / 50 / 1			
Weight (Kg)	84	97	106	107
Power (W)	314/366	314/366	314/366	314/366
Number of Doors	0	1	0	1
Compressor (HP)	1/4 1/3	1/4 1/3	1/4 1/3	1/4 3/4
Number of Shelves	0	1	0	1
Power Plug	10A			



Fan cooling



Digital



LED lamp

- \* SUR15-2D-4
- \* SUF15-2D-4

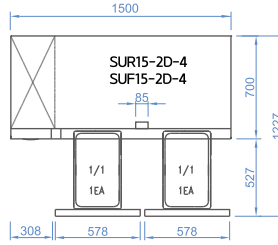

- \* SUR18-2D-2
- \* SUF18-2D-2

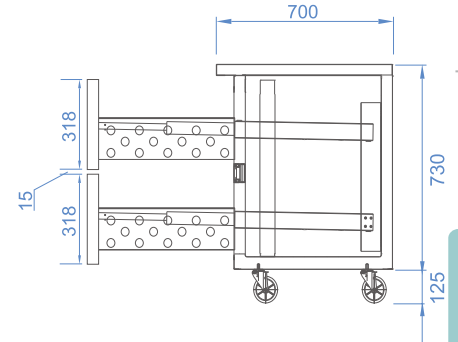
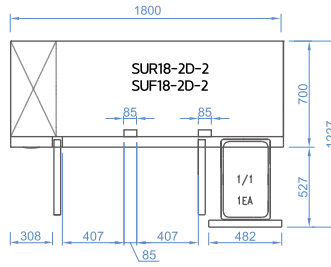

- \* SUR18-2D-4
- \* SUF18-2D-4

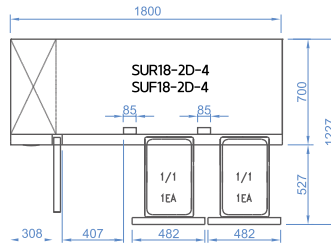

- \* SUR18-2D-6
- \* SUF18-2D-6

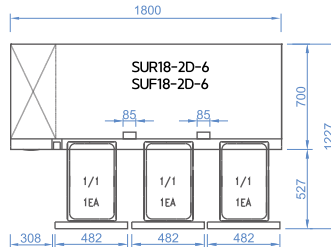

MODEL	SUR15-2D-4 SUF15-2D-4	SUR18-2D-2 SUF18-2D-2	SUR18-2D-4 SUF18-2D-4	SUR18-2D-6 SUF18-2D-6
Classification	Refrigerator / Freezer			
Cabinet Dimension (WxDxH mm)	1500x 700 x 855	1800x 700 x 855	1800x 700 x 855	1800x 700 x 855
Capacity (ℓ)	395	505	505	505
Inner Temperature (°C)	-2~ 8 / -21 ~ -12			
Ambient Temperature (°C)	40 / 38			
Refrigerant	R-134a / R-404a			
Insulation Type	Polyurethane / Cyclopentane + CFC Free			
Amps (A)	2.5/4.4	3/4.6	3/4.6	3/4.6
Voltage (V/Hz/Ph)	240 / 50 / 1			
Weight (Kg)	116	126	135	144
Power (W)	314/540	366/643	366/643	366/643
Number of Doors	0	2	1	0
Compressor (HP)	1/4 3/4	1/3 3/4	1/3 3/4	1/3 3/4
Number of Shelves	0	2	1	0
Power Plug	10A			

GLASS DOOR MERCHANDISER

REACH-IN

UNDER COUNTER

BAR EQUIPMENT

ICE MAKER

DISPLAY CASE

SPECIAL MODEL

BAKING LINE



# SALAD & PIZZA TABLE

SALAD SIDE PREP TABLE [BUFFET]

SALAD SIDE PREP TABLE [HOOD]



SKIPIO

# SALAD SIDE PREP TABLE BUFFET



Fan cooling



Digital



LED lamp

SSR9-1

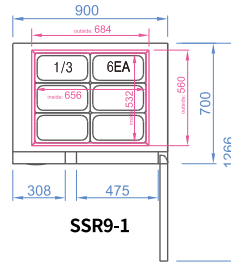

SSR9-1

SSR12-2

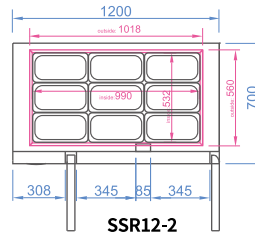

SSR12-2

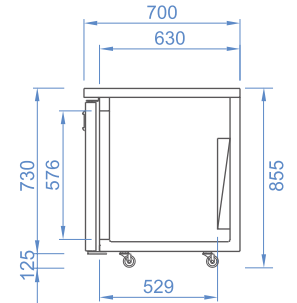

SSR15-2

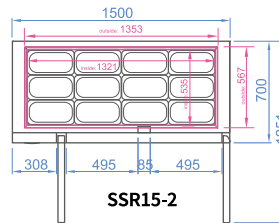

SSR15-2

SSR18-3

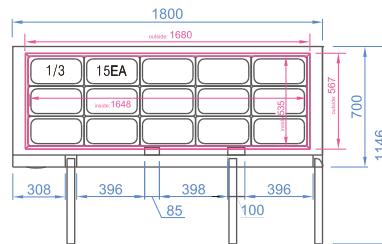

SSR18-3

**G/N Pan**  
(Pans Not Included)

MODEL	SSR9-1	SSR12-2	SSR15-2	SSR18-3
Classification	Refrigerator			
Cabinet Dimension (WxDxH mm)	900x 700 x 855	1200x 700 x 855	1500x 700 x 855	1800x 700 x 855
Capacity (ℓ)	233	343	458	568
Inner Temperature (°C)	-2~ 8			
Ambient Temperature (°C)	38			
Refrigerant	R-134a	R-134a	R-134a	R-134a
Insulation Type	Polyurethane / Cyclopentane + CFC Free			
Amps (A)	2.3	2.5	2.5	3
Voltage (V/Hz/Ph)	240 / 50 / 1			
Weight (Kg)	70	82	91	107
Power (W)	314	314	314	366
Number of Doors	1	2	2	3
Compressor (HP)	1/4	1/4	1/4	1/3
Number of Shelves	1	2	2	3
Power Plug	10A			

GLASS DOOR MERCHANDISER

REACH-IN

UNDER COUNTER

BAR EQUIPMENT

ICE MAKER

DISPLAY CASE

SPECIAL MODEL

BAKING LINE

# SALAD SIDE PREP TABLE HOOD LID

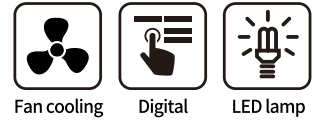

SHR9-1

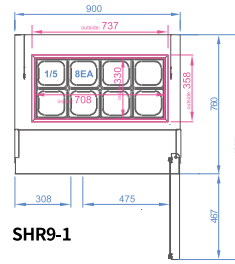

SHR9-1

SHR12-2

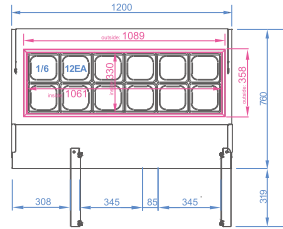

SHR12-2

SHR15-2

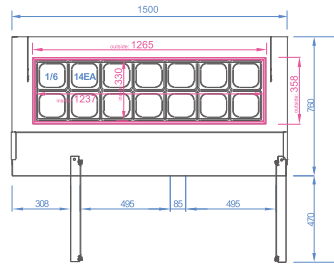

SHR15-2

SHR18-3

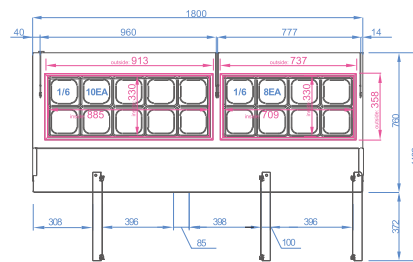

SHR18-3

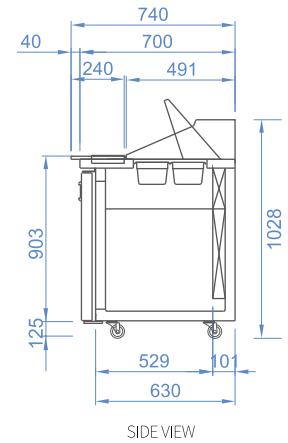

G/N Pan

(1/6 Pans Included)  
\*Withstand temperature up to 70 °C

MODEL	SHR9-1	SHR12-2	SHR15-2	SHR18-3
Classification	Refrigerator			
Cabinet Dimension (WxDxH mm)	900x 700 x 1028	1200x 700 x 1028	1500x 700 x 1028	1800x 700 x 1028
Capacity (ℓ)	293	432	556	702
Inner Temperature (°C)	-2~ 8			
Ambient Temperature (°C)	38			
Refrigerant	R-134a	R-134a	R-134a	R-134a
Insulation Type	Polyurethane / Cyclopentane + CFC Free			
Amps (A)	2.3	2.5	2.5	3
Voltage (V/Hz/Ph)	240 / 50 / 1			
Weight (Kg)	75	89	100	120
Power (W)	314	314	314	366
Number of Doors	1	2	2	3
Compressor (HP)	1/4	1/4	1/4	1/3
Number of Shelves	1	2	2	3
Power Plug	10A			

# PIZZA TABLE



Fan cooling



Digital



LED lamp

SPR-67SD

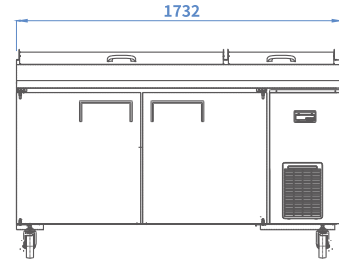

SPR-93SD

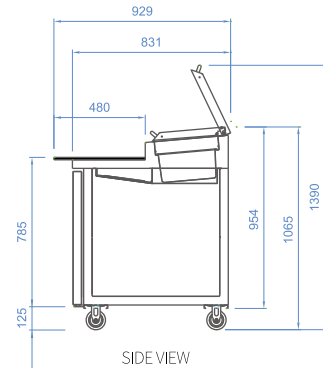
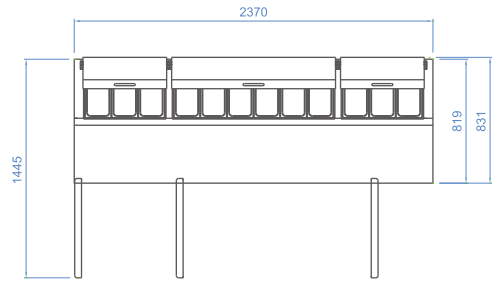

## G/N Pan

(Pans Included)

\*Withstand temperature up to 70 °C

MODEL	SPR-67SD	SPR-93SD
Classification	Refrigerator	
Cabinet Dimension (WxDxH mm)	1732x 929x 1065	2370x 929 x 1065
Capacity (ℓ)	450	872
Inner Temperature (°C)	1~ 8	
Ambient Temperature (°C)	38	
Refrigerant	R-134a	R-404a
Insulation Type	Polyurethane / Cyclopentane + CFC Free	
Amps (A)	2.7	3.8
Voltage (V/Hz/Ph)	240 / 50 / 1	
Weight (Kg)	105	262
Power (W)	370	660
Number of Doors	2	3
Number of Shelves	2	6
Number of Pans	9	12
Number of Hood	2	3
Compressor (HP)	1/3	1/2
Power Plug	10A	



---

# BACK BAR



SKIPIO



# BACK BAR



Fan cooling



Digital



LED lamp

SB9-2G



SB13-3G

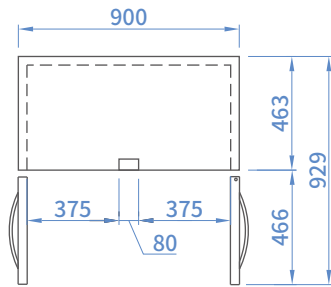

SB9-2G

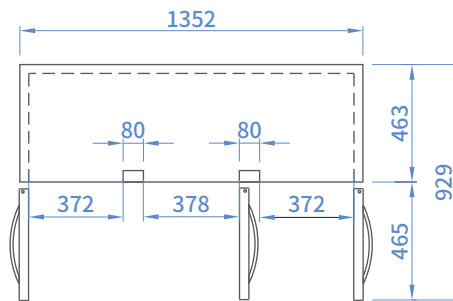

SB13-3G

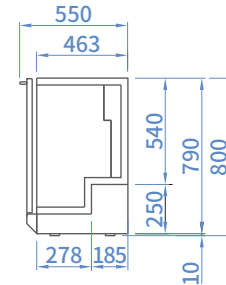

<800mm>

MODEL	SB9-2G	SB13-3G
Classification	Refrigerator	
Cabinet Dimension (WxDxH mm)	900 x 550 x 800	1352 x 550 x 800
Capacity (ℓ)	165	261
Inner Temperature (°C)	1~ 8	
Ambient Temperature (°C)	38	
Refrigerant	R-134a	
Insulation Type	Polyurethane / Cyclopentane + CFC Free	
Amps (A)	2.5	3.5
Voltage (V/Hz/Ph)	240 / 50 / 1	
Weight (Kg)	75	100
Door Type	Swing Door	
Number of Doors	2	3
Compressor (HP)	1/4	1/3
Power (W)	190	330
Number of Shelves	2	3
Power Plug	10A	10A

GLASS DOOR MERCHANDISER

REACH-IN

UNDER COUNTER

BAR EQUIPMENT

ICE MAKER

DISPLAY CASE

SPECIAL MODEL

BAKING LINE

# SIDE-MOUNT BACK BAR



Fan cooling



Digital



LED lamp

SBB-3G

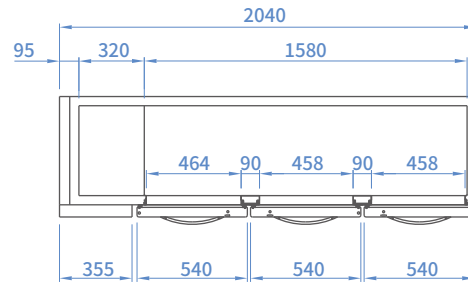

SBB-3G

SBB-4G

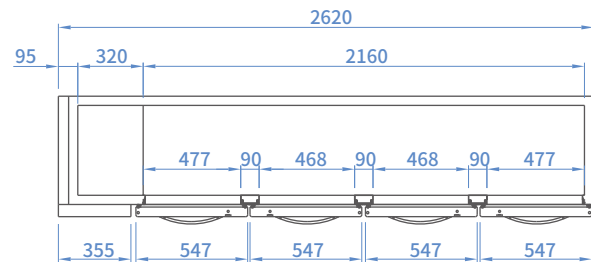

SBB-4G

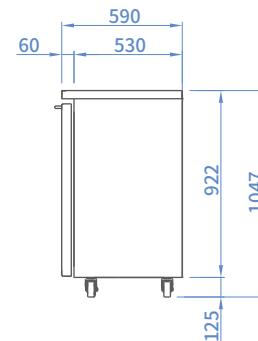

MODEL	SBB-3G	SBB-4G
Classification	Refrigerator	
Cabinet Dimension (WxDxH mm)	2040 x 590 x 1047	2620 x 590 x 1047
Capacity (ℓ)	605	815
Inner Temperature (°C)	1~ 8	
Ambient Temperature (°C)	38	
Refrigerant	R-134a	
Insulation Type	Polyurethane / Cyclopentane + CFC Free	
Power (W)	409	436
Voltage (V/Hz/Ph)	240 / 50 / 1	
Weight (Kg)	139	159
Door Type	Swing Door	
Number of Doors	3	4
Compressor (HP)	1/4	1/3
Number of Shelves	6	8
Power Plug	10A	



# DISPLAY LINE



[BAKERY CASE RECTANGLE]  
[GELATO SHOWCASE]





# RECTANGLE BAKERY CASE





# BAKERY CASE RECTANGLE

SB1500-2RD



\* Standard - Stainless Steel

2 Layer

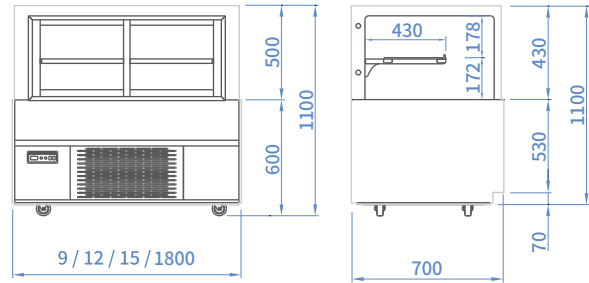

SB900-2RD

SB1200-2RD

SB1800-2RD



## \* BAKERY OPTION GUIDE

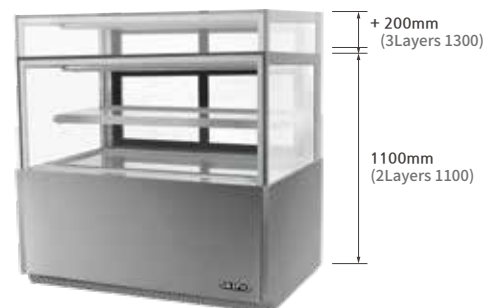
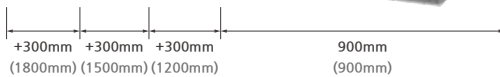



# BAKERY CASE RECTANGLE



Fan cooling



Digital



LED lamp

## SB1500-3RD



3 Layer

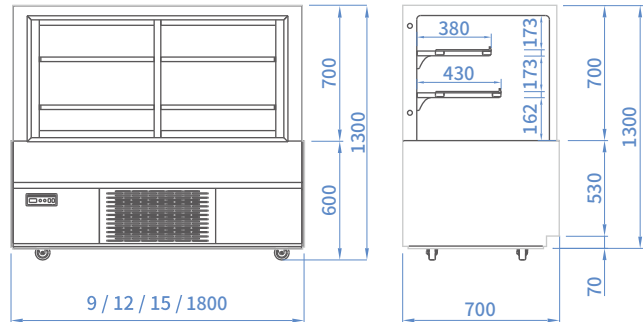

## SB900-3RD



## SB1200-3RD



## SB1800-3RD



MODEL	SB900-2RD SB900-3RD	SB1200-2RD SB1200-3RD	SB1500-2RD SB1500-3RD	SB1800-2RD SB1800-3RD
Classification	Refrigerator			
Cabinet Dimension (WxDxH mm)	900 / 1200 / 1500 / 1800 x 700 x 1100 (2Layer)/1300(3Layer)			
Capacity (ℓ)	501	669	837	1005
Inner Temperature (°C)	3 ~ 8			
Ambient Temperature (°C)	35			
Refrigerant	R-134a	R-134a	R-404a	R-404a
Insulation Type	Polyurethane / Cyclopentane + CFC Free			
Amps (A)	3.5	3.8	4	4
Voltage (V/Hz/Ph)	240 / 50 / 1			
Weight (Kg)	190	240	280	300
Door Type	Sliding Door			
Number of Doors	2	2	2	2
Compressor (HP)	1/3	1/3	1/2	1
Number of Shelves	1 (2Layer) / 2(3Layer) / 3(4Layer)			
Power Plug	10A	10A	10A	10A

GLASS DOOR MERCHANDISER

REACH-IN

UNDER COUNTER

BAR EQUIPMENT

ICE MAKER

DISPLAY CASE

SPECIAL MODEL

BAKING LINE



# GELATO SHOWCASE



ACRYLIC SLIDING DOOR



\* GELATO TUB (Standard : SGC-1200F MODEL) H : 150

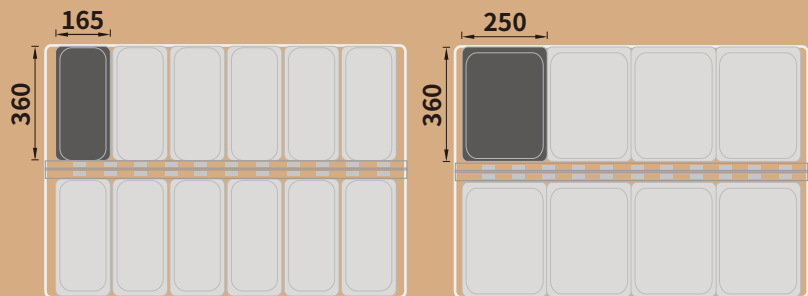

# GELATO SHOWCASE



Fan cooling



Digital



LED lamp

\* SGC-1200F



Tubs not included

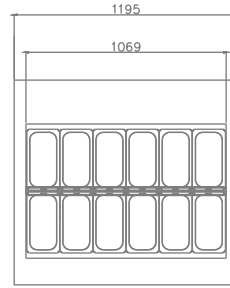

TOP

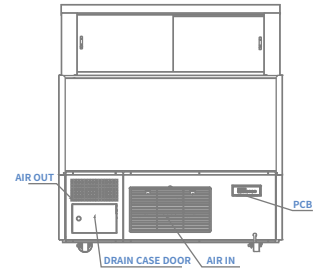

BACK

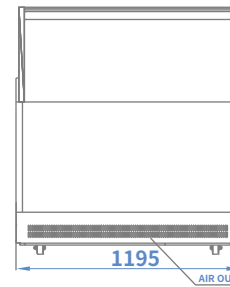

FRONT

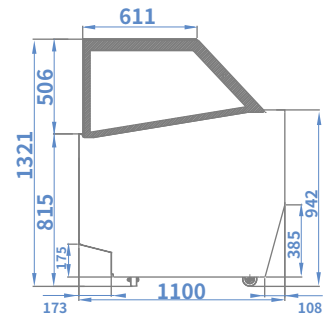

SIDE

\* SGC-1500F



\* SGC-1800F



MODEL	SGC-1200F	SGC-1500F	SGC-1800F
Classification	Freezer		
Cabinet Dimension (WxDxH mm)	1195 / 1547 / 1727 x 1034 x 1306		
Number of 1/3 Pans	12	16	18
Number of 1/2 Pans	8	10	12
Inner Temperature (°C)	-25 ~ -15		
Ambient Temperature(°C)	25(°C)		
Refrigerant	R-404a		
Insulation Type	Polyurethane / Cyclopentane + CFC Free		
Amps (A)	4.7	5.2	5.7
Voltage (V/Hz/Ph)	240 / 50 / 1		
Weight (Kg)	200	260	300
Door Type	Sliding Doors		
Power Plug	15A		
Power(W)	1034	1144	1254

GLASS DOOR MERCHANDISER

REACH-IN

UNDER COUNTER

BAR EQUIPMENT

ICE MAKER

DISPLAY CASE

SPECIAL MODEL

BAKING LINE



---

# SPECIAL MODEL

CHEF BASE

SKIPIO

# CHEF BASE

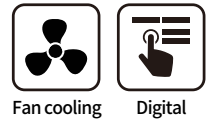

Fan cooling Digital

\* SCB14-4



G/N Pan  
(Pans Not Included)

\* SCB10-2

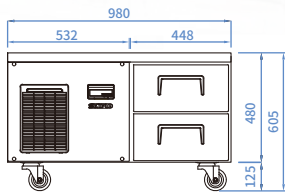

\* SCB18-6

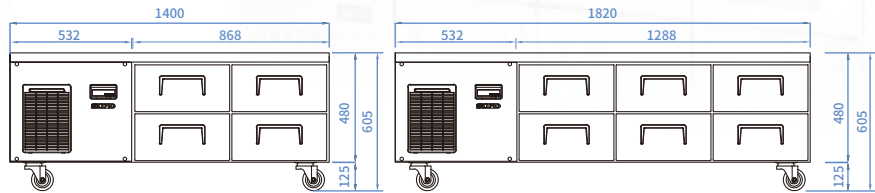

MODEL	SCB10-2	SCB14-4	SCB18-6
Classification	Refrigerator		
Cabinet Dimension (WxDxH mm)	980 / 1400 / 1820 x 700 x 605		
Capacity (ℓ)	85	176	267
Inner Temperature (°C)	-2~8		
Ambient Temperature (°C)	38		
Refrigerant	R-134a		
Insulation Type	Polyurethane / Cyclopentane + CFC Free		
Amps (A)	2.5	2.5	3.2
Voltage (V/Hz/Ph)	240 / 50 / 1		
Weight (Kg)	90	107	137
Power(W)	239	246	257
Number of Drawers	2	4	6
Compressor (HP)	1/4	1/3	3/4
Power Plug	10A		

# RECTANGLE BAKERY CASE



• **HIGH QUALITY GLASS**  
Use of quality tempered glass for safety and enhanced display effect



• **TEMPERATURE & HUMIDITY MONITOR**  
Easy to monitor temperature and humidity inside



• **LED LAMP**  
Enhance the display effect, and reduces unnecessary energy consumption



• **DRAIN WATER EVAPORATION SYSTEM**



• **LED LIGHT PANEL**



• **HIGH EFFICIENCY AIR VENTILATION**  
Efficient ventilation system for longevity of core parts



• **COLOR OPTION**  
sus / black



• **DIGITAL TEMPERATURE CONTROL SYSTEM**  
Enables precise control of temperature, power, and light

# GLASS DOOR MERCHANDISER



• **LED LIGHT BOX**



• **DIGITAL CONTROL SYSTEM**



• **LED LAMP**  
Display effect enhanced, Low energy consumption



• **DRAIN WATER EVAPORATION SYSTEM**



• **DOOR HANDLE**  
Easy Grip Door Handle



• **QUALITY IMPORTED COMPRESSOR**



• **SHELVES**

# REACH-IN (Dual Type)



- CONDENSER EASY CLEANING



- DIGITAL CONTROL SYSTEM

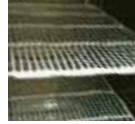

- SHELVES



- DRAIN WATER EVAPORATION SYSTEM



- DOOR HANDLE  
Easy grip recessed door handle



- LED LAMP  
Display effect enhanced,  
Low energy consumption



- SELF CLOSING AND STAY OPEN DOOR



- QUALITY IMPORTED COMPRESSOR

# UNDER COUNTER



- FRONT BREATHING WITH VENTILATION FAN



- DIGITAL CONTROL SYSTEM

- CONDENSER EASY CLEANING

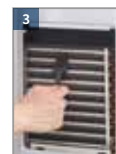
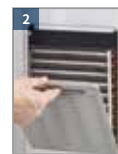
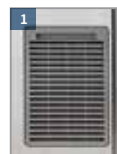

# GLOBAL REFERENCE

## HOTEL



## RESTAURANT • FAST FOOD





CAFE • BAKERY • ICE CREAM



EDUCATION • SPORTS CLUB



DEPARTMENT STORE • SUPERMARKET • MOVIE THEATER



# **SKIPIO Warranty**

by Experts, for Experts

**WARRANTY CLAIMS** – The user must report to its dealership so that the dealer can accumulate all pertinent information supporting the existence of the alleged defect.

## **TWO YEARS PARTS & LABOUR WARRANTY**

SKIPIO warrants to the original purchaser of every new SKIPIO refrigerated unit, the cabinet and all parts thereof, to be free from defects in material or workmanship, under normal use and service, for a period of two (2) year from the date of original installation.

Any parts covered by this warranty that are examined and determined by SKIPIO to have been defective within two (2) year of original installation shall be repaired or replaced as stated below. SKIPIO shall be deemed to have full complied with its obligation under the foregoing warranties by electing either one of the following procedures, at the sole discretion of SKIPIO:

- (a) Furnishing a replacement part, freight collect, in even exchange for the returned part, freight collect;
- (b) Receiving the defective part, freight collect; repairing it, freight collect.

## **Warranty Terms and Conditions**

- 1) The Warranty applies if and only if the Customer has used the Product in accordance with the directions given by SKIPIO and strictly for the purpose to which the Product is intended.
- 2) The warranty Period begins on the original date of purchased and used within Australia.
- 3) The warranty is valid only for Products originally purchased and used within Australia.
- 4) The Customer must provide to SKIPIO the details of the Invoice (including serial number and model code) when making a claim under the Warranty. Incorrect or incomplete details may delay the processing of the claim. SKIPIO reserves the right to charge the Customer for all reasonable expenses if the information provided by the Customer is incorrect of the Product was in fact not originally purchased by the Customer directly from SKIPIO.
- 5) SKIPIO or its authorized agent has the right to assess the Product to determine the cause of the defect. The Customer must make the product accessible for SKIPIO or its authorized agent to assess and, if applicable, to repair including removing all personal items in the way. If required, the Customer must at the Customer's own cost unless otherwise prescribed by law, return the Product to SKIPIO or its authorized agent. The Product must be returned with all original components including but not limited to manual, keys and bracket.

- 6) The Warranty does not apply:
  - a) If notice of the defect has not been given by the Customer within the Warranty Period; or
  - b) If the defect arises from or in the reasonable opinion of SKIPIO or its authorized agent, is likely to arise from one or more of the following:
    - c) Connection to improper, inadequate or faulty electricity;
    - d) Damage or failure as a consequence of not removing the packaging or transportation material before use;
    - e) Natural wear and tear including but not limited to filters, fuses, lamps, voltage/power surges, irregular electric power supply, natural events or disasters such as flooding and earthquake, riots and sabotage;
    - f) Improper use of cleaning agents, detergents, bleaches or another chemical additives or agents of corrosive nature;
    - g) Breakage, either intentionally or accidentally, to any part of the Product;
    - h) Any modification to, tampering with or repair or servicing of the Product except by SKIPIO or its authorized agent or using parts not approved or authorized by SKIPIO. ix) Improper, reckless, negligent or unsuited use of the Product including but not limited to:
      - (1) Use for an unspecified purpose;
      - (2) Use in an environment where the ambient temperature and relative humidity are outside the operating parameters specified for the Product;
      - (3) Movement of the Product when in operation (for clarity, the Products are designed for stationary operation only and must be connected directly to fixed wall supply);
      - (4) Improper adjustment made such as to the analogue thermostat or digital controller when the Product is in operation;
    - i) Corrosion or damage caused by foreign object externally or internally;
    - j) Engine mechanical or technical failure (but not limited to compressor failure) due to one or more of the following;
    - k) Inadequate and/or irregular maintenance (of the type specified or recommended by its manufacturer/SKIPIO) of components including but not limited to condensers and filters;
    - l) Inadequate and/or irregular cleaning of the condenser (fortnightly or more frequently if required);
    - m) Failure to provide adequate ventilation for the Product as specified or recommended by its manufacturer/SKIPIO;
    - n) Fail wear and tear.
  - 7) Any repair must be undertaken either by SKIPIO or an agent authorized by SKIPIO. Otherwise, SKIPIO is entitled to avoid the Warranty.
  - 8) The Warranty Period is not extended or renewed by any successful claim whereby the Product is replaced or Repaired
  - 9) SKIPIO makes no representation as to the time frame within which any repair can or will be carried out. In general, any repair will be restricted to normal business hours Monday to Friday (9am – 5pm) excluding public holidays and weekends. With the request, Skipio is liable to inform 'out of hours' surcharge' cost to customer prior to conduct repair service. The 'out of hours' surcharge' cost will apply to customer.
  - 10) Warranty back to base apply to any items that can be carried and place into standard vehicle (e.g.; SIM50A) is/are to be returned (or sent via pre-paid freight) to SKIPIO or its authorised service agent. The customer shall agree to arrange pick up the goods after it is being serviced.
  - 11) Where SKIPIO elects to replace rather than repair a Product but no identical replacement is available, SKIPIO has the right to replace the Product with one of a similar standard and design then available from its range. SKIPIO is not responsible for the re-packing and installation of any replacement.

- 12) Cabinets must be accessible and removable to designated area for service. Otherwise the cost of the damage and removal is on customer's expense.

### **What is NOT covered by SKIPIO's warranty?**

SKIPIO's sole obligation under this warranty is limited to either repair or replacement of parts, subject to the additional limitations below. This warranty neither assumes nor authorizes any person to assume obligations other than expressly covered by this warranty.

1. Warranty is NOT TRANSFERABLE. This warranty is not assignable and applies only in favour of the original purchaser/user to whom it was delivered to. ANY SUCH ASSIGNMENT OR TRANSFER SHALL VOID THE WARRANTIES HEREIN MADE AND SHALL VOID ALL WARRANTIES, EXPRESSED OR IMPLIED, INCLUDING ANY WARRANTY OF MERCHANTABILITY OR FITNESS FOR A PARTICULAR PURPOSE.
2. NO CONSEQUENTIAL DAMAGES: SKIPIO IS NOT RESPONSIBLE FOR ECONOMIC LOSS; PROFIT LOSS OR SPECIAL, INDIRECT, OR CONSEQUENTIAL DAMAGES, INCLUDING WITHOUT LIMITATION, LOSSES OR DAMAGES ARISING FROM FOOD OR PRODUCT SPOILAGE CLAIMS WHETHER OR NOT DUE TO REFRIGERATION FAILURE.
3. ALTERATION, NEGLIGENCE, ABUSE, MISUSE, ACCIDENT, DAMAGE DURING TRANSIT OR INSTALLATION, FIRE, FLOOD, ACTS OF GOD: SKIPIO is not responsible for the repair or replacement of any parts that SKIPIO determines have been subjected after the date of manufacture to alteration, neglect, abuse, misuse, accident, damage during transit or installation, fire, flood, or an Act of God.
4. TRANSPORTATION COSTS – SKIPIO will cover freight costs for parts covered under this warranty, provided that shipment has received prior approval. SKIPIO is not responsible for any other transportation costs but will ship parts either repaired or replaced under this warranty.
5. Services from an unauthorized person including owner – SKIPIO will not accept misuse of display controller which is not mentioned on user manual.
6. Consumable parts such as door gaskets, castors, legs, etc. are excluded from the warranty.

# MEMO

---

The image shows a memo template. At the top left, the word "MEMO" is written in a bold, black, sans-serif font. Below the title, there is a horizontal grey line. To the left of the main writing area, a vertical red line runs down the page, creating a margin. The rest of the page is filled with horizontal blue lines, spaced evenly, providing a grid for writing.