

ReFlex Underbench

SKOPE Salad and Pizza Prep
Hydrocarbon



ReFlex Underbench
SKOPE Salad and Pizza Prep
Hydrocarbon
Service Manual

MAN80292
Rev. 1.0 Oct. 2020

© 2020 SKOPE Industries Limited. All rights reserved.

SKOPE Industries Limited reserve the right to alter specifications without notice.

SKOPE® is a registered trademark of SKOPE Industries Limited.

SKOPE INDUSTRIES LIMITED

Head Office
PO Box 1091, Christchurch
New Zealand
Freephone: 0800 947 5673
Fax: (03) 983 3896
E-mail: enquiry@skope.co.nz
Website: www.skope.co.nz

Trademark Infringement

The SKOPE trademark on this product is infringed if the owner, for the time being, does any of the following:

- Applies the trade mark to the product after their state, condition, get-up or packaging has been altered in any manner
- Alters, removes (including part removal) or obliterates (including part obliteration) the trade mark on the product
- Applies any other trade mark to the product
- Adds to the product any written material that is likely to damage the reputation of the trade mark

Notice of the above contractual obligations passes to:

- Successors or assignees of the buyer
- Future owners of the product

CONTENTS

1	Servicing Hydrocarbon	
	Overview	5
	SKOPE HC Service Requirements	6
2	Specifications	
	Models	7
3	Electronic Controller	
	Overview	8
	Apps	8
	SCS Connect Field App	8
	SCS Connect Track App	8
	SKOPE Connect App	8
	Controller Faceplate	9
	Buttons and Display	9
	Service Mode	9
	SCS Connect Field App and Track App	11
	Connecting	11
	App Categories	12
	Faults and Alarms	14
	Notes	17
4	Wiring	
	ReFlex Salad and Pizza Prep	18
5	Spare Parts	
	Cabinet Assembly - Salad Prep	20
	Cabinet Assembly - Pizza Prep	22
	Cartridge Assembly - Salad and Pizza Prep	24
6	Installation	
	Installation Guidelines	26
	Ventilation Requirements	26
	Cleaning Before First Use	27
	Shelves	27
	Power Cord	27
7	Troubleshooting and Diagnostics	
	Electronic Controller	28
	General Operation	28
	Refrigeration System	30
8	Replacement Procedures	
	Lighting	32
	Hood and Lid Removal	34
	Doors	36
	Alignment Adjustment	36
	Door Gasket	36
	Removing and Refitting the Door	36
	Door Tension	36
	Door Hinges	37
	Door Locks	37
	Castors and Legs	38
	Cartridge End Panel	38
	Refrigeration Cartridge	39

Before Servicing	39
Gas Detector	40
Leak Detector	40
On-Site Work	40
Not Cooling Fault	40
Hydrocarbon Workshop	40
Removing the Cartridge	41
Refrigeration Cartridge Assembly	44
Defrost Cycle	44
Cartridge Electrics Panel	45
Condenser Fan	46
Evaporator Tub	47
Evaporator Fan	48
Compressor	49
Electronic Controller	50
Controller Location	50
QC Terminals	50
Replacing the Controller	51
Door Switch	52
Control Probe	52
Evaporator Probe	53
Condenser Probe	53
Ambient Probe	54
9 Routine Cleaning	
Cabinet	55
Condenser Coil	56
10 On-Site Work Procedure	
Swap Cartridge	57
Return Faulty Cartridge	58

1 Servicing Hydrocarbon

Overview

This appliance utilises hydrocarbon (HC) R290 Propane as its refrigerant. Hydrocarbon is a natural refrigerant that has a very low environmental impact.

Special service requirements are needed as hydrocarbon is a flammable refrigerant.

Safety hazards



The main hydrocarbon safety hazards are:

- Flammable refrigerant.
- Venting of hydrocarbon and compressor oil.
- Asphyxiation.

SKOPE does NOT recommend performing hazardous activities on the refrigeration system.

SKOPE HC Service Requirements

Servicing must only be performed by Approved SKOPE Service Technicians, and must meet all requirements in the SKOPE HC Service Policy (available from SKOPE), including the following:

Hydrocarbon work – SKOPE Service Policy

It is the responsibility of the service technician to follow SKOPE's Hydrocarbon equipment service policy and by accepting a service work order they agree to the following (where applicable):

- MUST – Ensure all workers are trained in the SAFETY of hydrocarbon products to the appropriate level for the work required.
- MUST – Follow all Local Safety Regulations relevant to flammable refrigerant gases.
 - Australia should reference - AIRAH Flammable Refrigerants – Safety Guide
 - New Zealand should reference – Flammable Refrigerant Safety Documentation (Refrigerant License NZ)
- MUST – Adhere to all on-site (workplace) Health and Safety requirements
- MUST – Not modify or alter the design of SKOPE equipment in any way
- MUST – In cases where the refrigeration system is not readily removable from the cabinet; then the entire cabinet MUST be sent to the Hydrocarbon workshop for repair.
- MUST – ONLY use SKOPE OEM Spare Parts; or identical replacement parts. Any variation in replacement part may render the system non-compliant and unsafe.
- MUST – Follow all best practice work activities for servicing hydrocarbon refrigerants (SKOPE recommend attending specific hydrocarbon refrigeration handling training courses). Nitrogen must be used for purging system before commencing “Hot Work” – brazing.
- MUST – Adhere to relevant SKOPE Service Manual. If any contradiction, the local Regulations take precedence over SKOPE requirements
- MUST – Work only in suitable, safe and compliant work spaces. Personal Protective Equipment must always be used when working on Hydrocarbon equipment.
- MUST – Service people diagnosing refrigeration faults must always carry and utilise Flammable Gas detectors when working on Hydrocarbon equipment.
- MUST – Prior to any service work; know where and how to safely and quickly isolate power supply to cabinet
- MUST – Not perform any Hot Work (brazing etc.) in the field. These are to be completed in a suitable service depot / workshop (in a dedicated specific Hazardous Work Area compliant to local flammable gas regulations)
- MUST – Not transport a refrigeration system with a known active leak. If there is an active leak the refrigerant must be safely removed (with use of Bullet Piercing Valve or Line Tap valves) before transporting. Valves must be removed at the hydrocarbon service depot once repair is completed.
- MUST – All hydrocarbon workshop areas must have emergency plans; that includes suitable evacuation and fire control plans and equipment.
- MUST – Only use refrigerant grade hydrocarbon, to precise mass specified on removable refrigeration system serial label.
- MUST – Be accurate refrigerant charge; The refrigerant mass is ultra-low charge and must only be measured in by accurate scales to +/- 1.0gram. Refrigerant MUST not be overcharged; or added to an already charged system.
- MUST – Use identical drier replacement; as any change will affect gas charge volume; and effect reliability compliance and safety.
- MUST – Any pipework replacement, must be identical to genuine SKOPE parts.
- MUST – Not introduce a sparking device inside a cabinet or inside a removable refrigeration system. Battery drills should not be used.
- MUST – Not perform any activity that could stress a refrigeration pipe (unless in a workshop).
- MUST – Get customer authorisation to permanently swap a removable refrigeration system.
- MUST – Have the Wellington Drive SCS Field app installed on a Bluetooth enabled device carried by the service technician (exception is for cabinets that do not utilise the Wellington Drive Controller). The app should be utilised for safe, accurate diagnosis of the system and it is required to complete a controller replacement in the field.
- RECOMMENDED – Have the Wellington Drive SCS Track app installed on a Bluetooth enabled device carried by the service technician. This passive app collects system data from the Wellington Drive SCS Connect Controller and transmit it to the cloud.
- Logistics companies may be used to transport a complete refrigerator where no separation of the refrigeration system occurs. Logistics companies are not required to be contracted to this SKOPE Service Policy.

2 Specifications

Models

This service manual is applicable to the SKOPE ReFlex salad and pizza prep models detailed in the table below. Refer to the relevant product specification sheet (available on the SKOPE website: www.skope.com) for specifications.

Model	SKOPE ID	Product Description
RF7.PPS.2.SD	RB2S	2-Door Salad Prep
RF7.PPS.3.SD	RB3S	3-Door Salad Prep
RF8.PPZ.3.SD	RB3Z	3-Door Pizza Prep
RF8.PPZ.4.SD	RB4Z	4-Door Pizza Prep

3 Electronic Controller

Overview

The cabinet is fitted with a Wellington Drive SCS Connect electronic controller. The controller is located in the cartridge compartment and is visible from the outside of the cabinet through the cartridge cover.

Apps

SCS Connect Field App The Wellington Drive Field app for mobile devices allows technicians to connect and interact with SKOPE equipment that utilise the Wellington Drive SCS Connect electronic controller. The app allows technicians to:

- View the current state of cabinet components (temperatures, compressor and fan motor states).
- View a 7-day history of those states.
- Manually change component states.
- Update and change controller parameters.
- Update controller firmware.

All technicians who service SKOPE equipment fitted with the Wellington Drive SCS Connect electronic controller are required to have the Wellington Drive Field app installed on their Bluetooth enabled mobile device. SKOPE also recommend that all technicians have the Wellington Drive Track app installed.

See “SCS Connect Field App and Track App” on page 11 for information on setting up and using the app.

SCS Connect Track App The Wellington Drive Track app for mobile devices transfers data from SKOPE equipment that utilise the SCS Connect controller to a cloud based server.

The app works automatically in the background. When the app detects a controller, it connects via Bluetooth to receive data from the controller and send data to the cloud. If no mobile data connection is available, the app stores data until a connection becomes available.

SKOPE recommend that all technicians who service SKOPE equipment fitted with the Wellington Drive SCS Connect electronic controller have the Wellington Drive Track app installed on their Bluetooth enabled mobile device.

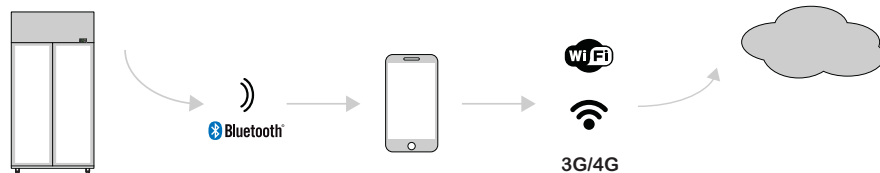

SKOPE Connect App The SKOPE-connect app is designed for end-users only, and provides wireless access to the controller from mobile devices with Bluetooth capability.

The app allows end users to adjust some electronic controller settings including energy saving modes, open/close hours and preset temperature set points for specific product.

Controller Faceplate

Buttons and Display The controller faceplate includes the front display panel and interface buttons.

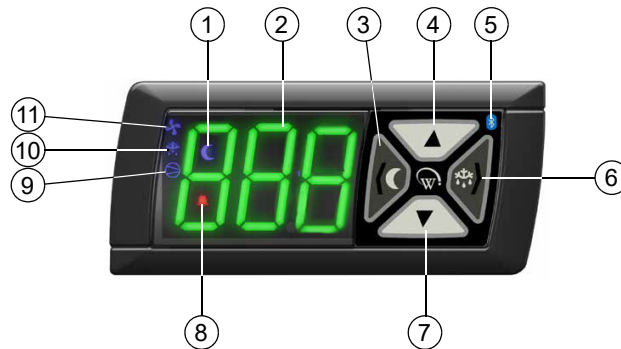

No.	Description
1	Night Mode: Indicator. On during night mode.
2	Display: Indicator. Digital display of cabinet air temperature or messages. The temperature is what the sensor inside the cabinet detects, and not necessarily the product temperature. However, they may be very close depending on how the controller is set to sense temperature.
3	Light Switch - Night Mode (back/abort): Button. Press to switch the lights on or off. Press and hold to switch cabinet between day and night mode. Used during programming.
4	Up: Button. Used for programming.
5	Bluetooth: Indicator. On when ready to connect to a device. Flashing when connected to a device.
6	Defrost Cycle (next/enter): Button. Press and hold to initiate manual defrost. Used during programming.
7	Down: Button. Used for programming.
8	Fault - Alarm: Indicator. On during fault or alarm. Note: Alarm message is also shown on the display during alarm.
9	Compressor: Indicator. On when the compressor is running.
10	Defrost Mode: Indicator. On during defrost cycle.
11	Fan: Indicator. ON when evaporator fan running.

Service Mode Service mode can be accessed and used via the SCS Connect Field app (see “SCS Connect Field App and Track App” on page 11), or the controller faceplate (refer to Wellington Drive Technologies documentation for further information.).

Note: A 9 digit pin code is required to access service mode via the controller buttons. Contact SKOPE to receive your service mode pin code.

There are 5 main service mode categories when accessing and using service mode via the controller faceplate:

Parameters

Provides access and editing of individual controller parameters.

It is not recommended that parameters are changed unless absolutely necessary. If incorrect parameter settings are suspected, reload the complete parameter set.

Reset

Returns the controller back to factory settings. Parameter set must be reloaded after performing a reset.

Manual test

Allows inspection of input values from sensors, and check the effects of output adjustments to peripherals, and to run preset test routines.

Statistics

Displays logged values and event counts to assist with fine tuning and diagnostics.

About

Lists the properties of the refrigeration system and the controller, including cabinet model codes, firmware, hardware and software versions.

SCS Connect Field App and Track App

Connecting Follow the procedures below to install and set-up the app, and connect to a controller.

Note: The SCS Connect Field app and Track app are separate from the SKOPE-connect app.

To install the SCS Connect Field app

1. Download the SCS Connect Field app from Google Play Store or Apple App Store.

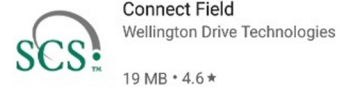

2. Enter your unique Activation Code and press 'Activate'. The activation code is provided by SKOPE Customer Services.
3. Enter a 4-digit PIN code, re-enter the code, and press 'SET PIN CODE'.

To connect to a cabinet

1. Ensure Bluetooth is enabled and you have internet access on your mobile device.

2. The app shows a list of nearby SKOPE cabinets. The signal bars indicate how close each cabinet is.



3. Select the cabinet of interest and press 'CONNECT'.
4. When successfully connected, a blue light flashes on the controller faceplate and the home screen is displayed in the app.

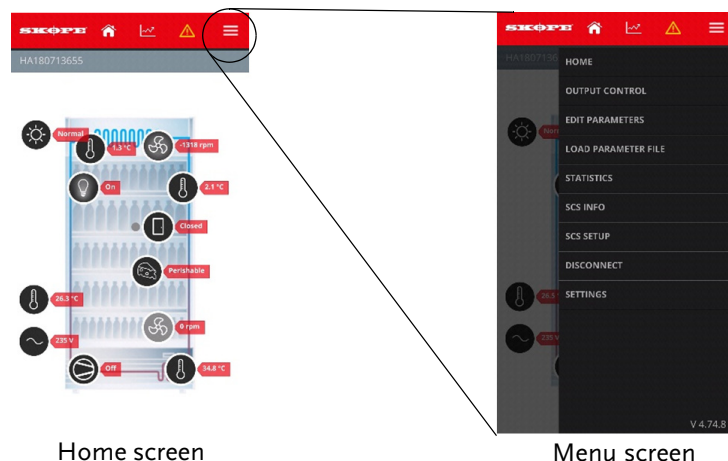

Home screen

Menu screen

Note: Available menu options will differ depending on user access levels

To install and use the SCS Connect Track app

1. Download the SCS Connect Track app from Google Play Store or Apple App Store.

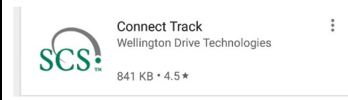

2. Enter your unique Activation Code and press 'Activate' (the same code as used for SCS Connect Field app). The activation code is provided by SKOPE Customer Services.

3. Respond to any dialogue boxes that appear and the app should be ready to use. Ensure Bluetooth is turned on.

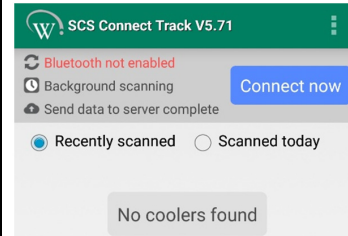

4. The app is passive and runs in the background (it can track automatically). When servicing a cabinet, the app should be opened to ensure tracking has finished prior to servicing.

App Categories

Various options are available in the app menu to provide information about the connected controller and its cabinet. Depending on user access level, some menu options may not be available.

Home screen

The home screen shows a graphical representation of the current state of the cabinet being controlled.

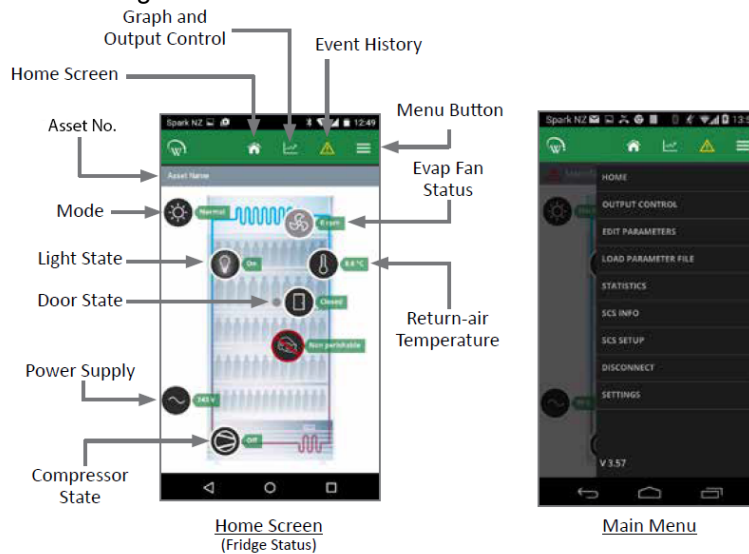

Output control

Provides control of the controller input sensors and switches, and output relays.

Edit parameters

Provides access and editing of individual controller parameters.

Note: Parameter changes must be recorded on warranty/job card.

It is not recommended that parameters are changed unless absolutely necessary. If incorrect parameter settings are suspected, reload the complete parameter set. **Note:** Updated parameters are not applied until DISCONNECT has been selected from the menu (after loading new parameter set).

Load parameter file

Allows reloading of model default parameter set or changing to new parameter set. See “Replacing the Controller” on page 51 for instructions.

Note: Updated parameters are not applied until DISCONNECT has been selected from the menu (after loading new parameter set).

Statistics

Information from the past seven days on cabinet activity including temperatures, door openings and alarms.

SCS info

Controller version and cabinet asset information.

SCS setup

Add or change SCS info (see above).

Disconnect

Disconnect from currently connected controller.

Settings

Change app general settings.

Parameter Numbers	Model No.	RF7.PPS.2.SD	RF7.PPS.3.SD	RF8.PPZ.3.SD	RF8.PPZ.4.SD
	620		✓	✓	
621				✓	✓

Faults and Alarms

The following table explains faults and alarms that the electronic controller may log and display.

If a fault occurs, the fault - alarm indicator is lit on the controller faceplate, but no message is displayed. Faults do not affect product temperature, and require no action from the shop owner.

Alarms are logged and the alarm message is displayed on the controller faceplate. Alarms may result in abnormal product temperature.

Some faults and alarms can be cleared by the shop owner, and others can only be cleared by a service technician.

If the cabinet is connected to the power supply and has warm product, check the SCS Connect Field App for active fault or alarm, and investigate. If the cabinet does not have an active fault or alarm, check the app statistics to determine if and when the controller signalled a fault or alarm.

Refer to the tables below for faults and alarm descriptions and possible causes and actions. The service tech type column refers to the service tech skill level required to complete a task. Refer to the SKOPE HC Service Policy (available from SKOPE) for service tech type details.

Faults (alarm indicator lit - no message displayed)

Description	Service tech type	Possible root cause
Door left open. The door has been open for several minutes. Excessive door open counts	1, 2, 3, 4	- door not self closing (torsion fault) - door switch / circuit - controller
Over-voltage protection The maximum allowable mains supply voltage has been exceeded. The cabinet has temporarily shut down to prevent damage and will restart once the supply voltage decreases.	1, 2, 3, 4	- should be a one off; if continues: - line voltage / rural - voltage setting parameter - controller
Under-voltage protection The mains supply voltage has dropped below the minimum allowable level. The cabinet has temporarily shut down to prevent damage and will restart once the supply voltage increases.	1, 2, 3, 4	- should be a one off; if continues: - power supply overloaded / multibox - line voltage / rural. - voltage setting parameter - controller
High condensing temperature protection The system was operating at an elevated temperature and has temporarily shut down to prevent damage. Extended operation in this condition may result in ALARM 15, increased energy consumption and a reduction in cabinet life. This alarm may be caused by very high ambient temperature.	2, 3, 4	NO swap cartridge required - cabinet installed in location outside rated conditions - condenser not clean - poor installation / ventilation - condenser fan motor / blade - controller
Excessive compressor cycling protection The system has been turning on and off too frequently.	2, 3, 4	Take spare cartridge in case refrigeration system fault. - condenser blocked - poor installation / ventilation - cabinet / cartridge gasket seals leaking - door not self closing / gasket leaking - product hot / blocking cabinet airflow - overloaded from excess door openings / ambient - fan motor / blade (condenser / evaporator) - controller - compressor / gas leak = SWAP cartridge

Alarms

Code	Description	Service tech type	Possible root cause
dor	Door left open. The door has been open for several minutes. Will revert to door left open FAULT after 10 minutes (see faults table on previous page).	1, 2, 3, 4	- door not self closing (torsion fault) - door switch / circuit - controller
8	Estimated product temperature below allowable range The estimated product temperature has been below the allowable range for longer than the permissible time. Potential causes are: an empty or partially filled cabinet, or low ambient temperature.	1, 2, 3, 4	- low ambient - App settings - controller
9	Estimated product temperature above allowable range The estimated product temperature has been above the allowable range for longer than the permissible time. Potential causes are: excessive door openings, door being left open, or warm product loaded into cabinet.	2, 3, 4	Swap cartridge may be required to be taken (may be required as fault could still be with sealed refrigeration system) - condenser blocked - poor installation / ventilation - frozen blocked evap coil - cartridge gasket leaking (to cabinet seal / lid seal) - door leaking air (bad gasket / door not self closing) - product hot / blocking cabinet airflow - overloaded from excess door openings / ambient - fan motor / blade (condenser / evaporator) - App settings - controller - compressor / gas leak = arrange SWAP cartridge
15	Excessive condensing temperature protection The system was operating at an excessive temperature and has shut down to prevent permanent damage. This alarm may occur due to very high ambient temperature.	2, 3, 4	NO swap cartridge required - cabinet installed in location outside rated conditions - condenser not clean - poor installation / ventilation - condenser fan motor / blade - controller
17	Control probe failure A critical system sensor has failed and the cabinet can no longer operate.	2, 3, 4	NO swap cartridge required - control Probe / circuit - controller
18	Electrical over-current protection activated The compressor was drawing too much current and has shut down to prevent permanent damage.	2, 3, 4	Take spare cartridge in case refrigeration system fault. - condenser blocked - poor installation / ventilation - cabinet / cartridge gasket seals leaking - door not self closing / gasket leaking - product hot / blocking cabinet airflow - overloaded from excess door openings / ambient - fan motor / blade (condenser / evaporator) - controller - compressor / gas leak = SWAP cartridge
19	Failed to reach set temperature The refrigeration system has been operating continuously for a long period without reaching the set temperature.	2, 3, 4	Take spare cartridge in case refrigeration system fault. - condenser blocked - poor installation / ventilation - frozen blocked evap coil - cabinet seal leaking / door / cartridge - product hot / blocking cabinet airflow - overloaded from excess door openings / ambient - fan motor / blade (condenser / evaporator) - controller - compressor / gas leak = SWAP cartridge
20	Over cooling product The internal temperature is too low. The system has temporarily shut down until the temperature has returned to normal. This can occur if the set temperature has been raised by a large amount.	1, 2, 3, 4	- confirm if really too cold; change parameters accordingly

Continued over page

Code	Description	Service tech type	Possible root cause
22	Evaporator fan over-current protection The current supplied to the evaporator fan motor is too high.	2, 3, 4	NO swap cartridge required - faulty fan motor - fan blade fault (imbalance / debris / blockage) - controller
23	Condenser fan over-current protection The current supplied to the condenser fan motor is too high.	2, 3, 4	NO swap cartridge required - faulty fan motor - fan blade fault (imbalance / debris / blockage) - controller
24	Controller communication error Controller has lost communication channels.	1, 2, 3, 4	- App - controller / circuit
25	Controller update failed Controller update could not be completed.	1, 2, 3, 4	- App - controller / circuit
26	Controller hardware failure Controller hardware has failed.	1, 2, 3, 4	- App - controller / circuit
27	Probe failure A non-critical system probe has failed. The cabinet will continue to operate with partial function but requires service.	2, 3, 4	NO swap cartridge required - Evap probe / connections - controller
28	No downward tendency The temperature is no longer decreasing.	2, 3, 4	Take spare cartridge in case refrigeration system fault. - condenser blocked - poor installation / ventilation - cabinet / cartridge gasket seals leaking - door not self closing / gasket leaking - product hot / blocking cabinet airflow - overloaded from excess door openings / ambient - fan motor / blade (condenser / evaporator) - controller - compressor / gas leak = SWAP cartridge
29	Compressor cutting out The compressor cut out on its internal protection or pressure switch.	2, 3, 4	Take spare cartridge in case refrigeration system fault. - condenser blocked - poor installation / ventilation - cabinet seal leaking / door / cartridge - product hot / blocking cabinet airflow - overloaded from excess door openings / ambient - fan motor / blade (condenser / evaporator) - controller - compressor / gas leak = SWAP cartridge
30	Excessive automatic defrosting The system is automatically defrosting too frequently.	2, 3, 4	Take spare cartridge in case refrigeration system fault. - door not self closing / gasket leaking - Evaporator probe - Evaporator motor / fan - controller - compressor / gas leak = SWAP cartridge
31	Compressor stalling The compressor is stalling on start up.	2, 3, 4	Take spare cartridge in case refrigeration system fault. - condenser blocked - poor installation / ventilation - cabinet / cartridge gasket seals leaking - door not self closing / gasket leaking - product hot / blocking cabinet airflow - overloaded from excess door openings / ambient - fan motor / blade (condenser / evaporator) - controller - compressor / gas leak = SWAP cartridge

4 Wiring

ReFlex Salad and Pizza Prep

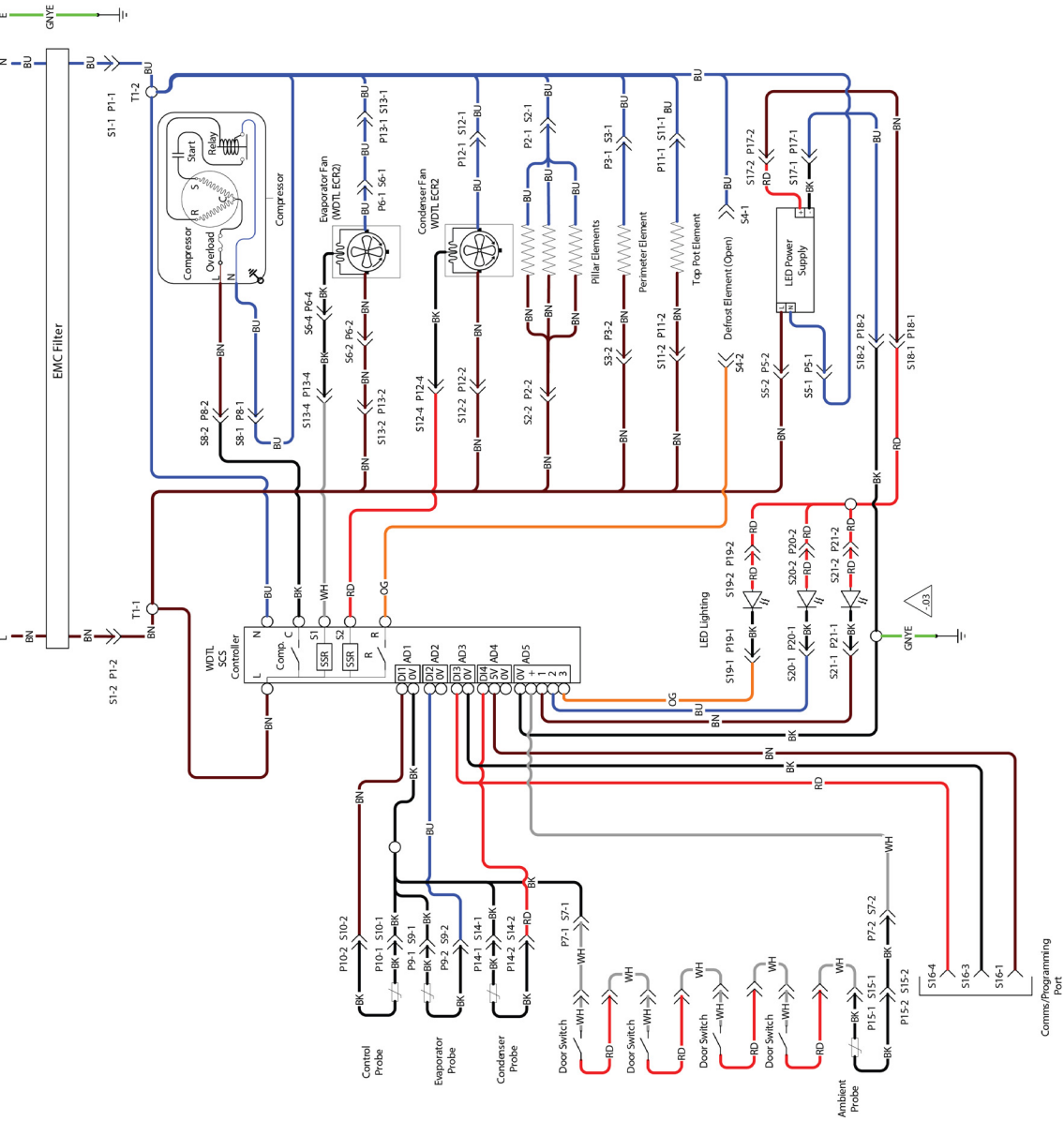

WIRE COLOURS

BK	Black
BN	Brown
RD	Red
OG	Orange
GN	Green
BU	Blue
GY	Grey
WH	White
GNYE	Green-Yellow

Based upon IEC 757 Standard

LEGEND

S1/P1	Power Connection Socket/Plug	Black 4-way
S2/P2	Pillar Element Wire Socket/Plug	Black 3-way
S3/P3	Perimeter Element Wire Socket	Black 3-way
S4/P4	Defrost Element Socket	Open, Yellow 4-way
S5/P5	LED Driver AC Input Socket/Plug	White 3-way
S6/P6	Evaporator Extension Flex Socket/Plug	White 4-way
S7/P7	Door Sensor Socket/Plug	White 2-way
S8/P8	Compressor Unit Socket/Plug (Blue 4-way)	Blue 4-way
S9/P9	Evaporator Extension Flex Socket/Plug	Black 2-way
S10/P10	Cabinet Sensor Socket/Plug	Blue 2-way
S11/P11	Top Pot Element Wire Socket/Plug	Black 3-way
S12/P12	Condenser Motor Unit Socket/Plug	Red 4-way
S13/P13	Evaporator Motor Unit Socket/Plug	White 4-way
S14/P14	Condenser Sensor Socket/Plug	Orange 2-way
S15/P15	Ambient Sensor Socket/Plug	White 2-way
S16/P16	Programming/Comms Port Socket	Blue 4-way
S17/P17	LED Driver DC Out Put Socket/Plug	Red 2-way
S18/P18	LED Driver Extension DC Out Put Flex Socket/Plug	Yellow 2-way
S19/P19	LED Lighting Channel A Socket/Plug	Red 2-way
S20/P20	LED Lighting Channel B Socket/Plug	Red 2-way
S21/P21	LED Lighting Channel C Socket/Plug	Red 2-way
T1	Unit Terminals	-

5 Spare Parts

Cabinet Assembly - Salad Prep

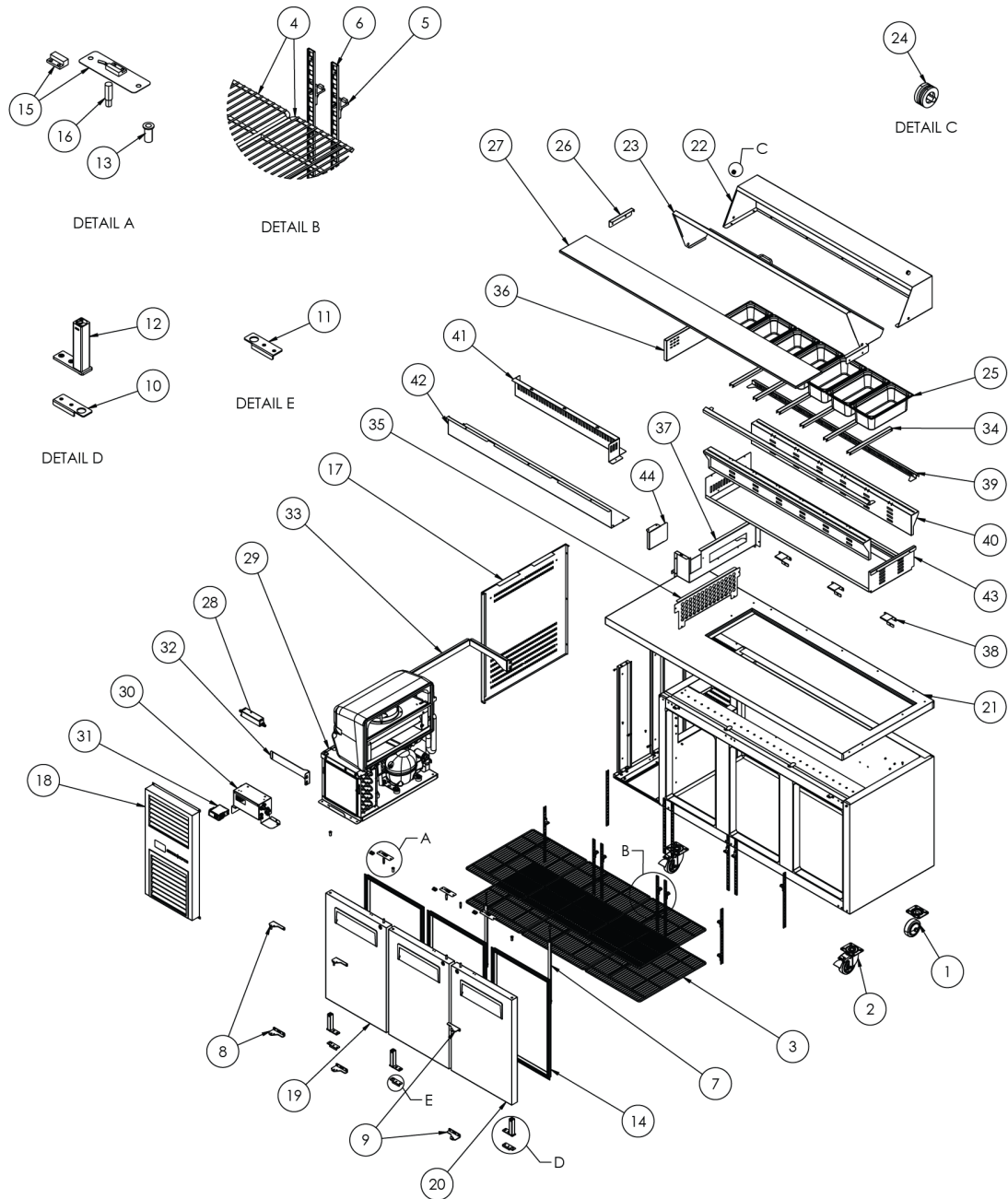

SKOPE ReFlex Salad and Pizza Prep

No.	Description	Part No.	RF7.PPS.2.SD	RF7.PPS.3.SD
1	CASTOR-UNBRAKED	SKC-2-190-0048-0	✓	✓
2	CASTOR-BRAKED	SKC-2-190-0047-0	✓	✓
3	SHELF SET-2DR SALAD	SKC-0-050-0061-0	✓	
	SHELF SET-3DR SALAD	SKC-0-050-0062-0		✓
4	SHELF-2DR SALAD 390X510	SKC-2-190-0061-0	✓	
	SHELF-3DR SALAD MID 475X510	SKC-2-190-0046-0		✓
	SHELF-3DR SALAD SIDE 415X510	SKC-2-190-0045-0		✓
5	SHELF-CLIP	SKC-2-110-0625-0	16	24
6	SHELF SUPPORT STRIP	SKC-2-190-0044-0	8	12
7	LIGHT-LED	SKC-4-050-0155-0	1	2
8	HINGE SET-LH	SKC-0-050-0063-0	1	2
9	HINGE SET-RH	SKC-0-050-0064-0	1	1
10	DOOR STOPPER-RH	SKC-2-190-0043-0	1	1
11	DOOR STOPPER-LH	SKC-2-190-0040-0	1	1
12	HINGE-SELF CLOSING	SKC-2-170-0410-0	2	3
13	BUSH-DOOR-TOP	SKC-2-110-0512-0	2	3
14	GASKET-DOOR-SMALL	SKC-2-190-0060-0	2	
	GASKET-DOOR-LARGE	SKC-2-190-0037-0		3
15	KIT-DOOR SENSOR	SKC-4-050-0130-0	2	3
16	KIT-LOCK PIN AND KEY	SKC-2-006-0996-0	2	3
17	CABINET PANEL-LH	SKC-2-180-0124-0	✓	✓
18	CABINET PANEL-LOUVRE	SKC-0-180-0011-0	✓	✓
19	DOOR-SOLID-LH-SMALL	SKC-0-180-0020-0	1	
	DOOR-SOLID-LH-LARGE	SKC-0-180-0010-0		2
20	DOOR-SOLID-RH-SMALL	SKC-0-180-0019-0	1	
	DOOR-SOLID-RH-LARGE	SKC-0-180-0009-0		1
21	BENCH TOP-2DR SALAD	SKC-0-180-0016-0	✓	
	BENCH TOP-3DR SALAD	SKC-0-180-0006-0		✓
22	HOOD-2DR SALAD	SKC-0-180-0018-0	✓	
	HOOD-3DR SALAD	SKC-0-180-0008-0		✓
23	LID-2DR SALAD	SKC-0-180-0041-0	✓	
	LID-3DR SALAD	SKC-0-180-0042-0		✓
24	HINGE SET-LID-SALAD	SKC-0-050-0071-0	2	2
25	GN1/3 PANS (100mm DEEP, STAINLESS STEEL 304)	SXX12239	4	7
26	RETAINER KIT-CUTTING BOARD SET (LH + RH)	SKC-0-050-0065-0	✓	✓
27	CUTTING BOARD-2DR SALAD 200x1267	SKC-2-190-0056-0	1	
	CUTTING BOARD-3DR SALAD 200x1797	SKC-2-190-0032-0		1
28	MEAN WELL LPF-16-24	ELZ12161	✓	✓
29	REFRIGERATION CARTRIDGE PACKED	ULQCNI-0029-P	✓	✓
30	CONTROLLER ELECTRICAL ASSEMBLY	UA0300026-SP	✓	✓
31	WDTL SCS FIRMWARE-REFLEX	ELZ11749-1627	✓	✓
32	EVAP TUB MOUNT BRACKET-FRONT	US08N00005	✓	✓
33	EVAP TUB MOUNT BRACKET-REAR	US08N00004	✓	✓
34	PAN HOLDER	SSY12193		
35	RETURN AIR GRILL PANEL	SSY12194	3	6
36	SIDE WELL:LEFT	SSY12195	1	1
37	TRANSITION DUCT	SSY12196	1	1
38	WELL HOLDER BRACKET	SSY12197	2	3
39	AIR CURTAIN VENTING - SMALL	SSY12198	2	
	AIR CURTAIN VENTING - MEDIUM	SSY12199		2
40	WELL SIDE VENT - SMALL	SSY12200	2	
	WELL SIDE VENT - MEDIUM	SSY12201		2
41	DISTRIBUTOR BRACKET - SMALL	SSY12202	1	
	DISTRIBUTOR BRACKET - MEDIUM	SSY12203		1
42	DUCT - SMALL	SSY12204	1	
	DUCT - MEDIUM	SSY12205		1
43	WELL BOTTOM - SMALL REFLEX PREP	SSY12206	1	
	WELL BOTTOM - MEDIUM	SSY12207		1
44	DUCT RIGHT COVER	SSY12208	1	1

Cabinet Assembly - Pizza Prep

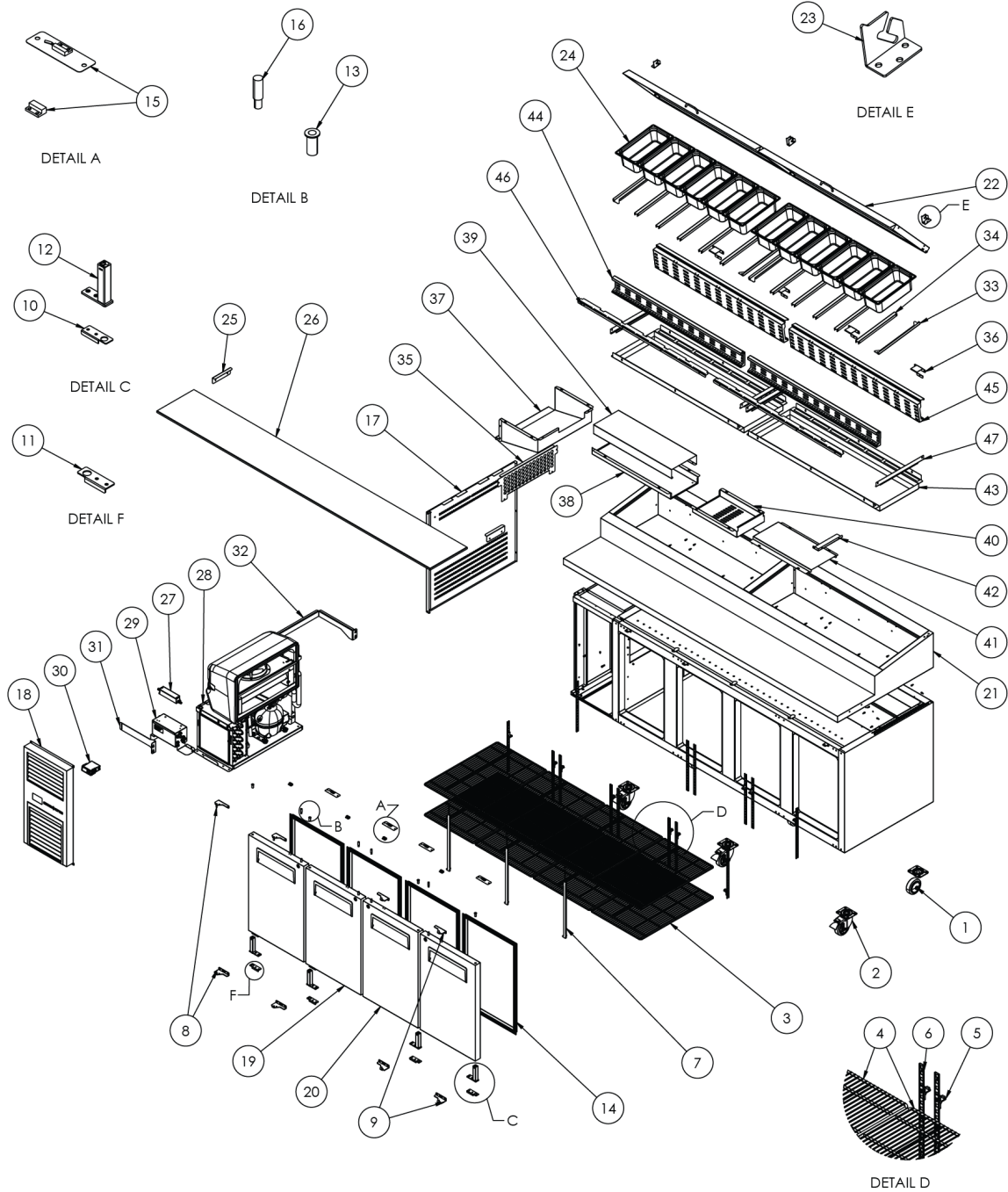

No.	Description	Part No.	RF8.PPZ.3.SD	RF8.PPZ.4.SD
1	CASTOR-UNBRAKED	SKC-2-190-0048-0	✓	✓
2	CASTOR-BRAKED	SKC-2-190-0047-0	✓	✓
3	SHELF SET-3DR PIZZA	SKC-0-050-0066-0	✓	
	SHELF SET-4DR PIZZA	SKC-0-050-0067-0		✓
4	SHELF-3DR PIZZA MID 475X610	SKC-2-190-0073-0	✓	✓
	SHELF-3DR PIZZA SIDE 415X610	SKC-2-190-0072-0	✓	✓
5	SHELF-CLIP	SKC-2-110-0625-0	24	32
6	SHELF SUPPORT STRIP	SKC-2-190-0044-0	12	16
7	LIGHT-LED	SKC-4-050-0155-0	2	3
8	HINGE SET-LH	SKC-0-050-0063-0	2	2
9	HINGE SET-RH	SKC-0-050-0064-0	1	2
10	DOOR STOPPER-RH	SKC-2-190-0043-0	1	2
11	DOOR STOPPER-LH	SKC-2-190-0040-0	2	2
12	HINGE-SELF CLOSING	SKC-2-170-0410-0	3	4
13	BUSH-DOOR-TOP	SKC-2-110-0512-0	3	4
14	GASKET-DOOR-LARGE	SKC-2-190-0037-0	3	4
15	KIT-DOOR SENSOR	SKC-4-050-0130-0	3	4
16	KIT-LOCK PIN AND KEY	SKC-2-006-0996-0	3	4
17	CABINET PANEL-LH	SKC-2-180-0187-0	✓	✓
18	CABINET PANEL-LOUVRE	SKC-0-180-0011-0	✓	✓
19	DOOR-SOLID-LH-LARGE	SKC-0-180-0010-0	2	2
20	DOOR-SOLID-RH-LARGE	SKC-0-180-0009-0	1	2
21	BENCH TOP-3DR PIZZA	SKC-0-180-0026-0	✓	
	BENCH TOP-4DR PIZZA	SKC-0-180-0037-0		✓
22	LID-PIZZA LARGE	SKC-0-180-0029-0	1	2
	LID-PIZZA SMALL	SKC-0-180-0030-0	1	
23	HINGE SET-LID-3DR PIZZA	SKC-0-050-0069-0	✓	
	HINGE SET-LID-4DR PIZZA	SKC-0-050-0068-0		✓
24	GN1/3 PANS (100mm DEEP, STAINLESS STEEL 304)	SXX12239	9	12
25	RETAINER KIT-CUTTING BOARD SET (2pcs)	SKC-0-050-0070-0	✓	✓
26	CUTTING BOARD-3DR PIZZA 310x1797	SKC-2-190-0068-0	1	
	CUTTING BOARD-3DR PIZZA 400x1797	SKC-2-190-0088-0	1	
	CUTTING BOARD-4DR PIZZA 310x2279	SKC-2-190-0081-0		1
	CUTTING BOARD-4DR PIZZA 400x2279	SKC-2-190-0087-0		1
27	MEAN WELL LPF-16-24	ELZ12161	✓	✓
28	REFRIGERATION CARTRIDGE PACKED	ULQCNI-0030-P	✓	✓
29	CONTROLLER ELECTRICAL ASSEMBLY	UA0300026-SP	✓	✓
30	WDTL SCS FIRMWARE - REFLEX	ELZ11749-1627	✓	✓
31	EVAP TUB MOUNT BRACKET_FRONT	US08N00005	✓	✓
32	EVAP TUB MOUNT BRACKET_REAR	US08N00004	✓	✓
33	WELL SIDE BKT TOP - PIZZA	SSY12225	4	4
34	PAN HOLDER	SSY12193	7	10
35	RETURN AIR GRILL PANEL	SSY12194	1	1
36	WELL HOLDER BRACKET	SSY12197	4	4
37	TRANSITION DUCT - PIZZA PREP	SSY12210	1	1
38	CENTRE DUCT BOTTOM FLOOR PIZZA	SSY12211	1	1
39	CENTRE DUCT TOP FLOOR PIZZA	SSY12212		1
40	RIGHT-SIDE DUCT A - PIZZA	SSY12213	1	1
41	RIGHT-SIDE DUCT B	SSY12214		1
42	DUCT END COVER	SSY12215	1	1
43	WELL 6 POTS - PIZZA PREP	SSY12216	1	2
	WELL 3 POTS - PIZZA PREP	SSY12217	1	
44	WELL DAG 6 POTS - PIZZA PREP	SSY12218	1	2
	WELL DAG 3 POTS - PIZZA PREP	SSY12219	1	
45	WELL RAG 6 POTS - PIZZA PREP	SSY12220	1	2
	WELL RAG 3 POTS - PIZZA PREP	SSY12221	1	
46	AIR DISTRIBUTOR 6 POTS	SSY12222	1	2
	AIR DISTRIBUTOR 3 POTS	SSY12223	1	
47	WELL SIDE BKT BOTTOM - PIZZA	SSY12224	4	4

Cartridge Assembly - Salad and Pizza Prep

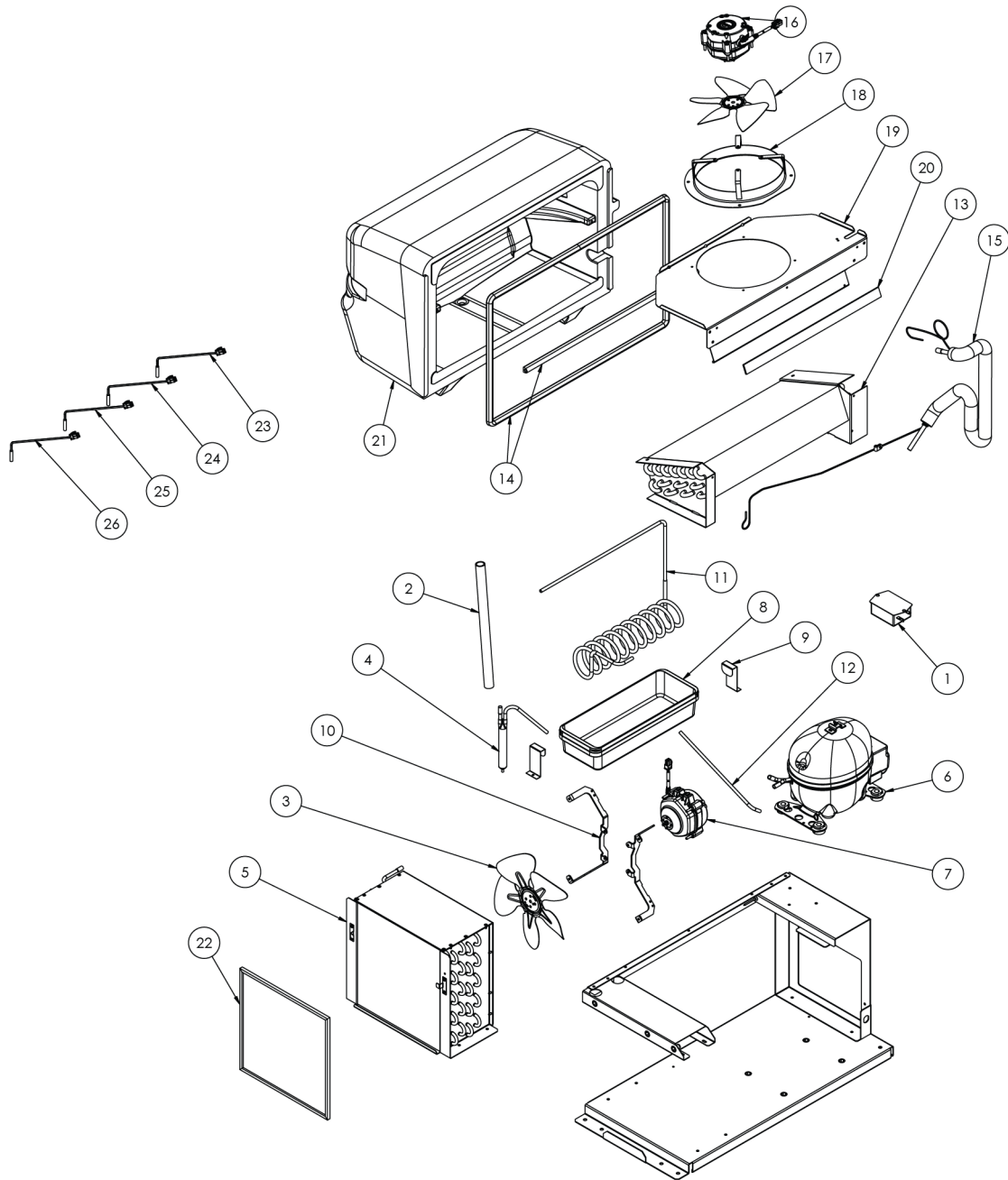

No.	Description	Part No.	ULQCN1-0029	ULQCN1-0030
1	SCHAFFNER EMI FILTER FN2030Z-10-06	ELZ10136	✓	✓
2	15MM ID TUBING	PLE12167-290SP	✓	✓
3	FAN BLADE Ø200 28°	0074000313	✓	✓
4	10GM SPUN DRIER	DRY12258	✓	✓
5	CONDENSER	CLS12066	✓	✓
6	COMP EM2X3125U R290 6.09CC	CPR12100	✓	
	COMP EMX3140U R290 9.50CC	CPR12164		✓
7	FAN MOTOR ECR2-0361 WDTL	ELM11309	✓	✓
8	CONDENSATE TRAY	UP10N00005	✓	✓
9	CONDENSOR TRAY BRACKET	US03N00005	✓	✓
10	MOTOR BRACKET - 200 MM WD	US01N00001	✓	✓
11	DISCHARGE LINE	UT03N00019	✓	
	DISCHARGE LINE	UT03N00020		✓
12	PROCESS TUBE	UT04N00001	✓	✓
13	EVAPORATOR COIL	CLS12065	✓	✓
14	UNIT D GASKET SET TOTAL LENGTH 2200	RUE12210-2200	✓	✓
15	SUCTION LINE ASSEMBLY	UA0400016	✓	
	SUCTION LINE ASSEMBLY	UA0400017		✓
16	AN MOTOR ECR2-0F61 WDTL	ELM11858	✓	✓
17	RH FAN BLADE 172MM-28DEG PITCH	FAN1168	✓	✓
18	FAN MOUNT WALL RING	US01N00003	✓	✓
19	EVAPORATOR FAN SHROUD	US02N00010	✓	✓
20	21 x 3.0 3829 PE INSEAL 384mm	RUE6617	✓	✓
21	EVAPORATOR BOX	UP05N00024	✓	✓
22	FILTER	UP12N00001	✓	✓
23	AMBIENT PROBE	UW0300037-075WH	✓	✓
24	APPLICATION PROBE	UW0300037-150BU	✓	✓
25	EVAPORATOR PROBE	UW0300037-150BK	✓	✓
26	CONDENSER PROBE	UW0300037-075OG	✓	✓
NS	POWER SUPPLY CORD (NOT SHOWN)	UW0100056	✓	✓
NS	EVAP FAN EXT. LOOM (NOT SHOWN)	UW0100058	✓	✓
NS	COMPRESSOR FLEX (NOT SHOWN)	UW0100059	✓	
NS	COMPRESSOR FLEX EMX3140U (NOT SHOWN)	UW0100068		✓
NS	EARTH WIRE - EMI FILTER (NOT SHOWN)	W-GNYE100-0200AIC	✓	✓

6 Installation

Installation Guidelines

When installing this cabinet, ensure the installation guidelines below are considered and met.

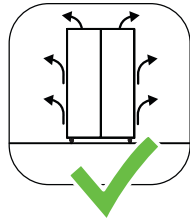

Ventilation
Ensure all ventilation requirements below are met.

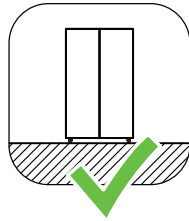

Surface
The installation surface must be capable of supporting the loaded cabinet.

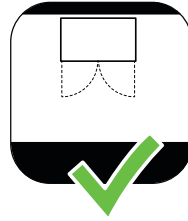

Door Opening
Allow adequate space for the door/s to open and close properly.

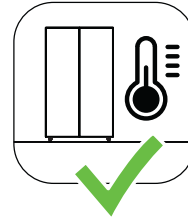

Climate Class
The cabinet must be installed in an environment within its climate class.
The climate class is stated on the cabinet rating label inside the cabinet.

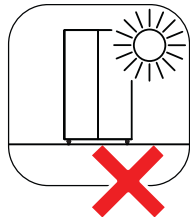

Sunlight
Do not install the cabinet in direct sunlight.

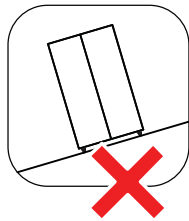

Uneven Surface
Do not install the cabinet on an uneven surface.

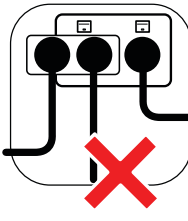

Power Supply
Do not overload the power supply.

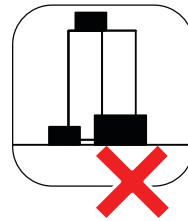

Blocking Ventilation
Do not store boxes or items in front or on top of the cabinet.

Ventilation Requirements

This cabinet must have the following ventilation clearances at all times:

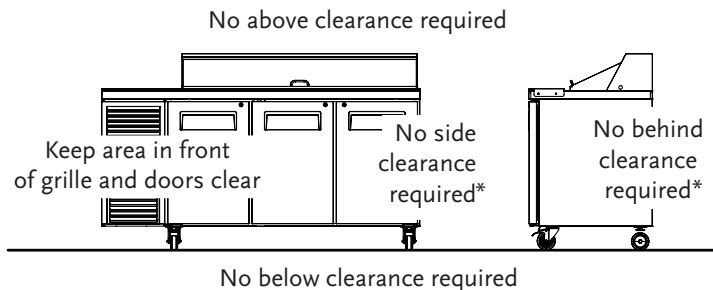

*When installed for continuous duty in climate class 7 environment (35°C ambient / 75% relative humidity), it is recommended to provide 50mm clearance around the sides and back of the cabinet.

Cleaning Before First Use

The cabinet interior and food contact surfaces such as the worktop must be thoroughly cleaned and sanitised before first use. Ensure the cabinet is unplugged from the power supply before cleaning, and use only standard stainless steel cleaners suitable for food preparation areas. The cabinet exterior can be cleaned as instructed in the cleaning section of this service manual (see “Routine Cleaning” on page 55).

Shelves

Each shelf is held in place with four shelf clips, which clip into the shelf support strips. The shelf clips may be positioned at different heights to suit various product.

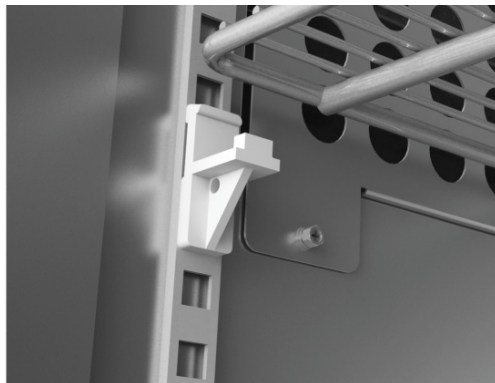

Power Cord

Before final positioning of the cabinet, pull the power cord out and connect to the power supply.

7 Troubleshooting and Diagnostics

Electronic Controller

Alarms signal unexpected operational changes in the cabinet or cartridge. When an alarm is activated, use the electronic controller app to assist with fault diagnosis and service as necessary. See page 14 for information.

General Operation

For problems with the cabinet and refrigeration cartridge use the following table. Refer to relevant section in this service manual for safe access to perform repair.

Problem	Possible Cause	Repair
<ul style="list-style-type: none"> • Cabinet not operating • No controller display 	<ul style="list-style-type: none"> • Loss of power supply • Loose plug 	<ul style="list-style-type: none"> • Check mains power supply. • Check all plugs are connected correctly.
<ul style="list-style-type: none"> • Lights not on. 	<ul style="list-style-type: none"> • See "Lighting" on page 32. 	
<ul style="list-style-type: none"> • Excess noise vibration 	<ul style="list-style-type: none"> • Refrigeration pipes transferring vibration into cartridge 	<ul style="list-style-type: none"> • Re-align pipes away from other parts.
<ul style="list-style-type: none"> • Frozen evaporator coil 	<ul style="list-style-type: none"> • Set-point is too cold 	<ul style="list-style-type: none"> • Check and raise.
	<ul style="list-style-type: none"> • Evaporator probe fault 	<ul style="list-style-type: none"> • Check and replace evaporator probe.
	<ul style="list-style-type: none"> • Controller fault 	<ul style="list-style-type: none"> • Replace controller.
	<ul style="list-style-type: none"> • Short of refrigerant 	<ul style="list-style-type: none"> • Perform refrigeration system diagnostics and service as required.
<ul style="list-style-type: none"> • Power consumption is higher than expected 	<ul style="list-style-type: none"> • Cartridge operating too hot • Cabinet door is opened excessively • Set point to low 	<ul style="list-style-type: none"> • Clean the condenser. • Ensure the cabinet has good ventilation around the refrigeration cartridge. • Ensure the cabinet is within the maximum operating temperature. • Ensure door is closed more often. • Raise set point

Continued over page

<ul style="list-style-type: none"> • Product is too warm. 	<ul style="list-style-type: none"> • Frequent door opening. • Recently loaded • Door not closing properly. • Refrigeration cartridge operating too hot. • Excessive door opening or refrigeration heat load. • Set point is too high 	<ul style="list-style-type: none"> • Limit door openings. • Allow time for the product to cool down. • Check and clean door gasket. • Ensure the cabinet has good ventilation around the refrigeration cartridge. • Ensure the cabinet is within the maximum operating conditions. • Lower set point.
<ul style="list-style-type: none"> • Moisture build up on door or exterior. 	<ul style="list-style-type: none"> • High humidity. • Frequent door opening. • Door not closing properly. 	<ul style="list-style-type: none"> • Check ambient operating temperature and ventilation requirements, and reposition cabinet if necessary. • Limit door openings. • Check and clean door gasket.
<ul style="list-style-type: none"> • Cabinet door does not shut properly. 	<ul style="list-style-type: none"> • Cabinet is on an uneven surface. • Door is obstructed. 	<ul style="list-style-type: none"> • Level the cabinet. • Check shelves and product.
<ul style="list-style-type: none"> • Warm cabinet temperatures • Compressor operating for long periods (more than 1 hour) 	<ul style="list-style-type: none"> • Blocked condenser • Poor ventilation around refrigeration cartridge 	<ul style="list-style-type: none"> • Clean the condenser. • Ensure the cabinet has good ventilation around the refrigeration cartridge. • Ensure the cabinet is within the maximum operating temperature.

Refrigeration System

The following diagnostic test is useful for workshop diagnosis of a short of gas situation. Perform the test before opening the refrigeration system.

It is beneficial to have a correctly operating cartridge running beside the cartridge being serviced to compare behaviour.

Note: These diagnostic procedures are indicative only.

Refrigeration system diagnostic test (perform in suitable workshop)

1. Unplug the cabinet from the power supply, remove the refrigeration cartridge, including controller and wiring loom assembly.
2. Unplug the evaporator fan motor (white 4-pin plug) from the wiring loom.
3. Install door switch jumper (white 2-pin plug) into wire harness.
4. Remove the evaporator tub cover and install blocker to prevent condenser airflow from affecting evaporator coil.
5. Connect the refrigeration cartridge to the power supply and allow to run for approximately 10 minutes until the evaporator temperature stabilises.
6. Optional: For enhanced diagnostics, connect to the controller via Bluetooth enabled device with WDT SCS Connect Field app.
7. Refer to the relevant table below as a guideline to determine if the system charge is correct at typical ambient condition around 25°C.

RF7.PPS.2.SD, RF7.PPS.3.SD

(cartridge ULQCN1-0029)

Observation	50% charged	75% charged	100% charged
Suction pipe at compressor	Cool / dry	Cool / dry	Cold / dry
Evaporator coil	1 x U-bend frosted	4 x U-bends frosted	50% U-bend frosted
Unit power	125 W / 0.6 A	150 W / 0.7 A	150 W / 0.7 A
Evaporator temperature	< 5°C	< -4°C	< -7°C

RF8.PPZ.3.SD, RF8.PPZ.4.SD

(cartridge ULQCN1-0030)

Observation	50% charged	75% charged	100% charged
Suction pipe at compressor	Cool / dry	Cool / dry	Light frost on Comp shell
Evaporator coil	3 x U-bends frosted	50% U-bend frosted	75% U-bend frosted
Unit power	210 W / 1.7 A	230 W / 1.7 A	230 W / 1.7 A
Evaporator temperature	< 5°C	< -4°C	< -7°C

Continued over page

8. Generally, a system with the correct refrigerant charge will frost back to the compressor. If the frost does not go back to the point shown there may be a capillary blockage or compressor fault. The point where the frost stops is affected by the ambient temperature. The tables above show system characteristics at different charge and 25°C ambient condition for a cartridge running on the bench.

9. Determine whether the system is short of refrigerant, blocked capillary or compressor fault.

A dry suction could indicate either short of gas, blocked capillary or compressor fault, and further analysis may be required. If there is no frost present at the evaporator coil inlet pipe a blocked capillary is likely. If frost is forming at evaporator coil inlet pipe system, and suction/compressor is behaving as shown in table above at 50% or 75%, the system is likely short of gas.

10. After fault has been diagnosed and repaired, reassemble the refrigeration system and test run.

8 Replacement Procedures

Lighting

The cabinet is fitted with LED modular interior lights. Ensure the light is replaced with the same light type. Fluorescent or LED tubes cannot be used in place of LED modular lights.

IMPORTANT

Replace the light with the same SKOPE OEM part.
DO NOT use alternative LED strip or tube lights, or fluorescent tubes.

The lighting is made up of three components which are replaceable:

- LED modular light/s
- Light power supply
- Interior wiring loom

Lighting components are all non serviceable items. If a component is faulty, it should be removed and a SKOPE OEM new replacement component fitted.

Refer to the diagnostics table below to determine what component may be at fault, and the procedures over the next few pages for component replacement instructions.

Ensure the cabinet is isolated from the power supply before cleaning or removing parts.

Lighting fault diagnostics

Problem	Possible Cause	Repair
No lights working. Cabinet is dark.	Lights switched off.	Switch lights on at electronic controller faceplate (see page 9), or the app.
	Controller is in Energy Saving mode.	Open the door to bring the controller into Normal mode.
	Controller alarm.	Check controller for alarm code.
	Plug not connected properly.	Check and clean light supply plugs to and from light power supply.
	Light power supply fault.	Replace light power supply.
Light component not working.	Plug not connected properly.	Check and clean plug connection in cabinet.
	Faulty light.	Replace light.
Segment of light not working.	Faulty light.	Replace light.

To replace an interior light component

1. Unplug the cabinet from the power supply.

2. Remove the shelves from either side of the light.

3. Unhook the black clip and unplug the light.

4. Unscrew and replace the light.

5. Plug in the light and hook black clip to plug, then reassemble the shelves.

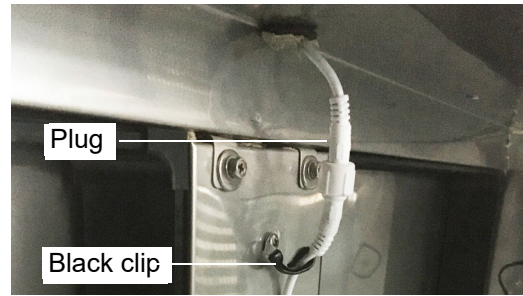

6. Reconnect to the power supply and check for correct operation.

To replace the LED driver power supply

1. Unplug the cabinet from the power supply.

2. Gain access to the cartridge electrics panel (see “Cartridge Electrics Panel” on page 45).

3. Unplug, unscrew and replace the light power supply.

4. Reassemble and test for correct operation.

Hood and Lid Removal

The salad and pizza prep cabinets are fitted with hoods & lids. These components can be easily removed for cleaning purposes or fitting a replacement part.

Salad prep cabinet - Lid & hood removal

1. Open the lid of the cabinet. Two sets of fasteners will need to be removed. These can be accessed on the inside of the lid.

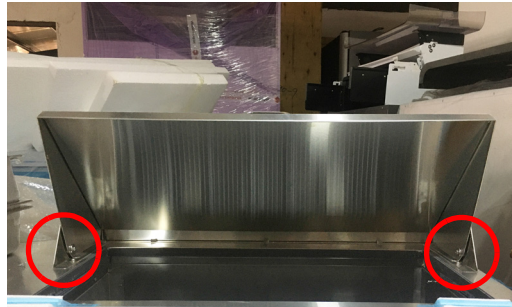

2. A spanner or socket wrench tool will be required for lid removal. Unscrew the two sets of fasteners on both sides of the lid.



3. Take care with the lid fasteners. Secure them so they don't get lost or damaged.



4. Remove the 5 x thumb screws from mounting positions. The hood can be removed from cabinet body.



5. Simply reverse the removal process to fit a cleaned or replacement lid.
-
-

Pizza prep cabinet - Lid removal

1. Open the hood of the cabinet. It will naturally slide into a locked position

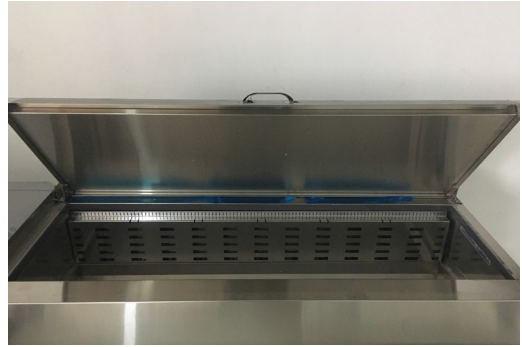

2. Slide the pins forward on an angle, and guide up through the exit feature on the bracket.

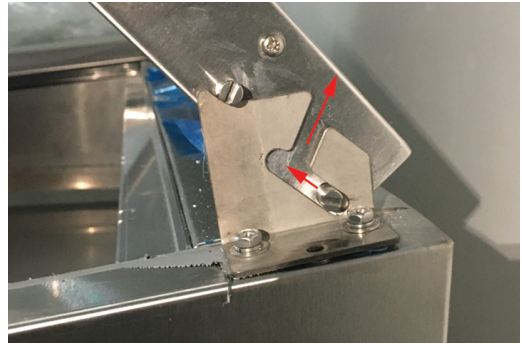

3. Remove the hood from cabinet brackets.

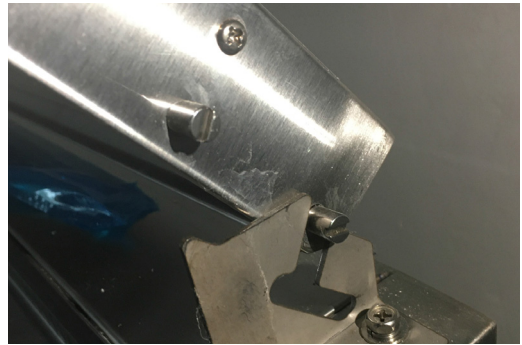

4. Simply reverse the removal process to fit a cleaned or replacement lid.
-
-

Doors

Alignment Adjustment If a door is out of alignment, realign it by loosening the top and/or bottom hinge bracket fixing screws, move the door as required, and re-tighten the hinge bracket screws.

Door Gasket The one-piece door gasket clips into the door frame and runs around the perimeter of the door. Remove the gasket by peeling it from the door frame, starting at a corner.

If the gasket is out of shape after refitting, use a hair dryer to heat and reshape it.

Removing and Refitting the Door For ease of servicing, the door can be removed from the cabinet.

To remove the door

1. Disconnect the cabinet from the power supply.
 2. Unscrew the top and bottom hinges and remove door from cabinet.
-



3. If necessary, remove top and bottom hinges, and self-closing mechanism (see "Door Hinges" on page 37).
-

To refit the door

1. If necessary, refit self-closing mechanism and top and bottom mechanism. Ensure all bushes and washers are present, and the bottom hinge is fitted in closed position for correct self closing.
 2. Refit the door to the cabinet.
 3. Check that the door seal gasket is fitted correctly and forms a complete seal with the cabinet when the door is closed.
-

Door Tension The door is fitted with a self-closing mechanism which allows the door to self-close. If door tension is lost, check that the self-closing mechanism is installed correctly, and if necessary replace (see "Door Hinges" on page 37).

Door Hinges Each door is fitted with top and bottom hinges, and an additional self-closing mechanism which allows the door to self-close. The hinges and self-closing mechanism are replaceable.

To remove the hinges

1. Remove the top hinge, washers and bush from the top of the door.

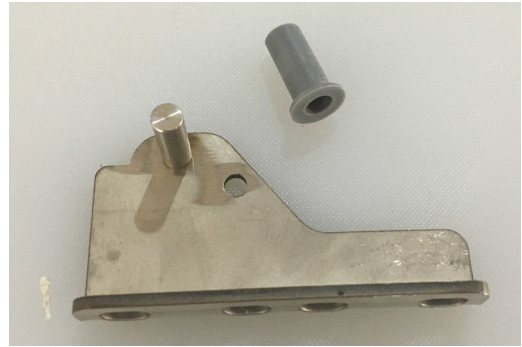

2. Unscrew and remove the bottom hinge and washers from the bottom of the door.



3. Unscrew and remove the self closing hinge from the bottom of the door.



Door Locks Each door is fitted with a key lock. The lock bolt can be removed and replaced. The lock is foamed into the door and cannot be removed.

To replace a door lock bolt

1. Unlock and open the door.
2. Use a slotted screwdriver to remove or fit the lock bolt to the lock mechanism inside the door.



Castors and Legs

The cabinet is supplied fitted with swivel castors. The front castors are lockable, the rear castors are free. A set of adjustable height legs is also included in the cabinet.

The castors can be removed for plinth mounting or for fitting the height adjustable legs.

To remove the castors

1. Raise the cabinet off the ground, and unbolt the castors from the bottom of the cabinet.



To fit the height adjustable legs

1. The supplied legs fit onto the castor mounting holes.

To plinth mount

1. The underside of the cabinet is completely flat for plinth mounting.



Cartridge End Panel

The panel at the LH end of the cabinet can be replaced.

To replace the end panel

1. Unplug the cabinet from the power supply.
 2. Unscrew and remove the front panel: Two screws at the bottom and two screws at the top of the front panel.
 3. Unscrew and remove the end panel: Three screws at the back of the cabinet and six screws from the side of the cabinet.
 4. Fit the replacement end panel, and refit the front panel.
-
-

Refrigeration Cartridge

Before Servicing Overview

Ensure you have read and understand this section before commencing with refrigeration cartridge servicing.

Important. Ensure the following before servicing:

- ▣ Only technicians contracted to SKOPE hydrocarbon service policy may service this cabinet.
- ▣ SKOPE hydrocarbon refrigeration systems must only be serviced by appropriately skilled refrigeration mechanics.
- ▣ Servicing of sealed refrigeration system must be completed at a hydrocarbon workshop/service area with dedicated hydrocarbon equipment and suitable personal protective equipment.
- ▣ All local hydrocarbon storage and handling regulations and procedures must be adhered to at all times.

Ensure all electronic controller alarms diagnostics and refrigeration system diagnostics are performed to confirm a refrigeration system fault is present. Do **NOT** open the refrigeration system. Check all components such as the electronic controller and electrical systems. If a sealed system fault is suspected, the system must not be opened; it must be sent to a SKOPE approved service depot for repair.

IMPORTANT

Use only dedicated hydrocarbon SKOPE OEM spare parts.

DO NOT use alternative parts.

For safety compliance, only SKOPE supplied components specified for the appliance shall be used for repairs.



Safety hazards

The main hydrocarbon safety hazards are:

- ▣ Flammable refrigerant.
- ▣ Venting of hydrocarbon and compressor oil.
- ▣ Asphyxiation.

Refrigerant identification

The cabinet rating label (located inside the cabinet) states the refrigerant type. In addition to this, warning labels are fitted to hydrocarbon refrigeration cabinets to indicate the use of R290 refrigerant.

Personal Protective Equipment

Ensure all required P.P.E. is used correctly during servicing.

Service equipment

All refrigeration service tools must be hydrocarbon compliant and any electrical equipment that could be exposed to the refrigerant must be intrinsically safe. **ONLY** dedicated hydrocarbon service equipment may be used.

In addition to standard tools for accessing and removing parts, specialist tools are required when completing refrigeration system service tasks detailed in this manual:

- ▣ Intrinsically safe vacuum pump.

- Dedicated hydrocarbon gauges.
- Intrinsically safe hydrocarbon combustible gas leak detector.
- Intrinsically safe scales to 1gm accuracy.
- Well ventilated work area.

Gas Detector A gas detector is required and must be used when servicing HC cartridges. A gas detector is a safety device for Hydrocarbon gas to warn the technician that hazardous flammable gas is present.

Leak Detector A leak detector is recommended for servicing HC cartridges. It is used to track and locate the source of Hydrocarbon gas leaks.

On-Site Work The service technician must have required knowledge, skills and tools to proceed with on-site refrigeration sealed system diagnostics.

Minimum knowledge and skills

- Experience and qualifications suitable for work on a flammable refrigeration system.
- Performs no unsafe activity.
- Fully complies with SKOPE HC service policy.

Minimum tools and equipment

- Hydrocarbon gas detector
- Safety signage - suitable to create a safe work zone 1.5m around the cabinet.
- Refrigeration gauge set - suitable for R290 flammable refrigerant.

Service vehicle

- Suitable for transporting flammable gas (being HC refrigeration systems). Vehicle storage area must be well ventilated externally, and not ventilated into the vehicle. There must be no ignition sources in the storage area, nor any areas where the gas may pool.
- Must be able to transport cartridges.
- Should carry minimum SKOPE HC service parts.

Not Cooling Fault If a customer reports a 'not cooling' fault, and it has been established that the cabinet is not cooling, follow the procedure on page 41 when making the service visit.

Hydrocarbon Workshop The following tools and equipment are required in the hydrocarbon workshop:

- Hydrocarbon Leak Detector.
- Dedicated Hazardous workshop Area - suitable for servicing and release of flammable refrigerant.
- Refrigeration Gauge set - suitable for R290 flammable refrigerant.
- Dry Nitrogen - suitable for purging and high pressure testing.
- Refrigeration Vacuum pump rated as suitable for use with R290 (by Vacuum pump supplier).
- Charging scales rated as suitable for use with R290 (by scales supplier), accuracy to 1gm.
- R290 refrigerant supply cylinder.

Removing the Cartridge

Note: The electronic controller and electrics panel (including light power supply) is matched to the cabinet, and must be left with the cabinet when exchanging the cartridge. Replacement spare part cartridges are not supplied with controller and electrics panel.

Follow the steps below and image over the page to remove the refrigeration cartridge from the cabinet. Ensure the cabinet is disconnected from the power supply before removing the cartridge.

WARNING

Cabinet body is connected to installation earth via the refrigeration cartridge. Removal of the cartridge removes cabinet earth. **NEVER** connect cabinet heating leads to the electrics box or any other power supply with the cartridge removed or risk of electric shock may be created.

CAUTION

Some connector colours vary depending on date of manufacture. After unplugging connectors, **ALWAYS** ensure reconnection has been undertaken correctly as operational faults may occur if incorrect. It is recommended to photograph wiring setup before unplugging for future reference.

To remove the refrigeration cartridge

1. Unplug the cabinet from the power supply, and cut the cable tie at the back of the cabinet to release the power cord.
2. Unscrew the front panel - (Phillips head screwdriver): Two screws at the bottom and two screws at the top of the front cover.
3. Unscrew the cartridge (Phillips head screwdriver): Two screws at the bottom and four screws on the right hand side of the cartridge. Two screws for the rear bracket do not need to be unscrewed. The two screws for front bracket should be unscrewed when removing the cartridge.
4. Partially slide the cartridge out. Hold the bottom of the controller box to slide the cartridge out, and take care of loose plugs, cables and the evaporator box gasket when sliding the cartridge. Release the electrical cables on the LH side of the cartridge by cutting the cable ties securing the cables.
5. Photograph wiring setup for future reference when refitting the cartridge.
6. Unplug the cartridge from the cabinet (see picture over page):
 - Black 3-Way plugs (heater elements) at the front of electrics box.
 - Red 2-Way plugs (LED lamps) at the front of the electrics box.
 - White 2-Way plug (door switch) on wiring loom.
7. The cartridge can now be removed from the cabinet.
8. When swapping cartridge: Detach controller box and electronic controller from the cartridge.
 - To remove the controller box: Unscrew the three screws (Phillips head screwdriver) at the bottom edge of the controller box and detach controller box from cartridge.
 - To remove the controller: Unscrew two self-tapping screws on top of the controller box, and remove LED driver from controller box. Unscrew two self-tapping screws in the front of controller box, and detach controller box lid from the controller box base. Press and hold the tabs on each side of the electronic controller to unlock, and push Wellington Drive SCS controller through the front of controller box. Unplug the electronic controller from the cartridge.

-
9. Reverse the steps above to refit the cartridge. When refitting, ensure:
- ▣ **IMPORTANT:** Ensure plug reconnection is undertaken correctly as operational faults may occur if incorrect. Refer to relevant image on page 46, wiring diagram on page 18, and previous recommended photograph for reference.
 - ▣ The evaporator box gasket is in good condition.
 - ▣ All plugs and cables are re-connected to the correct socket and cable tied back into place.
 - ▣ Wires and cables are clear of the cartridge when moving it.
 - ▣ The cartridge is pushed fully in the cabinet and screwed in place. Ensure the hook of the rear bracket is hooked in the left side slot of the bracket.
 - ▣ The front cover is refitted.
-

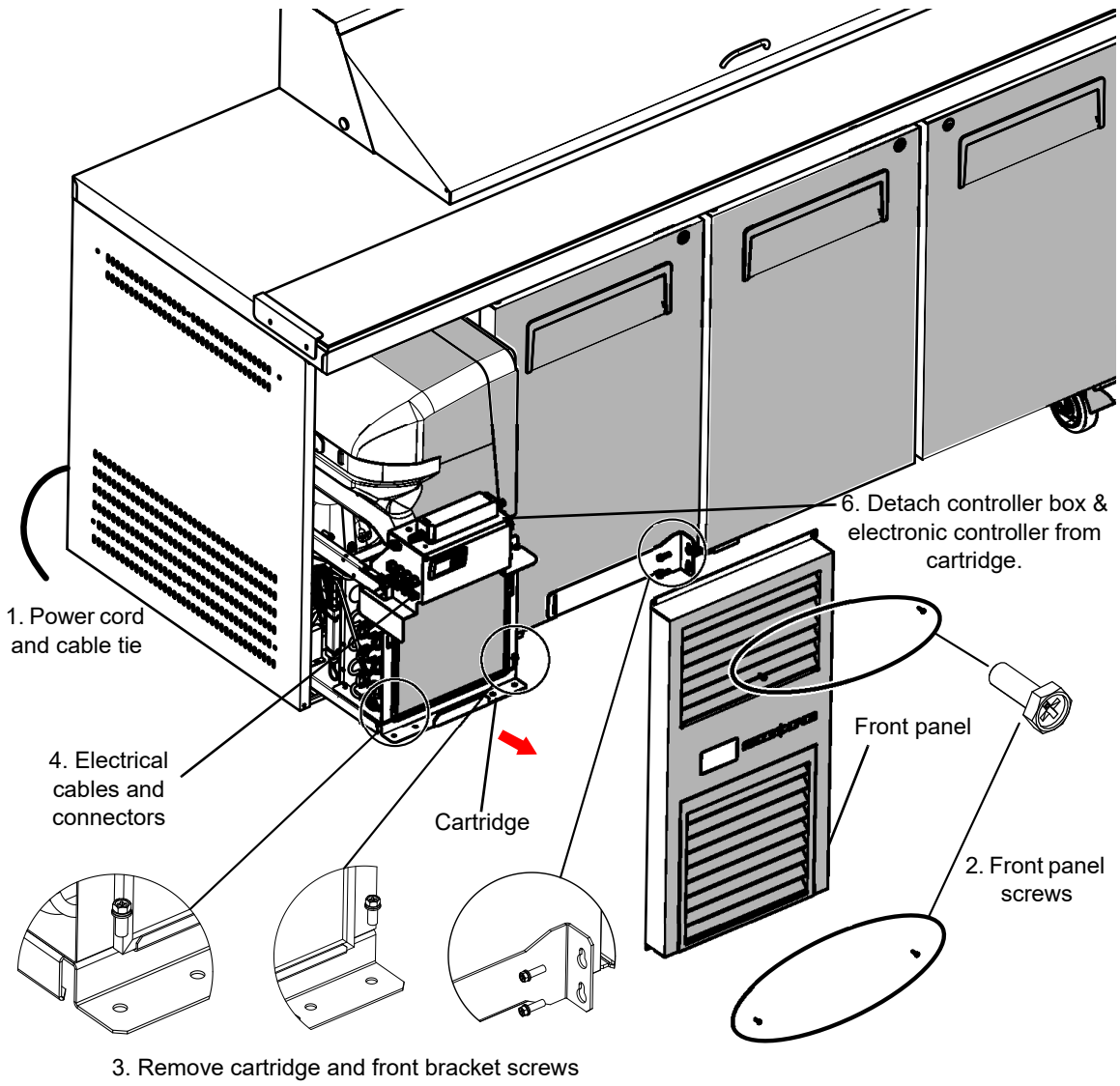

Refrigeration Cartridge Assembly

The refrigeration cartridge is an end mounted, electronically controlled removable cartridge.

The electronic controller and electrics panel (including light power supply) is matched to the cabinet, and must be left with the cabinet when exchanging the cartridge. Replacement spare part cartridges are not supplied with controller and electrics panel.

For safety and compliance, only SKOPE supplied parts specifically for this appliance may be used for repairs. Other parts may appear suitable, but may not be approved or safe for use in an appliance with hydrocarbon refrigerant.

The cartridge must only be used on a SKOPE Hydrocarbon compliant cabinet. Refer to the cabinet rating label to determine if the cabinet is suitable for use with a hydrocarbon cartridge. The rating label **MUST** state refrigerant as R290. If the label states a different refrigerant, or does **NOT** state a refrigerant, it is **NOT** suitable for a hydrocarbon cartridge.

WARNING
The hydrocarbon cartridge must only be used on an hydrocarbon compliant cabinet.

For servicing or transportation, the refrigeration cartridge unplugs and lifts off the cabinet. Some minor servicing can be performed without removing the refrigeration cartridge.

The model and serial number are both printed on the cartridge rating/serial number label attached to the panel above the condenser coil.

Different fridge and freezer cartridges are used across different models, and cartridge spare parts vary between different cartridges. Refrigeration system pipe routing varies between different model releases.

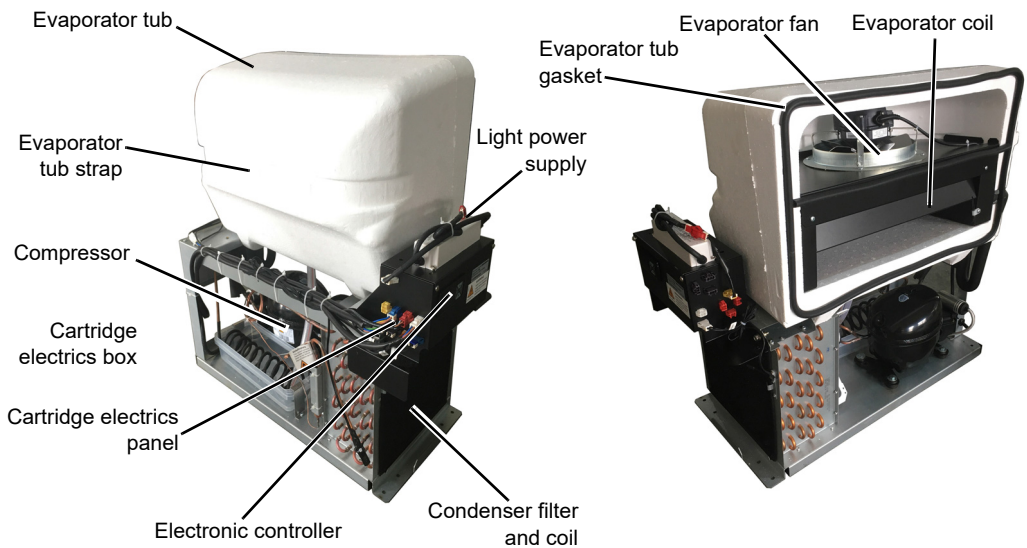

Defrost Cycle Defrost parameters vary depending on product type, and can be reviewed in the SCS Connect Field app.

**Cartridge
Electrics Panel**

The cartridge controller box (including light power supply) is matched to the cabinet, and must be left with the cabinet when exchanging the cartridge. Replacement spare part cartridges are not supplied with an electrics panel.

The cartridge controller box assembly contains the light power supply, and panel mount socket connectors for the cartridge and cabinet.

Due to the confined space within the cartridge electrics box, plugs may come loose as a result of movement and vibrations during servicing. Take care when refitting to ensure all plugs are securely attached to the correct sockets.



To remove the cartridge control box and open the electrics box

1. Remove the cartridge from the cabinet (see page 41).
2. Unscrew the control box from the cartridge (3 × screws).
3. To open the controller box (see page 41) Step-8 “To remove the controller”

Condenser Fan The condenser fan assembly is made up of a fan motor, fan blade and mounting brackets which can be replaced if necessary.

If the fan stops for any reason, check all connections to ensure no plugs have come loose.



IMPORTANT
 Replace the motor with the same SKOPE OEM part.
DO NOT use alternative parts.

It is important that the fan blade and/or fan motor is replaced with the same part to ensure safety, correct alignment, refrigeration performance, and compliance. Fan blades should be tightened to the recommended torque settings (shown in the table below).

Fan motor manufacturer recommended torque settings

Fan motor manufacturer	Torque setting
Wellington Drive	1.4 Nm

To access and remove the condenser fan assembly

1. Remove the cartridge from the cabinet (see page 41).
2. Remove the control box (see page 45).
3. Take note of cable routing (photo recommended), then cut the cable ties holding the condenser fan motor cable along the cartridge, and free up the condenser fan motor cable.
4. Unscrew the condenser fan assembly from the condenser coil, and remove the assembly (fan motor, fan blade, mounting brackets) from the cartridge by lifting the shroud up and out.

To replace the fan blade

1. Remove the condenser fan assembly (see above).
2. Remove the screw and washer from the centre of the fan blade, and lift the blade from the motor.
3. Replace new blade and fix with 12mm flat washer and serrated head screw. Tighten the blade to recommended torque setting.
4. Refit the condenser fan assembly to the cartridge. Following the same path as the original probe, secure the condenser fan motor cable with cable ties as necessary.
5. Reassemble and test.

To replace the fan motor (with correct SKOPE spare part only)

1. Remove the condenser fan assembly and the fan blade (see previous page).

 2. Detach the fan motor from the fan mounting brackets by removing the four screws from the mounting bracket.

 3. Fit new motor and reattach fan blade with 12mm flat washer and serrated head screw. Tighten the blade to recommended torque setting.

 4. Refit the condenser fan assembly to the cartridge. Following the same path as the original cable, secure the condenser fan motor cable with cable ties as necessary.

 5. Reassemble and test.
-
-

Evaporator Tub When refitting the tub, start at the bottom and take care of the plastic guide which could damage the tub if misaligned.



Evaporator Fan The evaporator fan assembly is a one piece assembly which can be replaced if necessary.

If the fan stops for any reason, check all connections to ensure no plugs have come loose. Refer to the label on the electrics box cover to identify the evaporator fan plug and socket in the electrics box.

The fan assembly is fixed to evaporator shroud with screws and metal bars.

IMPORTANT
Replace the motor with the same SKOPE OEM part.
DO NOT use alternative parts.

It is important that the assembly is replaced with the same part to ensure safety, correct alignment and refrigeration performance, and compliance.

To access and replace the evaporator fan assembly

1. Remove the cartridge from the cabinet (see page 41).

2. Unplug 4-way white connector behind the tub.

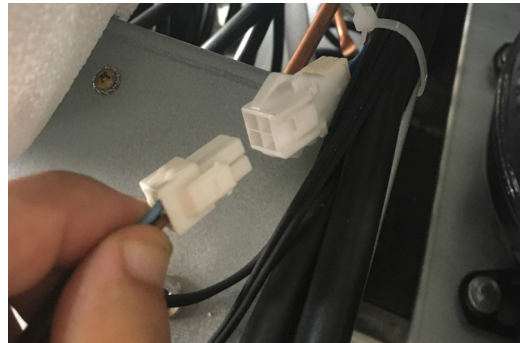

3. Unscrew two screws from evaporator assembly .



4. Remove evaporator fan assembly from tub.



5. Reassemble and test.

Compressor The compressor is located at the back of the refrigeration cartridge. If the compressor is causing excessive noise, check the mountings to ensure there is no damage to the rubber or the washers, nuts and screws.

Before replacing the compressor, check all plug connections and ensure the compressor electricians are operating correctly. The compressor must be supplied with consistent voltage over 220 volts. Ensure the voltage does not drop at start-up. If the voltage does drop, ensure the cartridge has a direct power supply (not from a multi-box or extension cord). Generally a faulty compressor may have a distinct hissing sound and run with a very hot body temperature.

IMPORTANT

To eliminate possible vibration noise, ensure no pipes touch the cartridge housing and condenser assembly.

Electronic Controller

The electronic controller and electrics panel (including light power supply) is matched to the cabinet, and must be left with the cabinet when exchanging the cartridge. Replacement spare part cartridges are not supplied with controller and electrics panel.

Different controller parameter sets are used across different models. Ensure the controller is set-up with the correct parameter set for the cabinet model.

Controller Location The electronic controller is located on the electrics panel at the front of the refrigeration cartridge.

To access and remove the controller

1. Unplug the cabinet from the power supply.
 2. Remove the unit cover from the cabinet.
 3. Unscrew two self-tapping screws on top of the controller box, and remove LED driver from controller box. Unscrew two self-tapping screws in the front of controller box, and detach controller box lid from the controller box
 4. To remove the controller: Press and hold the tabs on each side of the electronic controller to unlock, and push the Wellington Drive SCS controller through the front of the controller box. Unplug the electronic controller from the cartridge.
-
-

QC Terminals The terminals at the back of the controller are locking QC terminals, which cannot be pulled off without pressing in the locking tabs.

Use needle nose pliers to unlock and gently remove the terminals.

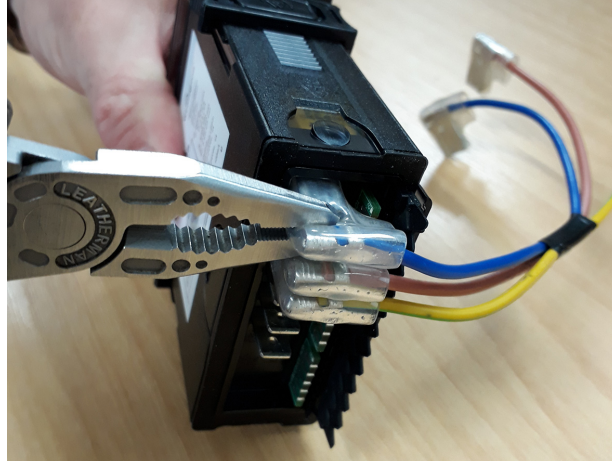

Replacing the Controller

Follow the steps below to replace the controller.

Note: Replacement spare part electronic controllers are not supplied with the parameter set loaded. This must be loaded via the SCS Connect Field app after replacing the controller. Internet access may be required.

To replace the controller

1. Disconnect the cabinet from the power supply and access the electronic controller (see "Controller Location" on page 50).
2. Disconnect the terminals from the back of the controller.
3. Fit the new replacement controller, and connect up the terminals at the back of the controller (see image below). Connect low voltage terminals before high voltage terminals.
4. Reassemble, perform electrical safety test, and reconnect to the power supply.
5. Use a mobile device to connect to the controller with the SCS Connect Field app (see "SCS Connect Field App and Track App" on page 11).
6. Navigate to the LOAD PARAMETER FILE menu.
7. Select the appropriate parameter file from LOCAL. If not available in LOCAL, search for the parameter file in SERVER (internet access required), and download to LOCAL.
8. Confirm correct file and WRITE TO SCS.
9. After WRITE TO SCS is complete, select MENU DISCONNECT to save parameter set on SCS.
10. Power cycle the controller, reconnect via SCS Connect Field app and check that correct parameter set has been applied.
11. Navigate to the SCS SETUP menu and select the model (as per the cabinet rating label).

12. Set up controller and cabinet links as required:

Corporate

The service tech must link to the controller to the cabinet serial number in the SCS Connect Field app.

General Market

The owner must set up SKOPE-connect (if in use).

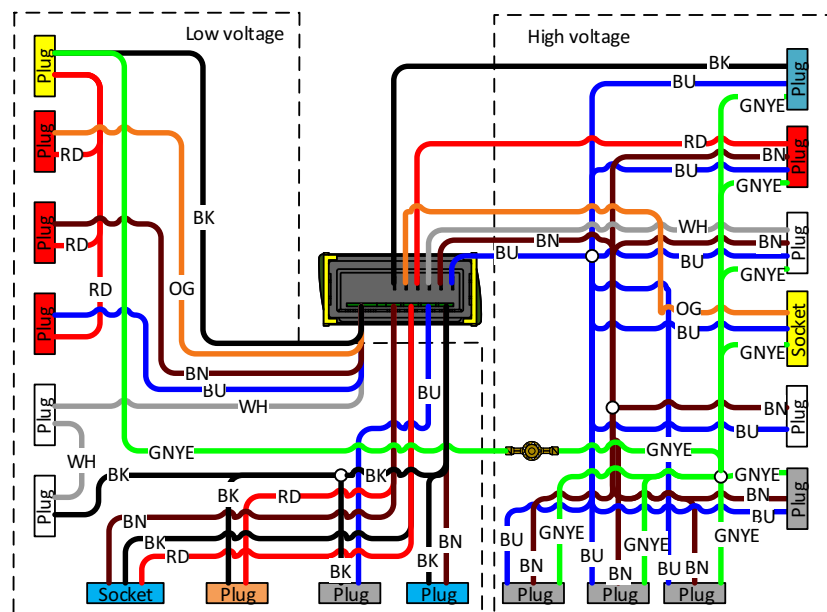

Door Switch The cabinet is fitted with a door switch above each door, which tells the electronic controller when a door is opened. A small magnet on the top edge of the door activates the switch.

To replace the door switch

1. Unplug the cabinet from the power supply.

2. Unscrew and remove the door switch cover: 2 x screws.

3. Unplug and replace the door switch.

4. Refit the cover.

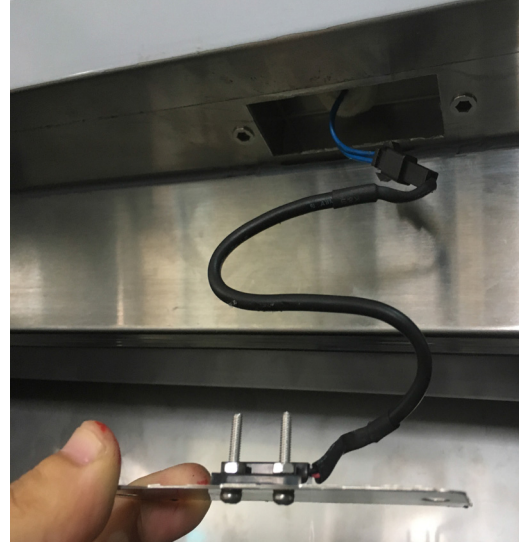

5. Reconnect the cabinet to the power supply and check for correct operation.

Control Probe The control probe is clipped to the inside of the evaporator assembly.

To replace the control probe

1. Remove the cartridge from the cabinet (see page 41).

2. Gain access to the evaporator fan assembly (see steps 2-3, "To access and replace the evaporator fan assembly" on page 48).

3. Take note of cable routing (photo recommended), then carefully cut cable ties to release the probe cable. Detach the probe from the evaporator assembly, trace back to its connector and unplug.

4. Replace the probe. Following the same path as the original probe, fit the new probe with cable ties as necessary. Ensure the probe cable is securely connected and cable tied in place.

5. Reassemble and test for correct operation.



Evaporator Probe The evaporator probe is located within the evaporator coil. It controls the refrigeration system defrost initiation and termination.

To replace the evaporator probe

1. Remove the cartridge from the cabinet (see page 41).

2. Gain access to the evaporator fan assembly (see steps 2-3, "To access and replace the evaporator fan assembly" on page 48).

3. Take note of cable routing (photo recommended), then carefully cut cable ties to release the probe cable. Carefully separate the coil fins around the probe, withdraw the probe from the evaporator coil, trace back to its connector and unplug.

4. Replace the probe. Following the same path as the original probe, fit the new probe with cable ties as necessary.
Ensure the probe is located in the same location (between the 4th and 5th fins), secured in place with the evaporator fins, and that the probe cable is securely connected and cable tied in place.

5. Reassemble and test for correct operation.



Condenser Probe The condenser probe is located on the side of the condenser coil.

To replace the condenser probe

1. Disconnect the cabinet from the power supply and remove the refrigeration cartridge (see page 41).

2. Take note of cable routing (photo recommended), then carefully cut cable ties to release the probe cable. Detach the probe from the side of the condenser coil, and trace the probe cable back to its connector, and unplug.

3. Following the same path as the original probe, run the new probe to the condenser coil and secure with cable ties. Locate the probe in the same location as the original probe.

4. Reassemble and test for correct operation.



Ambient Probe The ambient probe is located in front of the condenser coil. It monitors the temperature around the refrigeration cartridge. **Note:** The ambient probe is wired in series with the door switch.

To replace the ambient probe

1. Disconnect the cabinet from the power supply and remove the refrigeration cartridge (see page 41).
 2. Take note of cable routing (photo recommended), then carefully cut cable ties to release the probe cable. Detach the probe from the front of the cartridge, and trace the probe cable back to it's connector and unplug.
 3. Following the same path as the original probe, run the new probe to the condenser coil and secure with cable ties. Locate the probe in the same location as the original probe.
 4. Reassemble.
-
-



9 Routine Cleaning

Cabinet

Ensure the cabinet is unplugged from the power supply before cleaning.

Wipe the outside of the cabinet with a damp cloth, and the inside of the cabinet with standard stainless steel cleaners suitable for food preparation areas. Take care to keep moisture away from electrical parts.

IMPORTANT

Do **NOT** use abrasive, corrosive or solvent based cleaners, as this could damage the protective coating on the cabinet exterior.

The following duct & well components can be removed without a tool for routine cleaning.

ReFlex Salad Prep (refer to "Cabinet Assembly - Salad Prep" on page 20).

No.	Description	Part Number
33	WELL SIDE BKT TOP - PIZZA	SSY12225
34	PAN HOLDER	SSY12193
44	WELL DAG 6 POTS - PIZZA PREP	SSY12218
	WELL DAG 3 POTS - PIZZA PREP	SSY12219
45	WELL DAG 6 POTS - PIZZA PREP	SSY12220
	WELL DAG 3 POTS - PIZZA PREP	SSY12221

ReFlex Pizza Prep (refer to "Cabinet Assembly - Pizza Prep" on page 22).

No.	Description	Part Number
34	PAN HOLDER	SSY12193
36	SIDE WELL : LEFT	SSY12195
39	AIR CURTAIN VENTING - SMALL	SSY12198
	AIR CURTAIN VENTING - MEDIUM	SSY12199
40	WELL SIDE VENT - SMALL	SSY12200
	WELL SIDE VENT - MEDIUM	SSY12201

Condenser Coil

The condenser coil must be kept clean. SKOPE strongly recommends monthly cleaning of the condenser coil and air filter. Do **NOT** use hard or sharp tools to clean the coil as these may cause damage.

WARNING

Unplug the cabinet from the power supply before cleaning the condenser coil.

To clean the condenser coil and condenser filter

1. Unplug the cabinet from the power supply.
2. The filter is located behind the unit bottom grille. Rotate the grille out and slide the filter up and off the cabinet.
3. Clean the filter with a vacuum cleaner, wash with cold water and shake off any excess water before refitting. Do **NOT** apply hot water, blow-dry or place in dishwasher. If necessary, discard and refit new filter.

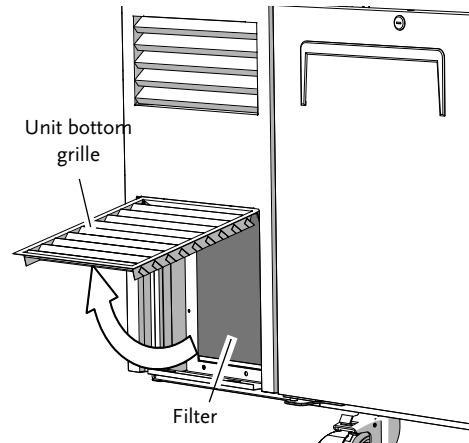

4. With the cabinet unplugged from the power supply and the filter removed (see steps above), brush the condenser coil with a soft brush to remove any dust and fluff.
5. Refit the filter, close the bottom grille and reconnect to the power supply.

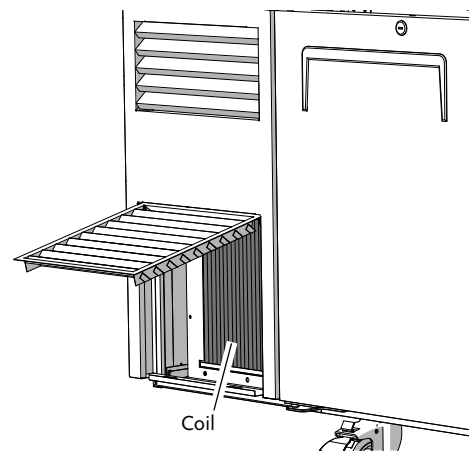

10 On-Site Work Procedure

If a customer reports a 'not cooling' fault, and it has been established that the cabinet is not cooling, follow the procedures below when making the service visit.

Swap Cartridge

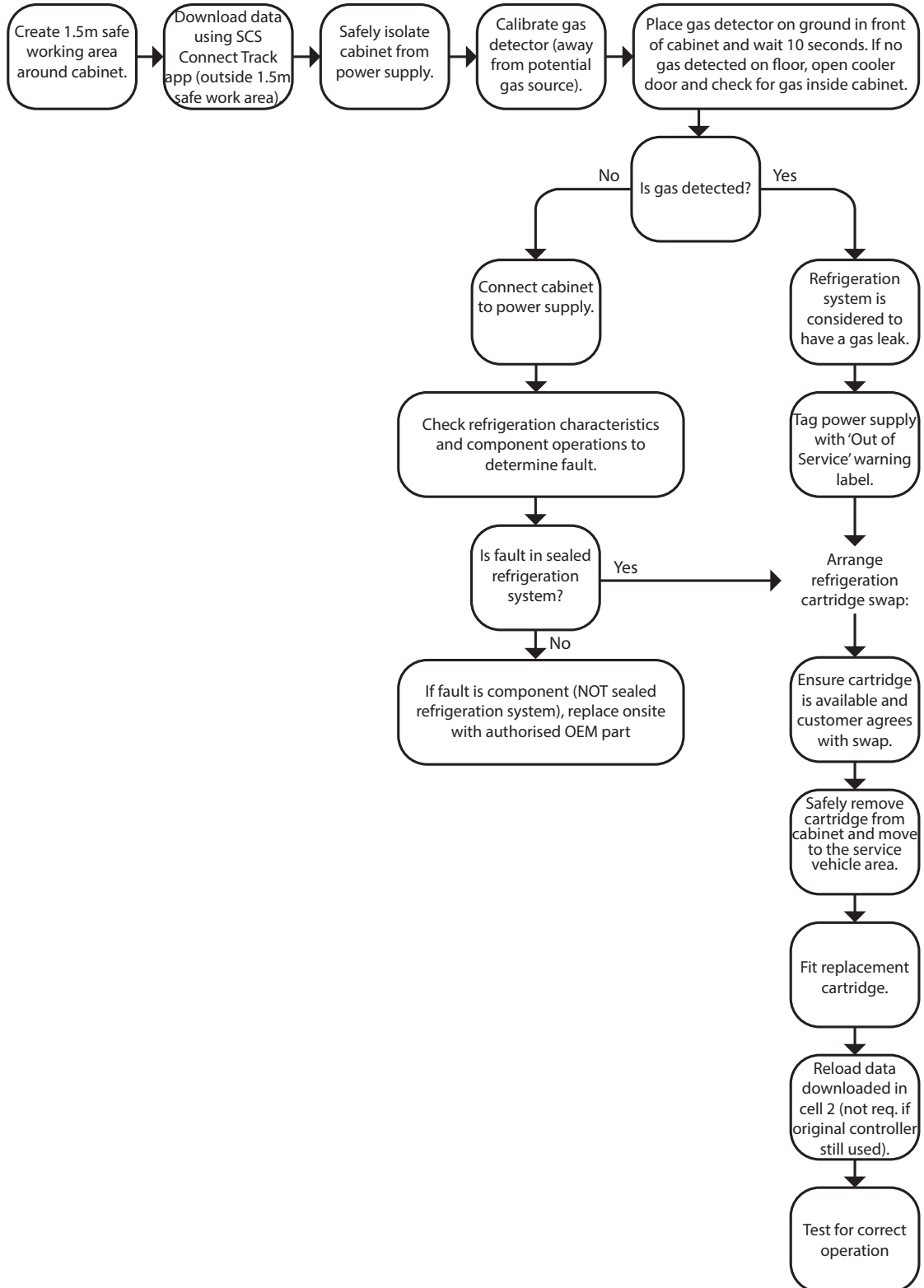

Return Faulty Cartridge

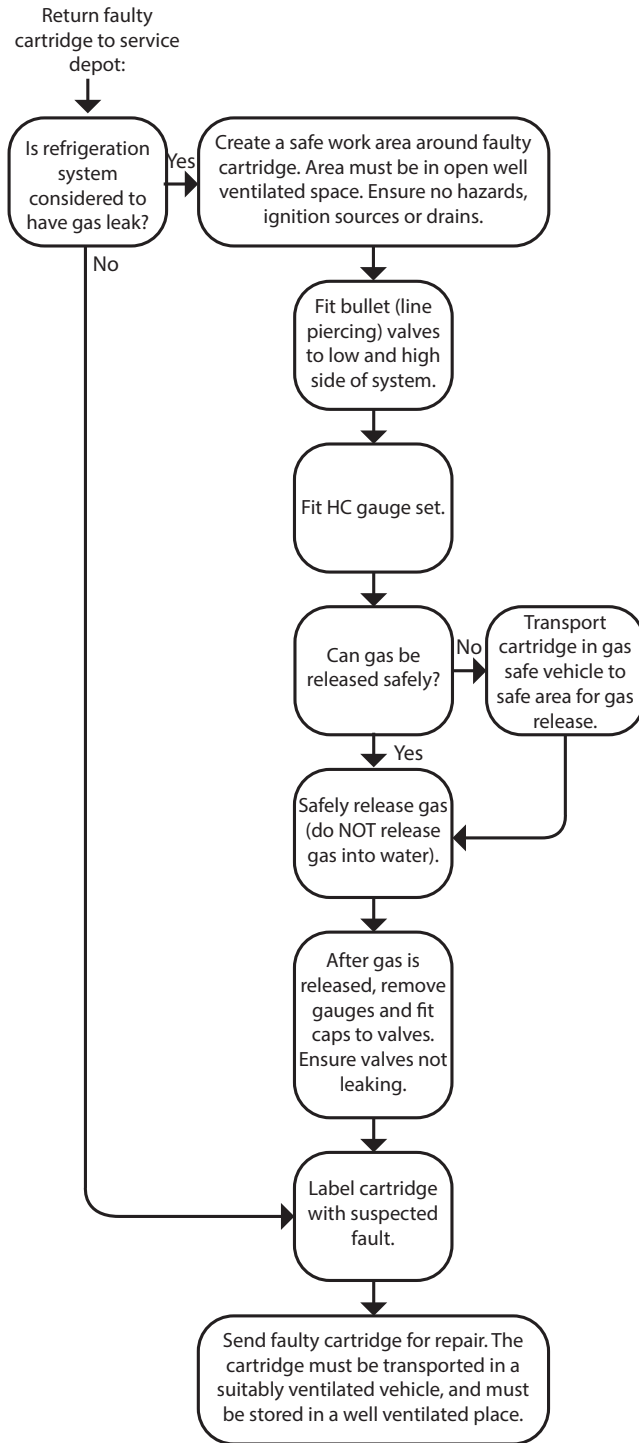

SKOPE Contacts

SKOPE Industries Limited

A.B.N. 73 374 418 306

AU: 1800 121 535

NZ: 0800 947 5673

skope@skope.com

www.skope.com