

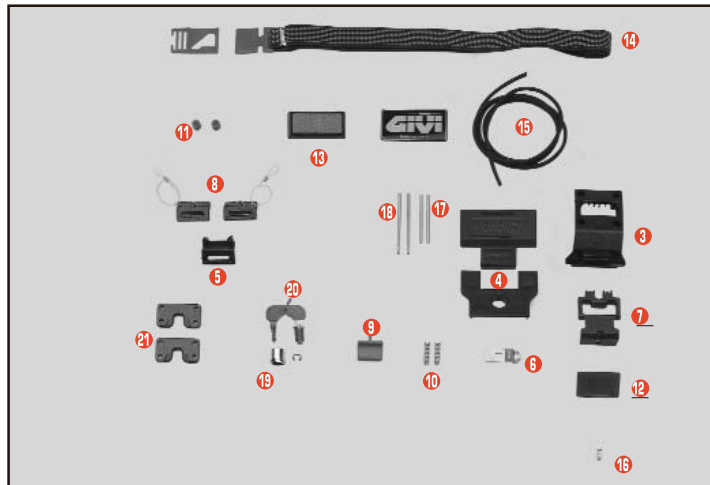

- 1 **Z38CN**\* \* E38 top-shell black
- 2 **Z34FN**\* \* E28-E34-E38 bottom-shell black
- 3 **Z101** Push set protection
- 4 **Z103**\* \* Top-case hinge
- 5 **Z104** Square two holes
- 6 **Z105** Key lock plate
- 7 **Z106** Bolt
- 8 **Z107** Bag yarn
- 9 **Z108** Top-case push button red
- 10 **Z109** Long bolt springs
- 11 **Z112R** Red pulley
- 12 **Z118**▲ Plate two holes
- 13 **Z119** Top-case reflector
- 14 **Z158** Spare elastic belt
- 15 **Z159R** Bag lock lining
- 16 **Z1237** Push button spring with washer



- 17 **Z193** Hinge pin 62 mm
- 18 **Z195** Hinge pin 78 mm
- 19 **Z210** Chrome bushing for lock set
- 20 **Z140R** Lock key
- 21 **Z110** Plate four holes

\* \*ITEM OUT OF STOCK



- 1 **Z36CN** E36-E45 top-shell black
- 2 **Z36FN** E36 bottom-shell black
- 3 **Z101** Push set protection
- 4 **Z106** Bolt
- 5 **Z108** Top-case push button red
- 6 **Z109** Long bolt springs
- 7 **Z112R** Red pulley
- 8 **Z185** Hinge plate
- 9 **Z119** Top-case reflector
- 10 **Z151N**▲ Top-case hinge E36 black
- 11 **Z153** Key lock plate
- 12 **Z159R** Bag lock lining

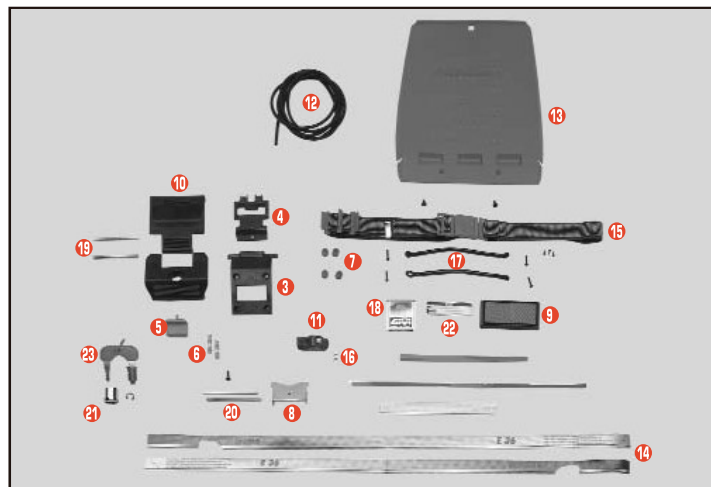

- 13 **Z160** Inner document holder
- 14 **Z165** Adhesive series for E36
- 15 **Z167** Spare elastic belt
- 16 **Z1237** Push button spring with washer
- 17 **Z664** Stop bag opening yarn E36 O96 with plastic sleeve
- 18 **Z186** GIVI logo
- 19 **Z194**\* \* Pin medium size 66 mm
- 20 **Z195** Hinge pin 78 mm
- 21 **Z208**▲ Chrome bushing for lock set
- 22 **Z405** Name holder
- 23 **Z140R** Lock key
- Z155** Pass belt

\* \*ITEM OUT OF STOCK