

D267KIT - D267KIT

ATTACCHI SPECIFICI PER - SPECIFIC FITTING KIT FOR
KIT DE MONTAGE SPECIFIQUE POUR - SPECIFISCHER MONTAGEKIT FÜR
ANCLAJE ESPECÍFICO PARA

SUZUKI BURGMAN K7 2006

125/200cc

ISTRUZIONI DI MONTAGGIO - MOUNTING INSTRUCTIONS
INSTRUCTIONS DE MONTAGE - BAUANLEITUNG - INSTRUCCIONES DE MONTAJE

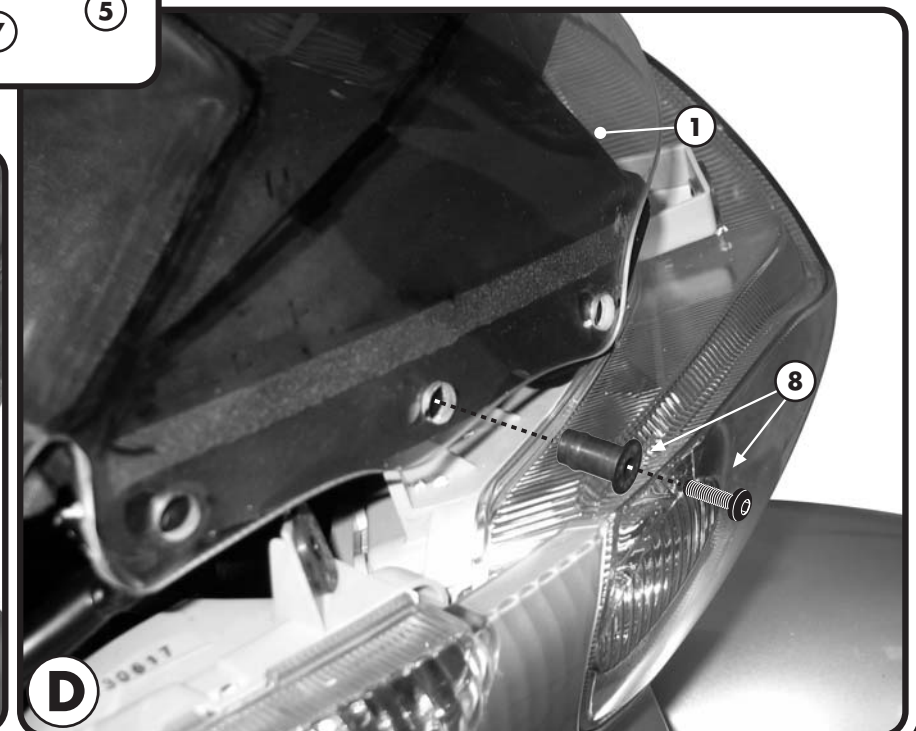
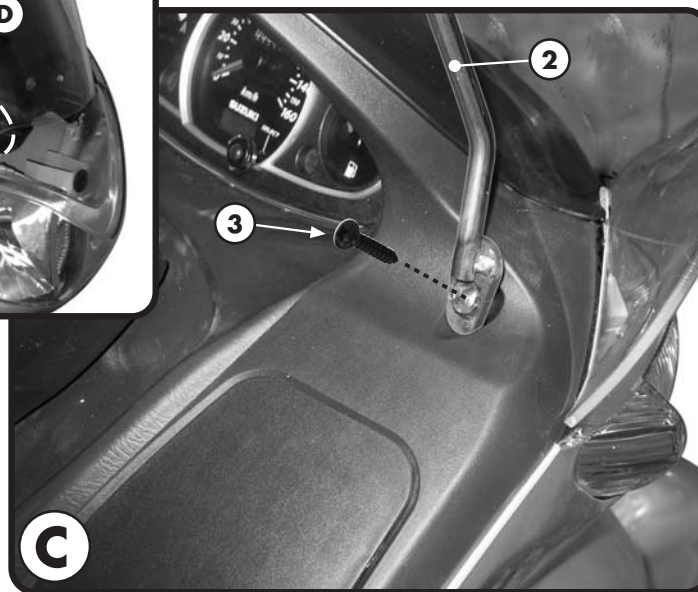
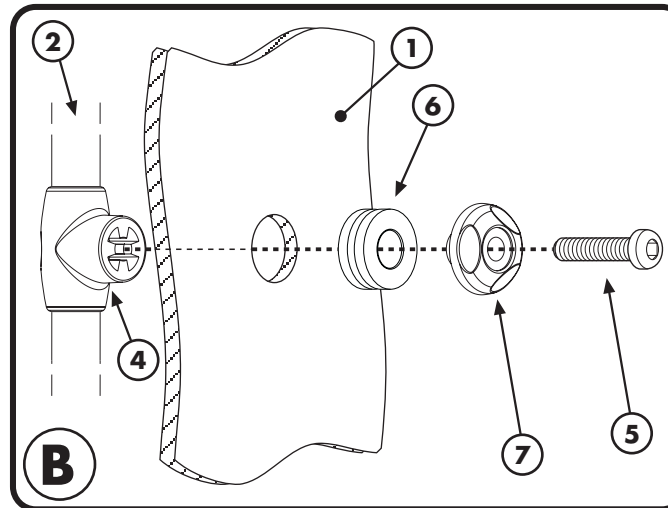
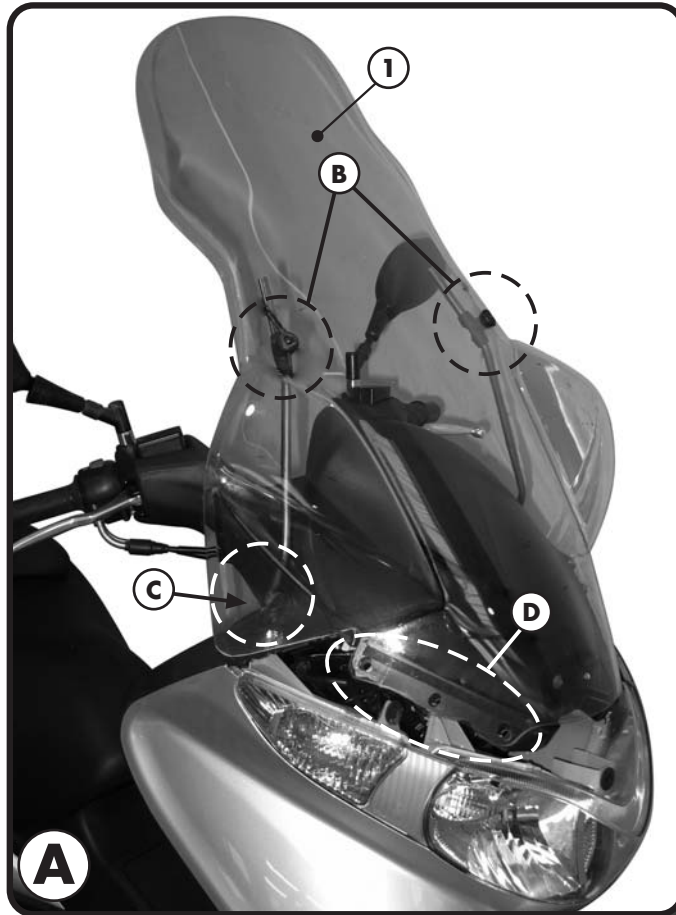
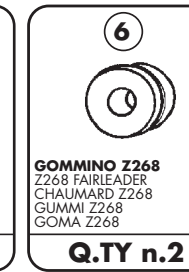
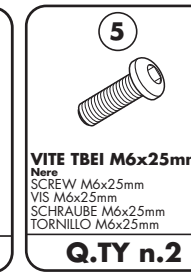
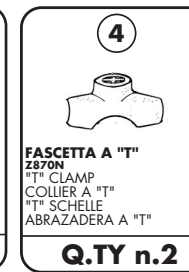
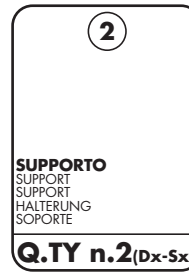
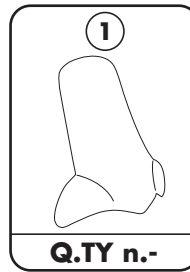

© Copyright 24012007MV-Rev00, 1/2

ATTACCHI SPECIFICI PER - SPECIFIC FITTING KIT FOR
KIT DE MONTAGE SPECIFIQUE POUR - SPEZIFISCHER MONTAGEKIT FÜR
ANCLAJE ESPECÍFICO PARA

SUZUKI BURGMAN K7 2006

125/200cc

ISTRUZIONI DI MONTAGGIO - MOUNTING INSTRUCTIONS
INSTRUCTIONS DE MONTAGE - BAUANLEITUNG - INSTRUCCIONES DE MONTAJE

I ISTRUZIONI DI MONTAGGIO

1. SMONTARE IL PARABREZZA ORIGINALE; POSIZIONARE IL PARABREZZA N°1 (NON INCLUSO) COME INDICATO IN FOTOGRAFIA A; PER IL FISSAGGIO FAR RIFERIMENTO ALLE FOTOGRAFIE B, C E D;
3. ULTIMARE IL MONTAGGIO CONTROLLANDO CHE TUTTE LE VITI SIANO SERRATE BENE.

GB MOUNTING INSTRUCTIONS

1. REMOVE THE ORIGINAL WINDSCREEN;
2. PLACE THE WINDSCREEN N° 1 (NOT INCLUDED) AS SHOWN IN PICTURE A; FOLLOW THE PROCEDURE INDICATED IN THE PICTURES B, C AND D;
3. LASTLY CHECK THAT ALL SCREWS HAVE BEEN TIGHTENED.

F INSTRUCTIONS DE MONTAGE

1. DEMONTER LE PARE-BRISE D'ORIGINE;
2. POSITIONNER LE PARE-BRISE N.1 (NON INCLUS) COMME INDIQUE EN PHOTO A; POUR LA FIXATION SE REFERER AUX PHOTOS B, C ET D;
3. TERMINER LE MONTAGÉ EN CONTROLANT LE BON SERRAGE DE TOUTES LES VIS.

D BAUANLEITUNG

1. MONTIEREN SIE DAS ORIGINAL WINDSCHILD AB;
2. POSITIONIEREN DIE DAS WINDSCHILD NR. 1 (NICHT VORHANDEN) WIE IM BILD A BESCHRIEBEN; FÜR DIE BEFESTIGUNG NEHMEN SIE AUF DIE BILDER B, C UND D BEZUG;
3. ZULETZT ÜBERPRÜFEN SIE, DASS ALLE SCHRAUBEN FESTGEZOGEN WURDEN.

ES

INSTRUCCIONES DE MONTAJE

1. DESMONTAR EL PARABRISAS ORIGINAL
2. POSICIONAR LA CÚPULA (NO INCLUDA) COMO INDICADO EN LA FOTO A; PARA EL ANCLAJE HACER REFERENCIAS A LAS FOTOGRAFÍAS B, C Y D
3. TERMINAR EL MONTAJE COMPROBANDO QUE TODOS LOS TORNILLOS ESTÉN BIEN APRETADOS.