

# WARRE HIVE

## ASSEMBLY GUIDE

**OUTER ROOF**  
w/ quilt box underneath

**BOXES**  
w/ top bars (small canvas between)

**FLOOR BOARD**  
w/ feet



### FINISHES

**Natural Finishes** optional  
Tung oil can be liberally applied to all outside cedar surfaces of your hive as a natural sealer. The wood will retain a nice shine and resilience. For the best results, we recommend sealing your hive prior to any outdoor exposure. Never seal the interior of the hive.

**NOTE:** We encourage you to treat the entirety of the outside of your hive with chemical-free tung oil.

### OUR HIVES

**Did you know?**  
All three of our hives (Warre, Top Bar, and Langstroth) are precision-milled in Portland, Oregon from Western Red Cedar.

### TOOLS

**Tools Needed** 2 total  
Drill or Screwdriver w/ Phillips head  
Hammer for frame assembly only



**Additional Equipage**  
Recommendations for Roof Part 2 where you will need additional equipage to adhere the large canvas to the quilt box.  
Tacks, staples, small nails, or corner metal brackets.



### ADDITIONAL INFO

**Assembly Questions?**  
Customer service is available daily by email [info@beethinking.com](mailto:info@beethinking.com) or phone (877) 325-2221.



**beethinking**  
BEEKEEPING SIMPLIFIED

### TIME

**Estimated Hive Assemble Time**  
1 - 2 hrs

# ROOF PART 1 - STEP 1

PARTS & HARDWARE

- a** Ridge Cap  
18" x 11/2"
- b** Precision Milled Shingles (4)  
18" x 5 5/8"  
OR (depending on your order)  
Copper Roof Panels (2)  
18" x 9"
- c** Peaked Roof Ends (2)  
16" x 7 13/16"
- d** Roof Side Rails (2)  
14 3/8" x 4 1/16"
- e** Roof Insert  
14 3/4" x 14 1/2"
- f** Screws (18)

EXPLODED VIEW

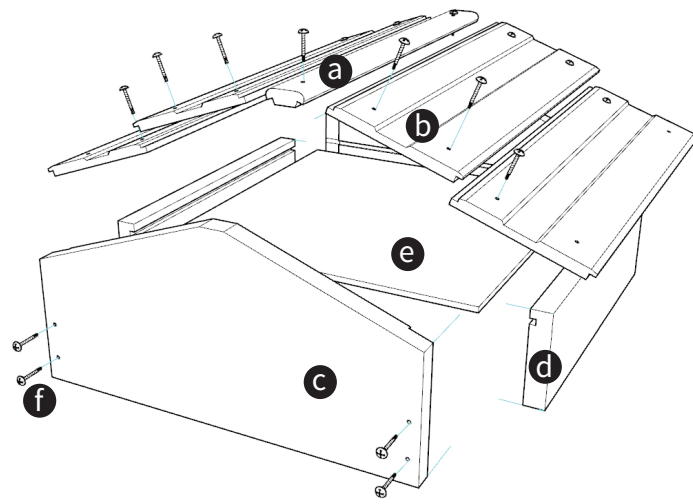

ROOF ASSEMBLY

**1.** Attach the two roof side rails to one peaked roof end. Make sure the grooves on all three pieces are aligned. Use a screwdriver or a hand drill to screw the pieces into place.

**2.** Slide roof insert into the grooves. Note: the insert is a rectangle, and it will only fit when the short-end is slid into place first.

**3.** Attach the second peaked roof end to the other ends of the roof side rails. (The roof insert should fit neatly into this peaked roof end's groove as well.) Use a screwdriver or a hand drill to screw pieces into place.

**4.** Use diagram below to differentiate the two sides on each shingle.

**If you have ordered copper roof panels, skip to step 5.** (Side A has a foot edge and side B has a roof edge.) To ensure that all pieces fit together, attach the ridge cap after the shingles are attached to the roof.

**5.** Attach the top shingles first, which rests under the notch of the ridge cap. Line up one shingle with the flat edge on the top of the peaked roof end. Once this is lined up, attach one shingle at a time with the pre-drilled holes. **If you have ordered copper roof panels, follow the directions of this step and then use the pre drills to attach to the peaked roof ends.**

**6.** Fit the ridge cap on the flat surfaces of the peaked roof ends.

The ridge cap fits neatly in between the top shingles. If there are gaps, realign the shingles to minimize.

**7.** To attach the bottom / lower shingles, slide side A under the roof side of the attached shingles. With a screwdriver or a hand drill, use the pre-drilled holes to attach the last two shingles.

**Note: For wooden shingles, the bottom shingles will have two extra holes, therefore, only two screws are needed.**

**8.** We always recommend sealing the point of connection between two pieces of wood with silicone or caulk. This ensures a water-tight seal and additional insulation for bees.

1

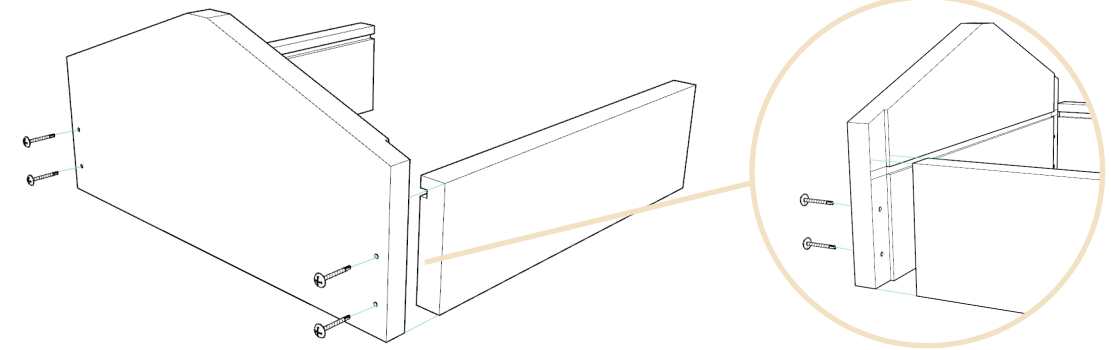

2

Turn the pieces vertically to slide the insert down into grooves if having difficulty

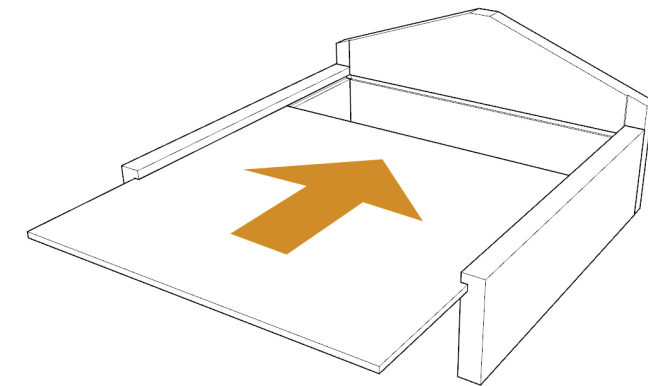

3

Use clamps on either peaked end to hold the pieces together easily

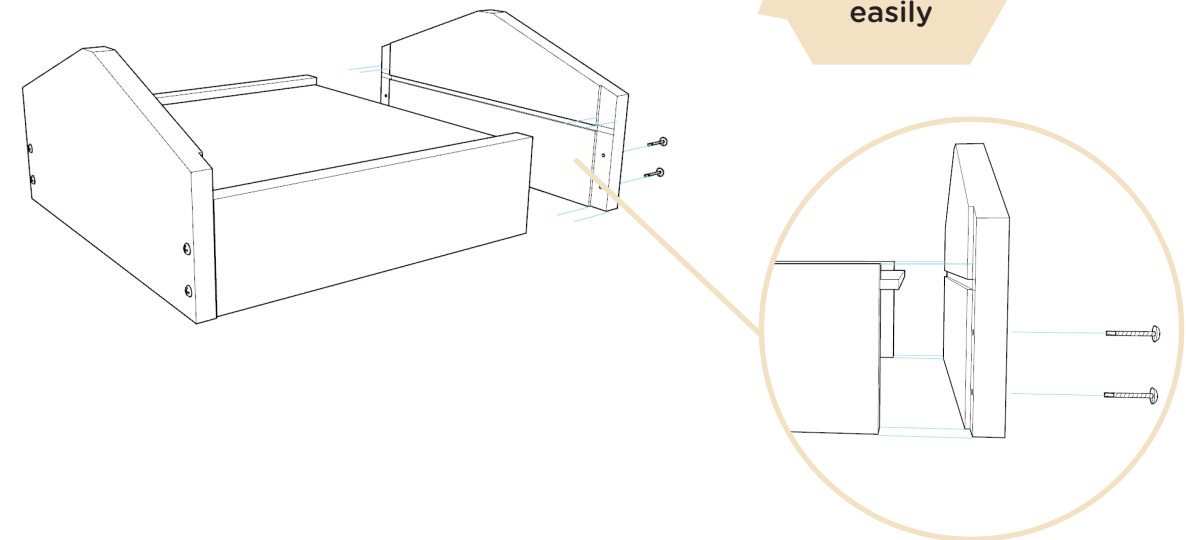

# ROOF PART 1 - STEP 1

4-5

Side A  
foot edge

Side B  
roof edge

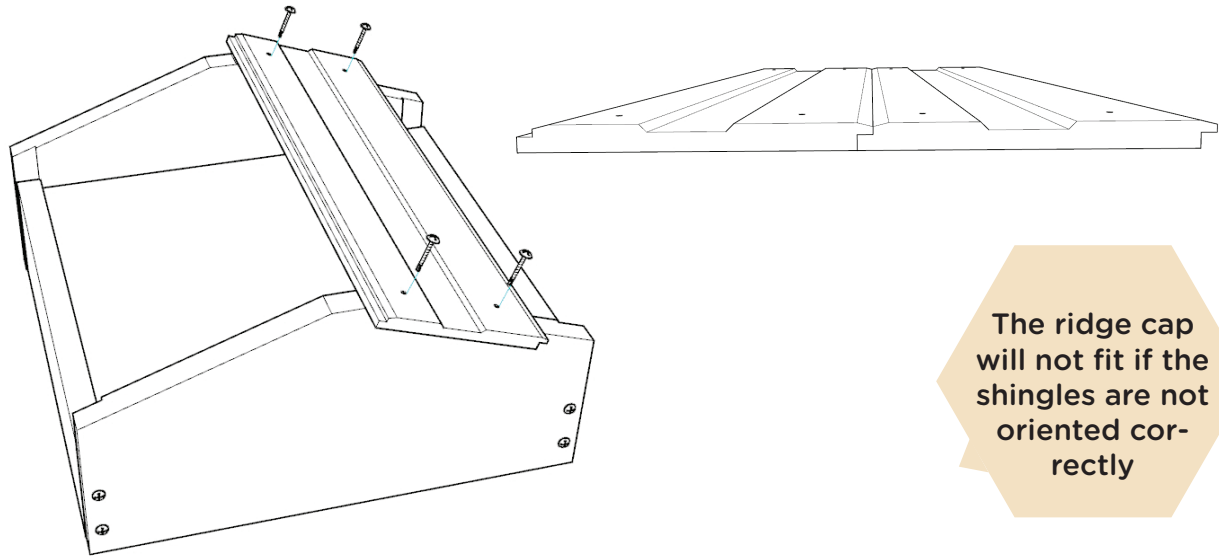

6

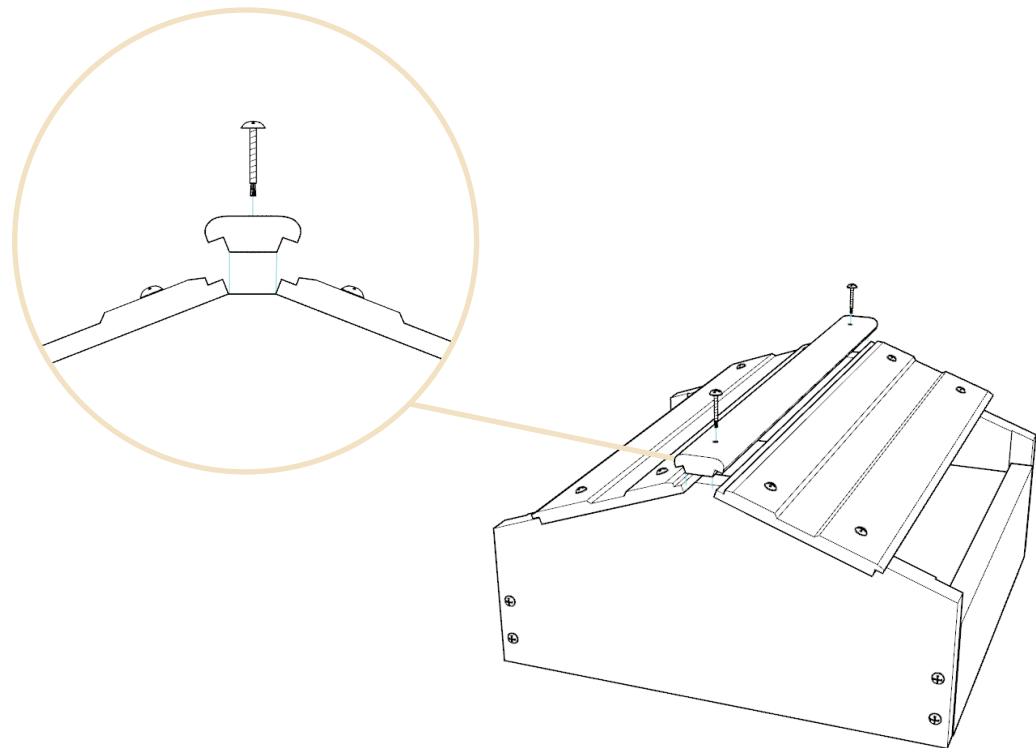

7-8

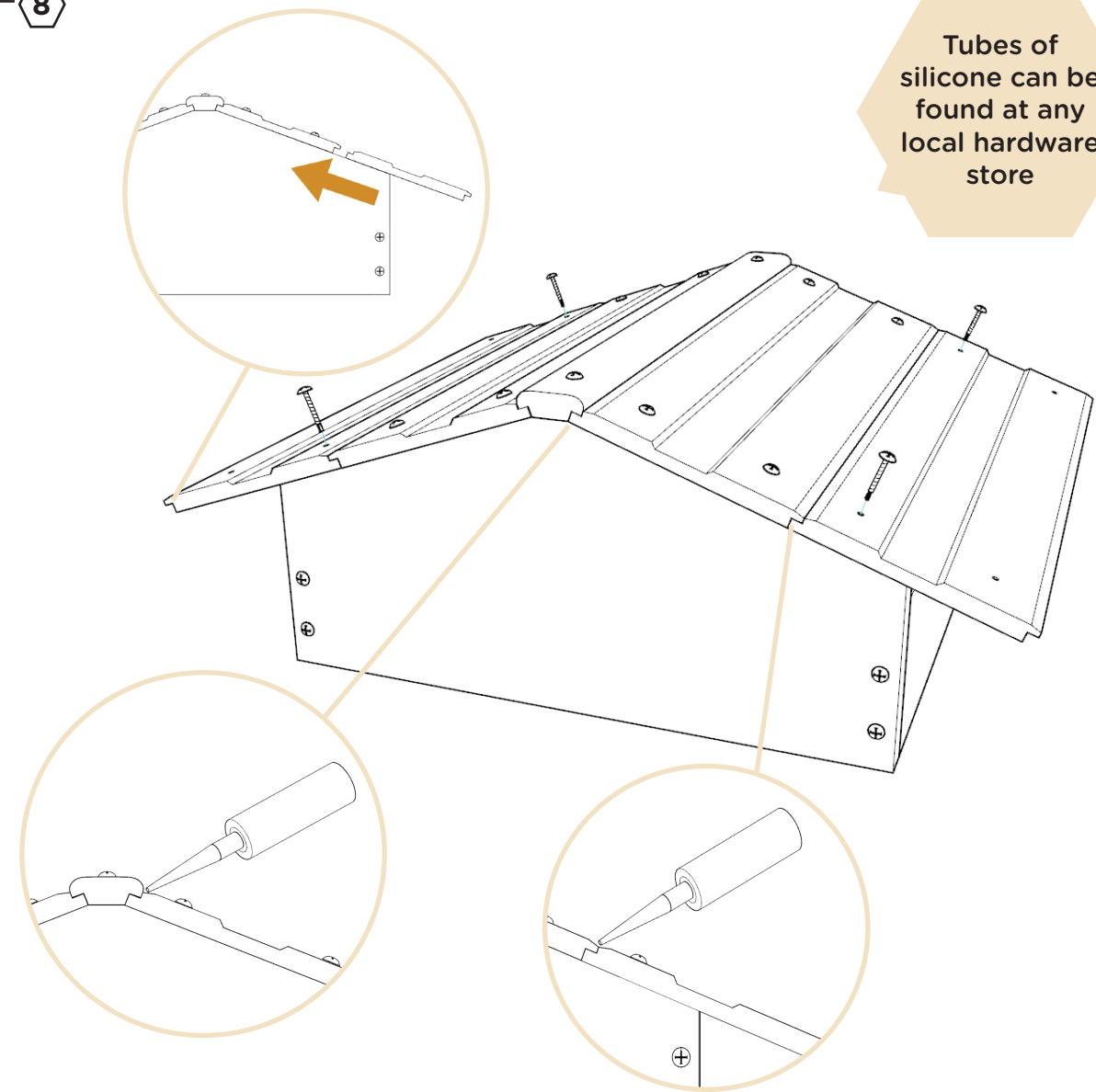

FINISHED PRODUCT

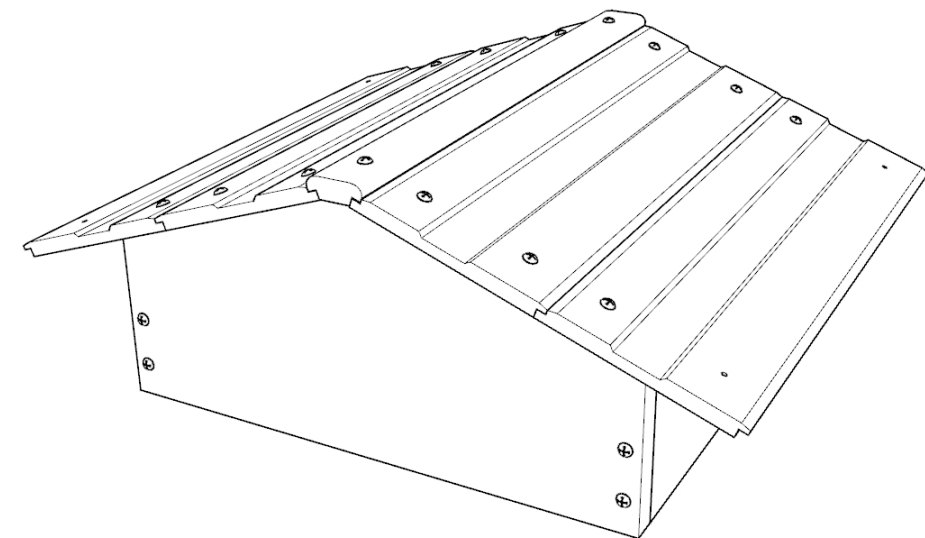

GREAT WORK! CONTINUE TO ROOF PART 2

# ROOF PART 2 - STEP 2

PARTS & HARDWARE

- a** 2 Long Quilt Sides 13 1/2"x 2 1/2"
- b** 2 Short Quilt Sides 12 1/2"x 2 1/2"
- c** 1 Small Canvas 13 3/4"x 13 3/4"
- d** 1 Large Canvas 17 1/4"x 17 1/4"
- e** 1 bag of shredded cedar for quilt box  
(different materials can be used to insulate your quilt box i.e. burlaps, crumbled paper, or dried leaves. It is important to replace your insulation yearly, or as needed)
- f** 8 2" screws
- Not included
- g** Additional equipage to adhere the large canvas (tacks, staples, small nails, or corner metal brackets all work wonderfully)

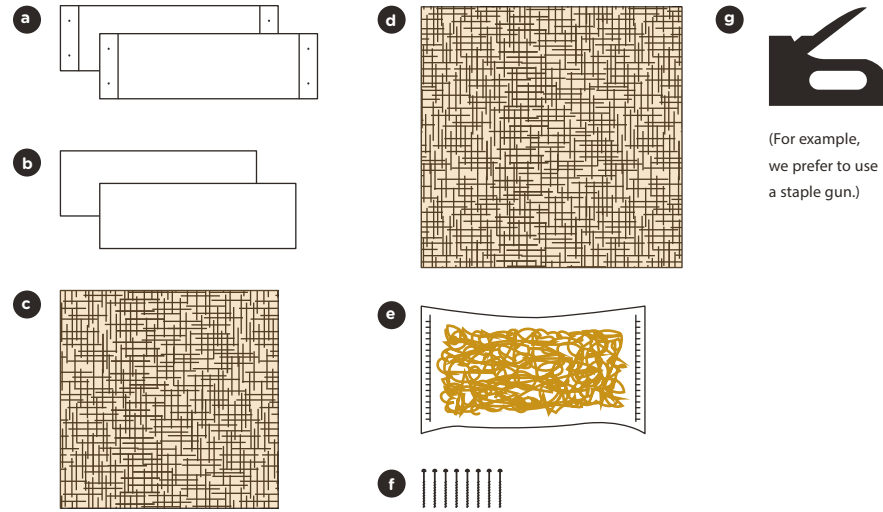

QUILT ASSEMBLY

- Q1.** Screw together 2 long quilt sides to the 2 short quilt sides using 8 screws.  
Note: Matching panels should be across from one another
- Q2.** Lay large canvas piece on flat surface. Center quilt box on top of the canvas.
- Q3.** Pull canvas up the outside of the quilt box
- Q4.** Once completed, fill with wood shavings or some other absorbent, organic material.
- Q5.** Hold on to the small canvas. After you assemble the boxes it will lay freely between the quilt box and the top bars of the top box.

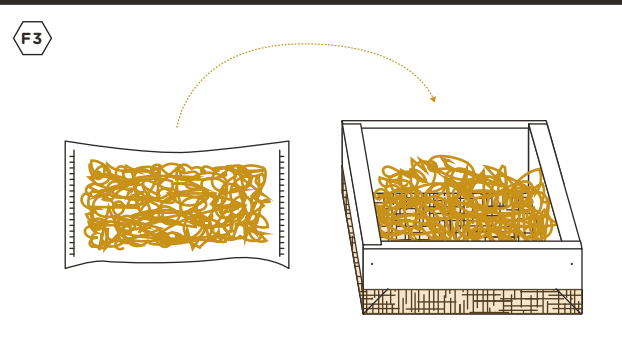
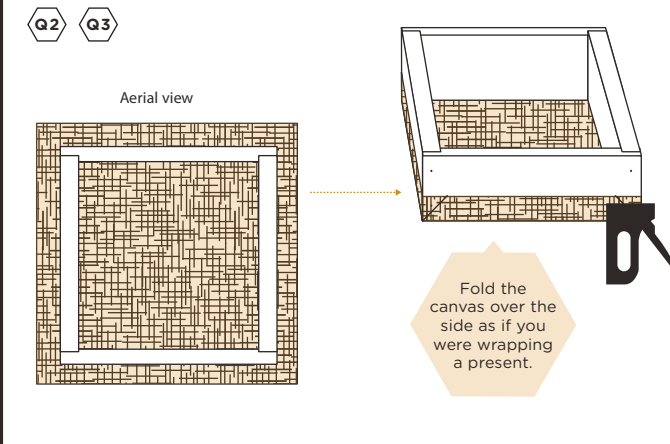
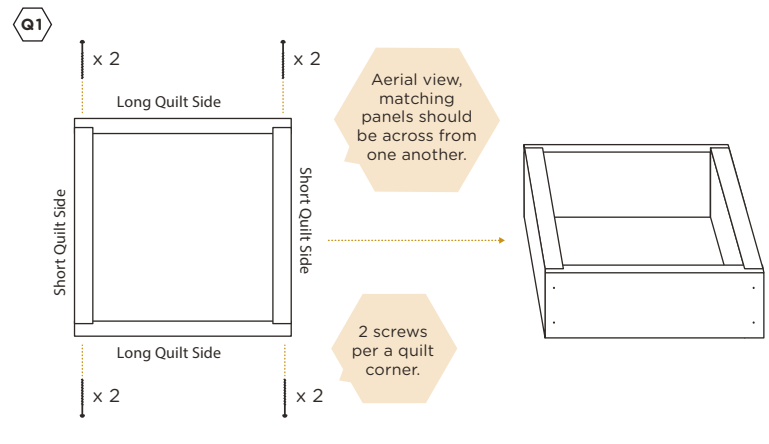

**FUN FACTS:**  
More than 75% of the world's flowering plant species need pollinators to survive.

For thousands of years humans have been using honey medicinally.

A single bee can visit upwards of 5,000 flowers a day.

Humans have been keeping bees for honey for over 9,000 years.

Honey is the only food that never spoils.

A honeybee colony is considered a superorganism, i.e. a single organism made up of many smaller creatures.

**NOW YOU ARE READY TO ASSEMBLE THE HIVE WINDOW!**

# WINDOW SIDE - STEP 3

PARTS & HARDWARE

- a** Window Top Rail 13 1/2" x 2 1/4"
- b** Window Bottom Rail 13 1/2" x 2 1/4"
- c** Window Cover 13 1/2" x 4"
- d** Plexi Glass 13 1/2" x 4"
- e** Self-Tapping Screws (6)
- f** Walnut Latches (2) 1 1/4" x 1 1/4"
- g** Spring Insert Screws (2)
- h** Springs (2)

EXPLODED VIEW

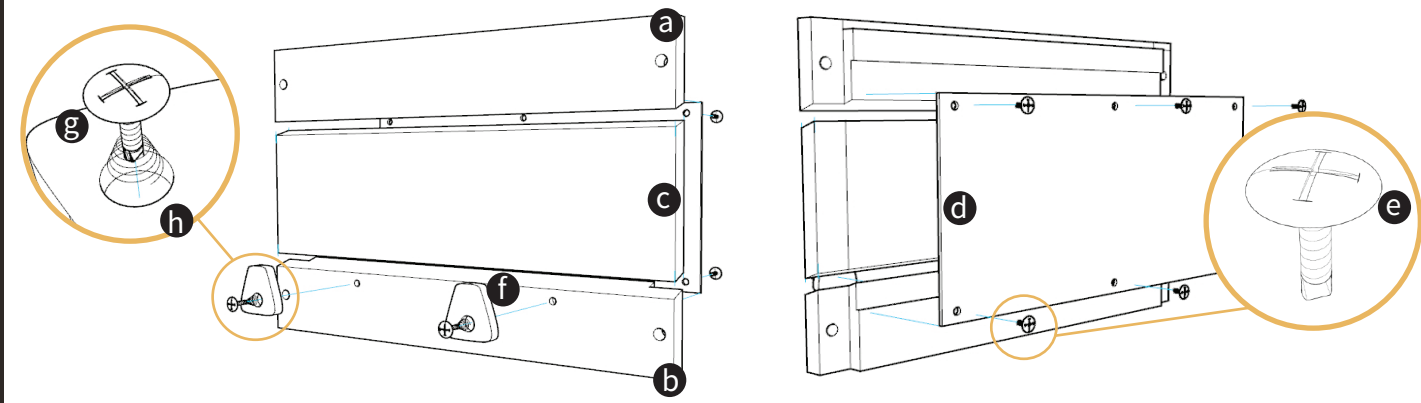

WINDOW SIDE ASSEMBLY

- 1.** Lay pieces A and B, the Window Top Rail and Window Bottom Rail, face down, grooved side up. (Note: Both pieces A and B has a shelf to hold the plexi glass. To differentiate these pieces, notice piece A has an additional shelf on the top, where comb frames will rest in the hive. Piece B has pre-drilled holes to attach latches.)
- 2.** Lay piece D, the plexi glass, down into the shelf of piece A and B. Line up the edges so there is a 1/16" gap between them. (this allows for wood expansion)
- 3.** Using a drill or a screwdriver, screw the 6 Self-Tapping Screws into the pre-drilled holes in the plexi glass. Tip: Instead of screwing one screw in at a time, place all 6 screws in a pre-drilled hole first, allowing the plexi glass to stay in place. Then screw each in.
- 4.** Once these pieces are assembled, flip the window over and slide piece C, the Window Cover, in place. There should be no gaps between any of these pieces to ensure privacy for the bees.
- 5.** Locate the pre-drilled holes for the Walnut Latches on piece B. Insert the Springs into the hole on the Walnut Latches, then insert the Spring Insert Screws into the Springs, and screw them into place on piece B. Note: If these latches are difficult to turn once attached, loosen screws gently by a couple of turns until they move easily.

# WINDOW - STEP 3

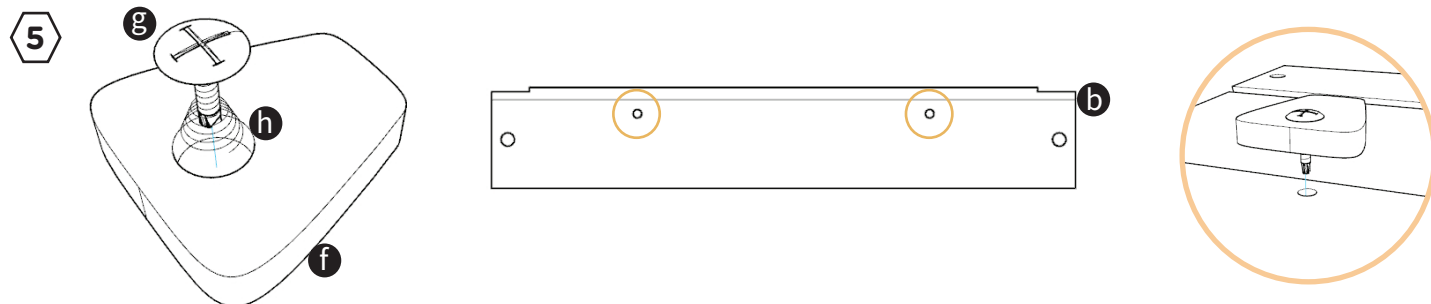
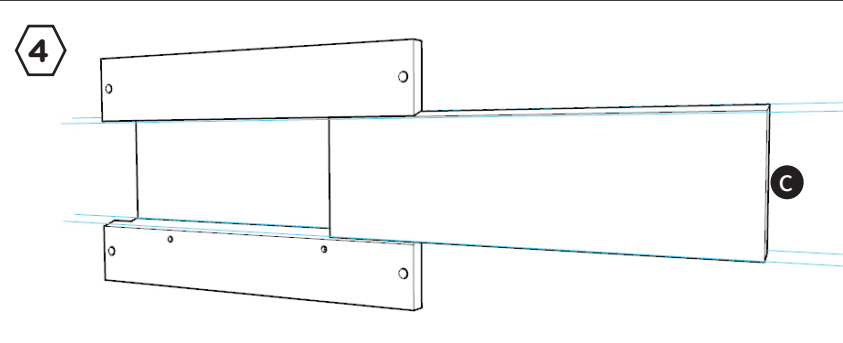
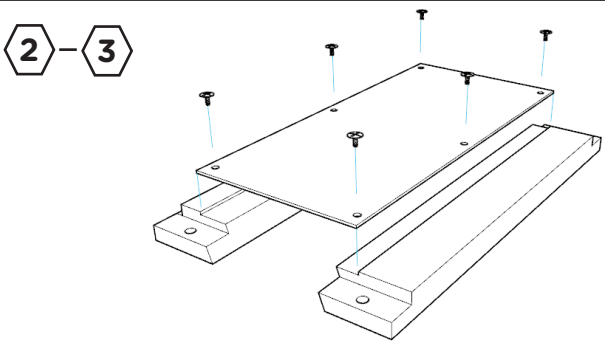
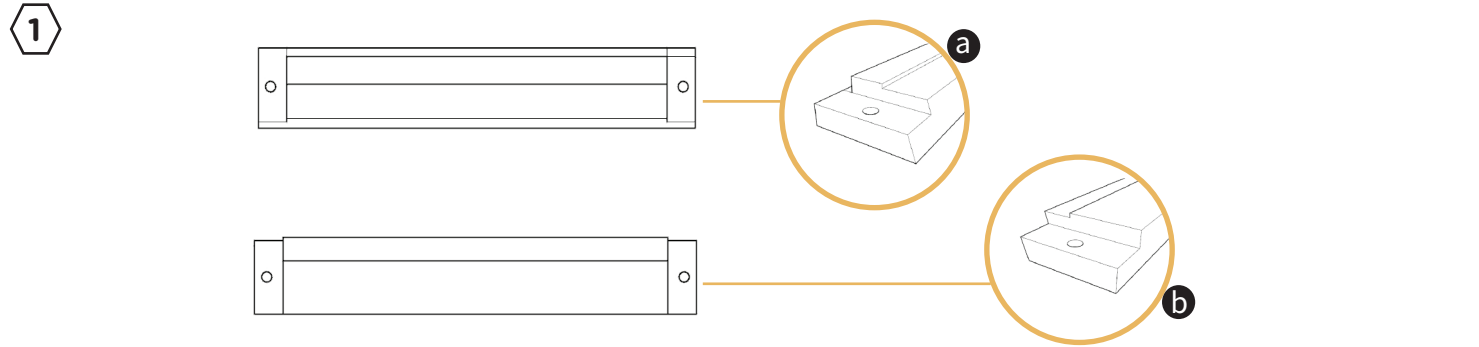

FINISHED PRODUCT

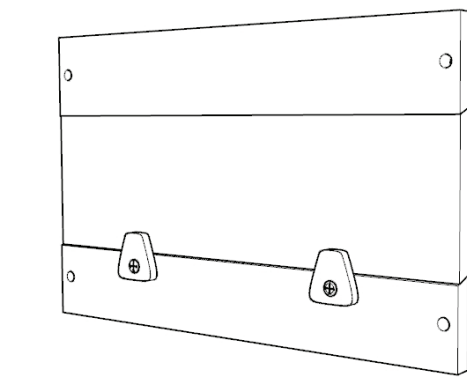

Front View

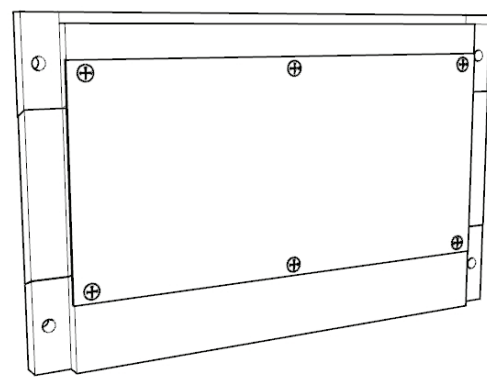

Back View

GREAT JOB! NOW YOU ARE READY TO ASSEMBLE THE REST OF YOUR HIVE

# THE REST - STEP 4

PARTS & HARDWARE

- Boxes**
- a** 2 Long Box Ends 13 1/2"x8 1/4"
  - b** 2 Windows Sides 13 1/2"x8 1/4"  
Reference Window Side Assembly prior to this step.
  - c** 4 Short Box Sides 12 1/2"x8 1/4"
  - d** 4 Handles 12 1/4"x2"
  - e** 10-12 2" screws  
(depending if you ordered window box panels or not. Window boxes require 10 screws and windowless boxes require 12 screws.)
  - f** 16 Top Bars 12 1/2" x 1"
- Stand**
- g** 1 Floor w/ screened bottom 15 1/2" x 13 1/2"  
& Floor insert 12" x 13 1/2"
  - h** 2 feet 17 1/2" x 2 1/4"  
4 3" Screws

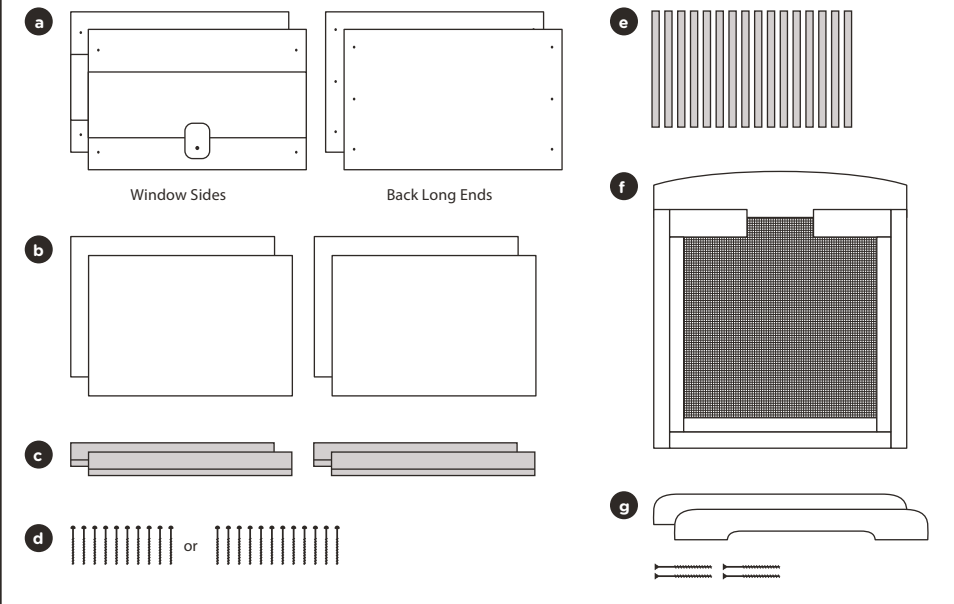

ASSEMBLY

- B1.** (Please reference the Window Assembly instructions before the next steps)  
Screw together 1 window side and 1 long box ends to 2 short box sides using 12 screws. Do this for both boxes.
- B2.** Attach 1 handle centered to the outside of each short box side using 2 screws each. Make sure that they slope downward away from the top of the box
- B3.** Evenly space 8 top bars into each box.  
(the top has the notch cut out on each long box side).
- S1.** Place screened floor on top of feet and then attach feet using 2 3" long screws on each side through the pre-drilled holes in the floor. From the bottom.
- S2.** Now stack the hive parts in this order:
- Floor Board (w/ or w/out feet)
  - 2 Boxes w/ the Top Bars inside  
(we recommend facing your window sides opposite of your entrance to not interfere with your bees flight path)
  - Small Canvas
  - Quilt box w/ insulation
  - Outer Roof/Telescoping Roof

