



E-CUTTER

CB03II-2516-RM

Evolutionary digital cutting system



01/ Medium production intensity
Entry level & affordable digital cutting system

02/ Synchronous belt
High efficient transmission system
Min. 5mm diameter cutting ability, max. 1500mm/s speed.

03/ M5
Jwei self-developed M5 motion controller

04/ Servo system
6 servo drive system

05/ Versatility
Diverse cutting tools for corresponding flexible materials.



Find us on Wechat

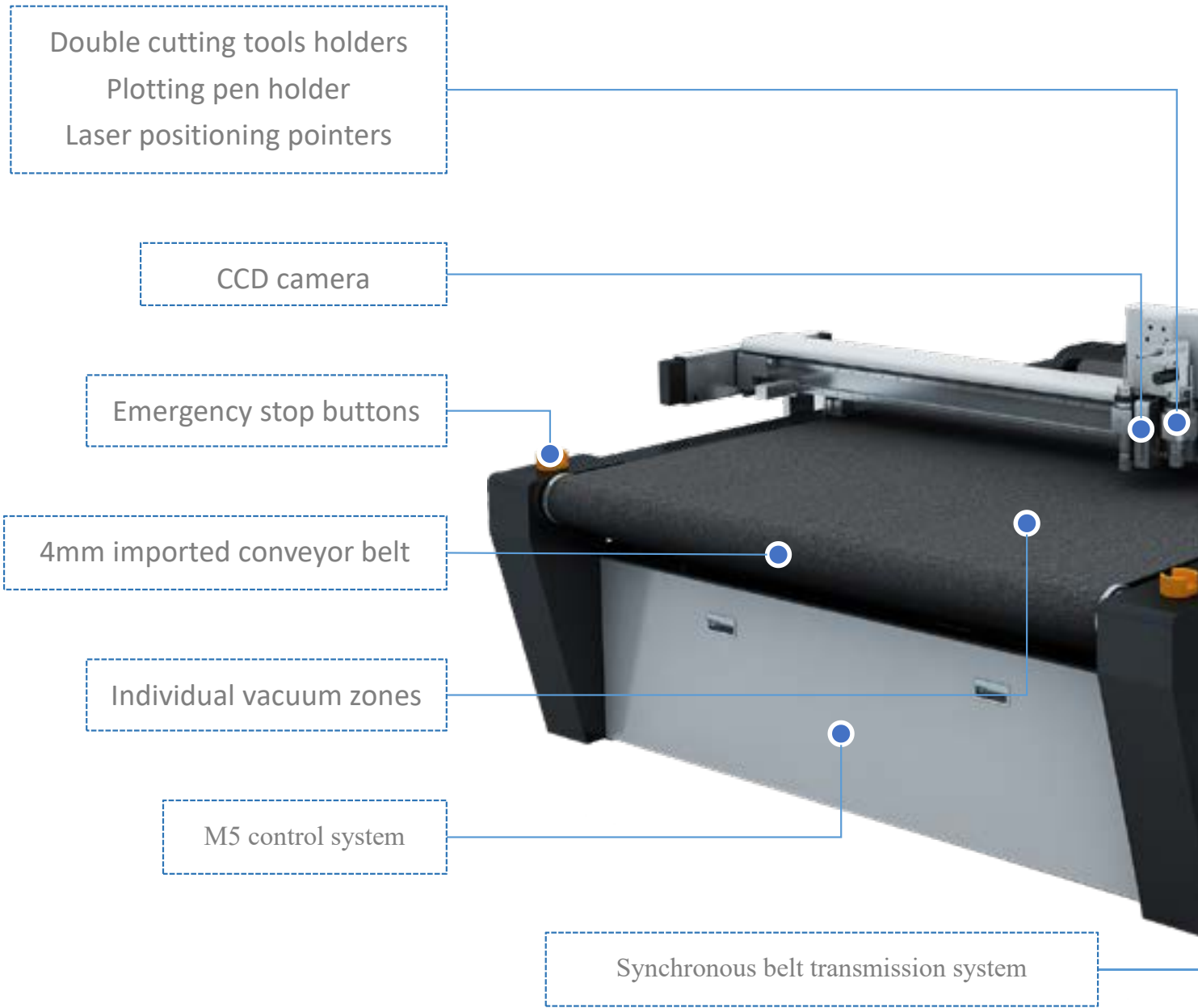

Compatible with:

Officially support by:



E-Cutter

www.jweicut.com

03II-2516-RM

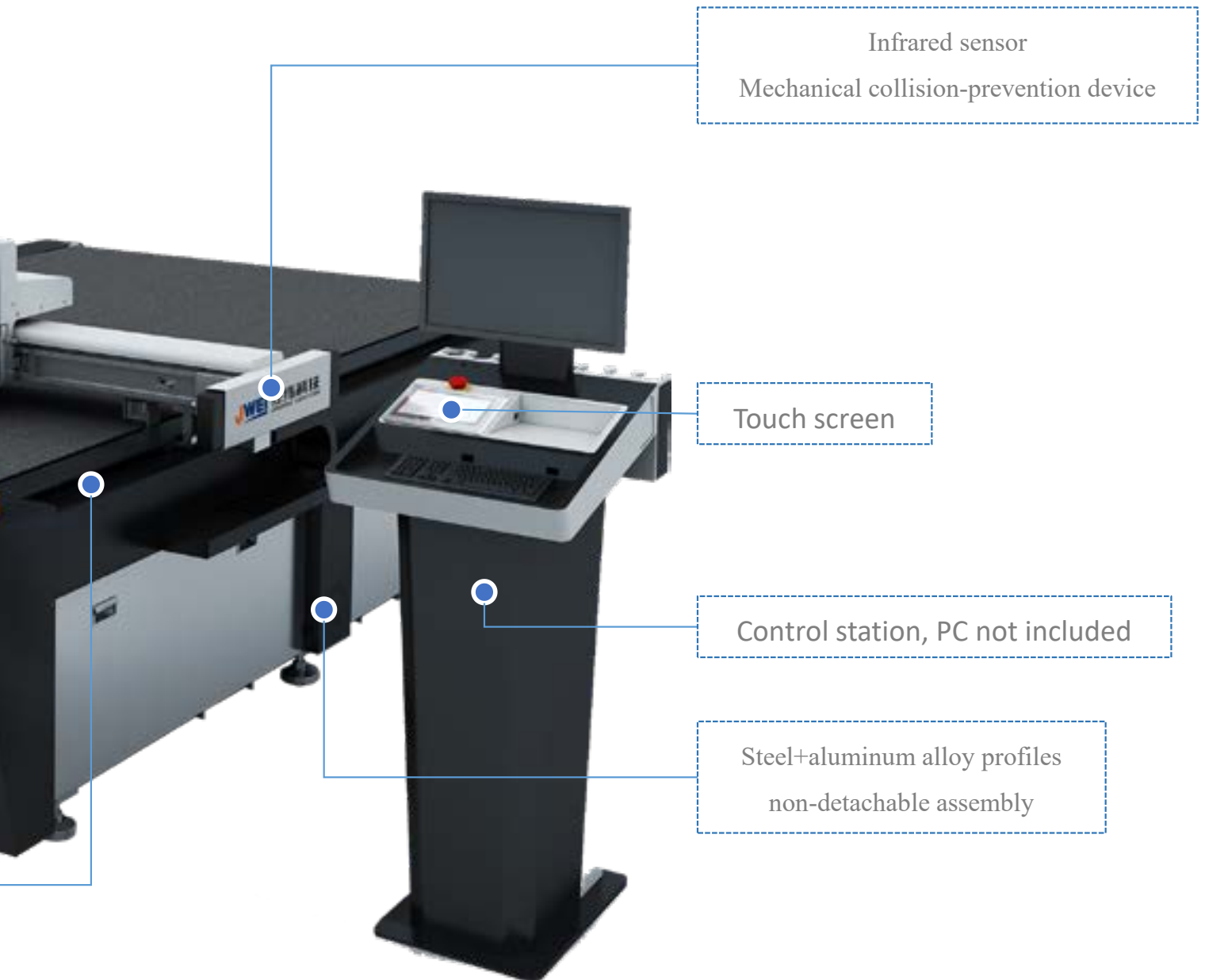

soft

Included:



Air compressor



Vacuum pump

Applications



Signage



POP/POS



Corrugated packaging



Home decoration



Textile



Automotive



Floor mat



Road sign

Parameters

Model	CB03II-1113	CB03II-1816-RM	CB03II-2513-RM	CB03II-2516-RM
Effective Cutting Area.	1100x1300mm	1800x1600mm	2500x1300mm	2500x1600mm
Cutting Module	Double universal tools cutting head Camera registration tool Laser positioning pointers Plotting pen holder			
Tools Compatibility	Compatible with all Jwei tools except 1800W router tool			
Max. Moving Speed	1500mm/s			
Max. Cutting Speed	1200mm/s			
Acceleration	1G			
Max. Cutting Thickness	50mm			
Repeat Precision	±0.1mm			
Safety Device	Infrared sensor, mechanical collision-prevention device			
Material Fixing Method	Energy-efficient 6 individual vacuum zones			
Transmission System	Synchronous belt			
Servo System	6 axis servo drive system			
Control System	Jwei self-developed M5			
Physical Frame	Steel + aluminum alloy profile, Non-detachable assembly			
Interface	Ethernet port			
Software	JWCS, QR Code system included			
File Format	DXF, PLT, PDF, HPGL, XML, CF2, AAMA, NC, EPS			
Rated Power	7.5 KW	9.5 KW	9.5 KW	9.5 KW
Power Supply	AC 3PH 380V ± 10%, 50/60Hz			
Noise Range	<75 dB - 90 dB			
Operating Environment	10-35 °C, 10-80% humidity			
Machine Dimension	2250x2320x1280mm	2945x2617x1280mm	3700x2500x1200mm	3700x2500x1200mm

JWEI reserves the rights of final explanation, no further information for any exchanging.