

WYNDHAM COLLECTION

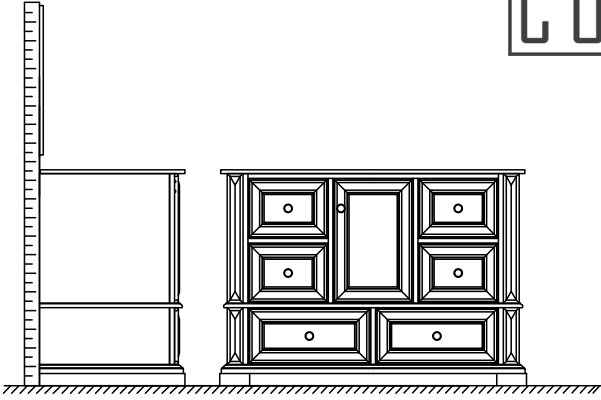

- Prior to installation, please check received items against the "Packing List". Please report any missing items to your retailer immediately.
- Protect all surfaces from sharp objects, high heat sources, direct prolonged sunlight and chemical hazards.
- Professional installation recommended.

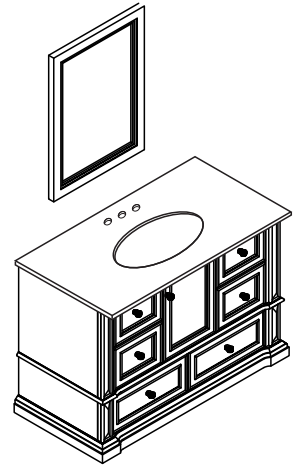

PACKING LIST

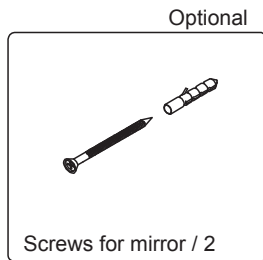
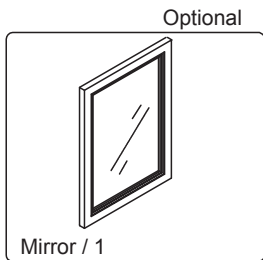
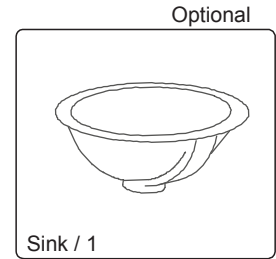
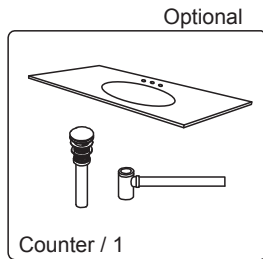
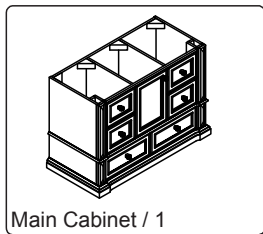

REQUIRED TOOLS NOT IN BOX

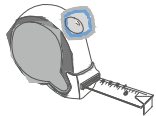

Tape measure

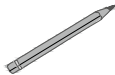

Pencil



Electric Drill

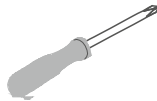

Phillips Screwdriver



Adjustable Wrench

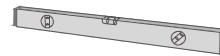

Spirit Level

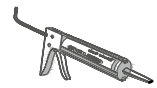

Silicone sealant

ADJUSTMENT OF HINGES (if required)

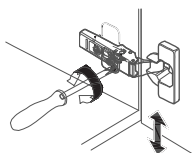

adjust height

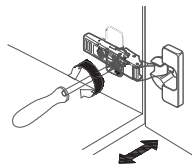

adjust laterally

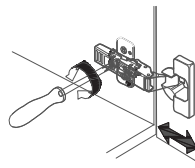

adjust depth

WC-J231-48
INSTALLATION

WYNDHAM COLLECTION

INSTALLATION INSTRUCTIONS

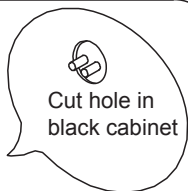
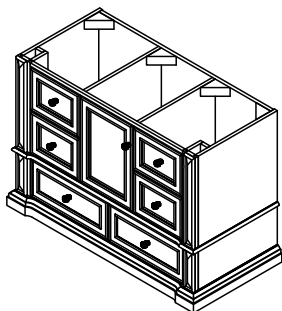

- ① Installer must cut appropriately sized hole in back of cabinet to accommodate existing placement of hot and cold wall valves and drains

②



Apply a continuous bead of quality sealant to the top surface (rim) of the sink.

③

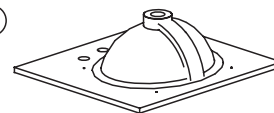

Turn the stone top upside down and place it on a clean, surface. Center the sink over the cutout.

④

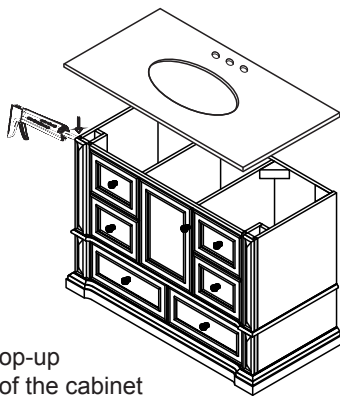
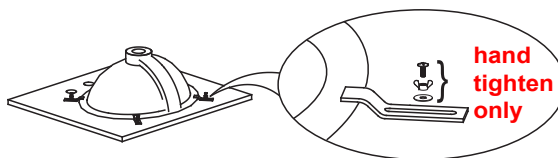

- ⑤ Install the counter and pop-up drain. Seal around the top of the cabinet with clear or white silicone sealant.

⑥

Attach mirror brackets to wall with supplied screws. Hang mirrors.

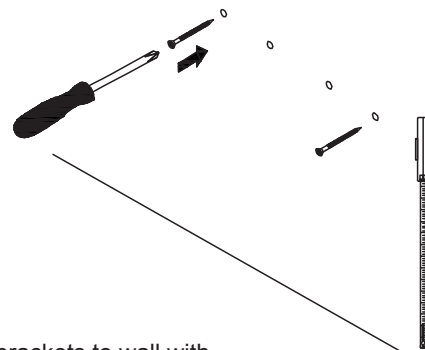

WC-J231-48
INSTALLATION