

Parani
MOTORCYCLE BLUETOOTH®



M10
Motorcycle INTERCOM

by **SENA**

1.3.0

USER'S GUIDE

ENGLISH

PRODUCT FEATURES

GETTING STARTED

Blast your favorite tunes, talk over the intercom with your buddies, hear directions from your GPS and more, all through your M10 Bluetooth® headset. With built-in Bluetooth® capabilities, HD Intercom, technology has never felt so minimal or freeing.



Bluetooth® Integrated



Intercom up to 1 km (0.6 mi)*



Four-way Intercom



LCD Display



Versatile Jog Dial



Firmware Upgradeable

*in open terrain

Update this product for free with the latest firmware to fully enjoy the new advanced features built into this product. Visit parani.com to see how to update your product.

Parani parani.com

TABLE OF CONTENTS

| | | | | | |
|------------|---|-----------|--|--|-----------|
| 1 | BEFORE STARTING | 5 | 3.3 | Charging the Headset | 11 |
| 1.1 | Package Contents | 5 | 3.4 | Powering On and Off | 12 |
| | 1.1.1 Wired Boom Microphone Type | 5 | 3.5 | Adjusting the Volume | 13 |
| | 1.1.2 Wired Microphone Type | 6 | 3.6 | Downloadable Parani Software | 13 |
| 2 | INSTALLING THE HEADSET ON YOUR HELMET | 7 | 3.6.1 Parani Device Manager | | 13 |
| 2.1 | Using the Clamp | 7 | 4 | PAIRING YOUR HEADSET WITH OTHER BLUETOOTH DEVICES | 13 |
| 2.2 | Using the Glued Surface Mounting Adapter | 7 | 4.1 | Phone Pairing | 14 |
| 2.3 | Installing the Speakers | 8 | 4.1.1 Initially Pairing the M10 | | 14 |
| | 2.3.1 Wired Boom Microphone Type | 8 | 4.1.2 Pairing When the M10 is Turned Off | | 15 |
| | 2.3.2 Wired Microphone Type | 9 | 4.1.3 Pairing When the M10 is Turned On | | 15 |
| 3 | GETTING STARTED | 11 | 4.2 | Second Mobile Phone Pairing | 16 |
| 3.1 | Button | 11 | 5 | MOBILE PHONE USAGE | 16 |
| 3.2 | LCD Display | 11 | 5.1 | Using Phone Functions | 16 |

| | | | | | |
|------------|------------------------------|-----------|------------|--------------------------------|-----------|
| 5.2 | Speed Dialing | 17 | 8 | GENERAL SETTINGS | 25 |
| 5.2.1 | Assigning Speed Dial Presets | 17 | 8.1 | Function Priority | 25 |
| 5.2.2 | Using Speed Dial Presets | 17 | 8.2 | Configuration Menu | 25 |
| 6 | STEREO MUSIC | 18 | 8.2.1 | Assigning Speed Dial | 27 |
| 7 | BLUETOOTH INTERCOM | 19 | 8.2.2 | Voice Prompt (Default: Enable) | 28 |
| 7.1 | Intercom Pairing | 19 | 8.2.3 | Delete All Pairings | 28 |
| 7.2 | Two-way Intercom | 20 | 8.3 | Firmware Upgrades | 28 |
| 7.2.1 | HD Intercom | 20 | 9 | TROUBLESHOOTING | 29 |
| 7.3 | Multi-Way Intercom | 21 | 9.1 | Fault Reset | 29 |
| 7.3.1 | Start Three-way Intercom | 21 | 9.2 | Factory reset | 29 |
| 7.3.2 | End Three-way Intercom | 22 | | | |
| 7.3.3 | Start Four-way Intercom | 23 | | | |
| 7.3.4 | End Four-way Intercom | 24 | | | |

1 BEFORE STARTING

1.1 Package Contents

1.1.1 Wired Boom Microphone Type

- **Headset Main Unit**

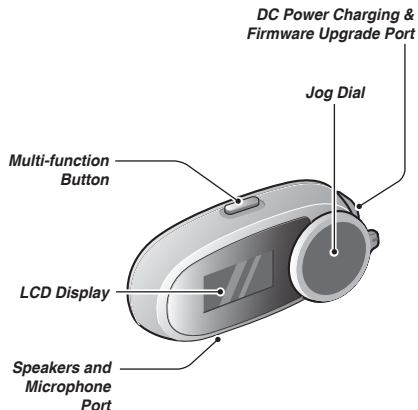

- **Speakers and Wired Boom Microphone**

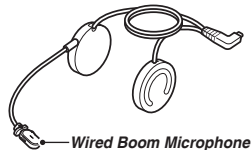

- **Clamp**



- **Glued Surface Mounting Adapter**



- **Speaker Sponge (2)**



- **Microphone Sponge (2)**



- **Hook and Loop Fasteners for Speakers (2)**



- **USB Power & Data Cable (USB-C)**



1.1.2 Wired Microphone Type

• Headset Main Unit

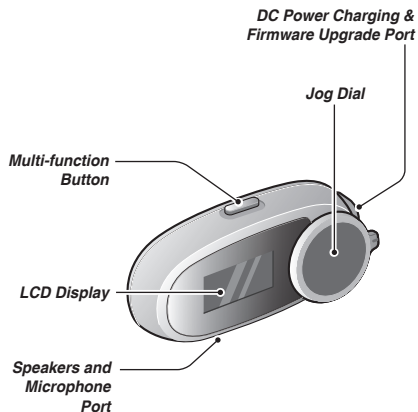

• Speakers and Wired Microphone

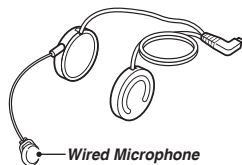

• Clamp



• Glued Surface Mounting Adapter



• Speaker Sponge (2)



• Hook and Loop Fasteners for Speakers (2)



• Hook and Loop Fasteners for Wired Microphone



• USB Power & Data Cable (USB-C)



2 INSTALLING THE HEADSET ON YOUR HELMET

Before installing the headset, you need to choose between the clamp and the glued surface mounting adapter. To install the headset to the helmet, follow the steps below:

2.1 Using the Clamp

1. Insert the main module into the clamp using the two connecting slots on the back.

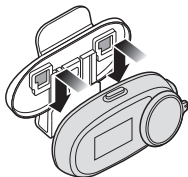

2. Insert the headset into the helmet using the clamp.

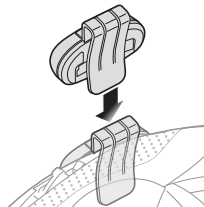

2.2 Using the Glued Surface Mounting Adapter

1. Insert the main module into the glued surface mounting adapter using the two connecting slots on the back.

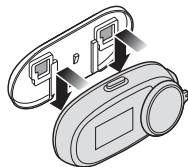

2. Remove the cover of the adhesive sticker on the back to glue the headset on to the helmet.

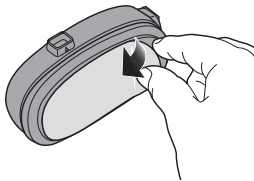

3. Attach the headset on the left side of the helmet.

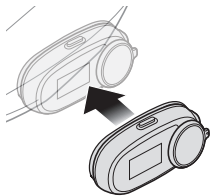

2.3 Installing the Speakers

2.3.1 Wired Boom Microphone Type

If you want to install speakers into the headset, follow the steps below:

1. Remove the cover of the adhesive sticker of the hook and loop fasteners for speakers.
2. Place the sticker on the helmet.

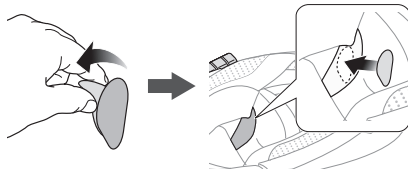

3. Place the speaker on the hook and loop fasteners.

4. Insert the Speakers and Microphone plug into the headset.

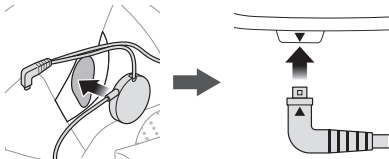

Note:

- If your speakers are too close to your ears and your ears are uncomfortable, you can attach a Speaker Sponge to the front of the speaker.
- Make sure that the microphone is located properly close to your mouth when you wear the helmet. Adjust the direction of the microphone so that the fin side of the microphone is facing outward, away from your lips.



2.3.2 Wired Microphone Type

If you have a full face helmet, you can use the wired microphone.

1. Remove the cover of the adhesive sticker of the hook and loop fasteners for speakers.
2. Place the sticker on the helmet.

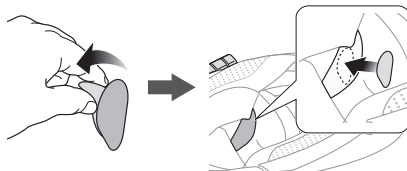

3. Place the speaker on the hook and loop fasteners.

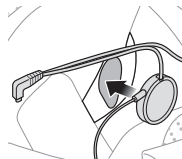

4. Peel off the cover of the hook and loop fastener for wired microphone to expose the adhesive tape. Then, attach the hook and loop fastener on the inside of the helmet's chin guard.

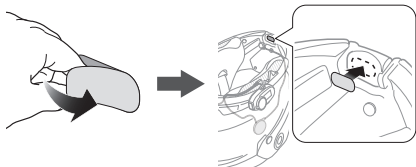

5. Attach the wired microphone to the hook and loop fastener for wired microphone.

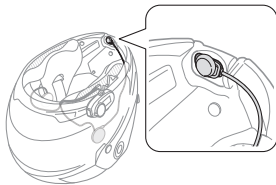

6. Insert the Speakers and Microphone plug into the headset.

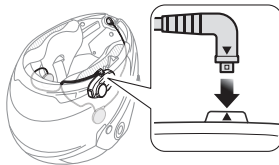

3 GETTING STARTED

3.1 Button

- Jog Dial

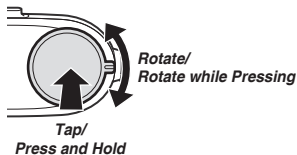

- Multi-function Button

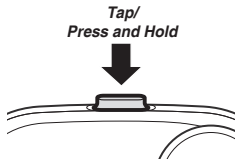

3.2 LCD Display

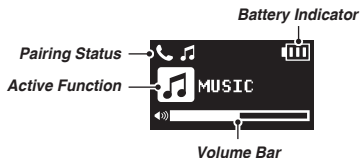

3.3 Charging the Headset

The headset can be charged using many common methods via the supplied USB power & data cable. Depending upon the charging method, the headset will be fully charged in about 2.5 hours.

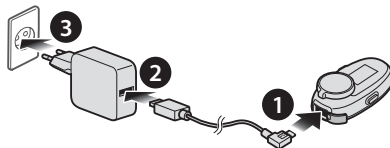

It takes about 2.5 hours to be completely charged.

Charging Status LCD



Charging



Fully Charged

Note:

- Any 3rd party USB charger can be used with Sena products if the charger is approved by either the FCC, CE, IC or other locally approved agencies that Sena accepts.
- The headset is compatible with 5 V input USB-charged devices only.

3.4 Powering On and Off

- To power on the headset, press and hold the **Multi-function Button** and **Jog Dial** for **1 second**.



- To power off the headset, tap the **Multi-function Button** and **Jog Dial**.



3.5 Adjusting the Volume

- To increase, rotate the **Jog Dial** counterclockwise.
- To decrease, rotate the **Jog Dial** clockwise.

3.6 Downloadable Parani Software

3.6.1 Parani Device Manager

The **Parani Device Manager** allows you to upgrade the firmware and configure its settings directly from your PC or Apple computer. For more information on downloading the **Parani Device Manager**, please visit parani.com.

4 PAIRING YOUR HEADSET WITH OTHER BLUETOOTH DEVICES

Before using the headset with other Bluetooth devices for the first time, they will need to be “paired.” This enables them to recognize and communicate with one another whenever they are within range. The headset can pair with multiple Bluetooth devices such as mobile phone, MP3 player, or GPS via Phone Pairing, Second Mobile Phone Pairing. The headset can also be paired with another Parani headset.

4.1 Phone Pairing

There are three ways to pair the phone.

4.1.1 Initially Pairing the M10

The headset will automatically enter the phone pairing mode when you initially turn on the headset or in the following situations:

- Rebooting after executing the **Factory Reset** feature; or
- Rebooting after executing the **Delete All Pairings** feature.

1. Press and hold the **Multi-function Button** and **Jog Dial** for **1 second**. You will hear a voice prompt, “**Phone pairing**”.



2. On your smartphone, search for **Parani M10**.
3. Enter 0000 for the PIN. Some smartphones may not ask for PIN.

Note:

- *The phone pairing mode lasts for **3 minutes**.*
- *To cancel phone pairing, tap the **Jog Dial** or **Multi-function Button**.*

4.1.2 Pairing When the M10 is Turned Off

1. Press and hold the **Multi-function Button** and **Jog Dial** for **5 seconds** until you hear a voice prompt, “**Phone pairing**” when the headset is turned off.



2. On your smartphone, search for **Parani M10**.
3. Enter 0000 for the PIN. Some smartphones may not ask for PIN.

4.1.3 Pairing When the M10 is Turned On

1. Press and hold the **Multi-function Button** for **5 seconds** until you hear a voice prompt, “**Phone pairing**” when the headset is turned on.



2. On your smartphone, search for **Parani M10**.
3. Enter 0000 for the PIN. Some smartphones may not ask for PIN.

4.2 Second Mobile Phone Pairing

1. Execute **Phone Pairing** and press and hold the **Multi-function Button** for **5 seconds**.
2. Tap the **Multi-function Button** until you hear a voice prompt, “**Second mobile phone pairing**”.



3. On your smartphone, search for **Parani M10**.
4. Enter 0000 for the PIN. Some smartphones may not ask for the PIN.

5 MOBILE PHONE USAGE

5.1 Using Phone Functions

- To answer/end the call, tap the **Multi-function Button** or **Jog Dial**.
- To reject an incoming call, press and hold the **Jog Dial** for **2 seconds**.
- To make a call with voice dialer, press and hold the **Multi-function Button** for **3 seconds**.



Incoming Call



Make a Call



Make a Call with Voice Dialer



Conversation

5.2 Speed Dialing

5.2.1 Assigning Speed Dial Presets

You need to assign speed dial numbers before using the speed dial. Speed Dial Presets could be assigned in the configuration menu.

5.2.2 Using Speed Dial Presets

1. Press and hold the **Jog Dial** for **3 seconds**.



2. Rotate the **Jog Dial** to navigate between the menus. You will hear voice prompts for each menu item.



Last Number
Redial



Speed Dial 1



Speed Dial 2



Speed Dial 3



Cancel

3. To redial the last number called, tap the **Multi-function Button** when you hear a voice prompt, “**Last number redial**”.
4. To call one of the speed dials, tap the **Multi-function Button** when you hear a voice prompt, “**Speed Dial (#)**”.
5. If you want to exit the speed dial immediately, rotate the **Jog Dial** until you hear a voice prompt, “**Canceled**”, and tap the **Multi-function Button**.

6 STEREO MUSIC

- To start/pause music, press and hold the **Jog Dial** for **1 second**.
- To track forward, rotate while pressing the **Jog Dial** **counterclockwise**.
- To track back, rotate while pressing the **Jog Dial** **clockwise**.



7 BLUETOOTH INTERCOM

7.1 Intercom Pairing

The headset can be paired with up to three other **Parani** headsets for Bluetooth intercom conversation.

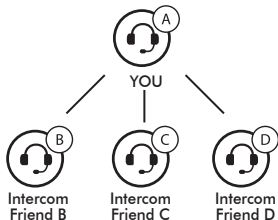

1. Turn on the two headsets (A and B) that you would like to pair with each other.

2. Press and hold the **Jog Dial** for **5 seconds**, then you will hear a voice prompt, “**Intercom pairing**”.



3. Simply tap the **Jog Dial** on any one of the two headsets A and B and intercom connection is automatically established.
4. You can make other pairings between headsets A and C, and between headsets A and D by following the same procedure as above.
5. The intercom pairing queue is ‘**Last-Come, First-Served**’. If a headset has multiple paired headsets for intercom conversations, the last paired headset is set as **first intercom friend**. The previous intercom friend becomes **second intercom friend**, and **third intercom friend**.

7.2 Two-way Intercom

You can start/end an intercom conversation with one of any intercom friends by tapping the **Jog Dial**.



- **Starting Two-way Intercom:**

To start an intercom connection with the **first intercom friend**, tap the **Jog Dial**, and to make a connection with a **second intercom friend**, double tap the **Jog Dial**. For the **third intercom friend**, triple tap the **Jog Dial**.

- **Ending Two-way Intercom:**

To end the intercom conversation, tap the **Jog Dial**.

7.2.1 HD Intercom

HD Intercom enhances the two-way intercom audio from normal quality to HD quality. When you enter into a **Multi-Way Intercom**, **HD Intercom** will be automatically disabled. If this feature is disabled, the intercom audio will change to normal quality.

*Note: **HD intercom** is only active for two-way intercom.*

7.3 Multi-Way Intercom

Multi-Way Intercom enables conference-call-style conversations with up to **three intercom friends** at the same time. While **Multi-Way Intercom** is in progress, mobile phone connection is temporarily disconnected. However, as soon as **Multi-Way Intercom** terminates, the mobile phone connection will be reestablished.



7.3.1 Start Three-way Intercom

You (A) can have a three-way conference intercom with two other intercom friends (B & C) by establishing two intercom connections at the same time.

1. You (A) need to be paired with two other friends (B & C) for three-way conference intercom.

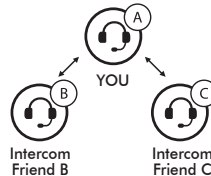

2. Start an intercom conversation with one of the two friends in your intercom group. For example, you (A) may start an intercom conversation with intercom friend (B). Or intercom friend (B) may start an intercom call with you (A).

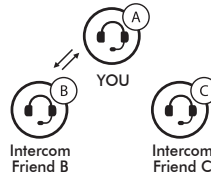

- The second intercom friend (C) may join the intercom by making an intercom call to you (A).

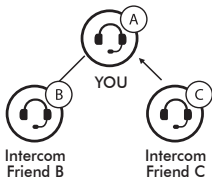

- Now you (A) and two intercom friends (B & C) are having a three-way conference intercom.

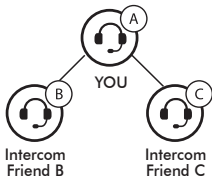

7.3.2 End Three-way Intercom

When you are a member of an active three-way conference intercom, you can completely terminate the conference intercom or just disconnect an intercom connection with one of your active intercom friends.

- Press and hold the **Jog Dial** for **1 second** until you hear a beep to terminate three-way conference intercom completely. It terminates both intercom connections with (B) and (C).
- Tap or double tap the **Jog Dial** to disconnect intercom connection with one of the two intercom friends accordingly. For example, by single tapping the **Jog Dial**, you can terminate the intercom connection with the first intercom friend (B). However, you still have the intercom connection with your second intercom friend (C). To disconnect from intercom friend (C), double tap the **Jog Dial**. Now both intercom friends are disconnected.

| Jog Dial | Result |
|-----------------------|----------------------|
| Press and hold for 1" | Disconnect (B) & (C) |
| Single tap | Disconnect (B) |
| Double tap | Disconnect (C) |

End Three-way Intercom

7.3.3 Start Four-way Intercom

You can have four-way conference intercom with three other intercom friends by adding one more intercom participant to the three-way intercom. While you are having three-way intercom as above in section 7.3.1, a new participant (D), who is an intercom friend of your intercom friend (C), may join the conference intercom by making an intercom call to your intercom friend (C). Please note that in this case, the new participant (D) is an intercom friend of (C), not of you (A).

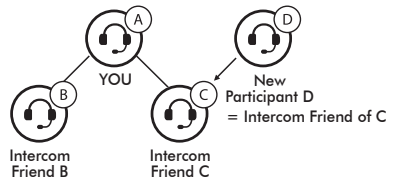

7.3.4 End Four-way Intercom

As in the case of three-way intercom, you can completely exit from the four-way conference intercom or just disconnect a single intercom connection.

1. Press and hold the **Jog Dial** for **1 second** until you hear a beep to terminate four-way conference intercom. It terminates the intercom connections between you (A), and your intercom friends (B) and (C).
2. Tap or double tap the **Jog Dial** to disconnect the intercom connection with one of the two intercom friends accordingly. However, when you disconnect the second friend (C) by double tapping the **Jog Dial**, you will be disconnected with the third participant (D) as well. This is because the third participant (D) is connected with you via the second friend (C).

| Jog Dial | Result |
|-----------------------|---------------------------|
| Press and hold for 1" | Disconnect (B), (C) & (D) |
| Single tap | Disconnect (B) |
| Double tap | Disconnect (C) & (D) |

End Four-way Intercom

8 GENERAL SETTINGS

8.1 Function Priority

The headset operates in the following order of priority:

| | |
|-----------|------------------------|
| (highest) | Mobile phone |
| | Bluetooth Intercom |
| (lowest) | Bluetooth stereo music |

A lower priority function is always interrupted by a higher priority function.



8.2 Configuration Menu



You can set the configuration of the headset by the voice menu instruction described below.

1. Press and hold the **Multi-function Button** for **12 seconds** until you hear a voice prompt, “**Configuration menu**”.



2. Rotate the **Jog Dial clockwise** or **counterclockwise** to navigate between the menus. You will hear voice prompts for each menu item.
3. You can enable the feature or execute the command by tapping the **Multi-function Button**, or disable the feature by tapping the **Jog Dial**.

| Configuration Setting | Enable/Disable or Execute |
|---|---------------------------|
|  <p>SPEED DIAL</p> <p>Speed Dial</p> | Execute |
|  <p>VOICE PROMPT</p> <p>Voice Prompt</p> | Enable/Disable |
|  <p>DELETE ALL PAIRINGS</p> <p>Delete All Pairings</p> | Execute |

| Configuration Setting | Enable/Disable or Execute |
|---|---------------------------|
|  <p>FACTORY RESET</p> <p>Factory Reset</p> | Execute |
|  <p>EXIT CONFIGURATION</p> <p>Exit Configuration</p> | Execute |

8.2.1 Assigning Speed Dial

1. To assign a phone number as a speed dial, rotate the **Jog Dial** until you hear a voice prompt, “**Speed dial**”.



2. Tap the **Multi-function Button**, and you will hear a voice prompt, “**Speed dial one**” and “**Phone connected**”.
Rotate the **Jog Dial** to select one of three speed dial numbers by hearing a voice prompt, “**Speed dial (#)**”.



3. Call a phone number you want to assign and you will hear a voice prompt, “**Save speed dial (#)**”. The phone number is automatically assigned to the selected speed dial number. Then the phone call will hang up immediately.
4. To exit the menu, rotate the **Jog Dial** clockwise or counter clockwise until you hear a voice prompt, “**Canceled**”, and tap the **Multi-function Button** to confirm. You will then hear a voice prompt, “**Canceled**”.



8.2.2 Voice Prompt (Default: Enable)

You can disable voice prompts by configuration setting, but the following voice prompts are always on.

- Voice prompts for configuration setting menu
- Voice prompts for factory reset
- Voice prompts for speed dial

8.2.3 Delete All Pairings

Delete all Bluetooth pairing information.

8.3 Firmware Upgrades

The headset supports firmware upgrades. You can update the firmware using the **Parani Device Manager**. Please visit Parani website at parani.com to check the latest software downloads.

9 TROUBLESHOOTING

9.1 Fault Reset

If the **M10** is not working properly for any reason, connect it to a USB cable.

The **M10** will automatically be turned off and a fault reset will occur.

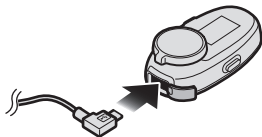

9.2 Factory reset

If you want to restore the headset to factory default settings, use the **Factory Reset** in the configuration menu. The headset automatically restores the default settings and turns off.

Copyright © 2021 Sena Technologies, Inc.

All rights reserved.

© 1998–2021 Sena Technologies, Inc. All rights reserved.

Sena Technologies, Inc. reserves the right to make any changes and improvements to its product without providing prior notice.