

CLEAT HANGER INSTRUCTIONS

TIPS BEFORE YOU GET STARTED

- There are two parts (strips) to one cleat hanger (one strip for the artwork, one strip for the wall).
- Both strips of the cleat hanger are identical.
- USE PROPER TOOLS. IT IS IMPORTANT TO INSTALL CLEATS LEVEL ON THE WALL AND LEVEL ON YOUR ARTWORK.

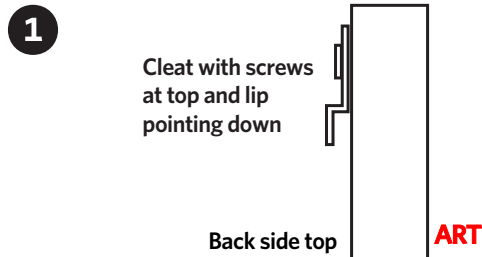

- One strip of the cleat will be attached to the back, top of the art.
- This strip of the cleat will be mounted with the screw holes at the top (using the #8x1/2" screws) and the lip pointing down. The lip will catch the second strip of the cleat that will be on the wall.
- The strip of the cleat is usually attached in the middle, back of the artwork
- Pilot holes for the screws are suggested in any wood frame.

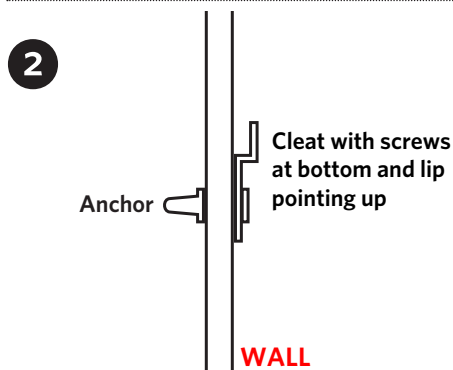

- The second strip of the cleat will be attached to the wall at a level height.
- On the wall, decide placement and hanging height of the artwork. For hanging height, be sure to take into account where the cleat is on the artwork (the measurement from the top edge of the artwork to the bottom of the strip).
- This strip of the cleat will be mounted to the wall with the screw holes at the bottom (using the #8x1" screws and plastic wall anchors) and the lip pointing up. The lip will catch the first strip of the cleat that is on the artwork.
- Make sure to install the cleat level. Small adjustments to level the cleat can be made by slightly loosening the screws, nudging the cleat in the direction to achieve levelness, then tighten screws.

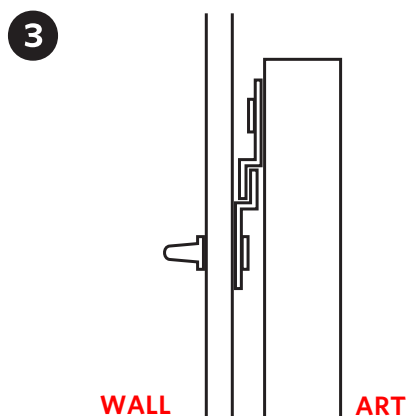

- Hold artwork loosely, flush against the wall and slightly above the cleat on the wall. Let the artwork slide down to interlock the two cleats.
- The artwork can shift left or right. However, it is best if both parts of the cleat hanger are engaged at least 90% of their length for strength and stability.
- The artwork can easily be removed from the wall by sliding the artwork upward a few inches to disengage the cleat parts.