



Ahead of the Curve®



Stealthbox®

INSTALLATION GUIDE
for the

SB-GM-5GSUV/10TW3

SKU# 94698

2021-Up Chevrolet / GMC Full-Size SUVs

Enclosure Type: Sealed

Driver Type: 10TW3-D4

Nominal Impedance: 2 ohms

Continuous Power Handling: 400 watts (RMS method)

SB-GM-5GSUV/10TW3 INSTR_SKU# 011569

! IMPORTANT

- Installation requires appropriate tools and safety equipment. Professional installation is recommended.
- If you prefer to perform your own installation, please read this installation guide completely before beginning.
- Before cutting or drilling, check for potential obstacles behind mounting surfaces.
- Mount this product securely to prevent damage or injury in severe conditions.

INSTALLATION
DIFFICULTY:

2 ^{OUT} OF 5

ESTIMATED TIME:
1 HOUR



Continued on Next Page

INCLUDED HARDWARE

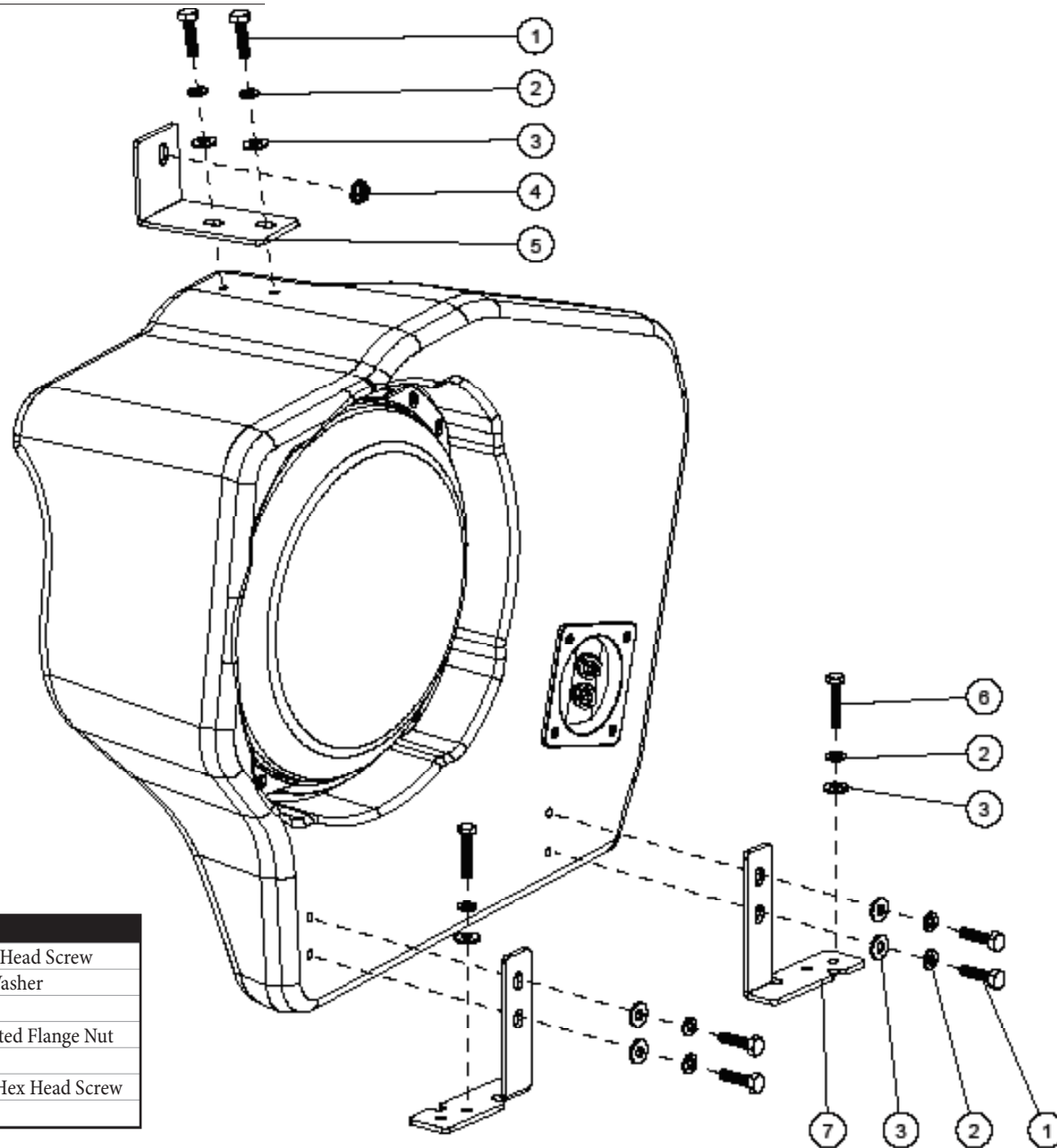

BOM ID	Qty	SKU	Description
1	6	150042	1/4 - 20 x 1" Hex Head Screw
2	8	151098	1/4" Split Lock Washer
3	8	151021	1/4" Flat Washer
4	1	150074	M6 - 1 mm Serrated Flange Nut
5	1	154446	Top Bracket
6	2	154448	M6 - 1 x 30 mm Hex Head Screw
7	2	154447	Bottom Bracket

POWER RECOMMENDATION

JL Audio recommends high quality amplifiers such as the JL Audio XD300/1v2. The diagram below shows the recommended crossover settings for the XD300/1v2. For a detailed description of the amplifier settings, consult the owner's manual for the amplifier. If another amplifier is being used, please reference this illustration and use similar settings on that amplifier.

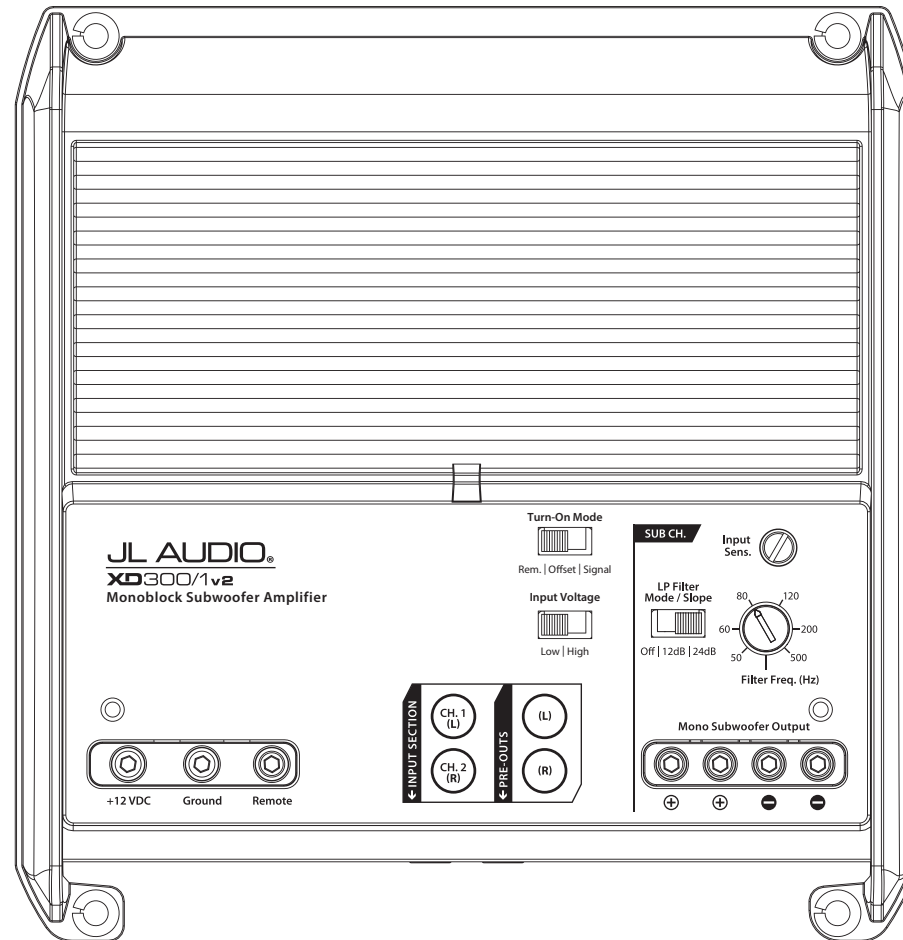

CONNECTIONS

Using quality power, signal, and speaker wire is essential in ensuring the performance of your Stealthbox®. JL Audio recommends using a 4 AWG power kit such as the XD-PCS4-1B for your Stealthbox® amplifier. Other kits are available should you be using more than one amplifier. Signal wire such as the JL Audio Premium Audio Interconnect Cables should be used to provide signal for both channels of the amplifier. JL Audio recommends using 12 AWG speaker wire for subwoofers such as our XC-BCS12-25.

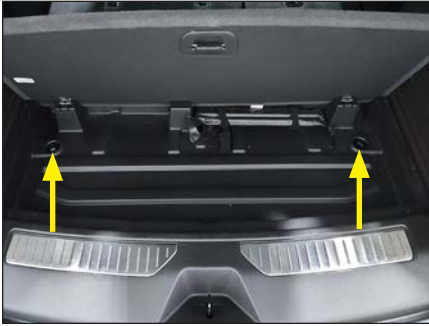

STEP 1
Flip the floor cargo door open. Unscrew and remove the two indicated plastic nuts.



STEP 2
Lift the cargo floor from the vehicle and set aside.

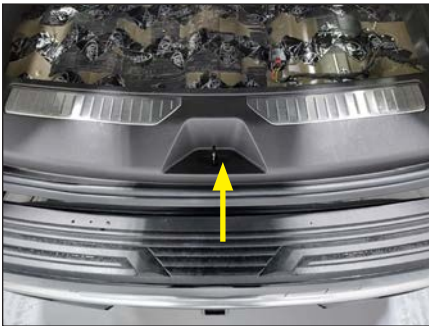

STEP 3
Pry and remove the plastic lock striker cover from the rear sill panel.

Unclip the rear sill panel's perimeter clips and lift it from the floor. Set the panel aside.



STEP 4
Pry the indicated cargo loop bolt cover open, exposing the Torx bolt underneath. Remove the exposed Torx bolt.

Unscrew and remove the indicated plastic nut.

Pry and release the weatherstripping from the rear edge of the panel.



STEP 5
Pry and unclip the upper panel to release. Remove the indicated bolt and detach the indicated bungee clip. Set the panel aside.



STEP 6
Remove the exposed bolt from the rear pillar speaker panel. Pry the panel to release it from the panel clips.

Disconnect the speaker harness from the rear of the pillar speaker and set the panel aside.



STEP 7
Release the seat belt bolt cover from the bottom of the driver side second row seat belt, exposing the bottom seat belt bolt. Remove the exposed lower seat belt bolt.



STEP 8
Pry and remove the indicated bolt cover from the panel, exposing the Torx bolt underneath. Remove the exposed Torx bolt.

Pry the panel from the vehicle, releasing it from the perimeter clips.



STEP 9

Flip the panel over that was removed in **STEP 8**. The seat belt guide trim is attached to the panel by plastic tabs. Carefully detach the seat belt guide trim from the panel by unlatching the plastic tabs.

Guide the unbolted seat belt bottom through the panel and set aside.



STEP 10

Remove the driver side rear door sill panel by prying it up from the floor, releasing it from the clips. Set the panel aside.



STEP 11

Unclip and remove the third row seatbelt guide panel.

Unclip the rear panel from its perimeter mounting clips.

Note: If the vehicle is equipped with a rear panel USB port, unclip the USB port from the panel and disconnect its wiring harness.

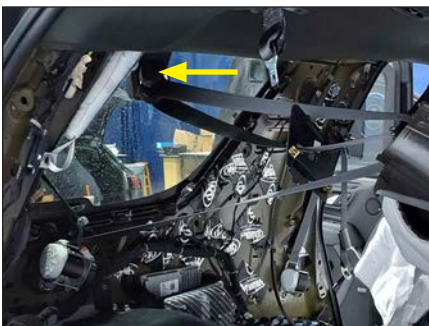

STEP 12

Open the third row seat belt upper bolt cover and remove the exposed bolt. Guide the third row seatbelt upper through the rear panel to free the panel from the vehicle completely. Set the rear panel aside.



STEP 13

Uninstall the factory subwoofer by removing the single indicated nut from the top bracket and the two indicated bolts from the bottom brackets.

Disconnect the factory subwoofer wiring harness and set the factory subwoofer aside.



STEP 14

Create four screw assemblies by sliding a supplied 1/4" Lock Washer and 1/4" Flat Washer onto a 1/4 - 20 x 1" Hex Head screw.

Referring to **Page 2** as a guide, orient two Bottom Brackets as shown in the illustration. Pass two screw assemblies through each Bottom Bracket into the threaded inserts at the bottom of the Stealthbox® and hand tighten.



STEP 15

Place the Stealthbox® into the vehicle, aligning the Bottom Bracket notches to the factory floor studs as shown in the image.

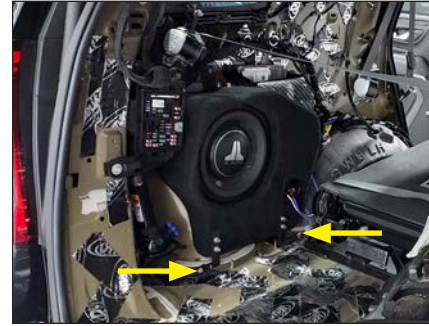

STEP 16

Create two screw assemblies by sliding a supplied 1/4" Lock Washer and 1/4" Flat Washer onto a M6 - 1 x 30 mm Hex Head Screw.

Use the two assemblies to attach the Bottom Brackets to the factory subwoofer enclosure mounting bolt holes in the floor. Hand tighten the screw assemblies. Connect speaker cable to the terminal cup of the enclosure, and route the cable as necessary.



STEP 17

Create two screw assemblies by sliding a supplied 1/4" Lock Washer and 1/4" Flat Washer onto a 1/4 - 20 x 1" Hex Head screw.

Referring to **Page 2** as a guide, orient the Top Bracket as shown in the illustration. Pass two screw assemblies through the Top Bracket into the threaded inserts at the top of the Stealthbox® and hand tighten.



STEP 18

Align the top hole of the Top Bracket to the factory upper subwoofer enclosure mounting stud. Use the supplied M6 - 1 mm Serrated Flange Nut to attach the Top Bracket to the vehicle.

Once all mounting brackets are aligned, fully tighten all bracket screw assemblies to the enclosure and the Top Bracket M6 - 1 mm Serrated Flange Nut to the factory stud.



STEP 19

Reinstall all factory parts and panels.

CONGRATULATIONS!

You have completed the installation for this model! Enjoy your new Stealthbox®!



MID/HIGH FREQUENCY DRIVER FITMENT

A variety of JL Audio coaxial and component systems will fit in the factory speaker locations of your vehicle.

Location / OEM Speaker Size	Suggested JL Audio Speaker Models	
	Coaxial Models	Component Models
Front Doors / 6 x 9-inch	C-690x ⁽¹⁾ , C1-690tx ⁽¹⁾ , C2-690tx ⁽¹⁾ C2-650x ⁽¹⁾ , C5-650x ⁽¹⁾	C1-690 ⁽¹⁾ , C1-650 ⁽¹⁾ , C2-650 ⁽¹⁾ , C3-650 ⁽¹⁾ , C5-650 ⁽¹⁾ , C7-650cw ^(1,2)
Rear Doors / 6.5-inch	C1-650x, C2-650x, C5-650x	C1-650, C2-650, C3-650, C5-650, C7-650cw ⁽²⁾

1 - Installation may require adaptor, 2 - Component woofer only

JL AUDIO | How we play.®    

(954) 443-1100

www.jlaudio.com

All specifications are subject to change without notice. "JL Audio" and "How we play" are registered trademarks of JL Audio, Inc. "Ahead of the Curve" and its respective logo are trademarks of JL Audio, Inc.

Printed in USA • ©2022 JL Audio, Inc. • For more detailed information please visit us online at www.jlaudio.com.

JLA-SKU# 011569 • ver. 8.16.22 • 10369 NORTH COMMERCE PARKWAY • MIRAMAR, FLORIDA • 33025 • USA



011569