

The MB100 is a non sterile disposable premium flat fold mask that is manufactured in Korea and meets Korea KMOEL-2017-64 standards. The MB series has a minimum filter performance of 94% for filtering non-oil-based particles.



Multi-Layer



Easy to breathe through



Comfortable earloop



Prevention of dust

Model Number: MB100

Alliable Medical's premium flat fold mask (MB100) is developed with fine filter technology that enables high filtration performance while allowing breathability and comfort. The design allows for a close and comfortable facial fit. The comparison chart below shows that USA, Europe, and Korea are considered to have equivalent performance standards.

Performance Standard Comparison Chart

Certification/ Class (Standard)	N95 (NIOSH-42C FR84)	FFP2 (EN 149-2001)	Korea 1 st Class (KMOEL - 2017-64)
Filter performance – (must be ≥ X% efficient)	≥ 95%	≥ 94%	≥ 94%
Test agent	NaCl	NaCl and paraffin oil	NaCl and paraffin oil
Flow rate	85 L/min	95 L/min	95 L/min
Total inward leakage (TIL)* – tested on human subjects each performing exercises	N/A	≤ 8% leakage (arithmetic mean)	≤ 8% leakage (arithmetic mean)
Inhalation resistance – max pressure drop	≤ 343 Pa	≤ 70 Pa (at 30 L/min) ≤ 240 Pa (at 95 L/min) ≤ 500 Pa (clogging)	≤ 70 Pa (at 30 L/min) ≤ 240 Pa (at 95 L/min)
Flow rate	85 L/min	Varied – see above	Varied – see above
Exhalation resistance - max pressure drop	≤ 245 Pa	≤ 300 Pa	≤ 300 Pa
Flow rate	85 L/min	160 L/min	160 L/min
Exhalation valve leakage requirement	Leak rate ≤ 30 mL/min	N/A	visual inspection after 300 L /min for 30 sec
Force applied	-245 Pa	N/A	N/A
CO ₂ clearance requirement	N/A	≤ 1%	≤ 1%



Features

- Multilayer protection
- Adjustable nose clip
- Designed not to slip while talking
- Extra soft chin covering
- Individually packed
- Comfortable earloop design and includes clip for better fit
- Flat fold style for easy transportation
- Made in Korea

Intended Use

Using a face mask may limit the spread of User's respiratory droplets. For single use.

Source: 3M technical Bulletin 17915000



Earloop Clip for Secure Fit



Comfort Fit with Hidden Nose Clip



Light Weight (3g) and Ergonomic Design

Materials

Outer & Inner Layer	Polypropylene
Filter Layer	Polypropylene
Nose Clip	Stainless, Polypropylene
Elastic Band	Polyurethane, Polyester
Earloop Clip	ABS Plastic

Packaging

Qty/ Box	Boxes/ Case
25	40

Fitting Instructions



1 Sanitize your hands thoroughly before touching the mask

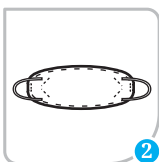

2 Inspect the overall condition of the mask to ensure there are no defective parts

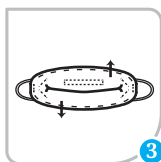

3 With the reverse side up, turn upright, and pull on the top and bottom to open up the mask



4 Place the mask over your mouth, nose, chin and place straps behind ears



5 Using both hands, press down the top metal edge over the bridge of your nose to create an air tight seal



6 Adjust the mask as needed to close off all possible openings.



Warnings and Limitations

- Always confirm the product is suitable for the application
- Keep the mask on during all periods of exposure
- Fit testing should be performed before assigning a mask to an individual
- Inspect all parts of the mask to ensure it is in good condition before use
- Dispose according to applicable regulations
- Do not alter the product in any way
- To be stored within temperature range of -5-87 degrees fahrenheit

**General Limitations by NIOSH
(All Part 84A Approvals)**

A	Not for use in atmospheres containing less than 19.5 percent oxygen.
B	Not for use in atmospheres immediately dangerous to life or health.
C	Do not exceed maximum use concentrations established by regulatory standards.
D	Air-line respirators can be used only when the respirators are supplied with respirable air meeting the requirements of CGA G-7.1 Grade D or higher quality
E	Use only the pressure ranges and hose lengths specified in the User's Instructions.
G	If airflow is cut off, switch to filter and/or cartridge and immediately exit to clean air.
H	Do not wear for protection against organic vapors with poor warning properties or those which generate high heats of reaction with sorbent.
I	Contains electrical parts which have not been evaluated as an ignition source in flammable or explosive atmospheres by MSHA/NIOSH.
J	Failure to properly use and maintain this product could result in injury or death.
K	The Occupational Safety and Health Administration regulations require gas-proof goggles to be worn with this respirator when used against formaldehyde.
L	Follow the manufacturer's User's Instructions for changing cartridges and/or filters.
M	All approved respirators shall be selected, fitted, used, and maintained in accordance with MSHA, OSHA, and other applicable regulations.
N	Never substitute, modify, add or omit parts. Use only exact replacement parts in the configuration as specified by the manufacturer.
O	Refer to User's Instructions, and/or maintenance manuals for information on use and maintenance of these respirators.
P	NIOSH does not evaluate respirators for use as surgical masks.
S	Special or critical User's Instructions and/or specific use limitations apply. Refer to User's Instructions before donning.

Source: <https://wwwn.cdc.gov/NIOSH-CEL/Limitations/A84>
To be used as a reference guide only.