

Tools Required
3 mm Allen key
5 mm Allen key
10 mm wrench

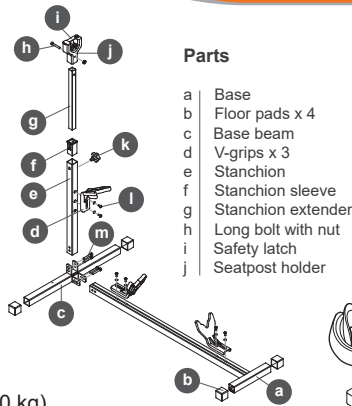

Max. Load 30 kg / 66 lb. (最大載重 30 kg)



Parts

- a Base
- b Floor pads x 4
- c Base beam
- d V-grips x 3
- e Stanchion
- f Stanchion sleeve
- g Stanchion extender
- h Long bolt with nut
- i Safety latch
- j Seatpost holder

Compatibility

Wheel Size: Small: 20"; Large: 24" – 29".
Tyre Width: 2.3–6.6 cm (0.9–2.6")
Max. Seatpost Diameter: 25.4 – 35 mm
Not suitable for bikes with mudguards in vertical mode.

2.3 – 6.6 cm (0.9 – 2.6")

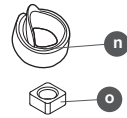

- k Height adjustment knob
- l Short bolts with washers x 6
- m Long bolts x 4
- n Wheel anchor strap
- o Square nuts x 4

Warning

For rear wheel use only. Use stand only on a flat, stable surface. Stand is designed to support a bike only—do not sit on bike while in the stand. Use stand in a place where it is unlikely to cause obstruction, be knocked or bumped, or interfered with by young children.

⚠ 警告 (繁體中文) 1、本產品僅供後輪使用。2、本產品垂直使用時，無法使用帶有泥除的自行車使用。3、僅供在平坦、穩定的表面上使用本產品。4、本產品僅限放置自行車，放置後請您不要坐在自行車上。5、請在不會造成阻礙或碰撞的地方使用本產品。6、請注意不要讓年幼的兒童去靠近。

Instructions

Assemble Stand

1. Attach floor pads to base and base beam (fig. 1).
2. Insert square nuts—flat side up—into base slot. Slide two nuts toward front of base, leaving remaining two nuts near rear (fig. 2).

3. Attach V-grips (x 2) to base. Select one of the options below:

For large bikes (24 – 29" wheels)

Place one V-grip near front of base, angled rearward over first pair of nuts. Screw two short bolts into nuts, but do not tighten as further adjustment will be necessary. Repeat this with other V-grip, this time with it angled forward (fig. 3a).

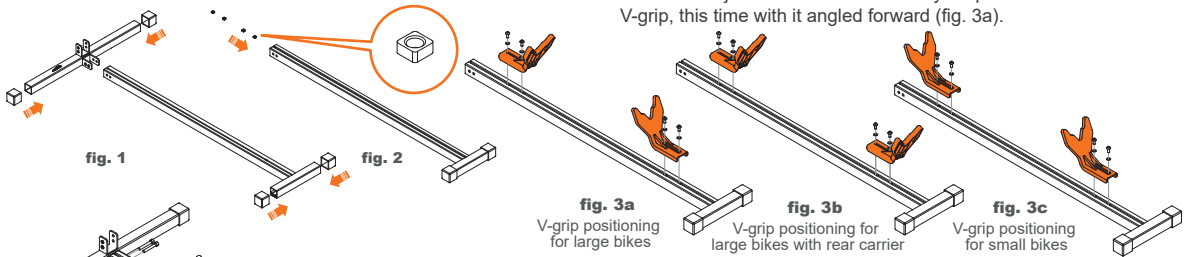

For large bikes (24 – 29" wheels) with rear carrier

Place one V-grip near front of base, angled forward over first pair of nuts. Screw two short bolts into nuts, but do not tighten as further adjustment will be necessary. Repeat this with other V-grip, again with it angled forward (fig. 3b).

For small bikes (20" wheels)

Place one V-grip near front of base, angled rearward over first pair of nuts. Screw two short bolts into nuts, but do not tighten as further adjustment will be necessary. Repeat this with other V-grip, again with it angled rearward (fig. 3c).

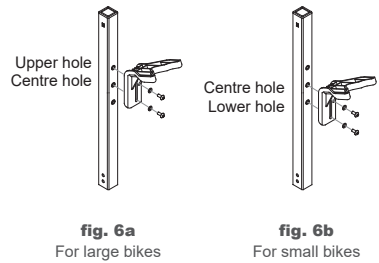
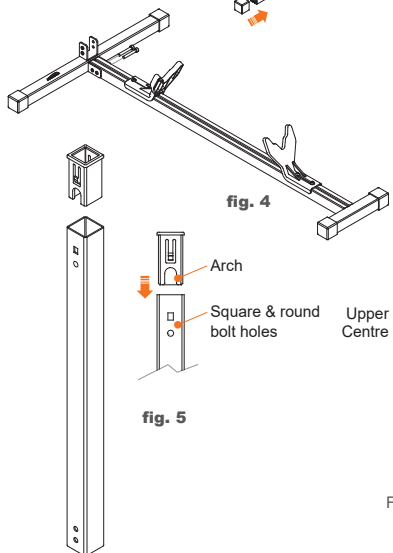

4. Attach base beam, logo facing upwards to base by inserting end of base into base beam bracket, matching bolt holes on both. Screw two long bolts into holes on bracket side that is flat, tighten (fig. 4).
5. Press stanchion sleeve into top of stanchion, matching arch on sleeve with square and round bolt holes on stanchion (fig. 5).
6. Attach third V-grip to stanchion—for large or small bikes only (do not attach if you are using a large bike with a rear carrier). **For large bikes** Place V-grip, angled upward over the upper and centre bolt holes, screw in remaining two short bolts, tighten (fig. 6a). **For small bikes** Place V-grip, angled upward over the centre and lower bolt holes, screw in remaining two short bolts, tighten (fig. 6b).
7. Attach stanchion to base beam by inserting its bottom end into the vertical bracket—V-grip facing frontward, matching the bolt holes on both. Screw two long bolts into holes on bracket side that is flat, tighten (fig. 7).

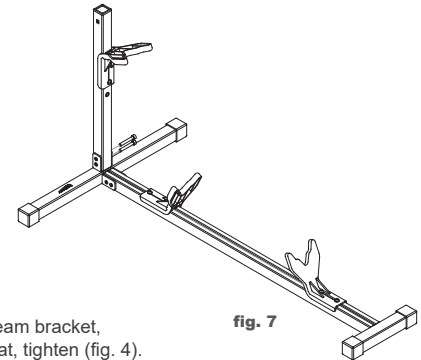

- Attach seatpost holder to stanchion extender. Screw in bolt, tighten using Allen key and wrench in unison (fig. 8).
- Insert stanchion extender into stanchion—the safety latch must face and open rearward (fig. 9).
- Screw in height adjustment knob to complete assembly (fig. 9, 10).

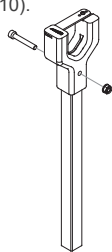

fig. 8

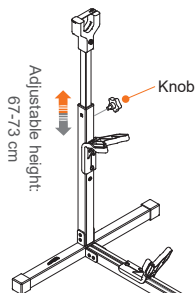

fig. 9

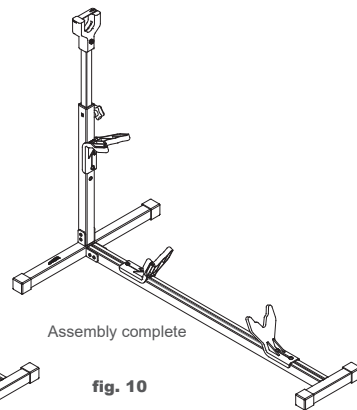

fig. 10

Using Stand

- To adjust stand and **store bike in horizontal mode**, roll bike onto stand backwards until the rear tyre rests against the vertical V-grip (if one is attached). Align the two horizontal V-grips so that they both press against each end of the tyre (fig. 11a, 11b, 11c). Slide V-grip bolts to opposite ends of their slots, and tighten (fig. 12). If your rear tyre rests firmly against all V-grips, your bike is stored correctly in horizontal mode. Ensure all bolts are tightened securely. Recommended: for extra stability, secure front wheel to down tube with anchor strap (fig. 13).
- To **store bike in vertical mode**, follow adjustment instructions as above (1). [Note: Your seatpost must be long enough to allow your seat to sit behind seatpost holder. Remove any bag, light, reflector, etc. attached to your seatpost.] Roll bike onto stand backwards. **Secure front wheel to down tube with anchor strap.** Open safety latch, lift bike by handlebars, standing it up. Lean bike backwards resting the seatpost in seatpost holder. Close latch. Adjust height of holder with knob if necessary (for best results, set position so that seatpost slants down slightly rearward) (fig. 14).

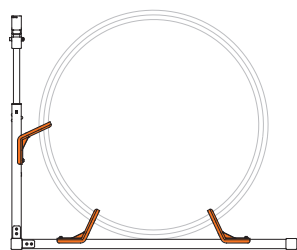

fig. 11a V-grip positioning for large bikes

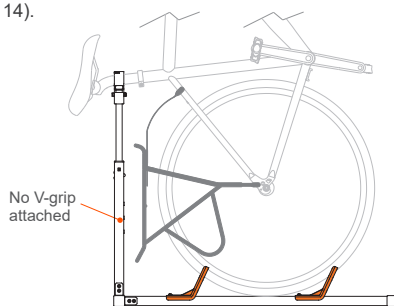

fig. 11b V-grip positioning for large bikes with rear carrier

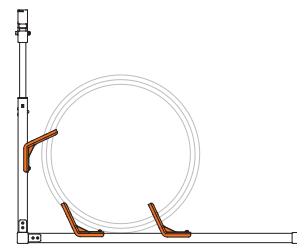
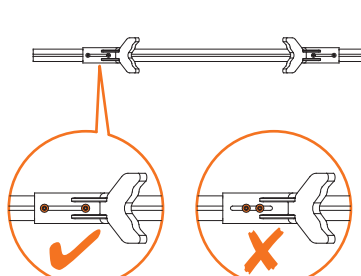

fig. 11c V-grip positioning for small bikes



Correct bolt placement Incorrect bolt placement

fig. 12

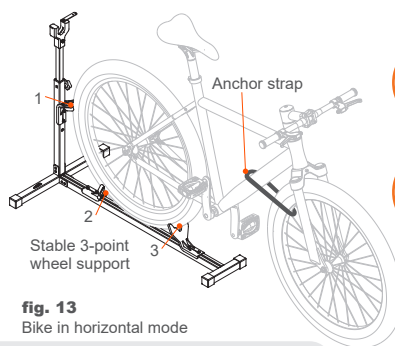

fig. 13 Bike in horizontal mode

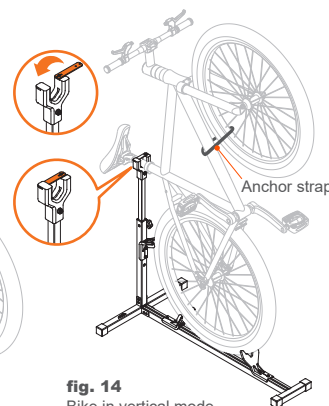

fig. 14 Bike in vertical mode

Note

Adjust setup if using a different bike in the stand. To prevent rust, avoid wet environments.

Limited Warranty

Ibera warrants this product for normal usage against workmanship, and material defects to the original purchaser for two year from purchase date. Products purchased online are not covered by this warranty unless purchased from an authorised Ibera online store. 1. User assumes all risk of personal injury, damage to or failure of the product when it is used in jumping, acrobatics or similar activities. 2. Warranty does not cover any incidental or consequential damages, such as personal injury or other losses due to accident, neglect, misuse, abuse, modification, normal wear and tear, improper care and cleaning, or failure to follow included instructions.

See other Ibera products at www.ibera.info

Ibera Co. Ltd.
Specifications subject to change without notice. Ibera is a trademark of Ibera Co. Ltd. All other trademarks are property of their respective owners. Copyright Ibera Co. Ltd. Made in Taiwan. IB-ST21

Artwork: 01/23