

Tools Required: 3 mm Allen key.

Parts

- a Allen bolt x 4
- b Washer x 4
- c Carrier interface adaptor(固定座)
- d Clamp top piece x 4
- e Clamp bottom piece (nut) x 4

Install Carrier interface adaptor

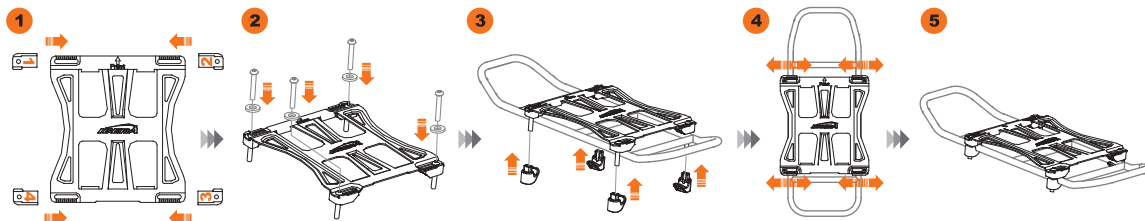

1. Place adaptor on carrier with Ibera logo facing front of bike. Clamp top pieces (numbered 1–4); slide piece marked '1,' under front-left slot of adaptor. It should be seated on top of carrier rod. **2.** Place Allen bolt through slot and hole in clamp top piece. **3.** Place a clamp bottom piece, hook end first, underneath the carrier rod, align with bolt. With Allen key, screw in bolt loosely. Repeat steps above for other three corners of adaptor. Numbered clamp top pieces should be assembled clockwise in order, according to number (1–4). **4.** With adaptor loosely assembled to carrier, adjust its position lengthways and widthways. Tighten Allen bolts very well. **5.** Adaptor mounted on carrier.

Mounting Bag

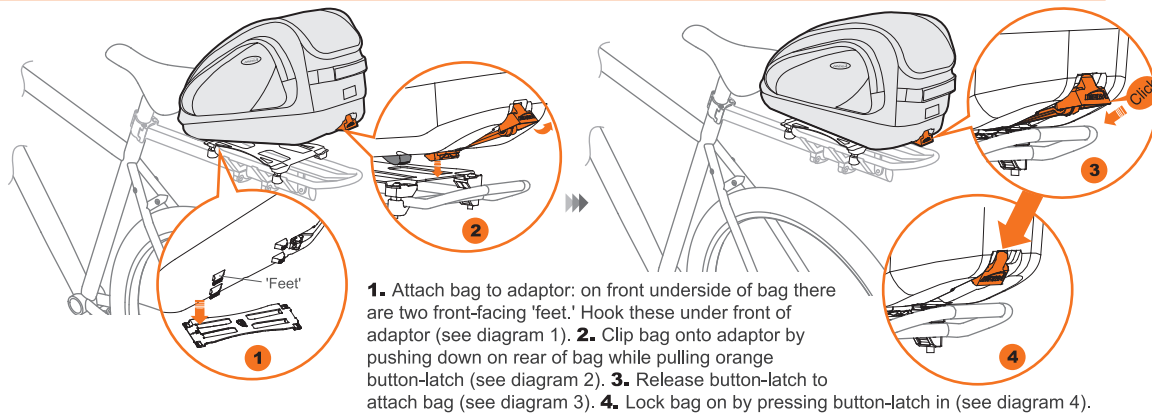

1. Attach bag to adaptor: on front underside of bag there are two front-facing 'feet.' Hook these under front of adaptor (see diagram 1). **2.** Clip bag onto adaptor by pushing down on rear of bag while pulling orange button-latch (see diagram 2). **3.** Release button-latch to attach bag (see diagram 3). **4.** Lock bag on by pressing button-latch in (see diagram 4).

Detaching Bag



1. To detach bag, pull button-latch out completely (see diagram 1). **2.** Lift bag off adaptor (see diagram 2).

Warning 1. Ensure adaptor is tightly secured to carrier before using. **2.** Securing bag to adaptor is a 2-step process: attach, then lock by pressing button-latch in. **3.** Always make sure bag is attached securely to adaptor before use. **4.** Do not use for off-road riding. **5.** Detach shoulder strap when riding.

警告 (繁體中文) 1、包包安裝於固定座後一定要再按一次橘色按鈕進行鎖固 (會聽到“喀”的聲音) 2、請確認固定座必須緊密鎖固於貨架上 3、本產品不可使用於越野騎行 4、騎行時請將肩帶收入包包內 **警告 (簡體中文)** 1、包包安裝於固定座後一定要再按一次橘色按鈕進行鎖固 (會聽到“喀”的聲音) 2、請確認固定座必須緊密鎖固於貨架上 3、本產品不可使用於越野騎行 4、騎行時請將肩帶收入包包內

Limited Warranty

Ibera warrants this product for normal usage against workmanship, and material defects to the original purchaser for two year from purchase date. Products purchased online are not covered by this warranty unless purchased from an authorised Ibera online store. 1. User assumes all risk of personal injury, damage to or failure of the product when it is used in jumping, acrobatics or similar activities. 2. Warranty does not cover any incidental or consequential damages, such as personal injury or other losses due to accident, neglect, misuse, abuse, modification, normal wear and tear, improper care and cleaning, or failure to follow included instructions.

Ibera Co. Ltd.
Specifications subject to change without notice. Ibera is a trademark of Ibera Co. Ltd. All other trademarks are property of their respective owners. Copyright 2016 Ibera Co. Ltd. Made in Taiwan. Artwork: 05-2016.