



Heavy-duty Easy Utility Stand

Adjustable stand for parking or display.

- Easy to use
- Front or rear wheel use
- Stable 3-point wheel support
- Adjustable wheel holder
- Durable construction
- Suitable for most bikes
- E-bike compatible

Features For parking or display. Easy to use. Front or rear wheel use. Adjustable wheel holder enables firm fit for different bikes, wheel or tyre sizes. Durable construction.

Compatibility Most bikes with 26–29" wheels / Max. tyre width: 102 mm / 4". [Max. Load 30 kg / 66 lb].

Material Steel, plastic.

1.42 kg

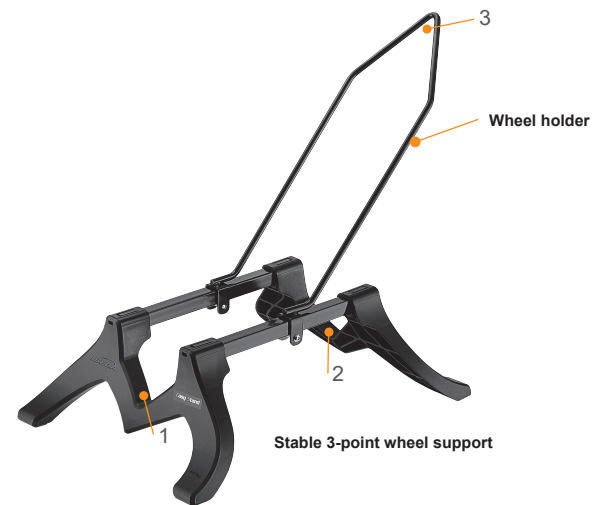

Rear wheel



Front wheel

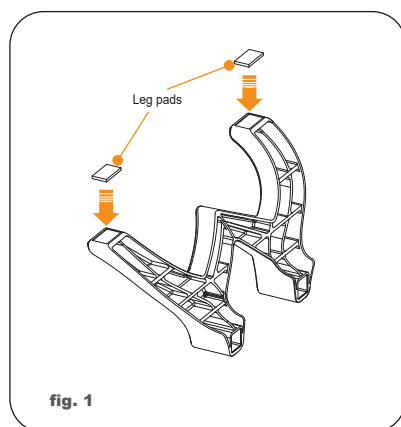

fig. 1

Attach leg pads.

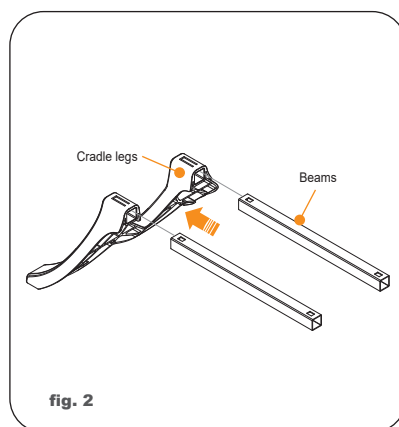

fig. 2

Assemble one set of cradle legs.

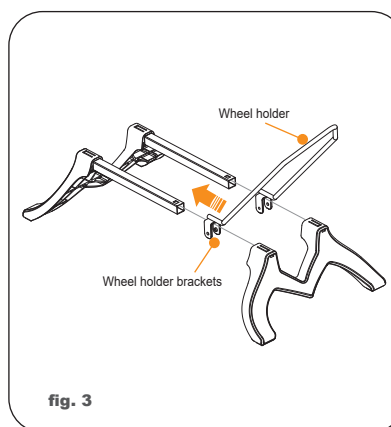

fig. 3

Insert wheel holder.

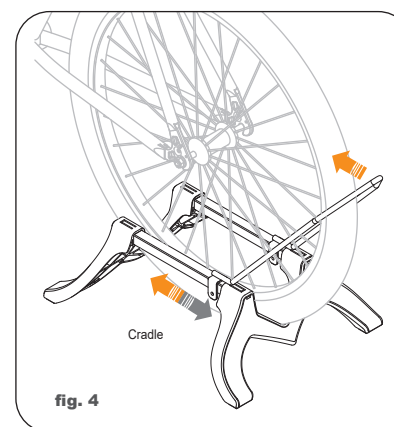

fig. 4

Place bike wheel in cradle.

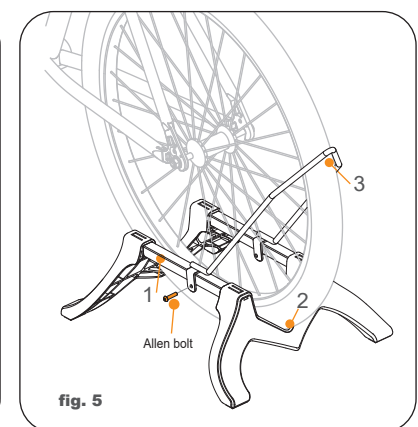

fig. 5

Adjust wheel holder.

INSTRUCTIONS

Assemble Stand

- 1. Attach leg pads.** Ensure legs are clean and dry before attaching adhesive pads (fig. 1).
- 2. Assemble one set of cradle legs.** Insert beams (with square holes facing up) into cradle legs. Push beams in firmly, locking in place (fig. 2).
- 3. Insert wheel holder.** With wheel holder angled backwards, slide its brackets along both beams. Do not insert bolts yet. Assemble second set of cradle legs (fig. 3).
- 4. Place bike wheel in cradle.** Use front or rear wheel (fig. 4).
- 5. Adjust wheel holder.** While holding bike, slide wheel holder back or forth until tyre fits snugly in centre of wheel holder and on both ends of cradle (see tyre touch points 1, 2, 3). One properly positioned, insert bolts and tighten firmly with Allen key (fig. 5).

Using Stand

Removing bike from stand. Gently stand with your foot on one corner of a cradle leg, lift bike out.

Notes

To use stand for different bikes, wheel or tyre sizes, you will need to readjust the wheel holder position.

For carriage or stowage, the cradle can be disassembled by inserting a slim flathead screwdriver into each slot and prying the tab gently upward to unlock.