



**Contra-angle handpiece  
Repair manual**

# Contents

Remove.....1

Inspection.....4

Assembling.....6

## ● Part 1: Remove contra-angle handpiece

---

1、 1# head fixing tooling, 2# transmission lever, 3# hexagon wrench, 4# movement rear cover wrench, 5# back nut removal fixture, 6# handle fixing seat.

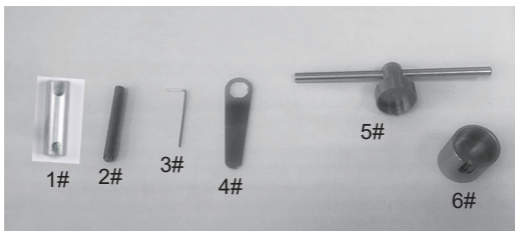

2、 Fix the head with the small side of the opening slot of 4# fixture, align the slot of the handle with 3# fixture and unscrew the handle.



## ● Part 1: Remove contra-angle handpiece

---

- 3、 Twist 2/3 of the screw counterclockwise with 3# tooling, remove the head and take out the drive shaft.



- 4、 Aim the cylinder at the fiber mouth of the handle with the 6# tool break and use the 2# tool to press out the gearbox.



## ● Part 1: Remove contra-angle handpiece

---

5、 Use 2# tooling to align the handle bore hole press out gearbox.

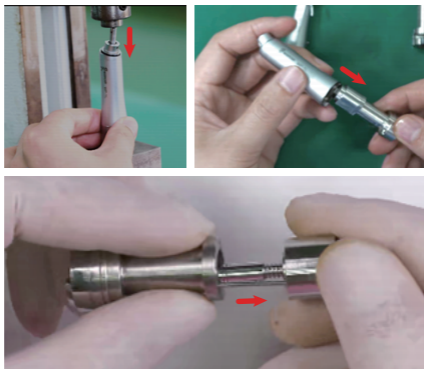

6、 Twist out the rear cover of the movement with 4# tooling and take out the movement.

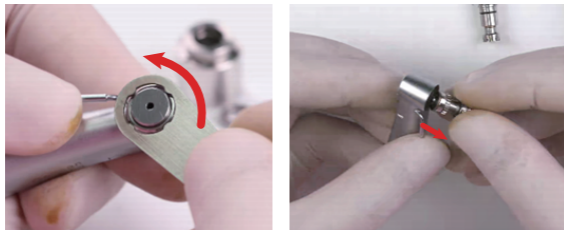

## ● **Part 2: Inspection**

---

1、 Check whether the surface of core gear and drive shaft gear is damaged and whether the bearing rotates smoothly.

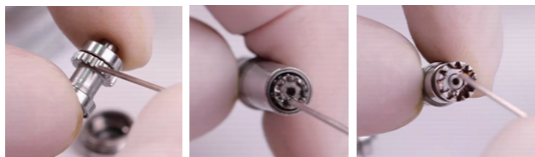

2、 Check whether there is foreign matter on the gearbox gear surface and whether the rotation is smooth.



## ● **Part 2: Inspection**

---

**Bending unit parts need to be replaced in the following cases:**

1. gear wear, broken
2. gear and bearing surface rust
2. the bearing rotation card, or the rotation will not move
4. Missing parts

**Alternative accessories:**

Gearbox assembly/movement assembly/drive shaft assembly

### ● **Part 3: Assembling contra-angle handpiece**

---

1、 Install gearbox



2、 Install the handle and pay attention to the optical fiber hole.





### ● Part 3: Assembling contra-angle handpiece

---

3、 Twist the handle nut with 5# fixture.



4、 Install the gasket on the movement (note: the front and back of the gasket, with the bump pointing outwards), then assemble the movement into the head, and twist the rear cover of the movement with # 2 tooling.

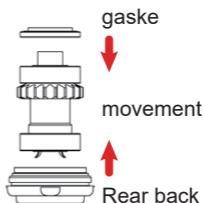

### ● **Part 3: Assembling contra-angle handpiece**

---

5、 Mount the drive shaft to the handle and then mount the machine head.

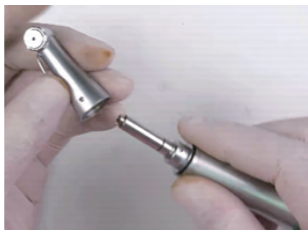

6、 Twist the screw with 2# tooling.



- **Part 3: Assembling contra-angle handpiece**

---

7、Tighten the nut



8、Complete



Scan and Login website  
for more information



Guilin Woodpecker Medical Instrument Co., Ltd.  
Information Industrial Park, Guilin National High-Tech  
Zone, Guilin, Guangxi, 541004 P. R. China

Tel:

Europe Sales Dept.: +86-773-5873196

North/South America & Oceania Sales Dep.:+86-773-5873198

Asia & Africa Sales Dep.:+86-773-5855350 Fax: +86-773-5822450

E-mail: woodpecker@glwoodpecker.com, sales@glwoodpecker.com

Website: <http://www.glwoodpecker.com>