

Product Specifications

30696-11 Pegasi M Sink Mixer, Pull Down, Chrome



Features:

- Designed & built in Australia
- Swivel spout reach 240 mm
- 2 stage flow step valve
- 34-35mm sink hole
- Recessed aerator
- Tough black rubber hose
- Hose lifts out
- M series

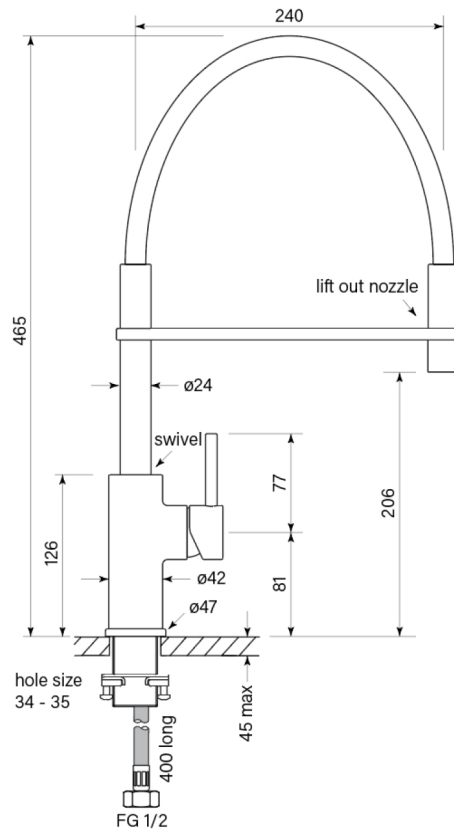

WaterMark

WM-022284

