

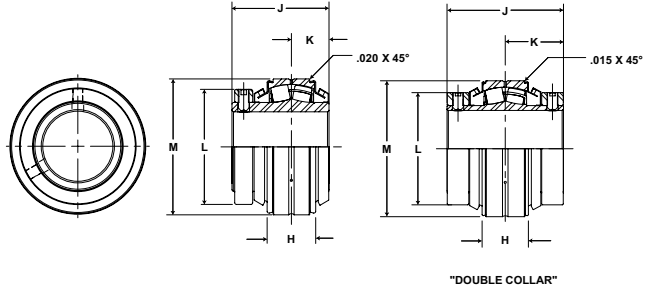

- Rolling Elements:** Spherical Roller
- Housing:** Insert Bearing
- Self Alignment:** +/- 2 Degrees
- Lock:** Setscrew
- Seal:** Felt
- Optional Seal:** Double Lip Contact
- Temperature:** -20° to 220° F



USI5000 Unitized Spherical Roller Bearing Inserts - Collar Mount

BORE DIAMETER inch	PART NO.	BASIC DYNAMIC RATING lb/N	DIMENSIONS inch / mm					UNIT WT. lb/kg
			H	J	K	L	M (NOMINAL)	
1 1/8	USI5000-102	20368 90597	1 15/64 31.4	2 3/4 69.9	1 25.4	2 49/64 70.2	3.1493 80.0	3.3 1.50
1 3/16	USI5000-103							
1 1/4	USI5000-104							
1 7/16	USI5000-107							
1 1/2	USI5000-108							
1 11/16	USI5000-111	22689	1 7/32	2 7/8	1 3/64	2 3/4	3.3462	3.0
1 3/4	USI5000-112	100921	31.0	73.0	26.6	69.9	85.0	1.36
1 15/16	USI5000-115	23520	1 17/64	2 7/8	1 1/16	3	3.5430	3.2
2	USI5000-200	104622	32.1	73.0	27.0	76.2	90.0	1.45
2 3/16	USI5000-203	28087 124931	1 23/64 34.5	3 1/8 79.4	1 9/64 29.0	3 1/4 82.6	3.9367 100.0	3.9 1.77
2 7/16	USI5000-207	44691	1 11/16	3 3/8	1 5/16	4	4.7241	7.3
2 1/2	USI5000-208	198786	42.9	85.7	33.3	101.6	120.0	3.32
2 11/16	USI5000-211	47447 211044	1 23/32 43.7	3 7/8 98.4	1 25/64 35.3	4 17/32 115.1	5.1178 130.0	9.9 4.50
2 3/4	USI5000-212							
2 15/16	USI5000-215							
3	USI5000-300							
3 3/16	USI5000-303	72640	2 1/8	4 15/32	1 45/64	5 5/16	6.2987	17.8
3 7/16	USI5000-307	323103	54.0	113.5	43.3	134.9	160.0	8.09
3 1/2	USI5000-308							
3 11/16	USI5000-311	96050	2 13/32	4 15/16	1 55/64	6	7.0861	15.8
3 15/16	USI5000-315	427230	61.1	125.4	47.2	152.4	180.0	7.18
4	USI5000-400							
4 7/16	USI5000-407	111537	2 11/16	6 3/4	3 3/8	6 1/2	7.8734	35.2
4 1/2	USI5000-408	496117	68.3	171.5	85.7	165.1	200.0	16.00
4 15/16	USI5000-415	158816 706414	3 21/64 84.5	7 27/64 188.5	3 23/32 94.5	7 1/2 190.5	9.0545 230.0	55.4 25.18
5 7/16	USI5000-507	196682 874842	3 21/32 92.9	9 1/32 229.4	4 33/64 114.7	8 1/2 215.9	9.8419 250.0	72.7 33.05
5 15/16	USI5000-515	196682 874842	4 25/64 111.5	9 25/32 248.4	4 57/64 124.2	10 254.0	11.4166 290.0	117.2 53.27
6 7/16	USI5000-608	334229	4 55/64	10 1/2	5 1/4	11	12.5976	162.5
6 1/2								
6 15/16								
7								

Note: 1 1/8" - 4" bore sizes have a single lock collar. 4 7/16" - 7" bore sizes have a double lock collar.

Metric dimensions for reference only.

Not all parts are available from stock. Please contact customer service for availability (800) 626-2120.

For more information on bearing capabilities outside of our standard offering, please contact Application Engineering (800) 626-2093.