

Mounting Style DXP

Pivot & Nose Mount, Double Acting, No Pivot Pin

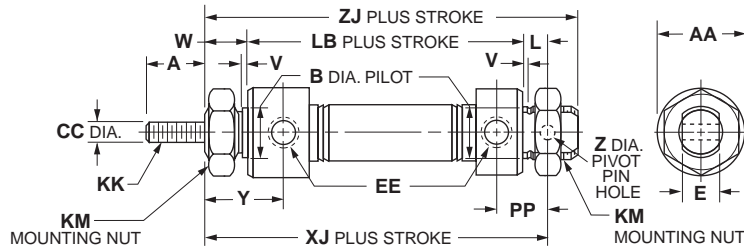

Bore sizes
5/16"
7/16"
3/4"

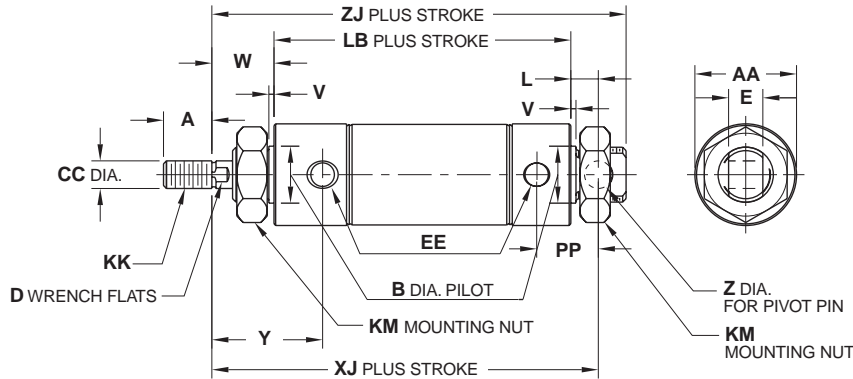

Bore sizes
9/16" *
7/8"
1-1/16"
1-1/4"
1-1/2"
1-3/4"
2" *
2-1/2" *
3" *

* No mounting nuts

B
 Round Body Cylinders
 Actuator Products

Bore size	SR	SRM	SRD	SRDM	Std. stroke (in)	Max. stroke (in)	SS rod std	A	AA	B	CC	D	E
5/16"	•				1/2, 1, 1-1/2, 2, 2-1/2, 3, 4	4	✓	0.38	0.50 SQ.	–	0.125	–	0.25
7/16"	•				1/2, 1, 1-1/2, 2, 3, 4	12	✓	0.50	0.74	0.437	0.188	–	0.31
9/16"	•	•	•		1/2, 1, 1-1/2, 2, 3, 4	12	✓	0.50	0.62	0.437	0.188	–	0.31
3/4"	•	•	•		1, 2, 3, 4, 5, 6, 8, 10	32	✓	0.50	0.86	0.624	0.250	–	0.38
7/8"	•				1, 2, 3, 4, 5, 6, 8, 10	32	✓	0.50	0.93	0.624	0.250	–	0.38
1-1/16"	•	•	•		1/2, 1, 1-1/2, 2, 2-1/2, 3, 4, 5, 6, 8, 10, 12	32	✓	0.50	1.12	0.624	0.312	0.25	0.38
1-1/4"	•	•			1, 2, 3, 4, 5, 6, 7, 8, 10, 12	32	✓	0.75	1.34	0.749	0.437	0.38	0.50
1-1/2"	•	•	•		–	32	✓	0.75	1.56	0.749	0.437	0.38	0.62
1-3/4"	•	•			1, 2, 3, 4, 5, 6, 8, 10, 12	32		0.88	1.84	1.031	0.500	7/16	0.62
2"	•	•	•		–	32		0.88	2.08	1.374	0.625	0.50	0.75
2-1/2"	•	•			–	32		0.88	2.62	1.500	0.625	1/2	0.75
3"	•				–	32		1.25	3.16	1.630	0.750	5/8	0.88

Bore size									XJ			ZJ		
	EE	KK	KM	L	LB	PP	V	W	SR	SRM	Y	Z	SR	SRM
5/16"	#10-32	#5-40 UNC	3/8-24	0.19	–	0.34	–	0.31	2.03	–	–	0.125	2.19	–
7/16"	#10-32	#10-32 UNF	7/16-20	0.25	1.94	0.44	0.05	0.38	2.56	–	0.72	0.157	2.81	–
9/16"	#10-32	#10-32 UNF	7/16-20	0.25	–	0.38	0.06	0.38	2.56	2.81	0.78	0.157	2.75	3.00
3/4"	1/8 NPTF	1/4-28 UNF	5/8-18	0.34	2.91	0.62	0.09	0.50	3.75	3.75	0.97	0.251	4.03	4.03
7/8"	1/8 NPTF	1/4-28 UNF	5/8-18	0.34	–	0.62	0.09	0.50	3.56	–	0.97	0.251	3.84	–
1-1/16"	1/8 NPTF	5/16-24 UNF	5/8-18	0.34	–	0.62	0.09	0.62	3.84	–	1.19	0.251	4.12	4.28
1-1/4"	1/8 NPTF	7/16-20 UNF	3/4-16	0.41	–	0.78	0.09	0.88	4.72	4.75	1.62	0.251	5.12	5.16
1-1/2"	1/8 NPTF	7/16-20 UNF	3/4-16	0.50	–	0.81	0.09	0.88	4.38	4.63	1.50	0.376	4.75	5.00
1-3/4"	1/4 NPTF	1/2-20 UNF	1-14	0.50	4.19	1.12	0.09	1.06	5.75	5.75	1.94	0.376	6.25	6.25
2"	1/4 NPTF	1/2-20 UNF	1-1/4-12	0.56	–	1.03	0.12	1.19	5.62	5.91	–	0.376	6.06	6.34
2-1/2"	1/4 NPTF	1/2-20 UNF	1-3/8-12	0.56	–	1.03	0.13	1.19	5.62	5.62	1.84	0.376	6.06	6.06
3"	3/8 NPTF	5/8-18 UNF	1-1/2-12	0.81	–	1.34	0.19	1.38	6.50	–	2.09	0.500	7.12	–

