

METRIC SET SCREW COLLARS



GMC-SERIES

Traditional cost effective collar design

Other sizes and materials available

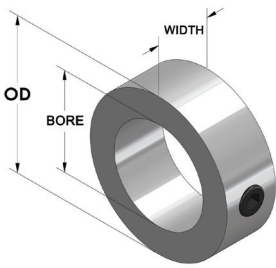

PART NUMBER		PRODUCT SPECIFICATIONS			
BLACK OXIDE STEEL	STAINLESS STEEL	BORE SIZE	OD	WIDTH	SET SCREW
GMC-03-B	GMC-03-SS	3	7	5	M2
GMC-04-B	GMC-04-SS	4	8	5	M2
GMC-05-B	GMC-05-SS	5	10	6	M3
GMC-06-B	GMC-06-SS	6	12	8	M4
GMC-08-B	GMC-08-SS	8	16	8	M4
GMC-09-B	GMC-09-SS	9	20	10	M5
GMC-10-B	GMC-10-SS	10	20	10	M5
GMC-12-B	GMC-12-SS	12	22	12	M6
GMC-13-B	GMC-13-SS	13	22	13	M6
GMC-14-B	GMC-14-SS	14	25	12	M6
GMC-15-B	GMC-15-SS	15	25	12	M6
GMC-16-B	GMC-16-SS	16	28	12	M6
GMC-18-B	GMC-18-SS	18	32	14	M6
GMC-20-B	GMC-20-SS	20	32	14	M6
GMC-22-B	GMC-22-SS	22	36	14	M6
GMC-24-B	GMC-24-SS	24	40	14	M8
GMC-25-B	GMC-25-SS	25	40	16	M8
GMC-28-B	GMC-28-SS	28	45	16	M8
GMC-30-B	GMC-30-SS	30	45	16	M8
GMC-32-B	GMC-32-SS	32	50	16	M8
GMC-34-B	GMC-34-SS	34	50	16	M8
GMC-35-B	GMC-35-SS	35	56	16	M8
GMC-36-B	GMC-36-SS	36	56	16	M8
GMC-38-B	GMC-38-SS	38	56	16	M8
GMC-40-B	GMC-40-SS	40	63	18	M10
GMC-45-B	GMC-45-SS	45	70	18	M10
GMC-50-B	GMC-50-SS	50	80	18	M10

METRIC CLAMPING COLLARS



GM1C & GM2C-SERIES

Clamping design fully engages the shaft without marring or other shaft damage

Effective on hard and soft shafts

Other sizes and materials available

1-PIECE

2-PIECE

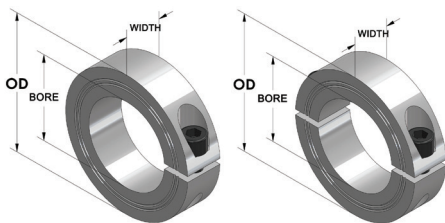

PART NUMBER				PRODUCT SPECIFICATIONS			
BLACK OXIDE STEEL (1-PIECE)	BLACK OXIDE STEEL (2-PIECE)	STAINLESS STEEL (1-PIECE)	STAINLESS STEEL (2-PIECE)	BORE SIZE	OD	WIDTH	CLAMP SCREW
GM1C-03-B	GM2C-03-B	GM1C-03-SS	GM2C-03-SS	3	16	9	M3
GM1C-04-B	GM2C-04-B	GM1C-04-SS	GM2C-04-SS	4	16	9	M3
GM1C-05-B	GM2C-05-B	GM1C-05-SS	GM2C-05-SS	5	16	9	M3
GM1C-06-B	GM2C-06-B	GM1C-06-SS	GM2C-06-SS	6	16	9	M3
GM1C-08-B	GM2C-08-B	GM1C-08-SS	GM2C-08-SS	8	18	9	M3
GM1C-09-B	GM2C-09-B	GM1C-09-SS	GM2C-09-SS	9	24	9	M3
GM1C-10-B	GM2C-10-B	GM1C-10-SS	GM2C-10-SS	10	24	9	M3
GM1C-12-B	GM2C-12-B	GM1C-12-SS	GM2C-12-SS	12	28	11	M4
GM1C-13-B	GM2C-13-B	GM1C-13-SS	GM2C-13-SS	13	30	11	M4
GM1C-14-B	GM2C-14-B	GM1C-14-SS	GM2C-14-SS	14	30	11	M4
GM1C-15-B	GM2C-15-B	GM1C-15-SS	GM2C-15-SS	15	34	13	M5
GM1C-16-B	GM2C-16-B	GM1C-16-SS	GM2C-16-SS	16	34	13	M5
GM1C-17-B	GM2C-17-B	GM1C-17-SS	GM2C-17-SS	17	36	13	M5
GM1C-18-B	GM2C-18-B	GM1C-18-SS	GM2C-18-SS	18	36	13	M5
GM1C-20-B	GM2C-20-B	GM1C-20-SS	GM2C-20-SS	20	40	15	M6
GM1C-25-B	GM2C-25-B	GM1C-25-SS	GM2C-25-SS	25	45	15	M6
GM1C-30-B	GM2C-30-B	GM1C-30-SS	GM2C-30-SS	30	54	15	M6
GM1C-35-B	GM2C-35-B	GM1C-35-SS	GM2C-35-SS	35	57	15	M6
GM1C-40-B	GM2C-40-B	GM1C-40-SS	GM2C-40-SS	40	60	15	M6
GM1C-45-B	GM2C-45-B	GM1C-45-SS	GM2C-45-SS	45	73	19	M8
GM1C-50-B	GM2C-50-B	GM1C-50-SS	GM2C-50-SS	50	78	19	M8
GM1C-55-B	GM2C-55-B	GM1C-55-SS	GM2C-55-SS	55	82	19	M8
GM1C-60-B	GM2C-60-B	GM1C-60-SS	GM2C-60-SS	60	88	19	M8
GM1C-65-B	GM2C-65-B	GM1C-65-SS	GM2C-65-SS	65	93	19	M8
GM1C-70-B	GM2C-70-B	GM1C-70-SS	GM2C-70-SS	70	98	19	M8
GM1C-75-B	GM2C-75-B	GM1C-75-SS	GM2C-75-SS	75	103	19	M8
GM1C-80-B	GM2C-80-B	GM1C-80-SS	GM2C-80-SS	80	108	19	M8