

Single Strand Hollow Pin Chains

Dimensions: inch

PEER Chain No.	Pitch P	Bushing		Plate		Pin		Overall Width		Average Ultimate Strength Lbs.	Average Weight Per Foot Lbs.
		Width	Diam.	Height	Thickness	Diam.	Ins. Diam.	F	G		
		W	R	H	T	D	D2				
40 HP	0.500	0.312	0.312	0.463	0.059	0.223	0.157	0.319	0.358	2,700	0.36
50 HP	0.625	0.375	0.400	0.579	0.077	0.286	0.202	0.394	0.453	4,500	0.58
60 HP	0.750	0.500	0.469	0.673	0.094	0.331	0.235	0.492	0.547	6,100	0.86
80 HP	1.000	0.625	0.625	0.935	0.125	0.449	0.318	0.638	0.695	11,400	1.48

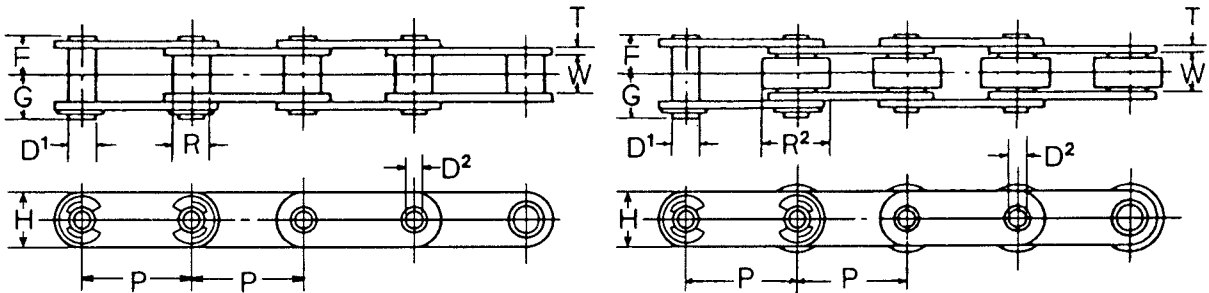

Extended Pitch Hollow Pin Chains

Dimensions: inch

PEER Chain No.	Pitch P	Bushing		Roller Diam. R2	Plate		Pin		Overall Width		Average Ultimate Strength Lbs.	Average Weight Per Foot Lbs.
		Width	Diam.		Height	Thickness	Diam.	Ins. Diam.	F	G		
		W	R		H	T	D1	D2				
C2040 HP	1.000	0.312	0.312	-	0.463	0.059	0.223	0.157	0.319	0.358	2,700	0.31
C2042 HP	1.000	0.312	-	0.625	0.463	0.059	0.223	0.157	0.319	0.358	2,700	0.55
C2050 HP	1.250	0.375	0.400	-	0.579	0.077	0.286	0.202	0.394	0.453	4,500	0.51
C2052 HP	1.250	0.375	-	0.750	0.579	0.077	0.286	0.202	0.394	0.453	4,500	0.82
C2060 HP	1.500	0.500	0.469	-	0.673	0.094	0.331	0.237	0.492	0.547	6,100	0.84
C2062 HP	1.500	0.500	-	0.875	0.673	0.094	0.331	0.237	0.492	0.547	6,100	1.32
C2080 HP	2.000	0.625	0.625	-	0.935	0.125	0.449	0.316	0.638	0.695	11,400	1.41
C2082 HP	2.000	0.625	-	1.125	0.935	0.125	0.449	0.316	0.638	0.695	11,400	2.25