

ENGINEERING CHAINS 400 SERIES PINTLE & ATTACHMENTS

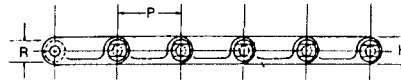
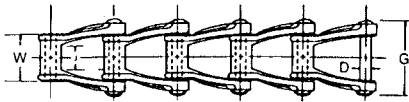

400 Series Pintle Chains

Dimensions: inch

PEER Chain No.	Pitch P	Bearing Area			Pin Diam. D	Plate Height H	Overall Width Riveted G	Average Tensile Strength Lbs.	Average Weight Per Foot Lbs.
		Width Over Bearing W	Diam. R	Max. Allow Sprocket Face J					
442	1.375	1.060	0.560	0.620	0.310	0.750	1.875	6,000	1.40
445	1.630	1.060	0.620	0.690	0.310	0.750	1.875	6,000	1.50
452	1.506	1.088	0.690	0.620	0.375	0.838	2.060	7,000	2.00
455	1.630	1.120	0.620	0.690	0.375	0.838	2.060	7,300	1.90
462	1.634	1.440	0.720	0.880	0.438	0.938	2.375	8,800	2.50
477	2.308	1.250	0.720	0.690	0.438	1.000	2.250	9,600	2.00
488	2.609	1.618	0.880	0.940	0.438	0.938	2.750	11,000	2.90
4103	3.075	1.875	1.250	1.120	0.750	1.500	3.250	27,000	5.70

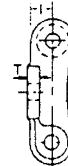
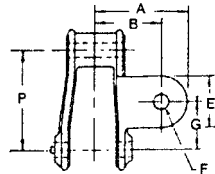

A-1 Attachments

Dimensions: inch

PEER Chain No.	Pitch P	A	B	E	F	G	I	T
445 A-1(R)	1.630	1.594	1.160	0.880	0.280	0.750	0.375	0.188
445 A-1(L)	1.630	1.594	1.160	0.880	0.280	0.750	0.375	0.188

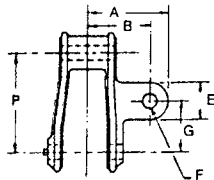

A-2 Attachments

Dimensions: inch

PEER Chain No.	Pitch P	A	B	E	F	G	T
477 A-22	2.308	1.938	1.500	0.880	0.340	1.120	0.250

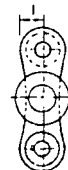
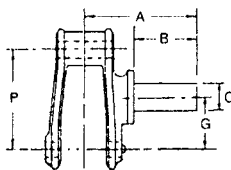

D-5 Attachments

Dimensions: inch

PEER Chain No.	Pitch P	A	B	C	G	I
452 D-5	1.506	2.500	1.590	0.560	0.750	0.375
477 D-5	2.308	2.750	1.500	0.621	1.118	0.620

ENGINEERING CHAINS 400 SERIES PINTLE & ATTACHMENTS

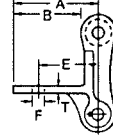
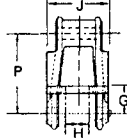

F-2 Attachments

Dimensions: inch

PEER Chain No.	Pitch P	A	B	E	F	G	H	J	T
445 F-2	1.630	1.280	0.910	0.940	0.236	0.620	1.060	1.500	0.160
455 F-2	1.630	1.250	0.810	0.940	0.236	0.620	1.060	1.810	0.160
462 F-2	1.634	1.308	0.810	1.000	0.236	0.620	1.060	2.090	0.160
477 F-2	2.308	2.000	1.500	1.438	0.374	0.750	1.750	2.620	0.250
488 F-2	2.609	1.980	1.500	1.375	0.374	1.060	2.030	2.875	0.280
4103 F-2	3.075	2.658	1.908	2.000	0.408	1.250	2.220	3.120	0.310

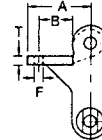
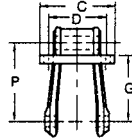

F-29 Attachments

Dimensions: inch

PEER Chain No.	Pitch P	A	B	C	D	F	G	T
4103 F-29	3.075	2.690	1.250	3.120	2.220	0.410	2.620	0.410

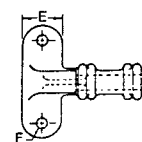
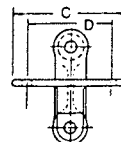
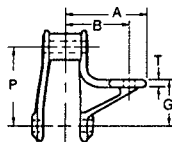

G-19 Attachments

Dimensions: inch

PEER Chain No.	Pitch P	A	B	C	D	E	F	G	T
477 G-19	2.308	2.280	1.720	3.250	2.250	1.120	0.410	1.310	0.188
488 G-19	2.609	2.688	2.000	3.620	2.620	1.375	0.340	1.375	0.220

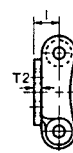
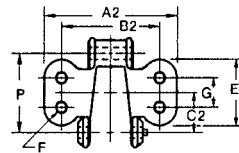
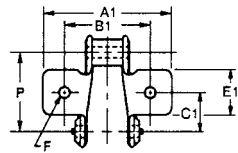

K-1 / K-2 Attachments

Dimensions: inch

PEER Chain No.	Pitch P	A1	A2	B1	B2	C1	C2	E1	E2	F	G	I	T1	T2
445 K-1	1.630	2.810	-	2.060	-	0.720	-	0.940	-	0.250	-	0.440	0.120	-
452 K-1	1.506	2.750	-	2.060	-	0.750	-	0.720	-	0.250	-	0.440	0.156	-
455 K-1	1.630	2.875	-	2.000	-	0.810	-	0.810	-	0.315	-	0.440	0.156	-
462 K-1	1.634	3.250	-	2.375	-	0.810	-	0.940	-	0.315	-	0.500	0.156	-
477 K-1	2.308	3.940	-	3.000	-	1.160	-	1.375	-	0.315	-	0.660	0.156	-
477 K-2	2.308	-	4.000	-	3.000	-	1.160	-	1.560	0.315	0.810	0.660	-	0.012
488 K-1	2.609	4.750	-	3.810	-	1.310	-	1.375	-	0.374	-	0.660	0.188	-
488 K-2	2.609	-	4.500	-	3.620	-	1.280	-	2.120	0.374	1.250	0.660	-	0.188
4103 K-1	3.075	5.440	-	4.188	-	1.500	-	1.720	-	0.433	-	0.812	0.220	-
4103 K-2	3.075	-	5.250	-	4.120	-	1.530	-	2.620	0.560	1.500	0.840	-	0.310