



Toyota Camry 2002-2006

PART NUMBER: MV-50-03-G3



PLEASE READ COMPLETE INSTRUCTIONS BEFORE INSTALLING THIS VSM G3

All instructions assume a drivers seat vantage point. Caution is advised when removing and reassembling wood or plastic parts of a dash. Applying unnecessary force or pressure may cause a piece to crack or break.

**When properly installed, the metal between the ball and 2 small holes is all that is exposed.
(Some exceptions apply).**

TOOLS REQUIRED: #2 Phillips screwdriver, drill and 5/64" bit, Dash Trim Removal Tool (DTRT), marking pen

PARTS INCLUDED: VSM G3, A Plate, J Stem, two (2) #8 x 1/2" screws

LOCATION: Below climate control - Left or right side

STEP 1. Begin by removing the climate control panel located below the cassette player. Insert a DTRT behind the climate control panel and pry out gently until all four (4) clips are loose. (Photo #1). Let the panel hang downward.

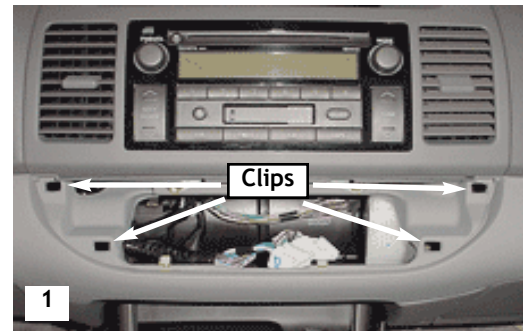

STEP 2. Place the VSM G3 on the left or right side of the bottom of the climate control cavity. (Photos 2-4). Using the VSM G3 as a guide, mark the location of the top and bottom holes. Drill two (2) pilot holes at the marked location using a 5/64" drill bit and drill. Align the G3 over the pilot holes, insert two (2) #8 x 1/2" screws and tighten.

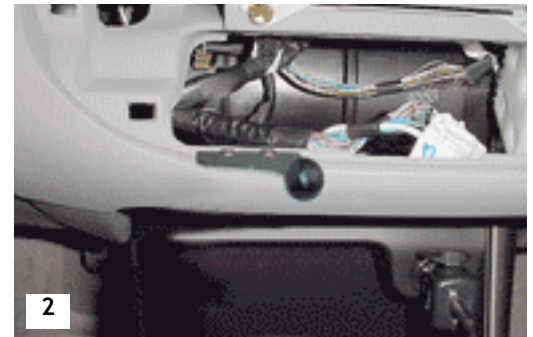

STEP 3. Assemble the dash in reverse order. This completes the installation of your VSM G3.

Photos 3 and 4 show optional mounting positions.

Note: See the Assembly Instructions for G3 Components for additional information.



Pro.Fit International, Inc.® may not be held liable for any damage to a vehicle before, during or after the installation or removal of this VSM G3™. Pro.Fit International may not be held liable for any personal injury resulting from accident or improper installation. Pro.Fit International, Inc.® 1335 Eagandale Court, Eagan, MN 55121, Ph: 651.688.3588 or 800.388.0073 Fx: 651.688.9876

Installation Difficulty
 ● ● ○ ○ ○
 Simple Advanced

© Pro.Fit International, Eagan, MN 2008

View Instruction & Updates
 Online at
www.pro-fit-intl.com