

Know your Miro humidifier

MH7000

miro

User Manual

- 1 Read the QR code using your mobile phone.

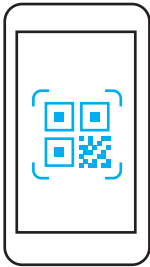

- 2 Click the link that pops up when you scan the QR code.

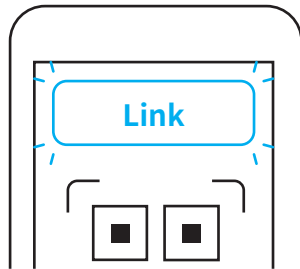

Scan the QR code below
and watch a quick how-to video.



Thank you for choosing Miro. We are glad to see you here.

Please read the user manual thoroughly before using the Miro humidifier. Please carefully read, understand, and follow all warnings and instructions.

The warranty information can be found in this user manual. Please keep this user manual for future use.

Please reach out to us using our support site: <https://support.mirohome.com>.



**Please email us at
support@mirohome.com
if you have any questions**

Table of contents

In The Box	6	Connecting the Power Cable	
Humidifier Modules	7	Connecting your humidifier to a power source	
Miro Humidifier			
Main Unit			
Touch Station			
Remote Controller			
Main Unit Assembly	10	How to Use the Touch Station	19
Assembling Miro Humidifier	11	Powering on/off	
Filling up the Stainless Steel Water Bowl		Mist output setting	
Placing the Stainless Steel Water Bowl		Low water-level indicator	
Floating the Main Unit		Child-lock on/off	
Inserting Cable Holder		Timer	
Installing Humidifier Case		Silent mode on/off	
Placing the Water Bowl Cover		Changing Brightness & Color	
Placing Outer Vapor Cap		UV Indicator	
Placing Directional Cap		How to Use the Remote Controller	24
Connecting Magnetic Connector		Smart Humidifier (miroT)	25
		Connecting miroT	
		miroT Installation & User Guide	

How to Clean Your Humidifier 27

Cleaning the Main Unit

Cleaning the UV Mist-maker engine

Frequently Asked Questions 34

**Please Read Before Use
For Your Safety** 38

Product Specifications 40

Warranty Disclaimer 41

**Miro Customer Service
(support.mirohome.com)** 41

In The Box

Please make sure all modules are in the box.
Contact support@mirohome.com if any module is missing.

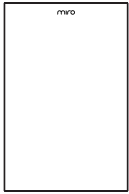

Humidifier Case

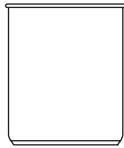

Stainless Steel
Water Bowl

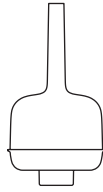

Main Unit



Outer Vapor Cap

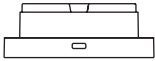

Touch Station

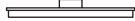

Water Bowl Cover



UV Mist-maker
engine



Directional Cap

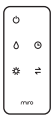

Remote Controller

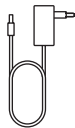

DC Adapter

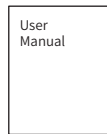

User Manual

Tip

Do not use any tough scrubber/sponge to clean the Stainless Steel Water Bowl.
Please make sure to clean the unit with a soft sponge and dish soap.

Humidifier Modules

Miro Humidifier

Directional Cap _____



Outer Vapor Cap _____



Water Bowl
Cover _____



Main Unit
[\(Please see page 8 for details\)](#)

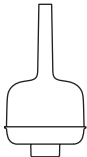

Stainless Steel
Water Bowl _____



Humidifier
Case _____

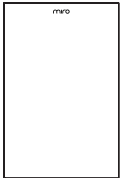

Touch Station _____



Main Unit

Outer Funnel _____

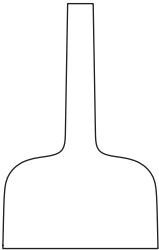

UV Mist-maker engine _____

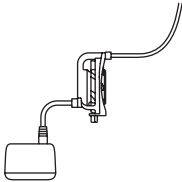

Inner Funnel _____

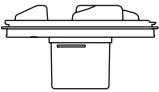

Balance Weight _____



Floating Base _____



Touch Station

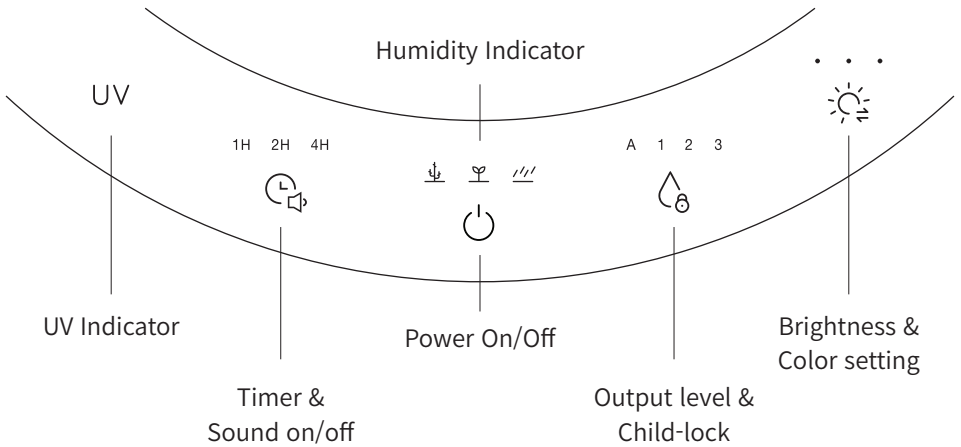

Remote Controller

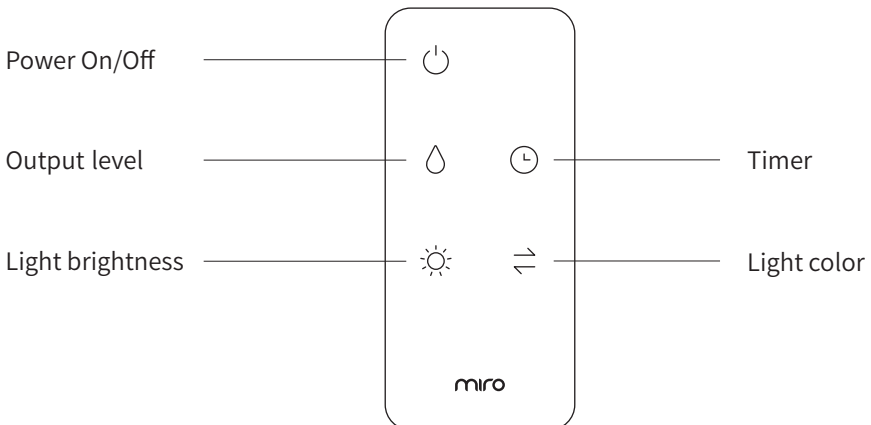

Main Unit Assembly

- 1 Align the UV Mist-maker engine with Inner Funnel. See Diagram 1-1 for details.
- 2 Align the Mist-maker fan inserts to the holes on the Inner Funnel. Push it in. See Diagram 1-1 for details.
- 3 Push in the Outer Funnel as shown in the Diagram 1-2.

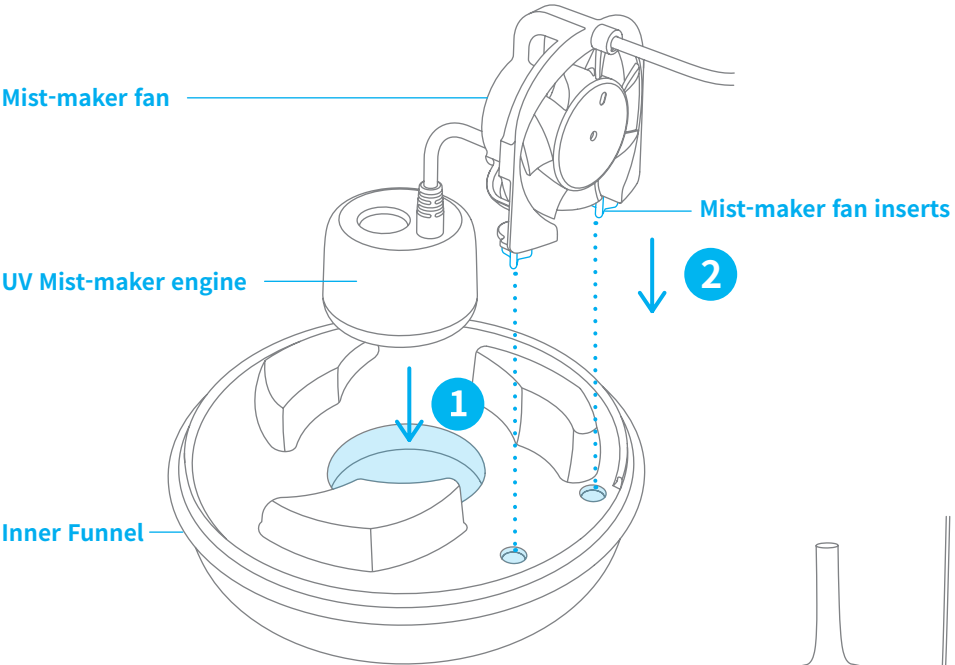

Diagram 1-1

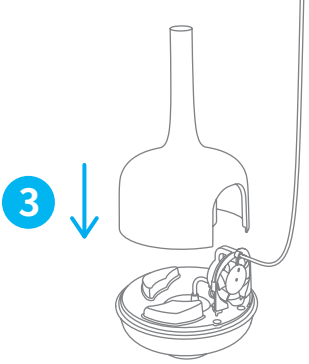

Diagram 1-2

Assembling Miro Humidifier

01. Filling up the Stainless Steel Water Bowl

Fill the water up to the bottom MAX line. The top MAX line indicates the maximum amount of water when the Main Unit is floating.

Warning

Please clean your Stainless Steel Water Bowl using a mild dish detergent before using your humidifier for the first time.

Do NOT

Using hot water, hard water, or contaminated water can permanently damage the unit.

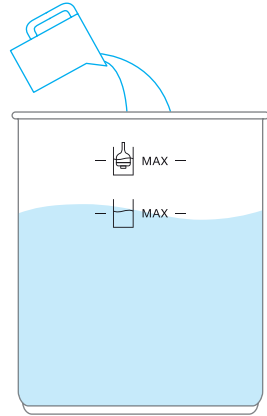

Stainless Steel Water Bowl

Please do not overfill the Stainless Steel Water Bowl

Overfilling the Water Bowl may cause the humidity output to decrease due to reduced airflow.

Top Max Line

Use this MAX indicator line if you are filling it up with the Main Unit inside.



Bottom Max Line

Use this MAX indicator line if you are filling it up without the Main Unit inside.



02. Placing the Stainless Steel Water Bowl

Place your Touch Station on a flat surface.
Use the guide to properly place your
Stainless Steel Water Bowl.

Warning

Please be careful when handling
the Stainless Steel Water Bowl.
Do not spill water on the Touch Station.

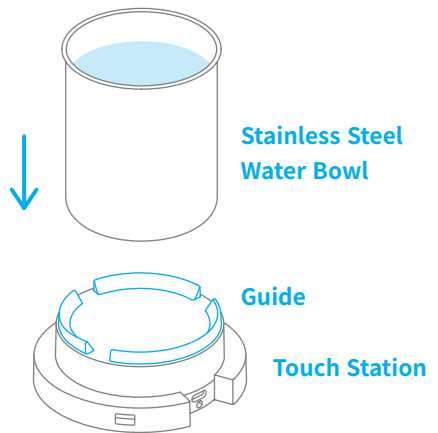

03. Floating the Main Unit

Float the assembled Main Unit in the Stainless
Steel Water Bowl. Make sure to take the
Magnetic Connector out.

Warning

Keep the magnetic connector
completely dry.

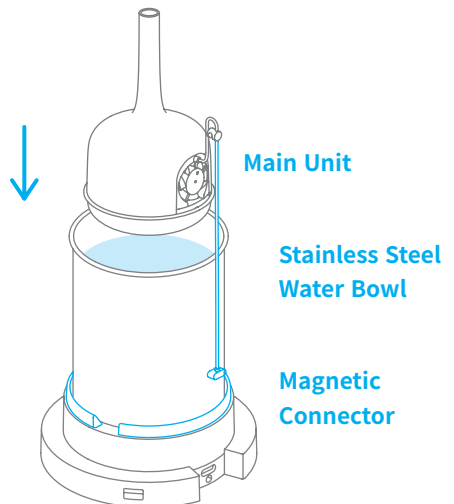

04. Inserting Cable Holder

Align the Cable Holder to Stainless Steel Water Bowl and connect it in place.

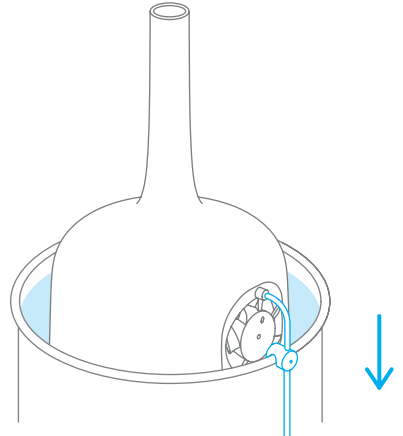
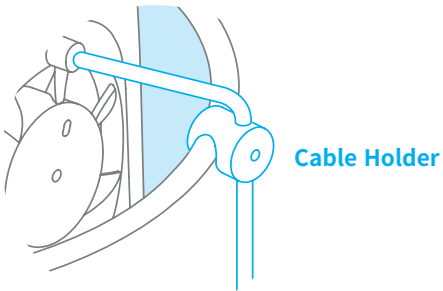

05. Installing Humidifier Case

Align the Humidifier Case to Stainless Steel Water Bowl and place it down.

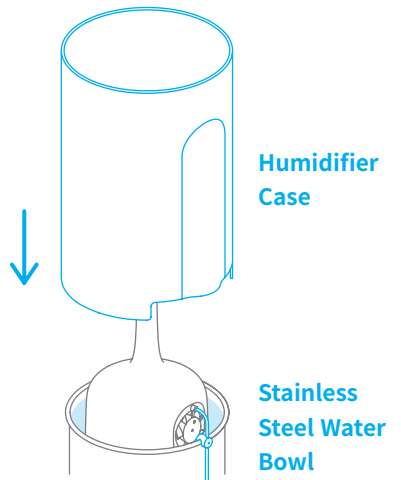

06. Placing the Water Bowl Cover

Place the Water Bowl Cover on top of the Humidifier Case.

Warning

Please do not overfill the Stainless Steel Water Bowl. Humidifier may not work if you overfill the water bowl.

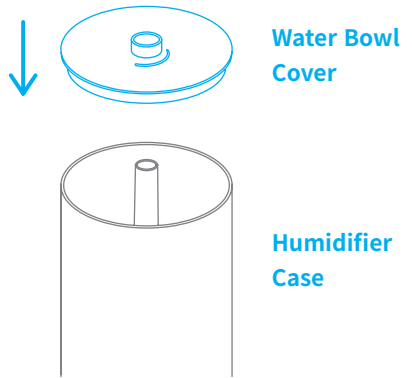

07. Placing the Outer Vapor Cap

Place the Outer Vapor Cap into the Water Bowl Cover.
Using Outer Vapor Cap will reduce condensation.

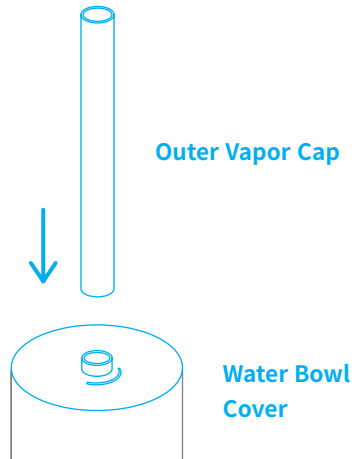

08. Placing Directional Caps (Directional/Straight)

Place the cap of your choosing on top of the Outer Vapor Cap.

Tip

The Directional Cap will shoot the mist at a slight angle while the Straight Cap will shoot the mist straight up.

Tip

You can turn the Directional Cap to desired direction.

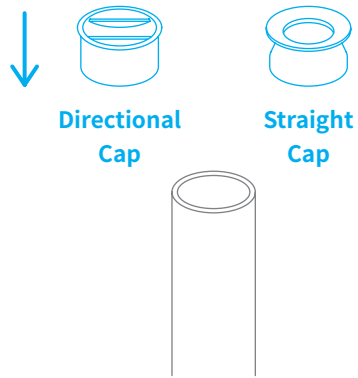

09. Connecting Magnetic Connector

Connect the Magnetic Connector into the Touch Station.

Warning

Please connect the Magnetic Connector to the Touch Station before connecting the DC Adapter to a power source.

Warning

Never pull the wire when disconnecting. Disconnect by lightly holding the base of the Magnetic Connector and pulling it off the Touch Station lightly.

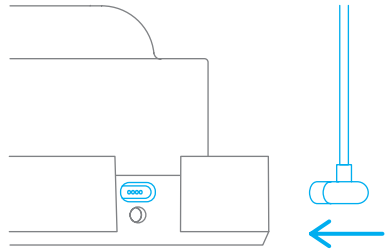

10. Connecting the Power Cable

Please connect the DC Adapter to the Touch Station.

Warning

Please connect the Magnetic Connector to the Touch Station before connecting the DC Adapter to a power source.

Warning

Never pull the wire when disconnecting. Disconnect by lightly holding the base of the DC Adapter and gently pulling it out.

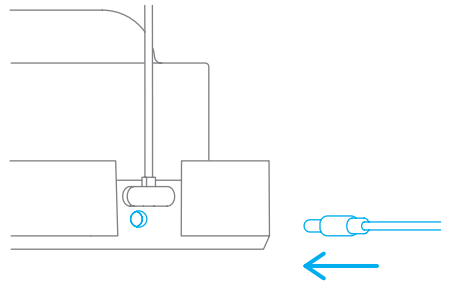

11. Connecting your humidifier to a power source

Please connect to a secure power source.
[Turn to page 19](#) for details on the Touch Station.

Warning

Make sure your hands are completely dry.
Do not follow this step if your hands are wet.

Warning

Please do not pull the wire when unplugging.

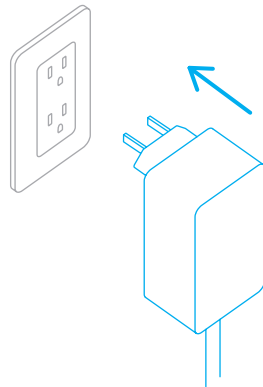

Maintain distance from the wall

Maintaining 2ft away from the wall helps the circulation of vapor from the humidifier, maximizing the humidifier efficiency.

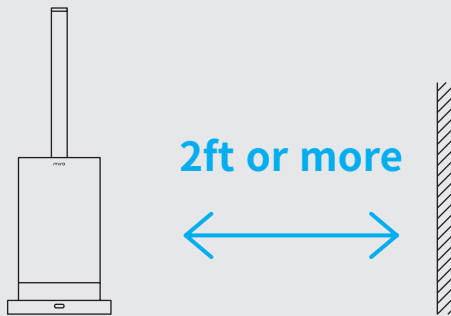

Maintain at least 8ft away from the Miro Air Purifier

The sensor from Miro Air Purifier will detect the vapor particles from the humidifier. This may cause the air purifier to perform at its highest output. Please set the Air Purifier power level to one if humidifier has to be used nearby.



Water level sensor

We use Stainless Steel Water Bowl to maximize UV disinfecting feature. You may feel a slight electric current. This is not harmful to humans.

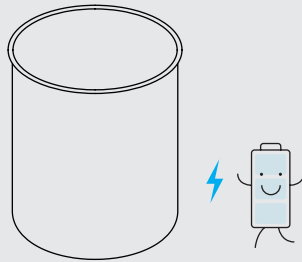

Surface condensation

There may be slight condensation inside the UV light glass due to difference in temperatures. This has no impact on the efficacy of UV disinfecting process.

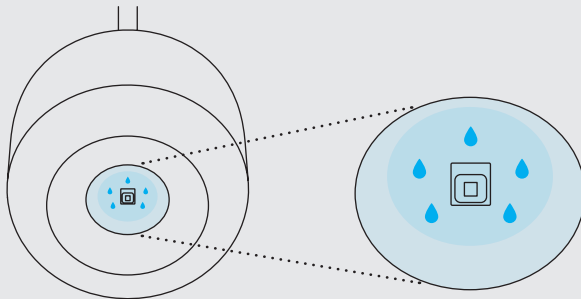

How to Use the Touch Station

Powering on/off

Tap the power icon to turn the humidifier on and off. When you turn on the humidifier, the output level will be on 'automatic' mode, light color will be 'warm white', and light brightness will be set to level 3 brightness.



Tip

The humidifier will automatically turn to snooze mode after 25 seconds of inactivity.

Tip

Your humidifier will remember your mist output setting, light setting, and touch volume setting as long as the power is uninterrupted.

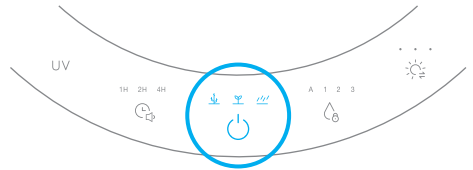

Humidity Level

Your humidifier is equipped with a sensor that can detect your environment's humidity.

Indicator	Humidity Level
Dry (㇀)	<40%
Good (㇁)	40~60%
Humid (㇂)	60% <



Mist output setting

You can adjust the mist output level to automatic. You can also set it to a specific output level from 1 to 3 by pressing the 'output level' icon (Automatic, Level 1, Level 2, Level 3, OFF).

Output Level	LED
Automatic	A
Level 1	1
Level 2	2
Level 3	3

Tip

Please refer [back to page 10](#) if your humidifier is not working properly. If you cannot self-diagnose, please reach us at support@mirohome.com



Mist Output Setting



Automatic Mode (A)

Automatic mode will use the humidity sensor in your humidifier to determine the output settings. The humidifier will automatically try to achieve the optimal humidity level of 40 ~ 60%.

Output Level	Humidity Level
OFF	60%<
Level 1	40~60%
Level 2	20~40%
Level 3	<20%

Tip

The internal humidity sensor may detect different levels from 3rd party external sensors.

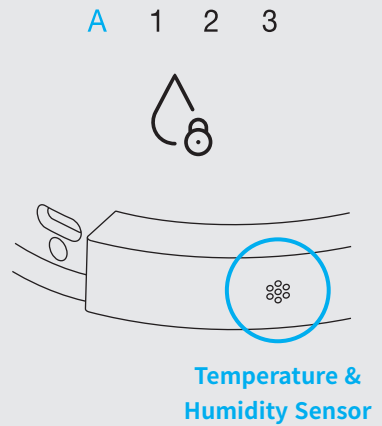

Child-lock on/off

Long press(2 seconds) the humidity output level button to toggle the child-lock function on/off. The icon will blink twice when child-lock function is enabled. The touch station will lock and become unresponsive. Long press the humidity output level button to disable the child-lock function.

Tip

Use the miroT to enable your humidifier's smart features. You can use the Miro Smart Home mobile application to change settings even if the child-lock function is enabled.

Tip

Use the child-lock feature to ensure that your humidifier runs without any interruption.

Low water-level indicator

The UV disinfection will stop if the water level drops below 1/3 of the Stainless Steel Water Bowl. The Humidity Output Level Button will start blinking. Please refill the Water Bowl.



Humidity Output Level Button

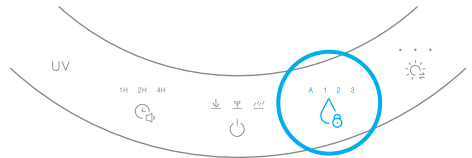

**Long press
(2 seconds)**



Humidity Output Level Button



Timer

Press the 'timer' icon to set the timer up to 7 hours.

Timer	LED Light
1 hour	1H
2 hour	2H
3 hour	1H, 2H
4 hour	4H
5 hour	1H, 4H
6 hour	2H, 4H
7 hour	1H, 2H, 4H



Timer button

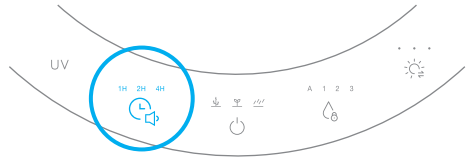

Silent mode on/off

Long press(2 seconds) the 'timer' icon to enable/disable the silent mode.



Timer button



Long press
(2 seconds)

Changing Brightness & Color

Set the light brightness by pressing the button shown in the Diagram (Level 3 - Level 2 - Level 1 - OFF)

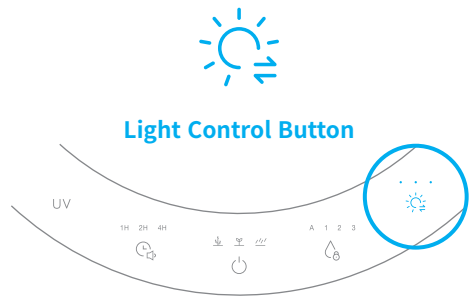

UV Indicator

The UV disinfecting process will begin once the UV indicator light is on. This will disinfect the water to ensure that the mist is clean. This feature only works when humidifier is in operation.

Tip

Discoloration will occur naturally because of the UV light. This is natural and not covered by the Warranty.

Tip

UV light will disinfect and clean the water. However, the modules will require frequent cleaning.

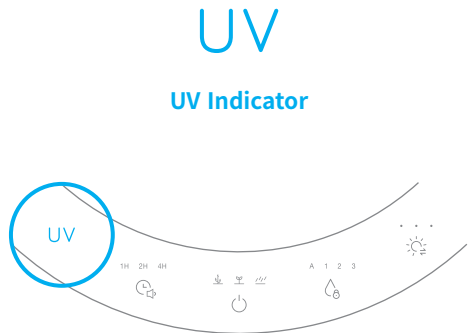

How to Use the Remote Controller

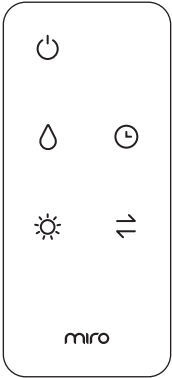

Icon	Name	Description
	Power on/off	Turn your humidifier on/off.
	Mist output settings	Change mist output settings (Auto - Level 1 - Level 2 - Level 3 - OFF)
	Timer settings	Change timer settings (1 hour - 2 hours - 3 hours - 4 hours - 5 hours - 6 hours - 7 hours - OFF)
	Brightness settings	Change brightness level (Level 3 - Level 2 - Level 1 - OFF)
	Color settings	Change color settings (White/Warm White)

Smart Humidifier (miroT) sold separately

Turn your humidifier into a smart appliance by connecting miroT. Your humidifier can connect to Miro Smart Home app, Alexa, Google Home, and other platforms once miroT is installed.

01. Installing miroT

Get your miroT ready

- 1 Find a slot on the side of the touch station as shown in the Diagram C1-1.
- 2 Push the miroT into the slot as shown in Diagram C1-2.

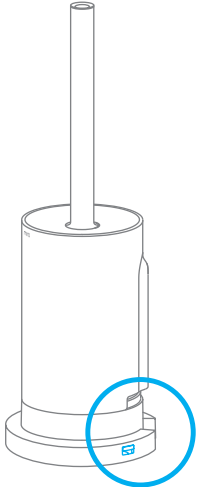

miroT slot cover

Diagram C1-1

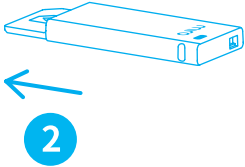
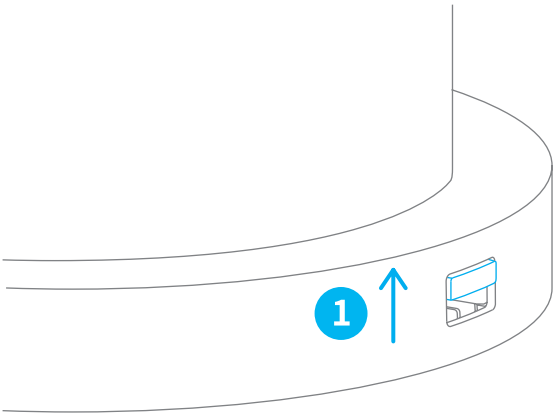

Diagram C1-2

02. miroT Installation & User Guide

Scan the QR code to get to miroT User Guide.

Warning

Make sure to place your smart appliance where you have strong Wi-Fi signal.

Tip

miroT can be purchased on shop.mirohome.com. Please check the compatibility before purchasing.



miroT User Guide

Purchase your miroT

Please go to shop.mirohome.com to purchase your miroT. You can also scan the QR code to get to the miroT page.

miroT Page



How to Clean Your Humidifier

Every module that touches water can be cleaned easily and thoroughly.

Modules that can be cleaned

Please make sure to disconnect your humidifier from power before cleaning. Use soft dish sponge and mild dish soap to clean the modules.



Humidifier Case



Stainless Steel Water Bowl



Water Bowl Cover



Outer Vapor Cap

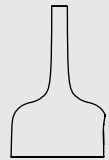

Outer Funnel



Inner Funnel



UV Mist-maker engine

(Keep the Magnetic Connector dry.)



Balance Weight



Straight Cap



Directional Cap

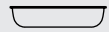

Floating Base

Warning

Please use gentle dish soap and sponge to clean the Stainless Steel Water Bowl. Using rough sponge or other cleaning materials will damage the module. Please keep the Magnetic Connector dry at all times.

Tip

Discoloration will occur naturally because of the UV light. This is natural and not covered by the Warranty.

Do NOT wash these modules **MUST READ**

Touch Station, DC Adapter, and the Magnetic Connector (connected to the Mist-maker engine) must stay out of water. These modules are not waterproof. Keep them dry at all times.



Touch Station

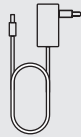

DC Adapter

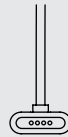

Magnetic Connector
(UV Mist-maker engine)

Please read before cleaning!

- Keep the Magnetic Connector dry at all times. Cover it with the cap before cleaning your Mist-maker engine/fan.
- Do NOT use a tough scrubber. It will damage the unit.
- Do NOT use any harsh chemicals including but not excluded to vinegar, acidic liquid, and baking soda.
- Do NOT use hot water or boiling water to sterilize the unit. This is not necessary and it will damage the unit.

01. Cleaning the Main Unit

- 1 Pull the Outer Funnel up to disassemble your Main Unit.
- 2 Pull the UV Mist-maker engine/fan out to further disassemble the Main Unit.

Warning

Please keep the Magnetic Connector dry when cleaning the Mist-maker engine/fan.

Warning

Use a gentle dish sponge and mild dish soap to clean the modules.
Do not use anything harsh.

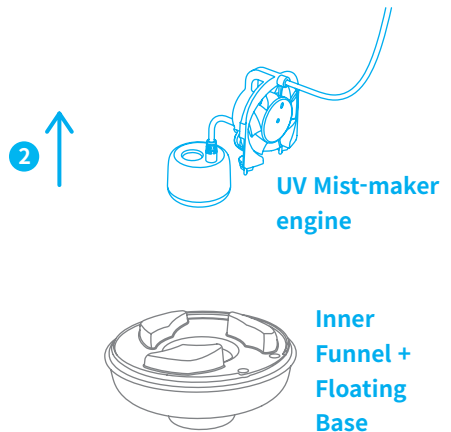
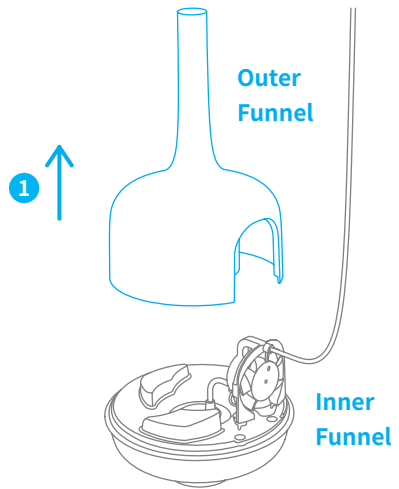

02. Cleaning the UV Mist-maker engine

Use the Magnetic Connector Cap to cover the Magnetic Connector before cleaning the Mist-maker engine/fan.

Warning

Your Mist-maker may malfunction if the Magnetic Connector gets wet.

Warning

Please handle the Mist-maker engine/fan gently. Do not put too much pressure in the engine. The glass may break if it is not handled with care.

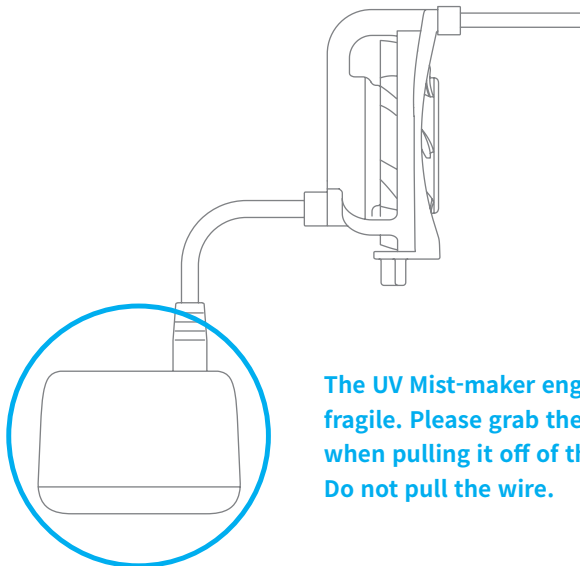
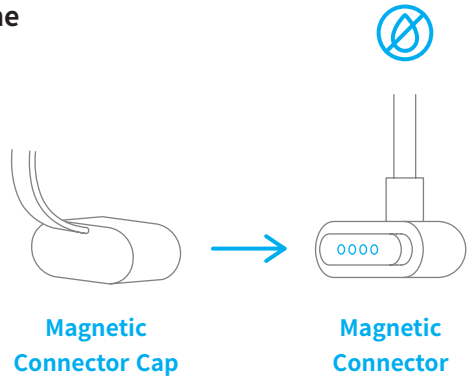

UV Mist-maker engine

The UV Mist-maker engine is extremely fragile. Please grab the circled part when pulling it off of the Floating Base. Do not pull the wire.

Deep cleaning your Main Unit

Cleaning Floating Base

Disassemble your Main Unit and use mild dish soap and soft sponge to clean. Make sure there's no water inside the Floating Base during reassembly.

Warning

Water in the Floating Base may cause your humidifier to malfunction.

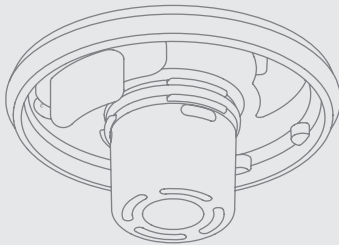
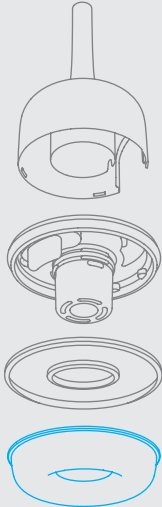

Inner Funnel

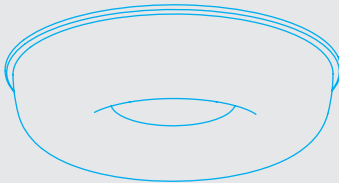

Floating Base

Deep cleaning your Main Unit

Cleaning the Inner Funnel Weight

Pull out the weight from the Inner Funnel. Clean it using mild dish soap and soft sponge. Make sure to dry everything before reassembly.

Warning

Your mist output will decrease without the weight.



※ Please make sure to put the weight back to its original position.

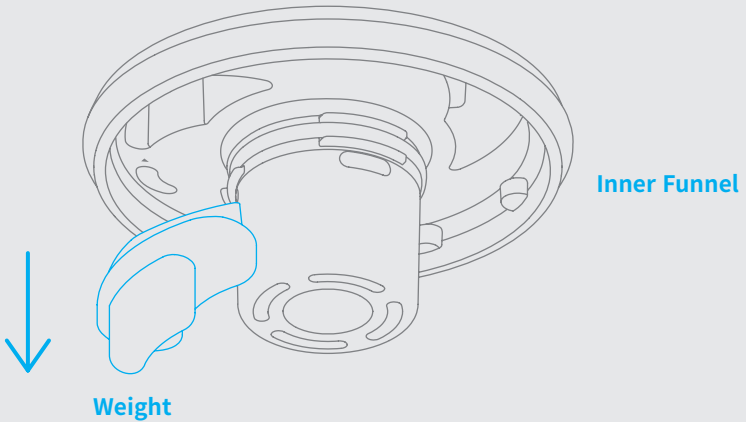

Deep cleaning your Main Unit

Cleaning the Inner Funnel Silicone Lining & Silicone

Gently take apart the silicone of the Inner Funnel to clean it with dish soap and sponge. Make sure to re-assemble it.

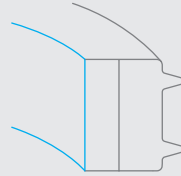

Inner Funnel Silicone Lining

Warning

The Main Unit will malfunction without the silicone lining.

Warning

Please use a dull tool to pull the silicone lining off of the Inner Funnel. Do not pull hard.

Outer
Silicone Lining

Inner
Silicone Lining

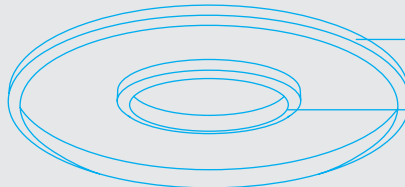
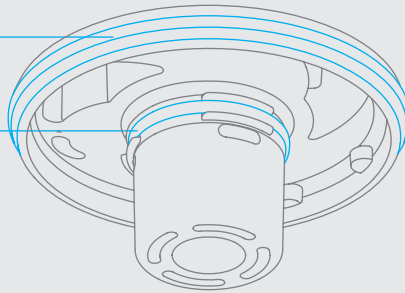

Outer Silicone

Inner Silicone

Frequently Asked Questions (FAQs)

Please find the frequently asked questions below.

If you continue to have issues with the humidifier, please create a problem ticket on support.mirohome.com or send us an email at support@mirohome.com.

Issue	Check First	Possible Solution
Humidifier does not work.	<ol style="list-style-type: none">1) Is the DC Adapter connected to a power source?2) Is the Magnetic Connector connected properly?3) Is everything connected to the Touch Station?	<ol style="list-style-type: none">1) Please connect the DC Adapter to a power source.2) Please reconnect the UV Mist-maker engine/fan Magnetic Connector.3) Please check all the connections and reconnect everything to the Touch Station.
There is water condensation around the humidifier.	<p>There are various reasons as to why the water condensation may be happening.</p> <p>Have you connected the Outer Vapor Cap?</p>	<p>The temperature and humidity may be causing the water condensation. When the air is completely saturated(humid) the mist will fall to the ground and cause water condensation. Reduce the output level and try to open the window every four hours.</p> <p>Using the Outer Vapor Cap may reduce the condensation. Please try to reduce the mist out put if the condensation is still occurring.</p>

Issue	Check First	Possible Solution
My humidifier will not make any mists.	Is the water too hot?	Please use lukewarm water for maximum performance.
	Is the water level too low?	Please refill the Water Bowl. The humidifier will stop running when there is about an inch level of water left. Please refill to keep using the humidifier.
	Is the Mist-maker and fan installed correctly?	Please refer to page 10~16 and install the modules correctly.
	Is the bottom of the Main Unit clean?	Please clean the bottom of the Main Unit to eliminate any blockage.
	Are there any soapy and/or oily contents on the UV Mist-maker engine/fan?	Please refer back to page 28 to learn how to clean your Mist-maker engine/fan.
	Is the Mist-maker fan running?	If the Mist-maker fan is not running, please contact us via support@mirohome.com . You can create a support ticket using support.mirohome.com .

Issue	Check First	Possible Solution
UV light is off.	Is the water level low?	UV function will automatically turn off if the water level is low. Please refill your water bowl.
	Are all the wires connected? Is the power on?	Please make sure all the wires are connected. Reconnect everything and power on the humidifier.
Humidity does not increase even when the humidifier is on.	Did you leave your window open? Is there a continuous airflow?	Humidity is affected by the size of the room, temperature, and ventilation. Please make sure to keep your windows closed to increase the humidity in your environment. Miro recommends using the humidifier in an enclosed space.
What type of water can I use?		You can use any type of water. Miro recommends using distilled or purified water for maximum performance.

Issue	Check First	Possible Solution
My room gets foggy whenever I use the Miro humidifier.	Is there limited ventilation in your room and completely closed off?	The continuous output and increase in humidity in a completely closed off space will make the air look foggy. Please reduce the output level and ventilate your space.
The dust level increases whenever I use the humidifier.	Is there at least 8ft between the air purifier and the humidifier?	Some sensors may recognize water vapor as dust particles. Please maintain at least 8ft between the humidifier and the air purifier.
The color of the flame from my gas cooktop changes whenever I turn on the humidifier.	Did the color of the flame change from blue to red?	This is a common occurrence. The flame color will change when your environment is high in humidity. Please don't be alarmed and continue to use your humidifier.
My humidifier is too loud.		Please use all the modules of the humidifier to reduce noise. If the unit is still too loud, please contact us at support@mirohome.com .

Issue	Check First	Possible Solution
My humidifier looks damaged/deformed after cleaning.	Did you wash the Touch Station and DC Adapter with liquid?	The Touch Station and DC Adapter should NOT be washed. They are not waterproof. Please do NOT wash them. Doing so will void your warranty.
	Did you use vinegar to clean your humidifier?	Please only use dish soap and sponge to clean your humidifier. We don't recommend using vinegar or any other chemical solution. Not only is it more difficult to clean using those chemical solution, it may also degrade your humidifier over time. We designed all Miro humidifiers so that you can easily clean them with only dish soap and sponge.
Can I use essential oils?		Please do not use essential oils with Miro humidifiers. The oil residue is difficult to clean and may discolor/damage your humidifier. The emulsifying agent from the essential oil may permanently damage your humidifier.

Issue	Check First	Possible Solution
There's some discoloration.		Discoloration will occur due to the UV light. This is natural and is not covered by warranty.
LED lights on the Touch Station does not work.	Check page 22 to see if the child-lock function is turned on.	Child-lock function will disable the Touch Station. Please disable the Child-lock function.
Mist does not come out when I put the humidifier to Auto mode.	Is the humidity in your environment over 60%?	Automatic mode will maintain your humidity in between 40-60%. Please use manual mode if you'd like more mist even at 60% humidity.

Please Read Before Use For Your Safety

To reduce the risk of injury/physical harm, please read the following before using your Miro humidifier.

WARNING

- Do NOT wash Touch Station and DC Adapter with water or any other liquid.
- Do NOT use dirty, rusty water to clean or operate your humidifier.
- Do NOT touch the DC Adapter or Magnetic Connector with wet hands. Keep them dry at all times.
- Do NOT drag or push the product when moving your humidifier. Please lift the whole unit.
- Do NOT use the humidifier if DC Adapter or Magnetic Connector is damaged.
- Do NOT operate your humidifier near hazardous items.
- Do NOT place your humidifier on top of a hot surface.
- Please use both hands when handling your humidifier.
- Please make sure to connect the Magnetic Connector to the Touch Station before connecting the DC Adapter to a power source.
- Make sure your Stainless Steel Water Bowl is dry when the humidifier is not in use.

Tips & Recommendations

- Miro recommends using the humidifier away from any other electrical appliances or any products sensitive to humidity.
- Always make sure to clean your humidifier and place your humidifier on a flat surface.
- Place your humidifier at least 2ft away from the wall for maximum performance.
- Continuous operation at max output may cause water condensation around your humidifier.

- Please do not pull the wire.
- Miro recommends using distilled or purified water. Hard water contains minerals that may shorten the lifespan of your humidifier.
- Please make sure your humidifier is disconnected from electricity when refilling or washing your humidifier.
- Please do not bend or pull any cables. Do not make a knot or tie the cable too tight.
- Keep the humidifier out of reach from children.
- Please disconnect your appliance from power before diagnosing/troubleshooting.
- Using rough sponge may damage your Stainless Steel Water Bowl.
- Please treat the UV Mist-maker engine with care. It is fragile, and the glass may break if handled carelessly.
- We test all our units before sending them out.
Please don't be alarmed if you think the product has been opened.
- Mist-maker engine/fan will heat up slightly. This is normal.
- Placing your humidifier on a cold surface may promote water condensation. You can place a towel underneath to prevent this situation.
- Miro recommends using distilled or purified water. Hard water contains minerals that may shorten the lifespan of your humidifier.
- Miro humidifiers are extremely powerful. Please maintain low mist output. Use high output level when your environment feels dry. Change back to low when optimal humidity is met.
- Discoloration is natural due to UV light.

Product Specifications

Model Name	MH7000
Manufacturer	Miro Corp.
Humidification Method	Ultrasonic
Color	White
Water Tank Size	4.8 L (1.27 gal.)
Item Weight	3.4 kg / 7.50 lbs.
Item Size	253 x 265 x 790 mm (10 x 10.4 x 31 inch)
Shipping Box Size	330 x 330 x 570 mm (13 x 13 x 22.5 inch)
Power Consumption	36 W
Output Current	DC 24 V / 1.5 A
County of Origin	Made in Korea

Tip

Product design and dimensions may slightly change without advance notice.



mirohome.com

Miro Support
support.mirohome.com