

Get started with myAbilia and CARY Base

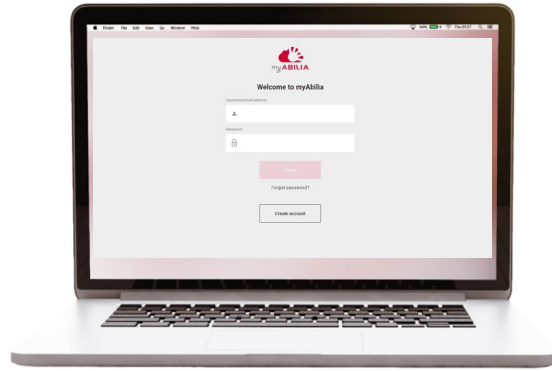

Get started with myAbilia – step by step

1. Set up myAbilia account



- Go to www.myabilia.com on a computer, mobile phone or tablet.
- Create a user account on myAbilia.
- Log in to myAbilia.
- Select the calendar module CARY.**
- Import the image library CARY.**

2. Connect CARY Base to myAbilia

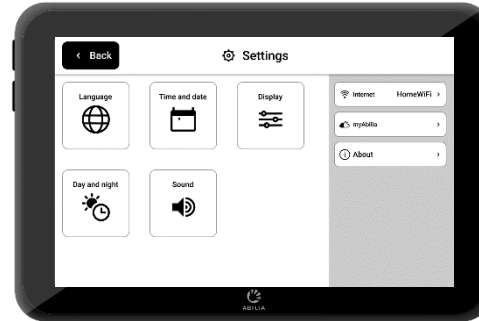

Make sure that the device is connected to Wi-Fi and log in with the user account.

3. Add activities

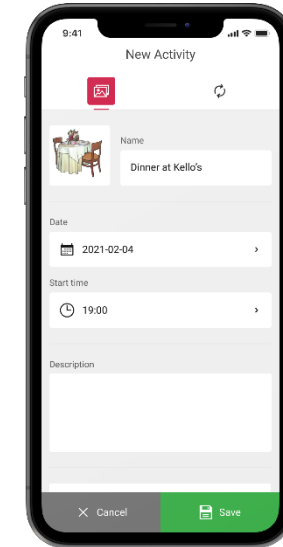

Log in to www.myabilia.com on a computer, mobile phone or tablet.

Use myAbilia to manage the calendar in CARY Base.

If you need more help, follow the instructions in this guide!

Create a user account at myAbilia

1. Open a web browser and go to www.myabilia.com.
2. Select **Create account**.
3. Select account type **User** and follow the instructions.



www.myabilia.com



Welcome to myAbilia

Username/Email address

Password

Log in

Forgot password?

Create account

Log in to myAbilia

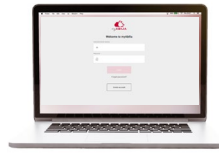

1. Open a web browser and go to www.myabilia.com.
2. Enter your username and password and select **Log in**.

The image illustrates the login process for myAbilia. On the left, the login form is shown with the following details:

- myABILIA logo
- Welcome to myAbilia
- Username/Email address:
- Password:
- Log in button
- Forgot password? link
- Create account button

An arrow points from the 'Log in' button to the right, where the mobile app interface is shown. The app interface includes the following details:

- Top navigation bar: Anna, New, Week 33, Actions
- Calendar view: Monday 16, Tuesday 17, Wednesday 18, Thursday 19, Friday 20, Saturday 21, Sunday 22
- Time slots: 24h, 12pm, 1pm, 2pm, 3pm, 4pm, 5pm, 6pm, 7pm
- Menu items: Calendar, Basic Activities, Basic Timers, Checklist, Image Archive, Notes, Voice Note

Select the calendar module CARY

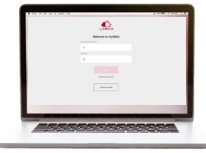

1. Select  and **My Profile** in the menu.
2. Select the tab **Modules** and select the modules intended for CARY:
 - Calendar – CARY
 - Basic Activities
 - Image Archive
3. Select **Save**.

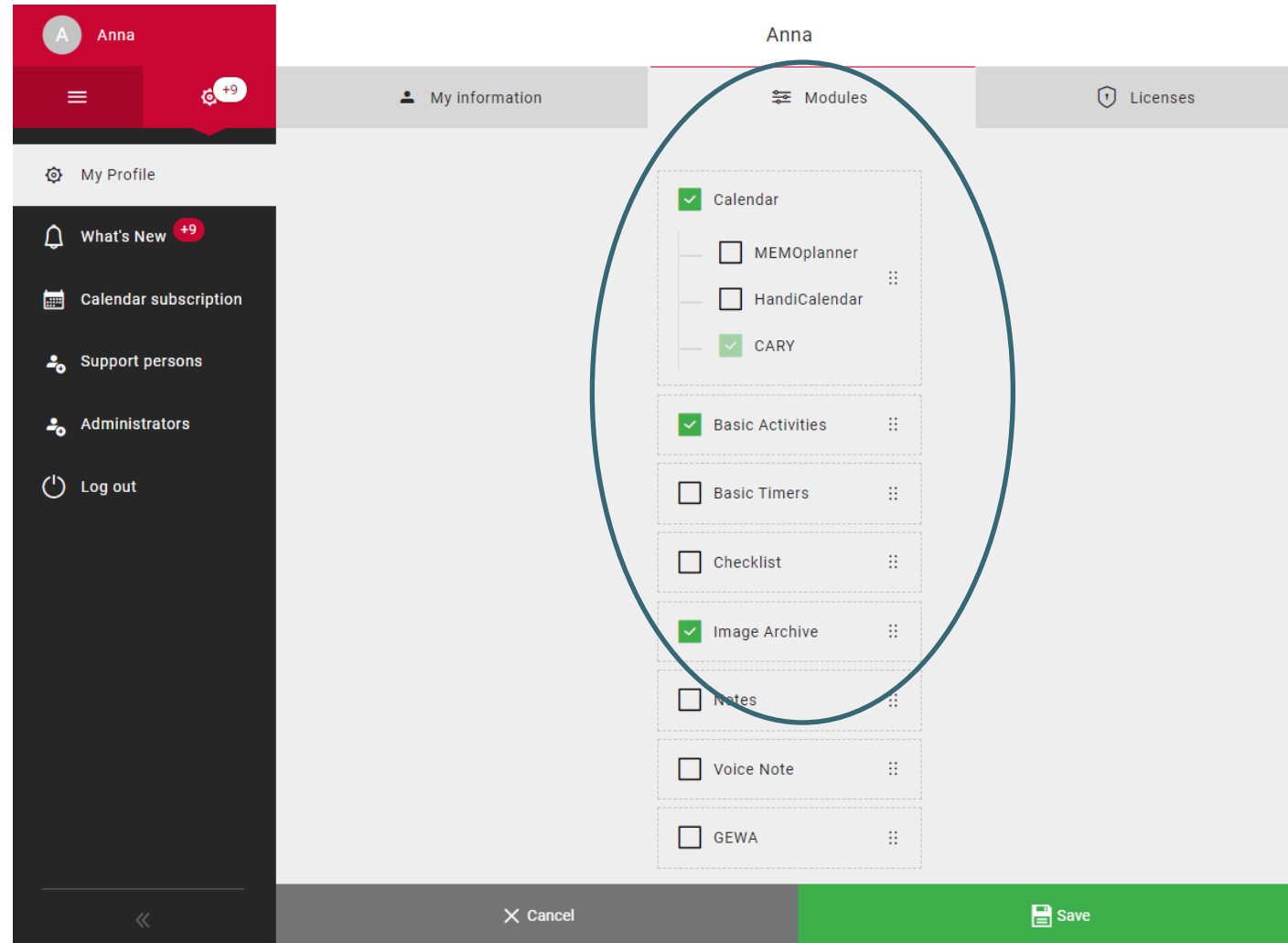

Import the image archive CARY

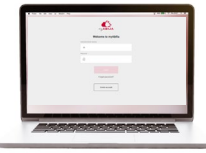

1. Select  and **Image Archive** in the menu.
2. Select **New** and **Import from Image Library**.
3. Select image archive **CARY** and **Add**.

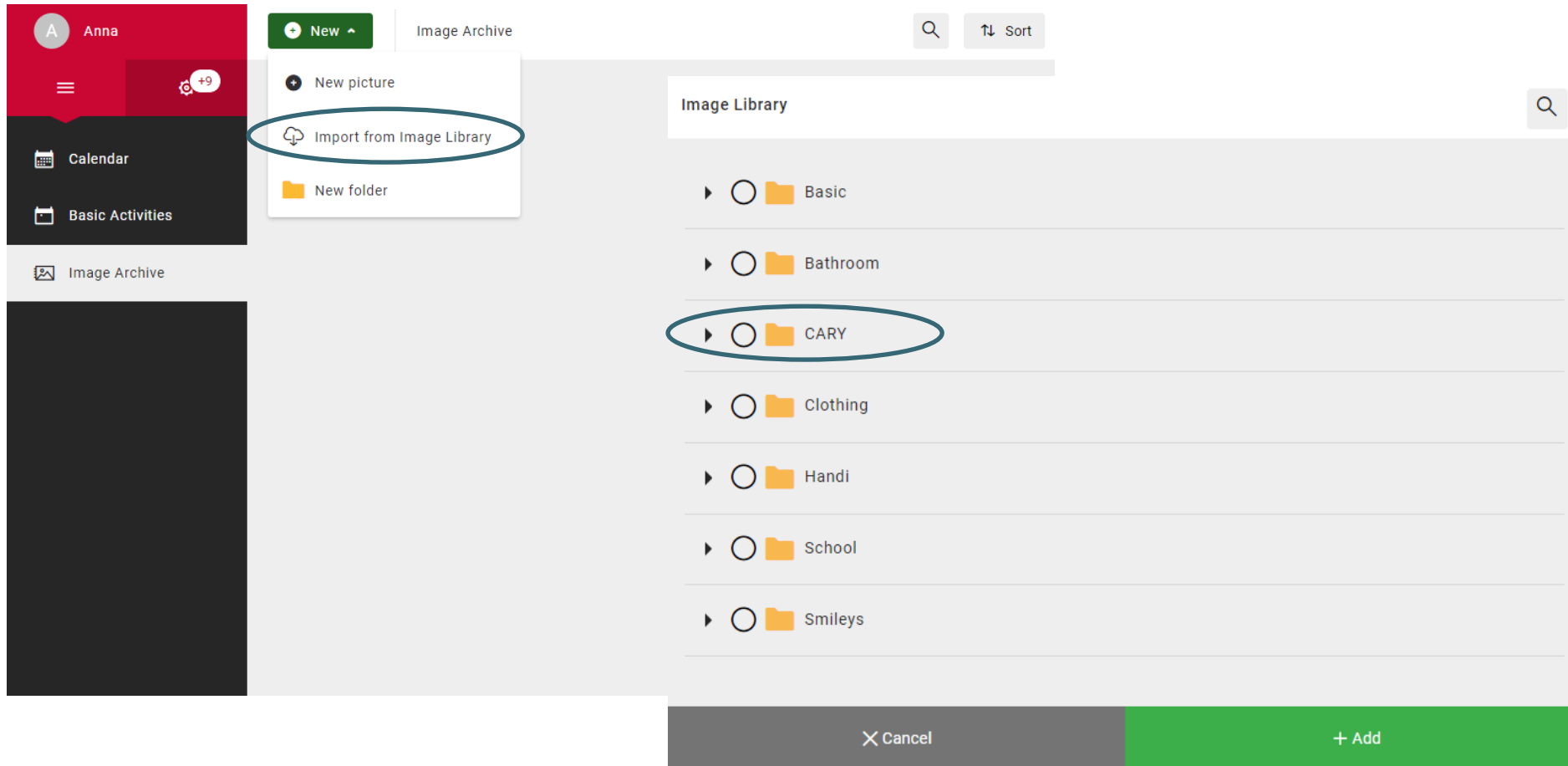

Connect CARY Base to myAbilia



1. Go to the Power menu and select **Settings**.

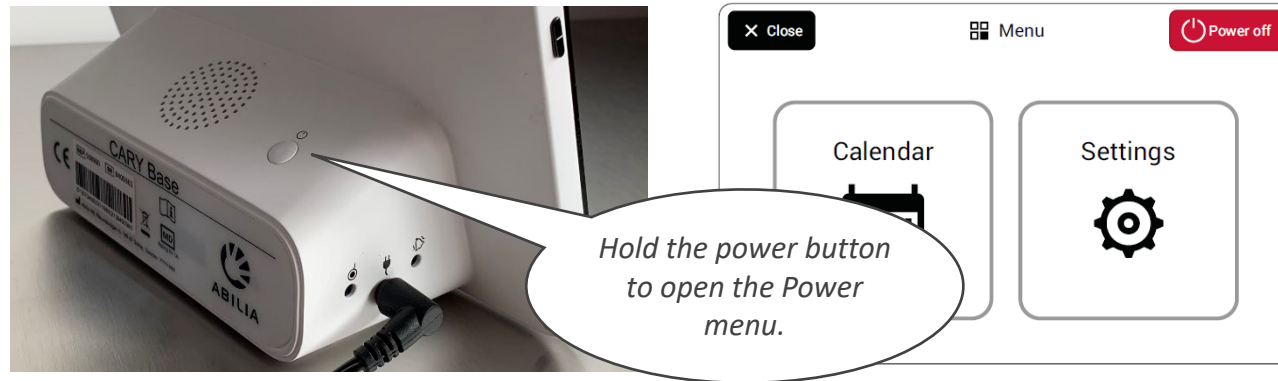

2. If the unit is not connected to the Internet, select **Internet** and select an available wireless network (Wi-Fi).
3. Select **myAbilia**.
4. Enter your username and password and select **Log in**.
5. Select **Back** and then **Close** to get back to the main view.

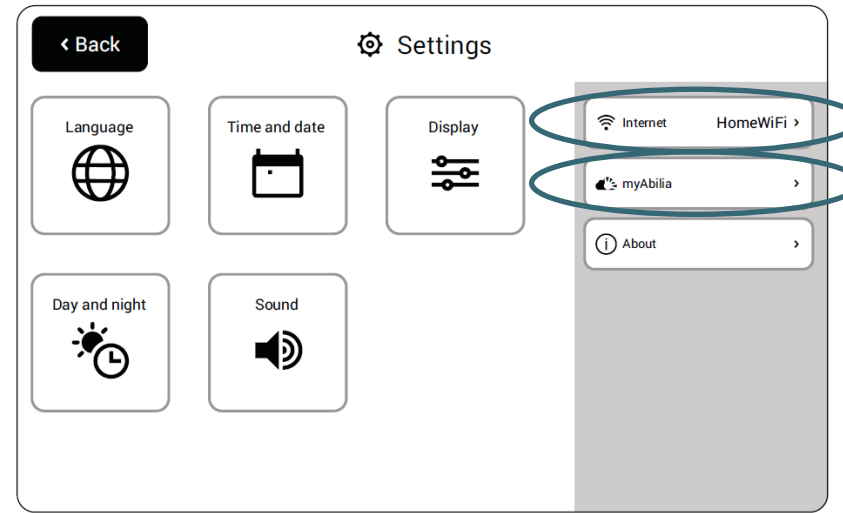

Add activities

1. Log in to www.myabilia.com with your user account.
2. Tap directly in the calendar to select **Date** and **Start time** of the activity.
3. Enter the name of the activity in the **Name** field.
4. Add a **Picture** and **Description** to the activity (optional).
5. Select to play a **message** or **text** when the reminder is shown (optional).
6. Select **Create** to save the activity.



CARY New Activity

Name & Picture Recurrence

Picture



Name
Walk the dog

Date
2021-08-18

Description
Don't forget dog poop bags

Start time
15:30

Record message

Extra settings

Show in dayplan Play text at alarm

Message =
Recorded sound or reading of text (Name and Description)



Walk the dog

Don't forget
dog poop bags

Name

Description

Picture =
Picture from the image archive or your
own photo.

How myAbilia works

Add an activity in CARY Base through myAbilia

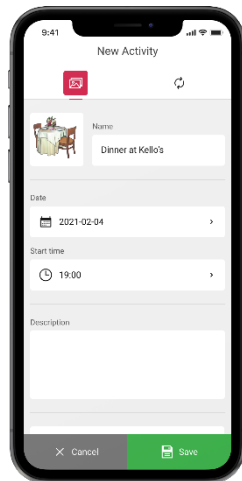

The activity shows in CARY Base



CARY Base is updated:
- Every five minutes
- When you tap Calendar

NOTE! The image archive in myAbilia does not show in CARY Base.