

A decorative graphic consisting of a series of thin, light gray lines that curve from the top left towards the bottom right. Along these lines, various small, colorful icons are scattered, including a sun, a house, a calendar, a lock, a speaker, a gear, a lightbulb, a cloud, a moon, a water drop, a lightning bolt, a play button, a document, a bar chart, a thermometer, a calendar page with '31', a book, a house with a window, a padlock, a speaker, a gear, a lightbulb, a cloud, a moon, and the word 'my' in orange. The overall effect is that of a stream of data or a path of information.

somfy®

Connexoon Window RTS

Contents

- 🔦 [Overview](#)
- 🔦 [Positioning](#)
- 🔦 [App Navigation](#)



Connexoon Window RTS Overview

An interface to receive instructions from your smartphone to control RTS motorised products and Philips Hue lighting.



Individual Control

Connect up to four smartphone devices, each with individual, personalised control



Centralisation

All of your Somfy RTS solutions in one place, allowing you to open and close with just one touch



Timer

Schedule the opening and closing of your equipment at the time and date of your choice



Ambiance Replay

Register a position for your window coverings and your lights to reproduce your favourite moments



Remote Access

Maximise the many benefits such as energy saving and privacy even when you're away from home



Connexoon Window RTS Overview

- 🔦 Control up to 30 RTS channels per Connexoon Window RTS from iOS and Android devices
- 🔦 4 Scenarios per Connexoon Window RTS
- 🔦 4 Modes per Connexoon Window RTS
- 🔦 8 Schedules per Connexoon Window RTS
- 🔦 Automate window coverings Scenes and Schedules
- 🔦 Supports Up/Down/Stop commands
- 🔦 Remote access via internet connection
- 🔦 Compatible with entire range of RTS products

Connexoon Window RTS Overview

OPERATING PRINCIPLE



RTS Communications
between Connexoon Window
RTS and the home's devices.



Ethernet Communications
between the router and the
Connexoon Window RTS device.

Remote Control (3G/4G)
Commands sent from the
smartphone via the 3G/4G
Internet network.



Control from Home
Commands sent from
the smartphone via the
home's WiFi.



Connexoon Window RTS Overview

Compatible end products



Roller Shutter



External Venetian Blind



External Vertical Screen



Swinging Shutter



Interior Roller Blind



Interior Venetian Blind



Single Curtain



Dual Curtains



Roman Blind



Cellular Shade



Zebra Shade



Awning icon coming soon



Light



Plug



Philips hue

Connexoon Window RTS Overview

How to connect

- 🔦 Plug directly into router and wall socket
- 🔦 Once connected green light on the side of the Connexoon Window RTS box will appear to show it's connected to the internet and server
 1. Solid Red: set up mode
 2. Solid Green: connected to LAN
 3. Quick Red Flash: updating software

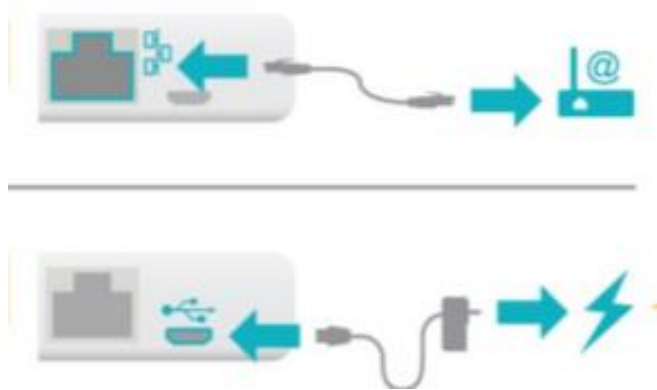

Connexoon Window RTS Overview

Remote Access

Control your window coverings remotely if connected to the internet

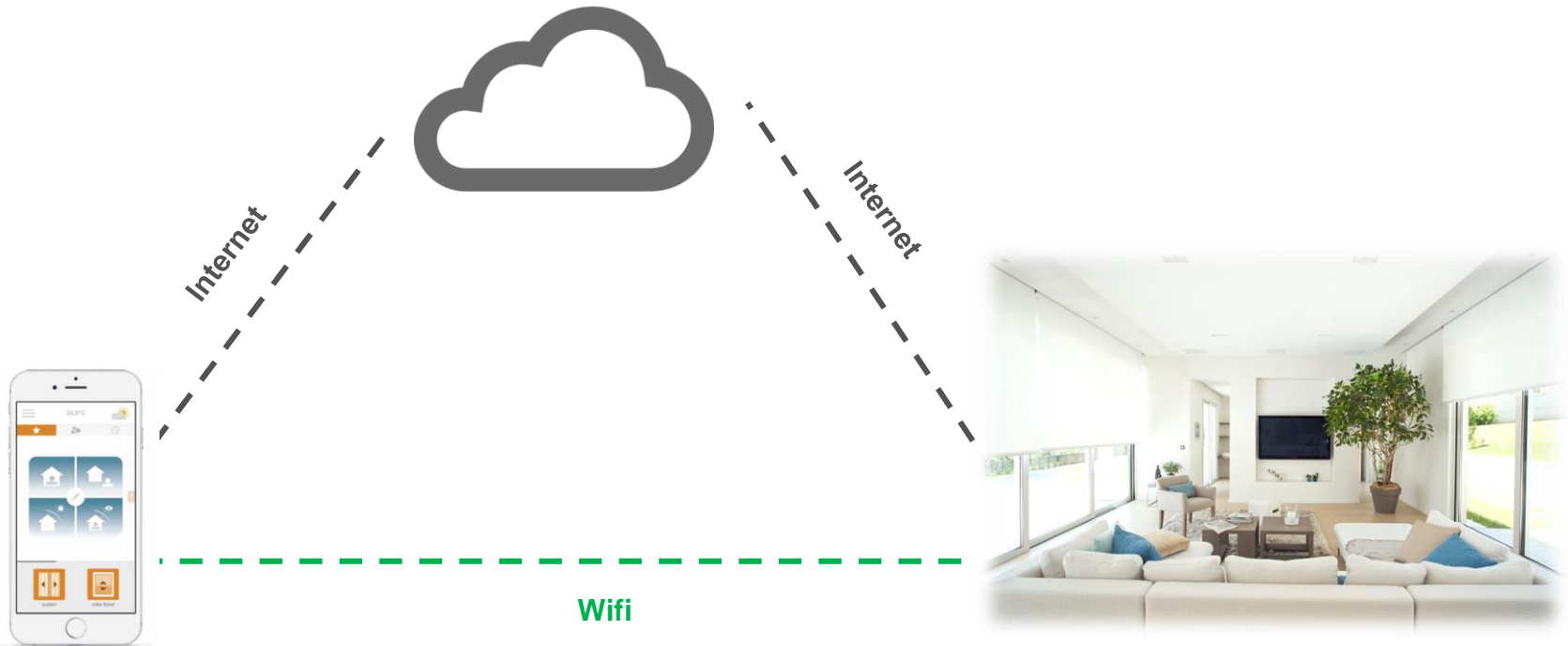

Positioning

Connexoon is right for users who.....

- 🔥 Want simple app control of RTS products
- 🔥 Want multiple schedules
- 🔥 Want a “set it and forget it” option

Unique Value Propositions:

- ✓ Timed Events
- ✓ Configure/control from mobile device
- ✓ Remote access

App Navigation

Initial Setup

1. Connect the Connexoon Window RTS to the router and power point. Wait for the LED on the side of the device to turn green
2. Register the Connexoon unit on www.somfy-connect.com
3. Download app from App Store or Google Play
4. Follow the on screen instructions to set up Connexoon Window RTS account
5. Program RTS products to the Connexoon Window RTS



Activating the Connexoon Window RTS

Step 1:

Go to www.somfy-connect.com to activate your Connexoon Window RTS Box

Step 2:

Enter PIN code located on the underside of the box

Step 3:

Enter required information

Activate your connected product

Please select your country and your language to create your account.

Country

Australia

Language

English

START ACTIVATION



Email and password [+]

Your information [+]

Summary [+]

CONNEXOON
WINDOW

Back to previous step

Email and password
Please enter your email address and choose your password to create your account

Email address

Confirm your email address

Password

Confirm your password

CONTINUE

Activating the Connexoon Window RTS

Step 4:
Enter your details

CONNEXOON
WINDOW

[Back to previous step](#)

Your information
Please indicate the address where the box will be installed. Please fill in all the fields below:

Mr. Ms.

First name

Surname

Address

Post code

Town

Telephone number

[SAVE AND CONTINUE](#)

Navigation: Email and password [•], Your information [•], Summary [•]

Step 5:
Confirm your details are correct and select confirm

CONNEXOON
WINDOW

[Back to previous step](#)

Summary

PIN code 0401-3502-7698
Your email jordan.smith2@students.mq.edu.au
Your offer WINDOW_RTS
Activation date 23.08.2018

Please take the time to read the documents below. By ticking the box below, I accept the legal conditions outlined in these documents.

I have read and accept [Commercial Offer description and General Conditions of Services.](#)

I have read and I accept [Somfy privacy policy.](#)

[CONFIRM](#)

Navigation: Email and password [•], Your information [•], Summary [•]

Step 6:
Confirmation screen notifying that you have been sent an email



CONNEXOON RTS has now been activated.

Check your emails!

You have just been sent an email containing a summary of your CONNEXOON offer, and a link to your account. Click this link in the next 24 hours to complete activation of CONNEXOON. You will then be able to download and customise your application.

[CLOSE THE WINDOW](#)

Activating the Connexoon Window RTS

Step 7:

Go to your email to confirm Connexoon Window RTS activation

Step 8:

The screen below will appear. You can now proceed to login to the app

DO YOU WANT TO START USING YOUR CONNEXOON IMMEDIATELY?

Hello jordan

You have just activated your Connexoon at www.somfy-connect.com. Welcome! Just confirm your e-mail below, and everyday life gets much easier and simpler...

Confirm my e-mail

Now you just need to download the mobile app (iOS or Android) to connect your equipment in a few clicks. Oh, if everything could be as simple as Connexoon! Always connected with your Somfy team



You have just completed CONNEXOON WINDOW RTS activation

You can now enjoy your CONNEXOON application on your smartphone.



Launching the App

When you first open the app, enter the email address and password that you have defined during the activation of your Connexoon Window RTS.

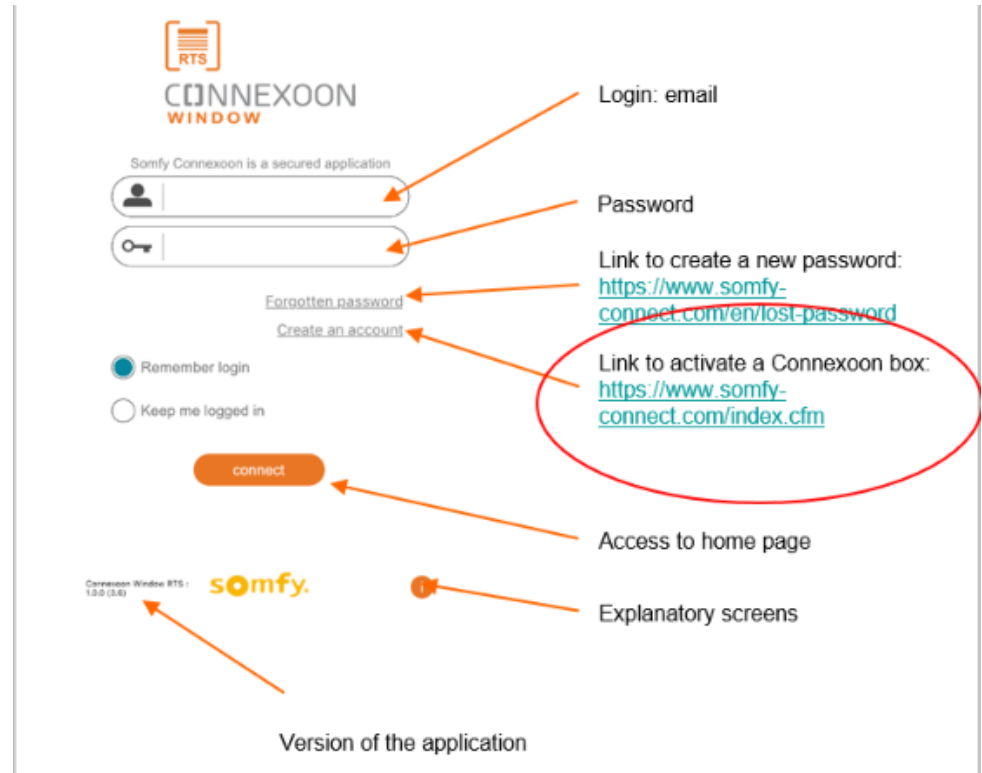

Launching the App

After the first connection through the login page, the user has to enter user name which can be changed later (menu/ my account / user name) and location of it's home (where the box is installed).

Welcome to the Connexoon **WINDOW RTS** application.

Through it, control all your RTS roller shutters, interior roller blinds and more.

Please, fill below your user name which will be used in the dashboard. If necessary, you will be able to modify it, at any time in MY ACCOUNT menu.

User name

Fill manually the location of your home, or press on the target button, to get automatically sunrise and sunset times:

Latitude 47.8590 Longitude 3.2992

validate

DASHBOARD

history scheduled

WEDNESDAY 22 FEBRUARY 2017

- roller shutter - Close Nicolas 13:10
- roller shutter - Open Andrea 06:55

TUESDAY 21 FEBRUARY 2017

- roller shutter - Close Nicolas 13:10

User Name: When the user opens the box for the first time, Connexoon Window RTS prompts to enter a name. This allows to differentiate users in case of multiple persons connected to the same box. On the dashboard, users names are displayed for each action, allowing to see who did what.

Location of the home: automatically receive sunrise and sunset time of your homes location. The location is also used to display weather data of your house.

Add RTS Equipment 1/2

Step 1

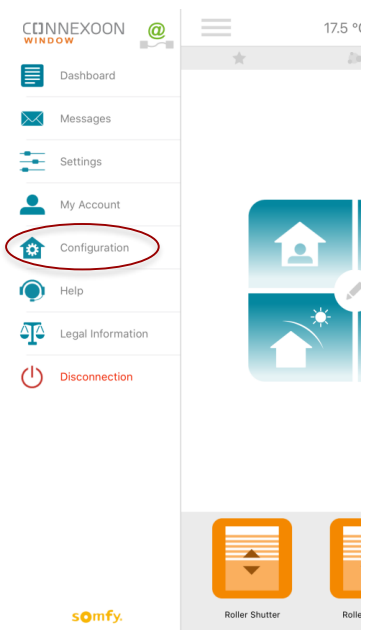

Step 2

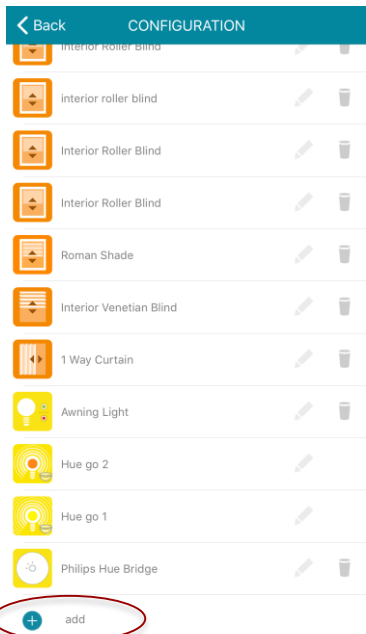

Step 3

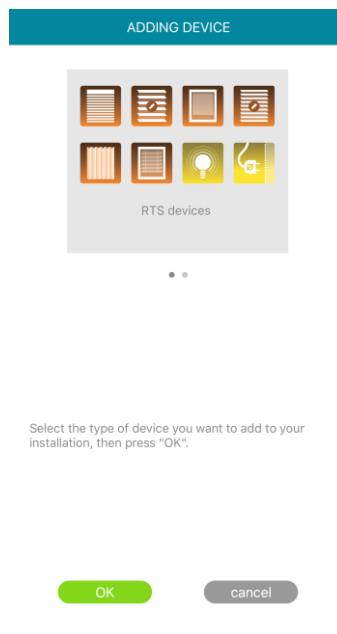

Step 4

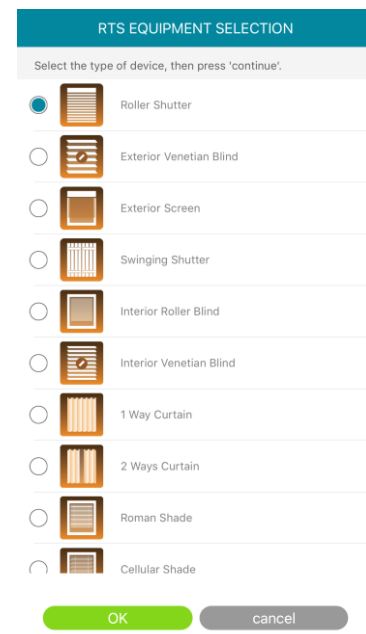

Step 5

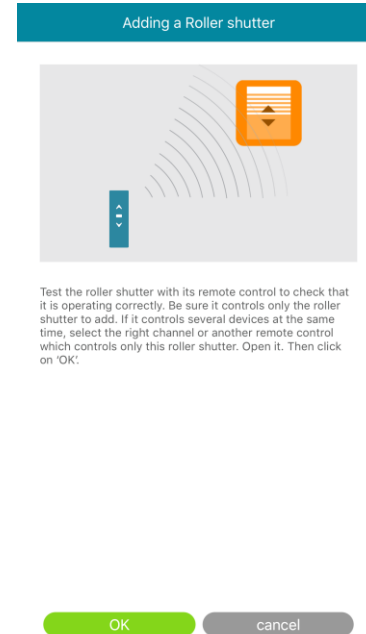

Add RTS Equipment 2/2

Step 6

deleting a Living Room

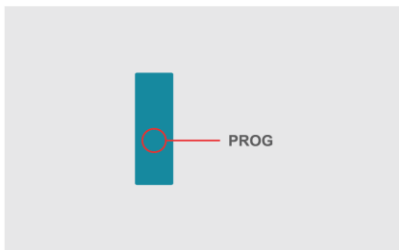

Press the PROG button (approx. 3s) on the back of your remote control until your equipment moves back and forth. Then you have 2 minutes to click on 'delete'.

delete

cancel

Step 7

Adding a Roller shutter



Test its connection by clicking the 'test' button below: the roller shutter closes during 5 seconds.

Test

Step 8

Adding a Roller shutter

- If your roller shutter has closed, click on 'OK'.
- If your roller shutter has not moved, click on 'restart' to repeat the procedure.
- If your roller shutter has still not moved after several attempts, click on 'abort'. If you have problems, you can also refer to the manual of the roller shutter motor.

OK

restart

Step 8

Adding a Roller shutter

Your roller shutter has been added successfully.

Set a name for your new roller shutter. Then, click on 'OK' to finalise.



Roller Shutter

OK

Rename Equipment

Step 1
Select 'Configuration'

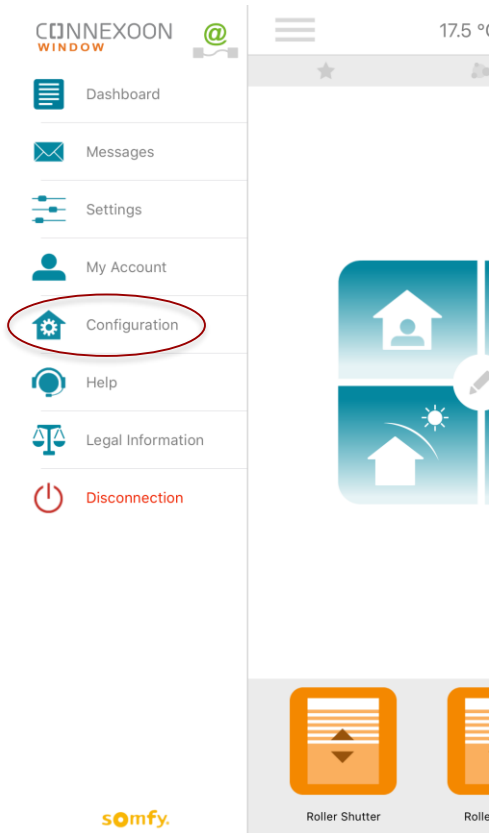

Step 2
Select the pencil icon next to the equipment to be renamed

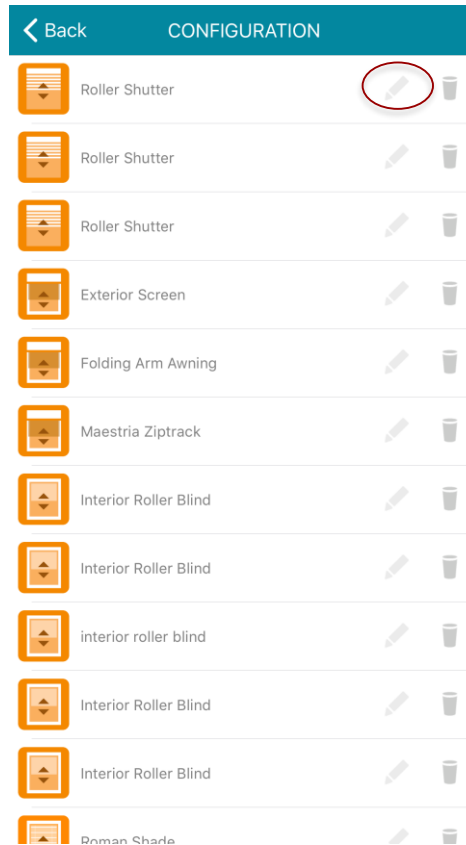

Step 3
Type in the new name for the equipment and select save

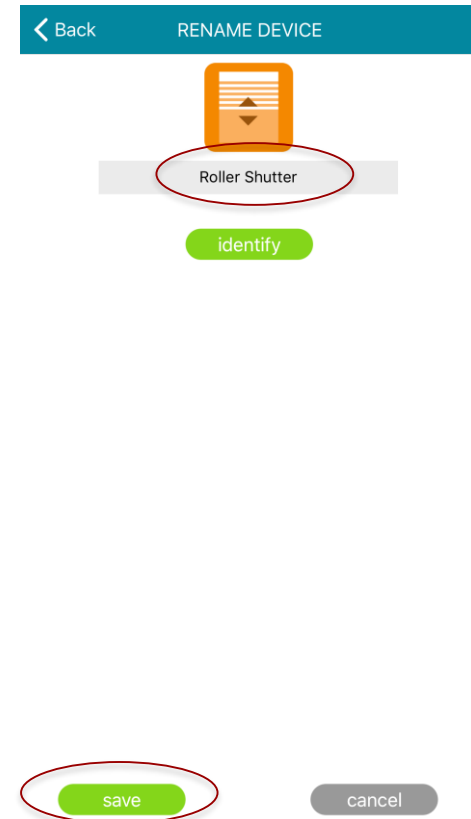

Delete Equipment 1/2

Step 1 Select configuration

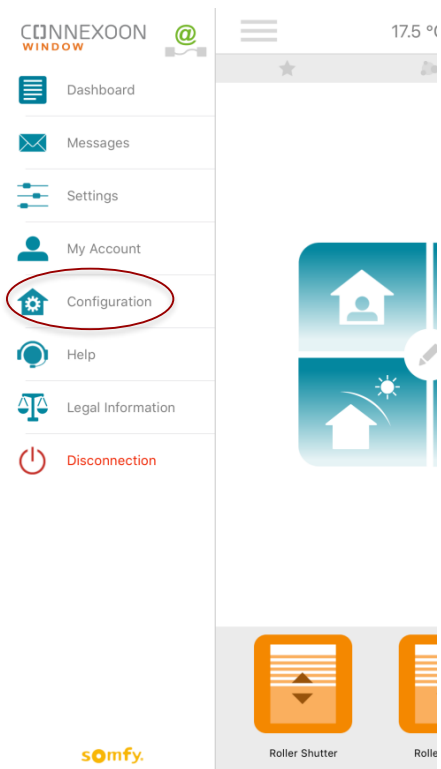

Step 2 Select the delete icon

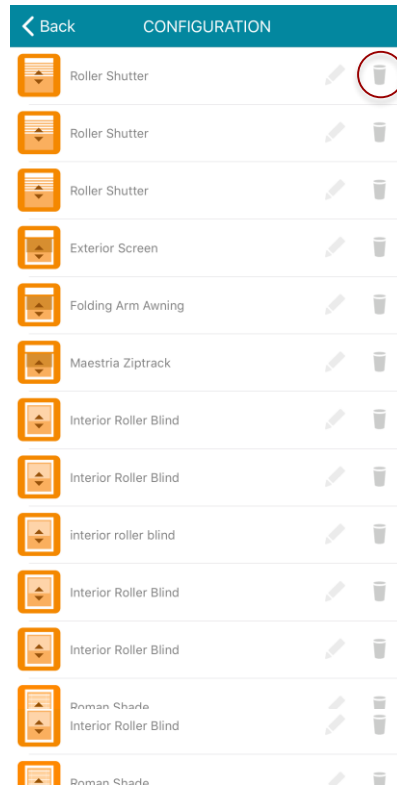

Step 3

deleting a Living Room

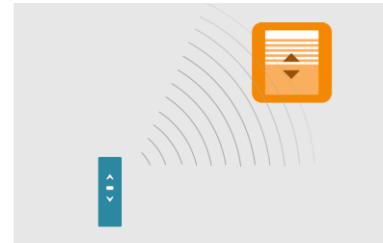

Test the roller shutter with its remote control to check that it is operating correctly. Be sure it controls only the roller shutter to delete. If it controls several devices at the same time, select the right channel or another remote control which controls only this roller shutter. Open it. Then click on 'OK'.



Step 4

deleting a Living Room

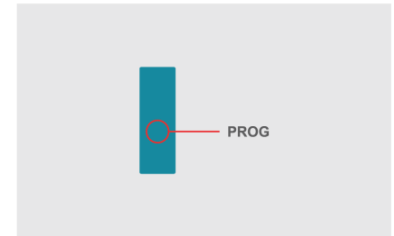

Press the PROG button (approx. 3s) on the back of your remote control until your equipment moves back and forth. Then you have 2 minutes to click on 'delete'.



Delete Equipment 2/2

Step 5

deleting a Living Room



Test its connection by clicking the 'test' button below : the roller shutter should not react.

Test

Step 6

deleting a Living Room

- > If your roller shutter has not moved, click on 'OK'.
- > If your roller shutter has closed, click on 'restart' to repeat the procedure.
- > If your roller shutter is still reacting to commands after several attempts, click on 'abort'. If you have problems, you can also refer to the manual of the roller shutter motor.

OK

restart

abort

Step 7

deleting a Living Room

Your device has been deleted successfully.

OK

Home Page

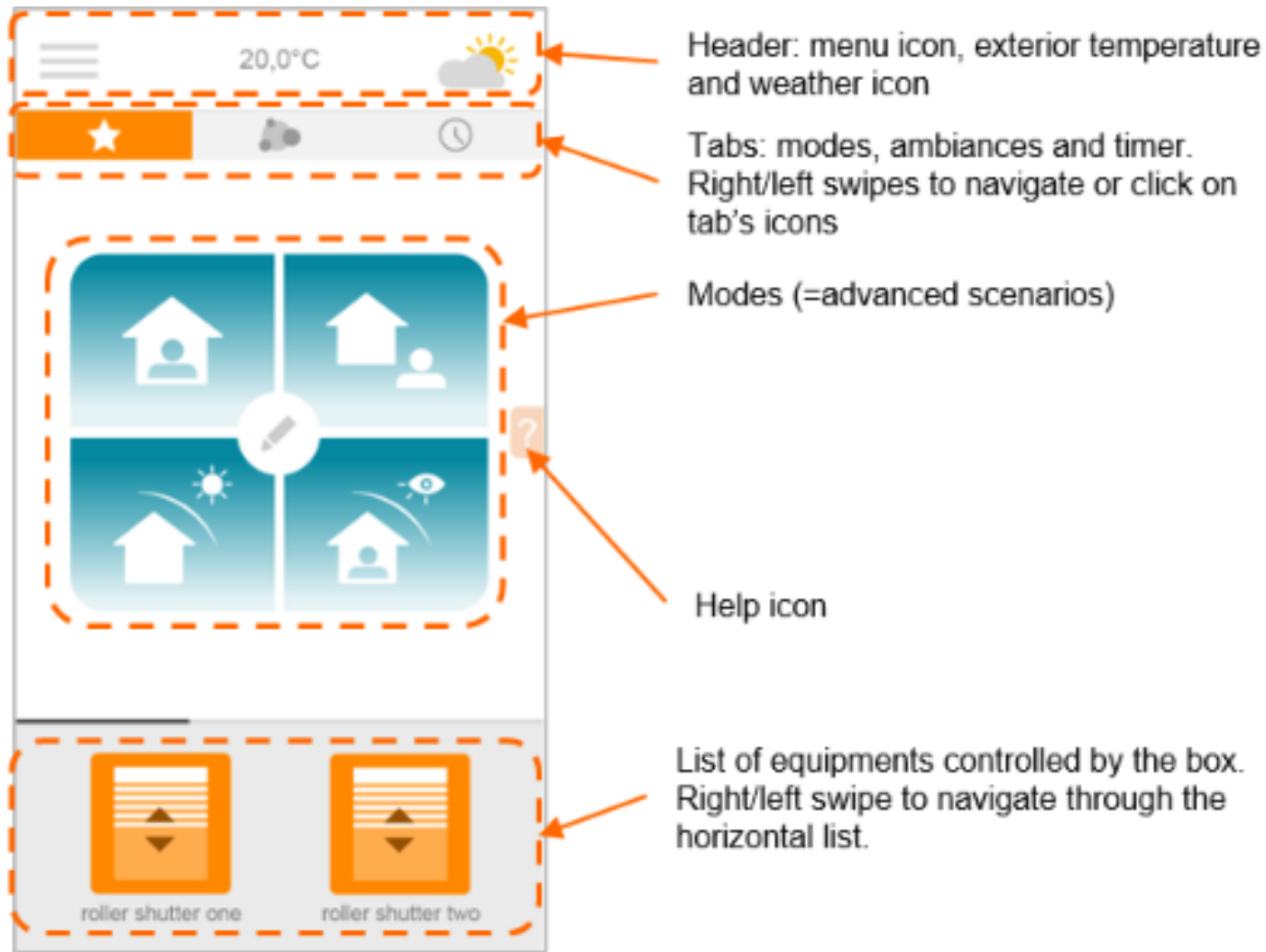

Modes Page

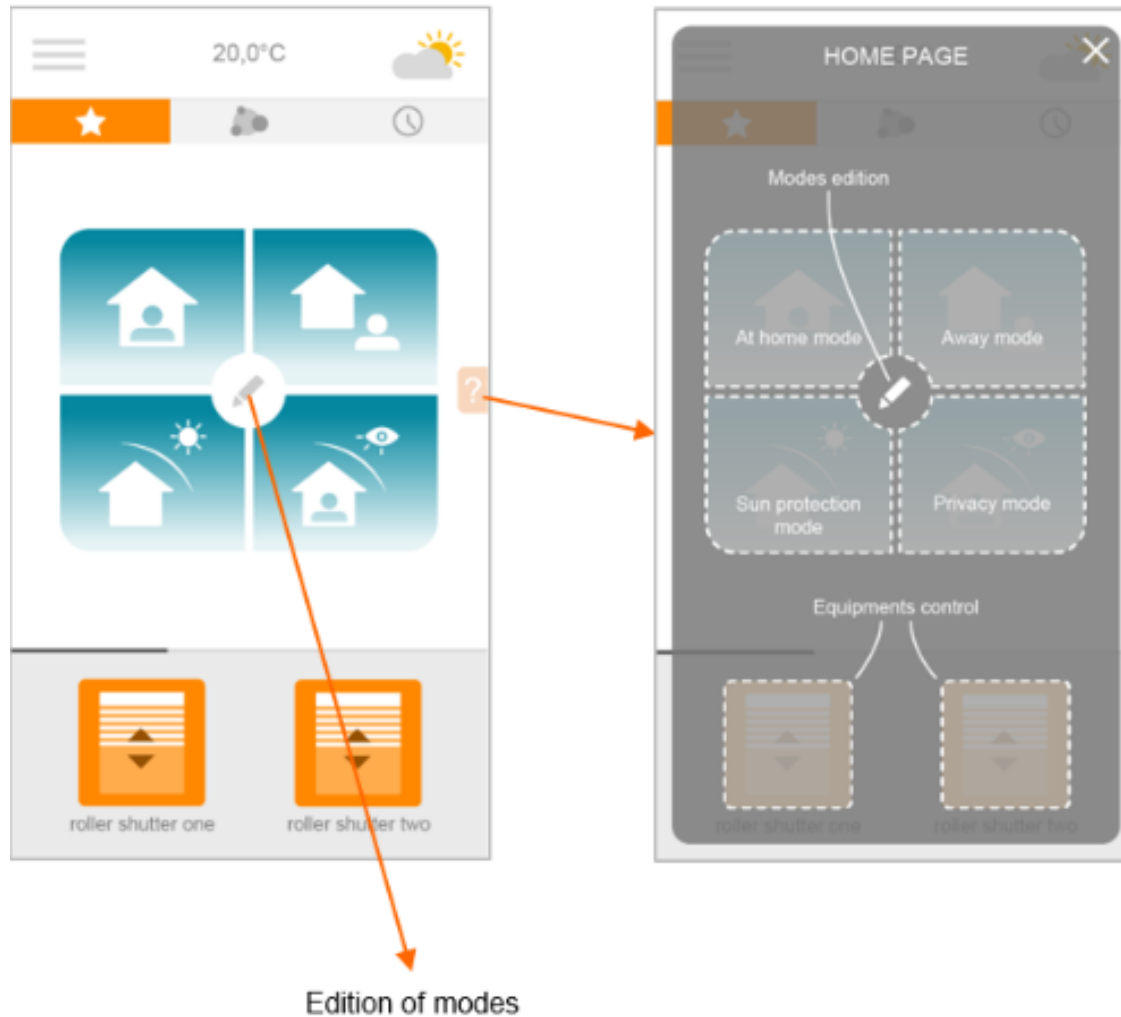

The modes page is the home page of the Connexoon app.

Press an icon to launch one of the 4 different modes:

at home, away, sun protection and privacy

Modes Settings 1/2



Press to launch the mode

If the mode isn't set, press a display and the help screen will appear

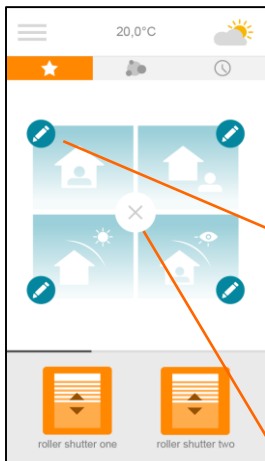

Selection of the mode to edit
→ **NEXT PAGE**

Back to home page

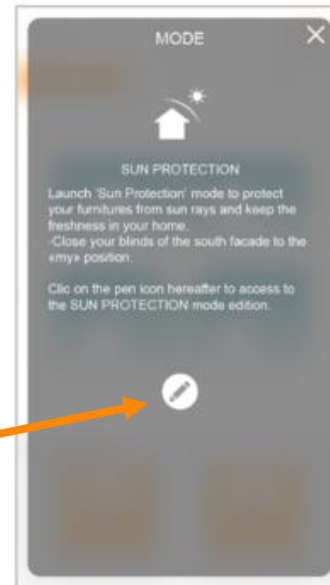
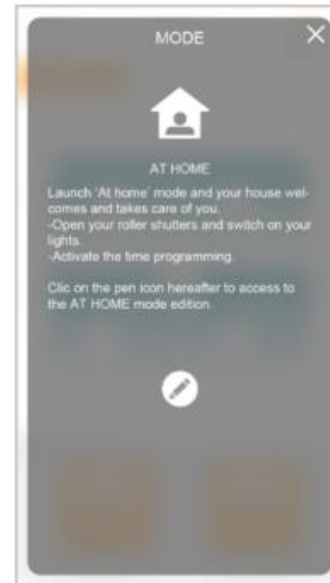

Direct access to edit the mode

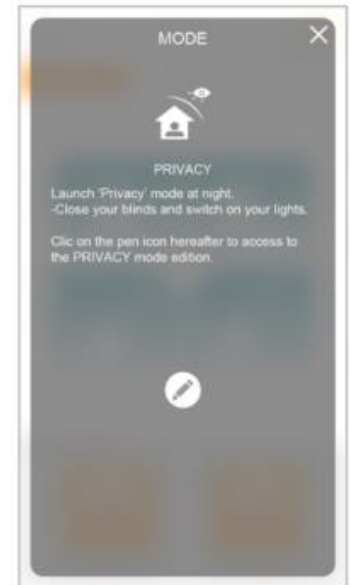

Modes Settings 2/2

Selection of equipment which will react when the mode is launched.

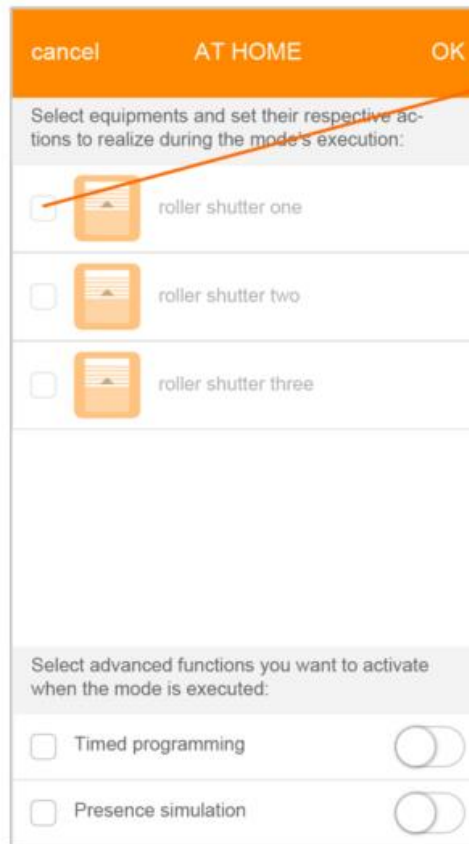

Selection of an equipment and its respective position



Highlighted line's equipment with icon of the requested position.

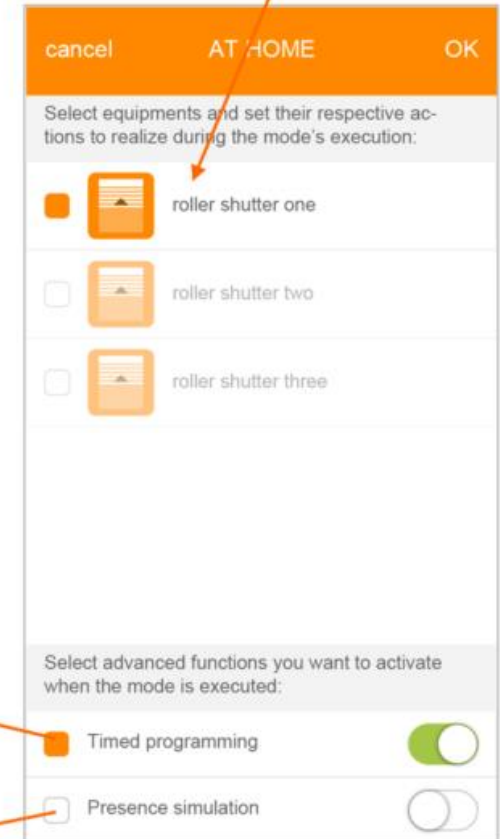

Timed programming:

- Not activated
- Activated and OFF
- Activated and ON

Presence simulation : ON or OFF.
Available only if the timed programming, above, is activated and ON.

Ambiance

The second main tab is the ambiance page which is composed of 4 ambiance/scenario icons. Pressing an icon launches RTS orders to activate the ambiance defined by a user.

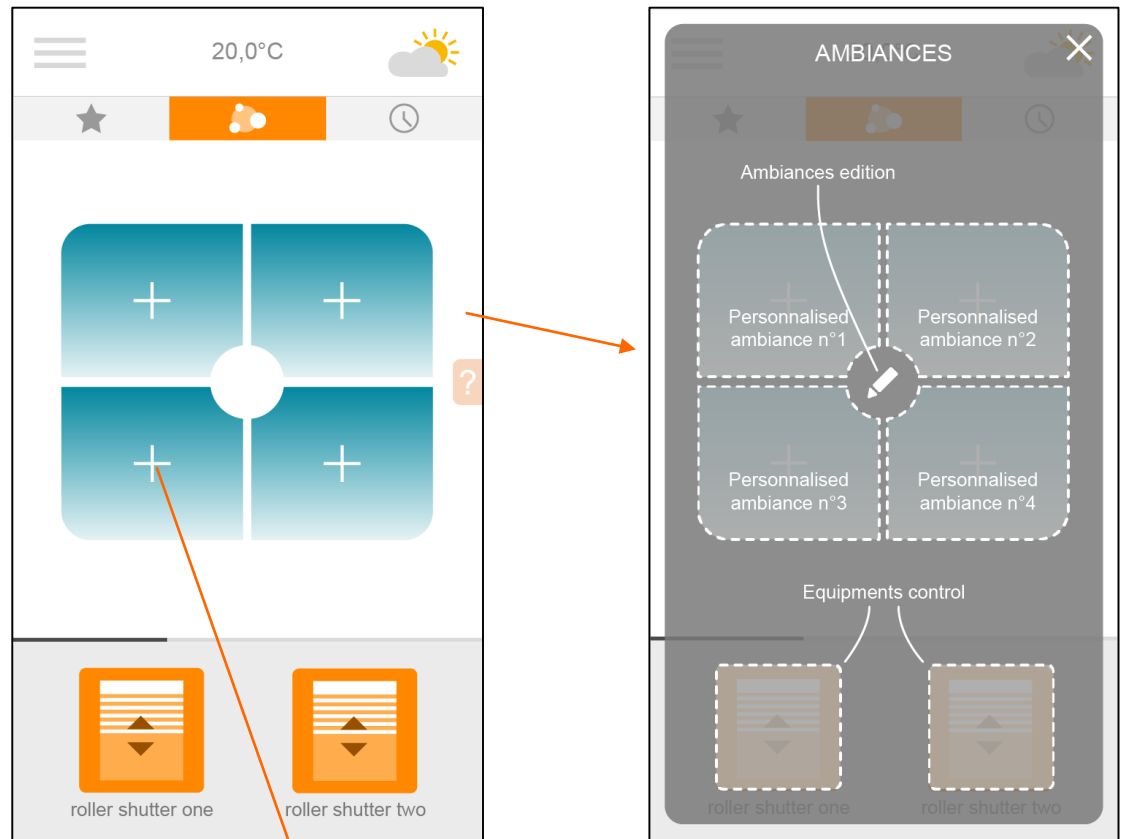

Select to edit the ambiance

Ambiance Settings

Three steps to set an ambiance:

- 🔦 Choose a picture, photo or icon
- 🔦 Name the ambiance
- 🔦 Select equipment and their respective action

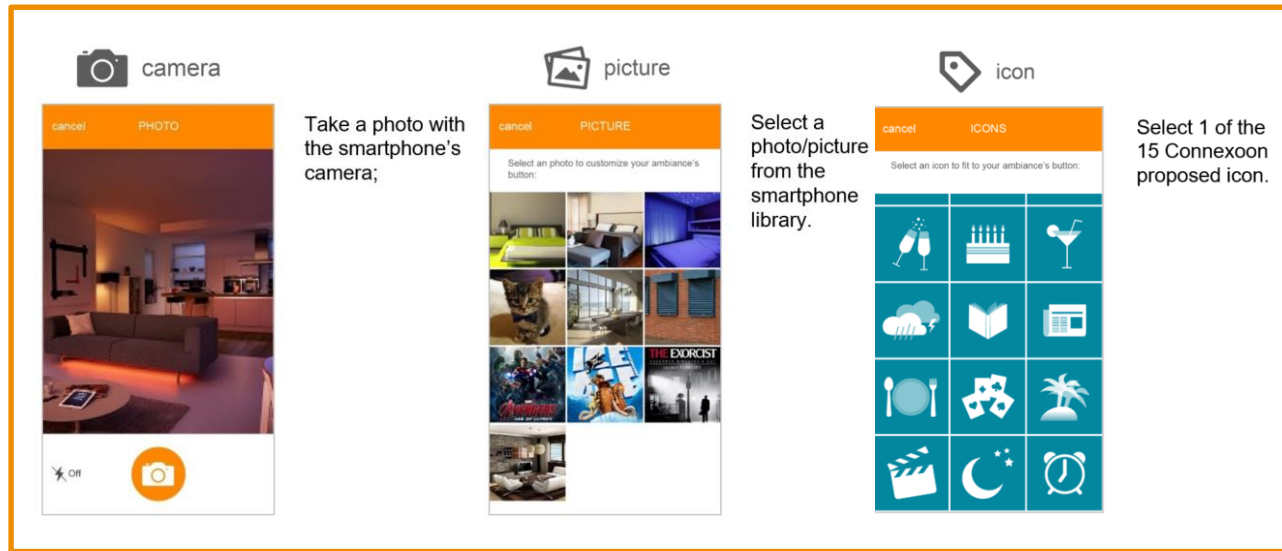
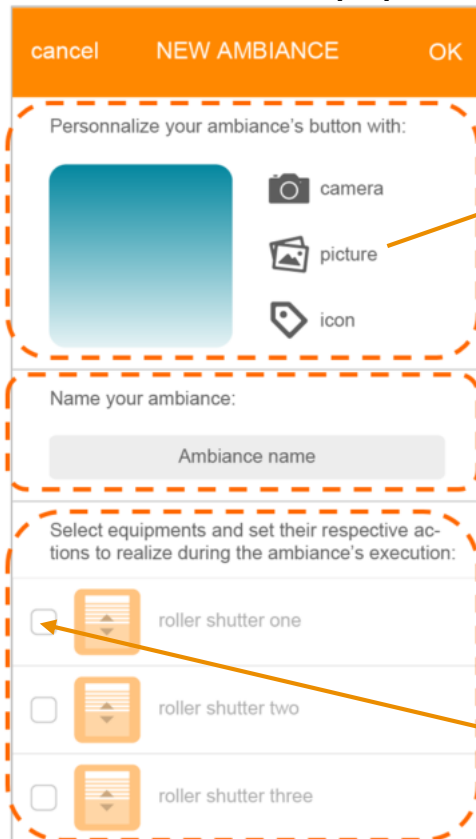

Equipment is added to the ambiance once the tick box is selected

Timer

The "Timer" function allows you to schedule any equipment.

Toggle  to turn on / off the Timer function.

When it's off (white), it means the timer function is completely turned off regardless of the preference for individual setting.

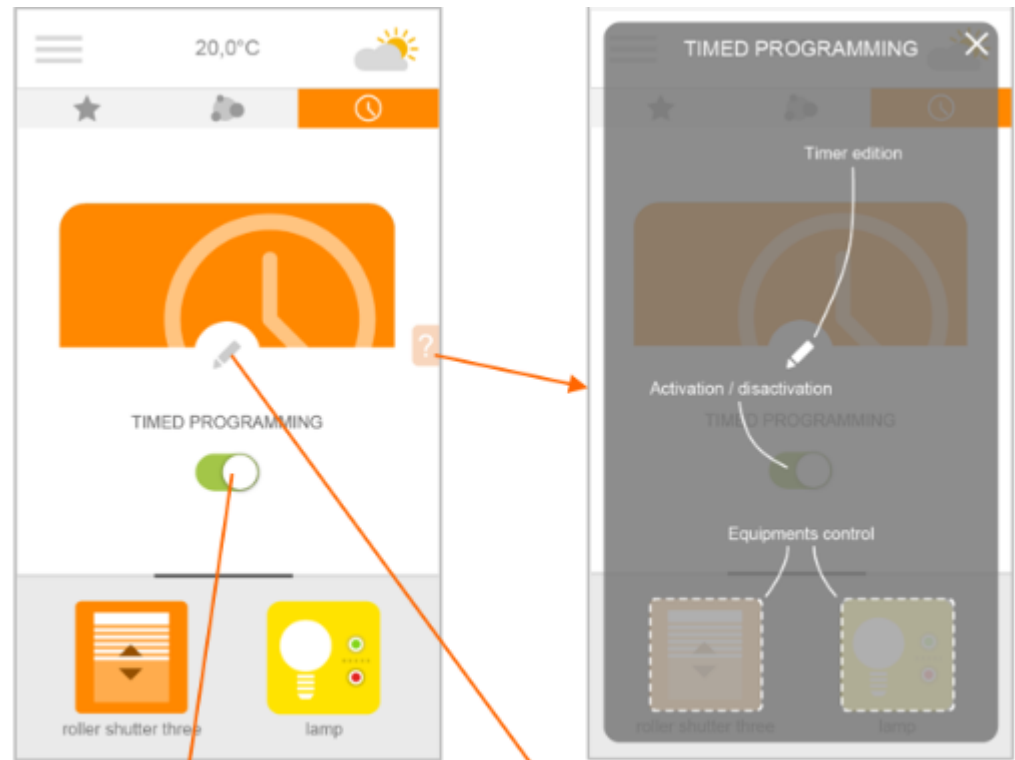

*Global timer activation/ deactivation
Override the activation of all the
Timer set.*

*Edit timed programming
(continued next page)*

Timer

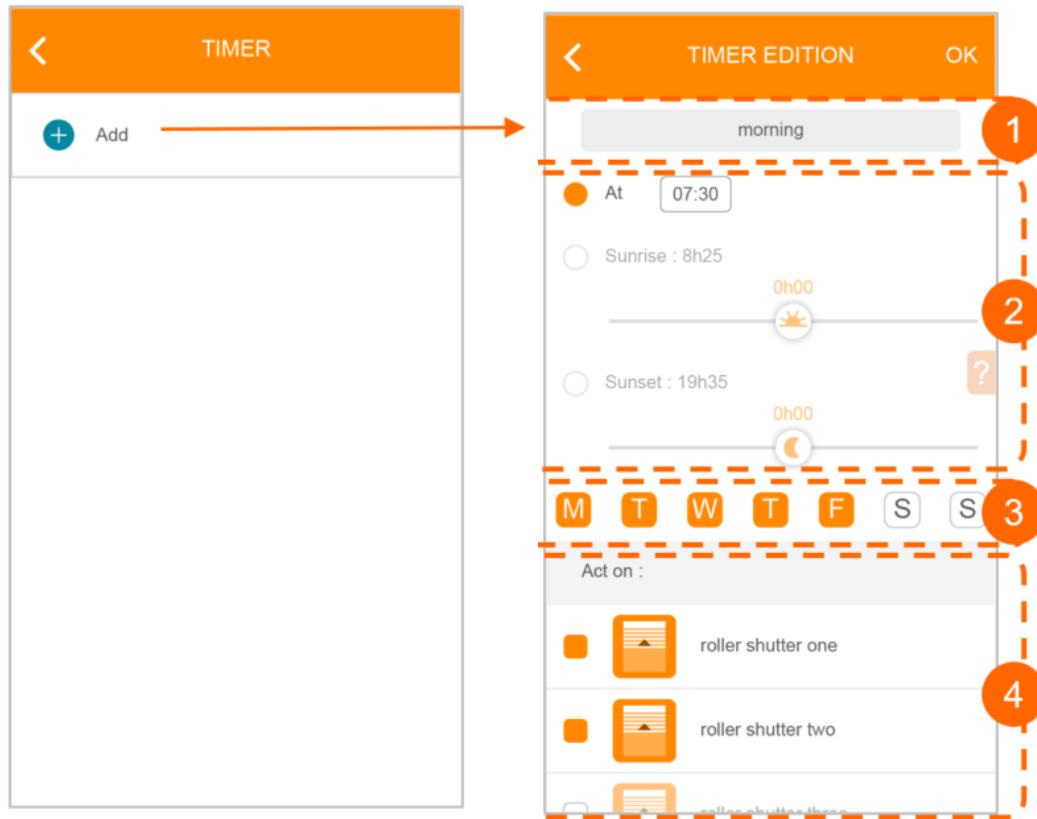

Note: Sunrise and sunset times are automatically updated based on the geographical location of the Connexoon Window RTS device

- 1 Naming of the timed program
- 2 Time settings
- 3 Days recurrence
- 4 Equipment selection

There can be a total of 8 timed programming's.

For each you can:

- activate/deactivate
- edit
- delete

Scenario Timed Programming

Step 1:
Open the scenario, mode or ambiance
and select the timed programming to
ON

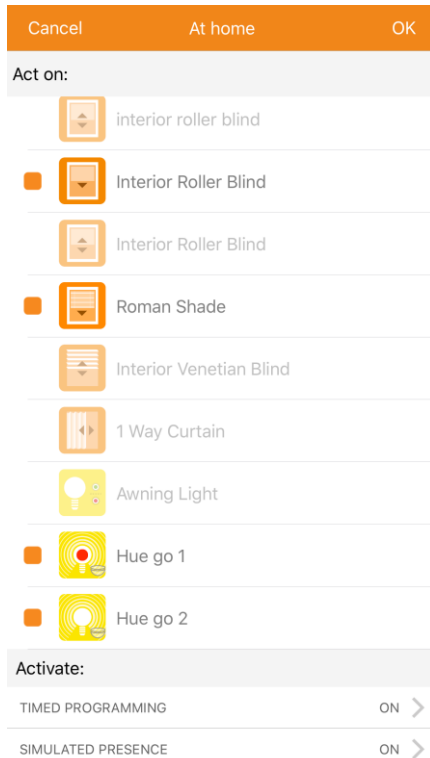

Step 2:
Go to the timed programming screen
and select edit

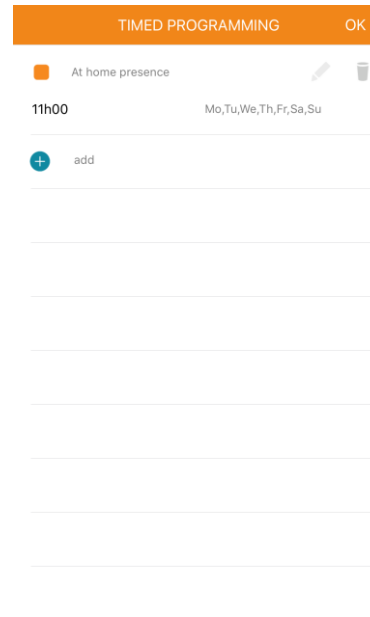

Step 3:
Edit the timing of the scenario

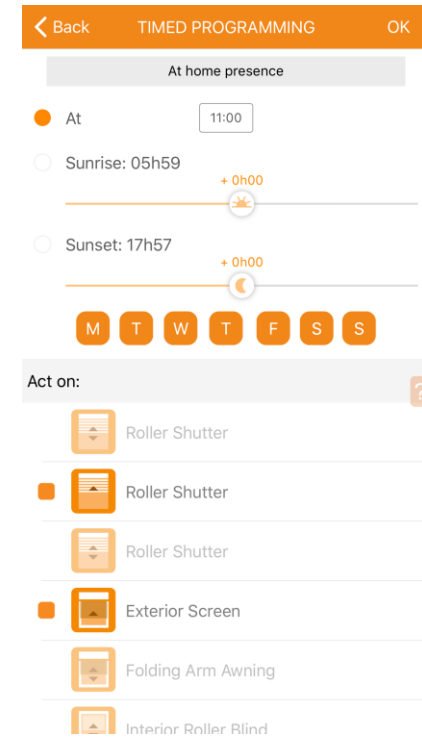

Presence Simulation

When “**Presence simulation function**” is activated, the timer programming will be played in the pre-set time within +/- 15 minutes. This is a great feature when on vacation or leaving your home empty, as the random pattern simulates an occupied home.

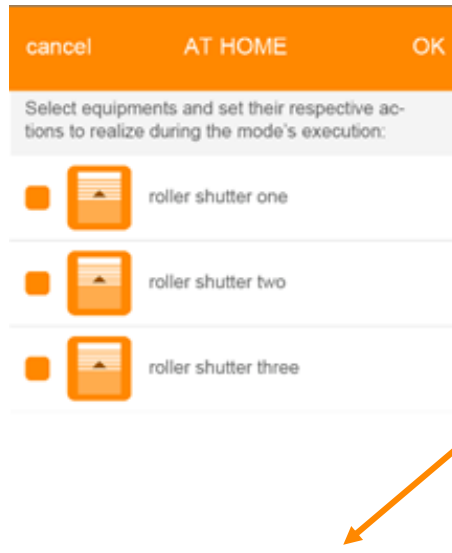

To activate Simulated presence, open the scenario “Timed programming” turned on in order to turn on “Presence simulation”

