



Warranty Service

Thanks for your shopping and trust.

We have been optimizing our products and improve our lifetime customer service to offer you a better shopping experience. If you have any problems, please feel free to send us an E-mail. We will solve your problems **within 24 hours**. In addition, your advice or suggestions will be much appreciated and welcomed.

Product Service

Email: Tech@tiejus.com

Distributor: distributor@tiejus.com

More About Us

Web: www.tiejus.com

Facebook: www.facebook.com/zumimallofficce

Brand Story

TieJus is a young and fresh security brand that has attracted millions of technology enthusiasts in just 6 months of establishment. TieJus is committed to creating a smarter and easier modern lifestyle for consumers. Let more consumers enjoy convenient modern life without worrying about information security.

At the beginning of 2022, combined with advanced intelligent AI technology, TieJus launched the first surveillance camera that combines artificial intelligence and security system. We believe small details make a big difference - that's why we create quality, easy-to-use smart home products.

Choose TieJus - the new security weathervane.

1. What's in the Box -----	P1
2. Meet the Doorbell -----	P2
3. Meet the Chime -----	P3
4. Download and Install App -----	P4
5. Account Registration -----	P5
6. Add Camera to App -----	P5
6.1 Preparations for Connection -----	P5
6.2 Connect Camera to App -----	P6
7. Charge your doorbell -----	P8
8. Set up Doorbell -----	P9
9. Pair With Your Indoor Chime -----	P10
10. Install Your doorbell -----	P12
11. Tamper Alarm -----	P14
12. Product Specifications -----	P15

1. What's in the Box

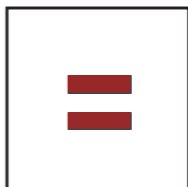
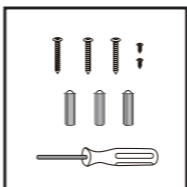

Doorbell * 1

DingDong *1

Quick User Guide *1

USB Cable *1

Screws Set/Screwdriver *1

3M Tape *2

NOTE: Micro SD card and power adapter are not included.

2. Meet the Doorbell

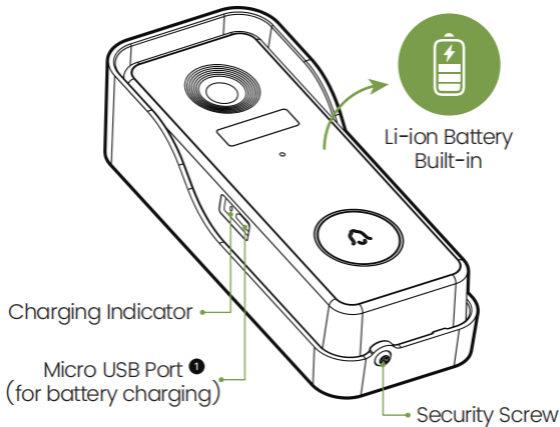
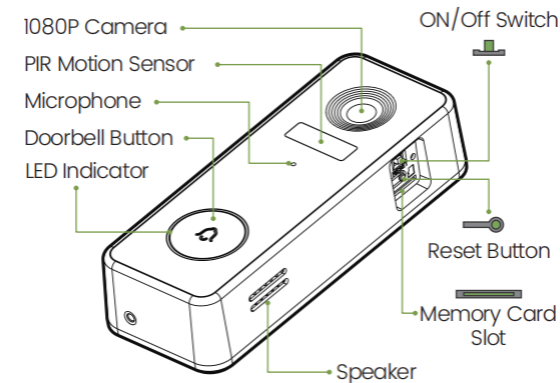

❶ Doorbell comes with a 4,500mAh rechargeable Li-ion battery.

3. Meet the Chime

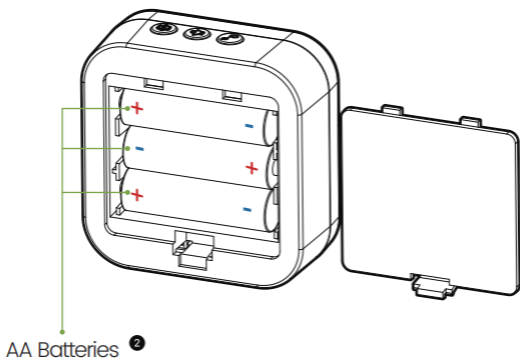
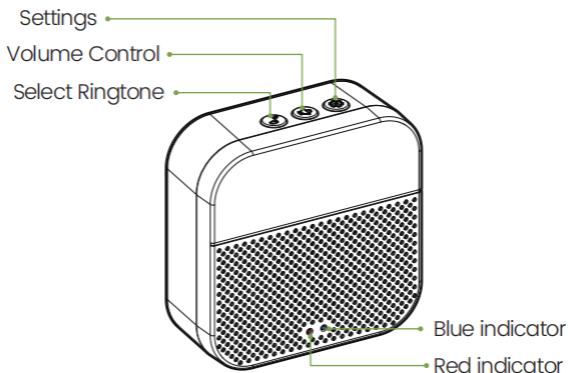

② Please mind the battery polarities while installing the batteries.

4. Download and Install App

Download ZUMIMALL App from Google Play™ or App Store™. Or scan the QR codes as below, with your smart phone.

NOTE: Google Play™ is a trademark of Google Inc.
App Store™ is a service mark of Apple Inc.



iOS



ZUMIMALL



Android

NOTE: Please turn on both of the following permissions.

- ① Allow ZUMIMALL App to access mobile cellular data and wireless LAN, otherwise it will fail to connect the camera.
- ② Allow ZUMIMALL App to receive pushed messages, otherwise, the phone will not receive alarms when motion is detected.

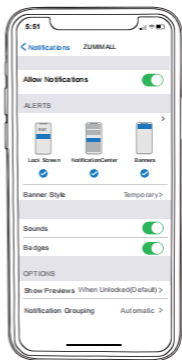
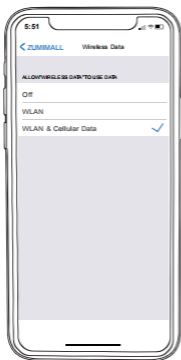

5. Account Registration

New user needs to sign up ZUMIMALL App with email address. Click 'Sign up' to create a New Account and follow the steps to complete registration.

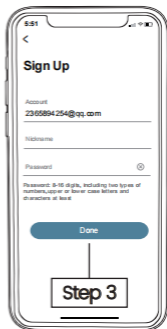
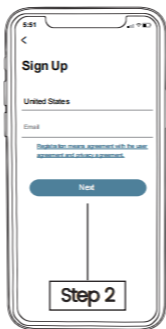
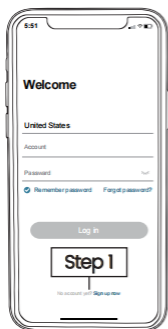

6. Add Camera to App

6.1 Preparations for connection

- ① Insert a Micro SD Card into the camera to save video clips or you can start the 7-day free cloud service. Without Micro SD Card or cloud service, no video will be saved.
- ② The camera only works with 2.4GHz Wi-Fi, not support 5GHz.
- ③ When connecting to the network, please take the camera close to the router (Recommended within 10-15ft).

6.2 Connect Camera to App



Tap 'Add Device'

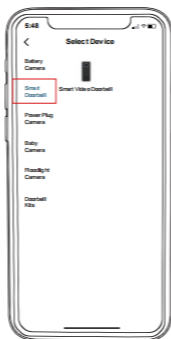

Select 'Battery Camera'

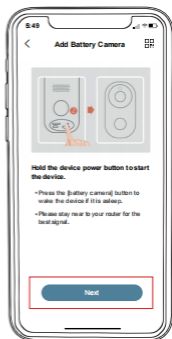

Turn on the Camera

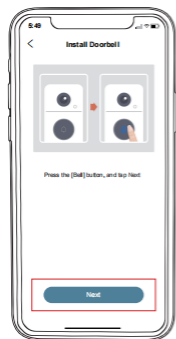

Reset the Camera



Input Wi-Fi Password

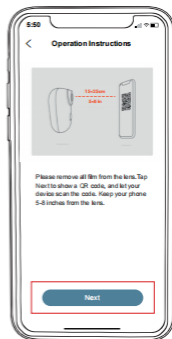

Prepare the Scanning



Scan QR Code when Indicator Flashing Slowly in Red



Finished Installation When Reaches 100%

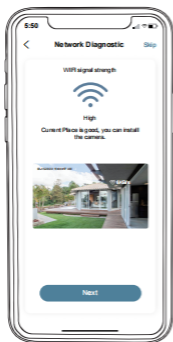

Perform Network Diagnosis

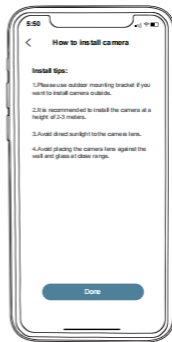

View Installation Tips

7. Charge your doorbell

Prior to the doorbell installation, please charge up your doorbell for about 8-10 hours till the charging LED turns BLUE from RED.

LED STATUS	INDICATION
 Solid red	Battery charging
 Solid blue	Fully charged

Compatible charger (not provided):

USB compatible mobile phone charger (DC 5V=1A~2A).

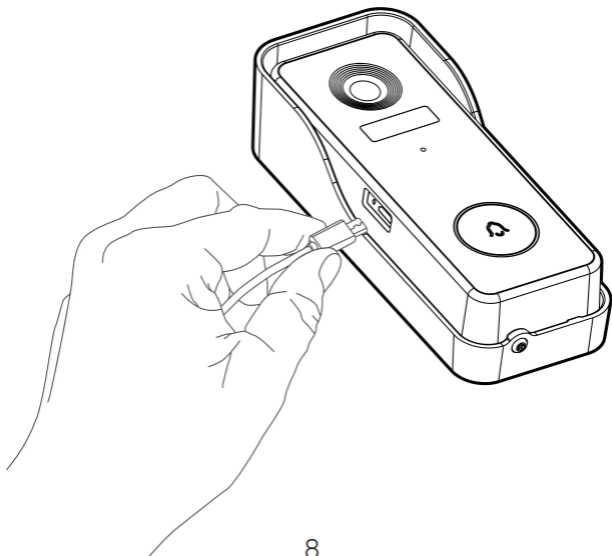

8. Set up Doorbell

- 1 Switch on power for your doorbell, and you will see the LED indicator flashes red (once per second). Start setting up your doorbell following the in-app instructions.

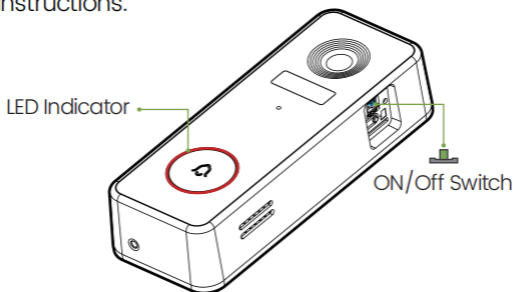

2 Tips

- Please operate the setup near your Wi-Fi router.
- Make sure your phone is connecting to a 2.4GHz Wi-Fi.
- Make sure the doorbell is turned on, and its indicator LED is flashing red. If not, press and hold RESET for 5 seconds.
- Ensure the Wi-Fi signal is good, and the Wi-Fi password is correct.

LED STATUS	INDICATION
○ Solid red	Device is abnormal.
○ Flash red (once/sec)	Ready for Wi-Fi configuration.
○ Flash red (twice/sec)	Connecting to Wi-Fi
○ Solid blue	Device is online
○ Flash blue (once/sec)	Live-viewing doorbell cam
○ Flash blue (twice/sec)	Firmware upgrading

9. Pair With Your Indoor Chime

- 1 Click the **SETTING** button on the chime, and the chime will be in pairing mode for 20 seconds, with its red LED flashing.

Settings



Flashing Red

- 2 Press the doorbell button to send a pairing signal, and your chime will sound to react, together with its blue LED flashing. Chime pairing succeeds.

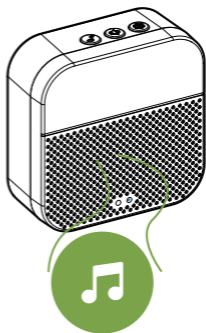
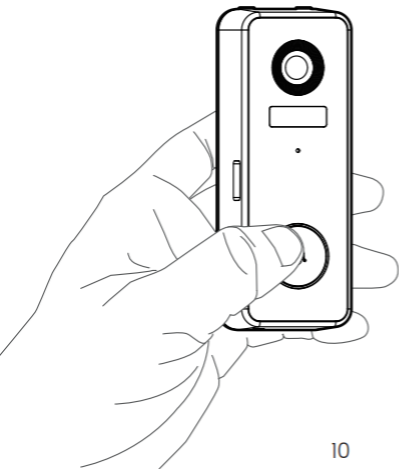

Chime rings & indicator flashes blue

3 Chime settings.

 **Ringtone selection.**
Click to change ringtone (4 ringtones available).

 **Volume control button.**
Click to control volume:
level 1: 110 dB; level 2: 100 dB
level 3: 90 dB; level 4: 80 dB

 **Settings.**
Click to enter/quit pairing mode;
Press & hold for 5 seconds to restore factory defaults.

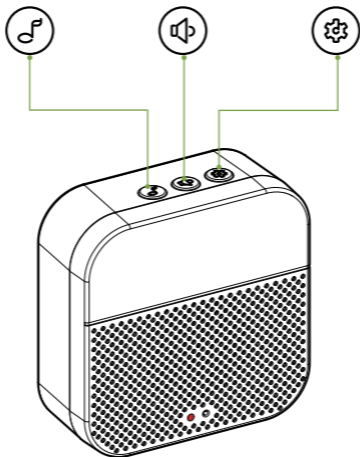

10. Install Your doorbell

- 1 Select location for your doorbell.



- 2 (OPTIONAL) Install at an angle.

You can purchase the following angled brackets so as to point your doorbell to a specific view angle.

Corner Mount
(Not included)

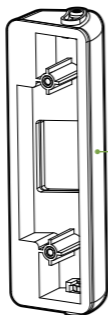

Wedge Mount
(Not included)

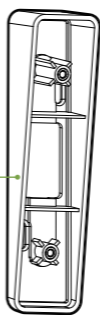

25 to 50 degree
angle adjustable

8 degree stackable
wedge mount unit

3 Standard installation.

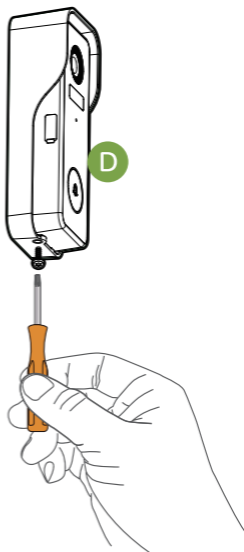
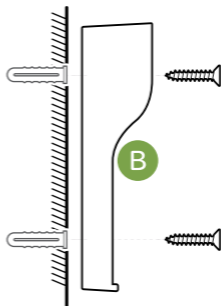
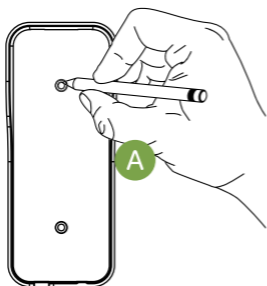

11. Tamper Alarm

Anti-theft Tamper Alarm.

You can also enable the anti-theft alarm in doorbell settings.

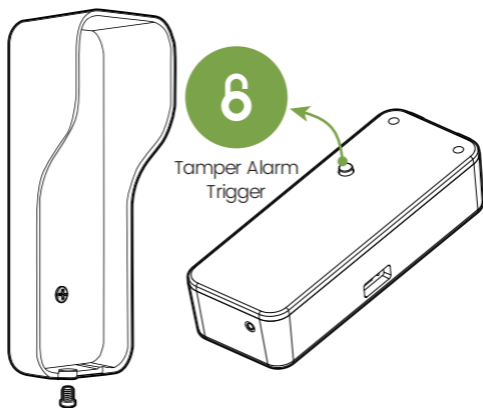

Tamper Alarm On

With tamper alarm on, your doorbell detects disassembly by the trigger on its back, and then a 30-second siren alarm will be triggered. Meantime, video recording get started, and alarm notification will be pushed to the owner's APP account.

Tamper Alarm Off

You can disable the tamper alarm in doorbell settings, and detach the doorbell without any alarm for battery recharge or regular maintenance.

12. Product Specifications

Video Doorbell Model No.: Bell J7

Camera	Full-HD Camera
Effective pixels	1920(H) x 1080(V)
IR LED	High power dot-array IR LED x 1
View angle	145°
Motion detect range	100° (Max 5m)
Motion sensitivity	5 level sensitivity settable
Alarm trigger	Call button, motion detect, anti-theft alarm
Wi-Fi	2.4 ~ 2.4835 GHz WIFI (IEEE802.11b/g/n)
Video recording	Video clips against events
Audio	Full duplex 2-way audio
Storage	SD card (Max. 128G)
Cloud storage	Yes (7-days-free trial)
Power supply	Built-in rechargeable Li-ion battery
Battery capacity	4,500mAh
Ingress protection	IP65
Operating Temp.	-10°C to 50°C
Dimensions	34.5 x 56 x 134.6mm
Net weight	125.8g (Battery Included)

Wireless Chime Model No.: Chime06

Power source 1	DC 5V 1A (from Micro USB)
Power source 2	AA LR6 1.5V battery x 3 units
Consumption	0.4W
Ringtones	4 ringtones optional
Connection type	Radio frequency 433MHz
Place of use	Indoor
Blue LED flashing	Pairing mode
Red LED flashing	Working normally
Blue LED flashing twice	Reset factory default succeeds
Working Temp.	-10°C ~ 50°C
Humidity	< 90%, no condensation
Dimension	75.5 x 75 x 28mm
Weight	70g (Exclude batteries)

