

CHAPIN

⚠ WARNING ⚠

WARNING: Improper use or failure to follow instructions can result in explosive failure causing serious eye or other injury. For safe use of this product you must read and follow all instructions. Do not leave a pressurized sprayer in the hot sun. Heat can cause pressure build-up resulting in possible explosion. Do not store or leave solution in tank after use. Always wear goggles, gloves, long sleeve shirt, long pants and full foot protection when spraying. Never use any tool to remove pump if there is pressure in sprayer. Never stand with face or body over top of tank when pumping or loosening pump to prevent ejecting pump assembly and/or solution from striking and injuring you. Never pressurize sprayer by any means other than the original pump. Do not attempt to modify this sprayer. Replace parts only with manufacturer's original parts. **Never spray flammable, caustic, acidic, chlorine, bleach or other corrosive solutions or heat, pressure, or gas producing chemicals. Always read and follow chemical manufacturer's instructions before use with this sprayer as some chemicals may be hazardous when used with this sprayer.**

SK-1154-1

Parts, Piezas, Pièces



<p>6-2001 Hose Kit Juego de manguera Nécessaire de tuyau</p>	<p>6-2000 Shut-off Handle Mango de cierre Poignée du robinet</p>	<p>6-6003 Nozzle Boquilla Buse</p>	<p>301120-4 Fan Nozzle (brass tip) Boquilla Buse</p>	<p>301272-1 Nozzle (brass tip) Boquilla Buse</p>
<p>6-7749 Extension wand (poly) Vara de extensión Rallonge</p>	<p>6-4566 Four Position Nozzle Boquilla de 4 posiciones Buse à 4 positions</p>			
<p>6-7756 Extension wand (brass) Vara de extensión Lance de rallonge</p>	<p>6-3337 Straps Tirantes Sangles</p>	<p>6-5385 Spray Shield Pantalla de pulverización Bouclier de pulvérisation</p>	<p>6-5364 Measure Cup Taza para medir Tasse à mesurer</p>	
<p>3-4843 Fan Nozzle Pack Paquete de boquilla a chorro Ensemble de buse à jet éventail</p>	<p>010842 Tool Holder Soporte para la herramienta Porte-outils</p>	<p>Relief Valve Válvula de descarga de presión Soupape de décompression</p>		
<p>6-1925 Repair Kit (not included) Juego de reparación (no incluido) Kit de réparation (non inclus)</p>	<p>6-8156</p>	<p>6-4645</p>	<p>6-8258</p>	<p>6-4648</p>

Note: Your particular sprayer may not include all parts pictured above.

Nota: Es posible que este pulverizador en particular no incluya todas las partes que se ilustran arriba.

Remarque : Votre pulvérisateur particulier pourrait ne pas inclure toutes les pièces illustrées plus haut.

Congratulations!

You have just purchased a quality Chapin product.

Register Your Sprayer Online @ www.chapinmfg.com Questions? Do Not Return To Store.

Call us @ 1-800-950-4458 or www.chapinmfg.com

⚠ WARNING ⚠

To prevent hose from blowing off, hose must cover both barbs on the outlet tube adapter and touch flange (Fig. 1B) before hose nut is securely tightened (Fig. 1C).

1. Hose to Tank

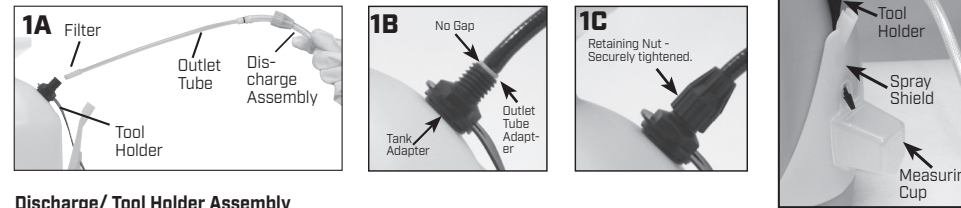

Discharge/ Tool Holder Assembly

- Insure the tool holder is assembled to the tank adapter before mounting the discharge assembly (Fig.1A). The Tool Holder snaps into the groove of the tank adapter. Figure 1D shows how the shield and cup are mounted (Not all models are provided with tool holder, spray shield and measuring cup).
- Insert the outlet tube portion of the discharge assembly into the tank adapter (Fig. 1A).
- Firmly insert the outlet tube portion into the tank adapter (Fig. 1B) leaving no gap between the tank adapter and outlet tube adapter. Firmly tighten the retaining nut to the tank adapter (Fig. 1C).

2. Nozzle / Extension Wand

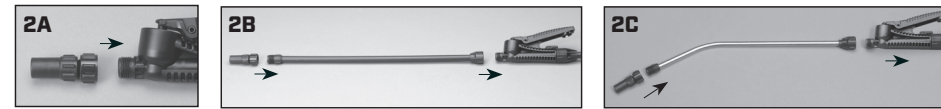

OR



Attach nozzle to shut-off handle or extension wand per Fig. 2A-2D depending on the style of extension wand included with sprayer.

Deck Sprayers Only (Fig. 2E-2G)

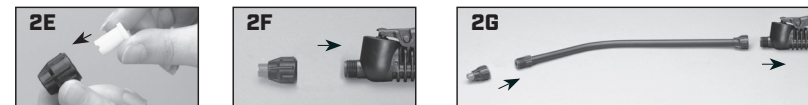

Insert nozzle into cap (2E).

Attach cap to shut-off handle or extension wand (Fig. 2F-2G).

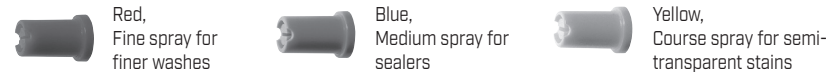

3. Filter

The filter helps prevent clogging while spraying. It is located on the end of the outlet tube inside your sprayer tank. To clean filter, remove the discharge assembly from the tank (Fig.1A). Make sure the filter is positioned at the bottom of the tank as pictured (Fig. 3A).

Note: Filters are not supplied with deck sprayers.

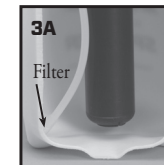

4. Shield Attachment to Wand

Snap shield onto wand as shown. Using the spray shield will help protect your plants etc. from over spray. (Not all models are provided with spray shield).



5. Pre-Use Check

- 1) **Do:** Check tightness of hose nut to be sure hose is securely attached to the tank outlet.
- 2) **Do:** Inspect hose for deterioration, cracks, softness, or brittleness. If any of these conditions are found, replace hose before using. Replace with original manufacturer's parts only.
- 3) **Do:** Remove pump (see Filling, Pressurizing and Spraying Instructions), inspect interior and exterior of tank for signs of deterioration of body and bottom. Any sign of deterioration indicates possible tank weakening and could result in explosive bursting under pressure. If any of these signs are found, discard tank immediately and replace. Do not attempt to patch leaks, etc., as this could result in serious injury.
- 4) **Do:** Follow Filling, Pressurizing and Spraying Instructions, except use water only (Pump plunger 10-20 strokes and inspect for leaks).
- 5) **Do:** Direct shut-off away from you and open to make sure discharge is not clogged.
- 6) **Do:** If unit passes this test, release pressure (see Pressure Releasing Instructions), empty tank, and proceed with Filling, Pressurizing and Spraying Instructions.
- 7) **Do:** Inspect all metal parts including the wand, nozzle and fittings for rust, corrosion and pitting. If any of these conditions are found, replace affected part with original manufacturer's part before using.

6. Filling

- 1) **Do:** Turn pump handle counterclockwise and remove pump
- 2) **Do:** Prepare spray solution following all directions and safety warnings on chemical label.
- 3) **Do:** Fill tank to no more than the proper gallon marker. Do NOT: overfill to accommodate pump.
- 4) **Do:** Check pump to make sure that no grass or dirt is stuck to barrel. Replace pump in tank and tighten securely.

7. Pressurizing and Spraying

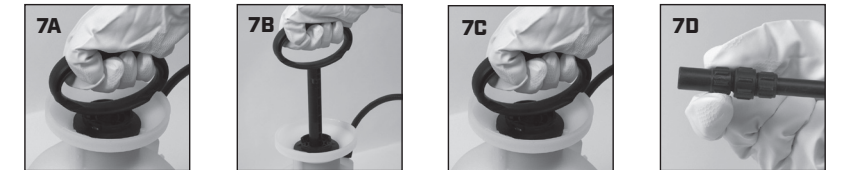

Do: Turn handle clockwise to tighten. Push handle down, turn 1/4 turn counterclockwise to release.

Do: Pump until you feel resistance.

Do: Push handle, down, turn 1/4 turn clockwise to lock. Begin spraying. Re-pump sprayer as required to maintain spray force.

Do: Turn end of nozzle to adjust spray pattern.

8. To Release Pressure

Sprayers with no pressure release valve

Do: With pump facing away, turn locked handle counterclockwise until air begins to escape. Stop turning handle when you hear air escaping.

Do: Point pump away until all air has escaped.

Sprayers with pressure release/relief valve

Fig. 8A: Lift and hold the cap OR, turn the valve slowly counterclockwise until air is completely exhausted.

Fig. 8B: Pull up stem until air is completely exhausted.

Fig. 8C: Pull ring out until air is completely exhausted.

Do: Point valve away from you when releasing pressure.

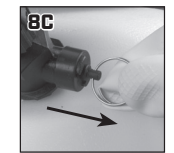
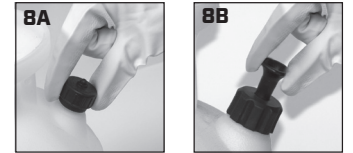

9. Care, Storage and Maintenance

- 1) **Do:** Follow chemical manufacture's instructions for cleaning. Rinse thoroughly with recommended solvent. Follow Filling, Pressurizing and Spraying Instructions, except pump unit only 8-10 strokes. Be sure that the wand and nozzle are thoroughly rinsed after each use.
- 2) **Do:** Open shut-off and allow water to run through discharge assembly.
- 3) **Do:** Release pressure (Follow Pressure Release Instructions), remove pump and empty sprayer.
- 4) **Do:** Store sprayer tank upside down, with pump removed, in a warm dry location.
- 5) **Do:** Periodically oil pump by dropping 10-12 drops of light oil down pump rod through opening in cover.

10. Fatigue-Free Spraying

For constant spraying, push down on shut-off handle and move grey locking mechanism away from you. To release, squeeze handle and move the grey locking mechanism back towards you. (Not all models are provided with this feature).

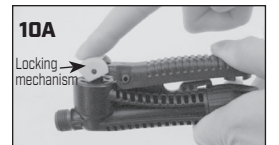

11. Troubleshooting - Tank pressurizes but does not spray.

WARNING: Release pressure in tank before troubleshooting.

Clean shut-off (Fig. 11A- 11D)

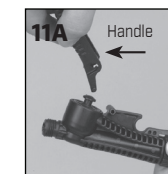

Pull handle straight up.



Insert notches from underside of handle into plunger grooves and turn counterclockwise.

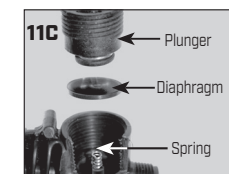

Remove plunger, diaphragm and spring. Wash diaphragm with mild detergent. Reassemble: Hold shut-off upright as shown, place spring in hole, place diaphragm on top of spring. Reassemble plunger and tighten.



Tighten plunger clockwise until flush to top of shut-off body. Do not over-tighten or unit may not spray. Slide forks under plunger, push handle down until it snaps into place.

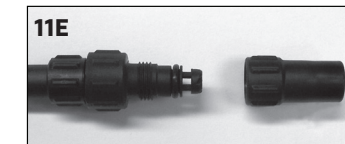

Clean Nozzle Assembly (Fig. 11E)

Remove nozzle cap. Clean and re-assemble.

CHAPIN

P.O. Box 549 700 Ellicott St.
Batavia, NY 14021-0549 U.S.A. 1-800-950-4458 www.chapinmfg.com

015646R0322

