

## Knurled grip knobs



### Material

Glass-fibre reinforced polyamide based (PA) technopolymer. Resistant to solvents, oils, greases and other chemical agents.

### Standard executions

- **EKK-B**: brass boss, threaded blind hole.

Ergostyle colours, matte finish.

- **EKK-p**: zinc-plated steel threaded stud, chamfered flat end UNI 947 : ISO 4753 (see Technical data).

Grey-black colour, matte finish.

### Special executions on request

The knurled knob EKK-p can be provided in one of the other Ergostyle colours.

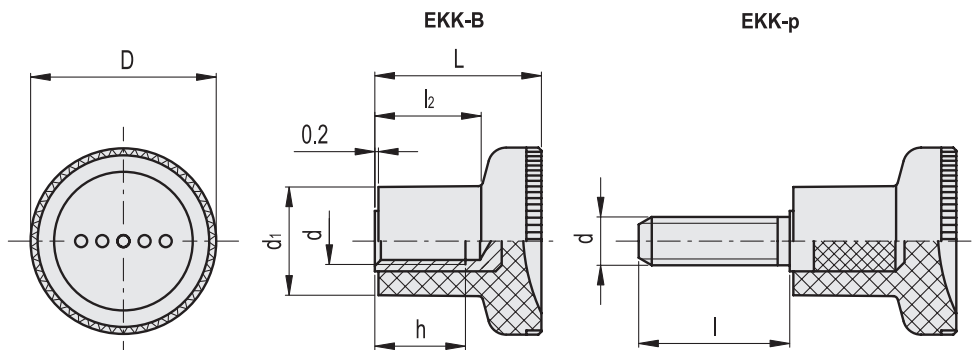

\* Complete with colour index, example: 242081-C2 EKK.16 B-M3-C2



### EKK-B

Code	Description	D	L	d <sub>6H</sub>	d <sub>1</sub>	h	l <sub>2</sub>	⚖
242081-*	EKK.16 B-M3-*	16	13	M3	8.5	6	8.5	7
242091-*	EKK.18 B-M4-*	18	15.5	M4	10.5	6	10.5	6
242111-*	EKK.21 B-M4-*	21	18	M4	12.5	10	10.5	8
242121-*	EKK.21 B-M5-*	21	18	M5	12.5	10	10.5	7
242211-*	EKK.25 B-M6-*	25	22.5	M6	14.5	12	14	11
242221-*	EKK.25 B-M8-*	25	22.5	M8	14.5	12	14	10
242311-*	EKK.31 B-M8-*	31	27	M8	18.5	15	17	20
242321-*	EKK.31 B-M10-*	31	27	M10	18.5	17	17	19

### EKK-p

Code	Description	D	L	d <sub>6g</sub>	d <sub>1</sub>	l	l <sub>2</sub>	⚖
243121-C1	EKK.21 p-M5x10-C1	21	18	M5	12.5	10	10.5	7
243126-C1	EKK.21 p-M5x16-C1	21	18	M5	12.5	16	10.5	8
243131-C1	EKK.21 p-M5x20-C1	21	18	M5	12.5	20	10.5	9
243146-C1	EKK.21 p-M6x16-C1	21	18	M6	12.5	16	10.5	10
243151-C1	EKK.21 p-M6x20-C1	21	18	M6	12.5	20	10.5	11
243161-C1	EKK.21 p-M6x30-C1	21	18	M6	12.5	30	10.5	13
243226-C1	EKK.25 p-M6x16-C1	25	22.5	M6	14.5	16	14	13
243231-C1	EKK.25 p-M6x20-C1	25	22.5	M6	14.5	20	14	14
243236-C1	EKK.25 p-M6x25-C1	25	22.5	M6	14.5	25	14	15
243241-C1	EKK.25 p-M6x30-C1	25	22.5	M6	14.5	30	14	16
243326-C1	EKK.31 p-M8x20-C1	31	27	M8	18.5	20	17	26
243331-C1	EKK.31 p-M8x25-C1	31	27	M8	18.5	25	17	28
243336-C1	EKK.31 p-M8x30-C1	31	27	M8	18.5	30	17	30
243346-C1	EKK.31 p-M8x40-C1	31	27	M8	18.5	40	17	32
243361-C1	EKK.31 p-M10x30-C1	31	27	M10	18.5	30	17	34
243371-C1	EKK.31 p-M10x40-C1	31	27	M10	18.5	40	17	40