

Materials list

1/2 yd HyperD³⁰⁰ orange (top fabric)

1/2 yd - HyperD³⁰⁰ Black (Bottom)

1 yd - Pocket mesh (side & Front Pocket)

1/2 yd - 3mm Spacer Mesh - (Straps, hip belt)

✓ 20" x 30" 1/4" closed cell foam (Hip & Shoulder straps)

10 ft - 3/4" webbing (straps, Hip belt accents, Sternum Strap)

15 ft - 1" webbing (strap attachment, Frame Attachment)

6 ft - 1 1/2" webbing (waist belt)

1/2 yd Divers mesh (Back panel)

10 ft - 1/8" shock cord (side & Front pockets)

4 - 1" ladder locks (straps, top compression)

2 - 1 1/2" ladder locks (waist belt)

2 - 1/2" ladder locks (load lifters)

2 yd - 1/2" grossgrain or webbing (load lifter straps, 1/2" D-Ring/Packhook/line loc attachments)

8 - 1/2" line locs 3 (side compression, Frame tensioners)

3 - 3/4" D-Rings (strap accent, Front pocket shock cord compression)

4 - cord locks (side pockets, Front Pocket, Front pocket compression) (2 regular, 2 - 2 hole cord locks)

2 - sternum strap adjusters

1 - whistle Buckle (sternum strap)

6 - 1/2" D-Rings (side compression)

4 - 1/2" pack hooks (front pocket compression)

1 - 3/4" buckle (roll top closure)

2 ft - water resistant zipper (side pouches) (#5)

2 - #5 coil zipper sliders

3/4" union tape (roll top closure)

24' lawson reflective glowwire (side compression, Frame tension) (you'll have extra)

72" of .125" x .325" carbon fiber strips (Frame)

9 yds polyester 1/2" bias tape (inside seam binding)

Fabric Marker, Orange HYPERD300 (Approximate)
need 1 1/2 yds.

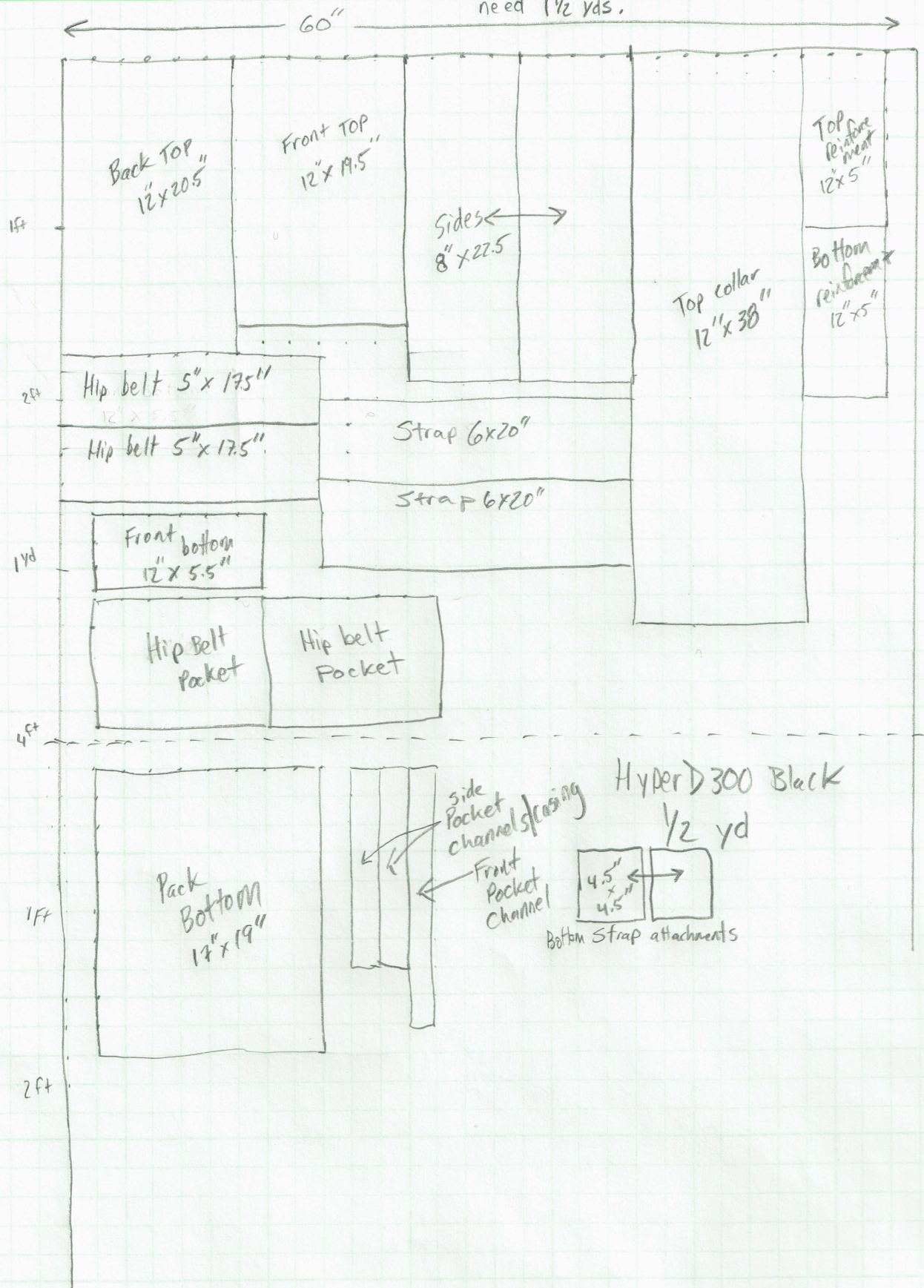

HyperD300 Black
1/2 yd

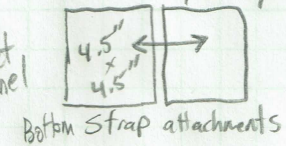
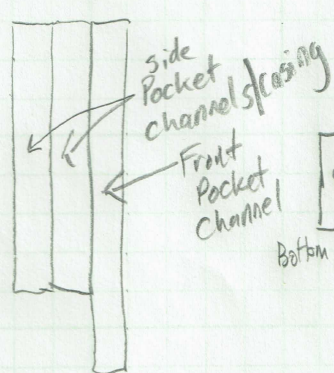

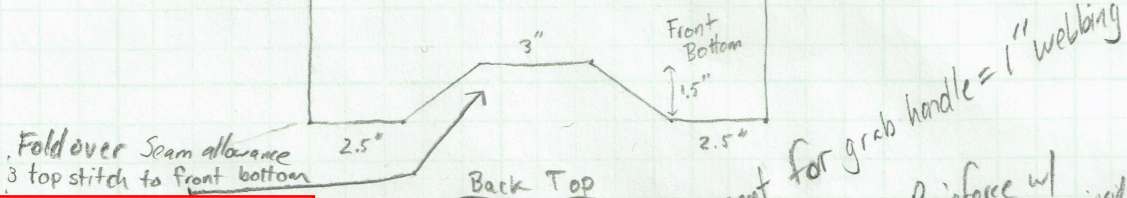
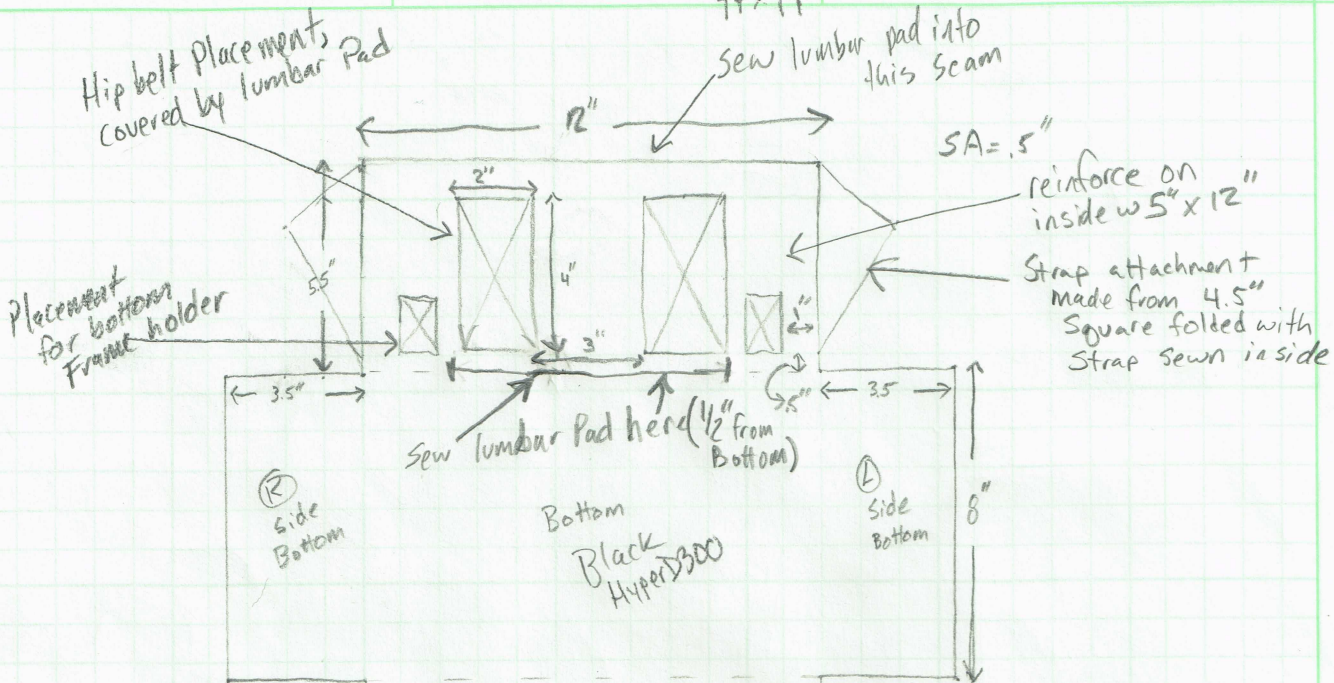

Add load lifters and 1" ladder locks here

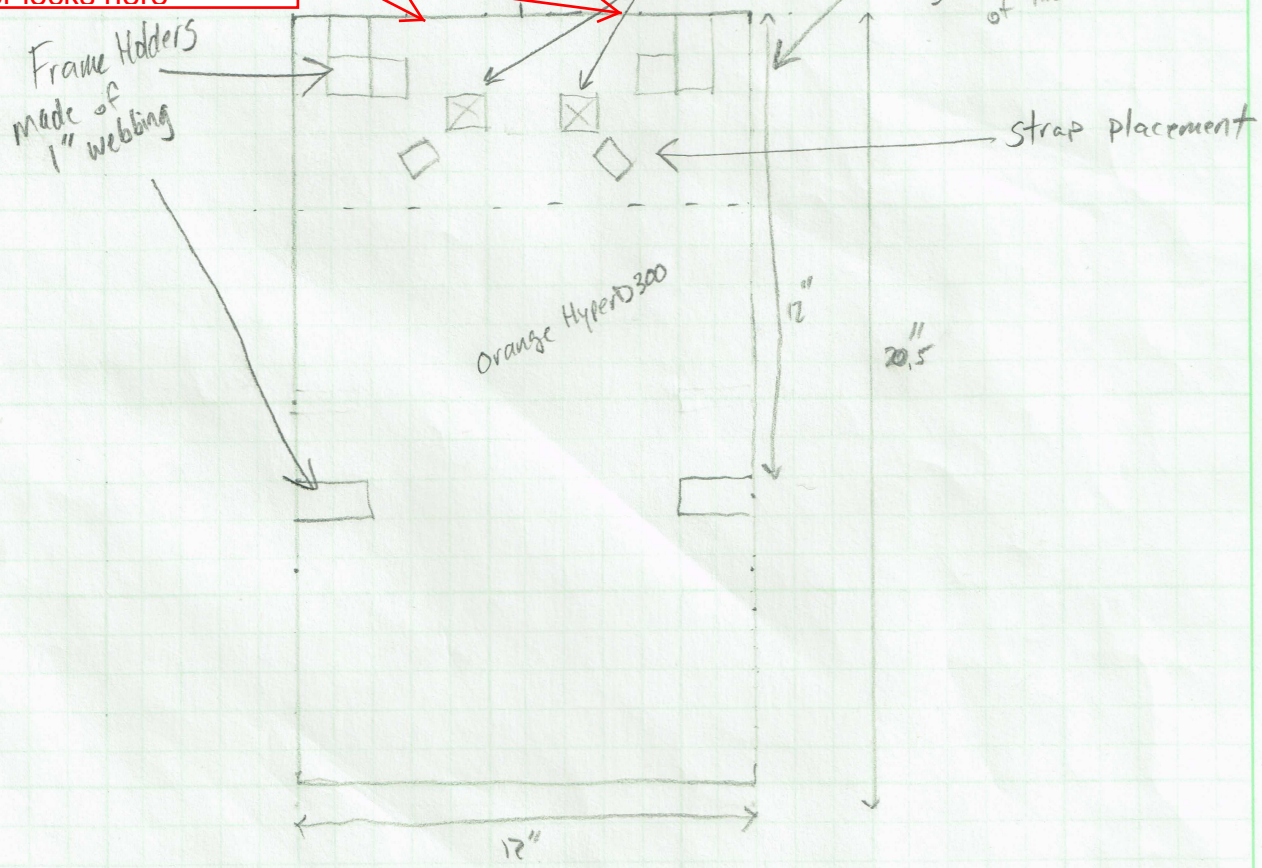

Distance between hip belt and shoulder straps must be adjusted to fit. This was designed for my 19.5" torso based off packs I've had that fit well.

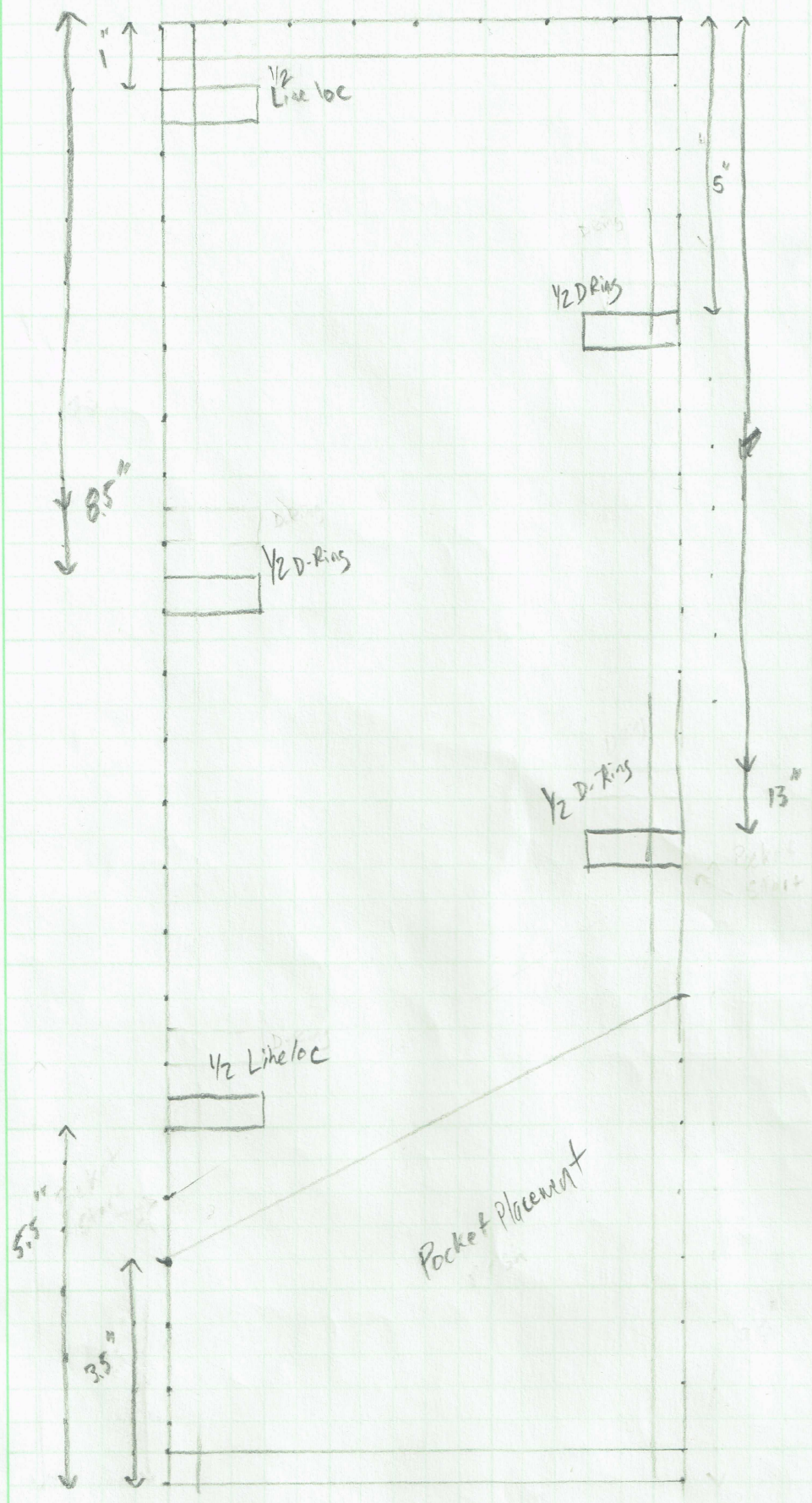

Front Panel Top 12x19.5"

V.3

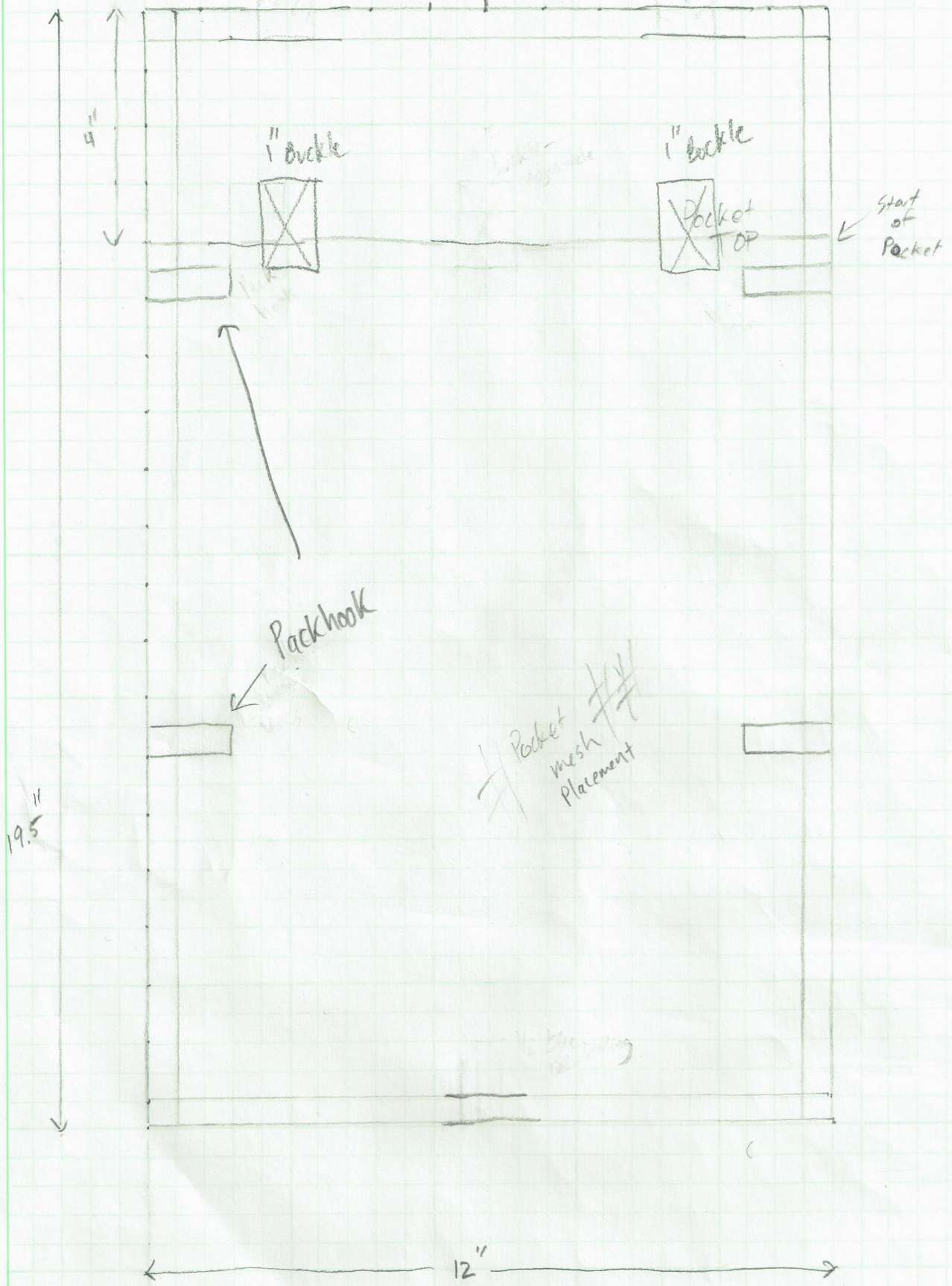

Front Panel Bottom
12" x 5.5"

V.3

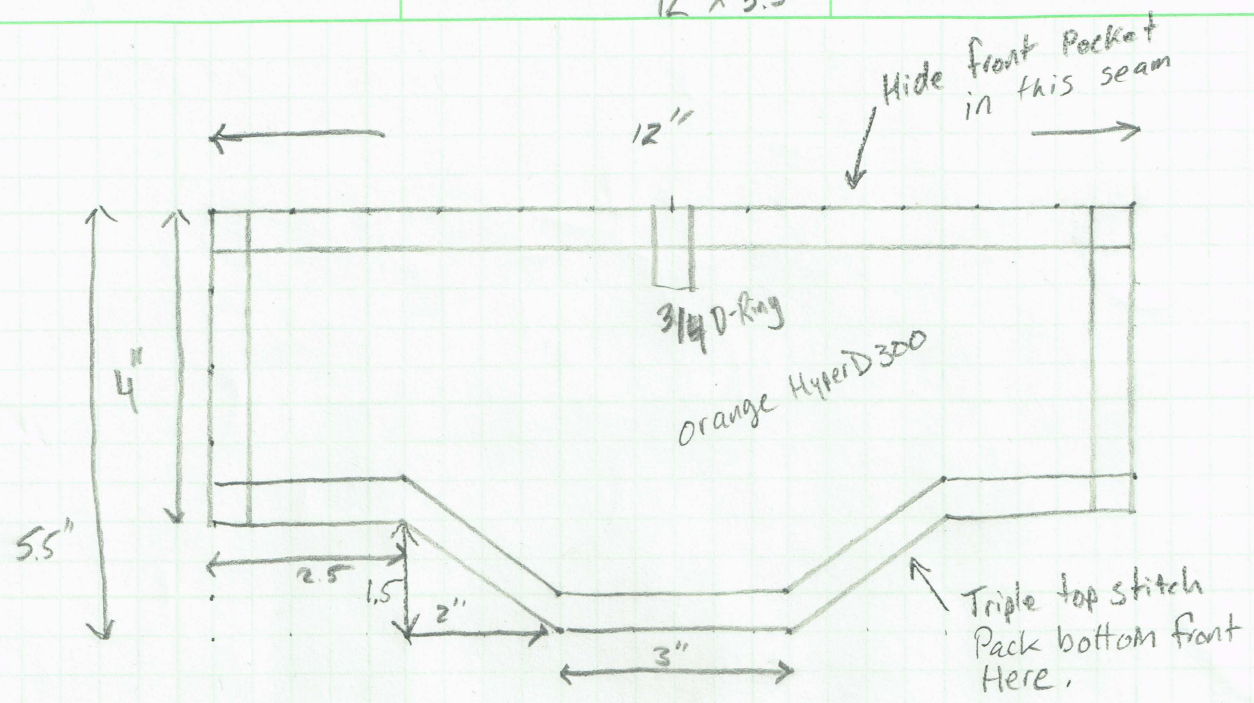

Top Collar (not to scale)
12" x 38"

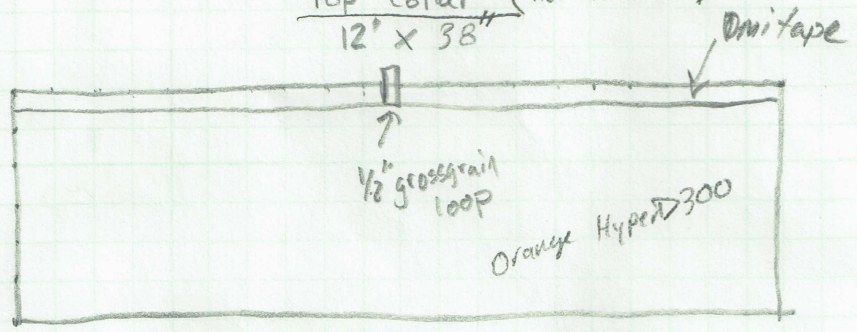

attach to completed body, finish with
flat felled seam, then sew union tape or velcro
3 Buckles to top seam

Front Pocket
17" x 15.5"

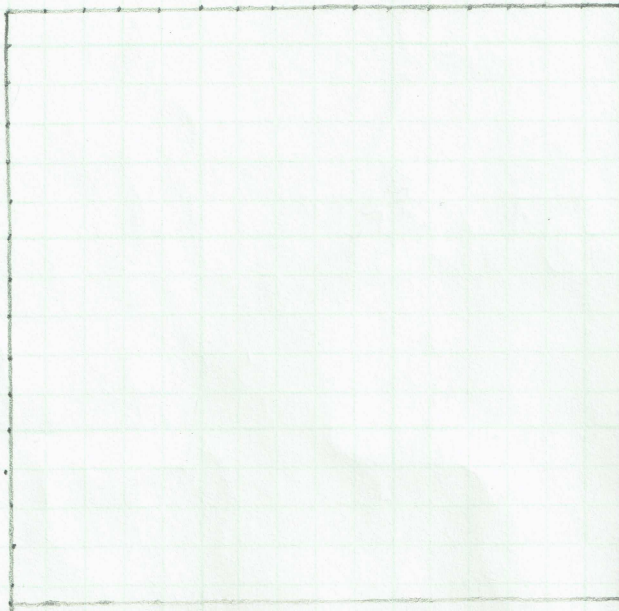

Casing: 2" x 17"

Pleat this edge to line up with Pack front Seam

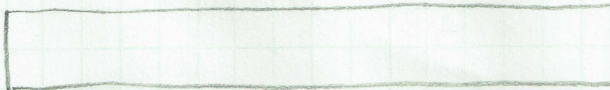

Side Pockets 12" x 12.5"

10.5" x 8"

Not to Scale

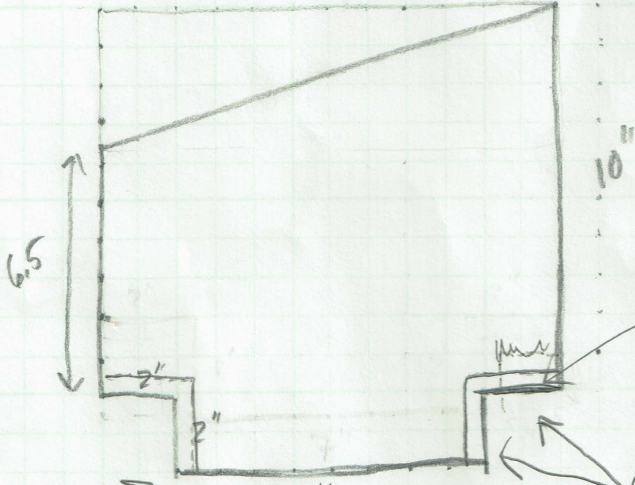

1/2" S.A.

Sew these edges together 1/2 S.A. leaving 1/2" unsewn at end (Shapes pocket)

Casing: 2" x 12.5"



Bind edge with Bias tape, Sew to Pack side Bottom

Hip Strap 17.5" X 5" one side 3D spacer mesh, 1 side HyperD 300 on All Straps & lumbar pad

Fits my ~34" waist, adjust accordingly

